



PLT SOLUTIONS PLT-90296 Color Wattage Selectable LED Wrap Around Fixture Light Installation Guide

[Home](#) » [PLT SOLUTIONS](#) » PLT SOLUTIONS PLT-90296 Color Wattage Selectable LED Wrap Around Fixture Light Installation Guide



PLT-90296 Color Wattage Selectable LED Wrap Around Fixture Light SAFETY AND Installation Guide

Contents [[hide](#)]

- [1 WARNING](#)
- [2 Installation Instructions](#)
- [3 General Wiring Diagram](#)
- [4 Documents / Resources](#)
- [5 Related Posts](#)

WARNING

- Before installing, servicing, or performing routine maintenance upon this equipment, follow these general precautions.
- To reduce the risk of death, personal injury, or property damage from fire, electric shock, falling parts, cuts/abrasions, and other hazards, read all warnings and instructions included with and on the fixture box and all fixture labels.
- Proper grounding is required to ensure safety.
- Power must be turned off at the breaker before installation or maintenance.

- This product must be installed in accordance with the applicable installation code by a person familiar with the construction and operation of the product and the hazards involved.
- Wear gloves and eye protection at all times while installing, servicing, or performing maintenance on the luminaire, and avoid direct eye exposure to the light source while it is on.
- Do not install damaged product. Inspect luminaire for damage that may have occurred during transit. If damaged, contact the manufacturer immediately.
- These instructions do not purport to cover all details or variations in equipment nor to provide every possible contingency to meet in connection with installation, operation, or maintenance. Should further information be desired or should particular problems arise which are not covered sufficiently for the purchaser's or owner's purposes, contact the manufacturer.

WARNING

- To prevent wiring damage, do not expose wiring to edges of sheet metal or any other sharp objects.
- All wiring connections should be capped with UL approved wire connectors.
- Risk of burn. Disconnect power and allow fixture to cool before handling fixture.

CAUTION

- Do not create any new or alter any existing holes.
- Verify that supply voltage is correct by comparing it with the luminaire label information.
- Green ground screw provided in proper location. Do not relocate.

NOTICE

1. Account for small parts and destroy packing material, as these may be hazardous to children.
2. Minimum 90° supply conductors.
3. Specifications and dimensions subject to change without notice.
4. Suitable for dry or damp location.

Installation Instructions

Surface Mounting to Ceiling

Step 1. Remove the lens from the housing by using the provided suction cup. Press the suction cup near one end of the fixture to absorb one side of the lens. Pull the suction cup to detach the lens from the luminaire. (Figure 1A)

Step2. Use a screwdriver to punch out one of the knock out holes and pass the electrical cable out from the housing.

Step 3. Use the luminaire as a template. Place it on the junction box and mark the four hole positions on the ceiling. Lay the luminaire aside and drill the four holes. Insert an anchor bolt into each hole and place the fixture in the desired location. Screw the four mounting screws into each anchor bolt, then connect the AC wires. (Figure 2)

Step 4. Install the lens by starting at one end of the housing. Insert lens slot onto the edge of the housing. Carefully squeeze the lens to engage the opposite side with the housing. Continue this action down the length of the lens until fully installed onto the housing. (Figure 2A)

Step 5. Turn on the luminaire.

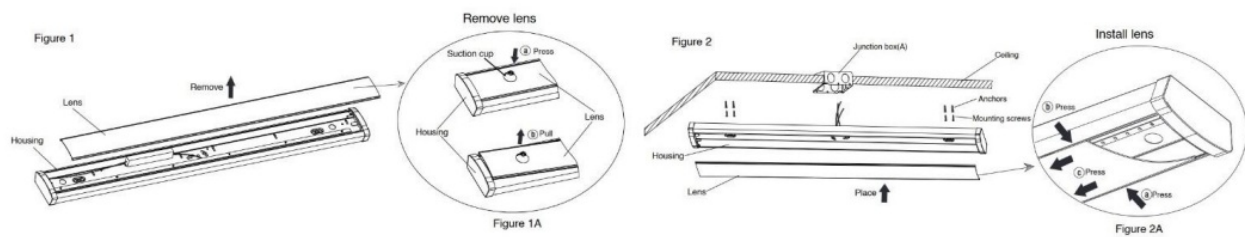

Surface Mounting to J-Box

Step 1. Remove the lens from the housing by using the provided suction cup. Press the suction cup near one end of the housing to absorb one side of the lens. Pull the suction cup to detach the lens from the luminaire.

Step2. Use a screwdriver to punch out one of the knock out holes and pass the electrical cable out from the housing.

Step 3. Use the luminaire as a template. Place it on the junction box and mark the four hole positions on the ceiling. Lay the luminaire aside and drill the four holes. Insert an anchor bolt into each hole and place the fixture in the desired location. Screw the four mounting screws into each anchor bolt, then connect the AC wires.

Step 4. Install the lens by starting at one end of the housing. Insert lens slot onto the edge of the housing. Carefully squeeze the lens to engage the opposite side with the housing. Continue this action down the length of the lens until fully installed onto the housing.

Step 5. Turn on the luminaire.

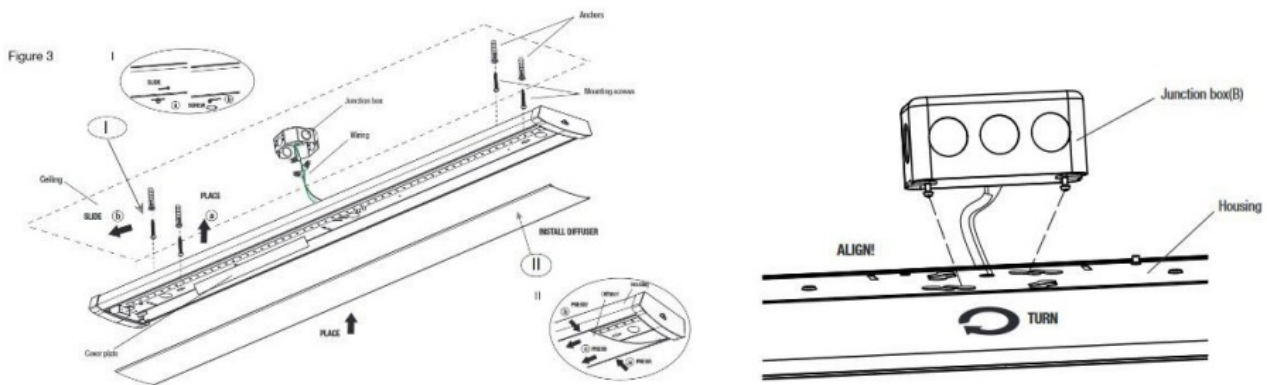

General Wiring Diagram

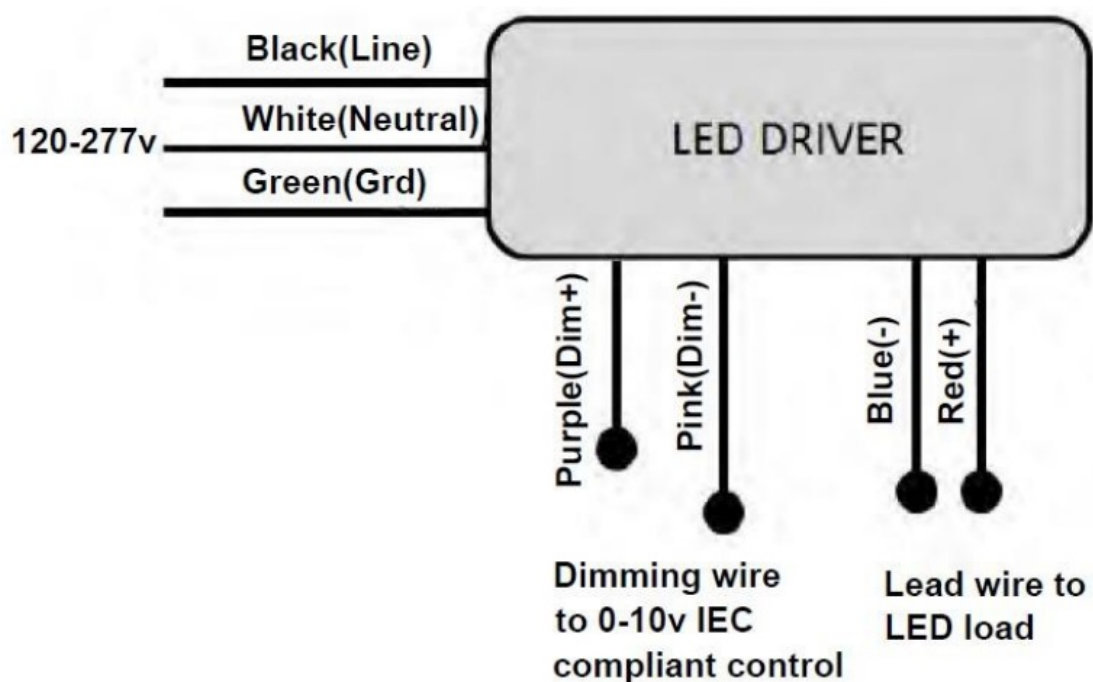



972-535-0926

pltsolutions.com

Ver 020723

Documents / Resources

	<p>PLT SOLUTIONS PLT-90296 Color Wattage Selectable LED Wrap Around Fixture Light [pdf] Installation Guide</p> <p>W 16-20-24, PLT-90296 Color Wattage Selectable LED Wrap Around Fixture Light, Color Wattage Selectable LED Wrap Around Fixture Light, Wattage Selectable LED Wrap Around Fixture Light, Selectable LED Wrap Around Fixture Light, LED Wrap Around Fixture Light, Around Fixture Light</p>
---	---