



# PLT PremiumSpec PLT-90293 Selectable LED Panel-Troffer Hybrid Fixture User Manual

[Home](#) » [PLT PremiumSpec](#) » [PLT PremiumSpec PLT-90293 Selectable LED Panel-Troffer Hybrid Fixture User Manual](#) 



## PLT-90293 Selectable LED Panel-Troffer Hybrid Fixture User Manual

### Contents

- [1 PLT-90293 Selectable LED Panel-Troffer Hybrid Fixture](#)
- [2 Installation Instructions](#)
- [3 Wiring Diagram](#)
- [4 Documents / Resources](#)
- [5 Related Posts](#)

## PLT-90293 Selectable LED Panel-Troffer Hybrid Fixture

COLOR/WATTAGE SELECTABLE LED PANEL/TROFFER HYBRID FIXTURE

### SAFETY AND INSTALLATION INSTRUCTIONS

#### WARNING

- Installation, service, and maintenance of luminaries should be performed by a qualified licensed electrician.
- Please read these instructions to fully understand and safely use this product.

#### CAUTION

- Check that all fixture connections have been properly made and the fixture is grounded to avoid potential electrical shock.

- Designed for use in AC110-277V, 50/60Hz, protected circuit

## NOTICE

- Suitable for damp locations.
- Access above ceiling required. Suitable for suspended ceilings.

## Installation Instructions

**Step 1.** Bend J-Hook by 45° making it vertical to the rear cover of the LED luminaire (Figure 1A). Bend the top part of J-Hook by 90° (Figure 1 B). Repeat STEP 1 to other J-Hooks.

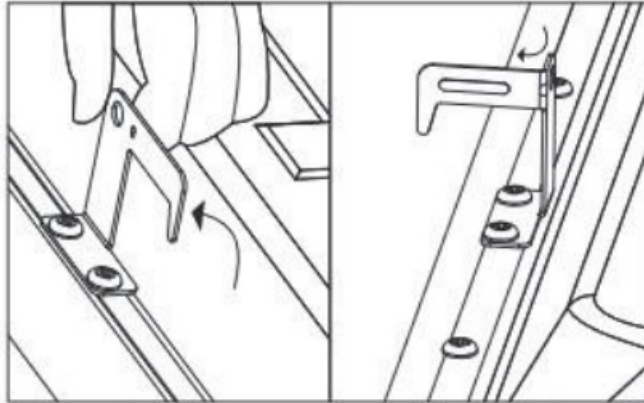

Figure 1 A

Figure 1 B

**Step 2.** Turn off power, remove the ceiling panel, then place LED luminaire into the T-bar, ensuring the LED luminaire is attached to the ceiling. (Figure 2) (J-Hook for positioning only)

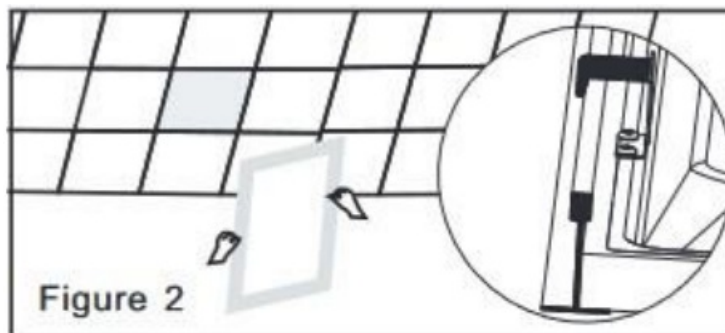

Figure 2

**Step 3.** Open the driver box. (Figure 3) (Size of conduit: 22.2mm or .87 inches dia)

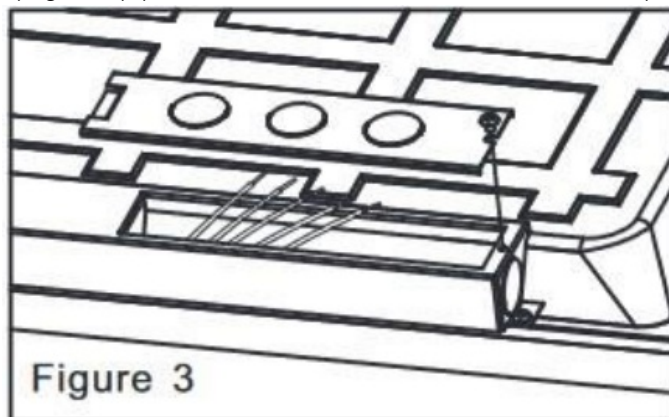

Figure 3

**Step 4.**

### 1. Connect AC Wires

- Connect the line wire to the black wire of the luminaire, the neutral to the white wire, and the ground wire to the green wire.

### 2. Connect Dimmer

- Compatible with 0-10V dinner
- The driver VIOLET (D+) to the dimmer+, and the driver PINK (D-) to the dinner
- Connect the wires with terminal cap as shown in wiring diagram (Figure 4) Incoming insulated dimming conductors shall have voltage rated at least equal to the branch voltage.

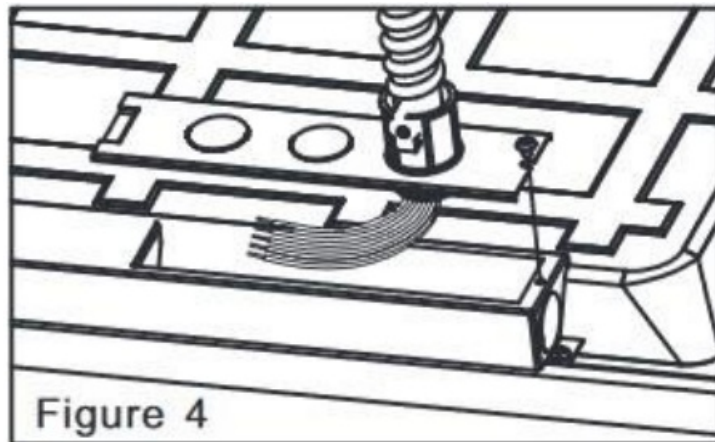

Figure 4

**Step 5.** Close the driver box and screw in. (Figure 5)

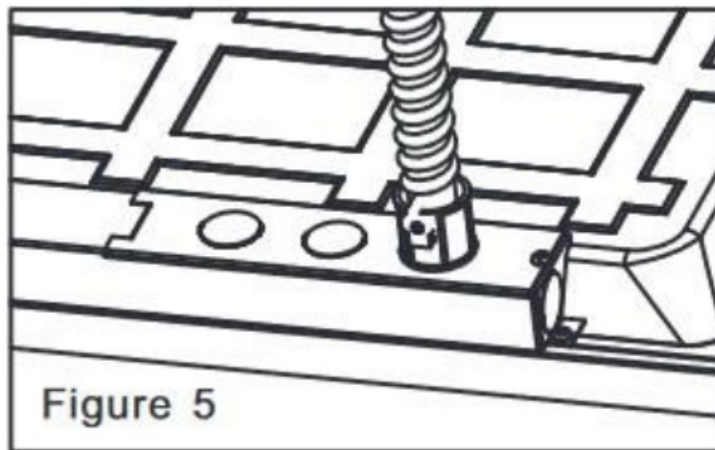
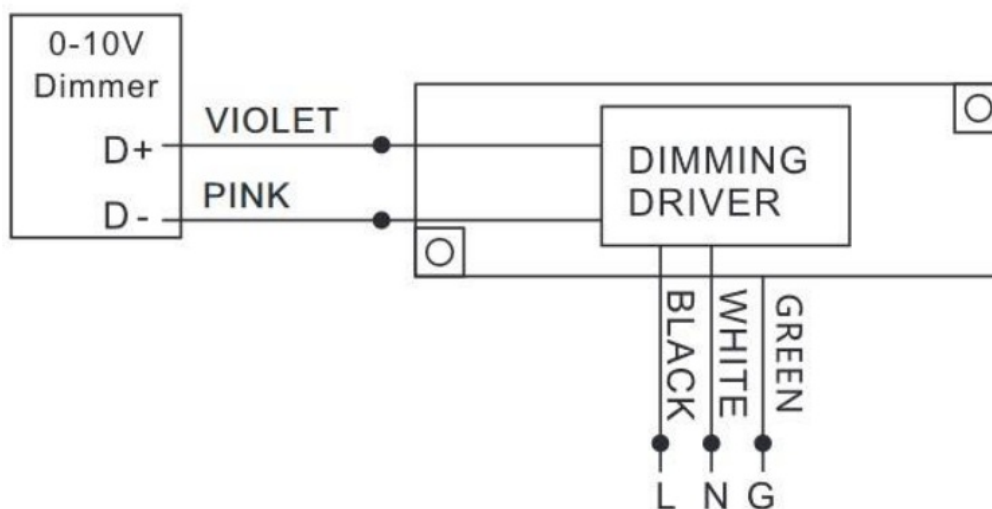

Figure 5

## Wiring Diagram



- Before installing, servicing, or performing routine maintenance upon this equipment, follow these general precautions.

- To reduce the risk of death, personal injury, or property damage from fire, electric shock, falling parts, cuts/abrasions, and other hazards, read all warnings and instructions included with and on the fixture box and all fixture labels.
- Proper grounding is required to ensure safety.
- Power must be turned off at the breaker before installation or maintenance.
- This product must be installed in accordance with the applicable installation code by a person familiar with the construction and operation of the product and the hazards involved.
- Wear gloves and eye protection at all times while installing, servicing, or performing maintenance on the luminaire, and avoid direct eye exposure to the light source while it is on.
- To prevent wiring damage or abrasion, do not expose wiring to edges of sheet metal or other sharp objects.
- Do not install damaged product. Inspect luminaire for damage that may have occurred during transit. If damaged, contact the manufacturer immediately.
- These instructions do not purport to cover all details or variations in equipment nor to provide every possible contingency to meet in connection with installation, operation, or maintenance. Should further information be desired or should particular problems arise which are not covered sufficiently for the purchaser's or owner's purposes, contact the manufacturer.

972-535-0926  
[pltsolutions.com](http://pltsolutions.com)  
 ver 031623

## Documents / Resources

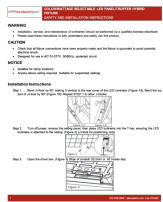
	<p><a href="#">PLT PremiumSpec PLT-90293 Selectable LED Panel-Troffer Hybrid Fixture</a> [pdf] User Manual</p> <p>PLT-90293 Selectable LED Panel-Troffer Hybrid Fixture, PLT-90293, Selectable LED Panel-Troffer Hybrid Fixture, Troffer Hybrid Fixture, Hybrid Fixture, Fixture</p>
---	--