



PLAUD NB-100 Built In AI Voice Recorder User Guide

[Home](#) » [PLAUD](#) » PLAUD NB-100 Built In AI Voice Recorder User Guide 

PLAUD NB-100 Built In AI Voice
Recorder User Guide

Welcome to PLAUD NOTE!

Hallo!

Ciao!

Bonjour!

Hola!

こんにちは!

안녕하세요!

你好!

Hello!



**Download the PLAUD App to
activate PLAUD NOTE upon first use.**

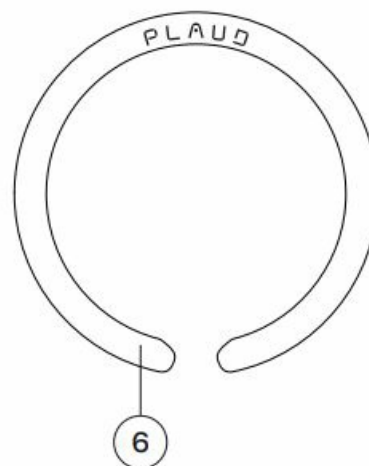
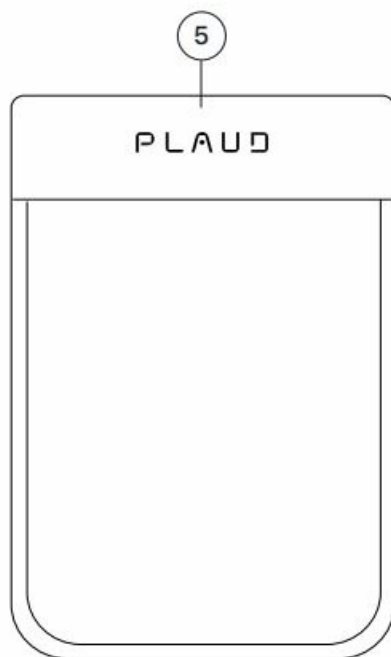
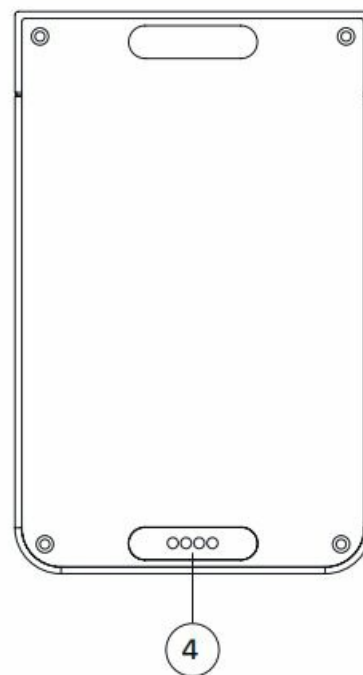
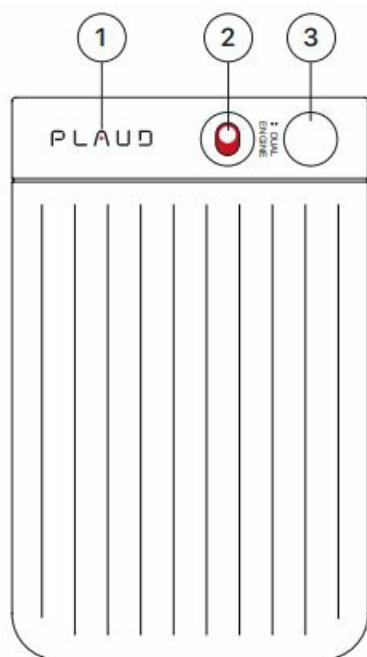

1. Indicator Light
2. Recording Mode Switch
3. Record Button
4. Charging Port
5. MagSafe Case
6. MagSafe Ring

Contents

- 1 Quick Guide
- 2 Start Recording
- 3 Documents / Resources
 - 3.1 References

Quick Guide

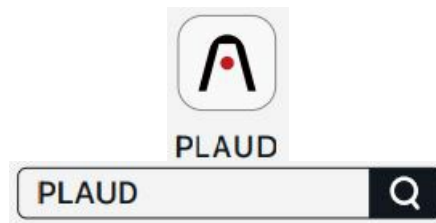

<https://apps.apple.com/us/app/plaud-ai-voice-recorder/id6450364080>



https://play.google.com/store/apps/details?id=ai.plaud.android.plaud&hl=en_IN

- Search for “PLAUD” in the App Store or Google Play to download the PLAUD App.
- Create your PLAUD Account.



- Short-press the record button to wake up your PLAUD NOTE.
- The white light illuminating indicates that your PLAUD NOTE is ready to bind with your account.

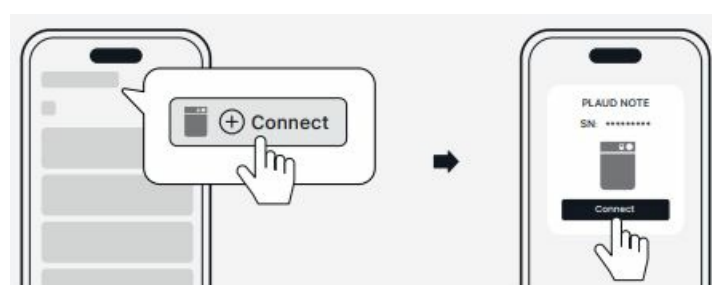

- Open the PLAUD App and follow the on-screen instructions to complete the binding process.

Start Recording

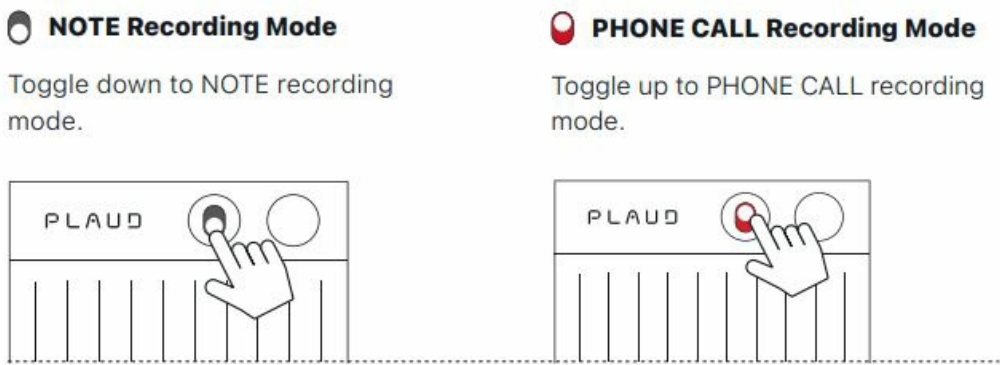

Notice
For phone call recording, ensure that your PLAUD NOTE is under the PHONE CALL recording mode and securely attached to the back of your phone using the provided MagSafe Case.

Start
Long-press the record button and hold it for 1 second until you feel 1 vibration, indicating that the recording has started.

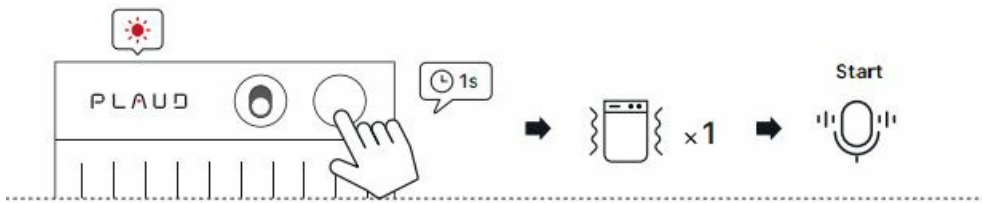

End
Long-press the record button and hold it for 1 second until you feel 2 vibrations, indicating that the recording has ended.

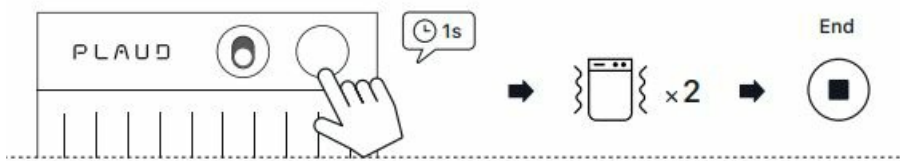

Documents / Resources

	PLAUD NB-100 Built In AI Voice Recorder [pdf] User Guide NB-100 Built In AI Voice Recorder, NB-100, Built In AI Voice Recorder, Voice Recorder, NB-100 Recorder
---	--

References

- [PLAUD.AI - Connect AI with Real Life](#)
- [User Manual](#)

Manuals+. Privacy Policy

This website is an independent publication and is neither affiliated with nor endorsed by any of the trademark owners. The "Bluetooth®" word mark and logos are registered trademarks owned by Bluetooth SIG, Inc. The "Wi-Fi®" word mark and logos are registered trademarks owned by the Wi-Fi Alliance. Any use of these marks on this website does not imply any affiliation with or endorsement.