



platypus Gravityworks Carbon Element Instruction Manual

[Home](#) » [platypus](#) » platypus Gravityworks Carbon Element Instruction Manual 

platypus®

GRAVITYWORKS™
CARBON ELEMENT



Contents

- [1 Gravityworks Carbon Element](#)
- [2 SPECIFICATIONS](#)
- [3 INSTALLATION INSTRUCTIONS](#)
- [4 Documents / Resources](#)
- [5 Related Posts](#)

Gravityworks Carbon Element



WARNING

Used alone, this product is not a microbiological filter. It will not remove, kill or deactivate harmful bacteria, protozoa or viruses. Use only in conjunction with a complete GravityWorks Filter System as instructed.

READ, UNDERSTAND, AND FOLLOW ALL instructions for GravityWorks Filter System and GravityWorks Carbon Element before use.

Failure to follow warnings and instructions may result in illness.

SPECIFICATIONS

| | |
|---------------|---|
| ELEMENT LIFE | ~ 300 liters (depends on water quality) |
| ELEMENT MEDIA | Granulated Activated Carbon |

INSTALLATION INSTRUCTIONS

Only install the GravityWorks™ Carbon Element BELOW the GravityWorks Filter Cartridge.

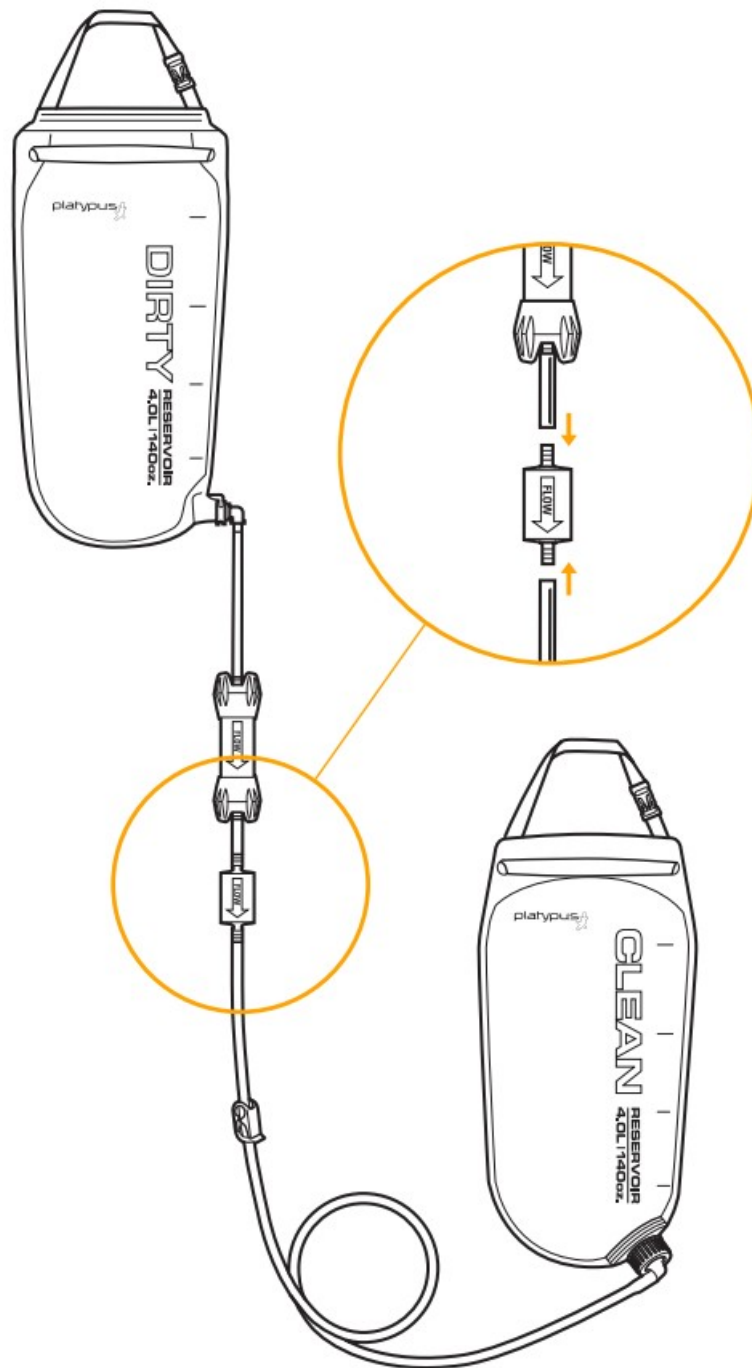
**FIRST USE:**

Flush out the loose carbon dust by letting a few liters of water flow through the Carbon Element before attaching outlet hose and clean reservoir. (This harmless carbon dust may recur if filter is dropped.)

STORAGE:

Before long term storage we recommend sanitizing the Carbon Element by placing it in boiling water for 5 minutes. Once Carbon Element has cooled, shake out excess water and store in a cool dry place.
DO NOT PLACE THE GRAVITYWORKS FILTER CARTRIDGE IN BOILING WATER.

platypus®

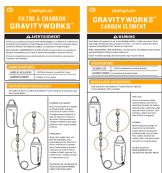

platypus Gravityworks Carbon Element [pdf] Instruction Manual
Gravityworks Carbon Element, Gravityworks, Gravityworks Element, Carbon Element, Element