



Pknight WiFi DMX Easy Node Blue User Manual

[Home](#) » [Pknight](#) » Pknight WiFi DMX Easy Node Blue User Manual 

Contents

- [1 Pknight WiFi DMX Easy Node Blue](#)
- [2 Product Usage Instructions](#)
- [3 Introduction](#)
- [4 Indicators](#)
- [5 General Instructions](#)
- [6 WiFi indicator diagram](#)
- [7 Setting](#)
- [8 WiFi SETTING](#)
- [9 Documents / Resources](#)
 - [9.1 References](#)
- [10 Related Posts](#)

Pknight

Pknight WiFi DMX Easy Node Blue



Specifications

- Product Name: wifi-dmx easynode BLUE
- Charging Port: Type-C
- Output Port: USB-A
- WiFi Channel: 2.4G
- Default IP Address: 192.168.4.1
- Default Hotspot Password: PKNIGHT.WIFI

Product Usage Instructions

Indicators

The device has several indicators for different functions:

- Charging Port (Type-C)
- Antenna
- Function Button (Refer to Page 4)
- Output Port USB-A (Works as a power bank for other devices)
- 2.4G WiFi Channel Indicator
- Power Indicator

Function Button Detailed Instructions

The function button controls various settings and functions of the device. Refer to the user manual for detailed instructions on using the function button.

Setting

To set up the device, follow these steps:

1. Find and connect to the PKNIGHT.WIFI+64123 network using the Wi-Fi settings on your mobile device.

2. The default password to join is PKNIGHT.WIFI.
3. Once connected, start the DMX app on your device.

WiFi Setting

If you need to change the WiFi name and password:

1. Open a web browser and enter 192.168.4.1.
2. You can customize the WiFi name and password for security purposes.
3. For external router connections, enter the router's WiFi name and password.
4. Check the settings to disable or enable router mode as needed.
5. Turn off the power and back on for changes to take effect.

Frequently Asked Questions (FAQ)

- **Q: What should I do if the LED indicator blinks quickly?**

A: If the LED indicator blinks quickly, it indicates normal DMX signal output. Otherwise, please recheck the setup.

- **Q: How do I restore factory settings if I forget the WiFi password?**

A: You can refer to the function button instructions on page 4 to restore factory settings if you forget the WiFi password.

Introduction

Congratulations and thank you for purchasing the Pknight WiFi-DMX EasyNode. The plug is a wireless bridge between your WiFi device and all lighting products equipped with DMX512. It is the ideal solution for film and television video lights or for any event where you don't want data cables to be seen, and when it is not easy to run data cables to your fixture(s) location. The EasyNode creates its own local secure Wi-Fi network so that you can use Your iPhone or iPad or Android phone or a laptop or Tablet PC as a lighting controller using many DMX apps.

Customer Support: Pknight provides a toll free customer support, to provide set up help and to answer any question should you encounter problems during your set up or initial operation. You may also visit us on the web at www.Pknightpro.com for any comments or suggestions.

E-mail: info@pknightpro.com / carrierplus@163.com We will contact you within 24 hours

important

Default IP Address: 192.168.4.1

Default Hotspot Password: PKNIGHT.WIFI

The app we can use:

APP	iOS	iPad	Android	Mac	Windows
WIFI-DMX PRO	✓	✓	✓	own production free app	
Luminair 4	✓	✓			
Stellar	✓	✓	✓		
Photon		✓			
StageLight		✓			
Blackout Lighting Console		✓			
vibrio		✓	✓		
LightRider		✓			
FreeStyle					✓
QLC+				✓	✓
Lightkey				✓	
LXConsole				✓	
Madrix				✓	✓
Chameleon				✓	
LightFactory					✓
arkaosmediamaster				✓	✓
Lightforge					✓
TOUCHDESIGNER				✓	✓
Jinx!LED Matrix Control					✓

noteThere are many other apps not on the list



Indicators

1. Charging Port (Type-C)
2. Antenna
3. Function Button
4. Output Port USB-A Works as a power bank for other devices
5. 2.4G WiFi Channel Indicator
 - Fast blink: Detects ArtNet or sACN input and outputs DMX signal

- Slow blink: Waiting for signal

6. Power Indicator



General Instructions

- For optimal performance, position the antenna higher with minimal obstructions.
- Avoid using the device in crowded 2.4G environments.
- Avoid using the device in crowded 2.4G environments.
- Resetting the device will restore default settings.

Function Button Detailed Instructions

- Short press: Power on
- Long press: Switch WiFi channel
- Double press: Power off
- Reset: restore default settings

For a comprehensive guide on using the Function Button, watch the step-by-step video tutorial. Scan the QR code below:



WiFi indicator diagram

13 colors



note

If the led indicator blinks quickly, the DMX signal output is normal, otherwise, it is abnormal. Please recheck!

All setup is done by the device with the apps installed.

Turned on the Pknight® WIFI-DMX EasyNode, you should be able to find the “PKNIGHT. WIFI+64123” network

using the Wi-Fi settings on your mobile network equipment. (*note*The red number 64123 is the unique identification of this controller) The default password to join is “PKNIGHT.WIFI”.After joining the network you can start the DMX app. The figure below is the interface of luminair.

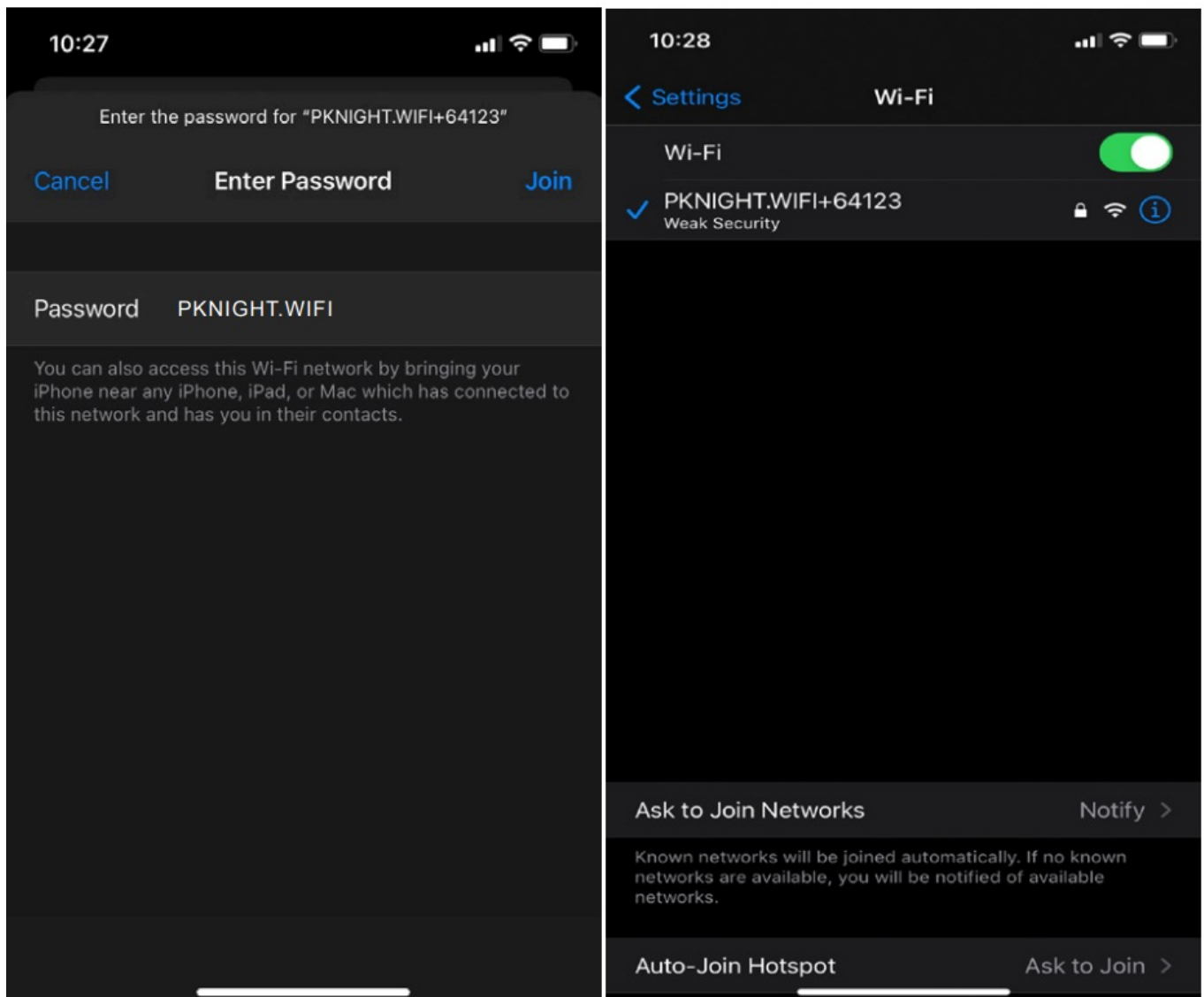

Setting

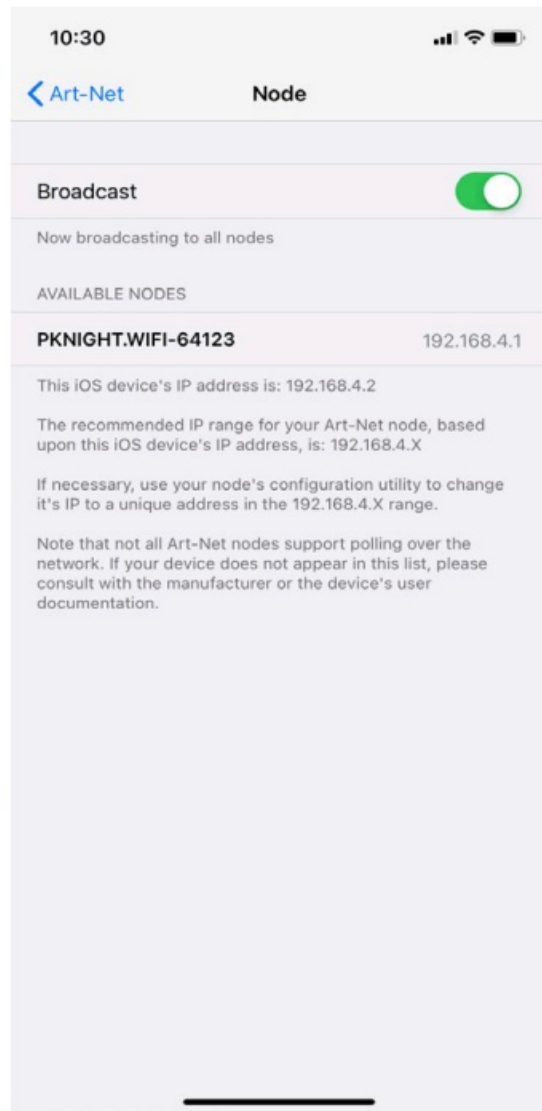

Here we have completed the work of signal connection, if you want to change this controller WiFi name and password, open the web browser of your device and enter 192.168.4.1, a view will appear similar to the following figure.

note

It is recommended that you change the name or password or both for the security of your lighting system.

WiFi SETTING

AA 192.168.4.1

WiFi-DMX ArtNet & sACNtoDMX & RDM

(DEVICE STATUS) (WIFI) (IP & NAME)

(PORT) A (SCENES) (FIRMWARE)

(REBOOT)

(WiFi Settings) **Save Changes**

(MAC Address):
94:B9:7E:87:F6:7C

(Wifi SSID): [Empty] 1

(Password): [Empty]

(Hotspot SSID): PKNIGHT.WIFI+64123 2

(Password): PKNIGHT.WIFI

(Start Delay):
25 (seconds) 3

(Stand Alone):
☒ 4

(In normal mode, the hotspot will start after delay seconds if the main WiFi won't connect. If no users connect, the device will reset and attempt the main WiFi again. This feature is purely for changing settings and ArtNet data is ignored.)

1. If you want to connect an external router, you need to enter the router's WiFi name and password, and not only that, you need to make sure the checkbox(4) is not checked if you want to make this connection take effect. (used only in router mode)
2. Here is the controller itself WiFi or hotspot information, it can be customized, The network name can be 1-32 characters in length and the password can be 8-16 characters in length. Only alphanumeric characters or space characters are allowed. If you forget the WiFi password, you can go back to page 4 and refer to the function button to restore factory settings.
3. If the wifi of the external router cannot be connected, the hotspot will start after a delay of 25 seconds. It can also be customized.
4. Check the independent mode to disable the router's WiFi connection and allow data to be received through its own hotspot. Usually, we use it as a switch to disconnect the router's WiFi and use its own hotspot to connect with other devices.

Turn off the power and then turn it back on for the changes to take effect.

Easylink mode

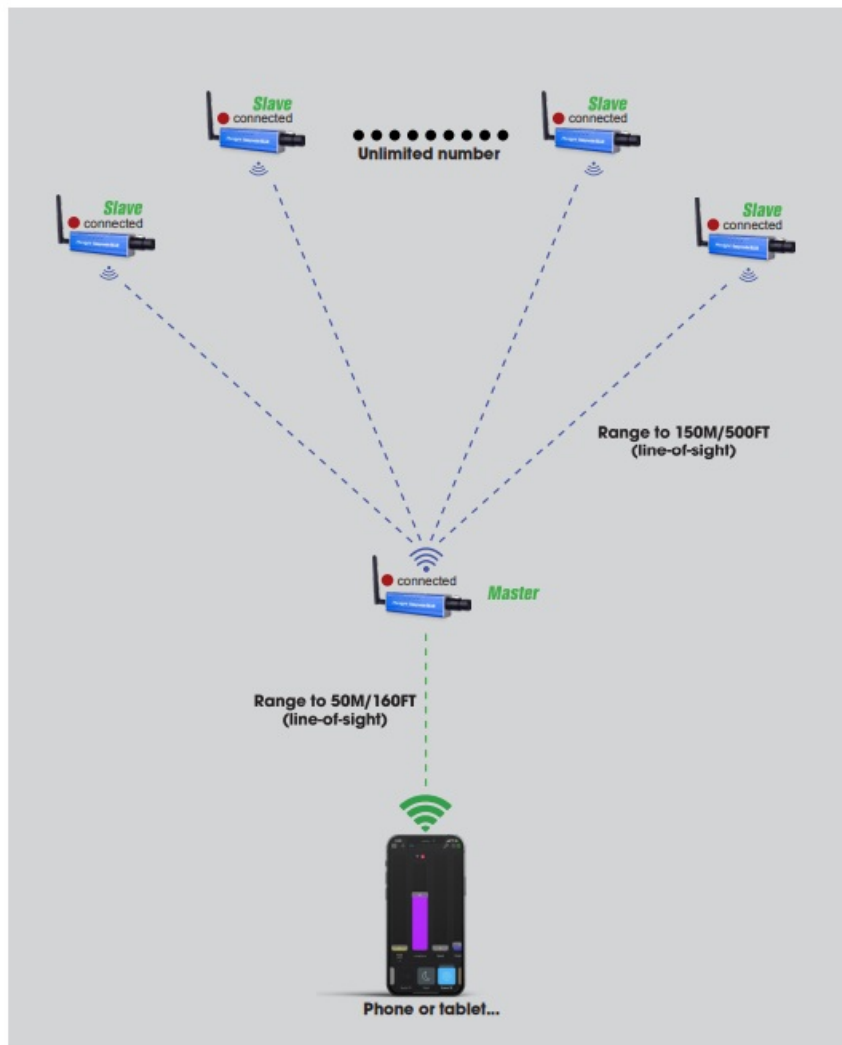

How to do?

In easylink mode, just make sure that the LED lights of each controller have the same color, and then connect the hotspot signal of any controller with a mobile phone. now it's good to go.

- The easylink mode is perfect for the system construction of film and television lights.
- The most cost-effective wireless dmx kit on the market
- It can only be used when connected to WiFi. NOT FOR BLUETOOTH

In Easylink mode, just adjust the indicator light of the controller to the same color and it is good to go

For a details, please scan the QR code below.



Tutorial - EasyLink

Router mode

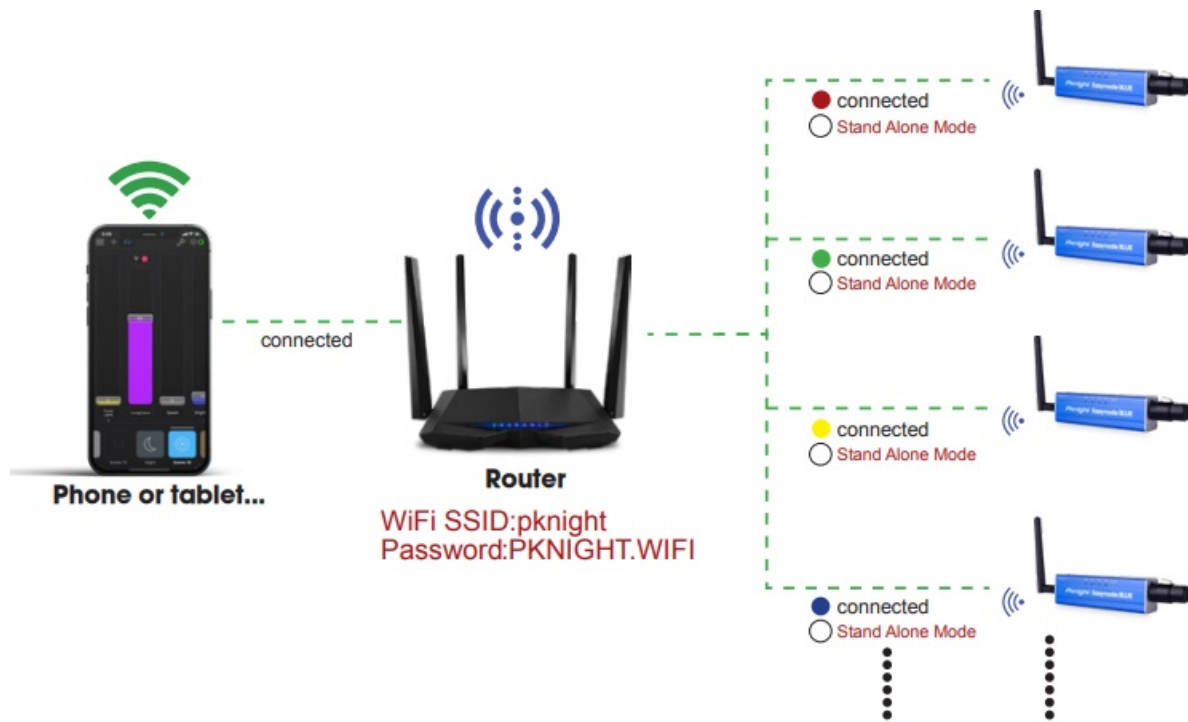

In router mode, we want to build such a local area network, our mobile phone or tablet computer and multiple controllers are connected to the 2.4G WiFi signal of the router. Buying a better router and assigning different wifi channel of controller will also optimize the stability and speed and range of the system's signal transmission.

different wifi channel of controller refer to different color of led indicator

How to do?

It's easy for our mobile phone or tablet PC. Let's follow the picture to set up the controller's network. First connect the mobile phone to the hotspot signal of the controller. Then open the mobile browser to do the operation as shown in the figure below

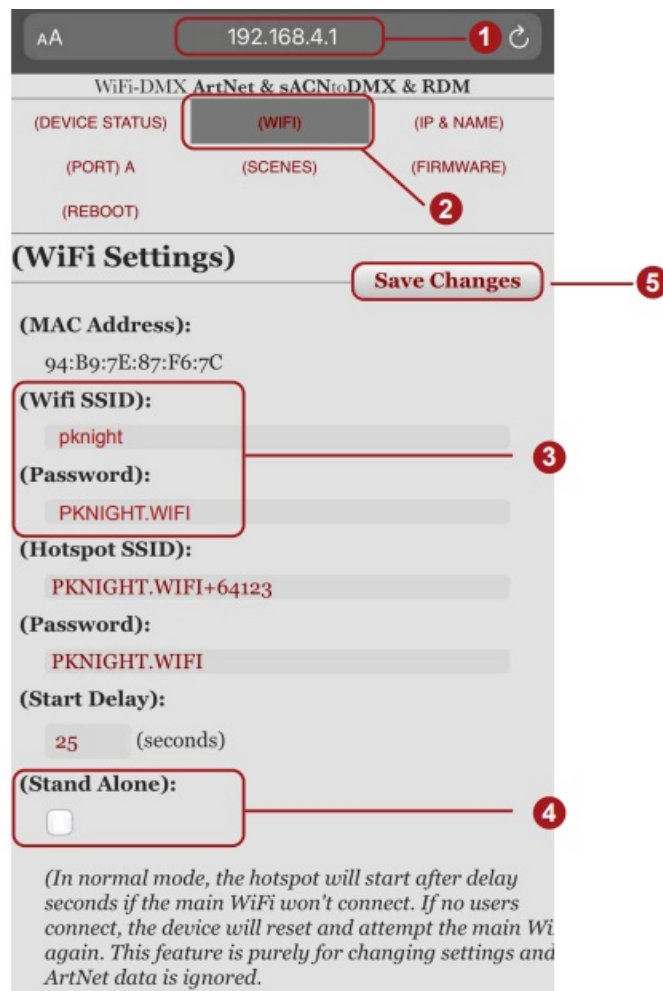

1. Enter 192.168.4.1 in the browser
2. Select the “WiFi” function bar
3. Enter the WiFi information of the router
4. Uncheck the Stand Alone checkbox
5. Save Change

Follow the steps in the figure above to connect all the controllers to the router one by one, the color indicator flashes on the controller should try different.

Disconnect the power to the controller for 3 seconds, then reconnect it. At this point, if your settings are correct, the controller will automatically connect to the router’s WiFi signal. If not, please check again.

Open the mobile WiFi interface, wait for the router WiFi signal to appear and connect to this signal.

Now it’s good to go!

Bluetooth Available

We support two apps for Bluetooth connection: Luminair (a third-party app) and WIFI DMX PRO (our proprietary app). Using Bluetooth connection will not prevent your phone or tablet from connecting to the internet.

1. App Selection: Choose which app to use, Luminair or WIFI DMX PRO
2. Network Configuration: Log in to the device’s network configuration page and select the corresponding Bluetooth name:
 - Luminair: BLUEDMX
 - WIFI DMX PRO: WIFI-DMX

3.

(Signal Loss Hold): ☒

(BLE Name):

✓ BLUEDMX (BLE for Luminair)
WIFI-DMX (BLE for WIFI-DMX PRO)

For detailed instructions, please scan the QR code below



Tutorial – Bluetooth

2024.5.25 revised edition

Documents / Resources

	<p>Pknight WiFi DMX Easy Node Blue [pdf] User Manual</p> <p>WiFi DMX Easy Node Blue, DMX Easy Node Blue, Easy Node Blue, Node Blue, Blue</p>
---	--

References

-  [Light Your Night – Pknight](#)
- [User Manual](#)

[Manuals+](#). [Privacy Policy](#)

This website is an independent publication and is neither affiliated with nor endorsed by any of the trademark owners. The "Bluetooth®" word mark and logos are registered trademarks owned by Bluetooth SIG, Inc. The "Wi-Fi®" word mark and logos are registered trademarks owned by the Wi-Fi Alliance. Any use of these marks on this website does not imply any affiliation with or endorsement.