

PIRNAR 2 Channel Smart LED Controller User Manual

[Home](#) » [PIRNAR](#) » PIRNAR 2 Channel Smart LED Controller User Manual 

PIRNAR 2 Channel Smart LED Controller

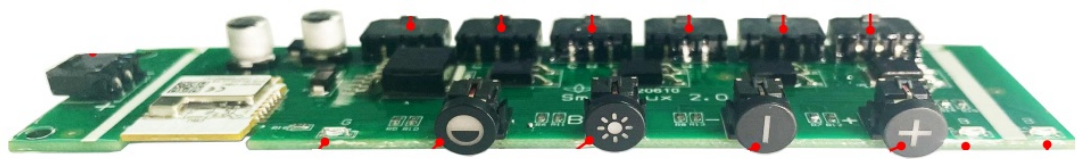

Contents

- [1 SPECIFICATIONS](#)
- [2 ADDING NEW DEVICES](#)
- [3 MANUAL DEVICE MANAGEMENT](#)
- [4 FCC Warning](#)
- [5 Documents / Resources](#)
- [6 Related Posts](#)

SPECIFICATIONS

Input Voltage	12Vdc / 24Vdc (Same as LED Working Voltage)
Max Output Current	5A /CH
Working Temperature	-25°C — 55°C
Storage Temperature	-40°C — 80°C

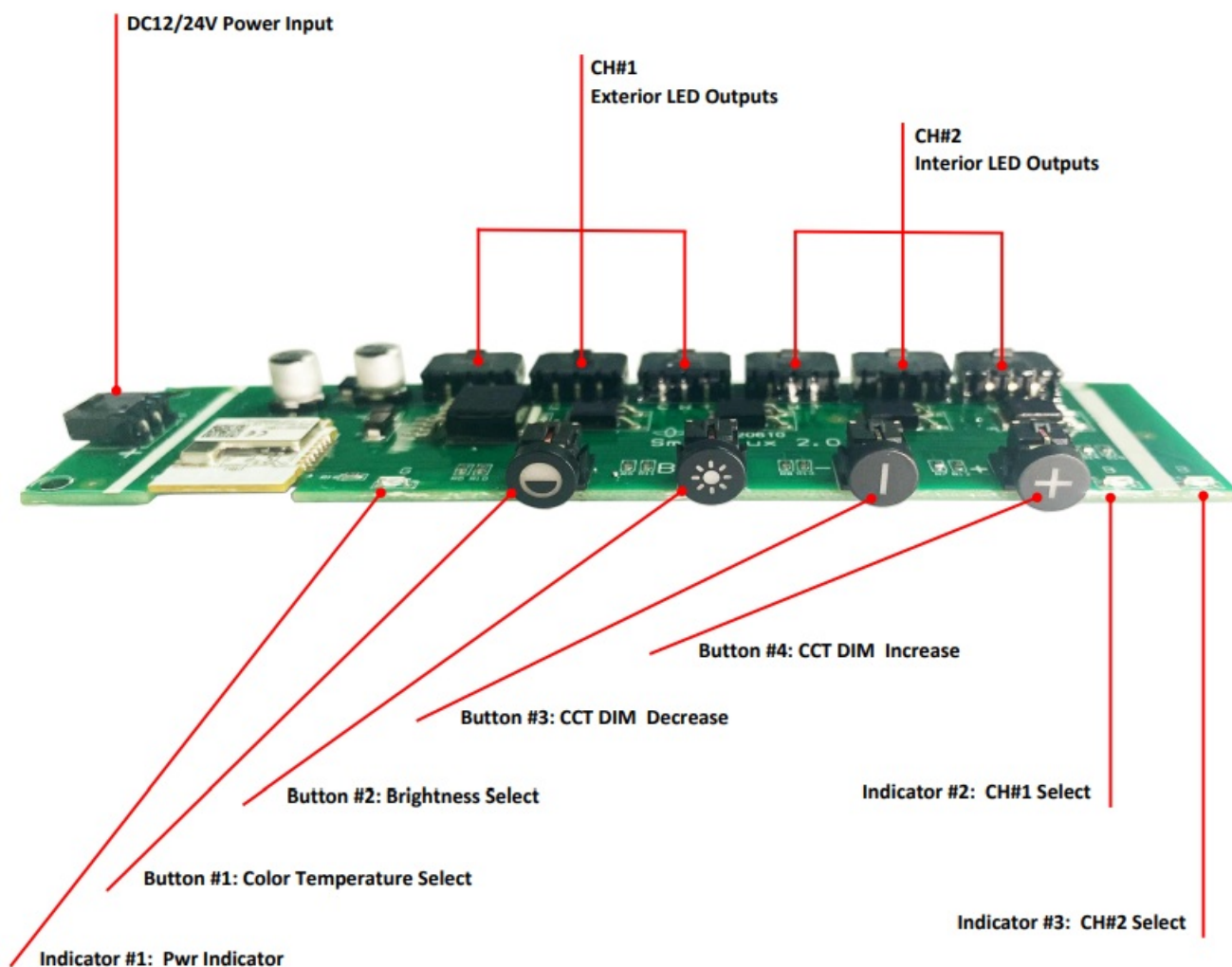

Press Button #1 + Button #2:

Keep 10S pressing

Resets the controller and goes into pairing mode

Press Button #3 + Button #4:

Keep 5S pressing

Switch and activate CH#1 or CH#2



ADDING NEW DEVICES

You must add a new device to manage your SmartLux lighting. Device must be within range of a 2.4 GHz Wi-Fi network.

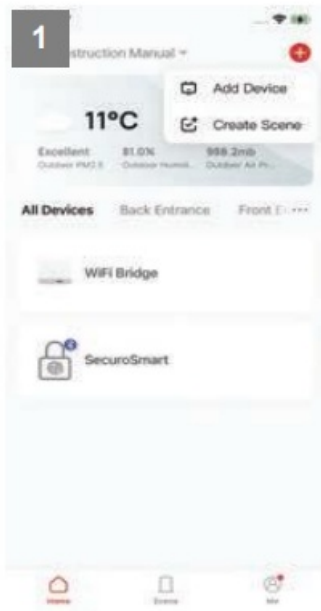
1. Click on "Add Device"  in the top right corner of the Pirnar app.



2. Wait for the app to automatically find a device. If the app does not find the device automatically, press down

Button#1  and Button#2  for 5-10 seconds until the LEDs start blinking.

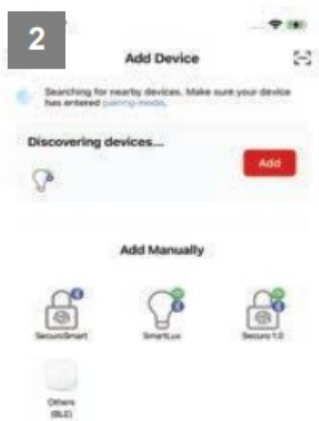

Wait for the device to be found automatically. Or choose the SmartLux device manually and follow the in-app instructions

3. Click on the symbol. Enter the  name and password for the 2.4 GHz Wi-Fi network.

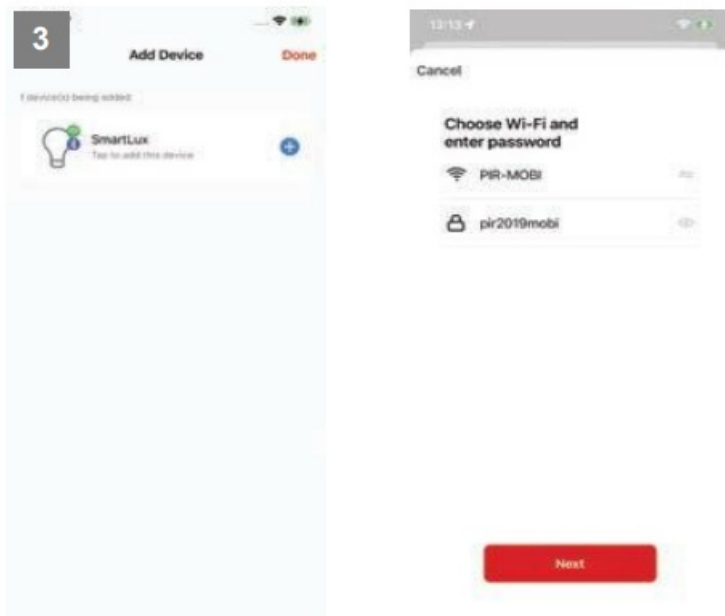

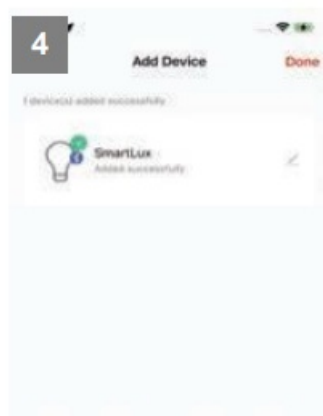

4. Finish adding devices





MANUAL DEVICE MANAGEMENT

Brightness: Press down Button#1  to change the brightness of LEDs

Then the Button#3  and Button#4  will be light up. allowing you to adjust the brightness.

Lighting Temperature: Press the Button#2  to change the lighting temperature.

Then the Button#3  and Button#4  will be light up. allowing you to adjust the lighting temperature.

Switching between CH#1 Exterior LED and CH#2 Interior LED

If you want to switch between CH#1 and CH#2

Press and hold both Button#3  and Button#4  5 seconds simultaneously.

This will make the Indicator#2 or Indicator#3 light up for the chosen channel (CH#1 or CH#2).

If the Indicator#2 was already lit, it will turn off and Indicator#3 will light up.

Shining LED indicator#2

Managing CH#1 Exterior LED

Shining LED indicator#3

Managing CH#2 Interior LED

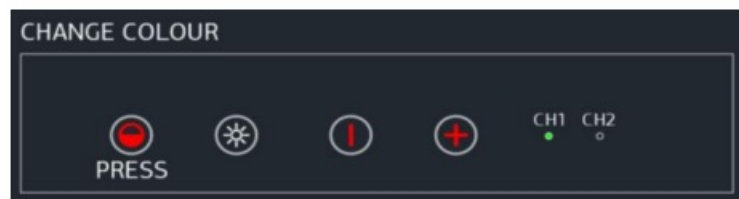
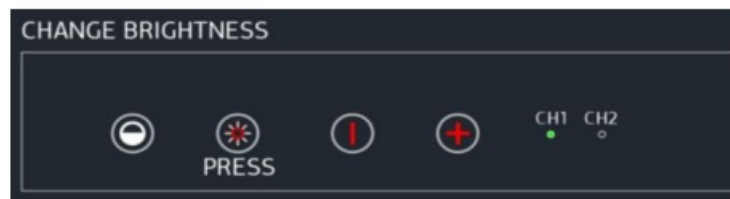
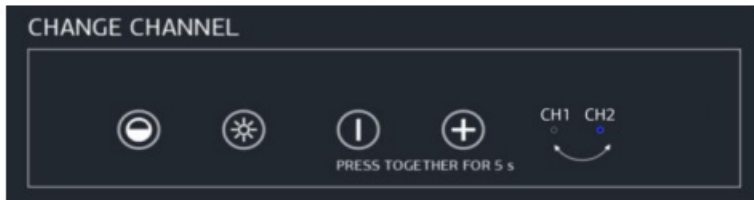

FCC Warning

This device complies with part 15 of the FCC rules. Operation is subject to the following two conditions: (1) this device may not cause harmful interference, and (2) this device must accept any interference received, including interference that may cause undesired operation.

Changes or modifications not expressly approved by the party responsible for compliance could void the user's authority to operate the equipment.

NOTE: This equipment has been tested and found to comply with the limits for a Class B digital device, pursuant to part 15 of the FCC Rules. These limits are designed to provide reasonable protection against harmful interference in a residential installation. This equipment generates uses and can radiate radio frequency energy and, if not installed and used in accordance with the instructions, may cause harmful interference to radio communications. However, there is no guarantee that interference will not occur in a particular installation. If this equipment does cause harmful interference to radio or television reception, which can be determined by turning the equipment off and on, the user is encouraged to try to correct the interference by one or more of the following measures:

- Reorient or relocate the receiving antenna.
- Increase the separation between the equipment and receiver.
- Connect the equipment into an outlet on a circuit different from that to which the receiver is connected.
- Consult the dealer or an experienced radio/TV technician for help.

Radiation Exposure Statement

This equipment complies with FCC radiation exposure limits set forth for an uncontrolled environment. This equipment should be installed and operated with minimum distance 20cm between the radiator and your body.

ISED Statement

This device complies with Industry Canada's license-exempt RSSs. Operation is subject to the following two conditions:

- This device may not cause interference; and
- This device must accept any interference, including interference that may cause undesired operation of the device.

Radiation Exposure Statement

This equipment complies with ISED radiation exposure limits set forth for an uncontrolled environment. This equipment should be installed and operated with minimum distance 20cm between the radiator and your body.



Documents / Resources

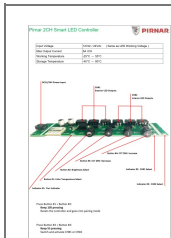

[PIRNAR 2 Channel Smart LED Controller](#) [pdf] User Manual
2BBOL-SMARTLUX, 2BBOLSMARTLUX, 2 Channel Smart LED Controller, Smart LED Controller, LED Controller, Controller