

Pipishell PIRTS06WN TV Console Table



Pipishell PIRTS06WN TV Console Table Instruction Manual

[Home](#) » [Pipishell](#) » Pipishell PIRTS06WN TV Console Table Instruction Manual 

Contents

- [1 Pipishell PIRTS06WN TV Console Table](#)
- [2 Product Information](#)
- [3 Important Safety Information](#)
- [4 Weight Restrictions](#)
- [5 Tools Needed](#)
- [6 Package Contents](#)
- [7 Contact information](#)
- [8 Documents / Resources](#)
 - [8.1 References](#)



Pipishell PIRTS06WN TV Console Table



Product Information

Specifications:

- **TV Console Model:** PIRTS06WN
- **Top Shelf Weight Capacity:** 150 lbs (68kg)
- **Middle Shelf Weight Capacity:** 30 lbs (13.6kg)
- **Drawer Weight Capacity:** 11 lbs (5kg)
- **Bottom Shelf Weight Capacity:** 60 lbs (27.2kg)

Tools Needed (Not Included):

- Phillips Screwdriver
- 5/32" (4mm) Allen Key

Installation Tips:

Align and loosely thread all bolts into the corresponding holes before fully tightening each bolt one by one.

• Step 1:

Place the recessed side of the mesh panel on a flat surface with the back facing up. Align and attach frames [1], [2], and [3] to the mesh panel using bolts [A] and Allen key [H].

• Step 2:

Attach adjustable feet [5] to the bottom panel [4] using screws [B]. Use a Phillips screwdriver to tighten them. Make sure the feet face out.

• Step 3:

Attach the bottom frame [6] to the bottom panel using bolts [C] and Allen key [H].

• Step 4:

Attach the top support bars [7] to frames [1] and [2] using bolts [E] and Allen key [H]. The large holes on the support bars should face out.

• Step 5:

Attach frames [8] and [9] to the back of the assembly. The support bars on these frames should face in with the

lip toward the back.

- **Step 6:**

Attach the top panel [10] to frames [1] and [2] using screws [E] and Allen key [H].

- **Step 7:**

Tighten all bolts and screws using a Phillips screwdriver. If the unit is not level, adjust the feet by turning them to raise or lower each corner.

FAQ

- **Q: What is the weight capacity of each shelf?**

A: The top shelf can hold up to 150 lbs (68kg), the middle shelf can hold up to 30 lbs (13.6kg), the drawer has a weight capacity of 11 lbs (5kg), and the bottom shelf can hold up to 60 lbs (27.2kg).

- **Q: What tools are needed for installation?**

A: You will need a Phillips screwdriver and a 5/32" (4mm) Allen Key. Please note that these tools are not included in the product.

- **Q: How do I adjust the unit if it is not level?**

A: If the unit is not level, you can adjust the feet by turning them to raise or lower each corner.

Important Safety Information

Please carefully read all instructions before attempting installation. If you DO NOT understand the instructions or have any questions or concerns, please contact our technical support line at 1-800-556-9829 (US/CA) / 44-808-196-3885 (UK) or customer service at support@pipishell.net.

CAUTION:

Avoid potential injuries and property damage!

DO NOT use this product for any purpose that is NOT explicitly specified in this manual. We are not liable for damage or injury caused by improper mounting, incorrect assembly or inappropriate use.

WARNING:

This product contains small items that may pose a choking hazard. Before starting assembly, verify all parts are included and undamaged. DO NOT use damaged or defective parts. If you require replacement parts, please contact our technical support line at 1-800-556-9829 (US/CA)/44-808-196-3885 (UK) or customer service at support@pipishell.net.

Weight Restrictions

Verify that the items you intend to store do not exceed the listed weight capacity.



Top Shelf Weight Capacity:
150 lbs (68kg)



Middle Shelf Weight Capacity:
30 lbs (13.6kg)



Drawer Weight Capacity:
11 lbs (5kg)

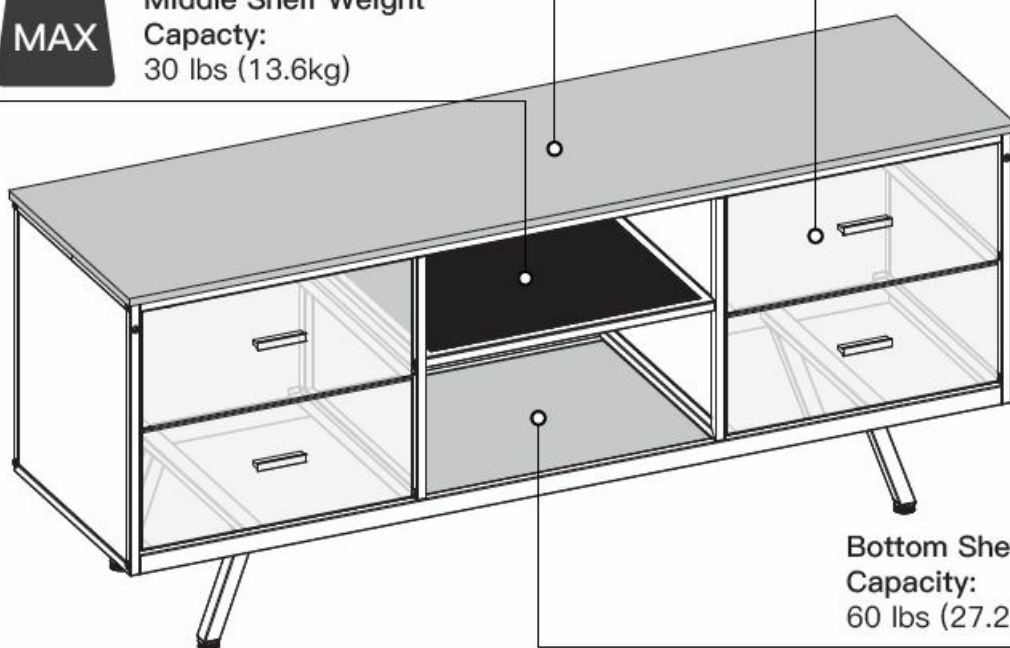

Bottom Shelf Weight Capacity:
60 lbs (27.2kg)

Tools Needed

Tools Needed (Not included)

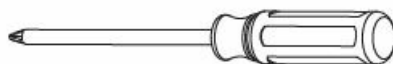

Phillips Screwdriver

Package Contents

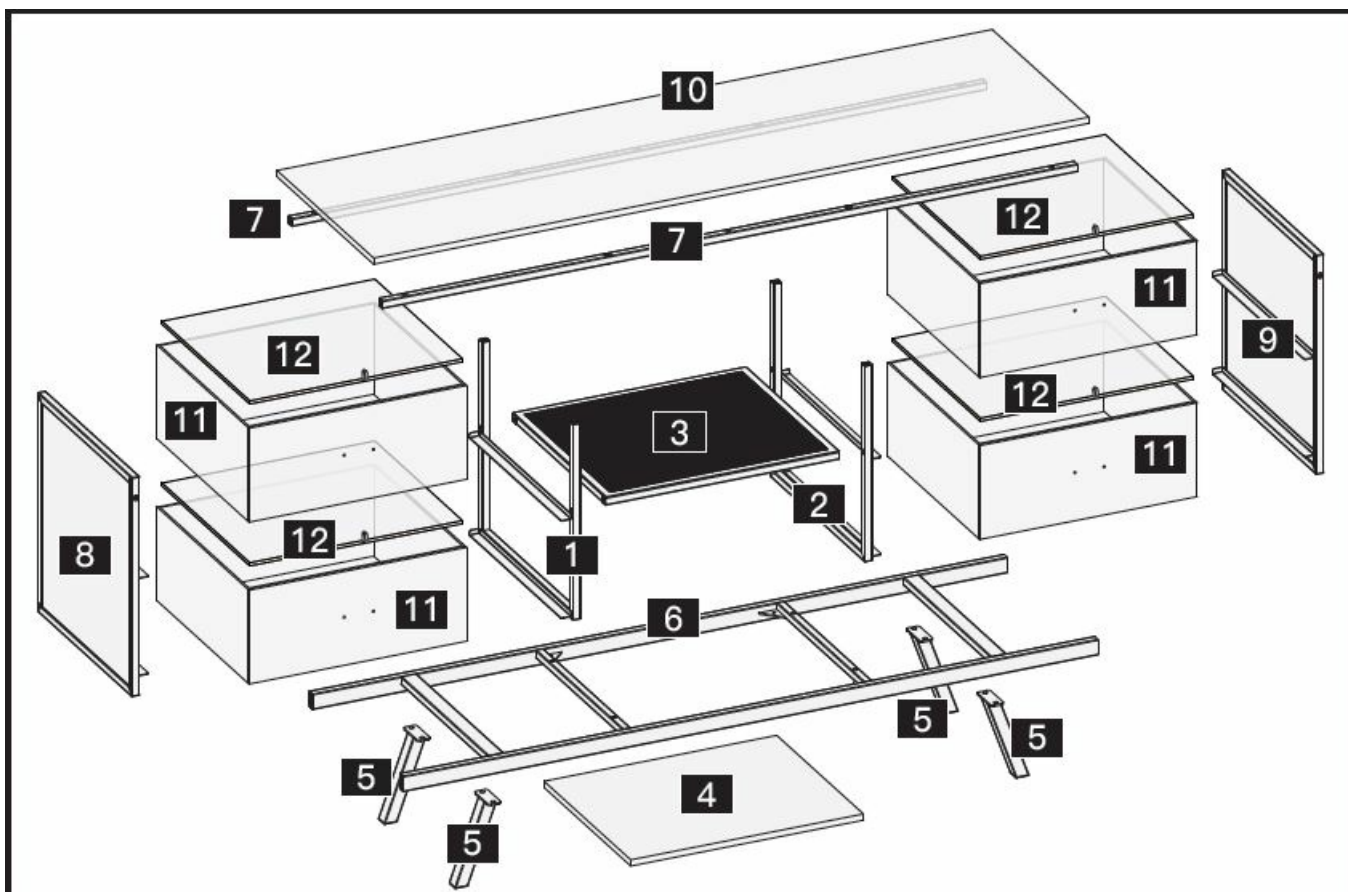

Left Middle Frame
[1] x 1



Right Middle Frame
[2] x 1



Mesh Panel
[3] x 1

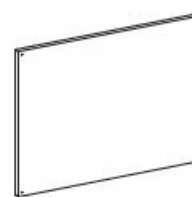

Bottom Panel
[4] x 1



Leg
[5] x 4

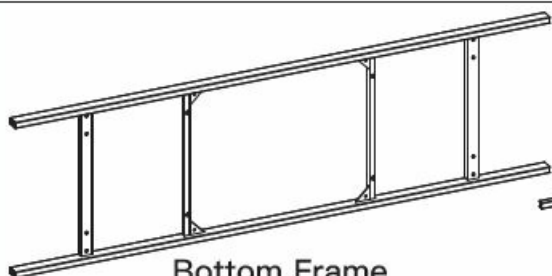

Bottom Frame
[6] x 1



Top Support Bar
[7] x 2

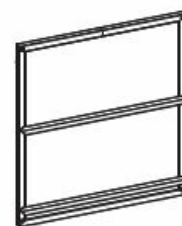

Left End Frame
[8] x 1

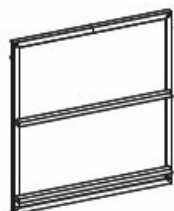

Right End Frame
[9] x 4

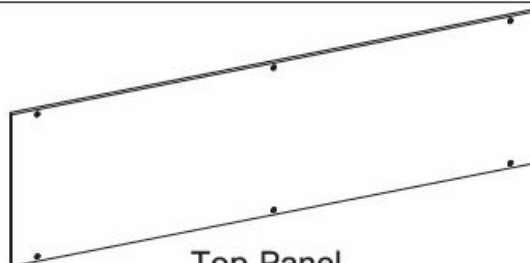

Top Panel
[10] x 1

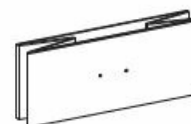

Fabric Drawer
[11] x 4

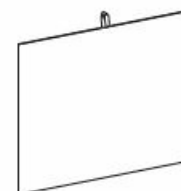

Drawer Bottom
[12] x 4

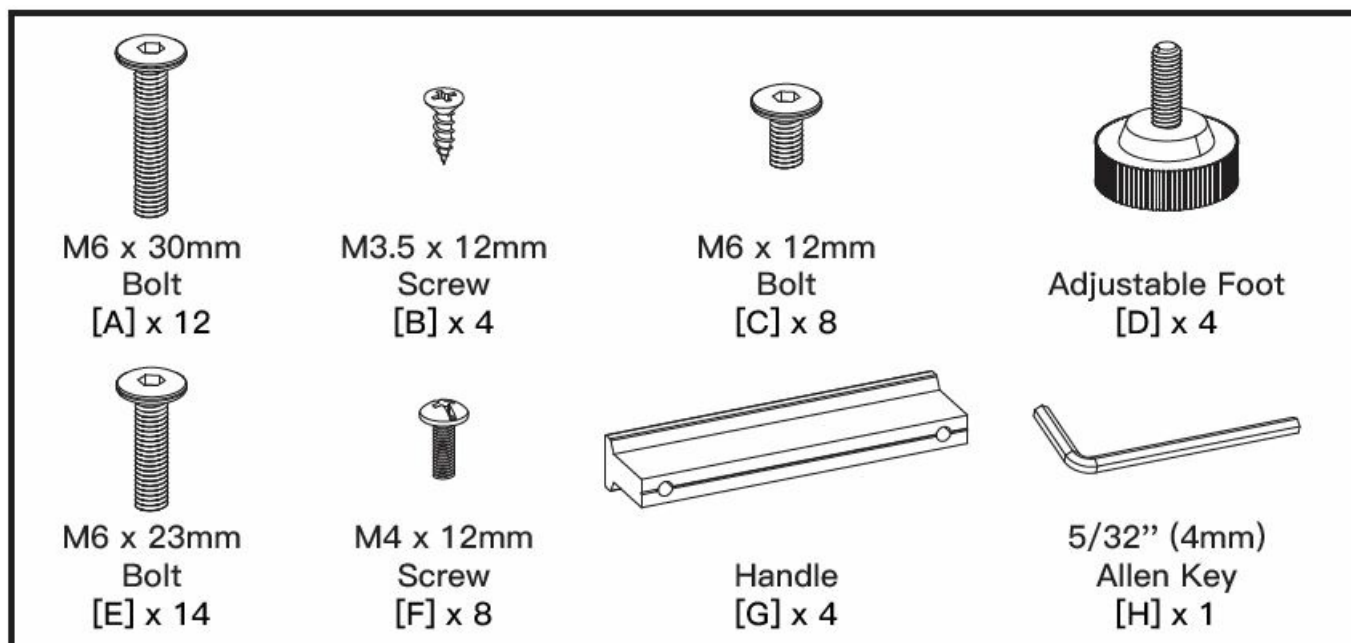

IMPORTANT INSTALLATION TIP: Align and loosely thread all bolts into the corresponding holes before fully tightening each bolt one by one.

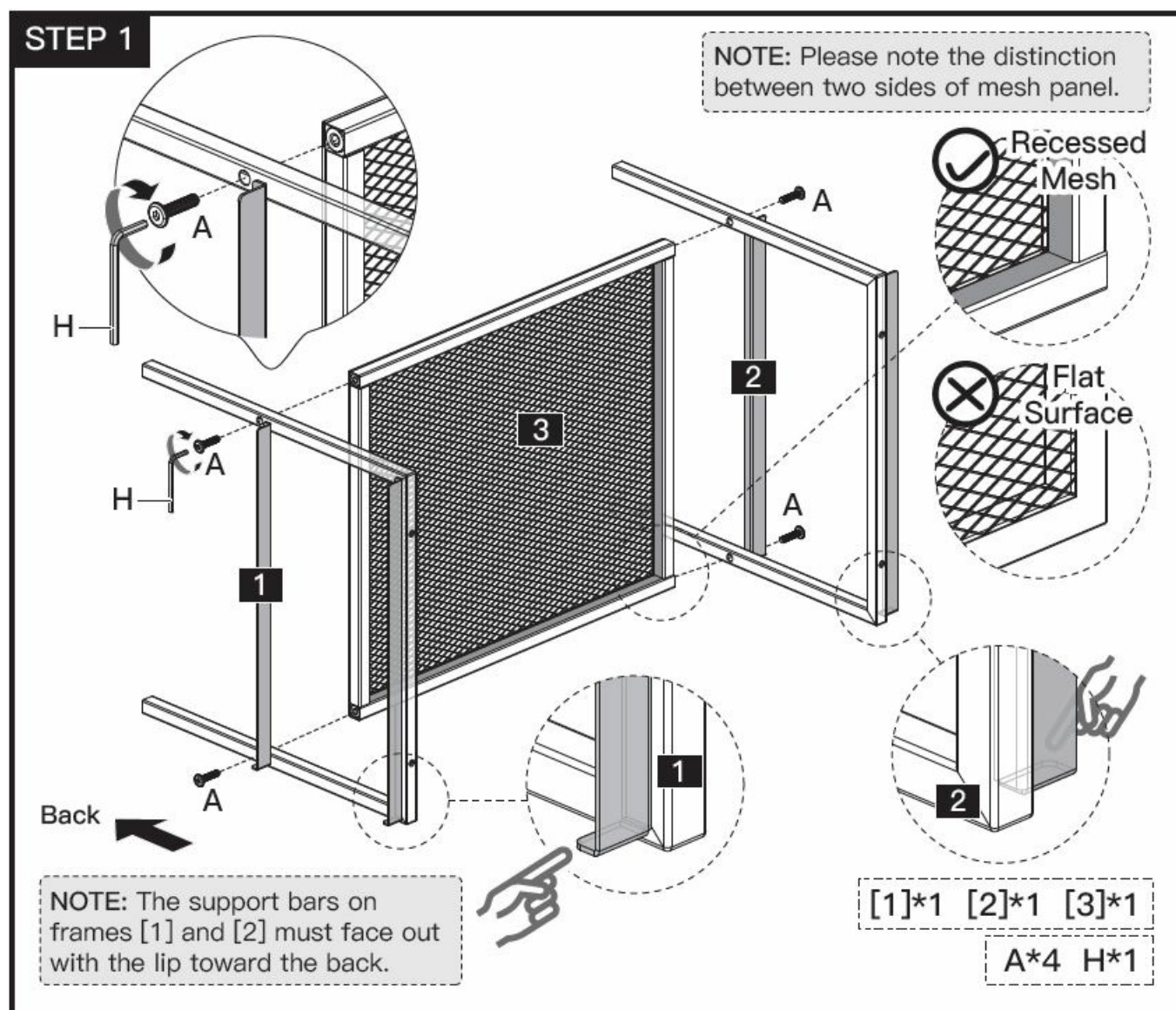

NOTE:

The support bars on frames [1] and [2] must face out with the lip toward the back.

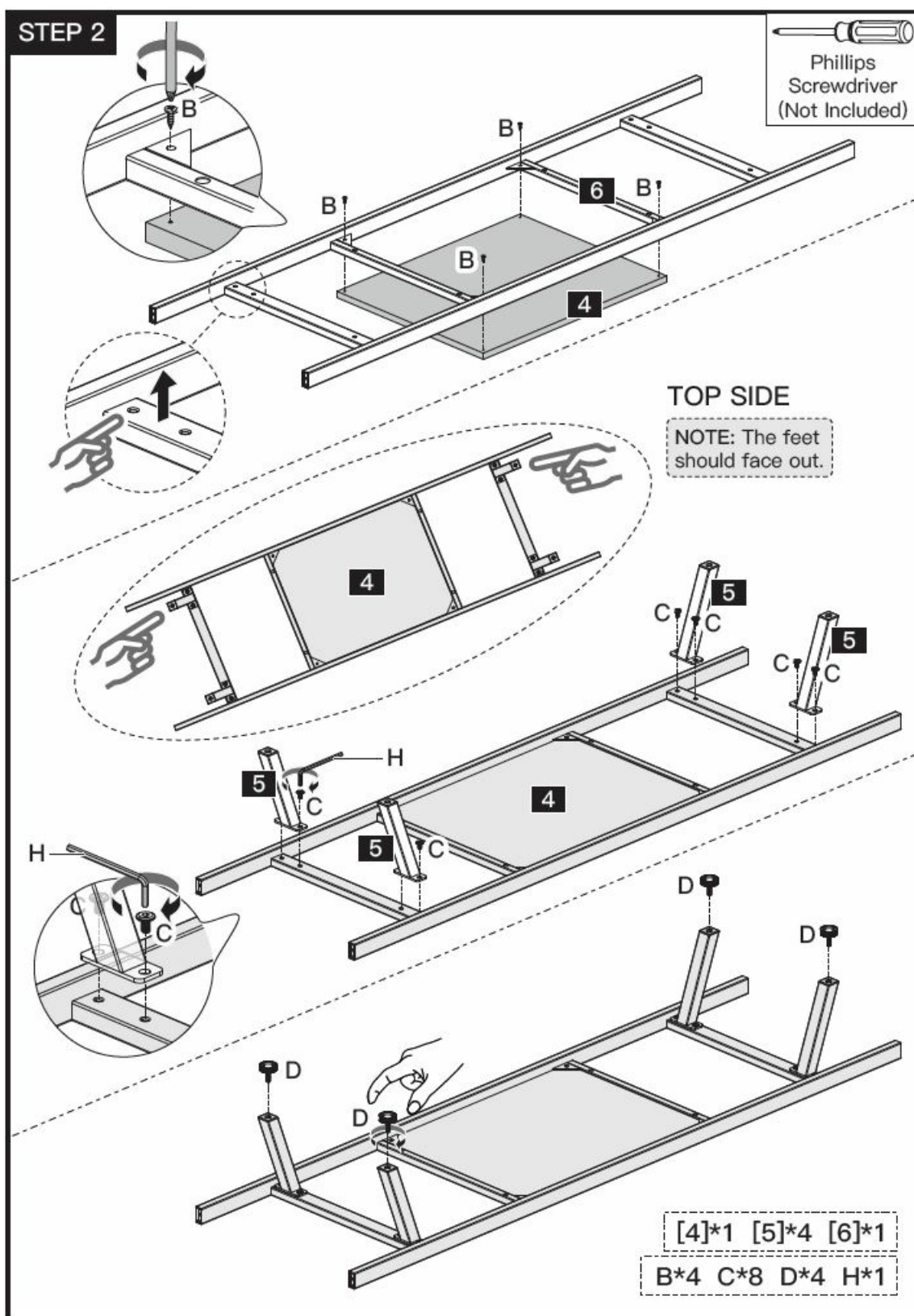

STEP 3

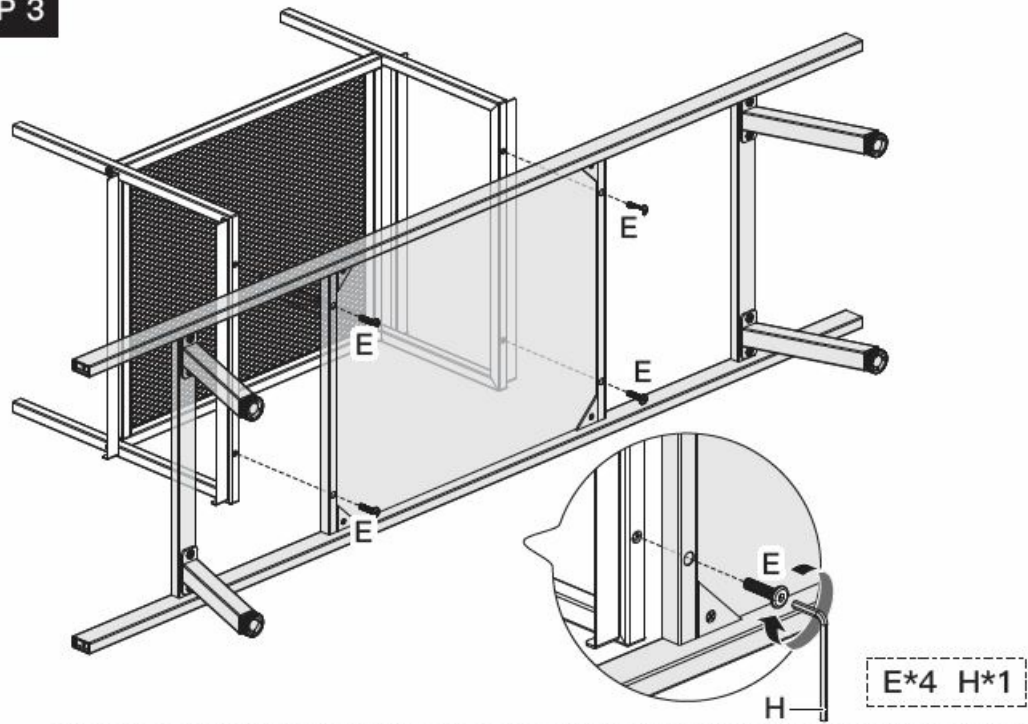

STEP 4

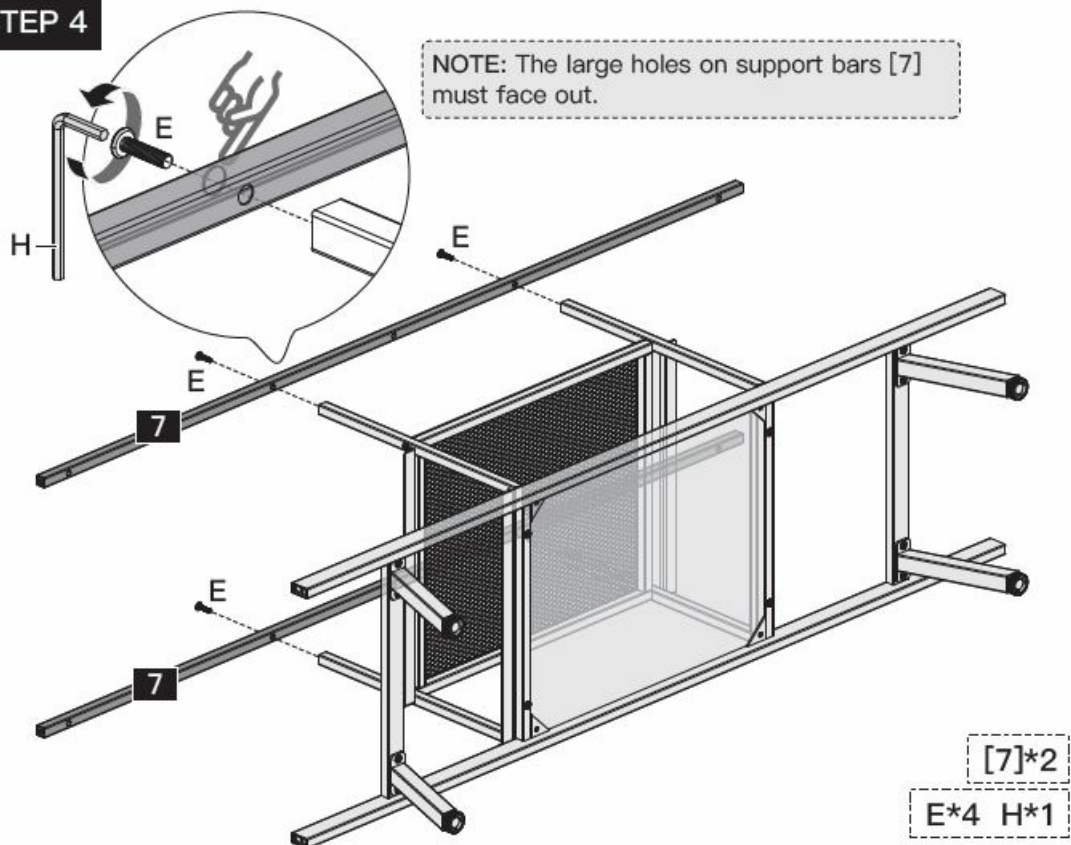

STEP 5

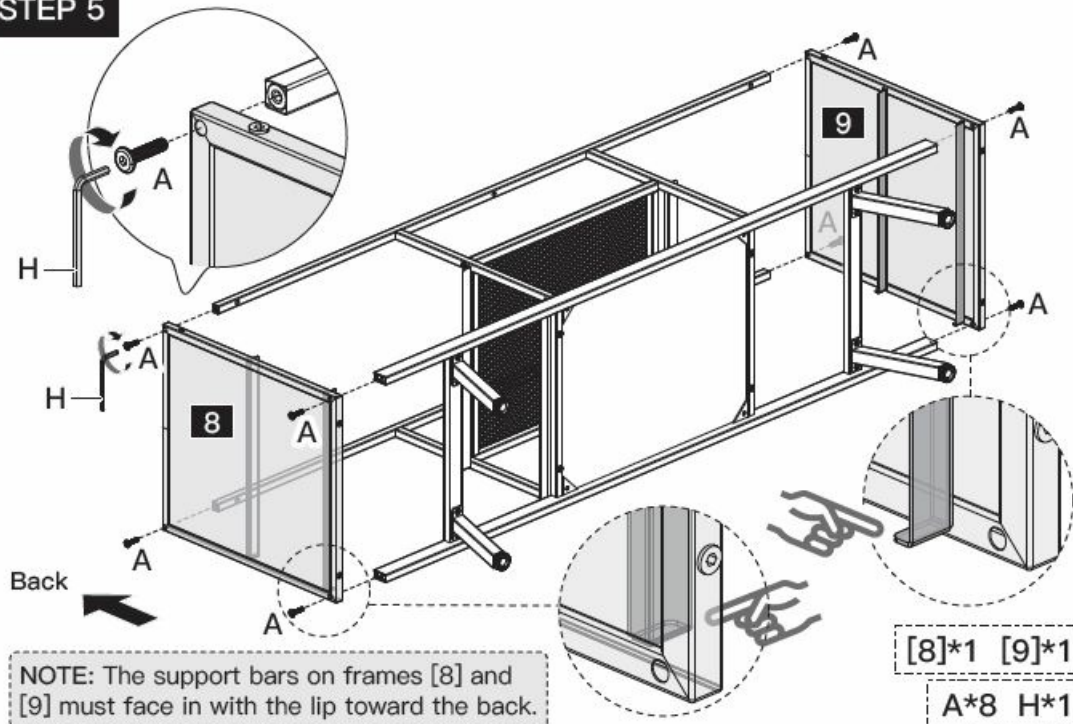

STEP 6

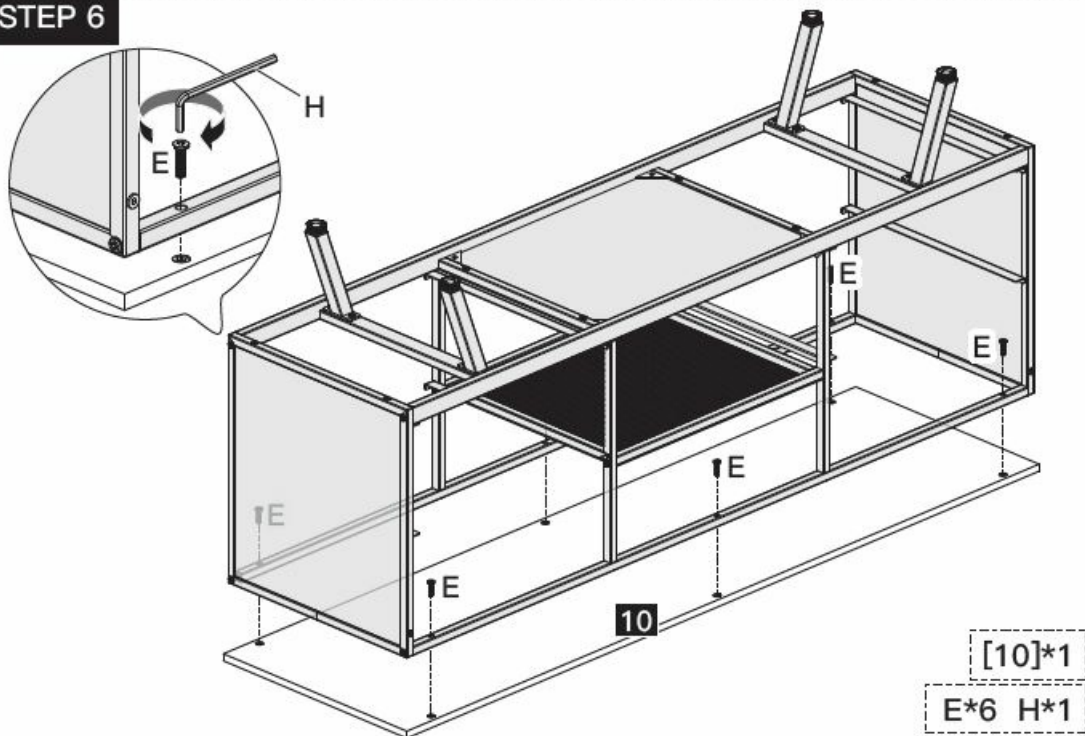

Remember to fully tighten all bolts or screws after Step 6 is finished.

STEP 7

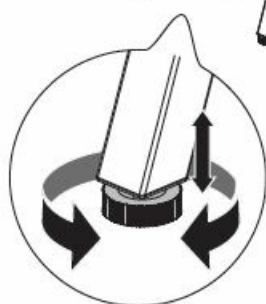
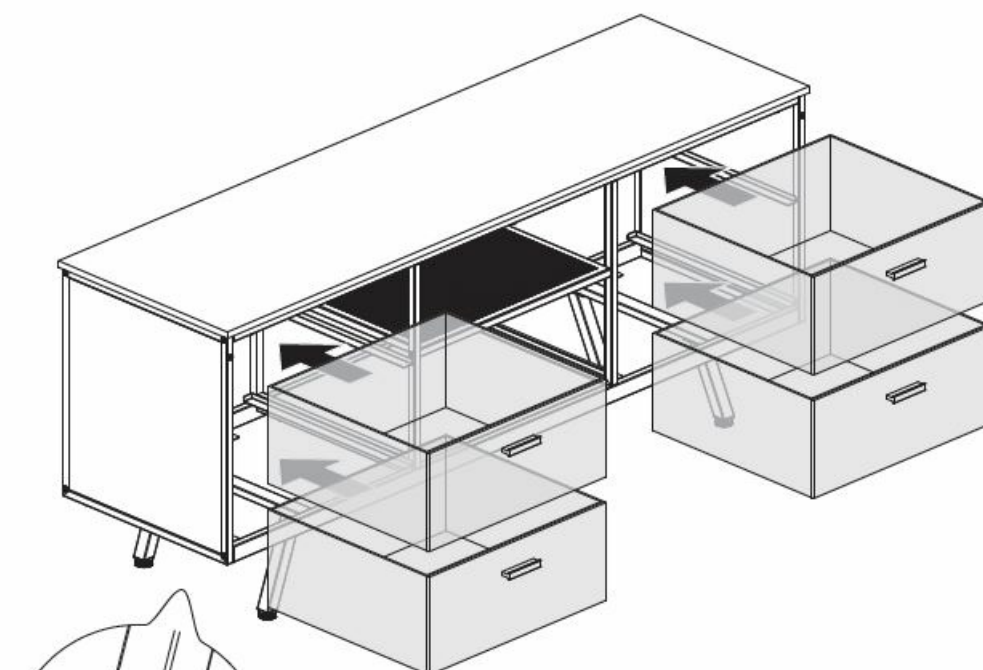
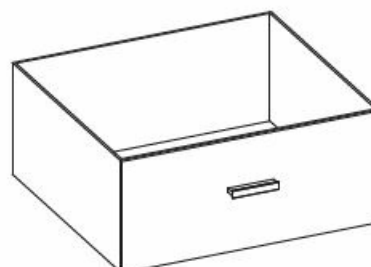
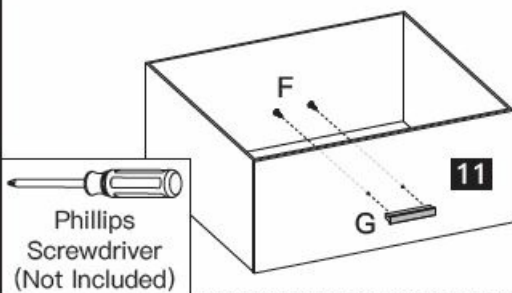
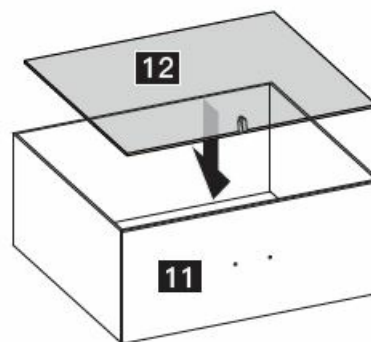
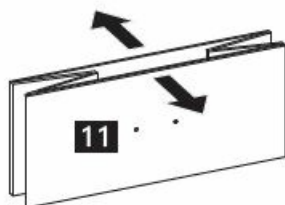

NOTE: If the unit is not level, adjust the feet by turning to raise or lower each corner.

[11]*4 [12]*4
F*8 G*4

Contact information

- (US/CA) 1-800-556-9829
- (UK) 44-808-196-3885
- support@pipishell.net
- www.pipishellav.com

Documents / Resources

	<p>Pipishell PIRTS06WN TV Console Table [pdf] Instruction Manual PIRTS06WN, PIRTS06WN TV Console Table, TV Console Table, Console Table, Table</p>
---	--

References

- [🌐 Pipishell Heavy Duty Full Motion TV Wall Mounts Make Your Life Better](#)
- [User Manual](#)