



# PIONEER TS-A693CH 2-Way Component Speaker System Instruction Manual

[Home](#) » [Pioneer](#) » PIONEER TS-A693CH 2-Way Component Speaker System Instruction Manual 

PIONEER TS-A693CH 2-Way Component Speaker  
System Instruction Manual

Instruction Manual

**Pioneer**

**TS-A693CH**  
SEPARATE 2-WAY / HP 2 VOIES SÉPARÉES  
2 VÍAS SEPARADAS

---



## Instruction Manual

Be sure to read this instruction manual before installing this speaker.

### **WARNING**

Over time, your hearing “comfort level” adapts to higher volumes of sound, so that what sounds “normal” can actually be doing harm. To protect against hearing loss, set your equipment’s volume at a low setting, slowly increase it until you can hear it comfortably and clearly, and leave it there. Do not turn up the volume so high that you can’t hear what’s around you.

### **CAUTION**

1. Do not touch the speaker flexible wire .
2. Do not use the speaker independently. To avoid breakage, be sure to use the specified network.
3. Do not change the direction of the speaker terminal assembly .
4. Make sure lead and speaker terminals do not contact metal.
5. When making connections, refer also to the instruction manual of the car stereo used.

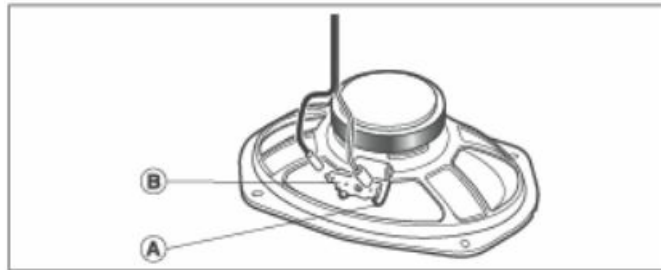

## Contents

- [1 PARTS INCLUDED](#)
- [2 FEATURES](#)
- [3 EXAMPLE OF COVERAGE](#)
- [4 HOW TO INSTALL](#)
- [5 DIMENSIONS](#)
- [6 SPECIFICATIONS](#)
- [7 Documents / Resources](#)

## PARTS INCLUDED

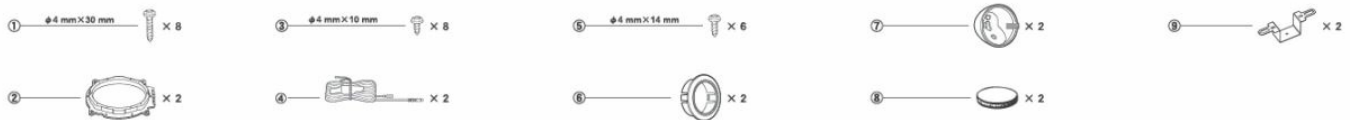

## A-series speakers engineered to get loud, while maintaining smooth, low distortion sound

- Powerful and Loud sound
- Smooth frequency response and sound dispersion for superior off-axis listening
- Clear mids and highs with low distortions

## FEATURES

1. OPEN & SMOOTH sound concept delivers smooth frequency response and wide dispersion for superior off-axis listening
2. Aramid fiber and Mica reinforced IMPP cone provides fast response and precise bass
3. PFSS (Progressive Flex Suspension System) balances between deep bass and high power handling \*Patent technology
4. Polyetherimide (PEI) dome diaphragm provides clear mids and highs with low distortions
5. Multi-Fit adapters expand installation flexibility and improve acoustic performances

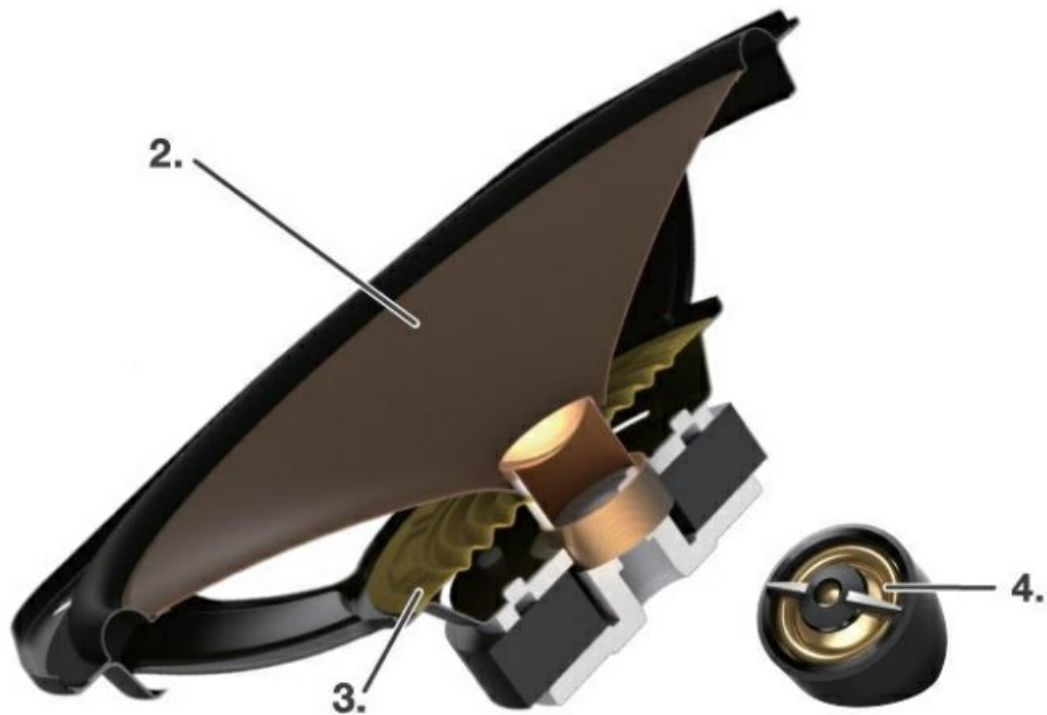

#### Multi-Fit Adapters Included Adaptateurs Multi-Fit Inclus

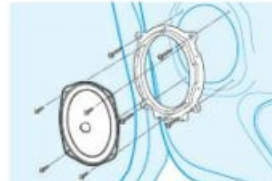

#### EXAMPLE OF COVERAGE

MAKE	MODEL
CHEVROLET	SILVERADO / TAHOE
DODGE	RAM1500
FORD	F-150
JEEP	CHEROKEE
TOYOTA	CAMRY / TACOMA

#### INSTALLATION FIT GUIDE

(For information about specific vehicles applications)



[http://www.pioneer-carglobal.com/speakerfitting-Aseries1\\_dr1](http://www.pioneer-carglobal.com/speakerfitting-Aseries1_dr1)

#### HOW TO INSTALL

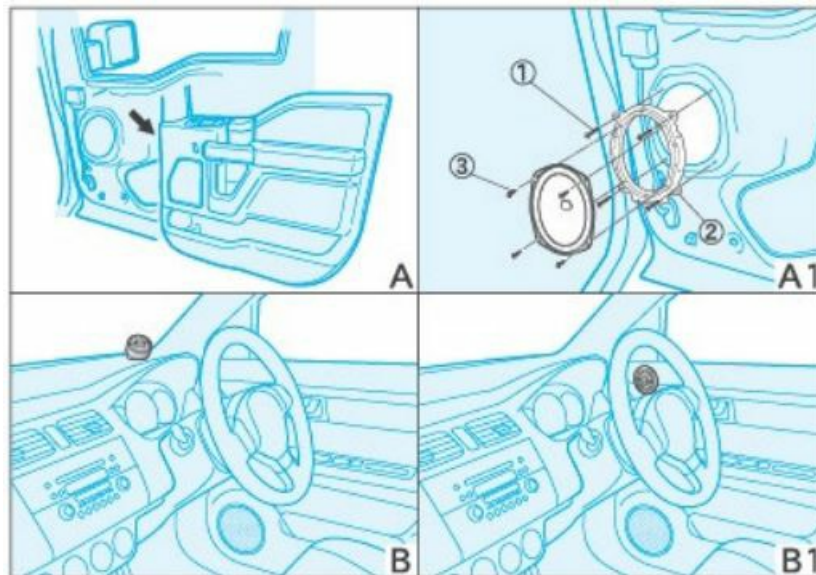

## DIMENSIONS

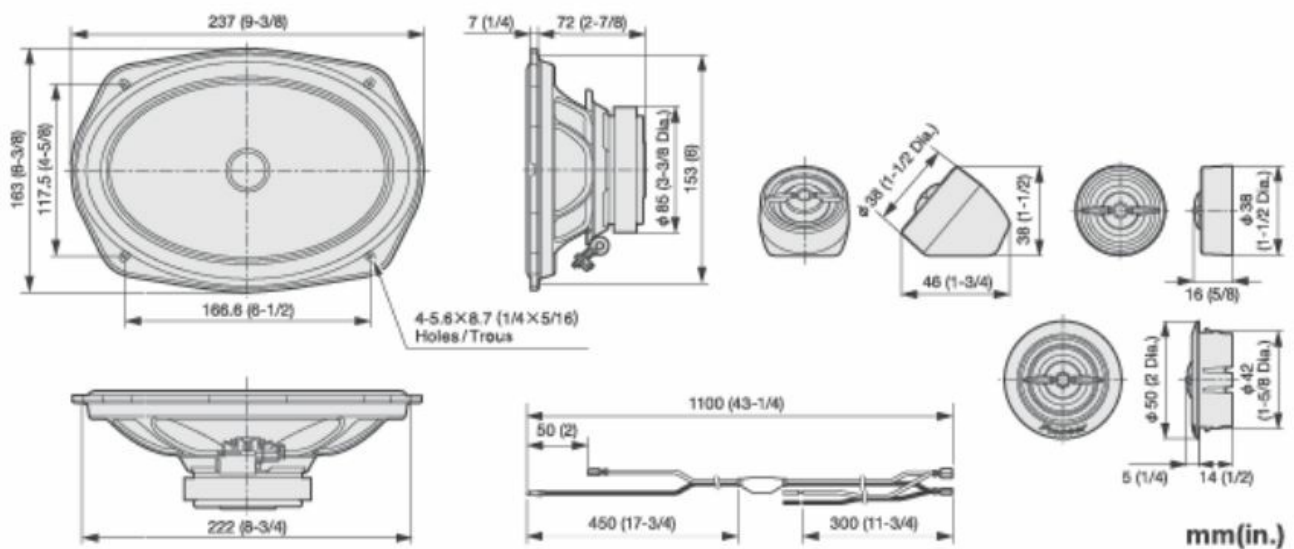



# CarSoundFit

Car Sound Simulator Application for more in-car sound experience.



## SPECIFICATIONS

- Reproduction system ..... Separate two way
- Speaker specifications
  - Woofer ..... 163 mm×237 mm (6"×9")
  - Tweeter .....  $\phi$ 20 mm (13/16"dia.)
- Continuous power handling (RMS) ..... 105 W
- Maximum music power ..... 460 W
- Sensitivity ..... 92 dB (1 W/1 m)  
98 dB (1 W/0.5 m)
- Frequency response ..... 30 Hz to 58 kHz (–20 dB)
- Nominal impedance ..... 4  $\Omega$
- Cutout diameter ..... 153 mm×222 mm (6"×8-3/4")

Do not ship your unit in for repair without contacting Pioneer first. Units sent without a return authorization number will be refused.

Pioneer Electronics (USA) Inc. CUSTOMER SUPPORT DIVISION  
P.O. Box 1760, Long Beach, Ca 90801-1760 U.S.A. 800-421-1404

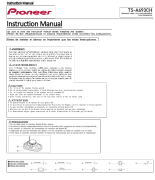

## Documents / Resources

	<p><b><a href="#">PIONEER TS-A693CH 2-Way Component Speaker System</a></b> [pdf] Instruction Manual TS-A693CH 2-Way Component Speaker System, TS-A693CH, 2-Way Component Speaker System, Component Speaker System, Speaker System</p>
---	---