



Pioneer Air Conditioner Remote Buttons and Functions Guide

[Home](#) » [Pioneer](#) » Pioneer Air Conditioner Remote Buttons and Functions Guide 

Contents

- [1 Pioneer Air Conditioner Remote Buttons and Functions Guide](#)
- [2 INTRODUCTION](#)
- [3 Button Layout and Functions](#)
- [4 Handling the Remote Controller](#)
- [5 Installing the Remote Holder](#)
- [6 Basic Functions](#)
- [7 Setting Temperatures](#)
- [8 FAN Mode Operation](#)
- [9 Advanced Functions](#)
- [10 FAQs](#)
- [11 Related Posts](#)



Pioneer Air Conditioner Remote Buttons and Functions Guide



INTRODUCTION

The Pioneer air conditioner remote is an essential accessory that allows users to control and adjust the settings of their Pioneer air conditioning unit conveniently. This compact device features various buttons and functions designed to enhance user experience and provide efficient control over the cooling or heating system. With the Pioneer air conditioner remote, users can easily regulate temperature, fan speed, mode selection, and more.

The design and specifications of this product are subject to change without prior notice as development continues. Consult with the sales agency or manufacturer for details. is a registered trademark of Parker Davis HVAC International, Inc.

- Parker Davis HVAC International, Inc.
- 3250 NW 107th Ave, Doral, FL 33172
- USA Tel.: (305) 513-4488
- Fax: (305) 513-4499
- e-mail: info@pd-hvac.com
- Website: www.pd-hvac.com

Read through and understand these instructions thoroughly before attempting to operate your new air conditioning unit using this remote. Be sure to store this manual for future reference.

Note:

- The layout of the buttons on this remote as depicted here is for the standard model. The actual model purchased may vary slightly from these illustrations.
- The signal output sent by this remote controller is processed entirely by the receiving air conditioning system.

In the case that any of the functions of the remote are not available for the specific model of the air conditioning unit, those functions will not work.

- Your air conditioning unit's user manual may have additional information regarding the usage of this remote controller.

Remote Controller Specifications

Model Number	RG66B6(B)/BGEFU1
Rated Voltage	3.0V dry batteries (R03/LR03x2)(2xAAA)
Signal Range	8m (25 feet)
Operational Temperature Range	23°F – 140°F

Notice:

This device complies with all relevant national regulations.

- For Canada, this device is compliant with CAN ICES-3(B)/NMB-3(B)
- For the USA, this device is compliant with section 15 of FCC law. Operation is subject to two conditions:
 1. This device may not cause harmful interference, and
 2. This device must accept any interference received, including interference that may cause undesired operation.

This equipment has been tested and found to comply with the limits for a Class B digital device, pursuant to section 15 of FCC law. These limits are designed to provide reasonable protection against harmful interference in a residential installation. This equipment generates, uses, and can radiate radio frequency energy and, if not installed and used in accordance with these instructions, may cause harmful interference to radio communications. However, there is no guarantee that interference will not occur in a particular installation. If this equipment does cause harmful interference to radio or television reception, which can be determined by turning the equipment off and on again, the user is encouraged to try and correct the interference by using one or more of the following measures:

- Re-orient or relocate the receiving antenna.
- Increase the separation distance between the equipment and the receiver.
- Connect the equipment to an outlet on a different circuit from that which the receiver is currently connected.
- Consult the dealer or an experienced radio/TV technician for help.

Changes or modifications not approved by the party responsible for compliance could void the user's authority to operate the equipment.

Button Layout and Functions

Before using your new air conditioner, be sure to familiarize yourself with the remote control. The following is a brief overview of the remote controller itself. For instructions on how to operate your air conditioner, refer to the BASIC and ADVANCED functions sections of this manual.

Note: HEAT mode is not supported by your appliance if you have purchased a cooling-only version. The HEAT

mode option on this controller will not function with cooling-only appliances.

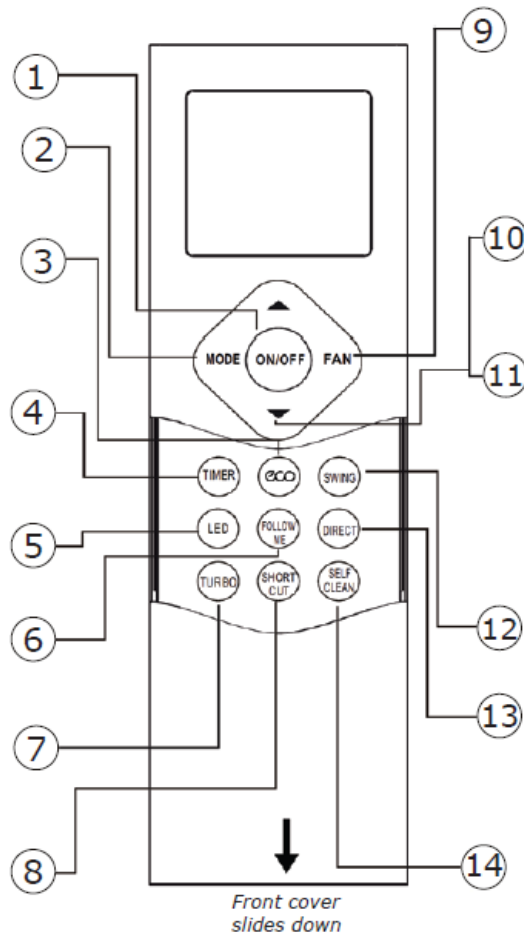

1. ON/OFF

Turns the unit on or off.

2. MODE

Cycles through the following operation modes: AUTO COOL DRY HEAT FAN

3. ECO

Starts and stops the energy efficiency feature. Hold this button for 2 seconds in order to activate the sleep feature.

4. TIMER

Sets the timer for turning the unit on or off. See the BASIC functions section for instructions.

5. LED

Turns the indoor unit's LED display on or off.

6. FOLLOW ME

Activates the remote as the thermostat instead of the unit.

7. TURBO

Sets the unit to reach the preset temperature in the shortest time.

8. SHORTCUT

Sets/activates your own presets.

9. FAN

Cycles through fan speeds in the following order:

10. AUTO LOW MED HIGH

Hold this button for 2 seconds to activate silent mode.

11. **TEMP** ▲

Raises temp. in 1° increments. Max 86°F (30°C).

12. **TEMP** ▼

Lowers temp. in 1° increments. Min 62°F (17°C).

NOTE: Press and hold ▲ ▼ to alternate between °F and °C.

13. **SWING**

Starts/stops the horizontal louver auto-swing feature.

14. **DIRECT**

Set the desired up/down airflow direction. (Each press is 6 degrees)

15. **SELF-CLEAN**

Starts/stops the self-clean feature.

Handling the Remote Controller

Not sure what a function does?

Refer to the BASIC FUNCTIONS and ADVANCED FUNCTIONS sections of this manual for detailed descriptions of operating your air conditioner.

Special Note

- **The button** designs on your unit may differ slightly from the illustrations and examples shown.
- If the indoor unit does not have a particular function, the function selection on the remote will have no effect.

Inserting/Replacing Batteries

Your air conditioning unit comes with two AAA batteries, which should be inserted into the remote.

- Remove the back cover from the remote to expose the battery compartment.
- Insert the batteries, paying attention when matching the (+) and (-) ends of the batteries with the symbols in the compartment.
- Re-attach the back cover.

Installing the Remote Holder

The remote control holder (which may or may not have been included in your unit) can be attached to a wall or stand. Check that the air conditioner is receiving signals before installation. Use the two included screws to install the holder.

Note About the Battery

For optimal product performance:

- Do not mix old and new batteries or ones of different types.
- Do not leave batteries in a remote that will not be used for more than 2 months

Remote Controller Tips

- The remote controller should be used within 8 meters of the unit.
- The unit will beep when signals from the remote area are received.
- Curtains, direct sunlight, etc. can interfere with the receiver's infrared signal.
- If the remote controller will not be used for more than 2 months, be sure to remove its batteries.

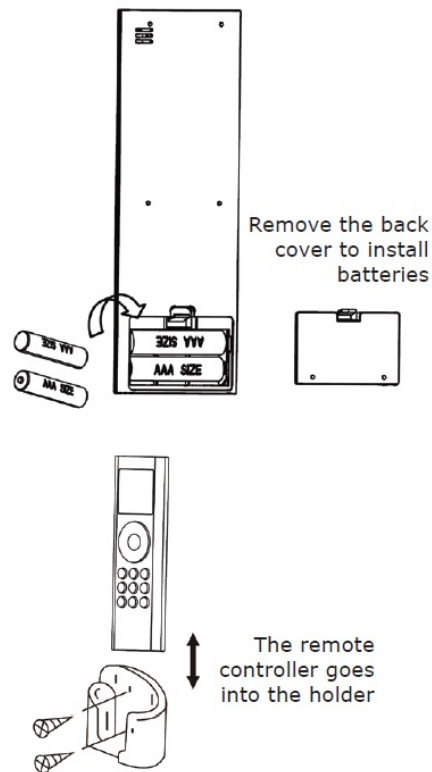

Battery Disposal Do not dispose of batteries as unsorted municipal waste. Refer to your local laws for the proper disposal of batteries.

LCD Screen Icons/Indicators

Information is displayed when the remote controller powers up. An overview of the various icons is given below.

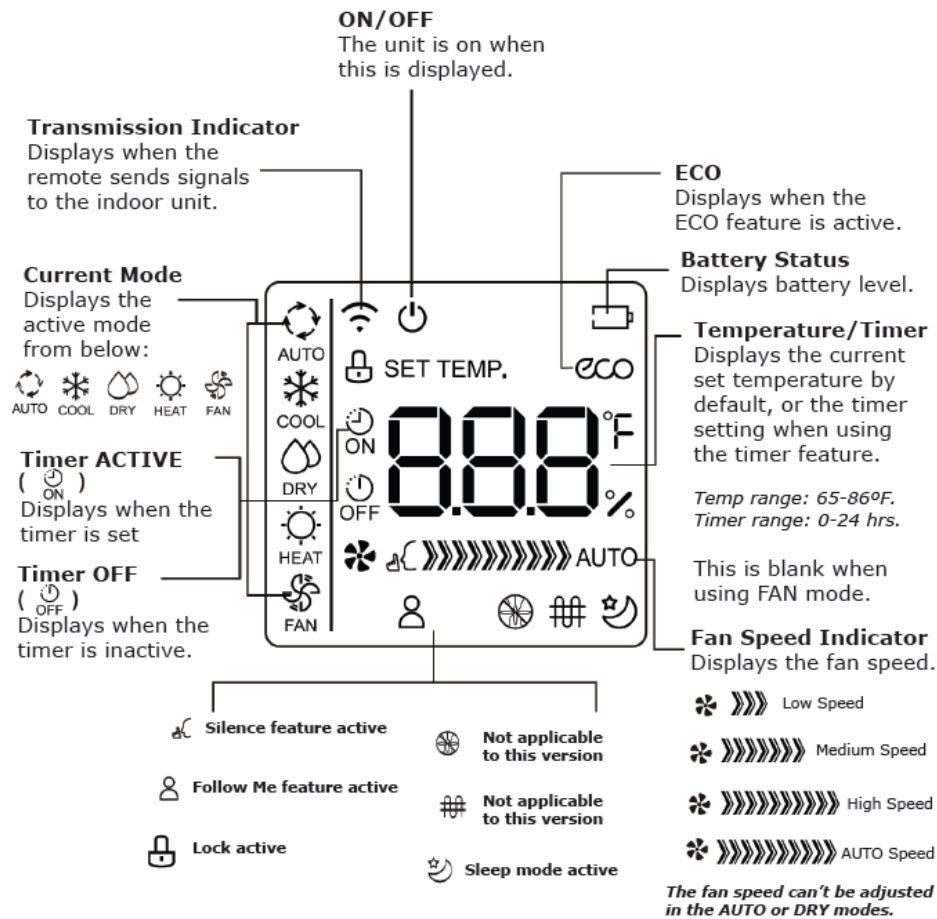

Note: All indicators shown in the figure above are for the purpose of clear presentation. During actual operation, only the relative functional icons will show on the display window.

Basic Functions

AUTO Mode Operation

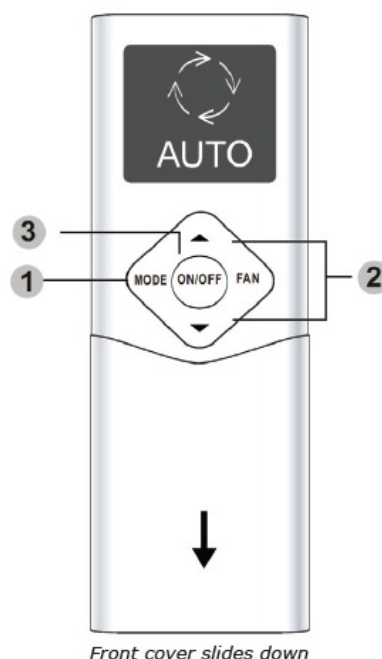

In AUTO mode, the unit will automatically select COOL, FAN, HEAT, or DRY modes based on the set temperature.

1. Press the MODE button to select AUTO mode.
2. Set your desired temperature using the temp ▲ or ▼ temp buttons.
3. Press the ON/OFF button to start the unit.

Note: Fan speed can't be set when in AUTO mode

COOL Mode Operation

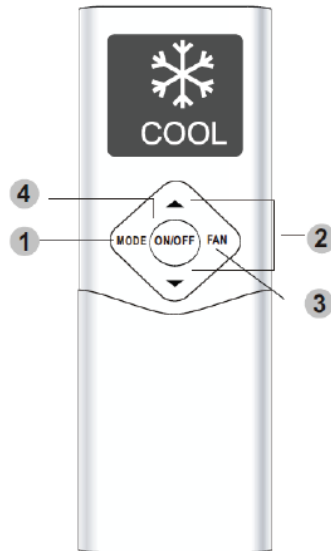

1. Press the MODE button to select COOL mode.
2. Set your desired temperature using the temp ▲ or ▼ temp buttons.
3. Press the FAN button to select the fan speed.
4. Press the ON/OFF button to start the unit.

Setting Temperatures

The operating temperature range for your air conditioning unit is 62-86°F (17-30°C). You can increase or decrease this set the temperature in 1° increments

DRY (Dehumidification) Mode

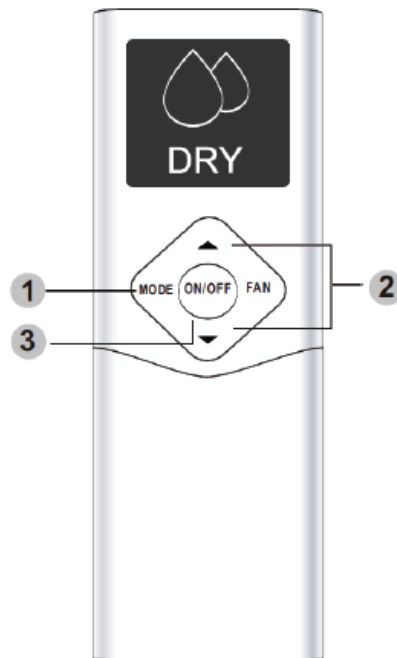

1. Press the MODE button to select AUTO mode.
2. Set your desired temperature using the temp ▲ or ▼ temp buttons.
3. Press the ON/OFF button to start the unit.

Note: Fan speed can't be set when in DRY mode.

FAN Mode Operation

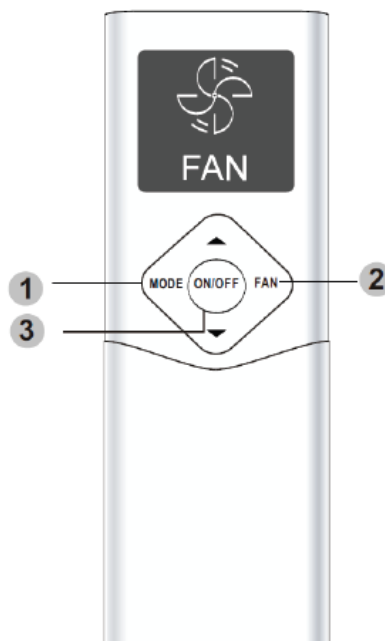

1. Press the MODE button to select FAN mode.
2. Press the FAN button to select the fan speed.
3. Press the ON/OFF button to start the unit.

Note: A temperature cannot be set when in FAN mode. As a result, your remote control LCD screen will not display the temperature.

HEAT Mode Operation

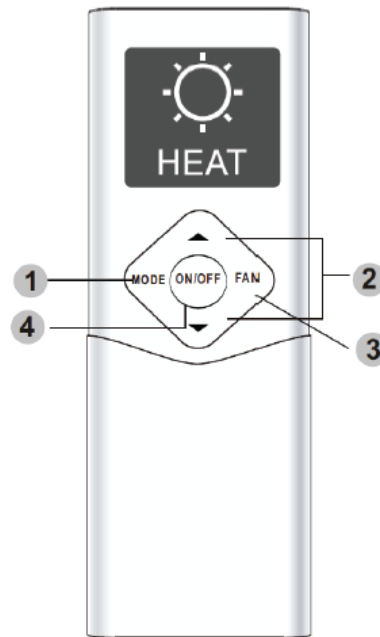

1. Press the MODE button to select HEAT mode.
2. Set your desired temperature using the temp ▲ or ▼ temp buttons.
3. Press the FAN button to select the fan speed.
4. Press the ON/OFF button to start the unit.

Note: As the outdoor temperature drops, the performance of your unit during HEAT mode may be affected. In such instances, it is recommended to use an additional heating appliance in conjunction with this air conditioner

Setting the TIMER function

Your air conditioning unit has two -related features:

- **TIMER ON** – Sets the amount of delay before the unit will automatically turn on.
- **TIMER OFF** – Sets the amount of time before the unit will turn itself off.

TIMER ON:

The TIMER ON feature allows you to set a fixed period of time, after which the unit will automatically turn itself on. For example, it can be scheduled to turn on when the user arrives home from work.

1. Press the TIMER button. The timer on the indicator and the time the amount will display.

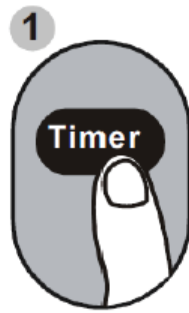

Note: This value indicates the amount of time left before the unit turns itself on. Activating TIMER ON with a value of 2h at 1 p.m. will turn the unit on at 3 p.m.

2. Press the temp ▲ or ▼ temp buttons repeatedly to configure the time that the unit should turn itself on.
3. 3-4. After 3 seconds, the TIMER ON feature will be active. The digital display on your remote controller will then return to displaying the temperature. The indicator remains on and the feature is now activated.

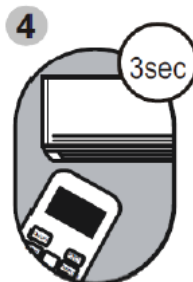

TIMER OFF:

The TIMER OFF feature allows you to set a fixed period of time, after which the unit will automatically turn itself off. For example, it can be scheduled to turn off when the user leaves home for work.

1. Press the TIMER button. The timer off indicator and the time amount will display.

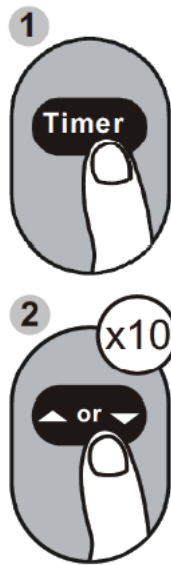

Note: This value indicates the amount of time left before the unit turns itself off. Activating TIMER OFF with a value of 5h at 2 p.m. will turn the unit off at 7 p.m.

2. Press the temp ▲ or ▼ temp buttons repeatedly to configure the time that the unit should turn itself off.
3. 3-4. After 3 seconds, the TIMER OFF feature will be active. The digital display on your remote controller will then return to displaying the temperature. The indicator remains on and the feature is now activated.

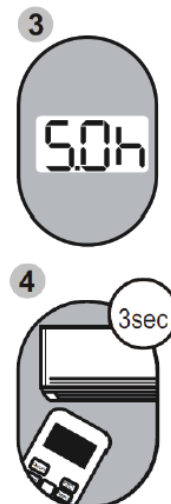

Note: When configuring the TIMER ON or TIMER OFF features, the configuration process will increase/decrease in 30-minute increments until the value reaches 10 hours. After 10 hours, the configuration will increase/decrease in 1-hour increments. Either function can be turned off by setting the timer to "0hr". 24-hour limit max

Setting TIMER ON and TIMER OFF simultaneously

Users are able to configure both the ON and OFF settings of the timer function. Be sure to note that the time periods that are set for either of the functions are the number of hours after the current time. Ex: If the current time is 1 p.m., and the user wants the system to turn itself on at 7 p.m. and run for 2 hours, they would do the following:

Configure the TIMER ON feature of the system to turn itself on in 6 hours:

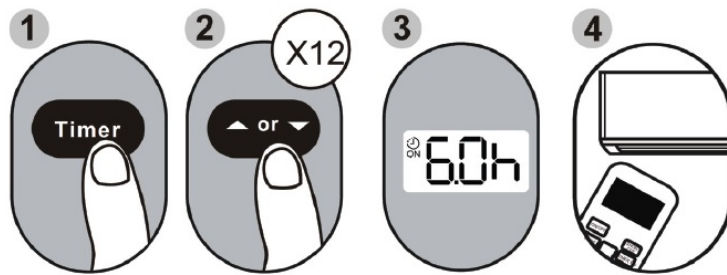

Configure the TIMER OFF feature of the system to turn itself off in 8 hours:

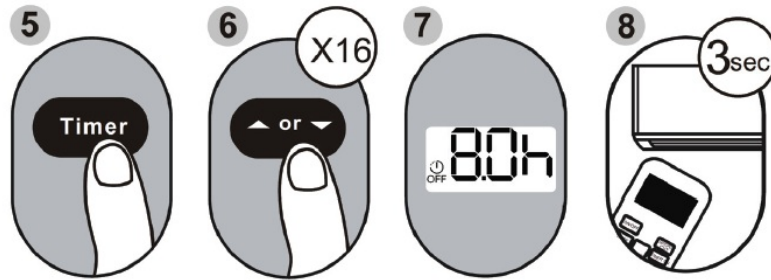

The example on page 11 shows how to set the system to turn on after 6 hours, operate for 2 hours and then turn itself off. See the figure below:

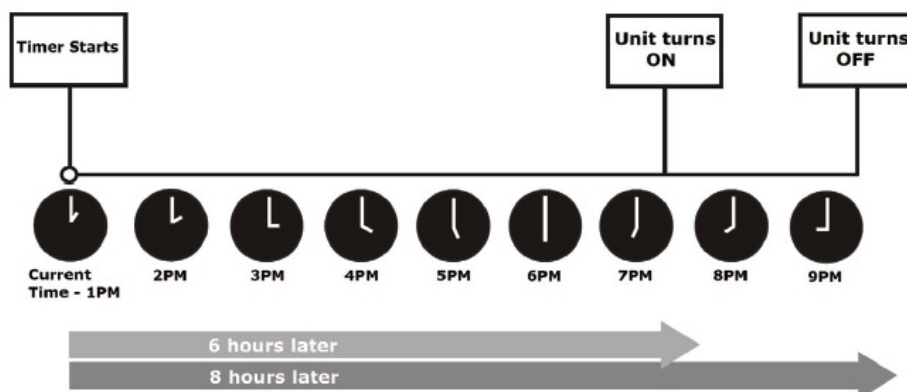

The remote display will be as shown

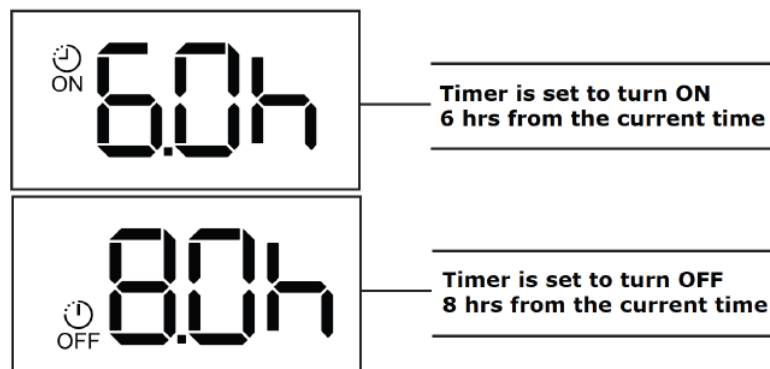

Note: If the user wishes to incorporate the scheduling feature, which will enable the ability to set specific times of each day of the week when the unit will turn off and on, they may purchase the Pioneer Wireless Internet Access & Control Module. This accessory is sold separately, and is available at www.pioneerminisplit.com

Advanced Functions

ECO Feature (COOL mode only)

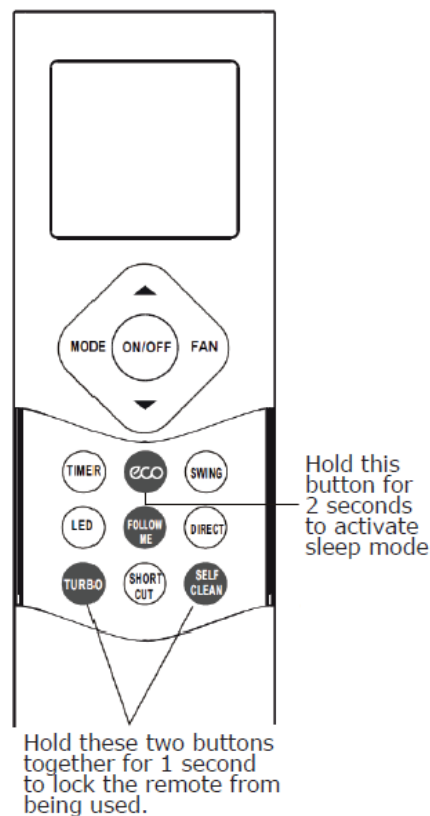

The ECO button is used to enter the system's energy-efficient mode. When the unit is in cooling mode, pressing this button will adjust the temperature to 75°F (24°C) and the fan speed will change to AUTO. If the current set temperature is set above 75°C/24°C, then the fan speed will be changed to AUTO and the set temperature will not change. Note: Pressing the ECO button, or modifying the mode/adjusting the set temperature to below 75°C/24°C will take the system out of ECO mode. When in ECO mode, the temperature should be set to 75°C/24°C or greater. If this results in insufficient cooling and discomfort, the ECO button should be pressed again to take the system out of ECO mode.

Sleep Mode

Holding down the ECO button for 2 seconds will put the system into sleep mode. Sleep mode is typically meant for periods of lower cooling requirements, such as during typical sleeping hours. This mode will result in decreased energy use, and can only be activated via remote control. For more details, please refer to the "sleep mode" section of the system user manual.

Note: Sleep mode is unavailable during FAN or DRY mode

Lock Feature

Press the turbo button and the self-clean button together for one second to lock or unlock the remote's button board.

"Follow Me" Feature

The "Follow Me" button enables the remote controller to measure the temperature at its current location and send this value to the air conditioning system every 3 minutes. When using AUTO, COOL, or HEAT mode, prioritize the temperature nearest to the user may ensure better comfort.

Silent Mode

Holding the FAN button for 2 seconds will activate/deactivate silent mode. This feature is only available to certain models. Use this feature to run the system more quietly. When running in this mode, the system may experience a

diminished heating or cooling output capacity

Vacation Mode

Pressing the button twice in one second will put the system into vacation mode. Under vacation mode, the system will remain at 46°F(8°C) and the indoor unit display will show “FP”, meaning freeze protection.

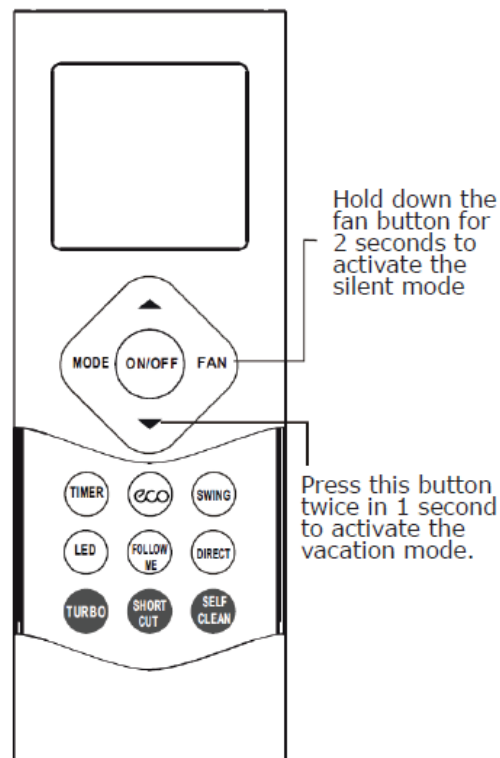

Shortcut Feature

This is used to restore current settings or to resume previous settings. Push the shortcut button when the remote control is on and the system will automatically revert back to its previous settings, such as its operating mode, set temperature, fan speed level, and the unit's sleep mode feature (if active). If held for more than 2 seconds, the system will automatically restore its current operating settings in use at the time

Self-Clean Mode

Airborne bacteria can manifest in the moisture that condenses in or around the unit's heat exchanger. With regular use, most of this moisture has usually evaporated. When the self-clean mode is active, the system will clean itself and afterward will turn itself off

automatically. This feature can be used as often as needed but is only available in COOL (AUTO), or DRY mode.

Turbo Mode

Turbo mode forces the unit to reach the set temperature in the quickest time possible. In cooling mode, this will result in the unit jump-starting the process with strong wind output. In heating mode, the unit may employ the use of a supplementary electric heater, for units that are equipped with this feature.

FAQS

Q: What are the main buttons on a Pioneer Air Conditioner remote?

A: The main buttons on a Pioneer Air Conditioner remote typically include Power On/Off, Mode, Temperature Up/Down, Fan Speed, Swing, and Timer buttons.

Q: What does the Power button do?

A: The Power button turns the air conditioner unit on or off. Pressing this button will either start or stop the cooling or heating function.

Q: What does the Mode button do?

A: The Mode button allows you to select different operating modes for your air conditioners, such as Cool, Heat, Fan, or Auto. You can cycle through the available modes by pressing the Mode button repeatedly.

Q: How do the Temperature Up/Down buttons work?

A: The Temperature Up/Down buttons enable you to adjust the desired temperature setting for your air conditioner. Pressing the Temperature Up button increases the temperature while pressing the Temperature Down button decreases it.

Q: What is the Fan Speed button for?

A: The Fan Speed button allows you to adjust the speed of the indoor fan of your air conditioner. You can typically choose from multiple fan speed settings such as Low, Medium, High, or Auto.

Q: What does the Swing button do?

A: The Swing button controls the horizontal movement of the air conditioner's louvers. When activated, the louvers will oscillate from left to right, distributing the airflow in a wider area.

Q: How does the Timer button function?

A: The Timer button allows you to set a timer for the air conditioner to turn on or off automatically. You can program the air conditioner to start or stop after a certain period, typically in hours.

Q: Are there any additional buttons or functions on a Pioneer Air Conditioner remote?

A: Depending on the specific model, Pioneer Air Conditioner remotes may include additional buttons such as Sleep mode, Turbo mode, Quiet mode, or Energy Saving mode. These buttons offer extra functionalities to optimize your comfort and energy usage.

What do the buttons on my AC remote mean?

The temperature buttons are usually up and down arrows with TEMP written by them. Pressing the UP button will increase the set temperature and pressing the DOWN button will decrease the temperature. Most units have a MODE button which will cycle through the air conditioning units' different operations.

What are common problems with remote controls?

There are many reasons that make your remote not work. However, the most common reasons for a TV remote that is not working are battery issues, pairing issues, or infrared sensor issues. Press the power button while pointing the remote control at your TV. Make sure the LED indicator on the TV blinks.

Download PDF: [Pioneer Air Conditioner Remote Buttons and Functions Guide](#)