

Pin tura A4 Mobile Phone and Tablet Computer Mockup Isolated Vector Image

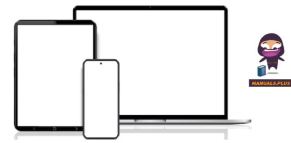

# Pin tura A4 Mobile Phone and Tablet Computer Mockup Isolated Vector Image Instruction Manual

[Home](#) » [Pin tura](#) » Pin tura A4 Mobile Phone and Tablet Computer Mockup Isolated Vector Image Instruction Manual 

## Contents

- [1 Pin tura A4 Mobile Phone and Tablet Computer Mockup Isolated Vector Image](#)
- [2 What's in the Box](#)
- [3 Installation Method](#)
- [4 Documents / Resources](#)
  - [4.1 References](#)

# Pin·tura<sup>®</sup>

**Pin tura A4 Mobile Phone and Tablet Computer Mockup Isolated Vector Image**

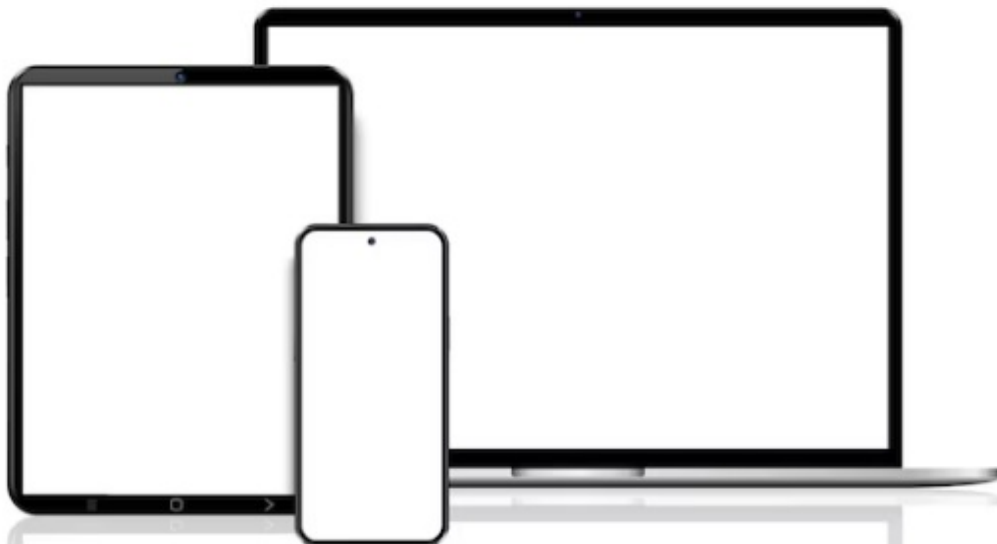

**What's in the Box**

What's in the Box	①Charging board(21.65in*21.65in)			
	②Wall bracket*1		③Power adapter*1	
	④Product bracket*2		⑤Lag bolts ¼" and 3 " long*3	
	⑥Pan head screw M3*12 (6pcs)	⑦Flat screw M3*12 (4pcs)	⑧Foot*2	
You will need	a. Pencil	b. Level	c. Drill	d. 1/8"Drill bit
	e. Stud Finder	f. Lag bolt driver		g. Socket screwdriver

## Installation Method

1

\*Due to the weight of the unit, we strongly recommend securing the bracket into the studs.

Step 1

Wooden Stud



Step 2

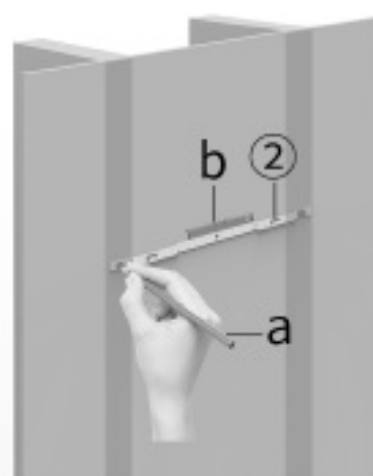

Step 3

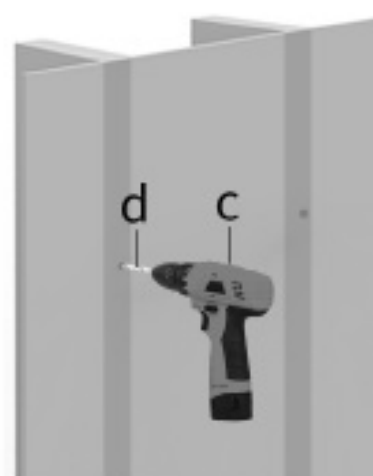

**\*You will need:** pencil, level, drill and 1/8" drill bit, stud finder, Lag bolt driver

2

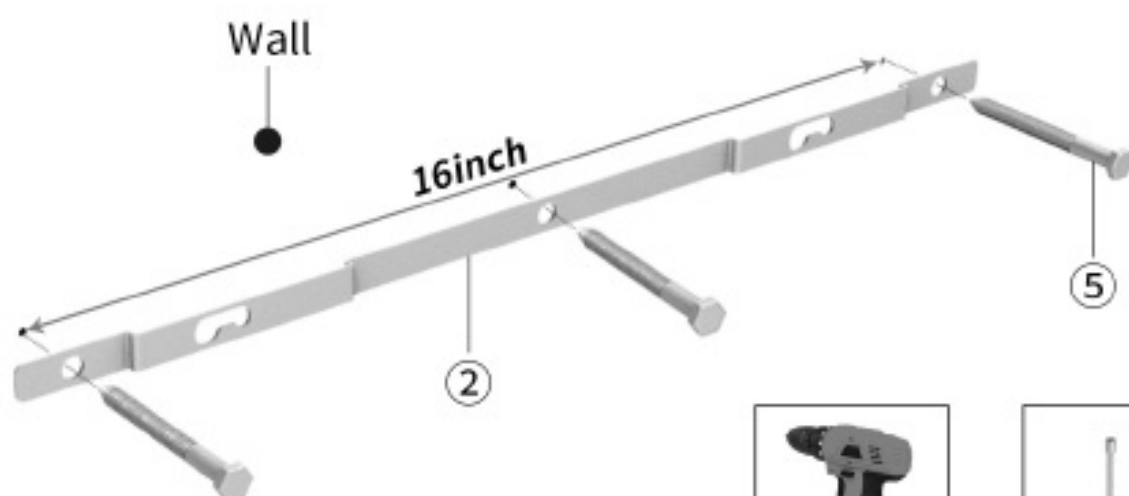

\*Tighten using a drill/impact driver with a lag bolt or a wrench.

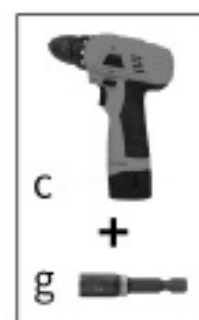

or



**3** Install the product brackets and foots, and connect power cord.

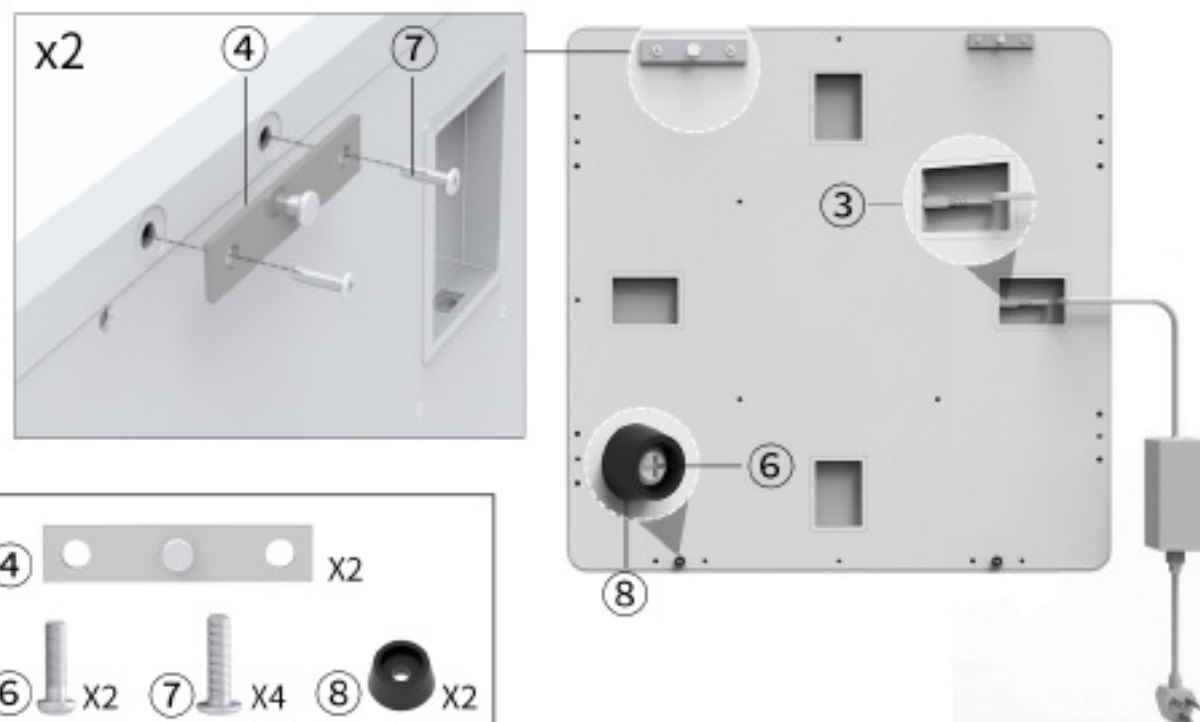

**4** Align then shift left to secure

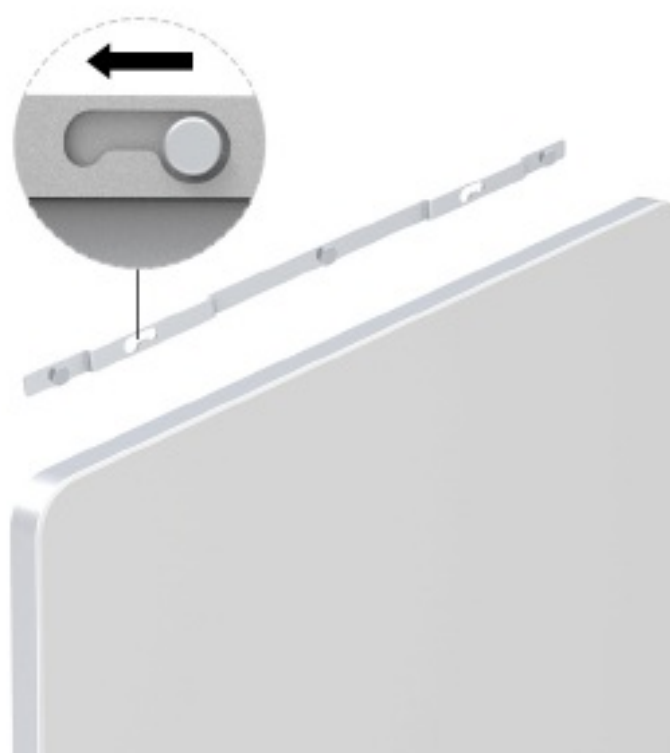

5

Plug in the board and place the tablets on the red lights.



The red positioning lights will light for 7 seconds.



6

Hover the tablet close to the center of the board to re-light the red positioning lights.

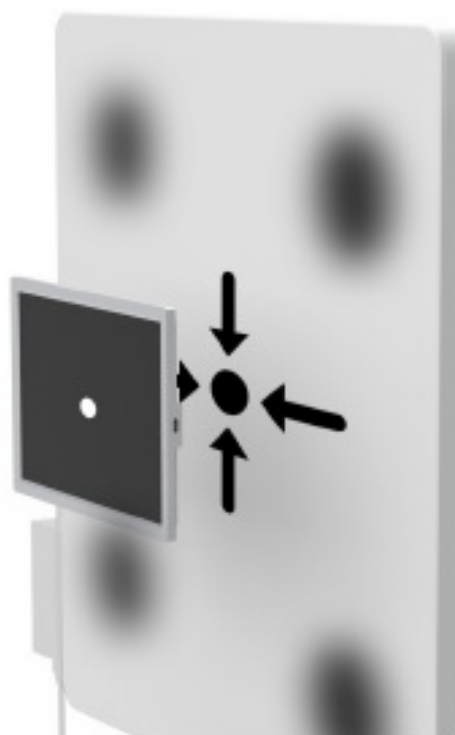

7

**Do not let go of the tablet until:**

- It is magnetically fixed to the board.
- It is powered on.



To find the operation manual please visit: <http://www.austinelec.com/english/ser/serl.aspx>



Learn  
more



Installation & APP  
instructions

## Documents / Resources

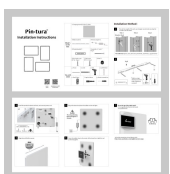

[Pin tura A4 Mobile Phone and Tablet Computer Mockup Isolated Vector Image](#) [pdf] Instruction Manual

A4 Mobile Phone and Tablet Computer Mockup Isolated Vector Image, A4, Mobile Phone and Tablet Computer Mockup Isolated Vector Image, Tablet Computer Mockup Isolated Vector Image, Computer Mockup Isolated Vector Image, Mockup Isolated Vector Image, Isolated Vector Image, Vector Image

## References

- [User Manual](#)

[Manuals+](#), [Privacy Policy](#)

This website is an independent publication and is neither affiliated with nor endorsed by any of the trademark owners. The "Bluetooth®" word mark and logos are registered trademarks owned by Bluetooth SIG, Inc. The "Wi-Fi®" word mark and logos are registered trademarks owned by the Wi-Fi Alliance. Any use of these marks on this website does not imply any affiliation with or endorsement.