



XPICOOC Smart Body Fat Scale User Manual

[Home](#) » [PICOOC](#) » XPICOOC Smart Body Fat Scale User Manual 

Contents

- [1 XPICOOC Smart Body Fat Scale](#)
- [2 Security Information](#)
- [3 Measuring Instructions](#)
- [4 Warranty and Support](#)
- [5 Documents / Resources](#)
- [6 Related Posts](#)

PICOOC LOGO

XPICOOC Smart Body Fat Scale



Security Information

- Patients with pacemakers or other medical equipment should not use this device!

- If you are pregnant, please consult a doctor for advice before using!
- Do not place the device on slippery surfaces when using!
- The device is covered by glass. In order to prevent injury, please make sure that the glass is not damaged before using.
- Any data or advices in the APP are for reference only, and they do not replace or stand for professional diagnosis of medical institutions.
- Please keep the manual properly, and offer it to others before they use the device, the manual should be included for sales.

For more security considerations, Please check your local dealer supporting websites or visit

<https://www.picooc.com>

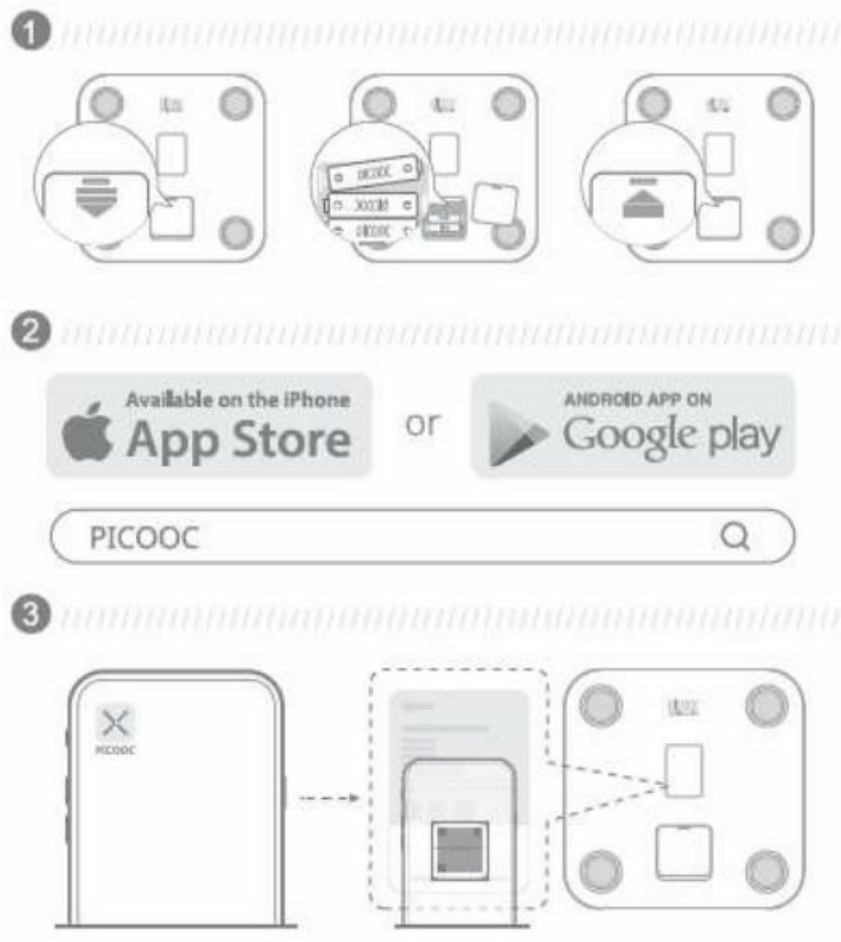

Measuring Instructions

Measurement error may be larger for the following users:

- Growing children
- Elderly people
- People suffering from colds and other ailments
- Osteoporotic patients with very low bone density
- Edema patients
- Artificial dialysis patients
- People who are involved with fitness or sports (or similar activities)

Please generally avoid using the scale in the following situations:

- After strenuous exercise
- After sauna or a bath
- After heavy drinking
- After ingesting significant food and/or water

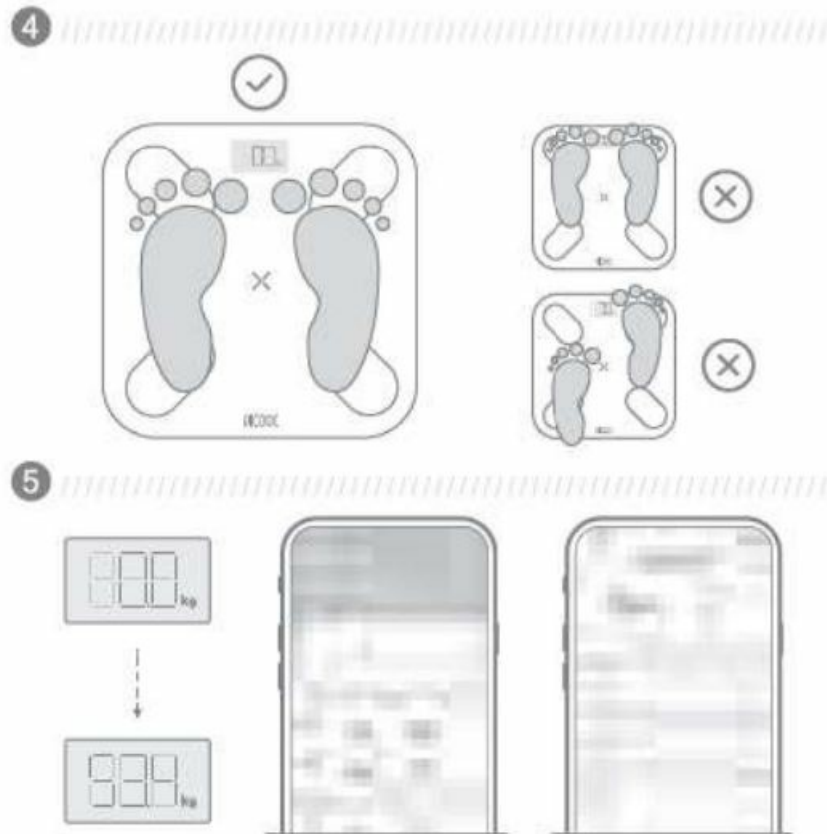

Warranty and Support

You may consult your dealer for warranty and service support policies of the device.

You may check the dealer information on supporting websites and learn about more information of the device.

(<http://www.picooc.com>)

This device complies with Part 15 of the FCC rules. Operation is subject to the following two conditions: 1) this device may not cause harmful interference, and 2) this device must accept any interference received, including interference that may cause undesired operation.

This equipment has been tested and found to comply with the limits for a Class B digital device, pursuant to Part 15 of the FCC rules. These limits are designed to provide reasonable protection against harmful interference in a residential installation. This equipment generates, uses and can radiate radio frequency energy and if not installed and used in accordance with the instructions, may cause harmful interference to radio communications. However, there is no guarantee that interference will not occur in a particular installation. If this equipment does cause harmful interference to radio or television reception, which can be determined by turning the equipment off and on, the user is encouraged to try correct the interference by one or more of the following measures:

- Reorient the receiving antenna.
- Increase the separation between the equipment and receiver.
- Connect the equipment into an outlet on a circuit different from that to which the receiver is connected.

- Consult the dealer or an experienced radio/TV technician for help.

Changes or modifications not expressly approved by the party responsible for compliance could void your authority to operate the equipment.

Documents / Resources

	<p>PICOOC XPICOOC Smart Body Fat Scale [pdf] User Manual 2ALE7-MINILITE, 2ALE7MINILITE, XPICOOC, XPICOOC Smart Body Fat Scale, Smart Body Fat Scale, Body Fat Scale, Fat Scale, Scale</p>
---	---

[Manuals+.](#)