



# PICKFUN P1 AI Pet Video Robot User Manual

[Home](#) » [PICKFUN](#) » PICKFUN P1 AI Pet Video Robot User Manual 

**PICKFUN P1 AI Pet Video Robot**



Dear pet owner, Please read this user manual carefully before first use of the product and keep it properly for future reference.

## Contents

- [1 Product info](#)
- [2 Instructions](#)
- [3 Product features](#)
- [4 Frequently Asked Questions](#)
- [5 Specifications](#)
- [6 Cautions](#)
- [7 Name and content of hazardous substances](#)
- [8 Non-warranty scope](#)
- [9 Warranty Claim Card](#)
- [10 Documents / Resources](#)
  - [10.1 References](#)
- [11 Related Posts](#)

## Product info

Pickfun AI Pet Video Robot, referred to as "Pickfun", is a warm smart creative short pets video robot with thinking. It can track, film pets and automatically edit into a short video to record time of your pets.

### 1. Structure



## 2. Packing list

Pickfun AI Pet Video Robot x 1, Power Adapter x 1, Card Picking Pin x1, User Manual x1

## Instructions

### 1. Download APP

Please go to Google Play or App Store to download Pick fun.

### 2. Power on

Please power on the Pickfun AI Pet Video Robot with the power adapter that comes with it in the package (Note: Do NOT use this adapter to power other electronic devices such as mobile phones in case of damage). When the indicator light remains orange, the power is on and the device starts self-check and rotation. After the self-test, the indicator turns orange marquee, and the device is ready for configuration.

### 3. Bind the device/configure the network

1. After registration and logging in to the ID in the Pick fun app, click “+” under the “Device” menu:

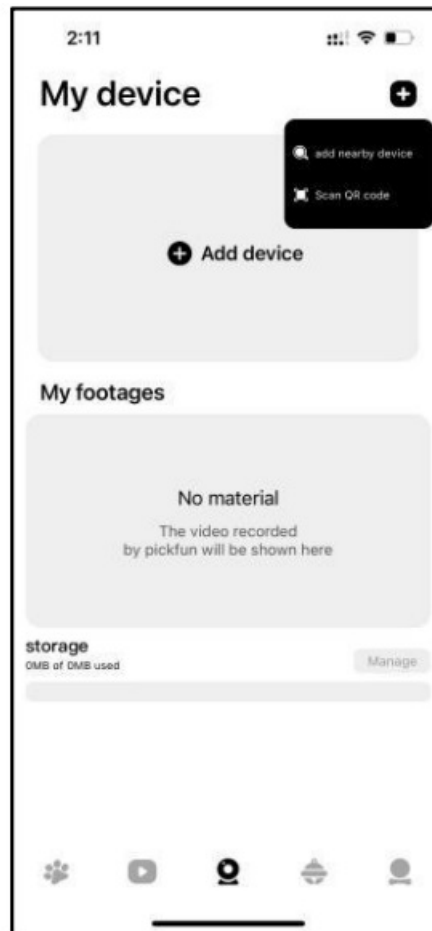
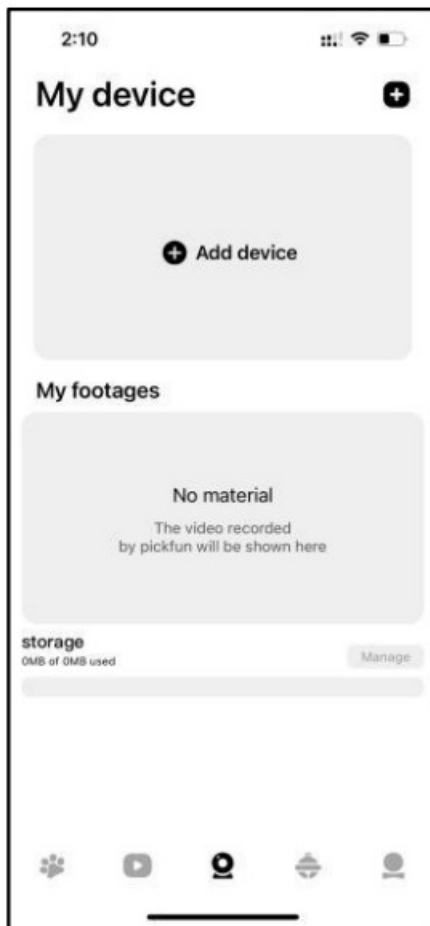

**Method 1:** Select “Scan QR code” and scan the QR code at the bottom of the device. (Keep the Bluetooth and location permission of the mobile phone enabled and connected)

**Method 2:** Select “Add nearby device”, enable Bluetooth in the mobile phone, and the app will start to search for devices around. According to the serial number at the bottom of the device, click “Connect” to connect your device;

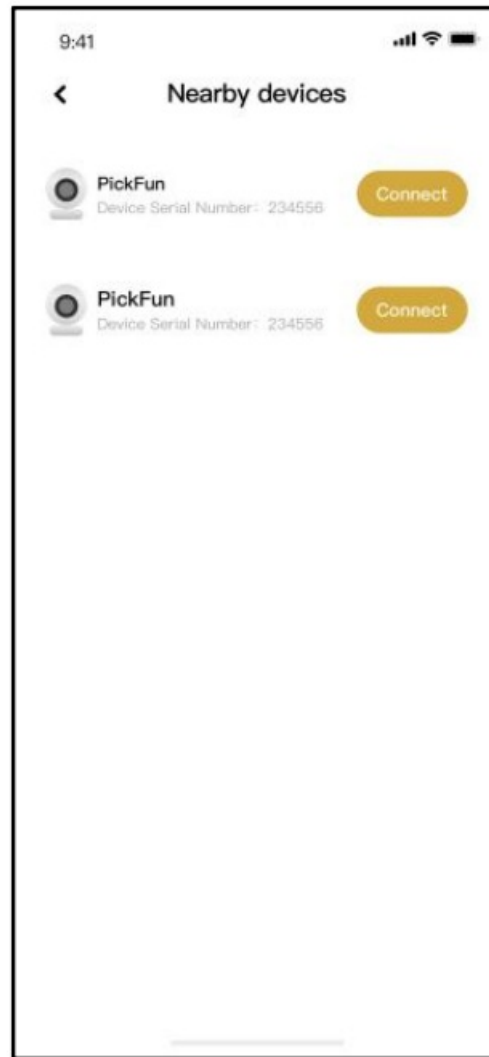
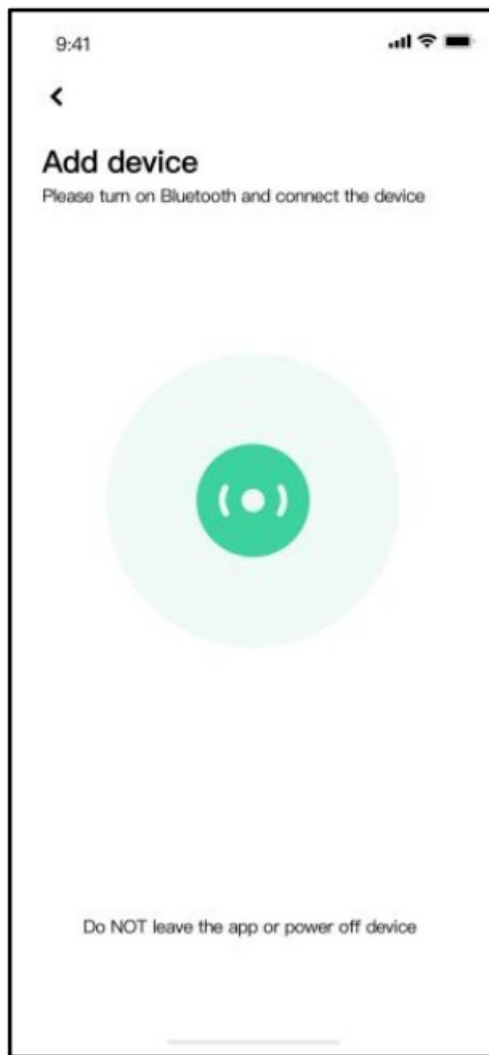

2. Prepare Device for connection: long press the bottom hole with the pin coming with device until a beep is heard. Click "Next" and continue to the next step;



3. Network configuration: Enter the Wi-Fi name and password, and click "Next" (Pickfuncurrently only supports 2.4GHz Wi-Fi connection)

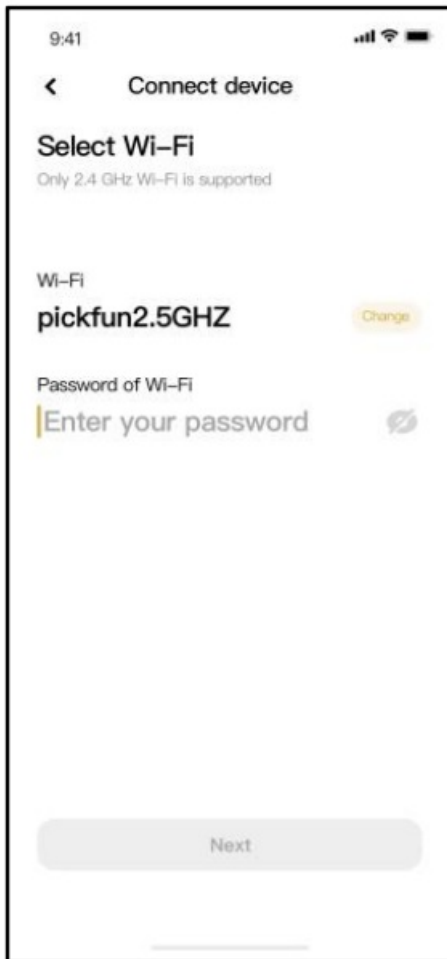

4. Successful connection: The device voice prompts network configuration is successful, and displays in the app the device is successfully connected, then you can click “Done” to continue to the real-time video screen, when the indicator light of the device changes from pink flash light to constant white.

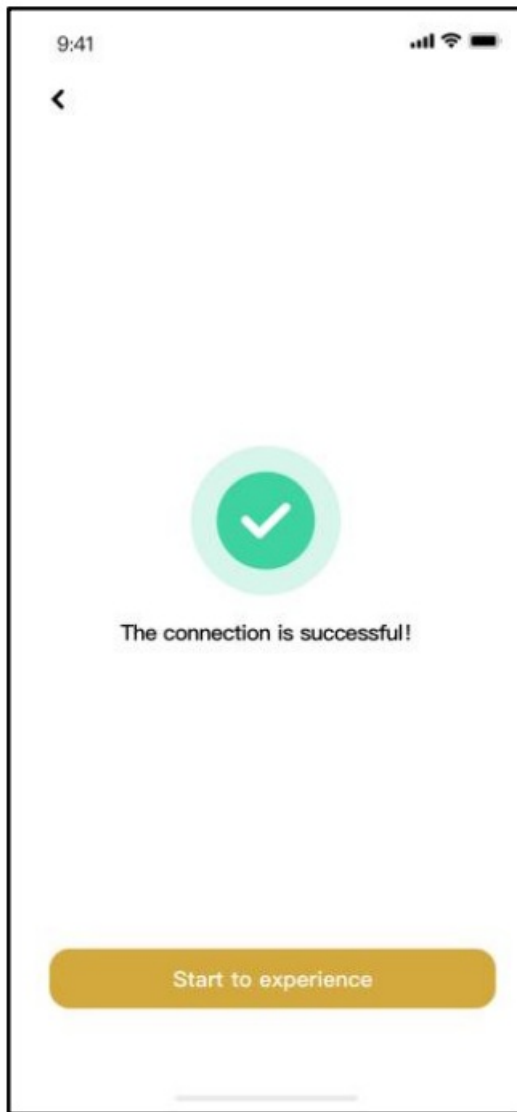

#### 4. Status indicator



**Constant single orange light:**  
powered on and self-check  
in progress



**Orange marquee light:**  
not connected to the  
network



**The upper white light:**  
offline working



**Constant upper white light:**  
working normally,  
searching and filming pets



**Constant lower  
white light:**  
real-time video  
stream working



**Pink and purple  
breathing light:**  
in network  
configuration



**Lights off and  
helmet down:**  
in sleep

## Product features

### 1. Generate short videos of pets in a smart way

Pickfun AI pet video robot, adopting AI algorithm, will automatically film and edit short videos of pets for pet parents, recording wonderful moments of cute pets without manual efforts throughout the whole process.

### 2. View the real-time video stream

After the device is bound successfully, you can click the connected Pickfun device in the app to view its real-time stream, adjust the PTZ of the device through the operation interface in the app and make remote calls, etc.

### 3. Welcome video and daily video clips

Pickfun automatically edits the video footage the device films, generates short videos with music and push to the Pick fun app

1. Welcome video: After the device is bound successfully, a welcome video is generated in a very short time, bringing you the fun of fast filming;
2. Daily video clips: After the device is bound and can work normally, automatic short videos will be released at 9.00 a.m., 10.30 a.m., 12.30 p.m., 2.30 p.m., 4.30 p.m., 6.30 p.m., and 8.00 p.m. every day;

### 4. Privacy protection

Pickfun tracks and detects pets only; the device will automatically sleep at night, the lens will turn downward for physical shielding during sleep, and the helmet will automatically cover down for secondary physical shielding, so you don't need to worry about privacy leakage.

## Frequently Asked Questions

### 1. How does the device work?

After the device is powered and the network configuration complete, Pickfun immediately enters the filming mode, automatically films pets, edits and pushes the edited short videos.

2. Recommended placement for Pickfun In order to obtain high quality short videos, please avoid the clutter in front of the Pickfun device and maintain a clear view. Please ensure the brightness of the environment. It is recommended that you open the curtains when you leave for work, and keep the room where the pet moves bright. To ensure better final video effect, it is recommended to place the Pickfun device lower than 1m above the ground (e.g., on a coffee table, TV cabinet, etc.).
- In case your pet knocks down the device, you can set it to sleep in the app and prevent it from continuous idling.

### 3. How does Pickfun save videos?

As Pickfun currently does not support TF card expansion storage, videos can be stored in the cloud. Pick fun gifts users with 300M cloud capacity for free and can upgrade to Pickfun+membership to enjoy 4G cloud storage capacity;

### 4. What to do when the app displays that the device is offline?

When the power is on, please check the device status according to the indicator light; Enter the device management menu in the app and check whether the device is in upgrade (when the device is in upgrade, there will be a short offline restart) ; After the device is powered off and restarted, observe the device status; If the issue remains after the above operations, please contact us;

## Specifications

Specifications	
Product name	Pick fun AI Pet Video Robot
Product model	Smart P1
Video resolution	1080P
Video encoding	H.264
Wireless connection	802.11n 150Mbps WiFi + Bluetooth BLE5.0
Focal length	Lens1 7.65 17.89mm lense2 6.0mm

Pixel	2M
Zoom	Support
Night vision	Not supported
Number of fill lights	10pcs
Steering angle	Horizontal: 350°; vertical: 35°
Storage method	Cloud storage
Tracking method	PTZ tracking
Privacy protection	Support
APP control	Horizontal + Vertical Control
Supported system	Android 5.0 or iOS 10.0 above
Power input	12V/2A
Executive standard	GB8898-2011
Product Size	135.5×110×110mm
Net Weight	440g
Operating temperature	-10°~50°
EAN encoding	6973696600011

## Cautions

- The power adapter for this product is 12V/2A, which works as a special adapter for this product only and shall not be used for mobile phones;
- The power adapter is not a toy, and children or minors should use it under the supervision of an adult;
- Ensure that the device is used within the coverage of the wireless Wi-Fi signal;
- Avoid placing it near sources of strong electromagnetic radiation interference;
- Avoid direct sunlight at close range;
- Ensure that there are no close-range obstructions around the device;
- It is forbidden to place the device outdoor, or in surroundings with high temperature, low temperature, humidity or intense sun-exposure, etc.

## Name and content of hazardous substances

Parts name	Hazardous Substances					
	Lead Pb	Mercury Hg	Cadmium Cd	Hexavalent chromium CrVI	Polybrominated biphenyls PBB	Polybrominated diphenyl ethers PBDE
PCBA	×	○	○	○	○	○
Power adapter	×	○	○	○	○	○
Housing	○	○	○	○	○	○
Gaskets, tapes and other small structural parts	○	○	○	○	○	○

This form has been prepared in compliance with the provisions of SJ/T 11364.

O: Indicates that the content of said hazardous substance in all of the homogenous materials in the component is within the limits required by GB/T 26572.

x: Indicates that the content of said hazardous substance exceeds the limits required by GB/T26572 in at least one homogenous material in the component.

## Non-warranty scope

Unauthorized maintenance, misuse, collision, negligence, abuse, liquid ingress, accident, modification, incorrect use of accessories not for this product, or tearing or altering labels and anti-counterfeiting marks;

1-year warranty period expires;

Product failure caused by external force;

Damage caused by force majeure;

Product accessories;

## Warranty Claim Card

Customer Name		Contact number	
Purchasing Date		Model No.	
Name of Dealer			

Reason for repair	
-------------------	--

If you need after-sales service, please call Tommi Service Hotline: +86 400-689-2108  
Manufacturer: Chengdu Tommi Technology Co., Ltd. Address: 14th Floor, Building 6, No. 399, West Section of  
Fucheng Avenue, High-tech Zone, Chengdu  
Version number of this user manual: V1.0

---

Documents / Resources

	<p><a href="#">PICKFUN P1 AI Pet Video Robot</a> [pdf] User Manual</p> <p>P1 AI Pet Video Robot, P1, AI Pet Video Robot, Pet Video Robot, Video Robot, Robot</p>
---	--

References

- [User Manual](#)