

phrozen CURE BEAM Post Curing UV Light String



# phrozen CURE BEAM Post Curing UV Light String User Manual

[Home](#) » [phrozen](#) » phrozen CURE BEAM Post Curing UV Light String User Manual 

## Contents

- [1 phrozen CURE BEAM Post Curing UV Light String](#)
- [2 Product Usage Instructions](#)
- [3 Product Specifications](#)
- [4 Instructions](#)
- [5 Button Functionality](#)
- [6 Documents / Resources](#)
  - [6.1 References](#)
- [7 Related Posts](#)



phrozen CURE BEAM Post Curing UV Light String



## Product Specifications

- **Power Requirement:** DC 7.5V 1A
- **Wavelength:** 700nm
- **LED Specifications:** 405nm
- **Controller Power:** 5W

## Product Usage Instructions

### Step-by-Step Instructions

When the device is turned on manually, the red indicator light will be turned on as well. The UV light will then be on continuously until the device has been turned off. If the UV light hasn't been used for 60 minutes, the device will automatically turn off.

### Button Functionality

- **POWER:** Click on the Power button to turn on (or turn off) the device.
- **TIMER H.S:** The indicator light from the Timer H.S button will light up in red once the device is turned on.
- **TIMER 1 MIN:** The UV light will automatically turn off after 1 minute when the yellow indicator light is turned on.
- **TIMER 10 MIN:** The UV light will automatically turn off after 10 minutes when the green indicator light is turned on.

## Warnings

**DO NOT** stare directly at the UV light. Please wear safety glasses before usage. **DO NOT** touch or poke the UV light source with sharp objects. Do not use electric cords from other devices. Do not use any chemicals to rub the lens of the UV light device. Do not use it with other adaptors.

**Alcohol Cleaning:** Use sanitizing alcohol to clean the exterior of the device. Do not use any oily or corrosive liquids to clean the device.

## Connectors

- **CH1:** This is the CH1 electric power connector.
- **CH2:** This is the CH2 electric power connector.

## FAQ

- **Can I use this device with adaptors other than the specified one?**
  - No, please do not use any other adaptors with this device. Use only the included power cord set packaged with the main unit.
- **How should I clean the device?**
  - Use sanitizing alcohol to clean the exterior of the device. Avoid using oily or corrosive liquids for cleaning.

## Product Specifications

- **Power Requirement:** DC 7.5V 1A
- **avelength:** 700 mA
- **LED Specifications:** 405 nm
- **Controller Power:** 5 W

## Instructions

### Step-by-Step Instructions

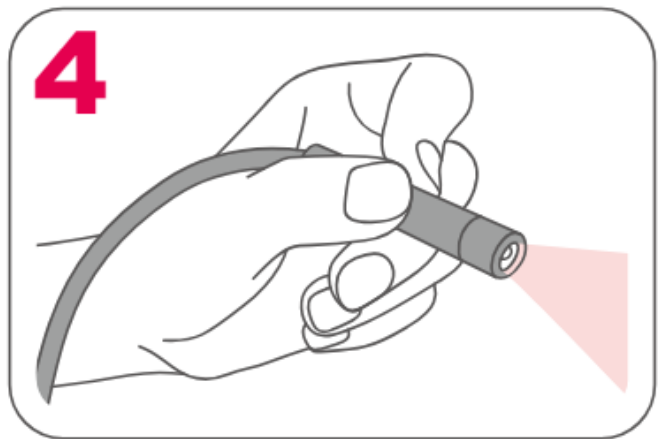
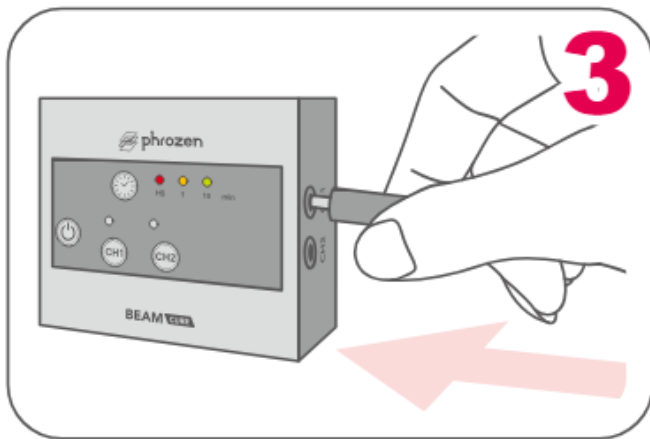
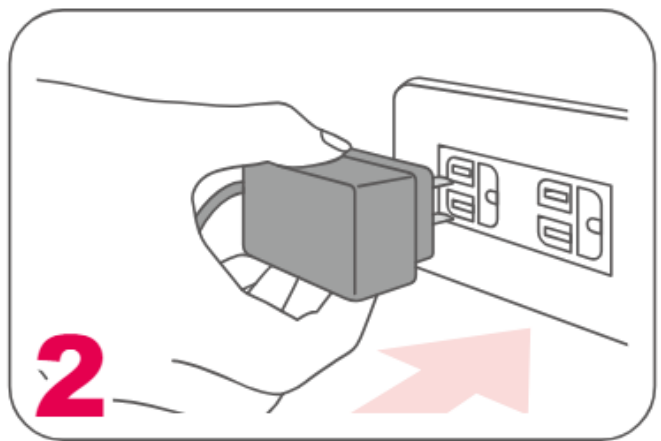
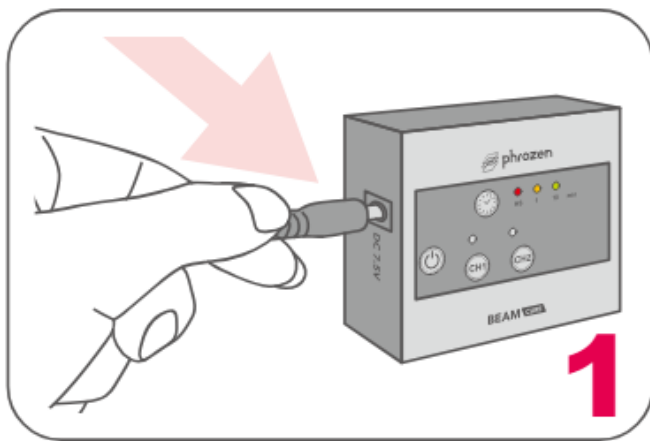

### Button Functionality

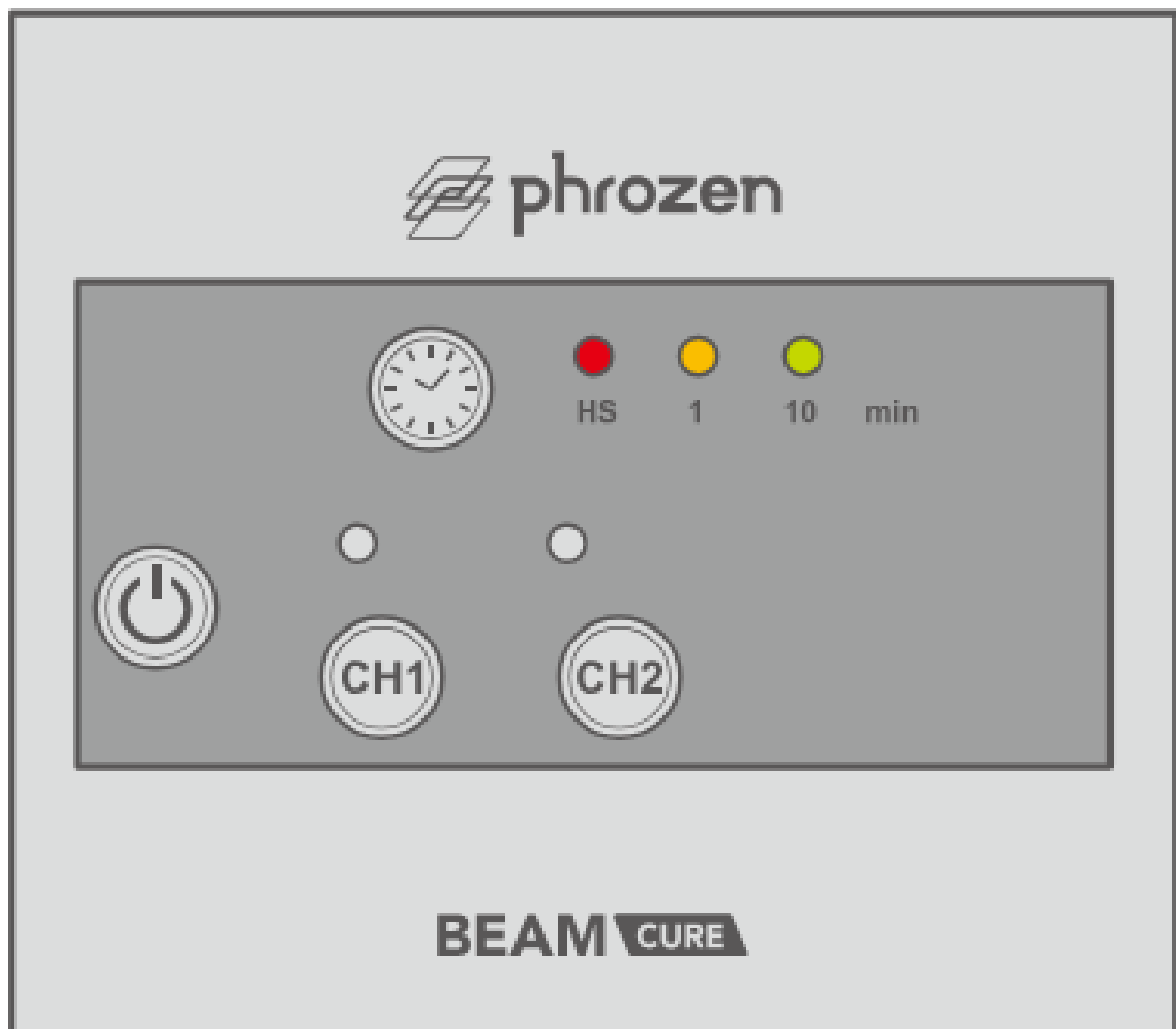



## TIMER H.S

When the device is turned on manually, the red indicator light will be turned on as well. The UV light will then be on continuously until the device has been turned off. If the UV light hasn't been used for 60 minutes, the device will automatically turn off.



## POWER

Click on the Power button to turn on (or turn off) the device. Once the device has been turned on, the indicator light from the Timer H.S button will light up in red. Click on the Power button one more time to turn off the device.



## TIMER 1 MIN

When the yellow indicator light is turned on, the UV light will automatically turn off after 1 minute.



## TIMER 10 MIN

When the green indicator light is turned on, the UV light will automatically turn off after 10 minutes.



## CH1

When the green indicator light is turned on, the UV light will automatically turn off after 10 minutes.



## CH2

This is the CH1 electric power connector.

### **Warning**



- DO NOT stare directly at the UV light. Please wear safety glasses before usage.
- DO NOT touch or poke the UV light source with sharp objects.
- Please do not use electric cords from other devices.
- Do not use any chemicals to rub the lens of the UV light device.
- Do not use it with other adaptors.
- The included power cord set packaged with the main unit cannot be used with electrical equipment other than the specified device



**Maintenance:** Please use sanitizing alcohol to clean the exterior of the device. Do not use any oily or corrosive liquids to clean the device.



Facebook



Facebook  
Group



YouTube



Instagram

Please follow Phrozen's social media accounts and subscribe to our YouTube channel to learn more about printing tips and share ideas with one another. Feel free to contact us if you have any question

---

## Documents / Resources



[phrozen CURE BEAM Post Curing UV Light String](#) [pdf] User Manual  
CURE BEAM Post Curing UV Light String, CURE BEAM, Post Curing UV Light String, Curing U  
V Light String, Light String

## References

- [User Manual](#)

### Manuals+. [Privacy Policy](#)

This website is an independent publication and is neither affiliated with nor endorsed by any of the trademark owners. The "Bluetooth®" word mark and logos are registered trademarks owned by Bluetooth SIG, Inc. The "Wi-Fi®" word mark and logos are registered trademarks owned by the Wi-Fi Alliance. Any use of these marks on this website does not imply any affiliation with or endorsement.