



Phomemo D30 Label Maker Machine User Guide

[Home](#) » [Phomemo](#) » Phomemo D30 Label Maker Machine User Guide 

Contents

- [1 Phomemo D30 Label Maker Machine](#)
- [2 Item Checklist](#)
- [3 Specifications](#)
- [4 Product Introduction](#)
- [5 How to Use](#)
- [6 Identifying the Label Size](#)
- [7 FCC Caution](#)
- [8 Documents / Resources](#)
 - [8.1 References](#)
- [9 Related Posts](#)



Phomemo

Phomemo D30 Label Maker Machine



Item Checklist

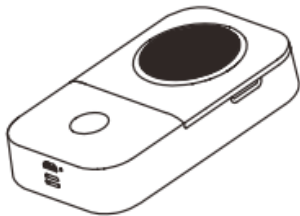

Label Maker*1



Instruction Manual*1

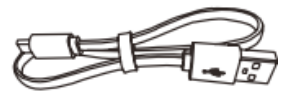

USB Cable*1

NOTE :The number of label rolls on the checklist is determined by the contents of the shipped package.

Specifications

Name	Smart Mini Label Maker
Model	D30
Technology	Thermal Printing
Width of label	12-15mm
Supported Consumables	Black mark thermal Label, Pre-cut Label, Continuous Label
Darkness	Light, Medium, High
Resolution	203dpi
Printhead Lifespan	50KM
Communication Port	Bluetooth
Product Dimensions	131.5*75.5*29mm (5.2*2.9*1.2inch)
Power Input	5V 2A
Power Supply	Micro USB
	Lithium Battery
OS Supported	Android
	iOS

Product Introduction

Parts and Features

1. Label Maker display Upper Cover

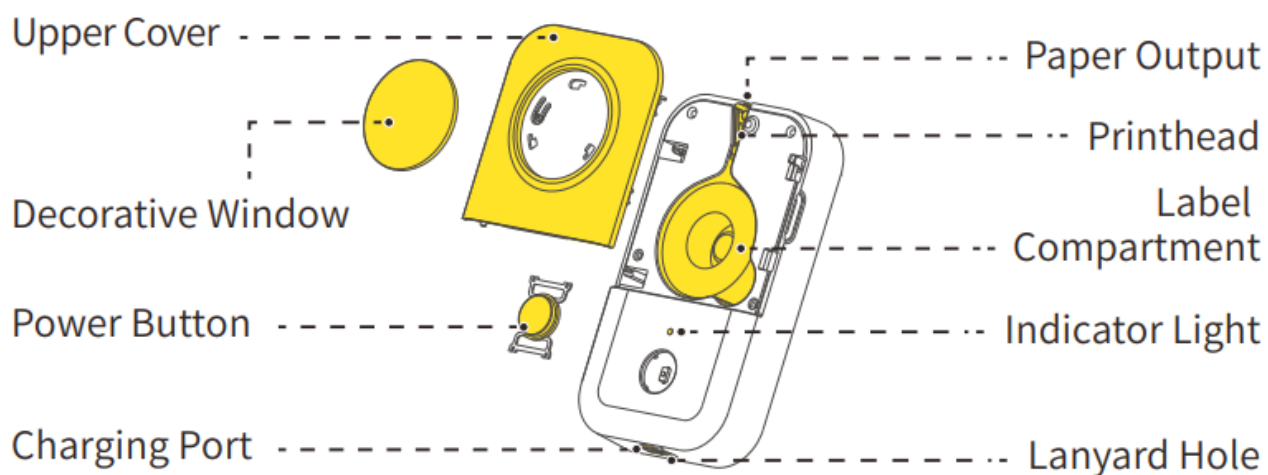

2. Features of Labels



Various labels are available for purchase

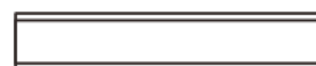

Features of Continuous Labels

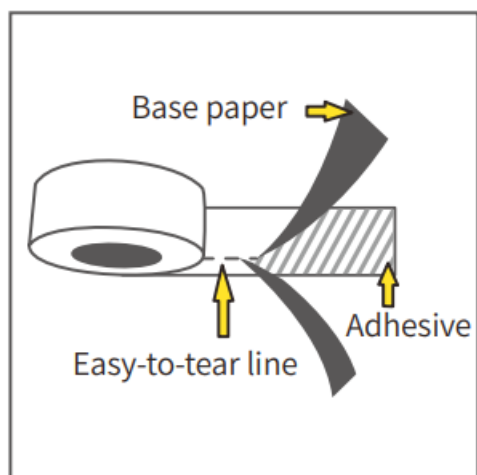
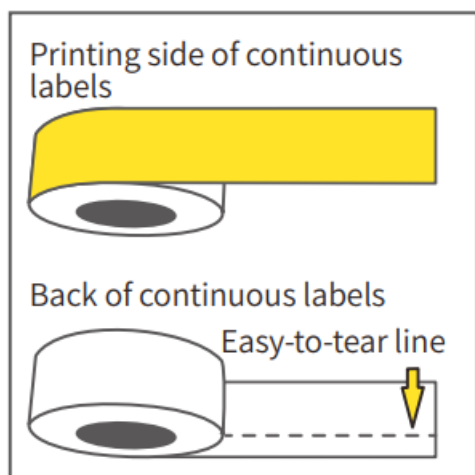



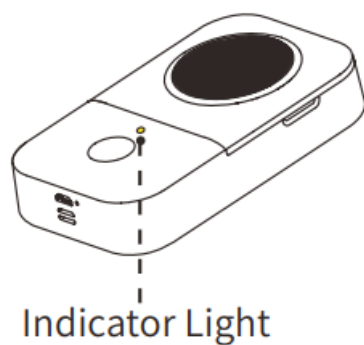



- Gently bend the label along the east-to-tear line to tear the base from the adhesive easily



Button	Operation	Functions
Power button	Hold for 3 seconds	Power on/off
	Press once	Output the label
	Press twice	Print diagnostic page

Indicator Light

 Green Light	Normal
 Blinking (slow) Green Light	Powered on & charging
 Blinking (fast) Green Light	Powered off & charging Error (No Paper, Cover is open,
 Red Light	Overheat)
 Blinking (slow) Red Light	10% Power left
 Blinking (fast) Red Light	5% Power left

How to Use

1. Open the label compartment.
2. Take out the label roll, tear the anti-loosening sticker.

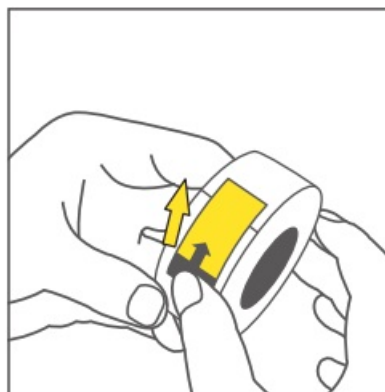
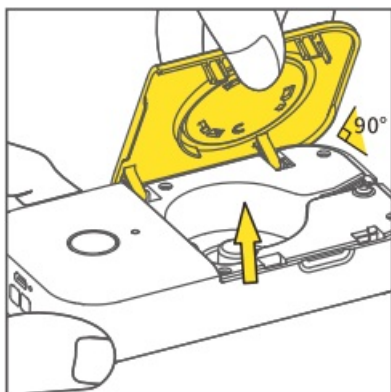

3. place the label roll into the label compartment with the printing side facing left.
4. Pull out 5 mm of the label of the Label Maker

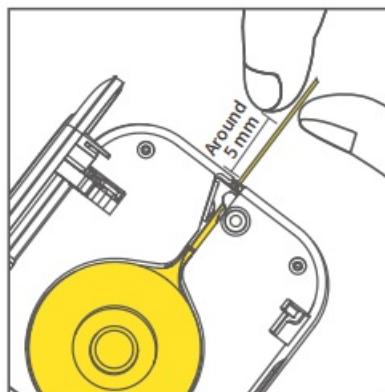
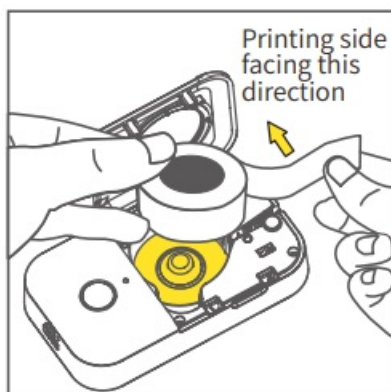

5. Close the cover.
6. Hold the power button for 3s to start the Label Maker

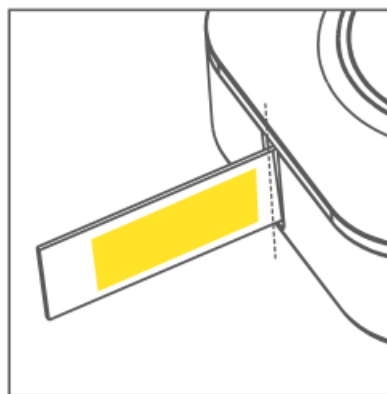
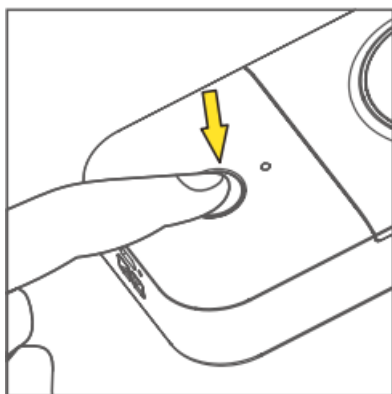

7. Press the power button once, and the Label Maker will start detecting the position of the label.01 Open the label compartment.

8. When the label comes out, the positioning of the label is complete.

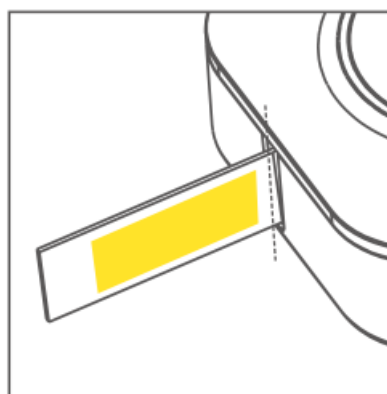
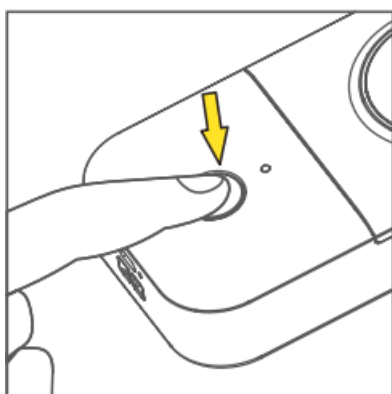

NOTE:

- After installing the label roll for the first time or replacing the label roll, remember to reposition the label (Step No. 7).
- If you do not reposition the label (Step No. 7), the first label you print will be printed incorrectly (missing contents, not aligning to the center, etc.).
- Continuous labels do not need repositioning. You only need to pull the label to the opening of the Label Maker.

Downloading the App



NOTE:

- You need to connect the Label Maker through the Print Master app.
- In compliance with Google's requirement, Android phones must enable GPS (Location Services) before using Bluetooth.

Method 1:

- Use your phone to scan the QR code to install the App.



Method 2:

- Search for "Print Master" in the app store on your phone to download the App.

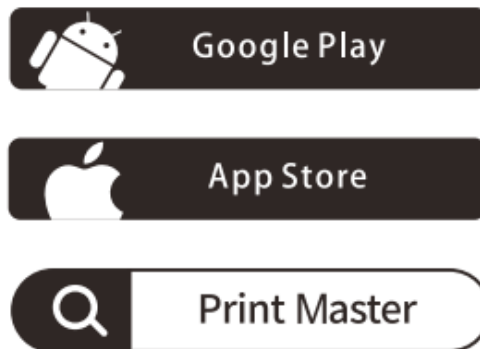

Connecting the Label Maker

1. Turn on GPS (Android phones only).
2. Open Print Master.

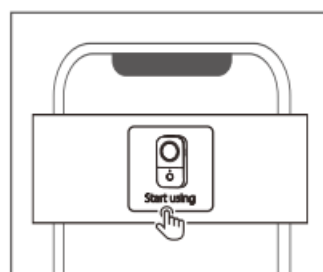
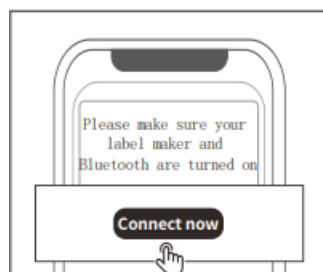

3. Tap the "Connect now" button to search for your device.
4. Press "Start using".

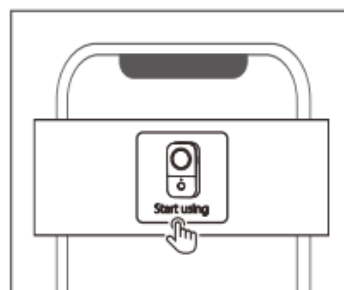

NOTE

- In compliance with Google's requirement, Android phones must enable GPS (Location Services) before using Bluetooth.
- Before connecting to your device in Print Master, please make sure your Label Maker is turned on and your phone's Bluetooth is on.

Identifying the Label Size

• Method 1:

Check the anti-loosening sticker. (The label size shown below is just an example. The size of the label roll you have may vary.)

• Method 2:

Check your label package

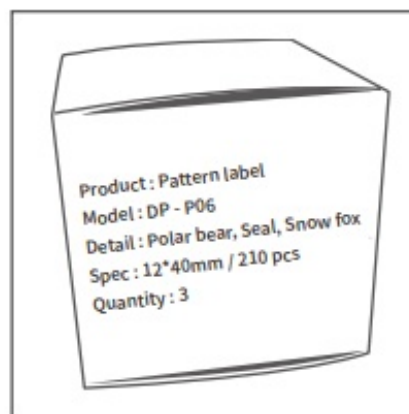
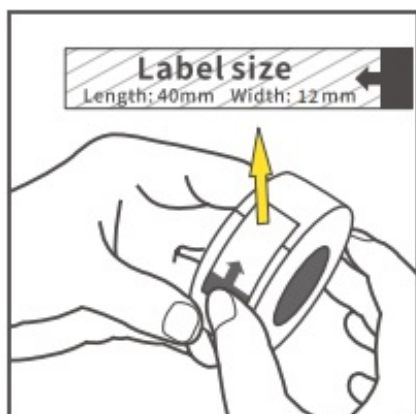

• Method 3:

Measure with a ruler.

• Method 4:

Check the tag on your label roll. (Label rolls are being updated, so the actual product you receive may vary.)

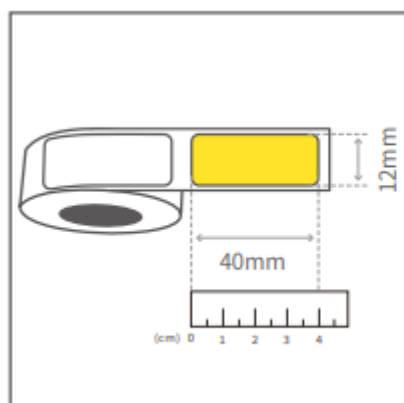

FCC Caution

This device complies with part 15 of the FCC Rules. Operation is subject to the following two conditions:

1. This device may not cause harmful interference, and
 2. This device must accept any interference received, including interference that may cause undesired operation.
- Any Changes or modifications not expressly approved by the party responsible for compliance could void the user's authority to operate the equipment.

Note:

- This equipment has been tested and found to comply with the limits for a Class B digital device, pursuant to part 15 of the FCC Rules. These limits are designed to provide reasonable protection against harmful interference in a residential installation. This equipment generates uses and can radiate radio frequency energy and, if not installed and used in accordance with the instructions, may cause harmful interference to radio communications. However, there is no guarantee that interference will not occur in a particular installation. If this equipment does cause harmful interference to radio or television reception, which can be determined by turning the equipment off and on, the user is encouraged to try to correct the interference by one or more of the following measures:
 - Reorient or relocate the receiving antenna.
 - Increase the separation between the equipment and receiver.
 - Connect the equipment into an outlet on a circuit different from that to which the receiver is connected.
 - Consult the dealer or an experienced radio/TV technician for help.

***RF warning for Portable device:**

- The device has been evaluated to meet general RF exposure requirement.
- The device can be used in portable exposure condition without restriction.

Documents / Resources

 <p>Instruction D30 Product Instruction</p>	<p>Phomemo D30 Label Maker Machine [pdf] User Guide D30, D30 Label Maker Machine, Label Maker Machine, D30 Maker Machine, Machine</p>
--	---

References

- [User Manual](#)