



OPERATING INSTRUCTIONS FOR DS2500E & GUARANTEE REGISTRATION

Contents [[hide](#)]

- [1 BATTERY INSTALLATION – 4 X LR03 AAA ALKALINE \(SUPPLIED\)](#)
- [2 DS2500 BASE FIXING INSTRUCTIONS](#)
- [3 CHOOSING A PLACE TO INSTALL YOUR SAFE](#)
- [4 DRILLING & BOLTING](#)
- [5 Documents / Resources](#)
 - [5.1 References](#)

BATTERY INSTALLATION – 4 X LR03 AAA ALKALINE (SUPPLIED)

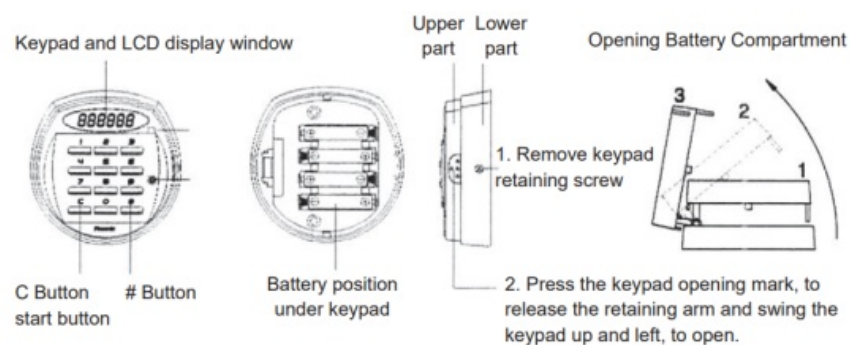

1. FIRST OPENING ON FACTORY DEFAULT CODE

Step 1 Press 'C' button

Step 2 Press factory code ' 1 2 3 4 5 6 '

Step 3 Press '#', a melodic tone will sound and the display confirms OPEnd

Step 4 Turn Knob or Handle clockwise and open the door while the tone is sounding

Caution

If an incorrect code is entered, Error will appear in the display panel and a short warning tone will sound. If an incorrect code is entered five times the lock will cease to operate for five minutes, a warning tone will sound and the display will indicate dELAY.

C > 1 > 2 > 3 > 4 > 5 > 6 > #

2. SETTING A NEW PERSONAL CODE.

It is advisable to set a new code with the door open and test the new code before closing the door.

Step 1 Press '#' button

Step 2 Enter the Present Code.

Step 3 Press '#' button.

Step 4 Enter New 4~16 digit Code.

Step 5 Press '#' button.

For Example:

If the present code is 1 2 3 4 5 6 and a new four digit code is decided as 4 2 4 2 press buttons as below. # 1 2 3 4 5 6 # 4 2 4 2 #

EnTErd will be indicated in the display and a short 3 second tone will sound to confirm the change to 4 2 4 2 # > 1 2 3 4 5 6 > # > 4 2 4 2 > #

3. SETTING THE DUAL CONTROL FUNCTION WHERE TWO OPERATORS WITH INDIVIDUAL PERSONAL CODES ARE REQUIRED TO OPEN THE LOCK.

With the door in the open position set the second code.

Step 1 Press the "M" memory button recessed into the back of the door.

Step 2 Press '2' button

Step 3 Press '#' button

Step 4 Enter 2nd Personal code

Step 5 Press '#' button

EnTErd will be indicated in the display and a short 3 second tone will sound, to confirm the 2nd code entry.

For Example:

If the present code is 4 2 4 2 and a second new four digit code is decided as 6 7 8 9 press buttons as below. EnTErd will appear in the display accompanied by a short tone to confirm

M 2 # 6 7 8 9 # M > 2 > # > 6 7 8 9 > #

4. TO ACTIVATE DUAL CONTROL

Step 1 Press the “M” memory button recessed into the back of the door.

Step 2 Press ‘9’ button

Step 3 Press ‘#’ button

M > 9 > #

5. TO OPERATE WITH THE DUAL CONTROL FUNCTION

Step 1 Press C button dual will appear in the display.

Step 2 Enter the first code 4 2 4 2

Step3 Press‘#’button a short 3 second tone will sound to confirm correct code

Step 4 Within 5 minutes enter the second code 6 7 8 9

Step5 Press‘#’button a short 3 second tone will sound to confirm correct code and OPEnD will appear in the display and the lock will be open. Either code can be entered first or second.

C > 4 2 4 2 > # > 6 7 8 9 > #

6. TO DEACTIVATE DUAL CONTROL

Step 1 Press the “M” memory button recessed into the back of the door.

Step 2 Press ‘9’ button

Step 3 Press ‘#’ button a short 3 second tone will sound to confirm deactivation and SinGLE will appear in the display. The second code will be automatically erased.

M > 9 > #

7. TO HIDE CODE IN THE DISPLAY AND TURNOFF KEYPAD SOUND.

Activate Press the “M” memory button recessed into the back of the door, press 7 then # (HIdE appears in the display) Deactivate Press the “M” memory button recessed into the back of the door, press 7 then

M > 7 >

8. TO HIDE CODE ENTRY IN A NUMBER SEQUENCE.

The code can be disguised by inserting random numbers either before, after or both before and after, the personal code. This procedure is designed to increase security and to confuse a potential observer attempting to memorise the code. This feature can be also be used with hidden code display and silent keypad as at 7 above.

For Example

Personal code is set as 4 2 4 2 Random prefix numbers 61 Random suffix numbers 91507

Step 1 Press C button

Step 2 Enter Code as 61 4 2 4 2 91507

Step 3 Press '#' button The display will confirm OPend

C > 61 4 2 4 2 91507 > #

9. ALARM SETTING

Activate Press the "M" memory button recessed into the back of the door, press 8 then # (ALErT appears in the display)

M > 8 > #

Deactivate

Step 1 Press 'C' button

Step 2 Enter Personal Code

Step3 Press'#' button a short 3second tone will sound to confirm deactivation and OPend will appear in the display.

C > Personal Code > #

10. BATTERY LIFE: 1 YEAR 3 TIMES A DAY. BATTERY REPLACEMENT IS REQUIRED WHEN:

1. LObAtt appears in display accompanied by a short one second warning tone.
2. Correct code is entered but lock will not open.
3. Even if batteries are completely exhausted, the codes are not lost.

11. BATTERIES

4 x 1.5 V AAA Alkaline Batteries are required to activate the lock. Used batteries should not be disposed of with normal domestic waste. These should be disposed of at approved collection points. You may also return used batteries to your Retailer at their expense (where applicable).

DS2500 BASE FIXING INSTRUCTIONS

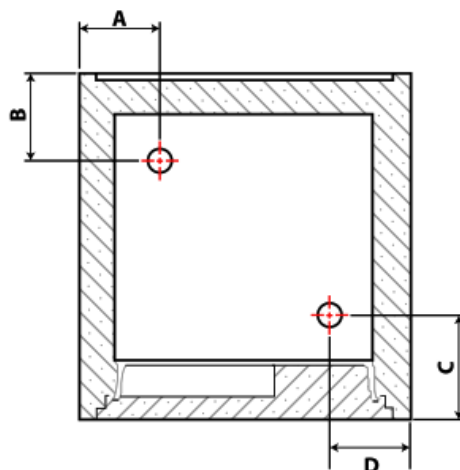

MODEL	A	B	C	D
DS2501	123	143	149	131
DS2502	123	143	149	131
DS2503	180	180	220	180

CHOOSING A PLACE TO INSTALL YOUR SAFE

1. Look for a place that does not restrict access and the swing of the door.
2. Ensure that the floor is level.
3. For best results a concrete floor is preferable.

DRILLING & BOLTING

1. Manoeuvre the safe into the required position. Now with the pencil mark the floor around the safe.
2. Open the safe door.
3. Using the pencil, mark the positions on the floor for drilling through holes in the base of the safe.
4. Now move the safe to one side, giving you access to the markings on the floor.
5. Before using the drill bit. With the ruler measure 60mm from the tip of the bit and put a piece of adhesive tape around the bit to ensure you do not drill too deep.
6. Drill the 12mm holes in the floor until you reach your 60mm marker.
7. Clean the floor around the holes.
8. There are three parts to your bolts:
 - a. A coach screw
 - b. A plastic expanding sleeve
 - c. A steel washer
9. Insert the plastic expanding sleeves into the drilled holes.
10. Place the safe back into position, insert the coach screws, including the washers, through the base of the safe, into the floor and tighten until you can not tighten them any further.

YOUR SAFE IS NOW BASE FIXED.

SECURING THE DATABOX INTO THE SAFE

Using the 2 adhesive strips provided, attach these to the back of the Databox. Position the box into the bottom of the safe, affixing it to the back wall.

Phoenix Safe Company where peace mind is guaranteed

GUARANTEE REGISTRATION

Please submit your guarantee registration by visiting our website

www.phoenixsafe.com and clicking on guarantee registration.

For further assistance or information please contact us on 0151 944 6444.

APEX HOUSE, 1 ORRELL MOUNT, LIVERPOOL, L20 6NS,

UNITED KINGDOM | +44 (0)151 944 6444



V1/PB MAY 2018

Documents / Resources

	<p>Phoenix DS2500E Data Safe with Fingerprint Lock [pdf] Instruction Manual</p> <p>DS2500E, DS2500E Data Safe With Fingerprint Lock, DS2500E, Data Safe With Fingerprint Lock, Fingerprint Lock, Lock</p>
---	---

References

- [User Manual](#)

Phoenix

Data Safe With Fingerprint Lock, DS2500E, DS2500E Data Safe With Fingerprint Lock, Fingerprint Lock, Lock, Phoenix

Leave a comment

Your email address will not be published. Required fields are marked *

Comment *

Name

Email

Website

☐ Save my name, email, and website in this browser for the next time I comment.

Post Comment

Search:

e.g. whirlpool wrf535swhz

Search

[Manuals+](#) | [Upload](#) | [Deep Search](#) | [Privacy Policy](#) | [@manuals.plus](#) | [YouTube](#)

This website is an independent publication and is neither affiliated with nor endorsed by any of the trademark owners. The "Bluetooth®" word mark and logos are registered trademarks owned by Bluetooth SIG, Inc. The "Wi-Fi®" word mark and logos are registered trademarks owned by the Wi-Fi Alliance. Any use of these marks on this website does not imply any affiliation with or endorsement.