

[Home](#) » [PHOENIX CONTACT](#) » **PHOENIX CONTACT UM-BEFE 35 Base Element Instruction**

**Manual** 



**UM-BEFE 35 – Base element**

**2955564**

<https://www.phoenixcontact.com/us/products/2955564>



## **Contents** [ [hide](#) ]

- [1 UM-BEFE 35 Base Element](#)
- [2 Commercial data](#)
- [3 Technical data](#)
- [4 Drawings](#)
- [5 Classifications](#)
- [6 Environmental product compliance](#)
- [7 Documents / Resources](#)
  - [7.1 References](#)

## **UM-BEFE 35 Base Element**

Please be informed that the data shown in this PDF document is generated from our online catalog. Please find the complete data in the user documentation. Our general terms of use for downloads are valid.

Base element with snap-on foot, for mounting on NS 32 or NS 35/7.5 DIN rail, with ribs,  
L = 35 mm

## Commercial data

Item number	2955564
Packing unit	10 pc
Minimum order quantity	10 pc
Sales key	AC13
Product key	ACHDDA
GTIN	4017918085537
Weight per piece (including packing)	21.18 g
Weight per piece (excluding packing)	21.18 g
Customs tariff number	85389099
Country of origin	PL

## Technical data

### Product properties

Product type	Component housing lower part
Housing type	Press-drawn section housings
Housing series	UM
Product family	UM BE

Type	Plug-in module base element
Ventilation openings present	no

## Dimensions

Dimensional drawing	
Width	35 mm
Height	111 mm
Depth	27.7 mm

## Material specifications

Color (Housing)	green (RAL 6021)
Housing material	PA
Surface characteristics	untreated

## Environmental and real-life conditions

### Ambient conditions

Ambient temperature (operation)	-40 °C ... 105 °C (depending on power dissipation)
Ambient temperature (storage/transport)	-40 °C ... 55 °C
Ambient temperature (assembly)	-5 °C ... 100 °C
Relative humidity (storage/transport)	80 %

## Mounting

Mounting type	DIN rail mounting
---------------	-------------------

## Drawings

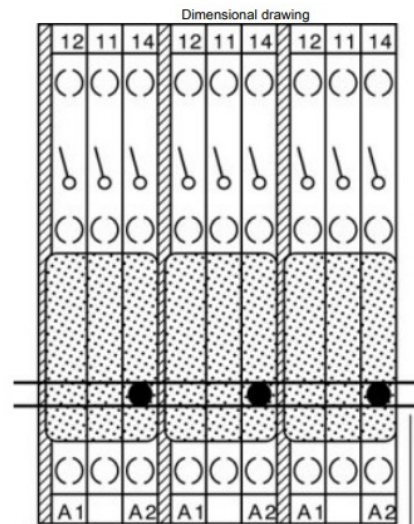

1 - 3

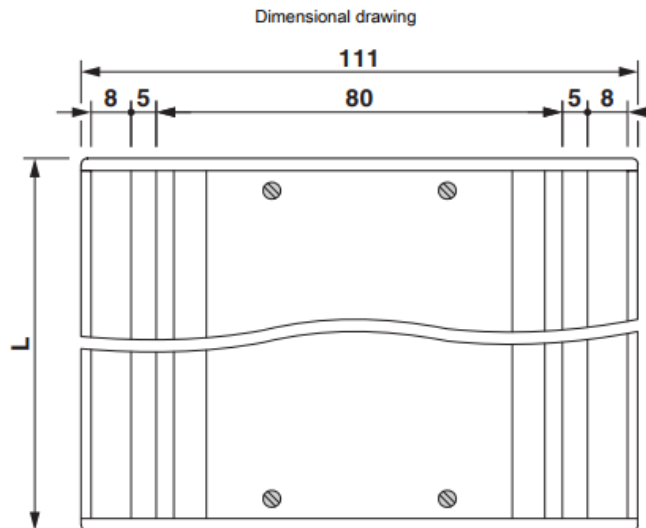

## Approvals

💡 To download certificates, visit the product detail page:

<https://www.phoenixcontact.com/us/products/2955564>



UL Recognized

Approval ID: E240868

## Classifications

## ECLASS

ECLASS-13.0	27190601
ECLASS-15.0	27190601

## ETIM

ETIM 9.0	EC002779
----------	----------

## UNSPSC

UNSPSC 21.0	31261500
-------------	----------

## Environmental product compliance

### EU RoHS

Fulfills EU RoHS substance requirements	Yes, No exemptions
---	--------------------

### China RoHS

Environment friendly use period (EFUP)	EFUP-E
	No hazardous substances above the limits

### EU REACH SVHC

REACH candidate substance (CAS No.)	No substance above 0.1 wt%
-------------------------------------	----------------------------

Phoenix Contact USA  
586 Fulling Mill Road  
Middletown, PA 17057, United States  
(+717) 944-1300  
[info@phoenixcon.com](mailto:info@phoenixcon.com)

## Documents / Resources

	<p><a href="#">PHOENIX CONTACT UM-BEFE 35 Base Element [pdf]</a> Instruction Manual</p> <p>UM-BEFE 35 Base Element, UM-BEFE 35, Base Element, Element</p>
---	---

## References

- [User Manual](#)

PHOENIX  
CONTACT

Base Element, Element, PHOENIX CONTACT, UM-BEFE 35, UM-BEFE 35 Base Element

---

## Leave a comment

Your email address will not be published. Required fields are marked \*

Comment \*

Name

Email

---

Website

☐ Save my name, email, and website in this browser for the next time I comment.

**Post Comment**

**Search:**

**Search**

[Manuals+](#) | [Upload](#) | [Deep Search](#) | [Privacy Policy](#) | [@manuals.plus](#) | [YouTube](#)

This website is an independent publication and is neither affiliated with nor endorsed by any of the trademark owners. The "Bluetooth®" word mark and logos are registered trademarks owned by Bluetooth SIG, Inc. The "Wi-Fi®" word mark and logos are registered trademarks owned by the Wi-Fi Alliance. Any use of these marks on this website does not imply any affiliation with or endorsement.