



PHOEBUS LINK LX-90T Car Intelligent Conversion Box User Manual

[Home](#) » [PHOEBUS LINK](#) » PHOEBUS LINK LX-90T Car Intelligent Conversion Box User Manual 

PHOEBUS LINK LX-90T Car Intelligent Conversion Box



Contents

- [1 Product introduction](#)
- [2 Products Host & Accessories](#)
- [3 Product Instructions](#)
- [4 Frequently Asked Questions](#)
- [5 FCC Statement](#)
- [6 IC STATEMENT](#)
- [7 Documents / Resources](#)
- [8 Related Posts](#)

Product introduction

Phoebe Link car intelligent conversion box, mainly used for realizing the interconnection of mobile phone and car.

The conversion function integrates the mobile phone and the car screen, which will convert the diversified Mobile phones to car entertainment, providing users with music & abundant driving pleasure; reducing the frequency of using the mobile phone, providing users with a safer driving Car experience.

Products Host & Accessories



Phoebus Link



TYPEC Cable
(30 CM)

Product Instructions

1. Connect the box to the original car USB Data interface; Press the ' APP' button or Enter to the Carplay page;
Read box data and wait for a connection



2. Turn on the Bluetooth of the iPhone, search for the Bluetooth Device naming: "smart Box-****". Pair it and allow the Sync, finally click "Use Carplay"

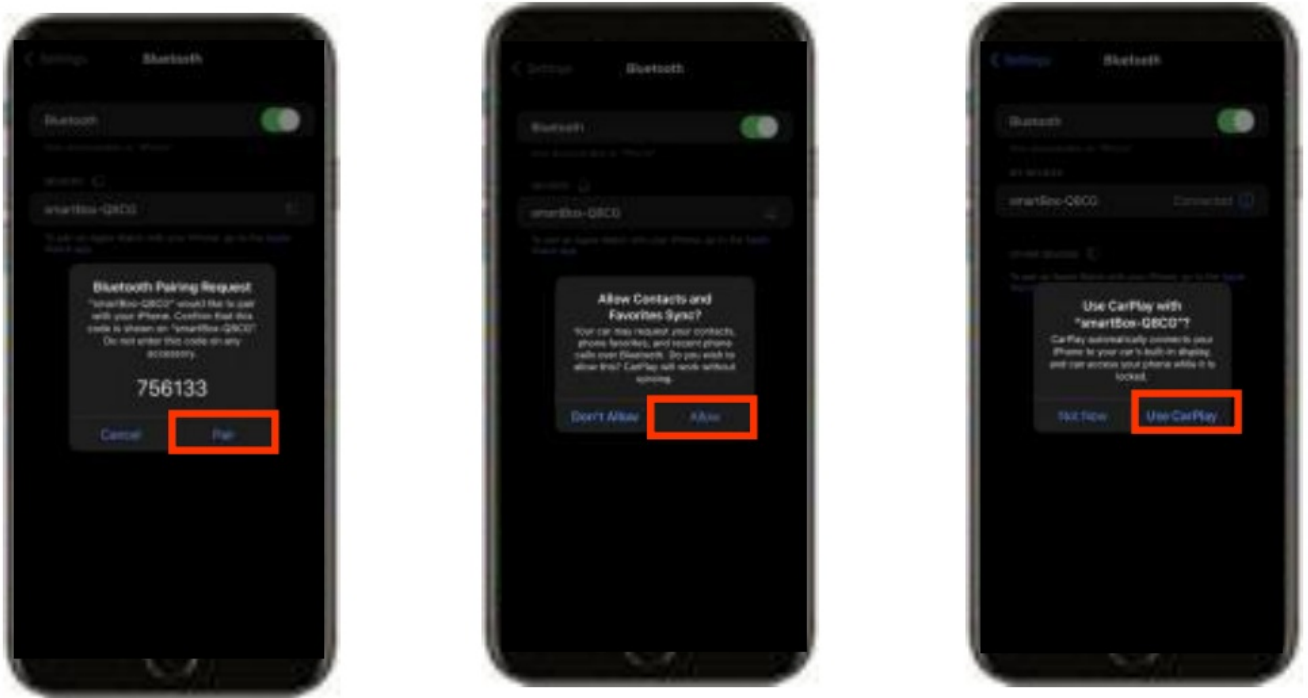

3. After the connection, please wait for a few seconds and Carplay interface will be shown



Frequently Asked Questions

1. How to update the product

The wireless Car Play adapter needs to be removed to a USB power adapter; join the WIFI devices naming 'smart Box-xxxx' on your iPhone with password: 888888888; Enter the IP Address 192.168.1.101 in your Safari Browser, and press 'click me to upgrade'; wait for a few minutes for upgrade.

Note: Please forget the 'smart Box-xxxx' Networks after upgrading successfully.

19:37 4G

System Version

Build Number 22011515.1334.1

Choose Headunit

Unit Type Default (For Most CarPlay Units) >

Problem Description

Car Make E.g. Toyota

Model Name E.g. Camry XLE

Year E.g. 2020

Detailed description of the problem:

Please enter text here

Submit

Online Update

Enter the web settings Page
There will be an upgrade prompt

Copyright © 2020 - 2021

192.168.1.101

19:38 4G

System Version

Build Number 22011515.1334.1

Choose Headunit

Unit Type Default (For Most CarPlay Units) >

Problem Description

Car Make E.g. Toyota

Model Name E.g. Camry XLE

Year E.g. 2020

Detailed description of the problem:

Please enter text here

OK

Default (For Most CarPlay Units)

Ford SYNC 2.0 Specific

For Ford SYNC 2.0 car unit,
please switch the Unit Type.

192.168.1.101

Note: When upgrading the box, please connect the USB data cable to the car charger port. Do not connect the box to the USB data port of the original car for upgrading.



2. Does the Car Play adapter fit my iPhone 11

? Yes, the wireless Car Play Adapter works every iPhone from the 6s(iOS 12.1) all the way up to the 13 Pro max(iOS 15 software version).

3. Do I have to sync the wireless Car Play adapter every time when starting my car?

Don't worry, After the first adaptation, the wireless Car Play adapter will automatically match the Bluetooth and WiFi of your iPhone every time.

4. How to upload the log data when the adapter doesn't work for my car unit?

Please enter the IP address Page & fill in the car info in the Problem Description sheet, and press 'Submit' to upload your log data.

Problem Description

Car Make E.g. Toyota

Model Name E.g. Camry XLE

Year E.g. 2020

Detailed description of the problem:

Please enter text here

Submit

FCC Statement

This device complies with part 15 of the FCC Rules. Operation is subject to the following two conditions: (1) this device may not cause harmful interference, and (2) this device must accept any interference received, including interference that may cause undesired operation.

Any changes or modifications not expressly approved by the party responsible for compliance could void the user's authority to operate the equipment.

NOTE: This equipment has been tested and found to comply with the limits for a Class B digital device, pursuant to Part 15 of the FCC Rules. These limits are designed to provide reasonable protection against harmful interference in a residential installation. This equipment generates, uses and can radiate radio frequency energy and, if not installed and used in accordance with the instructions, may cause harmful interference to radio communications.

However, there is no guarantee that interference will not occur in a particular installation. If this equipment does cause harmful interference to radio or television reception, which can be determined by turning the equipment off and on, the user is encouraged to try to correct the interference by one or more of the following measures:

- Reorient or relocate the receiving antenna.
- Increase the separation between the equipment and receiver.
- Connect the equipment into an outlet on a circuit different from that to which the receiver is connected.
- Consult the dealer or an experienced radio/TV technician for help.

To maintain compliance with FCC's RF Exposure guidelines, This equipment should be installed and operated with minimum 20cm distance between the radiator and your body: Use only the supplied antenna.

IC STATEMENT

This device complies with Industry Canada license-exempt RSS standard(s).

Operation is subject to the following two conditions:

(1) This device may not cause interference, and

(2) This device must accept any interference, including interference that may cause undesired operation of the device.

To maintain compliance with RSS-102 RF Exposure guidelines, This equipment should be installed and operated with minimum 20cm distance between the radiator and your body: Use only the supplied antenna.

Documents / Resources

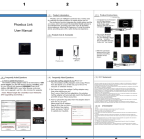
	<p>PHOEBUS LINK LX-90T Car Intelligent Conversion Box [pdf] User Manual PL8, 2A9BZ-PL8, 2A9BZPL8, LX-90T, Car Intelligent Conversion Box, Conversion Box, Car Intelligent Box, Box</p>
---	--