



PHILIPS S Line 191S8/201S8 LCD Monitor User Guide

[Home](#) » [Philips](#) » PHILIPS S Line 191S8/201S8 LCD Monitor User Guide 

Contents

- [1 PHILIPS S Line 191S8/201S8 LCD Monitor](#)
- [2 What In The Box](#)
- [3 Stand Fitting](#)
- [4 Ports](#)
- [5 Features](#)
- [6 Documents / Resources](#)
 - [6.1 References](#)
- [7 Related Posts](#)

PHILIPS

PHILIPS S Line 191S8/201S8 LCD Monitor



What In The Box

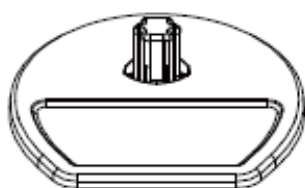
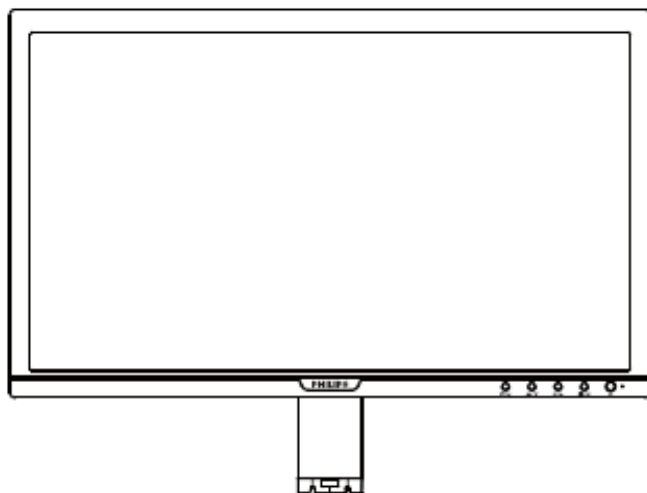

Power

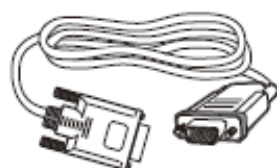

* VGA

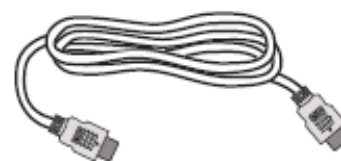

* HDMI

Different according to region

Display design may differ from those illustrated.

Stand Fitting

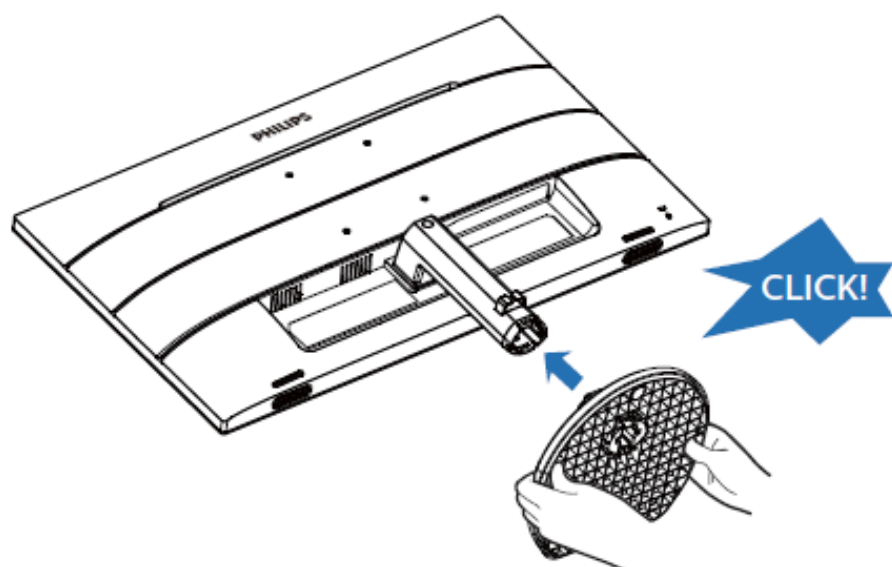

Ports

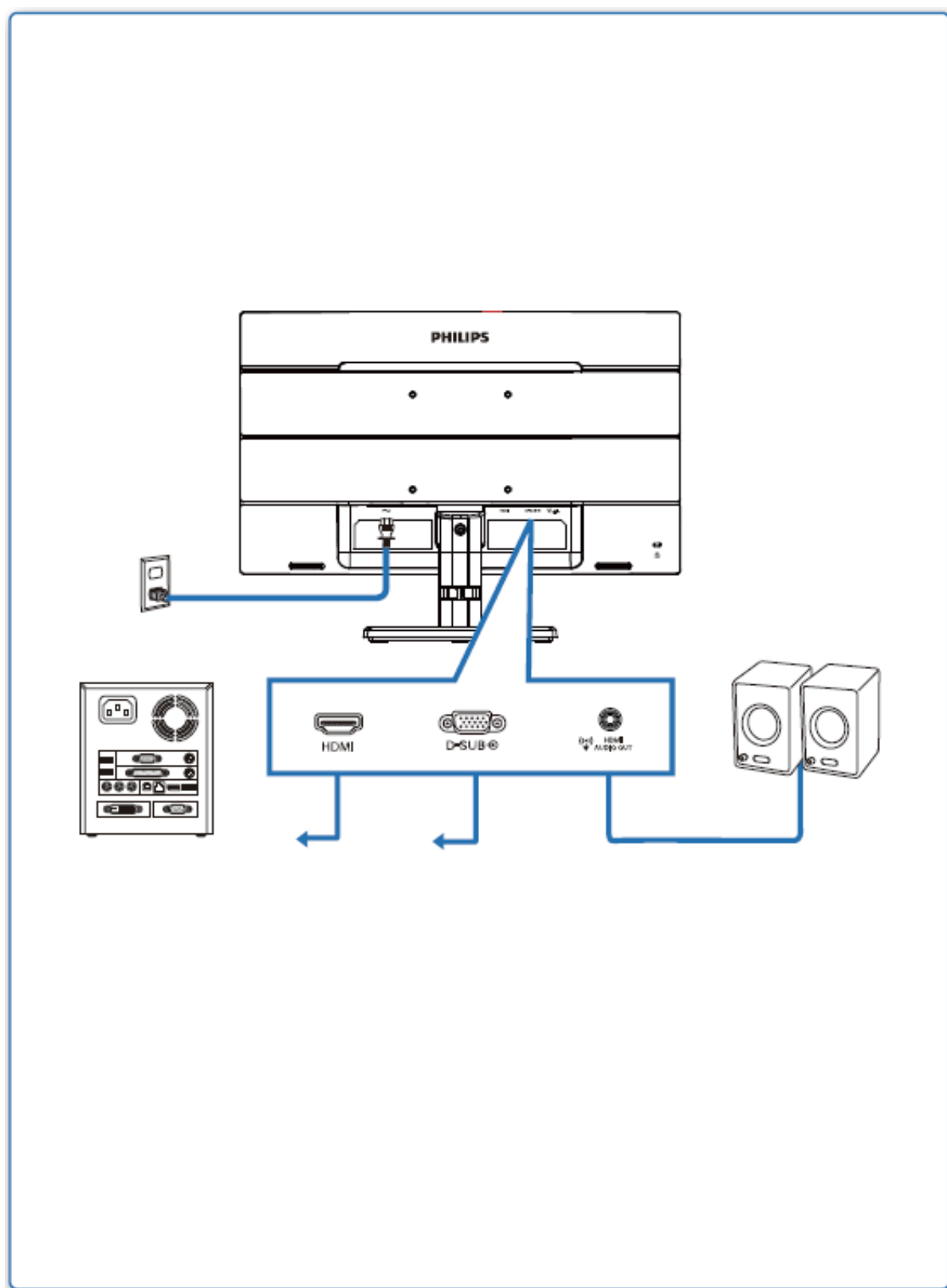

Features

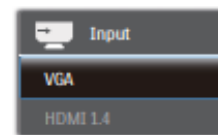
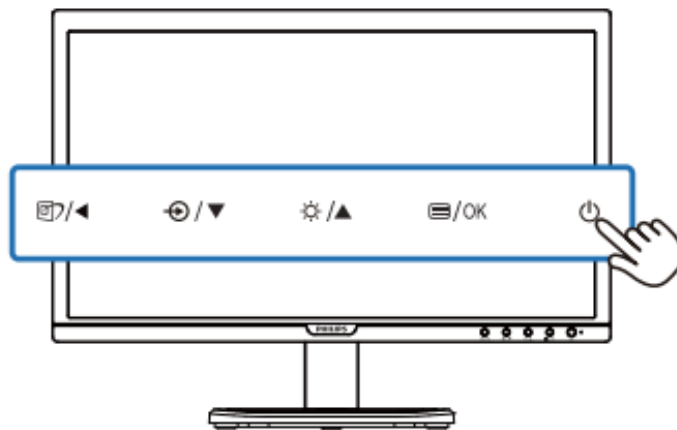

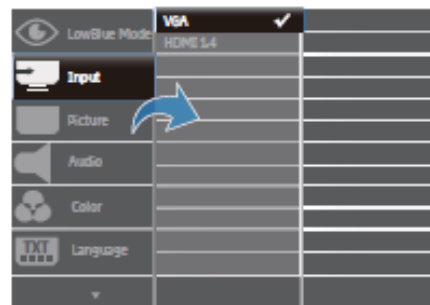

Version: M8191201SQ1T

© 2018 Koninklijke Philips N.V. All rights reserved.

This product was manufactured and brought to the market by or on behalf of Top Victory Investments Ltd. or one of its affiliates. Top Victory Investments Ltd. is the warrantor in relation to this product. Philips and the Philips Shield Emblem have registered trademarks of Koninklijke Philips N.V. used under license.

Specifications are subject to change without notice. The terms HDMI, HDMI High-Definition Multimedia Interface, and the HDMI Logo are trademarks or registered trademarks of HDMI Licensing Administrator, Inc.

www.philips.com.

Register your product and get support at www.philips.com/support.



FAQ



Software
SmartControl



User
Manual

Documents / Resources

	<p>PHILIPS S Line 191S8/201S8 LCD Monitor [pdf] User Guide</p> <p>S Line 191S8 201S8 LCD Monitor, S Line 191S8 201S8, LCD Monitor, Monitor, LCD</p>
--	---

References

- [Philips - United States | Philips](#)
- [Philips Customer Service Support - Home | Philips](#)
- [Product registration | Philips](#)

[Manuals+](#).