



**RC065B,
RC066B
Ledinaire
Panel**



PHILIPS RC065B, RC066B Ledinaire Panel User Manual

[Home](#) » [Philips](#) » PHILIPS RC065B, RC066B Ledinaire Panel User Manual 

Contents

- [1 PHILIPS RC065B, RC066B Ledinaire Panel](#)
- [2 Product Information](#)
- [3 Product Usage Instructions](#)
- [4 What's In The Box](#)
- [5 Specifications](#)
- [6 Dimension](#)
- [7 Available as accessory](#)
- [8 INSTALLATION](#)
- [9 Disconnect before servicing](#)
- [10 SR compatibility](#)
- [11 WEEE Statement](#)
- [12 Documents / Resources](#)
 - [12.1 References](#)



PHILIPS RC065B, RC066B Ledinaire Panel



Product Information

Specifications:

- **Model:** Ledinaire Panel RC065B/RC066B
- **Lumen Output:** 3400 lm
- **Life Expectancy:** 50,000 – 75,000 hours
- **Power Consumption:** 28.0W
- **Color Temperature:** 4000K
- **Dimensions:** 595x595x35 mm (RC065B) / 620x620x35 mm (RC066B)
- **Weight:** 1.65 kg (RC065B) / 1.75 kg (RC066B)
- **Safety Features:** Safety cable included

Product Usage Instructions

- **Installation:**
 1. Ensure the luminaire is not covered with thermal insulation or similar material.
 2. Use the provided safety cable for secure installation.
 3. Mount the panel using the Lay-In mounting method.
- **Color Temperature Adjustment:**

Use the multi-color switch to set your preferred color temperature between 3000K, 3500K, or 4000K.
- **Maintenance:**

Regularly clean the panel with a soft, dry cloth to maintain optimal performance.

FAQ:

- **Q: Can I purchase additional accessories for the product?**

A: Yes, you can purchase accessories like suspension sets and safety cables separately using the provided codes.
- **Q: What is the default color temperature setting?**

A: The default color temperature setting is 4000K.

This product contains a light source of energy efficiency class: D

The light source and/or control gear and/or the external flexible cable contained in this luminaire shall only be replaced by the manufacturer or his service agent or a similarly qualified person.

What's In The Box

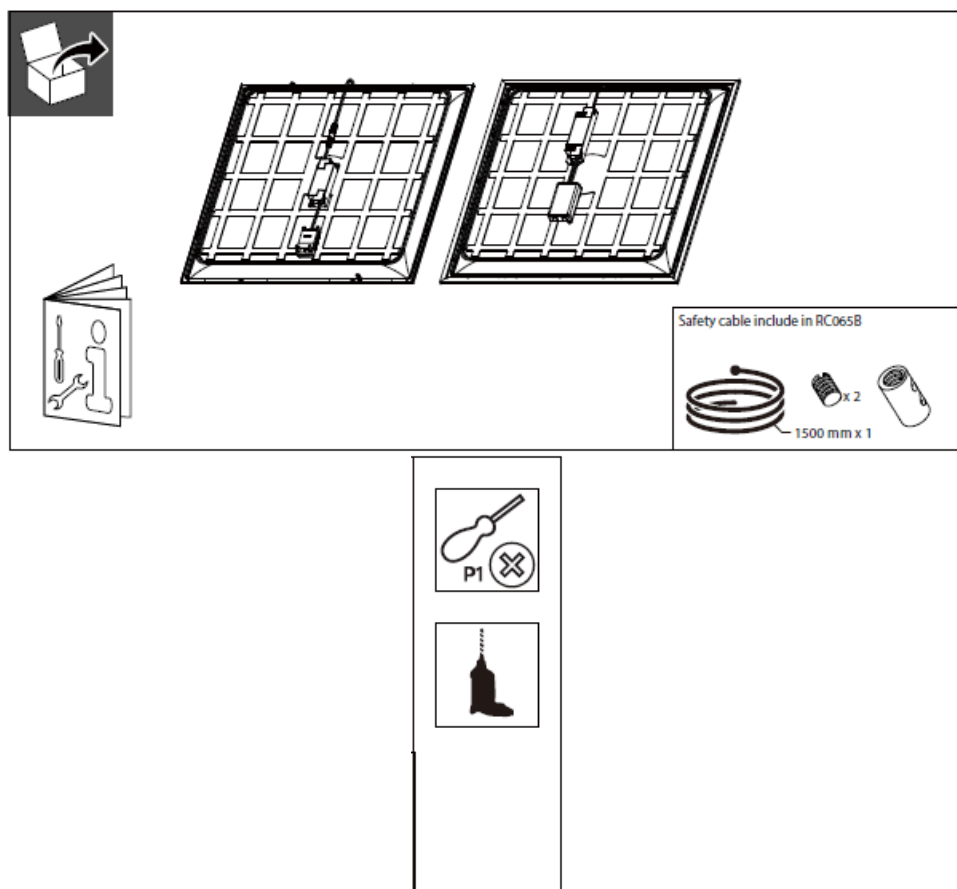

Specifications



| | Lumen (lm) | CCT (K) | P (W) IK Energy efficiency class of light source L×W×H  Safety cable (SC) in the box (mm) | | | | | | |
|--|-------------------|------------------------|---|----|---|-------------|------|-----|--|
| RC065B G5 34S/840 PSU W60L60 OC SC | 3400 | 4000 | 28.0 | 02 | D | 595x595x35 | 1.65 | Yes | |
| RC065B G5 34S/840 PSU W60L60 NOC SC | 3400 | 4000 | 28.0 | 02 | D | 595x595x34 | 1.35 | Yes | |
| RC065B G5 34S/840 PSD W60L60 OC SC | 3400 | 4000 | 28.0 | 02 | D | 595x595x35 | 1.65 | Yes | |
| RC066B 34S/840 PSU W62L62 OC | 3400 | 4000 | 28.0 | 02 | D | 620x620x35 | 1.75 | No | |
| RC066B 34S/840 PSD W62L62 OC | 3400 | 4000 | 28.0 | 02 | D | 620x620x35 | 1.75 | No | |
| RC065B G5 34S/840 PSU W60L60 OC 6PK SC | 3400 | 4000 | 28.0 | 02 | D | 595x595x35 | 1.65 | Yes | |
| RC066B 34_36S/830_40 PSU W62L62 OC | 3400/ 3600 | 3000/3500/ 4000 | 30.0 | 02 | D | 620x620x35 | 1.75 | No | |
| RC065B G5 34_36S/830_40 PSU W60L60 OC SC | 3400/ 3600 | 3000/3500/ 4000 | 30.0 | 02 | D | 595x595x35 | 1.65 | Yes | |
| RC065B G5 34_36S/830_40 PSU 60×60 NOC SC | 3400/ 3600 | 3000/3500/ 4000 | 30.0 | 02 | D | 595x595x34 | 1.35 | Yes | |
| RC065B G5 34_36S/830_40 PSD W60L60 OC SC | 3400/ 3600 | 3000/3500/ 4000 | 28.0 | 02 | D | 595x595x35 | 1.65 | Yes | |
| RC065B G5 34_36S/830_40 PSU 30×120 OC SC | 3400/ 3600 | 3000/3500/ 4000 | 30.0 | 02 | D | 295x1195x35 | 1.75 | Yes | |
| RC065B G5 34_36S/830_40 PSD 60×60 NOC SC | 3400/ 3600 | 3000/3500/ 4000 | 28.0 | 02 | D | 595x595x35 | 1.35 | Yes | |
| * Default setting: 3000/3500K/ 4000K * Product power included driver | | | | | | | | | |

Dimension

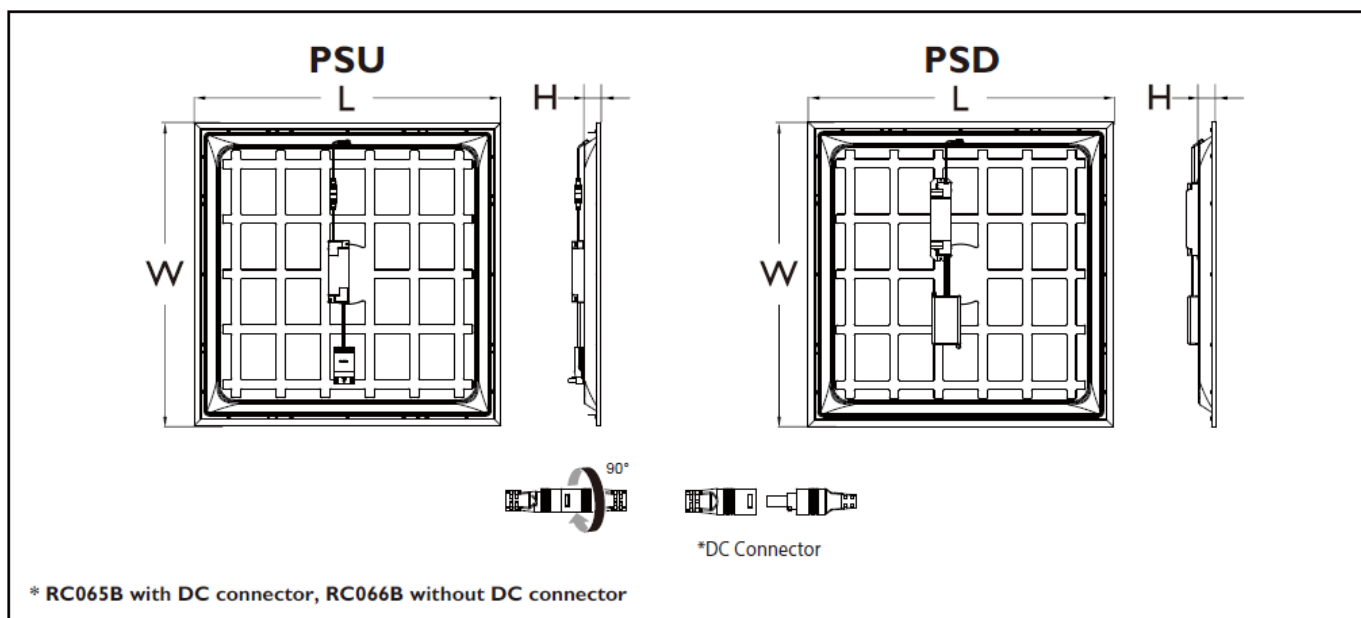

Available as accessory

Available as accessory (Need to purchase separately)

Suspension set:

- 911401809487: RC159Z Suspension set SME-3 WH
- 911401809387: RC159Z Suspension set SME-4 WH

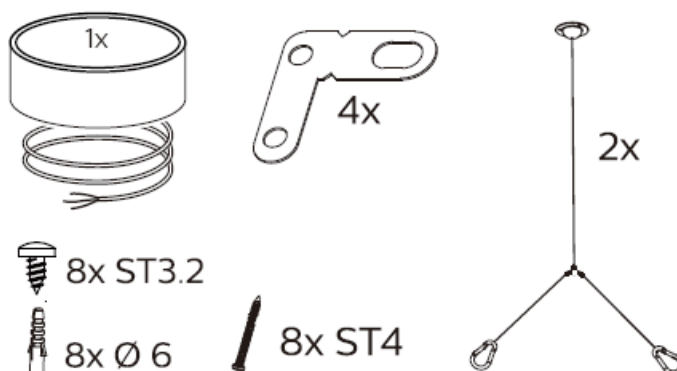

Plaster set:

- 911401809287:
RC159Z Plaster Ceiling SMB-PLC

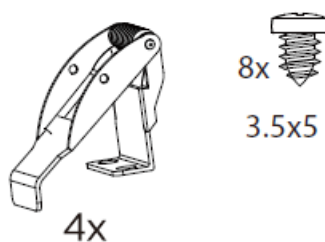

Safety cable:

911401809187: RC159Z Safety Cable

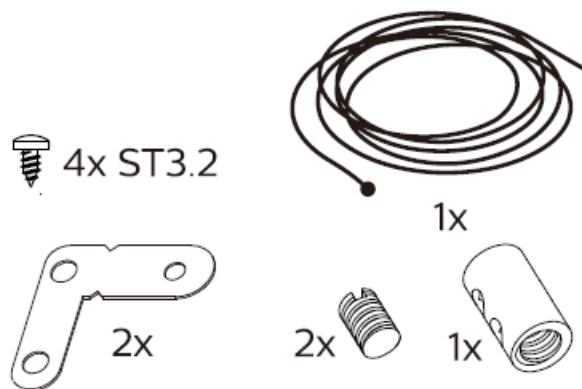

Surface mounted set:

- 911401808087:RC059Z SMB W60L60
- 911401808187:RC059Z SMB W62L62
- 911401808287:RC059Z SMB W30L120

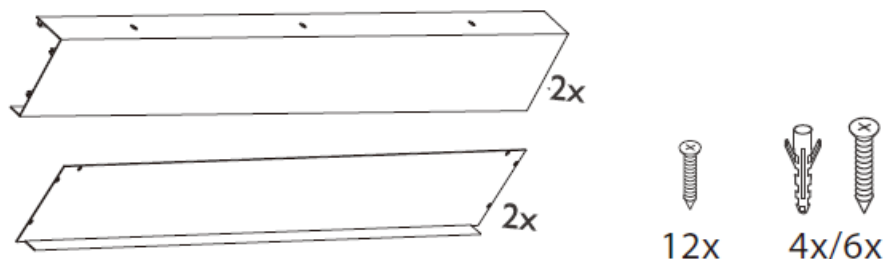

Surface mounted set:

- 911401807787:RC159Z SMB W60L60
- 911401807887:RC159Z SMB W62L62
- 911401807987:RC159Z SMB W30L120

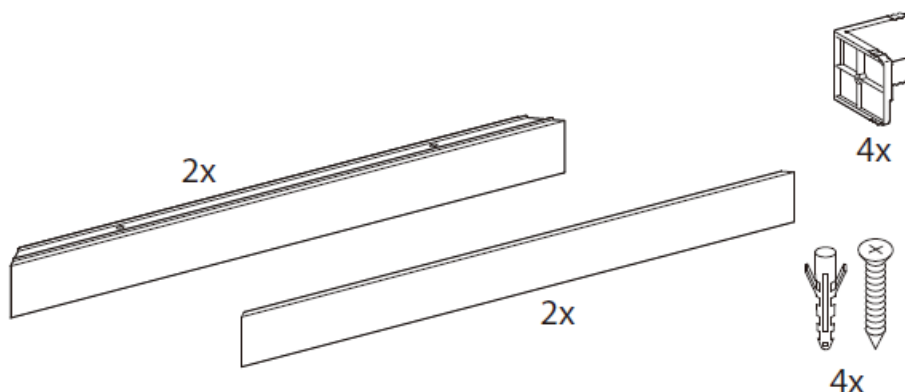

The luminaire shall not be covered with thermal insulation or similar material under any circumstance.

If the external flexible cable or cord of this luminaire is damaged, it shall be exclusively replaced by the manufacturer or his service agent or a similarly qualified person to avoid a hazard. The light source contained in this luminaire shall only be replaced by the manufacturer his service agent or a similar qualified person. Luminaire must not be used or stored in a corrosive environment where hazardous materials such as sulfur, chlorine, phthalates, etc, are present.

Inrush current

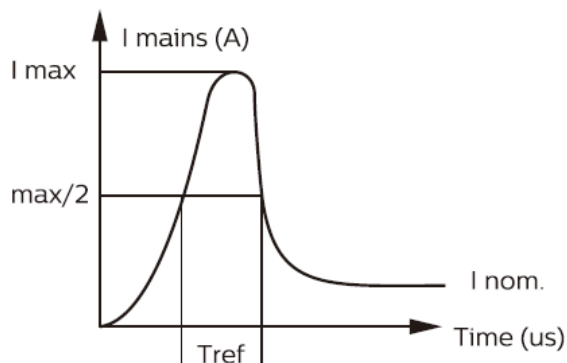

28W 28W 30W
PSU PSD

Electrical characteristics

| | | | |
|------------------------------------|-----------------|------|-----|
| I_{max} (A) | 16 | 25.8 | 22 |
| T_{ref} (μs) | 200 | 255 | 250 |
| MCB | Luminaires Max. | | |
| B-10 A | 12 | 9 | 6 |
| B-13 A | 16 | 13 | 8 |
| B-16 A | 20 | 17 | 10 |
| C-10 A | 17 | 17 | 10 |
| C-13 A | 23 | 23 | 13 |
| C-16 A | 28 | 28 | 17 |

INSTALLATION

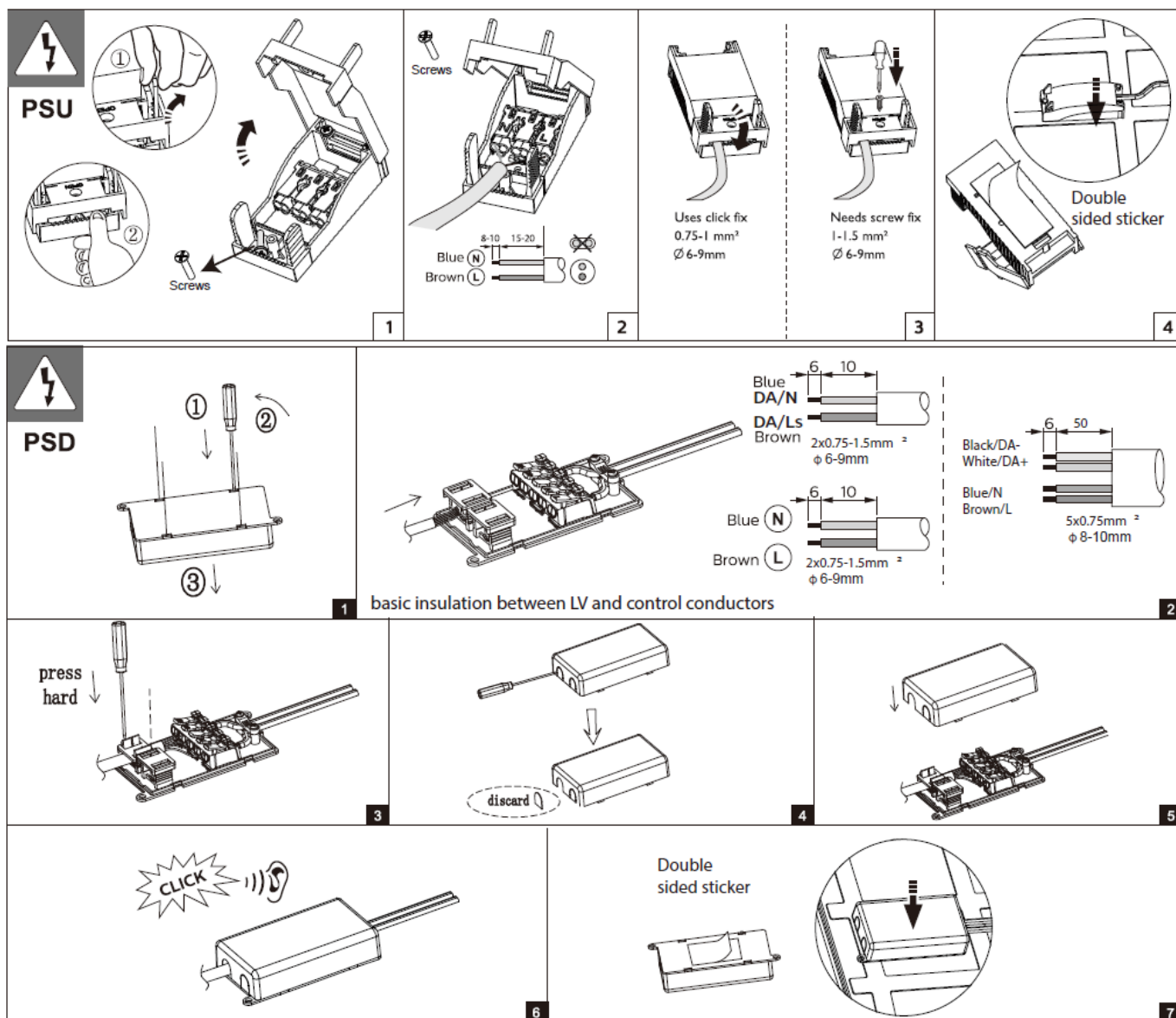

All-in: Multi Color switch set your color temperature to 3000K, 3500K, or 4000K (=default)

| Color Temperature selectable | | | |
|------------------------------|--------|-------------|---------|
| Drive | 3000K | 3500K/4000K | Wattage |
| PSU | 3400lm | 3600lm | 30W |
| PSD | 3400lm | 3600lm | 28W |

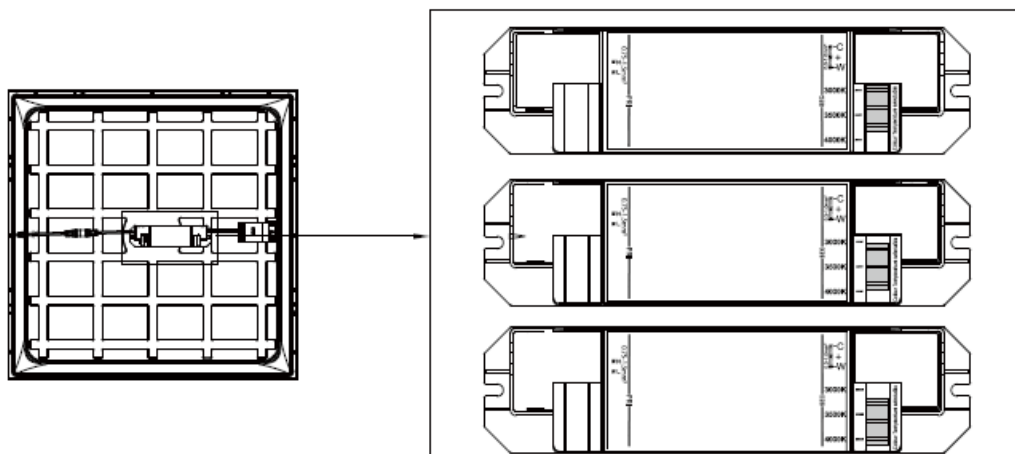

Visible Profile Ceiling mounting(VPC) – Lay-In mounting

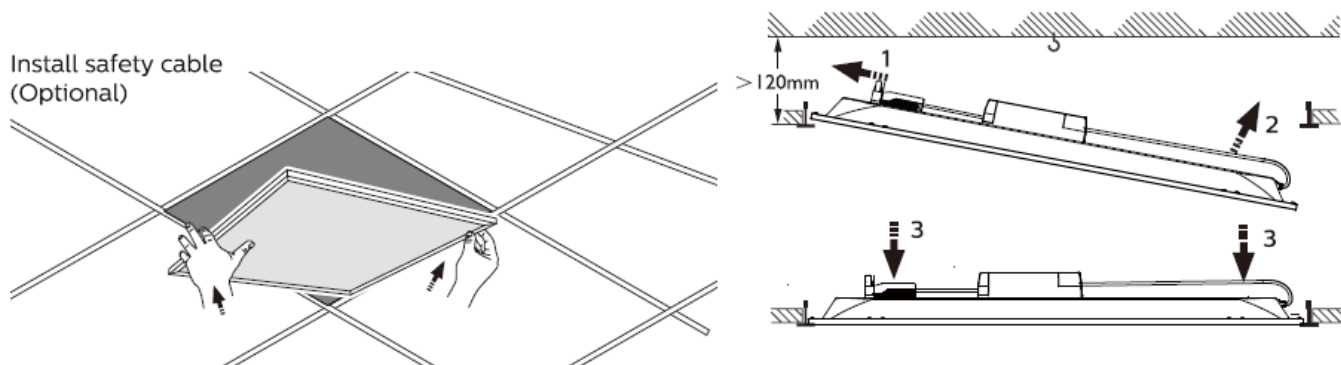

Suspension mounting (SME-3 WH/SME-4WH)

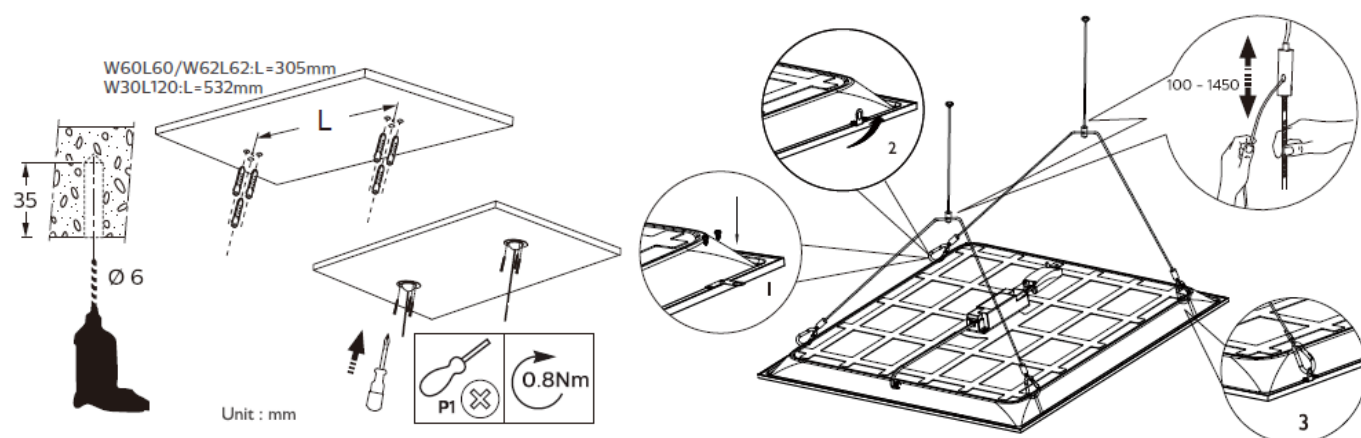

Plaster Ceiling Version mounting (SMB-PLC)

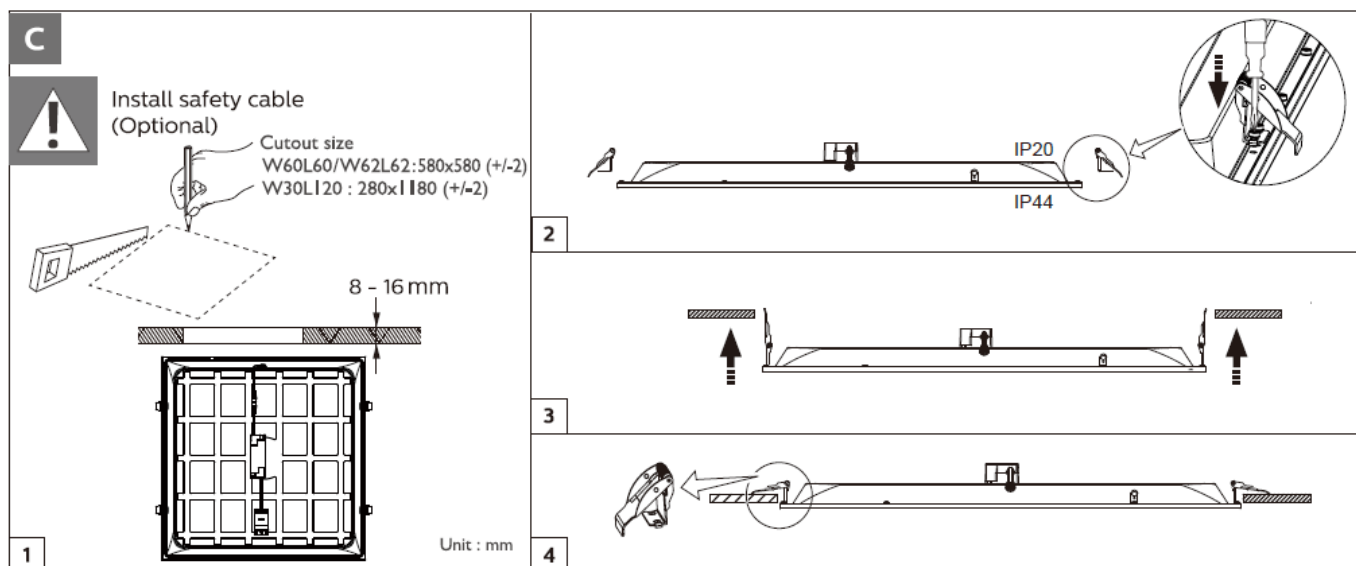

Safety cable (SC)

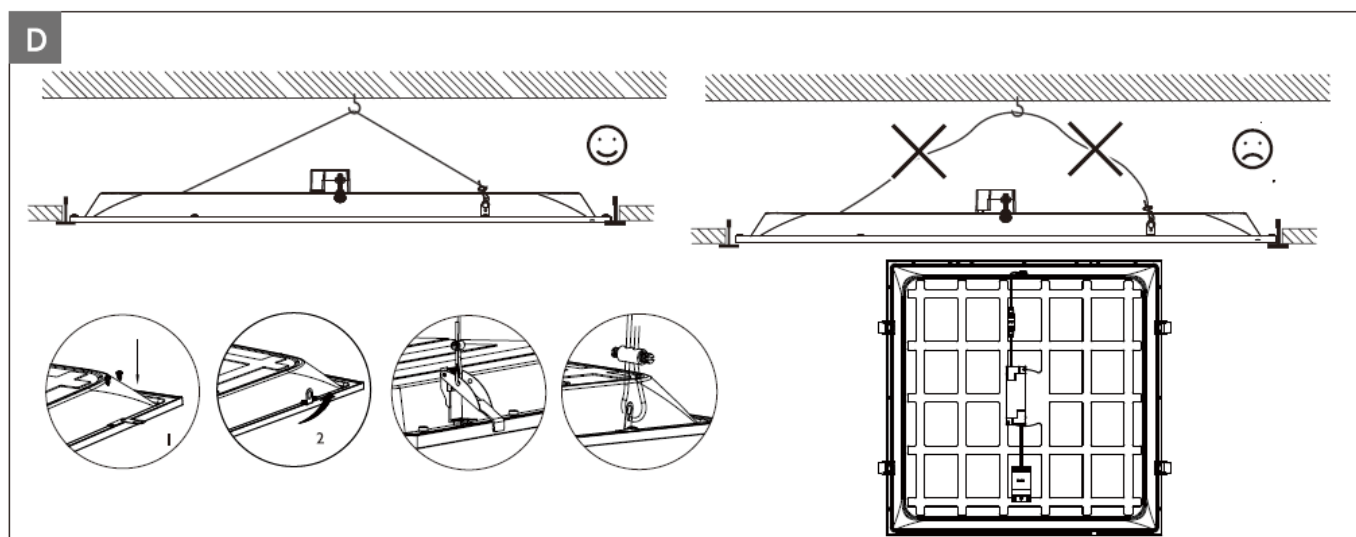

Surface mounted

- 911401807787:RC159Z SMB W60L60
- 911401807887:RC159Z SMB W62L62
- 911401807987:RC159Z SMB W30L120

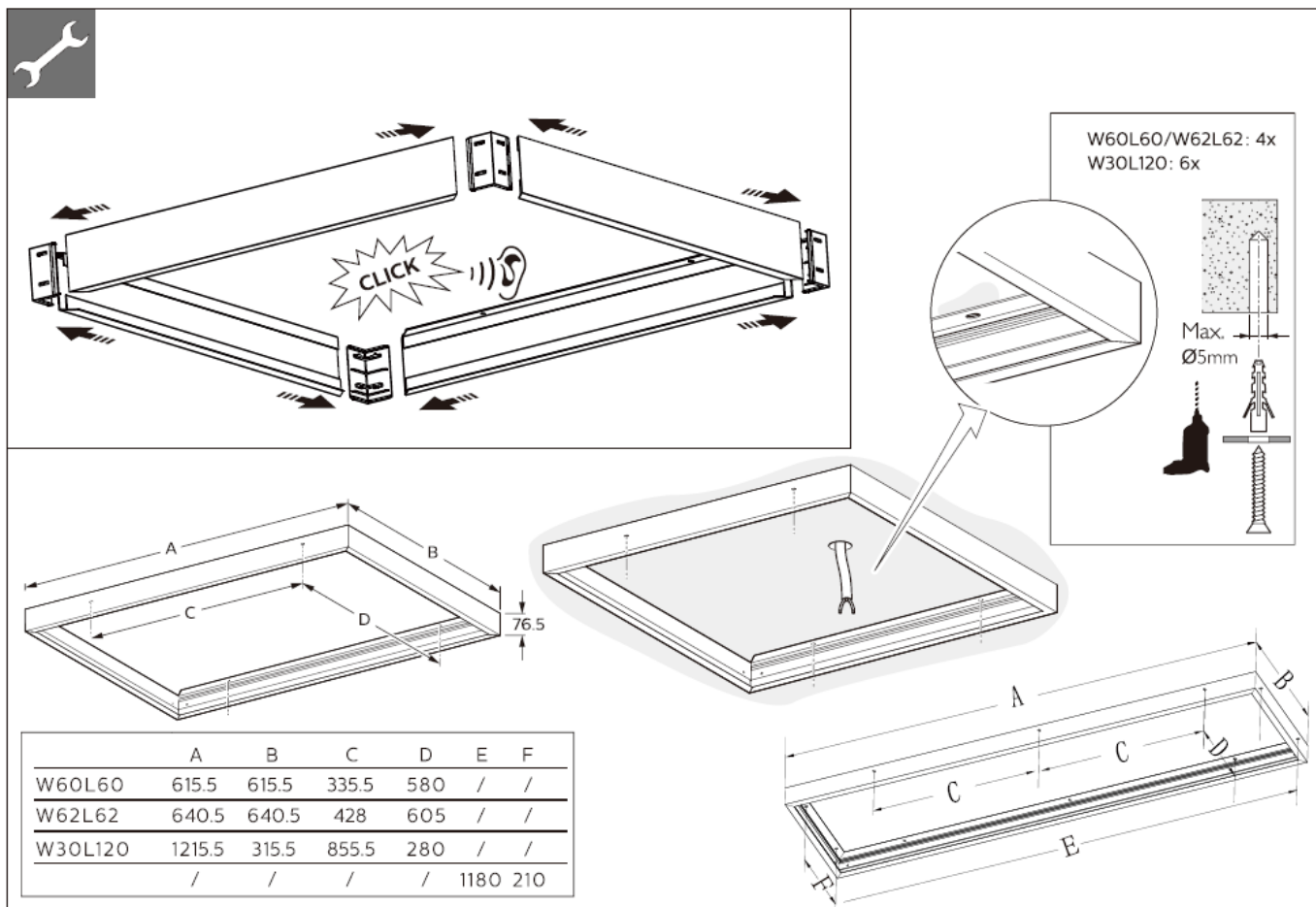

Surface mounted

- 911401808087: RC059Z SMB W60L60
- 911401808187: RC059Z SMB W62L62
- 911401808287: RC059Z SMB W30L120

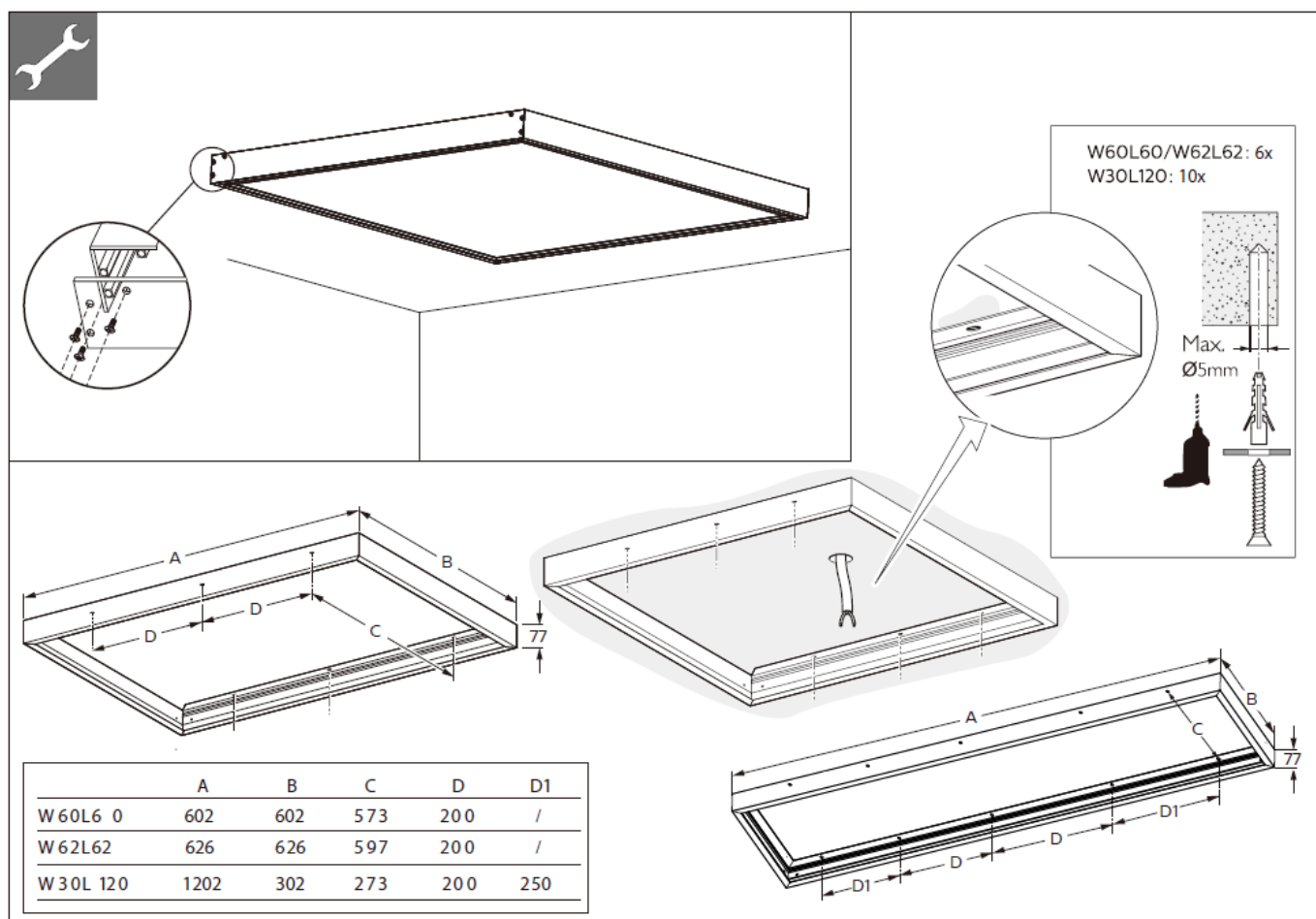

Philips and the Philips shield emblem are registered trademarks of Koninklijke Philips N.V.

Disconnect before servicing

- Luminaire has basic insulation between Low Voltage supply and control conductors.
- The light source contained in this luminaire and the external flexible cable shall only be replaced by the manufacturer his service agent or a similar qualified person.
- Storage, installation, use, operation, and maintenance of the products need to be performed exactly according to the instructions in this manual and/or other instructions as may be provided by us to guarantee the safe use of the product over its entire lifetime. Failure to adhere to these instructions will invalidate your entitlement to warranty. Bolts with an indication of torque strength on the drawing need to be tightened using a calibrated torque wrench. Pre-assembled bolts need to be retightened again to the required torque specification to ensure maximum strength over a lifetime.

SR compatibility

For SR-based luminaires only SR-certified components/sensors are to be used (see also: <http://www.lighting.philips.co.uk/oem-emea/products/driving-connected-lighting>). The functional compatibility of two (SR-certified) components/sensors to be used in combination, as well as the override possibility of any line-switch function used in an SR-based luminaire, is to be released by the master component/sensor supplier. If using a NEMA 7-pin socket on an SR-based luminaire, a full system verification is required. Not following this advice can/will cause risk of damage and non-compliance for which Signify cannot take any responsibility.

WEEE Statement

Please inform yourself about the local waste disposal, separation, and collection system for electrical and electronic products and packaging. Please act according to your local rules and do not dispose of your old product and packaging with your normal household waste. The correct disposal of the packaging, your product, and/or batteries will help prevent potential negative consequences for the environment and human health. Batteries should be disposed of separately from the municipal waste stream via designated collection facilities. When disposing of a product that contains non-user-replaceable batteries, the non-user-replaceable batteries shall be removed by a professional.

Documents / Resources

| | |
|---|--|
|  | PHILIPS RC065B, RC066B Ledinaire Panel [pdf] User Manual RC065B, RC066B, RC065B RC066B Ledinaire Panel, RC065B RC066B, Ledinaire Panel, Panel |
|---|--|

References

- [User Manual](#)

[Manuals+](#), [Privacy Policy](#)

This website is an independent publication and is neither affiliated with nor endorsed by any of the trademark owners. The "Bluetooth®" word mark and logos are registered trademarks owned by Bluetooth SIG, Inc. The "Wi-Fi®" word mark and logos are registered trademarks owned by the Wi-Fi Alliance. Any use of these marks on this website does not imply any affiliation with or endorsement.