

Philips 242S1E LCD Monitor



Philips 242S1E LCD Monitor User Manual

[Home](#) » [Philips](#) » Philips 242S1E LCD Monitor User Manual 

Contents

- [1 Philips 242S1E LCD Monitor User Manual](#)
- [2 Important Safety Instruction](#)
- [3 Operation](#)
- [4 Maintenance](#)
- [5 TCO Certified](#)
- [6 FCC Compliance Statement](#)
- [7 Warranty Statement](#)
- [8 References](#)

PHILIPS

Philips 242S1E LCD Monitor User Manual



Important Safety Instruction

Safety precautions and maintenance

Use of controls, adjustments or procedures other than those specified in this documentation may result in exposure to shock, electrical hazards and/or mechanical hazards. Read and follow these instructions when connecting and using your computer monitor. Excessive sound pressure from earphones and headphones can cause hearing loss. Adjustment of the equalizer to maximum increases the earphones and headphones output voltage and therefore the sound pressure level.

For models without AC switches

The power outlet should be installed near the equipment, if it is pluggable, for easy access.

Note

- To prevent possible hearing damage, do not listen at high volume levels for long periods.
- We recommend you switch off the monitor when it is not in use for a long time.

Operation

- Remove any object that could fall into ventilation holes or prevent proper cooling of the monitor's electronics.
- Do not block the ventilation holes in the cabinet.
- Operate under the specified power supply. Be sure to operate the monitor only with the specified power supply. Use of an incorrect voltage will cause malfunction and may cause fire or electric shock.
- The USB Type-C port could only be connected to specific equipment with fire enclosure in compliance with IEC 62368-1 or IEC 60950-1.

Maintenance

- To avoid the risk of shock or permanent damage to the set, do not expose the monitor to dust, rain, water, or excessive moisture environment.

- To maintain the best performance of your monitor and use it for a longer lifetime, please use the monitor in a location that falls within the following temperature and humidity ranges.
- Temperature: 0-40°C 32-104°F
- (If the temperature range is inconsistent with the contents of the manual, the manual shall prevail.)
- Humidity: 20-80% RH
- Altitude : 0-5000m(0-16400 ft).
- Please confirm the distribution system in building installation shall provide the circuit breaker rated 120/240V, 20A (maximum).
- If provided with a 3-pin attachment plug on the power cord, plug the cord into a grounded (earthed) 3-pin outlet. Do not disable the power cord grounding pin, for example, by attaching a 2-pin adapter.
- The grounding pin is an important safety feature.

Caution(Applicable models with battery)

- Replacement of a battery with an incorrect type that can defeat a safeguard;
- Disposal of a battery into fire or a hot oven, or mechanically crushing or cutting of a battery, that can result in an explosion;
- Leaving a battery in an extremely high temperature surrounding environment that can result in an explosion or the leakage of flammable liquid or gas;
- A battery subjected to extremely low air pressure may result in an explosion or the leakage of flammable liquid or gas.
- Risk of fire or explosion if the battery is replaced by an incorrect type

Caution(Applicable models with coin/button cell batteries)

- Do not ingest battery, Chemical Burn Hazard.
- This product contains a coin/button cell battery. If the coin/button cell battery is swallowed, it can cause severe internal burns in just 2 hours and can lead to death.
- Keep new and used batteries away from children.
- If the battery compartment does not close securely, stop using the product and keep it away from children.
- If you think batteries might have been swallowed or placed inside any part of the body, seek immediate medical attention.

Stability Hazard.

- The product may fall, causing serious personal injury or death. To prevent injury, this product must be securely attached to the floor/wall by the installation instructions.
- A product set may fall, causing serious personal injury or death. Many injuries, particularly to children, can be avoided by taking simple precautions such as:
- ALWAYS use cabinets or stands or installation methods recommended by the manufacturer of the product set.
- ALWAYS use furniture that can safely support the product.
- ALWAYS ensure the product is not overhanging the edge of the supporting furniture.
- ALWAYS educate children about the dangers of climbing on furniture to reach the product or its controls.
- ALWAYS route cords and cables connected to your product so they cannot be tripped over, pulled or grabbed.

- NEVER place a product in an unstable location.
- NEVER place the product on tall furniture (for example, cupboards or bookcases) without anchoring both the furniture and the product to a suitable support.
- NEVER place the product on cloth or other materials that may be located between the product and supporting furniture.
- NEVER place items that might tempt children to climb, such as toys and remote controls, on the top of the product or furniture on which the product is placed.
- If the existing product is going to be retained and relocated, the same considerations as above should be applied.

Note

This monitor accepts a 75mm x 75mm/100mm x 100mm/200mm x 200mm VESA-Compliant mounting interface. VESA Mounting Screw (M4 or M6). Always contact the manufacturer for wall-mount installation. (For models with wall mount)

Prevent Tipping

When using the display, fasten the LCD to a wall using a cord or chain that can support the weight of the monitor to prevent the monitor from falling.

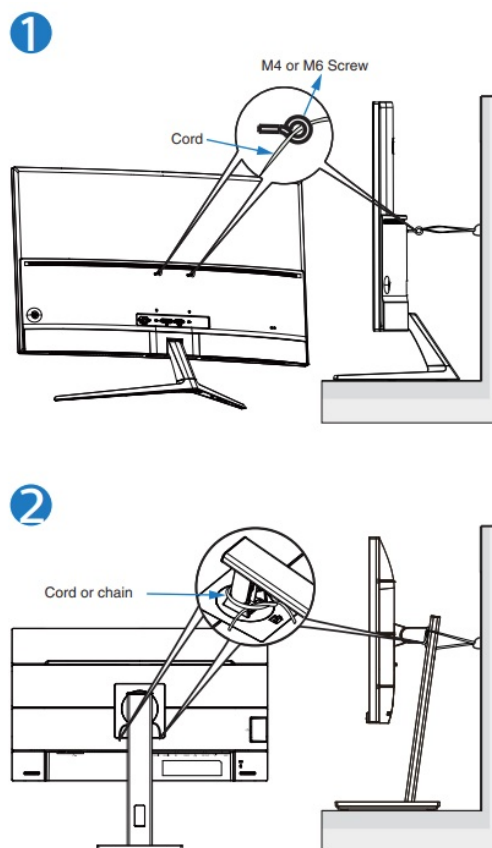

Note

- Display design may differ from those illustrated.
- Installing must be done by a qualified technician, and please contact your supplier for more information.
- For the Models with net weight $\geq 7\text{kg}$. Please select a suitable way to Prevent Tipping.
- For the models with VESA Mount, please use the method, install the screws with a ring to the VESA Mount hole, then tie the cord or chain to the wall.

- Otherwise, please use the method of tying the cord or chain to the stand and then fixing it to the wall.

Only applicable to the model of application)

The terms HDMI, HDMI High-Definition Multimedia Interface, HDMI Trade Dress and the HDMI Logos are trademarks or registered trademarks of HDMI Licensing Administrator, Inc.

TCO Certified

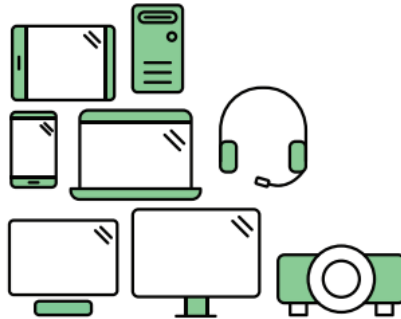

A third-party certification according

IT products are associated with a wide range of sustainability risks throughout their life cycle. Human rights violations are common in the factories. Harmful substances are used both in products and their manufacture. Products can often have a short lifespan because of poor ergonomics, low quality and when they are not able to be repaired or upgraded. This product is a better choice. It meets all the criteria of TCO Certified, the world's most comprehensive sustainability certification for IT products. Thank you for making a responsible product choice, that helps drive progress towards a more sustainable future! Criteria in TCO Certified have a life-cycle perspective and balance environmental and social responsibility.



Conformity is verified by independent and approved verifiers that specialize in IT products, social responsibility or other sustainability issues. Verification is done both before and after the certificate is issued, covering the entire validity period. The process also includes ensuring that corrective actions are implemented in all cases of factory non-conformities. Last but not least, to make sure that the certification and independent verification is accurate, both TCO Certified and the verifiers are reviewed regularly. Want to know more? Read information about TCO Certified, full criteria documents, news and updates at tcocertified.com. On the website, you'll also find our Product Finder, which presents a complete, searchable listing of certified products. Toward sustainable IT products, a User-defined mode is used for TCO Certified compliance.

Only applicable to the model of application)

IT products are associated with a wide range of sustainability risks throughout their life cycle. Human rights violations occur in the supply chain. Harmful substances are used both in products and their manufacture. Products can often have a short lifespan because of poor ergonomics, low quality and when they are not able to be repaired or upgraded.

This product is a better choice. It meets all the criteria of TCO Certified, the world's most comprehensive

sustainability certification for IT products. Additionally, it fulfils the requirements of TCO Certified Edge, the supplemental certification that recognizes leading-edge products that exceed typical performance in a particular sustainability attribute. At our Product Finder (tcocertified.com/product-finder) you can find out which TCO Certified Edge criterion or criteria this product meets.

Criteria in TCO Certified have a life-cycle perspective and balance environmental and social responsibility. Compliance is verified by independent verification organizations that specialize in IT products, social responsibility or other sustainability issues. Verification is done both before and after the certificate is issued, covering the entire validity period. The process also includes ensuring that corrective actions are implemented in all cases of factory non-conformities.

Thank you for making a responsible product choice, that helps drive progress towards a more sustainable future!

Want to know more?

Read information about TCO Certified, full criteria documents, news and updates at tcocertified.com. On the website, you'll also find our Product Finder, which presents a complete, searchable listing of certified products.

Regulatory Information

EPEAT (Only applicable to the model of application)(www.epeat.net) The EPEAT (Electronic Product Environmental Assessment Tool) program evaluates computer desktops, laptops, and monitors based on environmental criteria developed through an extensive stakeholder consensus process supported by the US EPA. EPEAT system helps purchasers in the public and private sectors evaluate, compare and select desktop computers, notebooks and monitors based on their environmental attributes. EPEAT also provides a clear and consistent set of performance criteria for the design of products and provides an opportunity for manufacturers to secure market recognition for efforts to reduce the environmental impact of their products.

Benefits of EPEAT (Only applicable to EPEAT registered model)

Reduce the use of primary materials.

Reduce the use of toxic materials.

Avoid the disposal of hazardous waste.

EPEAT's requirement that all registered products meet ENERGY STAR's energy efficiency specifications, means that these products will consume less energy throughout their life.

Note: For EPEAT-related information please refer to <MMD EPEAT Declaration> via

URL: <https://mmdmonitors.com/corporate-social-responsibility/> since PHILIPS monitor EPEAT registration manufacturer is MMD-Monitors & Displays Nederland B.V.

Energy Star Declaration (Only applicable to EPA-certified model)

ENERGY STAR is a program run by the U.S. Environmental Protection Agency (EPA) and the U.S. Department of Energy (DOE) that promotes energy efficiency. This product qualifies for ENERGY STAR in the "default" settings and this is the setting in which power savings will be achieved. Changing the factory default picture settings or enabling other features will increase power consumption that could exceed the limits necessary to qualify for an ENERGY STAR rating.

For more information on the ENERGY STAR program, refer to energystar.gov.

Note

- To prevent possible hearing damage, do not listen at high volume levels for long periods.
- We recommend you switch off the monitor when it is not in use for a long time.

(CE Only applicable to the model of application)

This device complies with the requirements set out in the Council Directive on the Approximation of the Laws of the Member States relating to the Electromagnetic Compatibility Directive (2014/30/EU), Low-voltage Directive (2014/35/EU), ErP Directive (2009/125/EC), RoHS directive (2011/65/EU) and Radio Equipment Directive (2014/53/EU)(for Radio Equipment) This product has been tested and found to comply with the harmonized

standards for Information Technology Equipment, these harmonized standards are published under Directives of Official Journal of the European Union.

Federal Communications Commission (FCC) Notice (U.S. Only) This equipment has been tested and found to comply with the limits for a Class B digital device, under Part 15 of the FCC Rules. These limits are designed to provide reasonable protection against harmful interference in a residential installation. This equipment generates, uses and can radiate radio frequency energy and, if not installed and used per the instructions, may cause harmful interference to radio communications. However, there is no guarantee that interference will not occur in a particular installation. If this equipment does cause harmful interference to radio or television reception, which can be determined by turning the equipment off and on, the user is encouraged to try to correct the interference by one or more of the following measures:

- Reorient or relocate the receiving antenna.
- Increase the separation between the equipment and the receiver.
- Connect the equipment to an outlet on a circuit different from that to which the receiver is connected.
- Consult the dealer or an experienced radio/TV technician for help.
- Changes or modifications not expressly approved by the party responsible for compliance could void the user's authority to operate the equipment.

Use only RF shielded cable that was supplied with the monitor when connecting this monitor to a computer device. To prevent damage which may result in fire or shock hazard, do not expose this appliance to rain or excessive moisture.

THIS CLASS B DIGITAL APPARATUS MEETS ALL REQUIREMENTS OF THE CANADIAN INTERFERENCE-CAUSING EQUIPMENT REGULATIONS.

FCC Compliance Statement

This device complies with Part 15 of the FCC Rules. Operation is subject to the following two conditions: (1) this device may not cause harmful interference, and (2) this device must accept any interference received, including interference that may cause undesired operation.

EN55022 or EN55032 Compliance (Czech Republic Only)

This device belongs to category B devices as described in EN55022 or EN55032 unless it is specifically stated that it is a Class A device on the specification label. The following applies to devices in Class A of EN55022 or EN55032(radius of protection up to 30 meters). The user of the device is obliged to take all steps necessary to remove sources of interference to telecommunication or other devices.

For EU: The crossed-out wheeled bin implies that used batteries should not be put into the general household waste! There is a separate collection system for used batteries, to allow proper treatment and recycling by legislation.

Please contact your local authority for details on the collection and recycling schemes.

For Switzerland: The used battery is to be returned to the selling point.

For other non-EU countries: Please contact your local authority for the correct method of disposal of the used battery. According to EU directive 2006/66/EC, the battery can't be disposed of improperly. The battery shall be separated to collect by local service.

Restriction on Hazardous Substances Statement (India)

This product complies with the "E-Waste (Management) Rules, 2016" CHAPTER V, rule 16, sub-rule (1). Whereas New Electrical and Electronic Equipment and their components or consumables or parts or spares do not contain Lead, Mercury, Cadmium, Hexavalent Chromium, polybrominated biphenyls and polybrominated diphenyl ethers beyond a maximum concentration value of 0.1% by weight in homogenous materials for lead, mercury, hexavalent chromium, polybrominated biphenyls and polybrominated diphenyl ethers and of 0.01% by weight in homogenous materials for cadmium. except for exemptions set in Schedule 2 of the Rule.

E-Waste Declaration for India

This symbol on the product or on its packaging indicates that this product must not be disposed of with your other household waste. Instead, it is your responsibility to dispose of your waste equipment by handing it over to a designated collection point to recycle waste electrical and electronic equipment. The separate collection and recycling of your waste equipment at the time of disposal will help to conserve natural resources and ensure that it is recycled in a manner that protects human health and the environment. For more information about E -e-waste please visit <http://www.india.philips.com/about/sustainability/recycling/index.page> to know where you can drop off your waste equipment for recycling in India please contact on below given contact details below.

Helpline number: 1800-425-6396 (Monday to Saturday, 9 a.m. to 5:30 pm)

Centralized E-waste collection center

Address:

TPV Technology India Private Limited,
59, Maheswari Nagar, 1st Main Road, Mahadevapura Post, Whitefield Road,
Bangalore, Karnataka, PIN: 560048, Tel: 080-3023-1000

E-mail: india.callcentre@tpv-tech.com

Information for U.K. only

WARNING – THIS APPLIANCE MUST BE EARTHED.

Important

This apparatus is supplied with an approved moulded 13A plug. To change a fuse in this type of plug proceed as follows:

1. Remove the fuse cover and fuse.

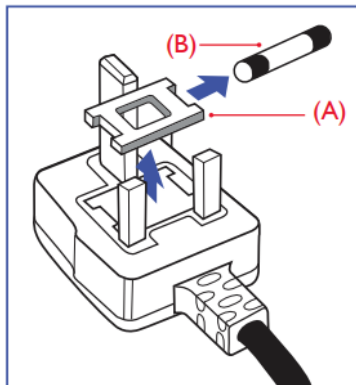

2. Fit new fuse which should be a BS 1362 5A, A.S.T.A. or BSI-approved type.

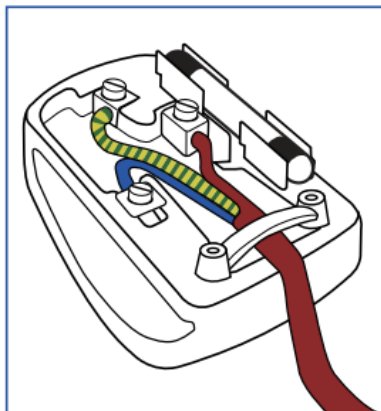

3. Retit the fuse cover.

If the fitted plug is not suitable for your socket outlets, it should be cut off and an appropriate 3-pin plug fitted in its place. If the mains plug contains a fuse, this should have a value of 5A. If a plug without a fuse is used, the fuse at the distribution board should not be greater than 5A.

NOTE: The severed plug must be destroyed to avoid a possible shock hazard should it be inserted into a 13A

socket elsewhere. (A)(B)

How to connect a plug

The wires in the mains lead are coloured by the following code:

BLUE -“NEUTRAL”(“N”)

BROWN -“LIVE”(“L”)

GREEN&YELLOW -“EARTH”(“E”)

1. The GREEN&YELLOW wire must be connected to the terminal in the plug which is marked with the letter “E” or by the Earth symbol or coloured GREEN or GREEN&YELLOW.
2. The BLUE wire must be connected to the terminal which is marked with the letter “N” or coloured BLACK.
3. The BROWN wire must be connected to the terminal which is marked with the letter “L” or coloured RED.
4. Before replacing the plug cover, make certain that the cord grip is clamped over the sheath of the lead – not simply over the three wires.

Warranty Statement

Region	Product Category	Warranty Period
USA, Canada	All Monitors	4 years
USA, Canada	Refurbished monitor	90 days
Mexico	All Monitors	3 years
Chile	All Monitors	3 years
Peru	All Monitors	3 years
Brazil	All Monitors	1 year
China	All Monitors	3 years
Asia Pacific	All Monitors	3 years
MEA	All Monitors	3 years
Europe	Monitors C, E lines	24 months
	Monitors B, M, S, X, P, V lines	36 months

PHILIPS Monitor’s warranty period is listed below, for areas not covered in this table, please follow their warranty statement.

Spare Parts Service

Extending the lifetime of IT products is the most effective way to reduce their environmental impact. Spare parts are not upgradeable, but repairable and/or replaceable. Spare parts are available for use in the repair of EPEAT-registered products (refer to www.epeat.net) for a minimum of 5 years after the point of sale or 2 years after the end of production, whichever is later. Spare parts are available for use in the repair of non-EPEAT registered products for a minimum of 3 years after the point of sale or 1 year after the end of production, whichever is later. Please refer to the “Service Contact Information” section or www.philips.com/support for further information.

Key Spare Parts List

Components or Assemblies	Replaceable	Repairable	How to Replace or Repair
Connectivity cables	Yes	No	By hand without tool, but please contact your dealer or your local service center (via www.philips.com/support) for confirming the cables specification when necessary.
Power cables	Yes	No	
External power supply ⁽¹⁾	Yes	Yes	For replacing, please follow above action. For repairing, please just contact your local service center (via www.philips.com/support) for help when necessary to avoid any risk.
Display panel or display assembly	Yes	Yes	Please just contact your local service center (via www.philips.com/support) for help when necessary to avoid any risk.
Internal power supply ⁽²⁾	Yes	Yes	
System board ⁽³⁾ /motherboard	Yes	Yes	

2021 © TOP Victory Investments Ltd. All rights reserved. This product has been manufactured by and is sold under the responsibility of Top Victory Investments Ltd., and Top Victory Investments Ltd. is the warrantor of this product.

Philips and the Philips Shield Emblem are registered trademarks of Koninklijke Philips N.V. and are used under license. Specifications are subject to change without notice.

Download PDF: [Philips 242S1E LCD Monitor User Manual](#)

References

- [User Manual](#)