



# PHILIPS PDUVCC UV-C Control System Instruction Manual

[Home](#) » [Philips](#) » PHILIPS PDUVCC UV-C Control System Instruction Manual 

## Contents

- [1 PHILIPS PDUVCC UV-C Control System Instruction Manual](#)
- [2 IMPORTANT SAFEGUARDS](#)
- [3 Package Content](#)
- [4 Dimension](#)
- [5 Instruction](#)
- [6 Read More About This Manual & Download PDF:](#)
- [7 Documents / Resources](#)
  - [7.1 References](#)
- [8 Related Posts](#)

# PHILIPS PDUVCC UV-C Control System Instruction Manual



## IMPORTANT SAFEGUARDS

### READ AND FOLLOW ALL SAFETY INSTRUCTIONS

Devices must be installed by a qualified electrician in accordance with all national and local electrical and construction codes and regulations.

THIS EQUIPMENT IS DESIGNED FOR USE WITH GERMICIDAL LAMPS OR UV SOURCES. STRICT ADHERENCE TO THE INSTALLATION DIRECTIONS AND SAFETY PROTOCOLS IS NECESSARY TO PREVENT OCCUPANT EYE AND SKIN EXPOSURE TO HARMFUL RADIATION.

UV radiation can pose a risk of personal injury. Overexposure can result in damage to eyes and bare skin. To reduce the risk of overexposure this equipment must be installed in accordance with the manufacturer's site planning recommendations, including instructions on the relative location of each germicidal system component, the minimum distances between UV-generating devices and other objects or surfaces, and protection from line-of-sight exposure to UV radiation in occupied spaces located above the equipment mounting area (e.g. upper floor balconies, open staircases, etc.)

UV and optical radiation can be reflected by surrounding surfaces such as ceilings and walls. Since the reflective properties of surfaces can vary widely, it should be considered as part of site planning. Follow the manufacturer's recommendations for selecting appropriate ceiling and wall finishes.

IT IS THE RESPONSIBILITY OF THE INSTALLER TO ENSURE THAT PERSONS WILL NOT BE EXPOSED TO EXCESSIVE UV OR OPTICAL RADIATION DURING EQUIPMENT OPERATION. THIS WILL REQUIRE THE INSTALLER TO CONDUCT AN ASSESSMENT OF ALL SITE AND EQUIPMENT SAFEGUARDS TO ENSURE THE SYSTEM IS OPERATING IN ACCORDANCE WITH THE SYSTEM MANUFACTURER'S INSTRUCTIONS AND SAFETY PROTOCOLS, INCLUDING AN ASSESSMENT OF IRRADIANCE OR ILLUMINANCE LEVELS IN THE SURROUNDING OCCUPIED SPACES.

Equipment should be mounted in locations and at heights where it will not readily be subjected to tampering by unauthorized personnel.

Maintenance and servicing of this UV generating equipment shall be performed by authorized personnel. Service

personnel must wear appropriate Personal Protective Equipment (PPE) if the equipment will be in operation during the maintenance or servicing work. Contact the equipment manufacturer for PPE recommendations and guidance. Please refer to UV-C Lamp Installation Instructions for details.

When replacing lamps, replace them only with the lamps for which the equipment is marked and intended.

The use of accessory equipment not recommended by the manufacturer may cause an unsafe condition.

Do not use this equipment for other than intended use.

## SAVE THESE INSTRUCTIONS

### Package Content

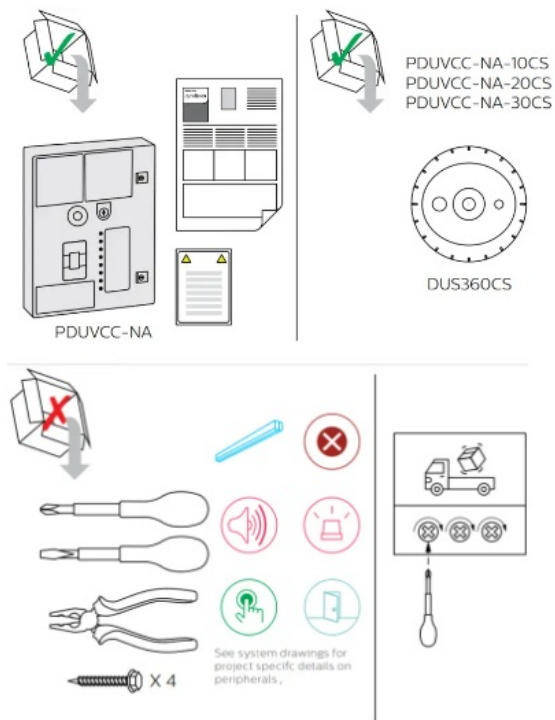

### Dimension

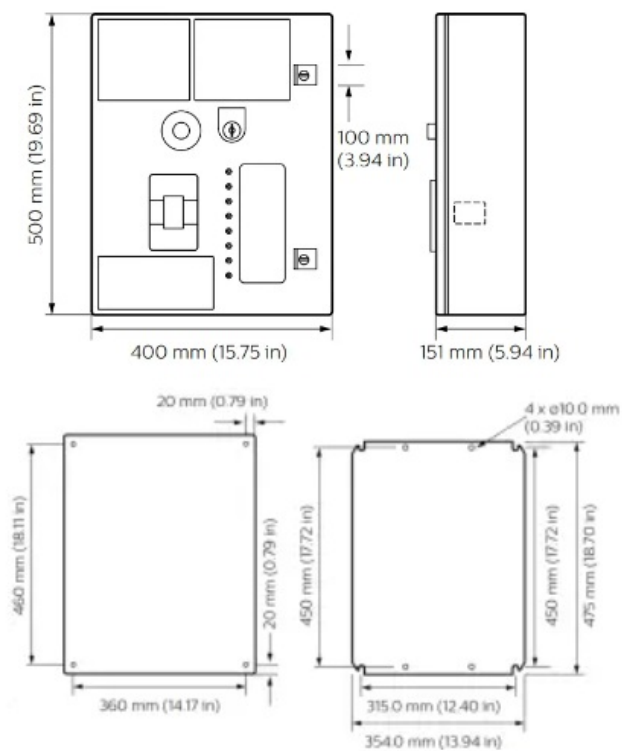

## Instruction

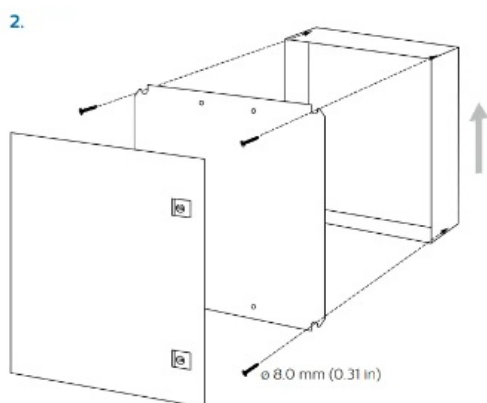
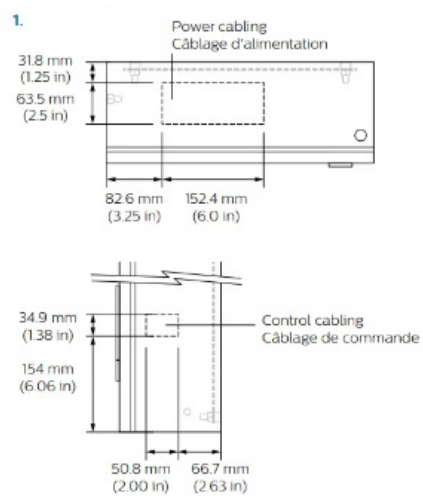

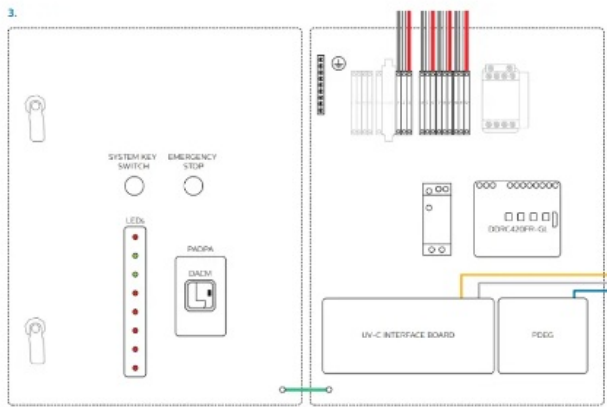

-  UV-C lamp
-  Warning light
-  Audible alarm
-  Area emergency stop
-  Motion sensor
-  Door switch
-  Checkpoint

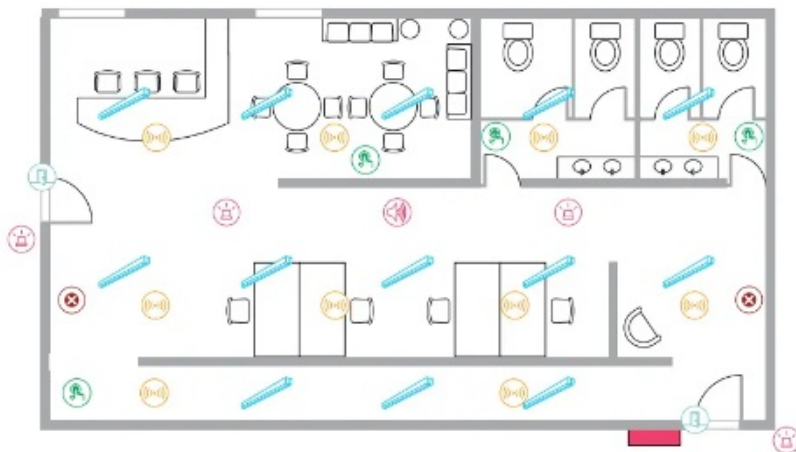

### Installation example



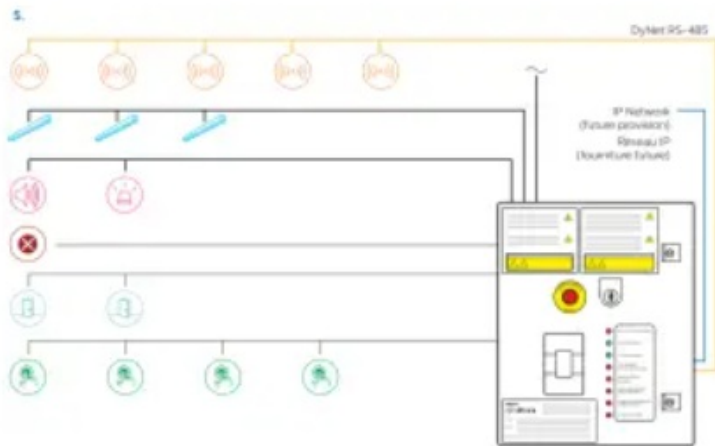

See system drawings for project specific details on peripheral

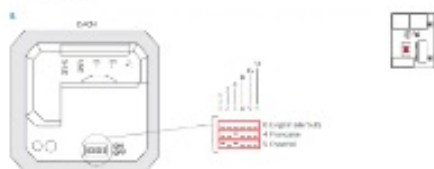
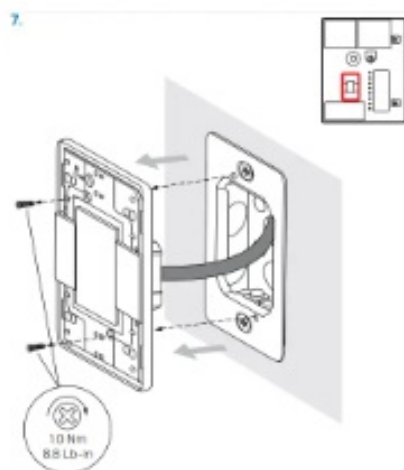
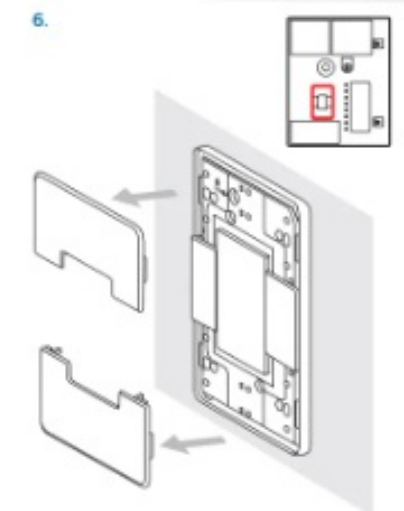

Peripheral devices and Philips UV-C luminaires and lamps supplied separately. See system drawings for project specific details



**PDUVCC NA**  
**Output ratings**

Load Type		 
 Electronic Ballast	3 x (16 A, 120, 277, 347 V )	
 General Use		2 A, 120 V

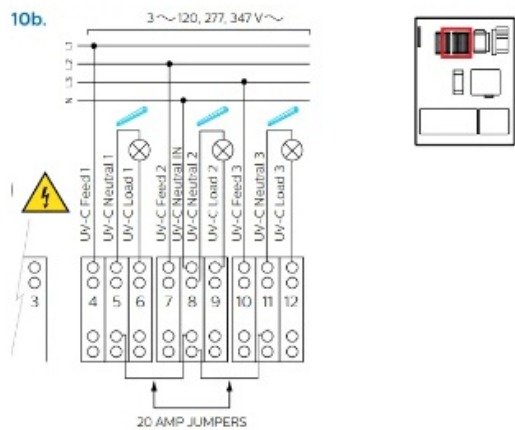
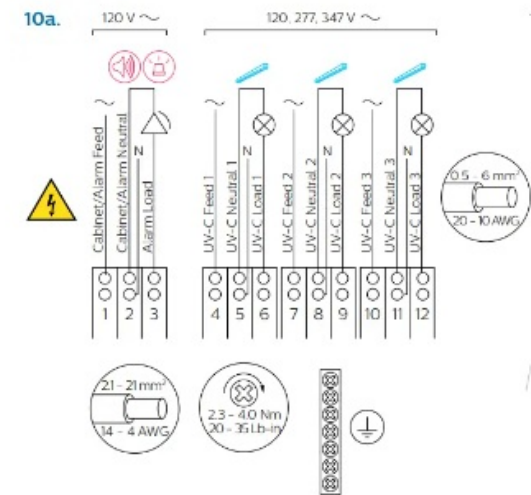

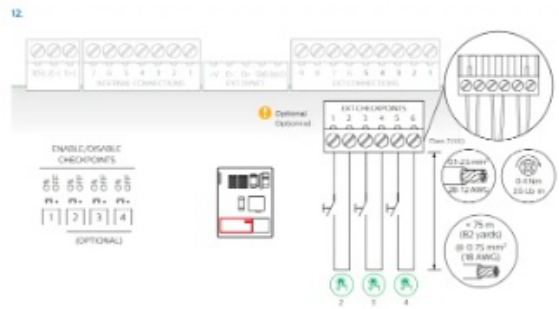
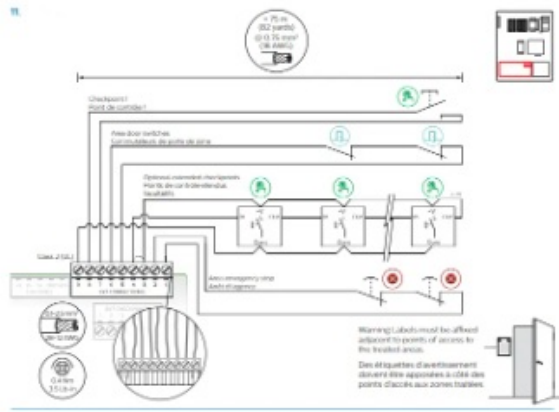

Refer to Specification Sheet for equipment ratings.



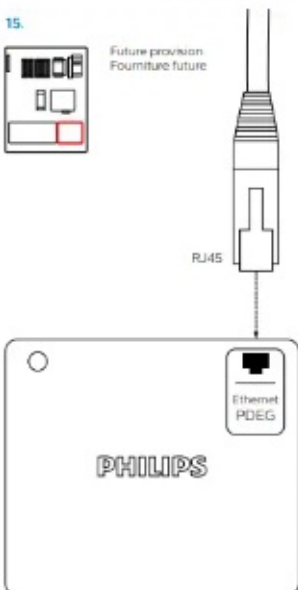
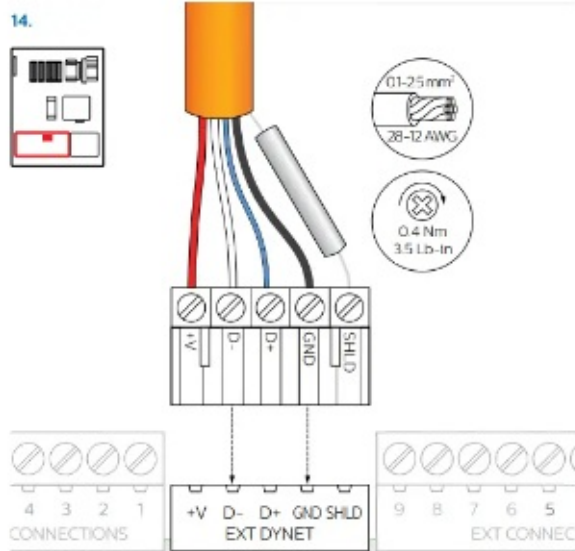
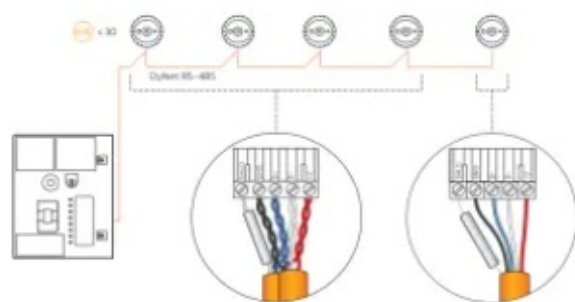

Unused checkpoints must be disabled.

Sensors may not be provided for all systems – go to step 15

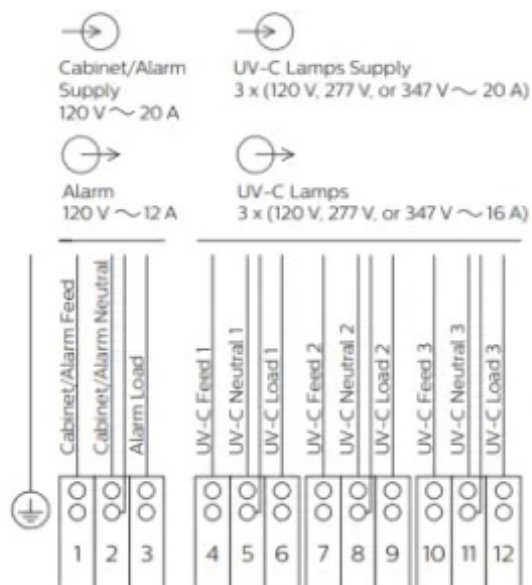

ALTERNATE WIRING FOR 3 ~

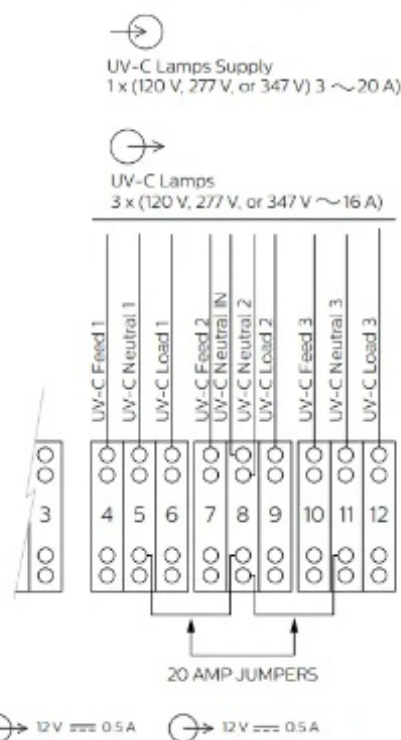

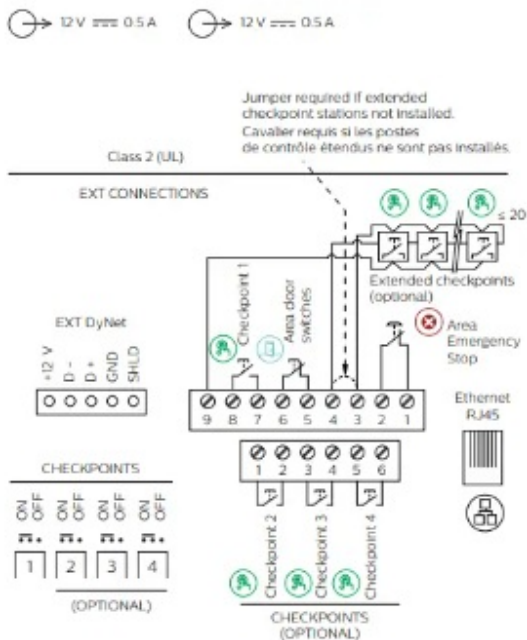

The site specific installation manual shall include detailed information for properly locating the components of a system in a given space. This information shall include, as applicable, drawings depicting examples of correct installations, as well as examples of unacceptable installations that may pose a risk of UV overexposure (e.g. installation at inappropriate heights, locations or orientations, open sightlines between the radiation source and exposed upper floors, stairs or walkways, etc.).

Only install sensors supplied with the system. Ensure that only the required number of sensors are installed for your space. The remainder can be used as spares.

Refer to user guide for system setup and operation.

This Class A digital apparatus complies with Canadian ICES-003.

**Warning** – This is a class A product. In a domestic environment this product may cause radio interference in which case the user may be required to take adequate measures

© 2020 Signify Holding. All rights reserved. The information provided herein is subject to change, without notice. Signify does not give any representation or warranty as to the accuracy or completeness of the information included herein and shall not be liable for any action in reliance thereon. The information presented in this document is not intended as any commercial offer and does not form part of any quotation or contract, unless otherwise agreed by Signify.

<http://www.lighting.philips.com/dynalite>

**Read More About This Manual & Download PDF:**

**Documents / Resources**

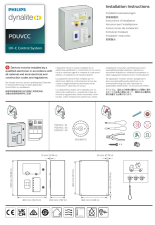

**[PHILIPS PDUVCC UV-C Control System](#)** [pdf] Instruction Manual  
PDUVCC, UV-C Control System, PDUVCC UV-C Control System, Control System

## References

-  **[Philips Dynalite - Lighting Controls, Lighting Management](#)**

Manuals+.