



## PHILIPS GC628 All In One Ironing Solution User Manual

[Home](#) » [Philips](#) » PHILIPS GC628 All In One Ironing Solution User Manual 

# PHILIPS

GC628 All In One Ironing Solution  
User Manual



## Contents

- 1 GC628 All In One Ironing Solution
- 2 Type of water to use
- 3 Steam lock
- 4 Documents / Resources
  - 4.1 References
- 5 Related Posts

## GC628 All In One Ironing Solution

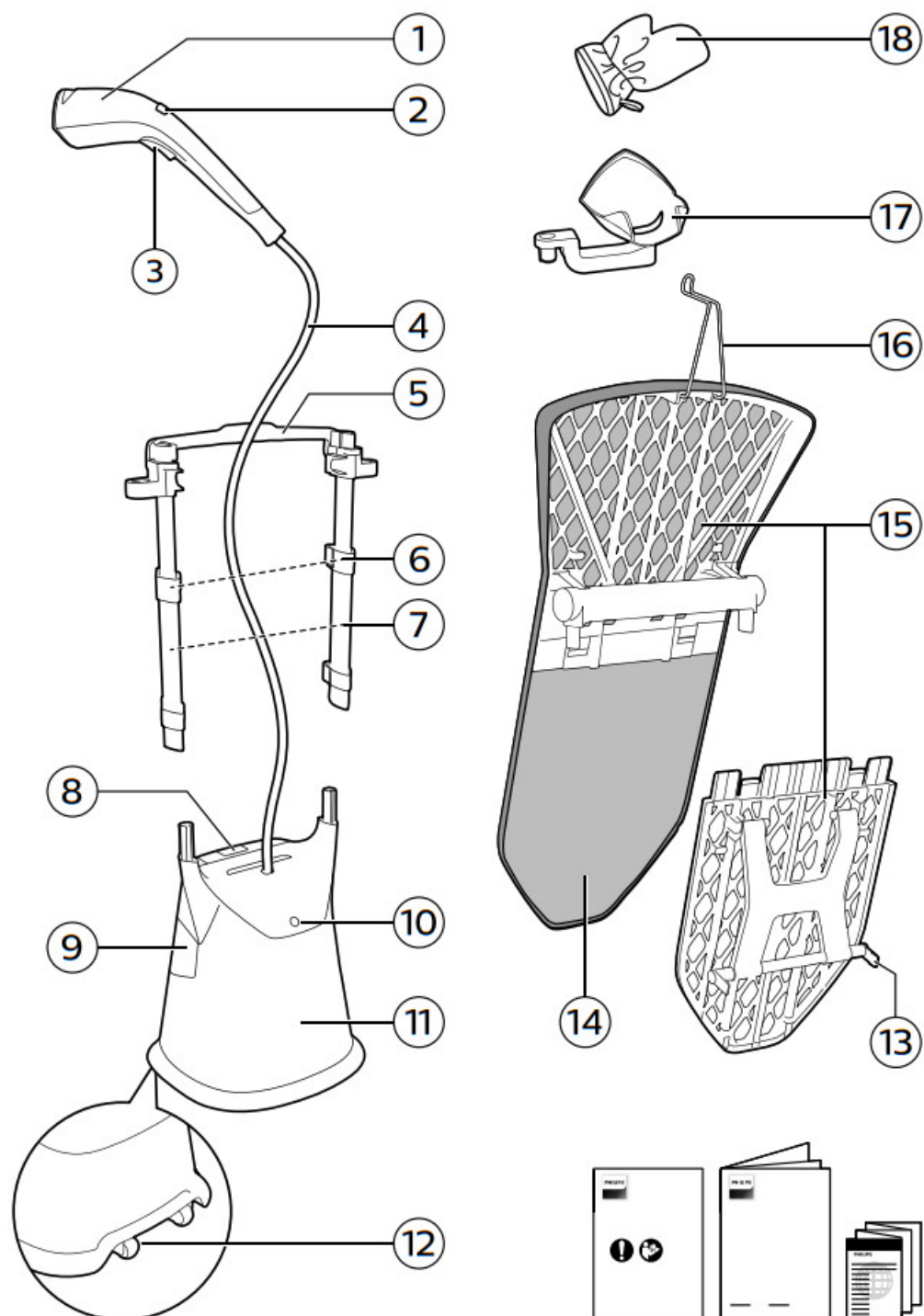

1	Steamer head	10	Power button
2	Steam selection	11	Base
3	Steam trigger	12	Wheels
4	Steam supply hose	13	Board lock
5	Board tilting lever	14	Board cover
6	Pole lock clip	15	Board
7	Poles	16	Hanger hook
8	Water tank release lock	17	Side docking
9	Water tank	18	Glove

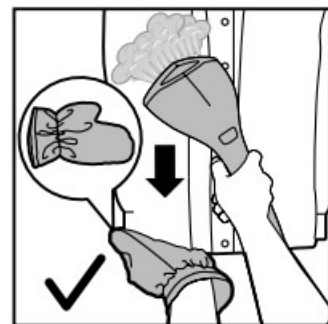
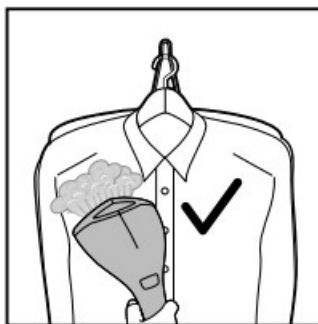
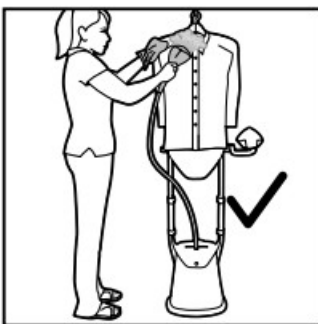
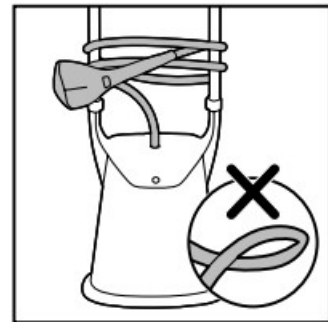
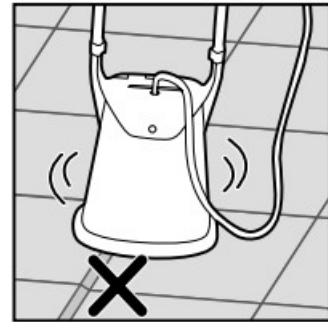
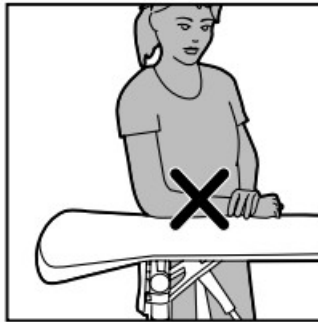
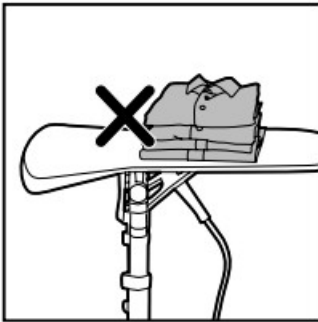
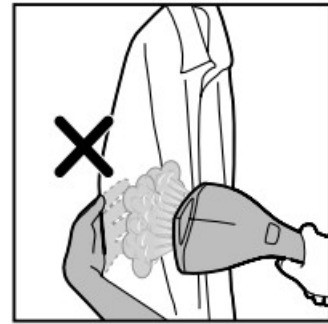

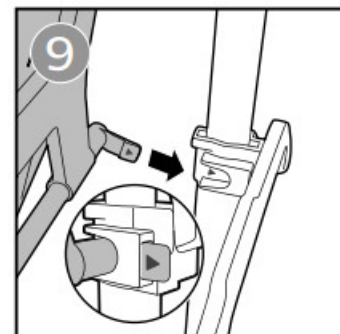
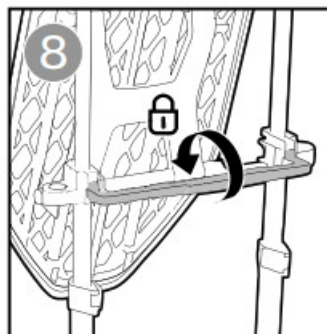
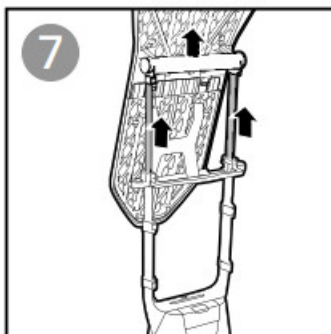
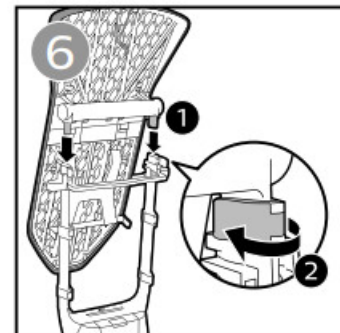
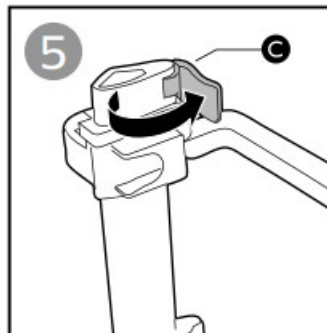
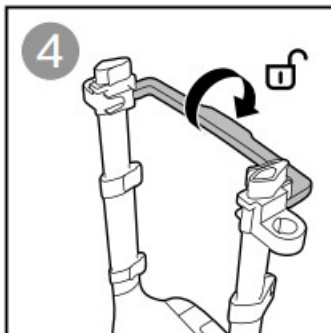
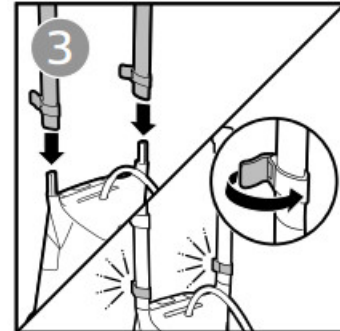
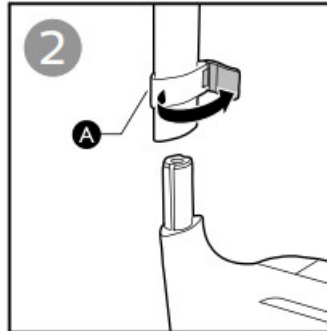
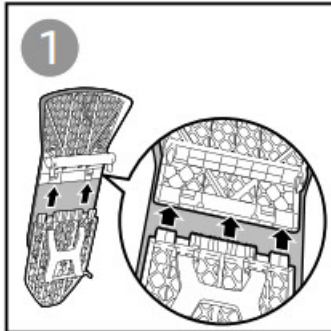
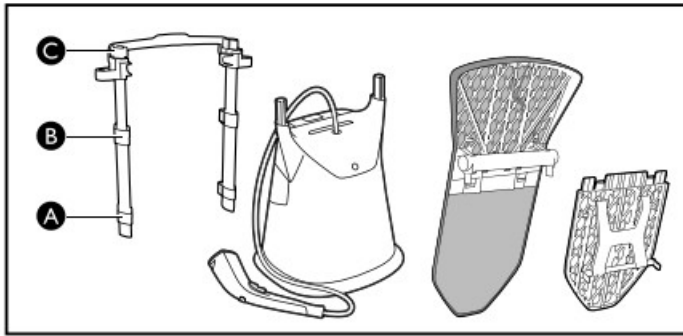

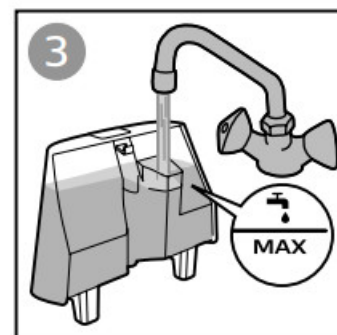
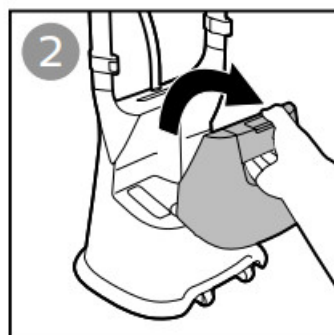
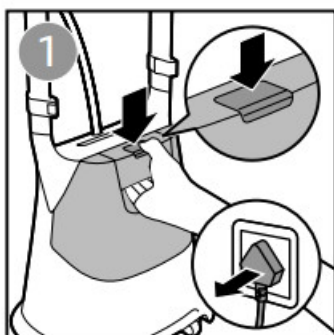
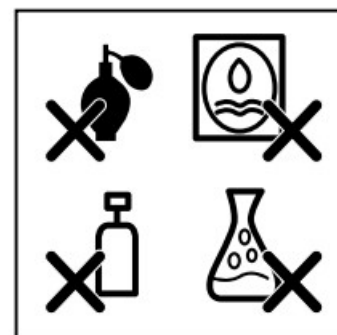
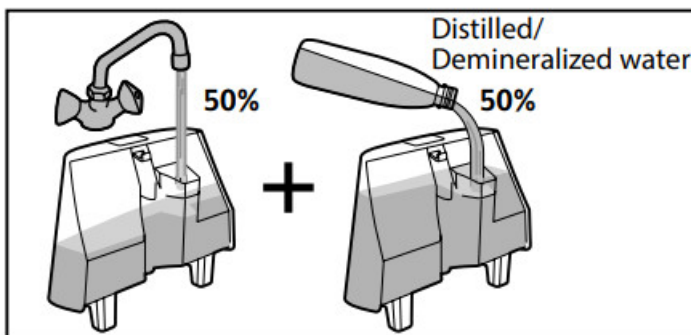
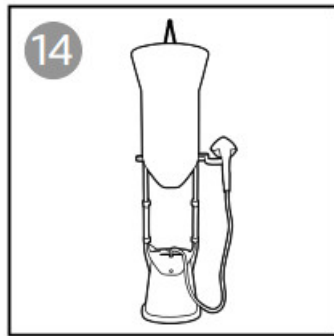
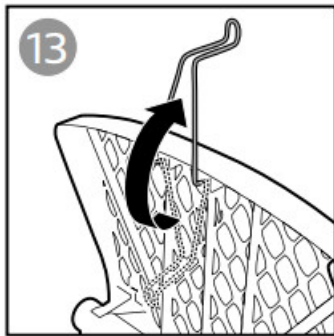
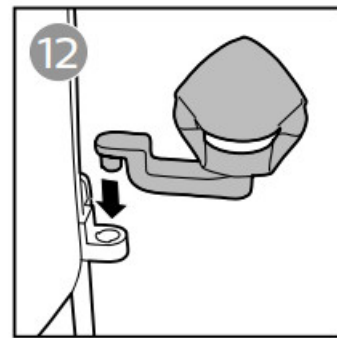
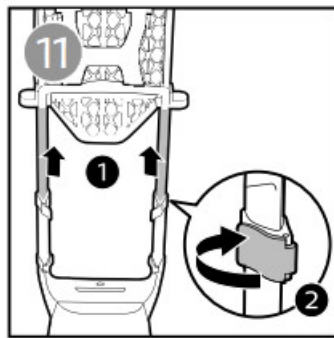
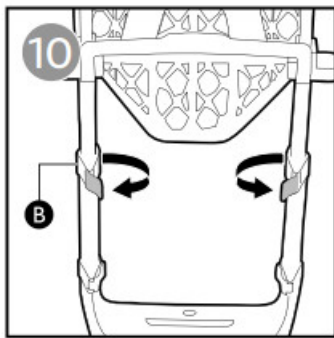

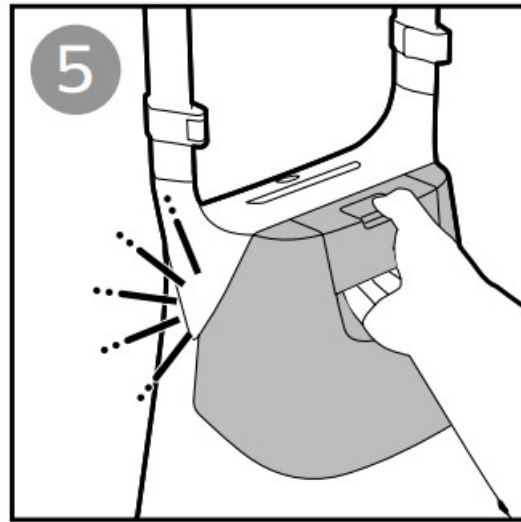
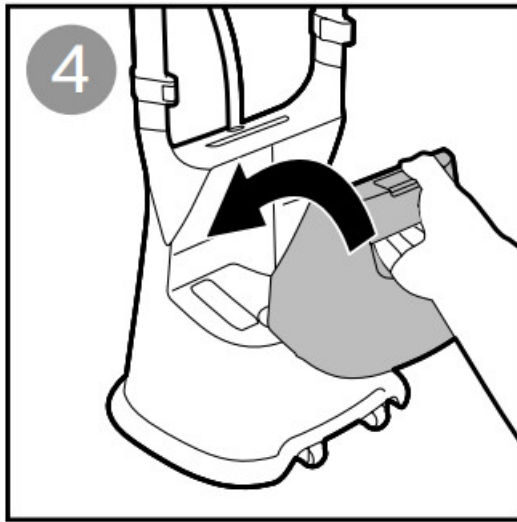

### Type of water to use

The appliance is suitable to be used with tap water. However, if you live in an area with hard water, we recommend that you mix an equal amount of tap water with distilled or demineralized water. This will prevent fast scale build up and prolong the lifetime of the appliance.

**Warning:** Do not use perfumed water, water from the tumble dryer, vinegar, starch, descaling agents, ironing aids, chemically descaled water or other chemicals, as they may cause water spitting, brown staining or damage to your appliance.

**Note:** Do not fill the water tank beyond the MAX indication.

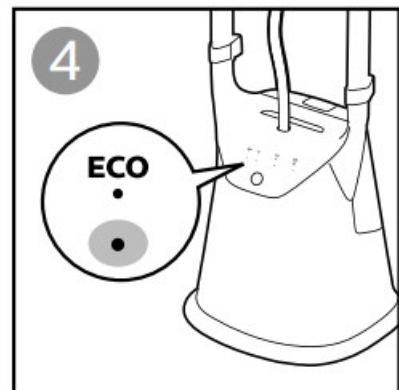
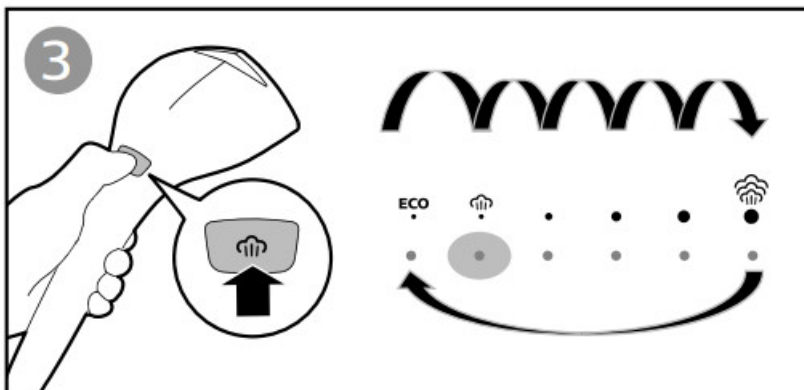
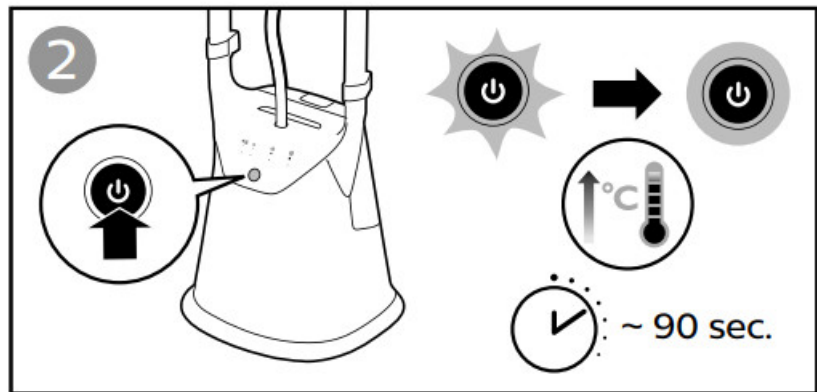
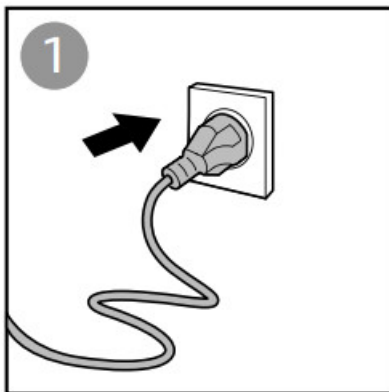



The power button flashes indicating that the appliance is heating up. When the appliance is ready for use after 90 seconds, the light turns steady.

By using the ECO mode (reduced amount of steam), you can save energy without compromising on the ironing result.

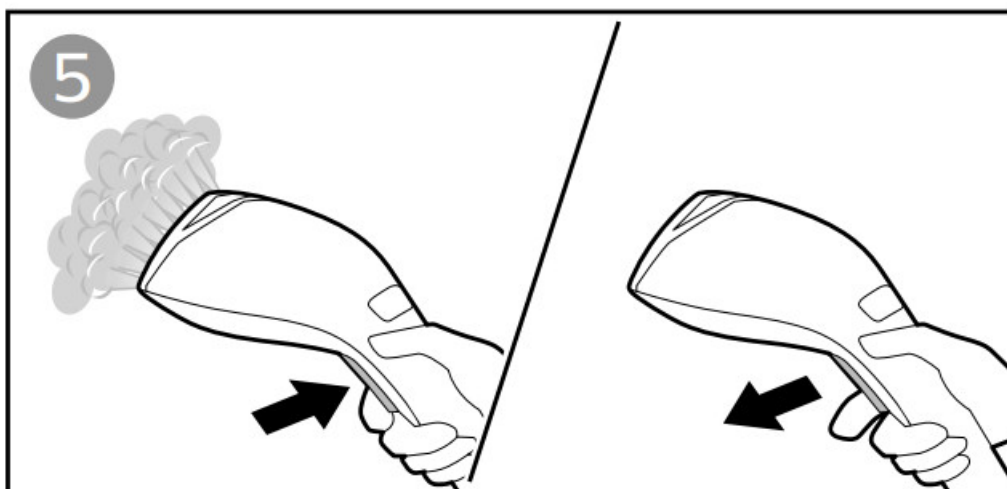

Press and hold the steam trigger to start steaming.  
Release the steam trigger for steam stop.



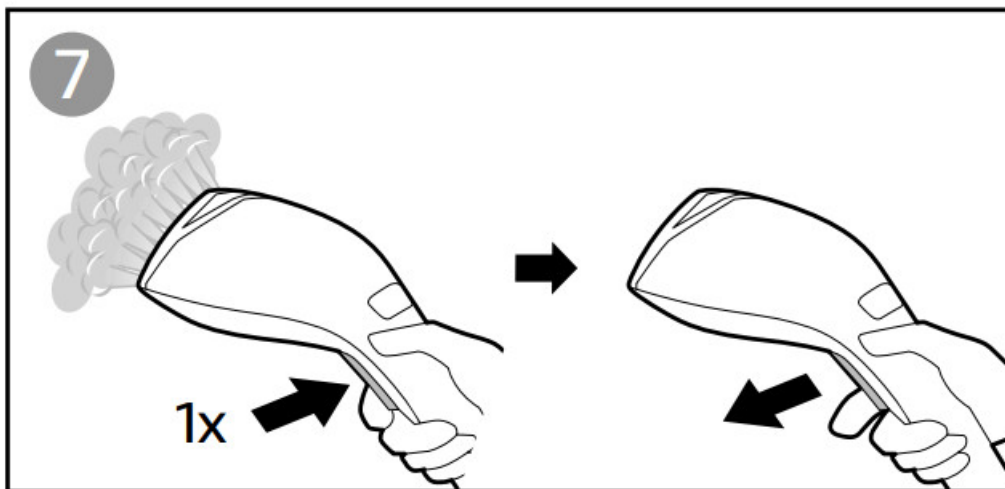
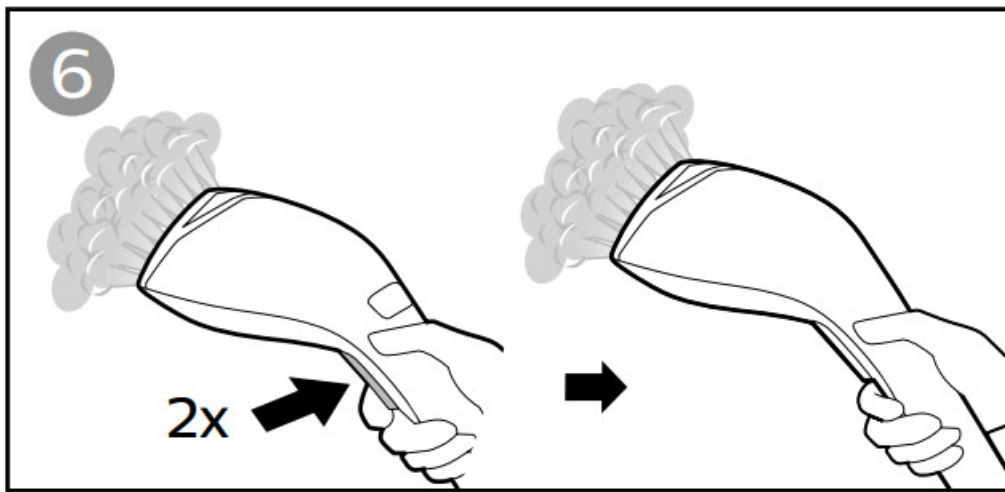

## Steam lock

Double tap the steam trigger for continuous steam.

Press the steam trigger once to deactivate steam lock.

The steam lock comes with automatic release function, which can prevent continuous steaming when the appliance is left unattended.

After 10 minutes activation of steam lock, steam will stop automatically. This is normal.

Double tap on the steam trigger again and steam will be emitted continuously.

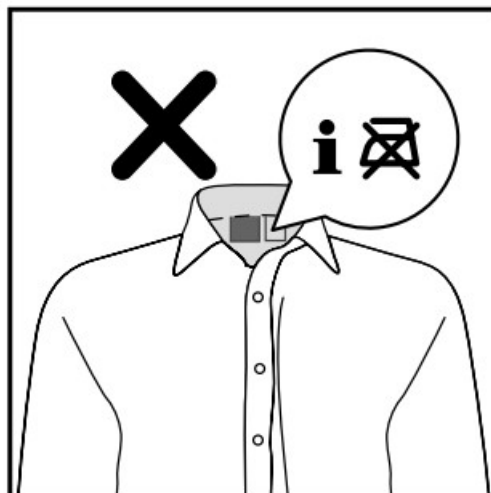
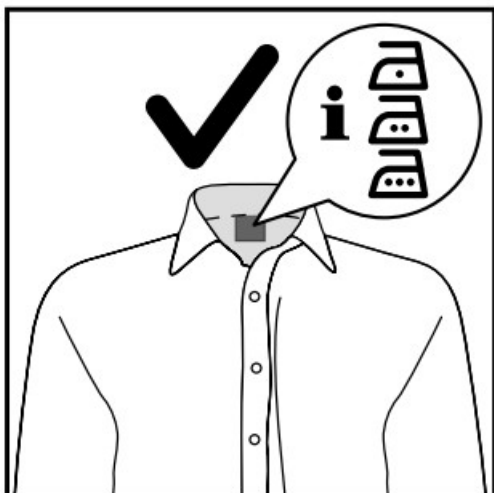

This appliance comes with OptimalTEMP technology steam plate.  
It enables you to steam all types of ironable fabrics, in any order and without sorting your garments.  
**Warning:** Do not steam on non-ironable fabrics.

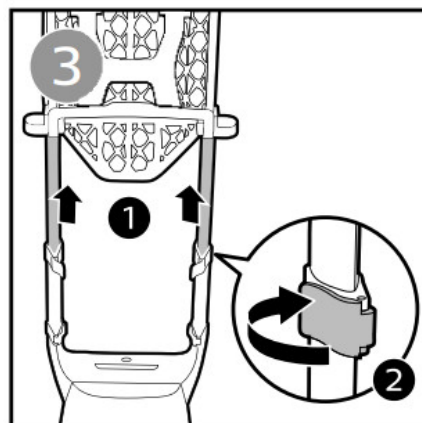
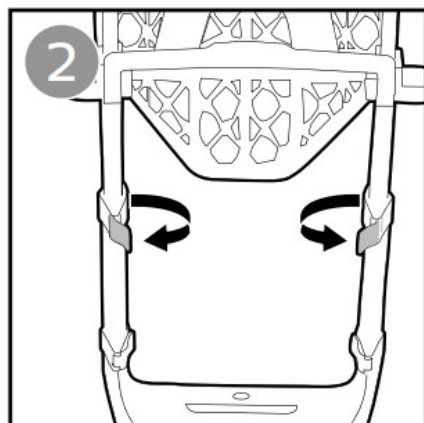
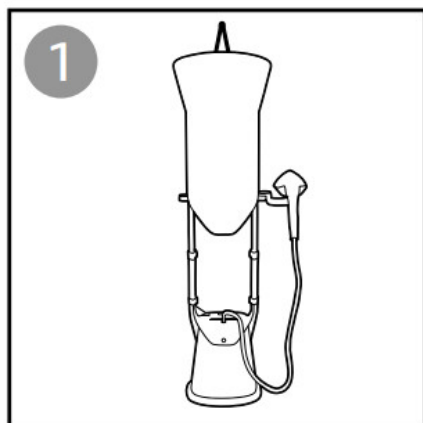

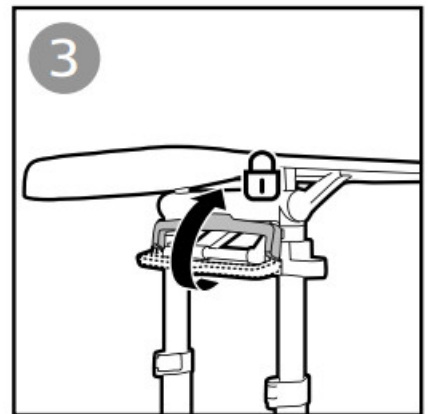
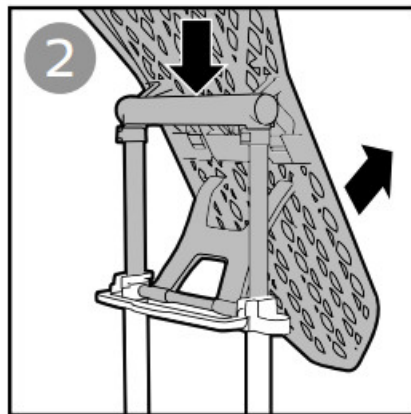
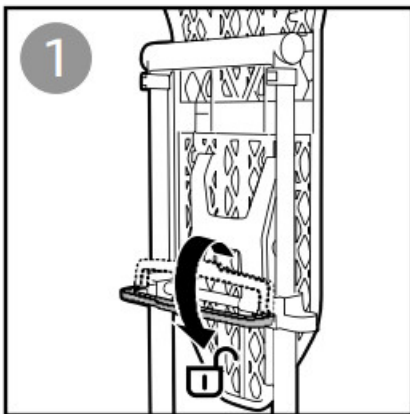
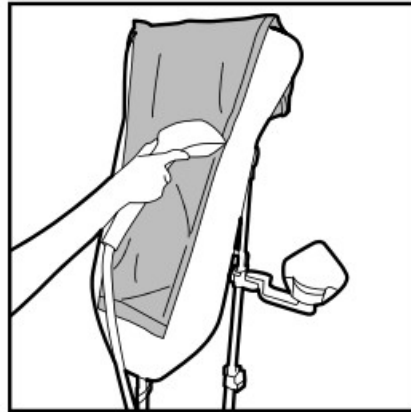
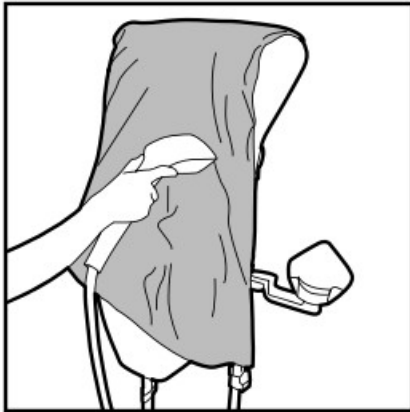
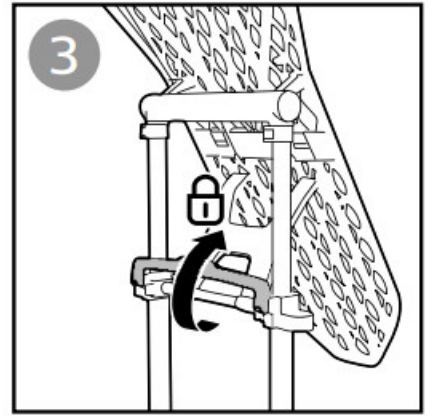
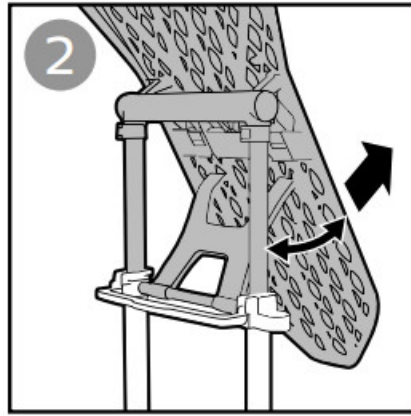
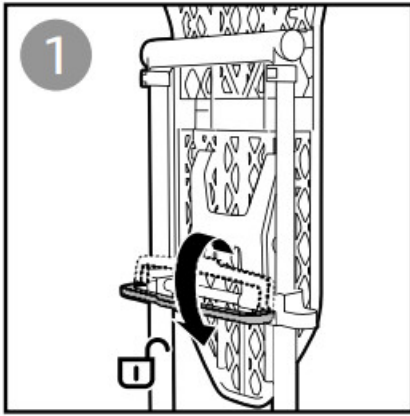

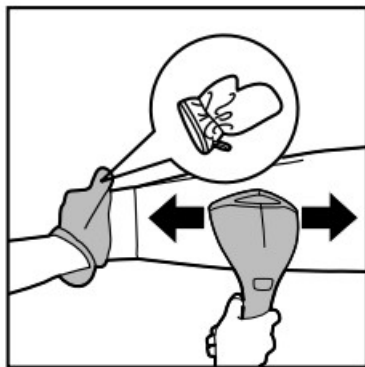
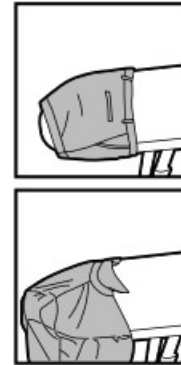
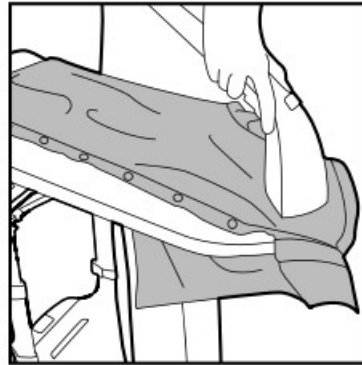
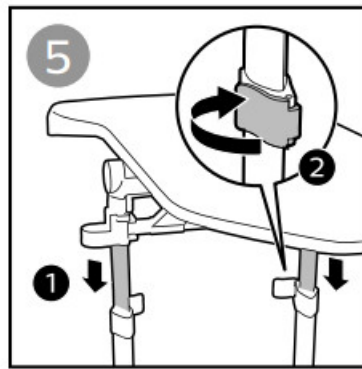
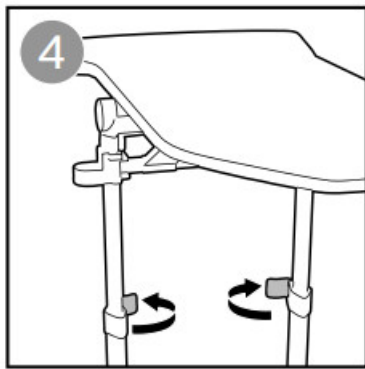

Put the glove on the hand you are using to hold a garment.  
The glove protects your hand against the steam from the steamer head.

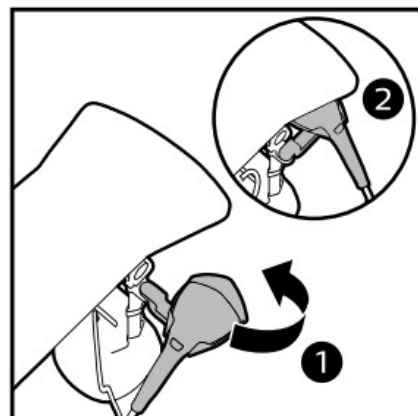
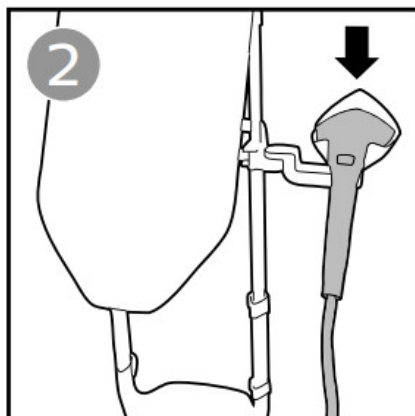
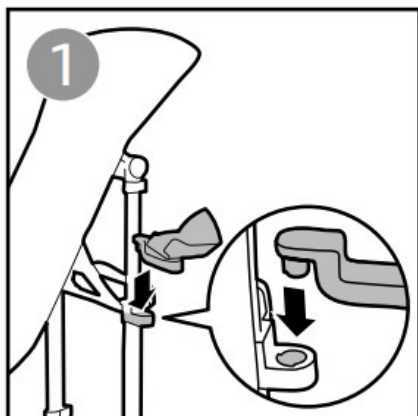

This side docking allows you to access steamer head conveniently without the hassle of reaching high up. You can choose to use the side docking at either the right side or left side of the device.

We recommend you to switch off your continuous steam when you are using the side docking.

Caution: Keep the steamer head away from children to avoid burning.

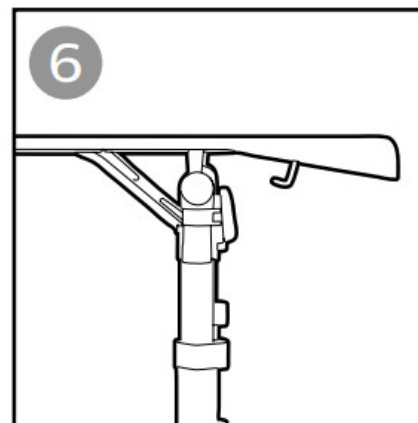
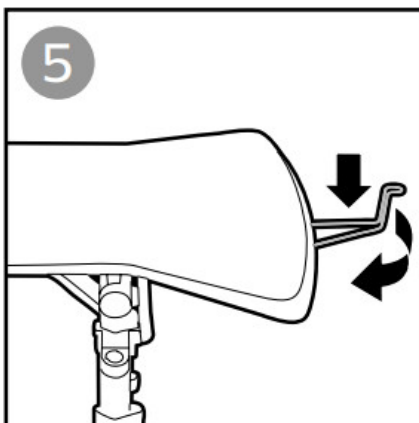
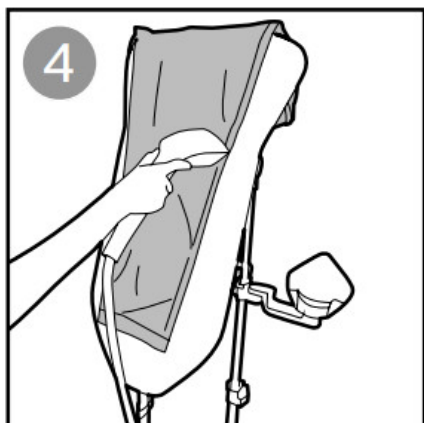
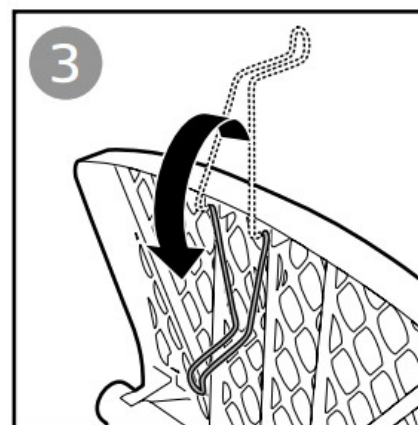
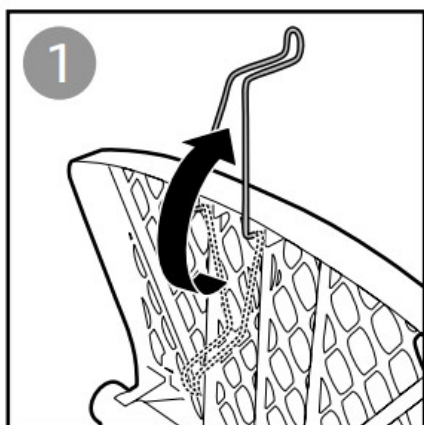

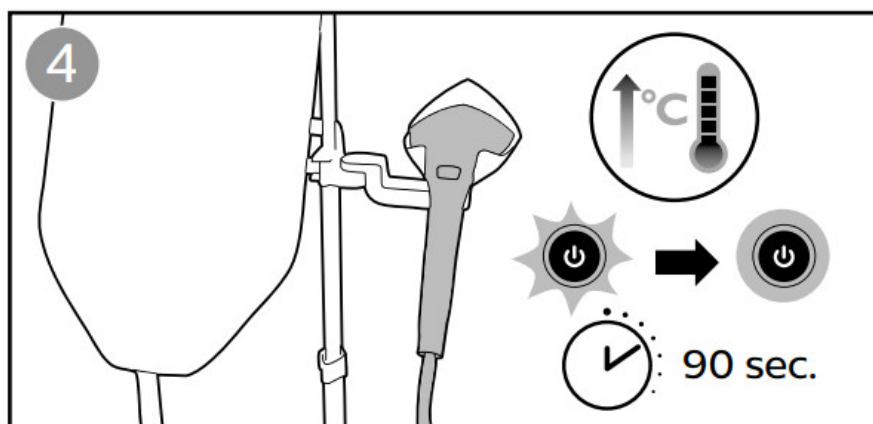
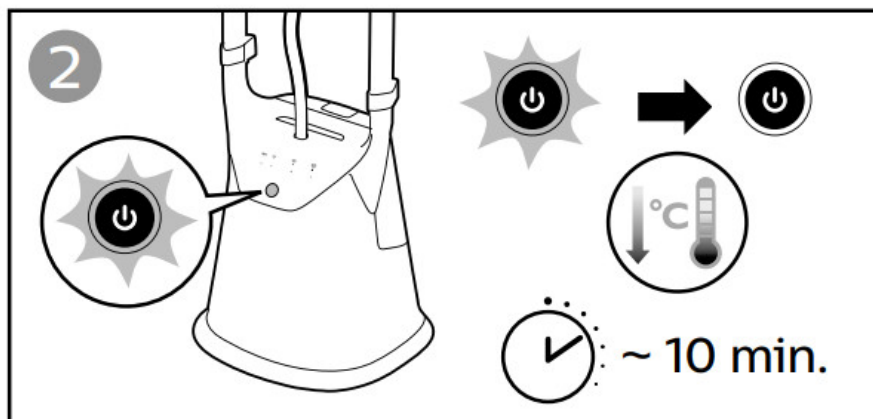
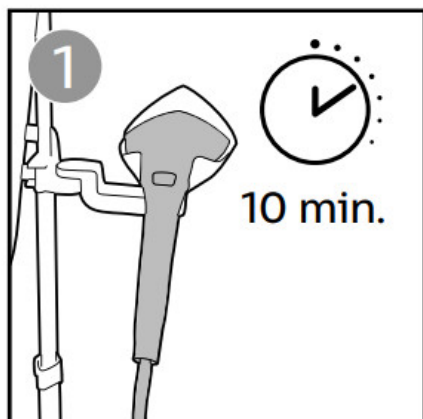

The appliance comes with an auto shut-off feature.

When the steamer head is placed onto the holder and the appliance has not been used for more than 10 minutes, the power button flashes and the appliance starts to cool down. Upon leaving the appliance untouched for the next 10 minutes, it will switch off automatically.

Press the power button to let the appliance reheat.



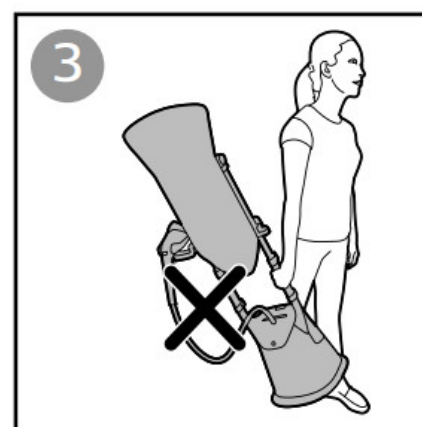
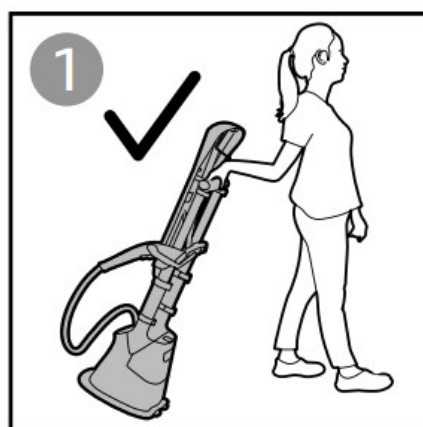
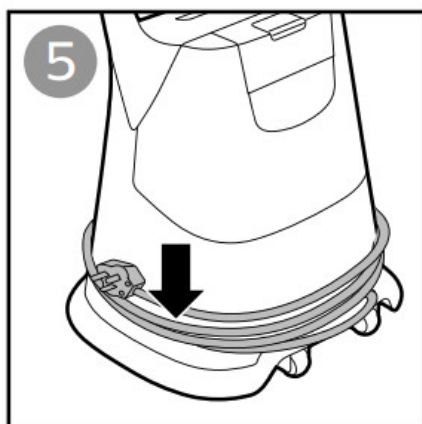
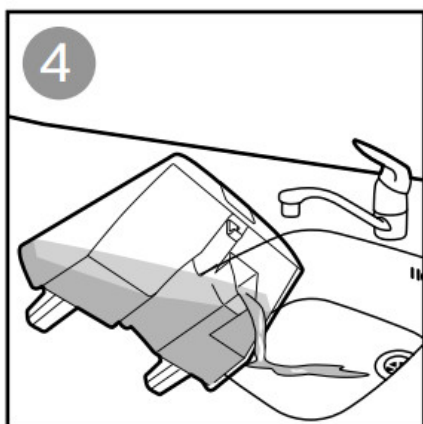
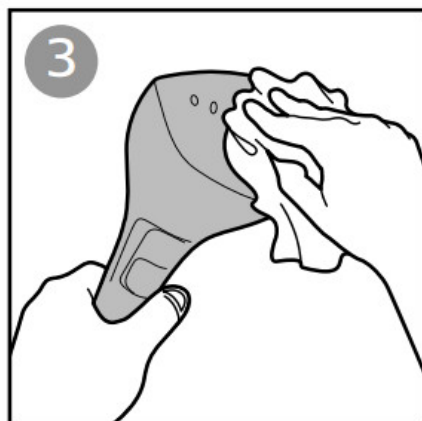
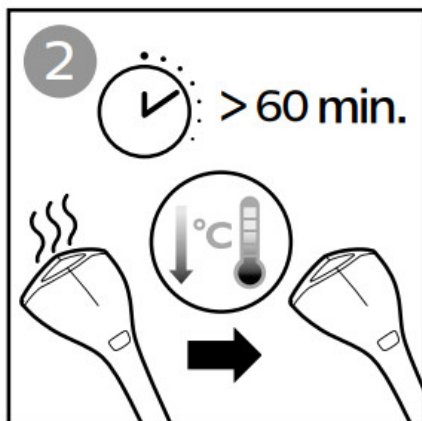
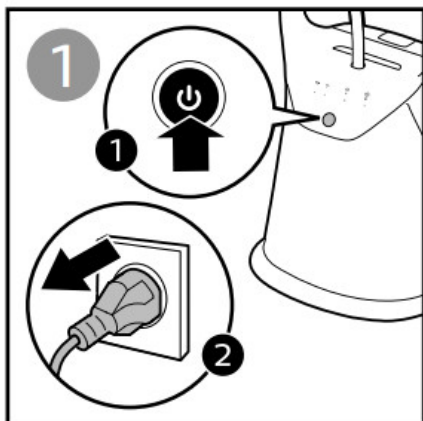



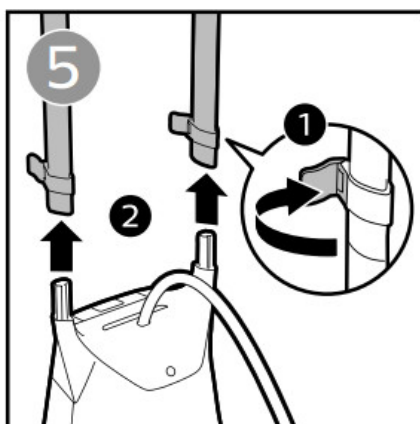
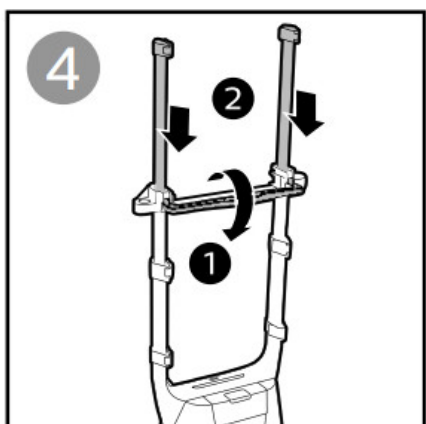
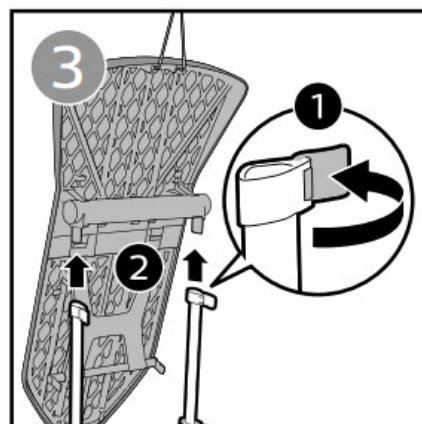
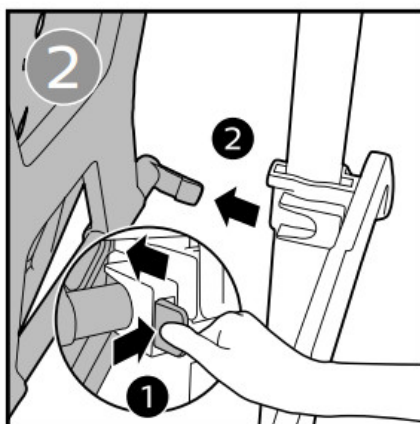
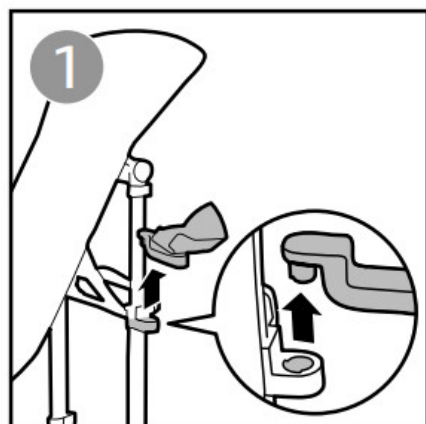

Problem	Possible cause	Solution
The appliance produces no steam.	The steamer has not heated up sufficiently (power button flashes).	Let the appliance heat up for 90 seconds. When the appliance is ready for use, the light turns steady.
	Auto shutoff has been activated when the appliance has not been used for more than 10 minutes (power button flashes).	Press the power button and wait for 90 seconds for the appliance to heat up again.
	Steam trigger has not been pressed to emit steam.	Press the steam trigger to activate steam.
	Low water level in the tank or the tank is not inserted properly.	Refill the water tank and insert it properly.
	Steam lock has been activated for 10 minutes.	Steam lock feature comes with automatic release function. Double tap on the steam trigger again for continuous steam (refer to ).
Water leaks out from the steamer base.	The water tank is not inserted properly.	Insert the tank properly.
	Water tank has been overfilled.	Fill water up to its MAX marking.

Steam lock cannot be activated.	Fail to enter steam lock function.	Double tap to activate the steam lock function ( refer to).
Steam does not stop automatically after placing the steamer head onto the holder.	Steam lock function is activated.	Press once to deactivate steam lock ( refer to ).
The board cover becomes wet or there are water droplets on the garment during steaming.	Steam has condensed on the board cover after a long steaming session.	Leave it to dry before storage. Replace the board cover if it has worn out. Purchase a new board cover from a Philips Authorized Service Center.
Board is shaky during use.	The poles are not installed properly or the board is not secured onto the poles.	Refer to  for correct installation.
	The board lock is not fully inserted.	Insert the two board locks fully until you hear a “click” sound ( refer to  ).
	The board is not fully secure in vertical position.	Make sure that the board tilting lever is in a locked position before attaching it to the poles ( refer to  ).
Board cannot be tilted or be used in horizontal position.	The board lock is not locked onto the pole.	Ensure that the board lock is in a locked position ( refer to  ).
	The board tilting lever has not been released.	Ensure unlocking tilting lever to allow board to be tilted to its desired position. Once a desired position is attained, lock the tilting lever to secure board. ( refer to  )
Water droplets drip from the steamer head, sometimes the appliance produces a creaking sound.	Steam condenses into water in the hose and affect smooth steam flow.	Lift the steamer head to straighten the hose vertically. At the start of a steaming session, set the steam setting to be in MAX mode. Hold the steamer head away from the garment and press the steam trigger for 10 seconds to release the initial gush of water droplets.
Dirty water, brown stains or white flakes come out of the steamer head and stain the garment.	Chemical or additives is added into the water tank.	Never use chemical or additives with the appliance. Fill the water tank with water and allow it to steam out 1 full tank to rinse off chemical residues. For stain on garment, rinse off any stains under running water. For stain on steamer head, wipe any deposits off the steamer head with a damp cloth.

	<p>Depending on where you stay, the water hardness level may be high and results in fast scale builds up.</p>	<p>Ensure that water tank is emptied after a steaming session. It is recommended to use a combination of demineralization/distilled water (50%) mixed with tap water (50%).</p> <p>At the start of a steaming session, set the steam setting to be in MAX mode. Hold the steamer head away from the garment and press the steam trigger for 10 seconds to release the initial gush of water droplets. For stain on garment, rinse off any stains under running water.</p> <p>For stain on steamer head, wipe any deposits off the steamer head with a damp cloth.</p>
--	---	---

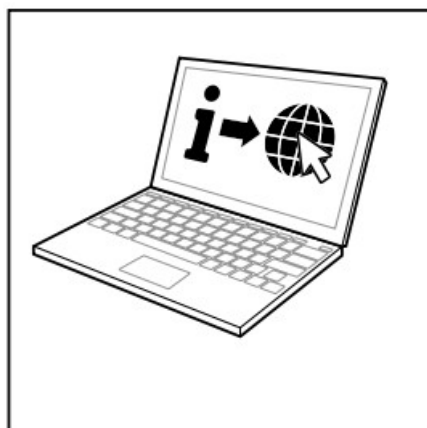

[www.philips.com/support](http://www.philips.com/support)



© 2021 Philips Domestic Appliances Holding B.V.  
All rights reserved.  
4239.001.2026.3 (03/08/2021)

