

PHILIPS
EcoSet
BLE IR
Visual
Controller
Switch



PHILIPS EcoSet BLE IR Visual Controller Switch Instruction Manual

[Home](#) » [Philips](#) » PHILIPS EcoSet BLE IR Visual Controller Switch Instruction Manual 

Contents

- [1 PHILIPS EcoSet BLE IR Visual Controller Switch](#)
- [2 Application](#)
- [3 Product Description](#)
- [4 Function Description](#)
- [5 Matters Needing Attention](#)
- [6 System Application Instructions](#)
- [7 System Application Instructions](#)
- [8 Documents / Resources](#)
 - [8.1 References](#)
- [9 Related Posts](#)

PHILIPS

PHILIPS EcoSet BLE IR Visual Controller Switch



Application

- Application environment Indoor
- Load power LED Max. 3x400W
- Storage temperature -20°C ~ 70°C
- Storage humidity 5% ~ 90% RH
- Operating temperature 0°C ~ 45°C
- Operating humidity 5% ~ 85% RH
- RF transmit power <10dBm
- RF frequency 2400 – 2483.5MHz

The switch parameters in this manual are provided for operation at Ta25°C.

Product Description

Product model	Size
EcoSet BLE IR Visual Controller Switch	86*87*36.5mm

Technical Parameter

1. Power supply mode: 220 ~ 240V AC 5V 1.5A
2. IP Grade: IP20
3. CMIIT ID: 2021DP7059

This equipment contains radio transmission module with model approval code: CMIIT ID: 2021DP7059.

Function Description

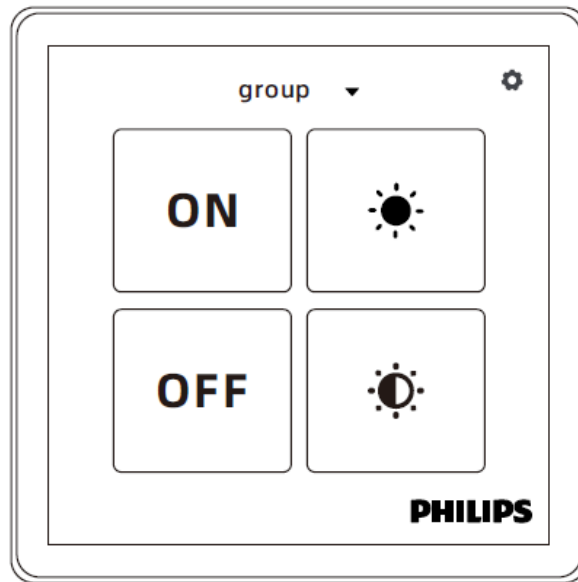

1. "ON " Turns on the luminaire
2. "OFF " Turns off the luminaire
3. Dims up
4. Dims down

Please refer to Ecoseet system application guide for detailed functional description.

Matters Needing Attention

1. Please read this manual carefully before installing or using this product.
2. For wall mounting, have it professionally installed.
3. The switch (radiation direction) should not be blocked by metal (conductor) objects, to ensure the optimum efficiency of signal transmission.
4. Switches are located as far away as possible from radiation sources such as transformers and switching devices; the further away from the source of interference, the better the RF performance.
5. Keep the switch away from signal devices such as router (Zigbee and Wi-Fi, etc.)
6. The switch shall be protected from corrosive environment and harmful substances such as sulfide, halide, phthalates and other environments.
7. The switch can be cleaned with a dry cloth dampened with a small amount of alcohol at a low concentration (70%-75%), never with water or with aggressive cleaning agents.
8. Considering the impact of metal structures on wireless signals, do not cover or obstruct the wireless antenna on the switch with metal (as shown in the figure). During on-site use, ensure that the switch is kept away from surrounding metal pipes, concrete steel structures, and other materials to minimize their negative effects on wireless signals. If there are metal pipes, concrete steel structures, or other obstructions between the switch and the receiver, it will affect the transmission distance of the wireless signal.

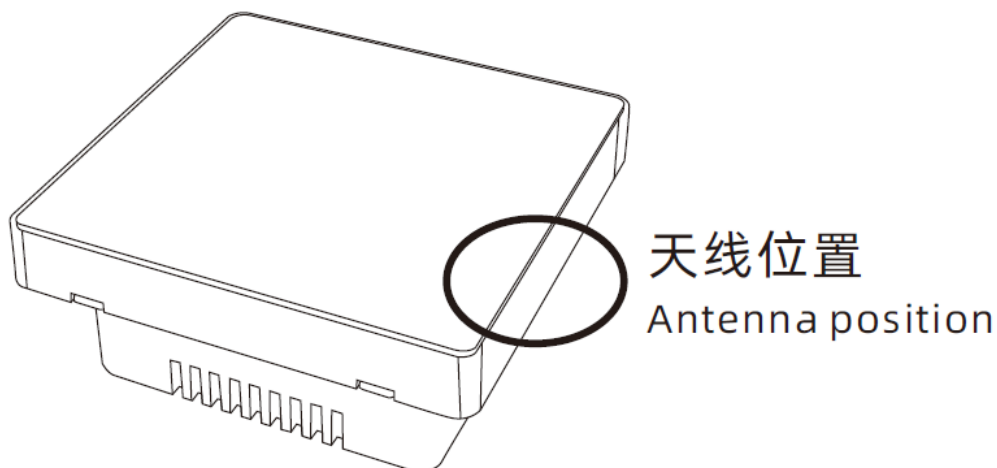

9. Please make sure to carefully read the key instructions of installation and system application related to your target application to ensure system performance.

Office Application

1. Before installation, please ensure the main power supply is turned off.
2. Follow the installation steps to mount this product inside an 86-type switch box on the wall.
3. Using the wiring diagram, connect the live wire to the L terminal, the neutral wire to the N terminal, and the load (light) wires to the L1, L2, and L3 terminals. After verifying that the wiring is correct, tighten the terminal screws.

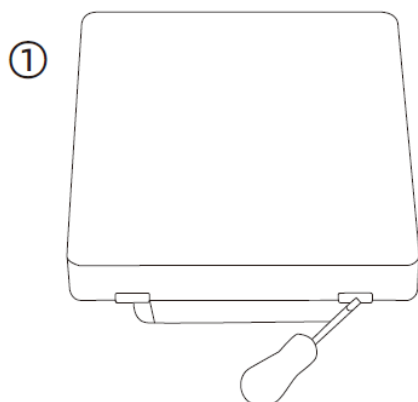

取下控制面板，请小心使用一字螺丝刀，以免损伤到产品
Remove the visual controller.
Use a flat-head screwdriver carefully to avoid damaging the product.

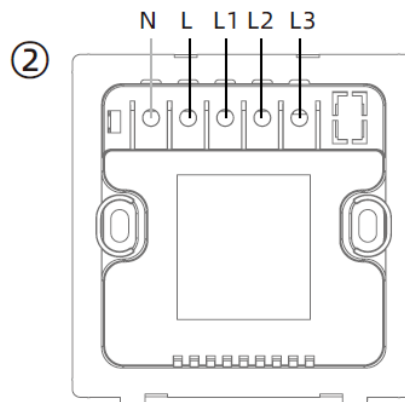

1. Remove the visual controller. Use a flat-head screwdriver carefully to avoid damaging the product.
2. Wiring diagram
3. Screw the bottom shell onto the 86-type switch box on the wall

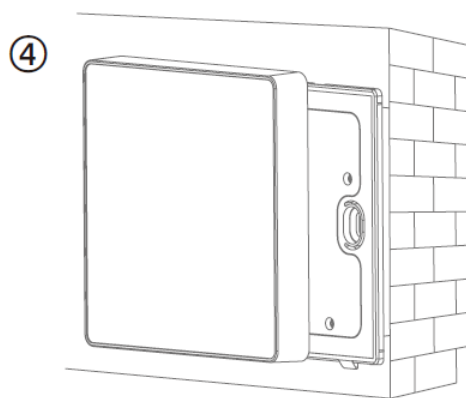
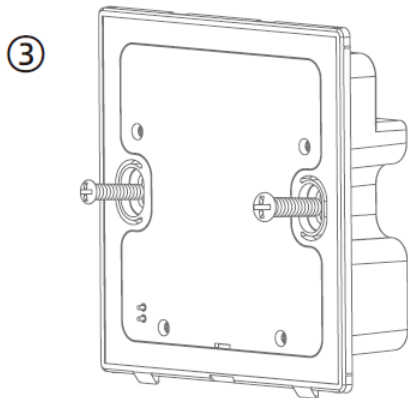

4. Clip the faceplate onto the bottom shell.
5. If removing the screen from the wall, one-touch commissioning and auto reset functions no longer work. Tighten the power base box screws until the bottom shell is secure and does not move, but avoid overtightening to prevent the visual controller and power base box from fitting unevenly or loosely.

System Application Instructions

1. The visual controller can create and save up to 30 new networks, including those created through both "One-touch commissioning" and "New group". For functional explanations of "One-touch commissioning" and "New group", please refer to the application guide.
2. "One-touch commissioning"
"One-touch commissioning" feature relies on a relay to automate grouping. This system triggers the grouping signal through a relay switch on/off, so the target luminaires and sensors need to be physically connected in the same electrical circuit with the relay to achieve the one-touch commissioning functionality. "New Group" feature allows users to create a new group, and components such as luminaires and sensors need to be manually added to the group by the user.
3. Each network can support up to 50 node devices (including the visual controller, sensor, luminaire), but the specific number may be depended on the signal quality in the actual scenario, potentially prevent it from reaching the full capacity of 50 node devices.
4. These key functions will not be saved after power-off: Demo mode, All lights (+/- /On/Off), Home page (+/- /On/Off), Motion sensor, etc.
5. To check if a luminaire has been added to the network, user can click the "blink" function for verification. By clicking "blink", if the luminaire responds and flashes once, it shows that the luminaire has successfully joined the network.
6. In office applications, each luminaires can only be part of one network, but within a single network, there can be multiple sensors or luminaires.

Industry Application

1. Available for separated purchase.
2. 5V 1.5A power supply is required when the visual controller is removed for stand-alone use.

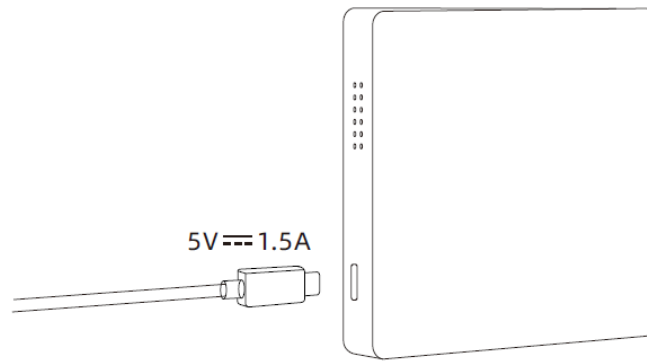

Product Description

Product model	Size
EcoSet BLE IR Visual Controller	86*87*13mm

System Application Instructions

1. The visual controller can create and save up to 30 new networks.
2. In warehouse application, sensors and luminaires are integrated. Each network can support up to 50 node devices (including the visual controller, sensor, luminaire), but the specific number may be depended on the signal quality in the actual scenario, potentially prevent it from reaching the full capacity of 50 node devices.
3. These key functions will not be saved after power-off: Demo mode, All lights (+/-), Home page (+/-), Motion sensor, etc.
4. To check if a luminaire has been added to the network, user can click the “blink” function for verification. By clicking “blink”, if the luminaire responds and flashes once, it shows that the luminaire has successfully joined the network.

The names and contents of harmful substances in the product (Only for China)

	(Pb)	(Hg)	(Cd)	(Cr6+)	(PBB)	(PBDB)
PCB	X	○	○	○	○	○
SJ/T11364. ○: GB/T25672 : GB/T25672						

Signify Luminaires (Shanghai) Co., Ltd
 Address: 2F Building 1, No.2555 Hechuan Road,
 Minhang District, Shanghai
Zip code: 200233

Documents / Resources



[PHILIPS EcoSet BLE IR Visual Controller Switch](#) [pdf] Instruction Manual
EcoSet BLE IR Visual Controller Switch, EcoSet, BLE IR Visual Controller Switch, Visual Controller Switch, Controller Switch, Switch

References

- [User Manual](#)

[Manuals+](#), [Privacy Policy](#)

This website is an independent publication and is neither affiliated with nor endorsed by any of the trademark owners. The "Bluetooth®" word mark and logos are registered trademarks owned by Bluetooth SIG, Inc. The "Wi-Fi®" word mark and logos are registered trademarks owned by the Wi-Fi Alliance. Any use of these marks on this website does not imply any affiliation with or endorsement.