



# PHILIPS DUS90AHB-D Dynalite Multifunction Sensor Instruction Manual

[Home](#) » [Philips](#) » PHILIPS DUS90AHB-D Dynalite Multifunction Sensor Instruction Manual 

## PHILIPS DUS90AHB-D Dynalite Multifunction Sensor Instruction Manual





Devices must be installed by a qualified electrician in accordance with all national and local electrical and construction codes and regulations.

### Warnings

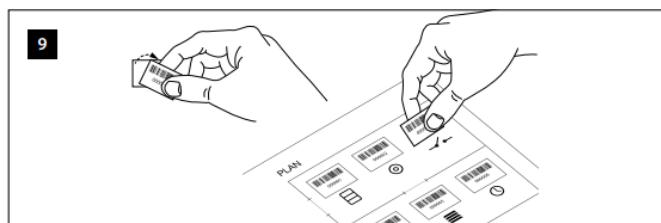
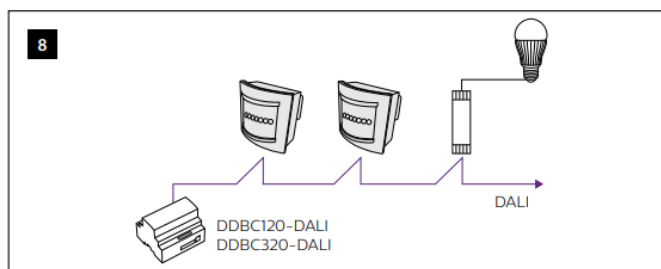
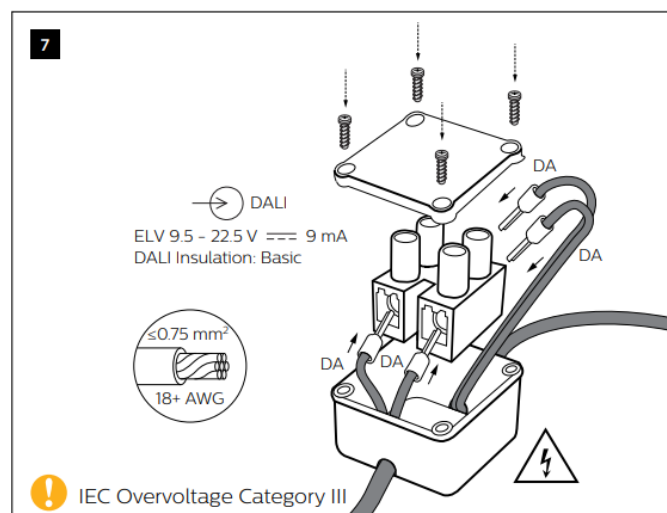
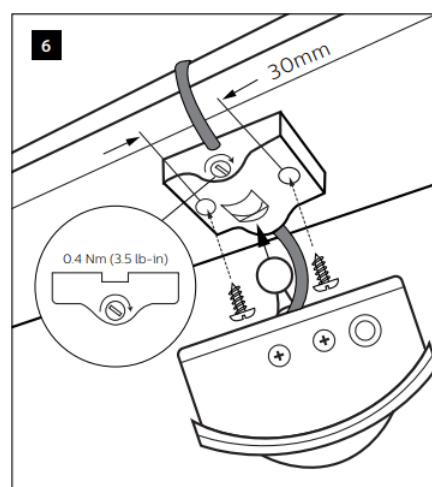
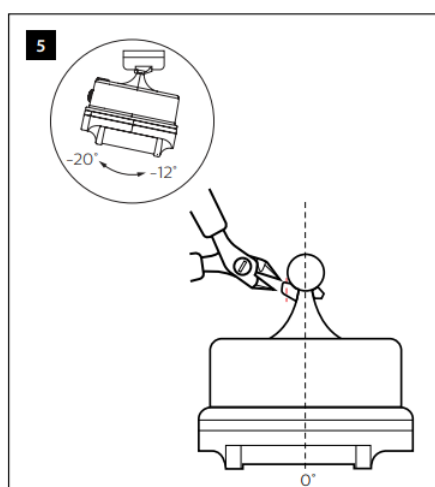
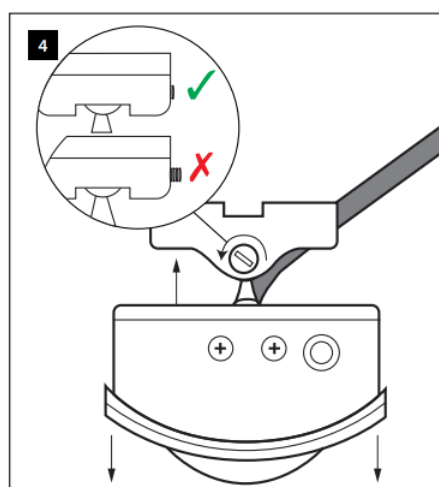
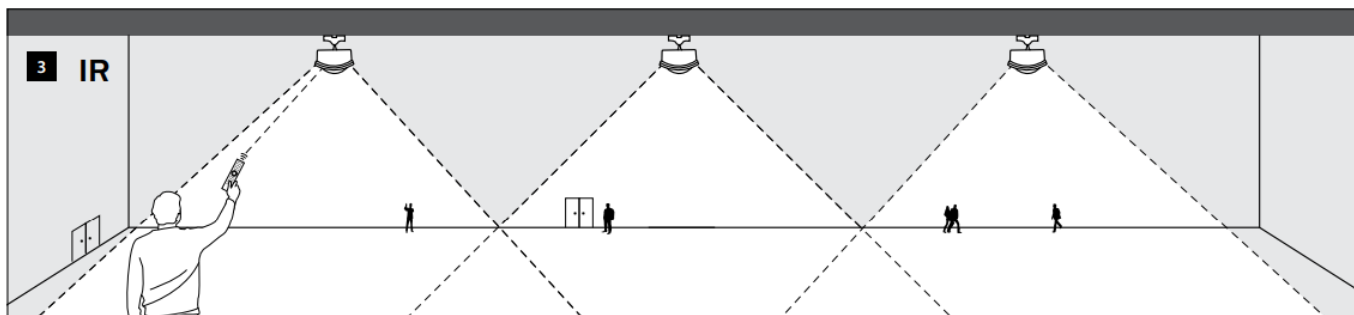
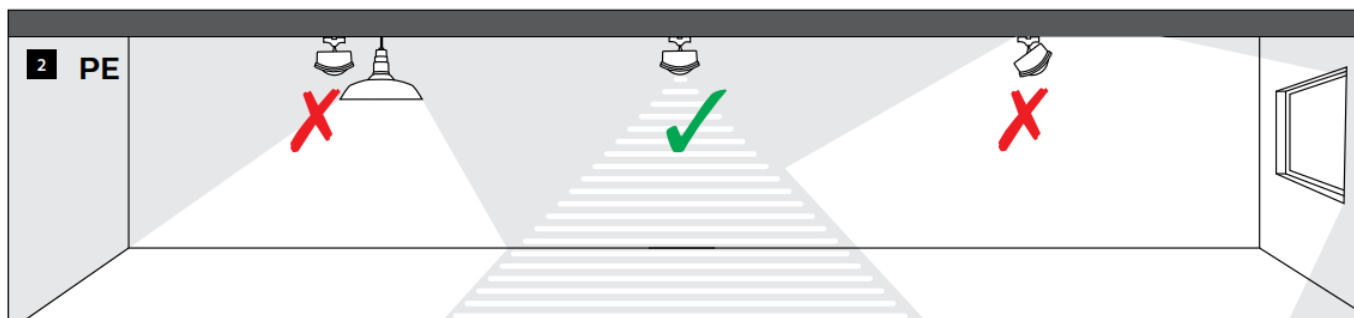



-  Do not connect inputs to mains. DALI wires are NOT SELV and should never be considered touch safe.
-  Refer to Service Guide for full cleaning recommendations.
-  Installation of a home and building automation and control system shall comply with IEC 60364 (all parts). The temperature limits and current-carrying capacities for the communication wires specified in IEC 60364-5-52 shall not be exceeded.

© 2022 Signify Holding. All rights reserved. Specifications are subject to change without notice. No representation or warranty as to the accuracy or completeness of the information included herein is given and any liability for any action in reliance thereon is disclaimed. Philips and the Philips Shield Emblem are registered trademarks of Koninklijke Philips N.V. All other trademarks are owned by Signify Holding or their respective owners.

<http://www.dynalite.com/>

**Documents / Resources**

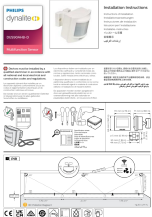
	<p><b><a href="#">PHILIPS DUS90AHB-D Dynalite Multifunction Sensor</a></b> [pdf] Instruction Manual DUS90AHB-D, Dynalite, Multifunction Sensor, Dynalite Multifunction Sensor, DUS90AHB-D Dynalite Multifunction Sensor, Sensor</p>
---	---

**References**

-  [Philips Dynalite - Lighting Controls, Lighting Management](#)