



PHILIPS DMRC210 Relay Controller Instruction Manual

[Home](#) » [Philips](#) » PHILIPS DMRC210 Relay Controller Instruction Manual 

Contents

- [1 PHILIPS DMRC210 Relay Controller](#)
- [2 Installation Instructions](#)
- [3 WHATS IN THE BOX?](#)
- [4 TOOLS](#)
- [5 DIMENSION](#)
- [6 INSTALLATION](#)
- [7 SPECIFICATION](#)
- [8 WIRING](#)
- [9 CONNECTION](#)
- [10 Documents / Resources](#)
 - [10.1 References](#)
- [11 Related Posts](#)

PHILIPS

PHILIPS DMRC210 Relay Controller



Installation Instructions

Devices must be installed by a qualified electrician in accordance with all national and local electrical and construction codes and regulations

WHATS IN THE BOX?

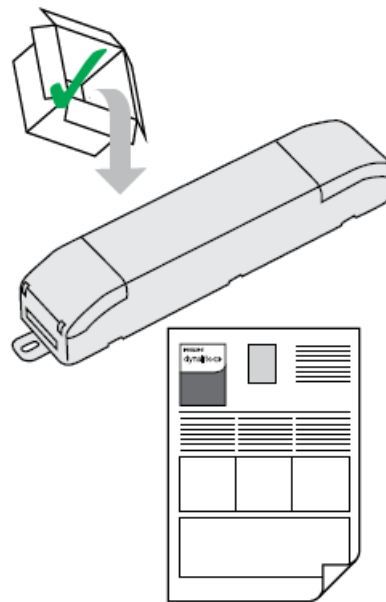

TOOLS

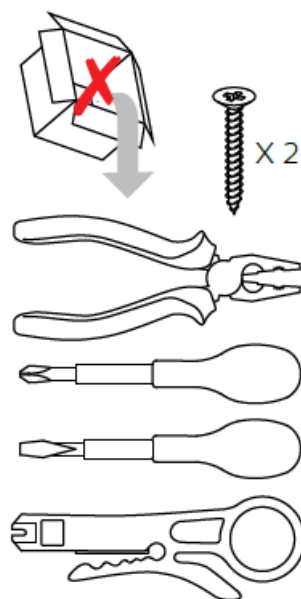

DIMENSION

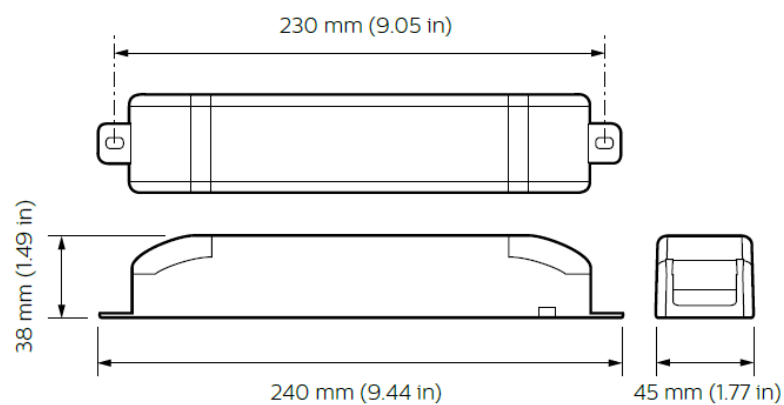

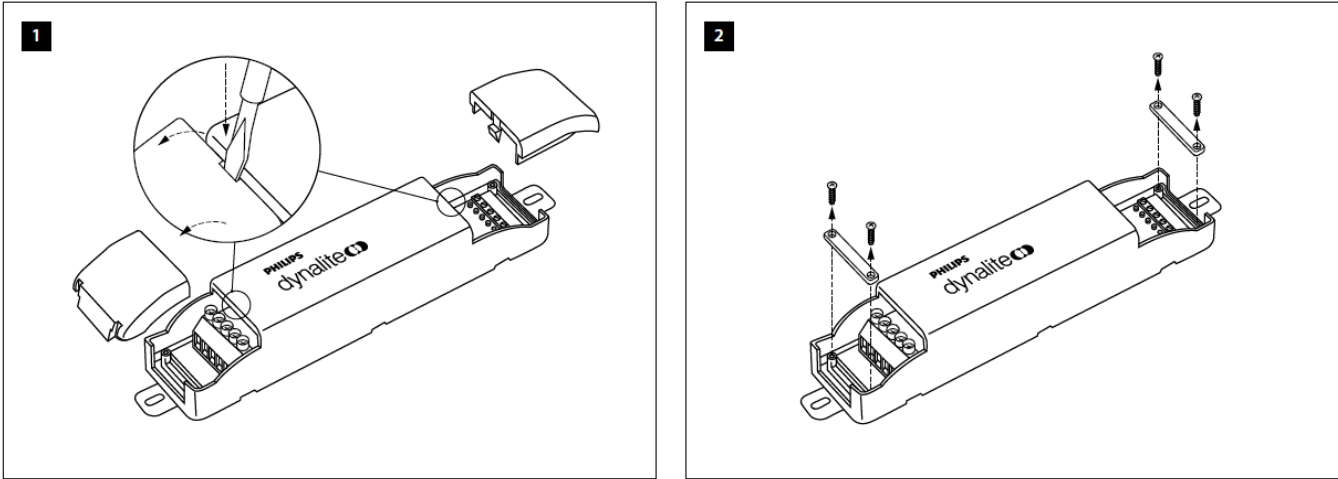

INSTALLATION



SPECIFICATION

4

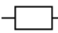
Output Ratings/Channel (CH)

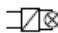
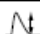
Load Type	CH1-CH2
 General Use	10 A, 240 V ~
 Incandescent	5 A, 240 V ~
 Electronic Ballast	3 A, 240 V ~
 Inrush Current	165 A

Output Ratings/Group

$DMRC210 \leq 20\text{ A}$

5

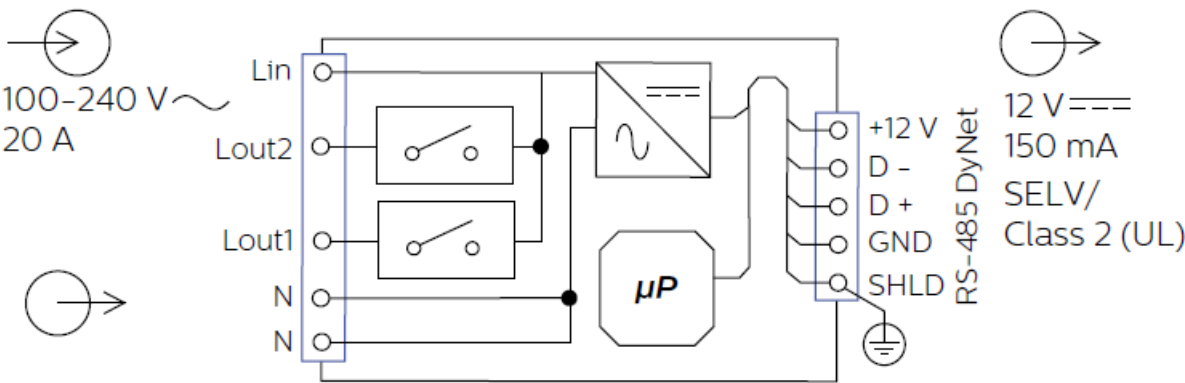

WIRING

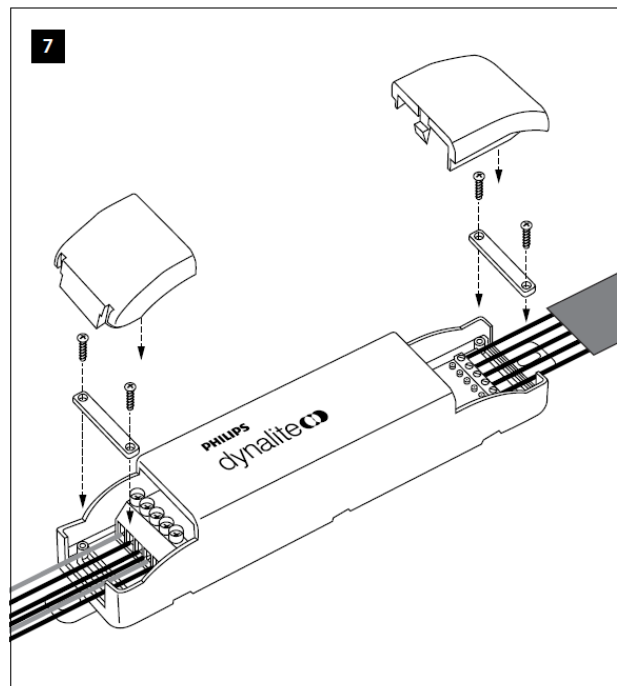
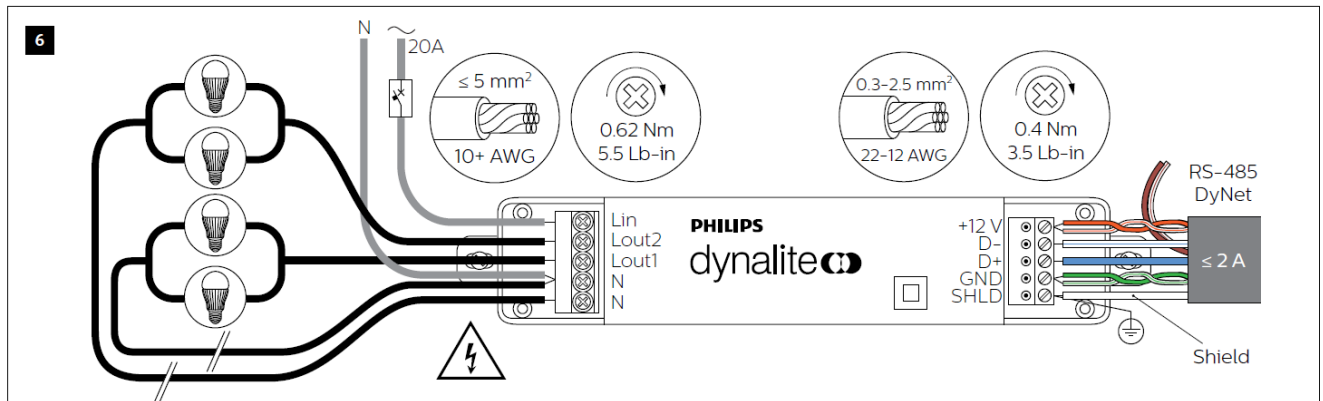



CONNECTION

2022 Signify Holding. All rights reserved. Specifications are subject to change without notice. No representation or warranty as to the accuracy or completeness of the information included herein is given and any liability for any action in reliance thereon is disclaimed. Philips and the Philips Shield Emblem are registered trademarks of Koninklijke Philips N.V. All other trademarks are owned by Signify Holding or their respective owners

www.dynalite.com

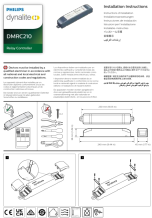
Documents / Resources

	<p>PHILIPS DMRC210 Relay Controller [pdf] Instruction Manual DMRC210 Relay Controller, DMRC210, Relay Controller, Controller</p>
	<p>PHILIPS DMRC210 Relay Controller [pdf] Instruction Manual DMRC210 Relay Controller, DMRC210, Relay Controller, Controller</p>

References

-  [Philips Dynalite - Lighting Controls, Lighting Management](#)