



PHILIPS DMBC110 Signal Dimmer Controller Instruction Manual

[Home](#) » [Philips](#) » PHILIPS DMBC110 Signal Dimmer Controller Instruction Manual 



Contents

- 1 DMBC110**
 - 1.1 Signal Dimmer Controller
 - 1.2 Installation Instructions
- 2 Documents / Resources**
 - 2.1 References
- 3 Related Posts**

DMBC110

Signal Dimmer Controller

Installation Instructions





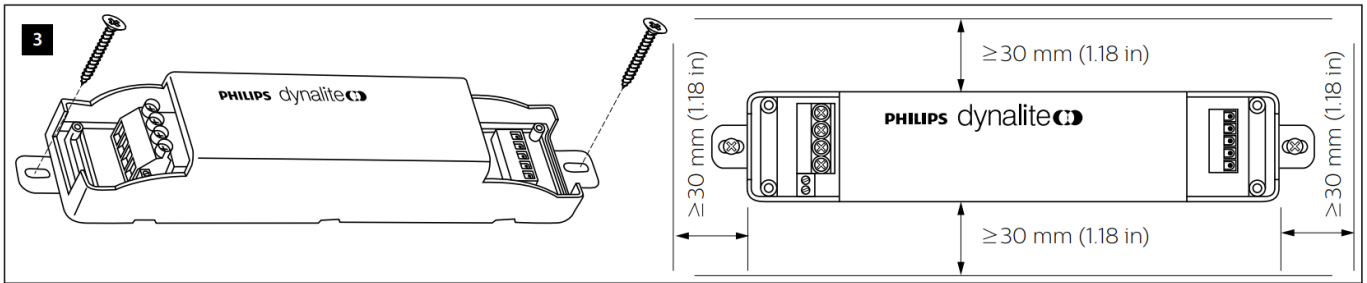
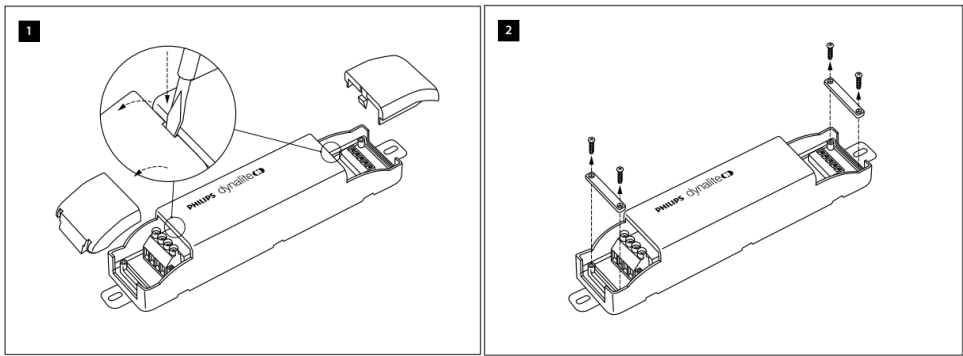
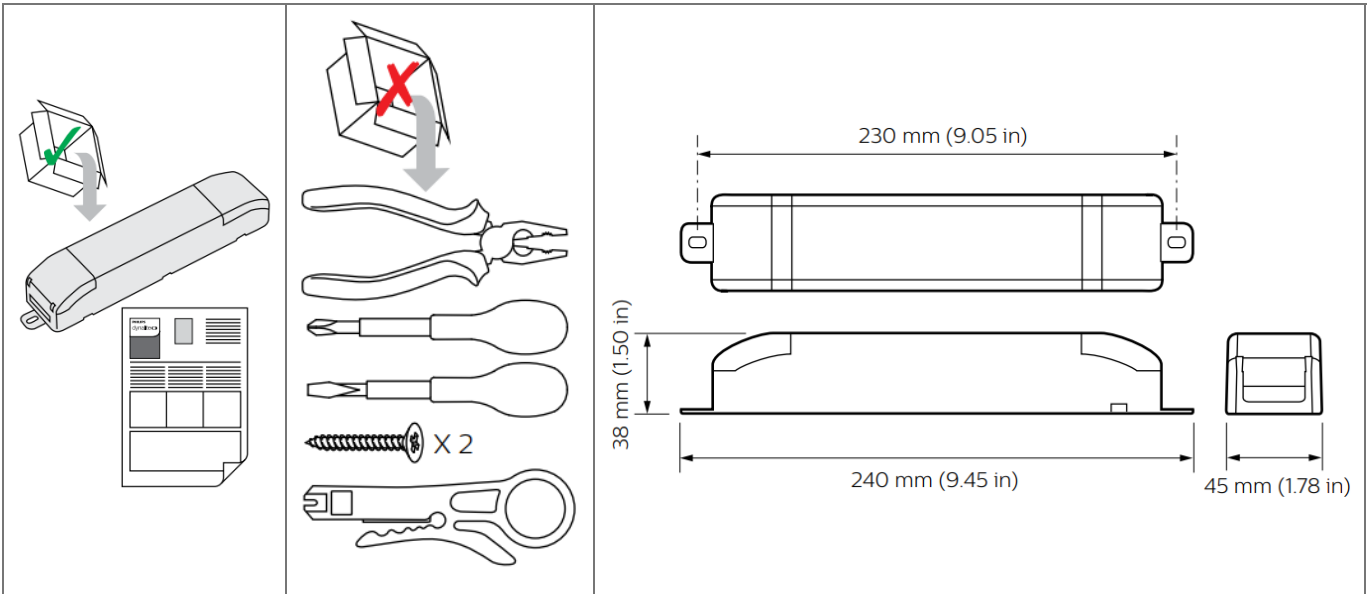

Devices must be installed by a qualified electrician in accordance with all national and local electrical and construction codes and regulations.



IEC Pollution Degree II

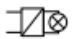

Output Ratings/Channel (CH)

Load Type	
 General Use	10 A, 240 V ~
 Electronic Ballast	3 A, 240 V ~
 Inrush Current	165 A

Control Channel Ratings

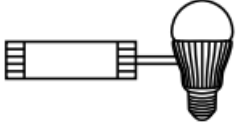
	
DALI Broadcast	$\leq 5/\text{CH}$ Guaranteed 10 mA Maximum 250 mA Insulation: basic
DSI	$\leq 5/\text{CH}$
1-10 V	Sink 20 mA Source 10 mA

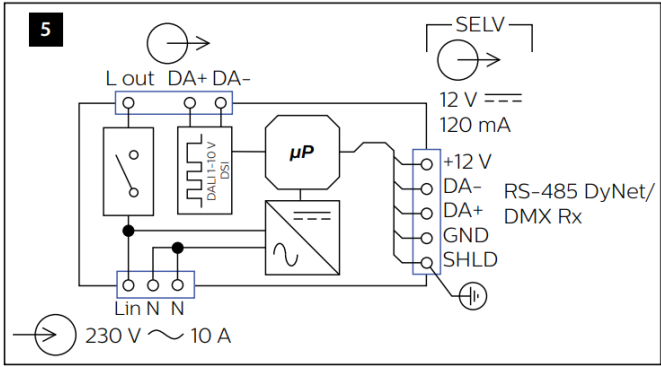

IEC Overvoltage Category III

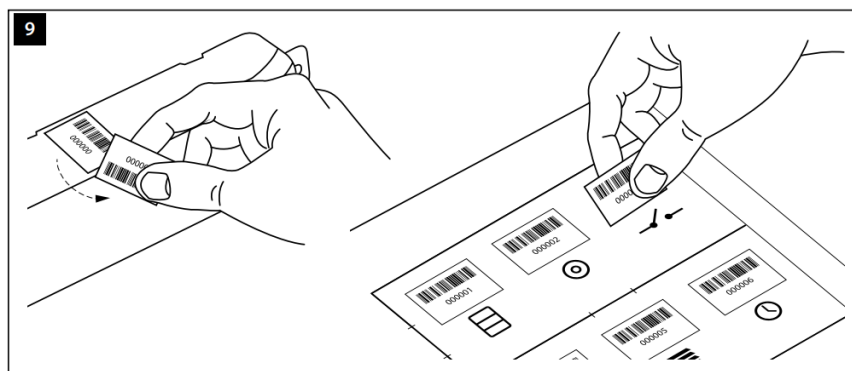
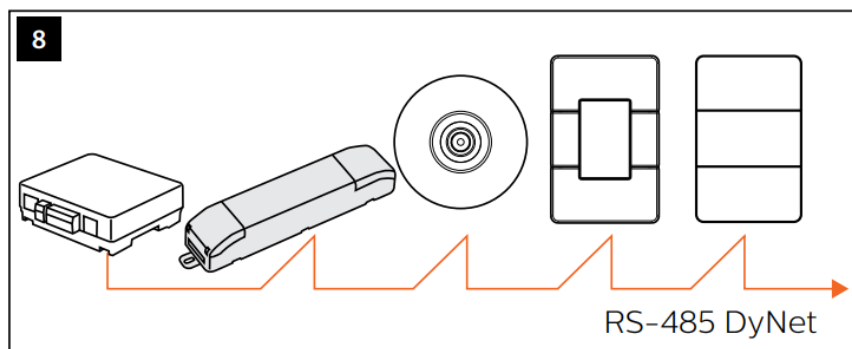
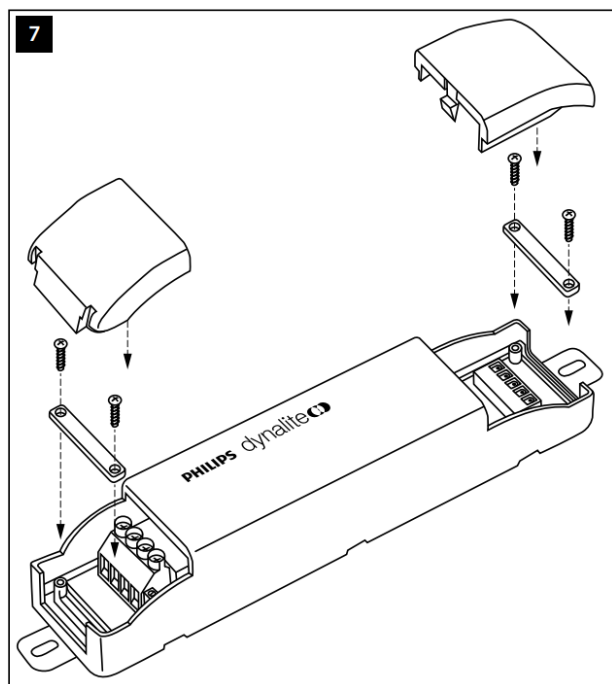
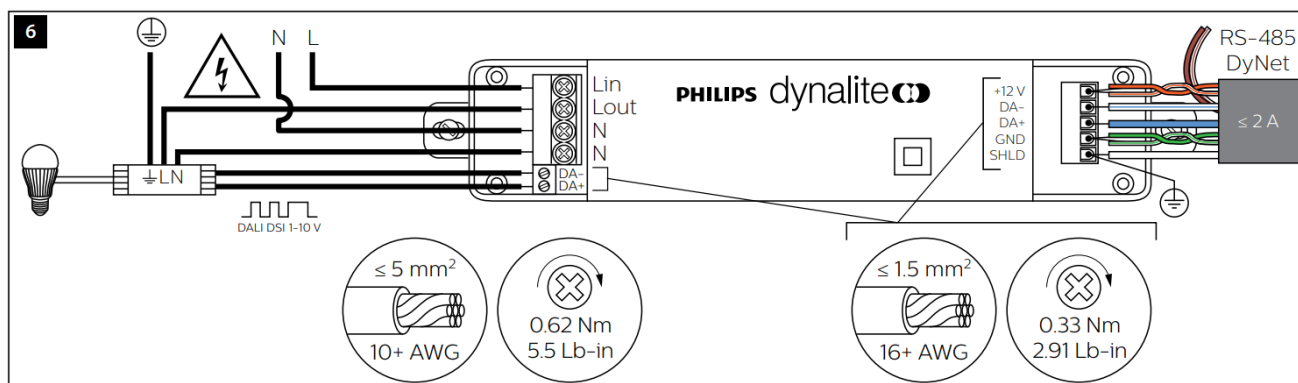



© 2022 Signify Holding. All rights reserved. Specifications are subject to change without notice. No representation or warranty as to the accuracy or completeness of the information included herein is given and any liability for any action in reliance thereon is disclaimed. Philips and the Philips Shield Emblem are registered trademarks of Koninklijke Philips N.V. All other trademarks are owned by Signify Holding or their respective owners.

www.dynalite.com



AZZ 394 0922 R15

Documents / Resources

	<p>PHILIPS DMBC110 Signal Dimmer Controller [pdf] Instruction Manual DMBC110 Signal Dimmer Controller, DMBC110, Signal Dimmer Controller, Dimmer Controller, Controller</p>
	<p>PHILIPS DMBC110 Signal Dimmer Controller [pdf] Instruction Manual DMBC110 Signal Dimmer Controller, DMBC110, Signal Dimmer Controller, Dimmer Controller, Controller</p>

References

-  [Philips Dynalite - Lighting Controls, Lighting Management](#)