

PHILIPS DMAL120F Dynalite Network Devices



PHILIPS DMAL120F Dynalite Network Devices Instructions

[Home](#) » [Philips](#) » PHILIPS DMAL120F Dynalite Network Devices Instructions 

Contents

- [1 PHILIPS DMAL120F Dynalite Network Devices](#)
- [2 Product Information](#)
- [3 Product Usage Instructions](#)
- [4 Product data](#)
- [5 Dynalite Network Devices](#)
- [6 Documents / Resources](#)
 - [6.1 References](#)
- [7 Related Posts](#)



PHILIPS DMAL120F Dynalite Network Devices



Product Information

- **Specifications**

- **Product Name:** DMAL120F
- **Product Code:** 871869600143100
- **Order Code:** 913703061609
- **Material No (12NC):** 913703061609
- **Numerator – Quantity Per Pack:** 1
- **EAN/UPC – Product/Case:** 8718696001431
- **Numerator – Packs per outer box:** 1
- **EAN/UPC – Case:** 8718696008935

- **General Information**

- The DMAL120F is a network device provided by Dynalite to facilitate a seamless installation of different devices.
- It is designed to bring all the different devices together for a problem-free installation.

- **Remarks**

- **CE mark:** Yes
- **EU RoHS compliant:** Yes

- **Temperature**

- **The DMAL120F operates within the following ambient temperature range:**
 - Ambient temperature range: [insert temperature range]

- **Dimensional Drawing**

- **The DMAL120F has the following dimensions:**
 - **Length:** 230 mm (9.06 in)
 - **Width:** 38 mm (1.50 in)
 - **Height:** 240 mm (9.45 in)
 - **Weight:** 45 mm (1.77 in)

- **Product Data Sheet**

- Please download the Lighting – Product Data Sheet for more information and ordering options.
- The data sheet contains detailed information about the DMAL120F and its specifications.

- **Order Product Name**

- The order product name for the DMAL120F is DMAL120F.
- For any further inquiries or information, please visit www.lighting.philips.com.

Product Usage Instructions

- **Installation**

- Follow the steps below to install the DMAL120F:
- Ensure that all the required devices are properly connected to the network.
- Locate a suitable location for the DMAL120F.
- Mount the DMAL120F securely using appropriate mounting hardware.
- Make sure all connections are securely tightened.
- Connect the DMAL120F to the power source.

- **Configuration**

- To configure the DMAL120F, follow these steps:
- Ensure that the DMAL120F is properly installed and powered on.
- Access the DMAL120F configuration interface by entering its IP address into a web browser.
- Follow the on-screen instructions to configure the desired settings.
- Save and apply the configuration changes.

- **Troubleshooting**

- If you encounter any issues with the DMAL120F, try the following troubleshooting steps:
- Check all connections to ensure they are secure.
- Restart the DMAL120F and any connected devices.
- Reset the DMAL120F to its default settings, if necessary.
- Contact customer support for further assistance.

- **Maintenance**

- Regular maintenance of the DMAL120F is recommended to ensure optimal performance:
- Periodically check all connections and tighten if necessary.
- Clean the device using a soft, dry cloth to remove any dust or debris.
- Do not use any harsh chemicals or solvents for cleaning.

- **Safety Precautions**

- Follow these safety precautions when using the DMAL120F:
- Ensure that the device is installed and operated according to the provided instructions.
- Avoid exposing the device to extreme temperatures or humidity.
- Do not attempt to disassemble or modify the device.
- Disconnect the device from power before performing any maintenance or cleaning.
- Keep the device away from water and other liquids.

- **FAQ (Frequently Asked Questions)**

- **Question:** What is the maximum ambient temperature range for the DMAL120F?
- **Answer:** The maximum ambient temperature range for the DMAL120F is [insert temperature range].
- **Question:** How can I access the DMAL120F configuration interface?

- **Answer:** You can access the DMAL120F configuration interface by entering its IP address into a web browser.
- **Question:** Can I reset the DMAL120F to its default settings?
- **Answer:** Yes, you can reset the DMAL120F to its default settings if necessary.
- **Question:** How often should I perform maintenance on the DMAL120F?
- **Answer:** Regular maintenance of the DMAL120F is recommended to ensure optimal performance. Perform maintenance periodically or as needed.

DMAL120F

- To bring all the different devices together, Dynalite supports a range of network devices that are useful in creating a problem-free installation.

Product data

General Information

- **Remarks** Please download the Lighting – Product Data Sheet for more information and ordering options
- **CE mark** CE mark
- **EU RoHS** compliant Yes

Temperature

- **Ambient temperature range** 0 to +60 °C

Product Data

- **Order product name** DMAL120F
- **Full product name** DMAL120F
- **Full product code** 871869600143100
- **Order code** 913703061609
- **Material No (12NC)** 913703061609
- **Numerator** – Quantity Per Pack 1
- **EAN/UPC** – Product/Case 8718696001431
- **Numerator** – Packs per outer box 1
- **EAN/UPC** – Case 8718696008935

Dynalite Network Devices

Dimensional drawing

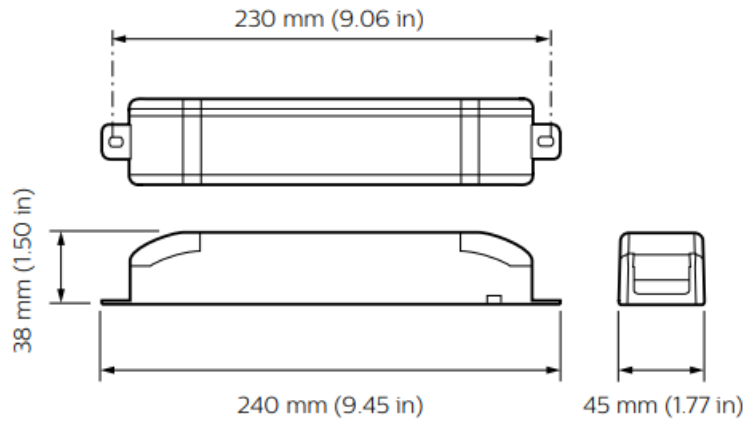

© 2024 Signify Holding All rights reserved. Signify does not give any representation or warranty as to the accuracy or completeness of the information included herein and shall not be liable for any action in reliance thereon. The information presented in this document is not intended as any commercial offer and does not form part of any quotation or contract unless otherwise agreed by Signify. All trademarks are owned by Signify Holding or their respective owners.

- www.lighting.philips.com.
- 2024, January 5 – data subject to change

Documents / Resources

	<p>PHILIPS DMAL120F Dynalite Network Devices [pdf] Instructions</p> <p>DMAL120F Dynalite Network Devices, DMAL120F, Dynalite Network Devices, Network Devices , Devices</p>
---	---

References

- [User Manual](#)

[Manuals+](#), [Privacy Policy](#)

This website is an independent publication and is neither affiliated with nor endorsed by any of the trademark owners. The "Bluetooth®" word mark and logos are registered trademarks owned by Bluetooth SIG, Inc. The "Wi-Fi®" word mark and logos are registered trademarks owned by the Wi-Fi Alliance. Any use of these marks on this website does not imply any affiliation with or endorsement.