



PHILIPS CoreLine Trunking Gen2 Instruction Manual

[Home](#) » [Philips](#) » PHILIPS CoreLine Trunking Gen2 Instruction Manual 

PHILIPS

CoreLine Trunking Gen2 Instruction Manual

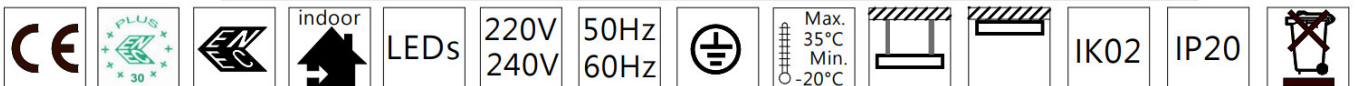
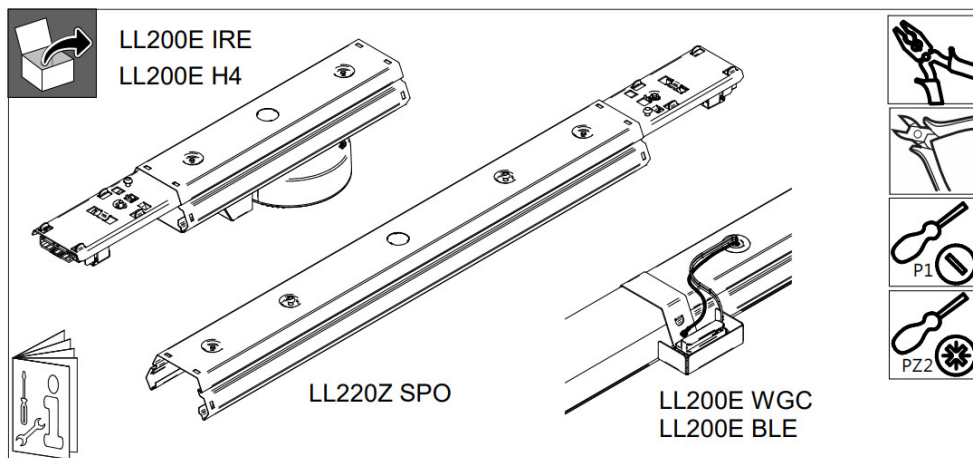

Contents

- [1 CoreLine Trunking Gen2](#)
- [2 Inrush current](#)
- [3 Maintenance instructions](#)
- [4 Documents / Resources](#)
 - [4.1 References](#)
- [5 Related Posts](#)

Prevent water from entering on or in the luminaire at installation and during use of the luminaire.

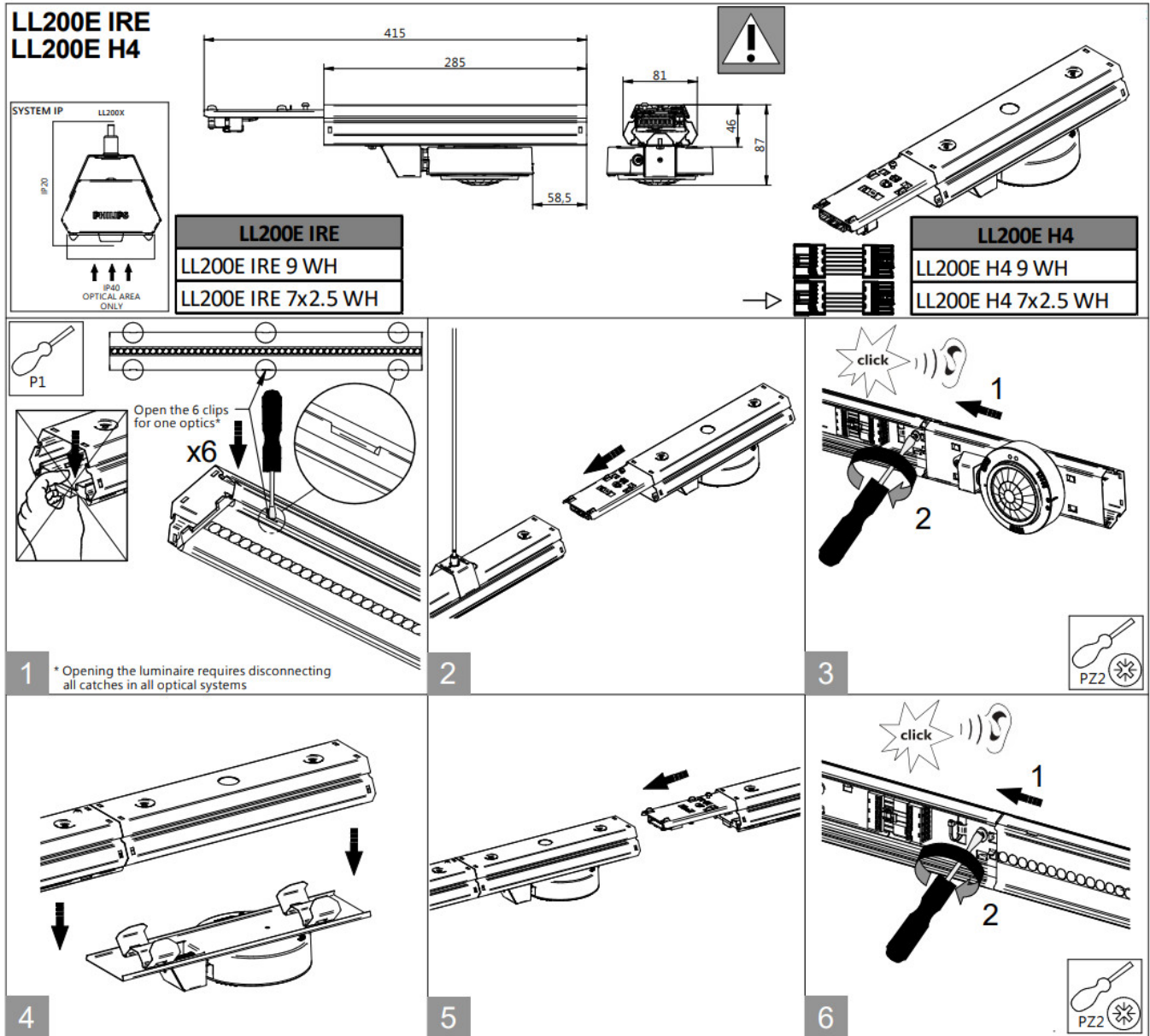

- for use with SIA drivers (sensor LL200E H4) or SR drivers (sensor LL200E IRE)
- one sensor supports max. 4 drivers
- to separate group of luminaires containing one sensor use the separator connector

LL200E WGC
LL200E BLE

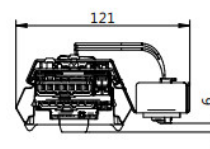
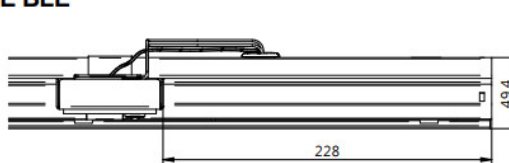
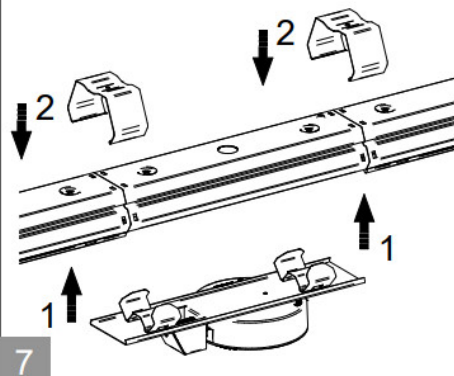

LL200E WGC	LL200E BLE
LL200E WGC 9 WH	LL200E BLE 9 WH
LL200E WGC 7x2.5 WH	LL200E BLE 7x2.5 WH

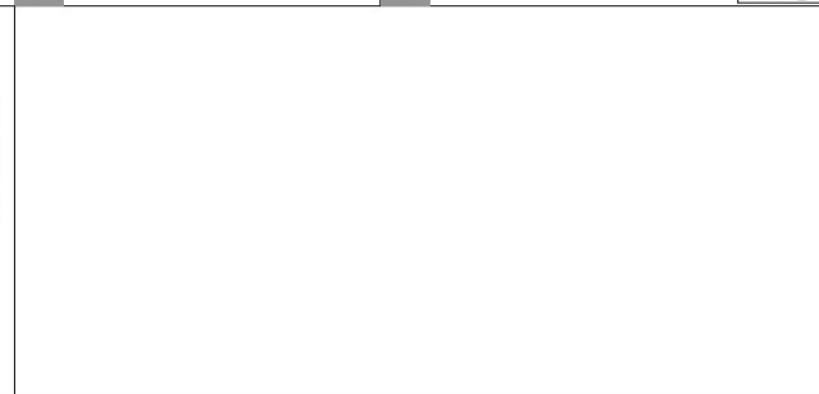
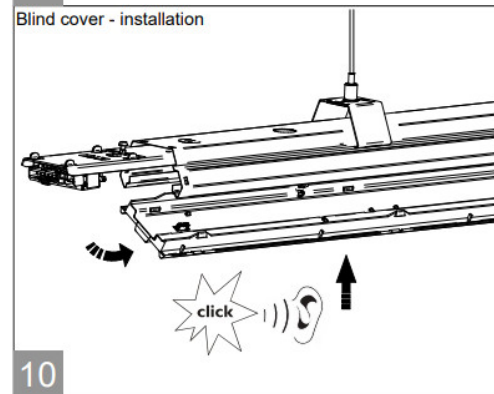
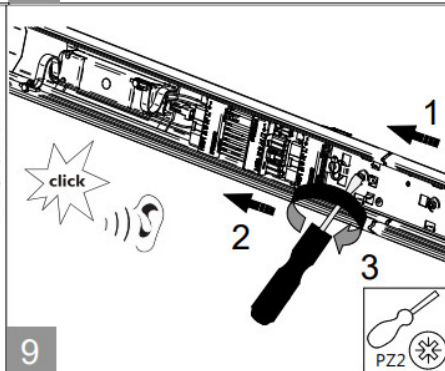
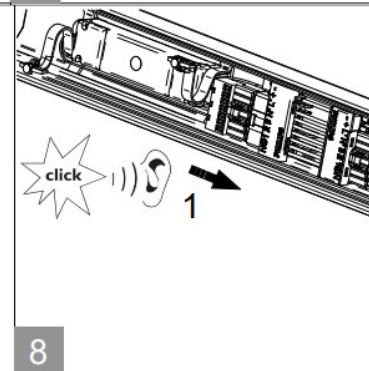
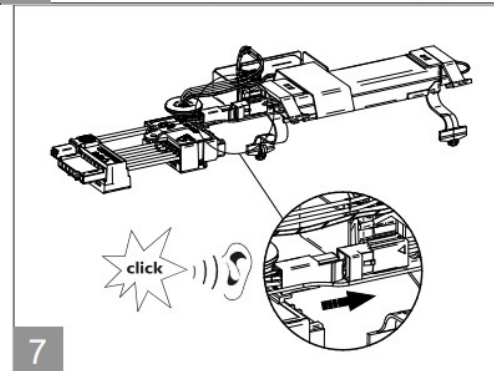
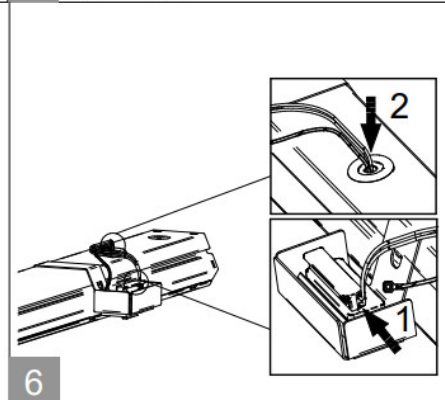
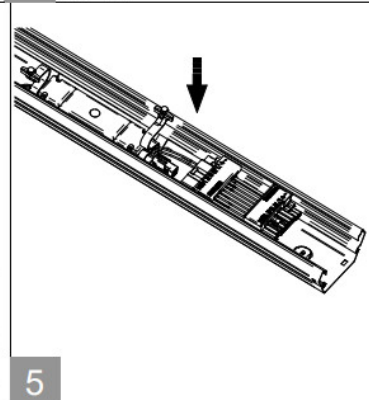
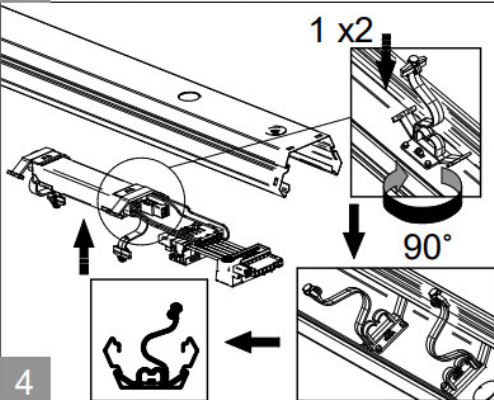
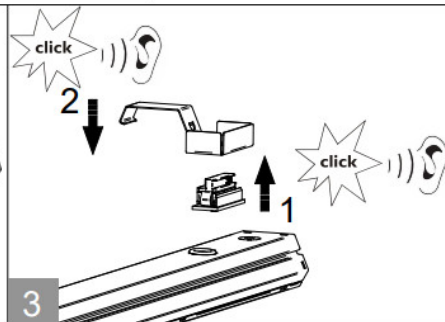
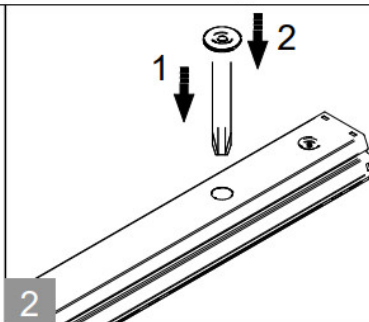
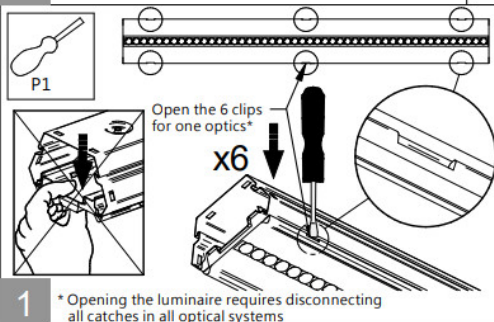

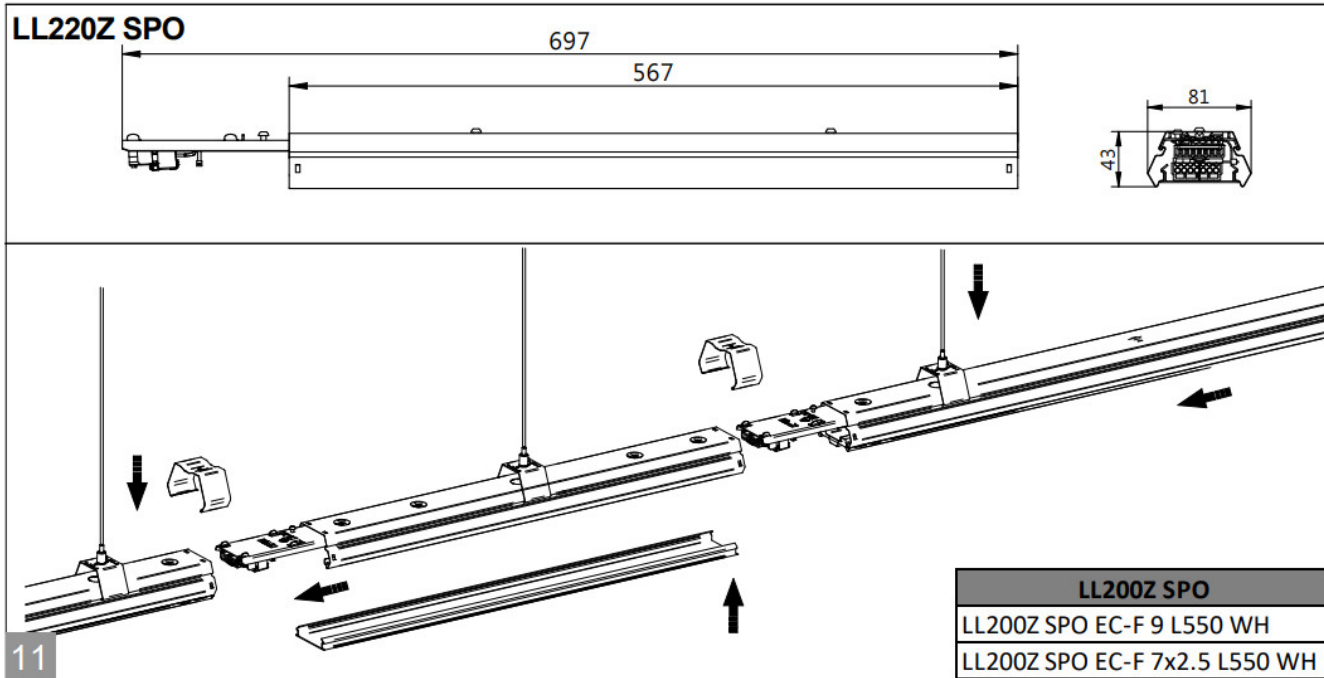

Inrush current

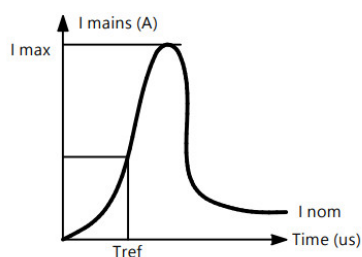

TYPE	53S 1xPSU (36W)	30S/45S 1xSRD (35W)	90S 2x SRD (35W)	30S/45S 1xPSD (35W)	90S 2xPSD (35W)	30S/45S/53S/80S 1xPSD (60W)	90S/160S 2xPSD (60W)	53S/80S 1xSRD (60W)	160S 2xSRD (60W)	45S/80S 1xPSU (75W)	90S/160S 2xPSU (75W)	80S/120S 1xPSU (100W)	240S 2xPSU (100W)	80S/90S/120S 1xPSD (100W)	240S 2xPSD (100W)	80S/90S/120S 1xSRD (100W)	240S 2xSRD (100W)	80S/120S/160S 1xPSD (150W)	240S 2xPSD (150W)	160S 1xSRD (150W)
I _{max} [A]	14,0	21,0	42,0	23,1	46,2	25,1	50,2	21,0	42,0	19,0	38,0	22,5	45,0	10,0	20,0	4,5	9,0	5,1	10,2	5,1
T _{ref} [μs]	250	280	280	221	221	214	214	280	280	280	280	30	30	35,9	35,9	1000	1000	760	760	760
cable Ø [mm²]	1.5 / 2.5*																			
MCB B-6A	13/13	8/8	4/4	8/8	4/4	8/8	4/4	8/8	4/4	9/9	4/4	9/9	4/4	7/7	3/3	7/7	3/3	6/6	3/3	4/4
MCB B-10A	20/20	13/13	6/6	13/13	6/6	13/13	6/6	13/13	6/6	15/15	7/7	14/14	7/7	11/11	5/5	11/11	5/5	10/10	5/5	7/7
MCB C-10A	34/34	21/21	10/10	22/22	11/11	21/21	10/10	21/21	10/10	24/24	12/12	23/23	11/11	18/18	9/9	18/18	9/9	16/16	8/8	12/12
MCB B-13A	26/26	17/17	8/8	17/17	8/8	17/17	8/8	17/17	8/8	19/19	9/9	18/18	9/9	14/14	7/7	14/14	7/7	12/12	6/6	9/9
MCB C-13A	40/44	28/28	14/14	29/29	14/14	28/28	14/14	28/28	14/14	32/32	16/16	30/31	15/15	24/24	12/12	24/24	12/12	20/21	10/10	16/16
MCB B-16A	33/33	21/21	10/10	22/22	11/11	21/21	10/10	21/21	10/10	24/24	12/12	23/23	11/11	18/18	9/9	18/18	9/9	16/16	8/8	12/12
MCB C-16A	40/56	35/35	17/17	37/37	18/18	35/35	17/17	35/35	17/17	40/40	20/20	30/39	15/19	30/30	15/15	30/30	15/15	20/27	10/13	20/20

* **Warning!** The values on the left are for 1.5 mm thick cables, the values on the right are for 2.5 mm thick cables

Maintenance instructions

To assure the lighting quality of this unique LED lighting concept there are a few instructions regarding the maintenance of this LED luminaire:

1. Do not touch electronic components!

Electronic components are under high voltage.

Electronic components are ESD sensitive.

2. During installation or when maintaining the luminaire please use static free gloves to avoid marks on the

luminaire.

3. To remove dirt and spots use the following:

Dust: only use micro fiber cloths

Fingerprints, etc.: use a cleaner for synthetic materials with antistatic properties.

4. Do not stare into the LED light beam.

5. To avoid scratches and dirt on optical parts remove protective foil after installation.

6. The luminaire shall be installed by a qualified electrician and wired in accordance with the latest IEE electrical regulations or the national requirements.

7. The light source of this luminaire is not replaceable: when the light source reaches its end of life whole luminaire shall be replaced.

8. Driver insulation: Basic according to IEC 61847-1.

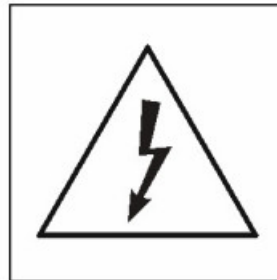
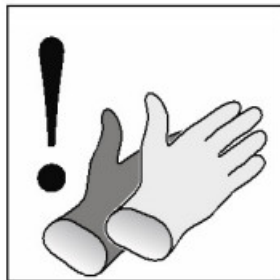

442710401452

© 04/ 2020, Signify Holding All rights reserved

Printed in Poland

Data subject to change without notice

Keep for future reference: www.philips.com/lighting

Documents / Resources

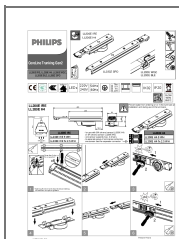

[PHILIPS CoreLine Trunking Gen2](#) [pdf] Instruction Manual

CoreLine Trunking Gen2, CoreLine Trunking, Trunking Gen2, Trunking, CoreLine, LL200E IRE, LL200E H4, LL200E WGC, LL200E BLE, LL200Z SPO

References

- [LED & Conventional lighting solutions | Philips lighting](#)

