



## PHILIPS 34M2C5501A Computer Monitor User Guide

[Home](#) » [Philips](#) » PHILIPS 34M2C5501A Computer Monitor User Guide 

**PHILIPS 34M2C5501A Computer Monitor**



## Contents

- 1 Contents
- 2 Installation Instruction
- 3 Customer Support
- 4 Documents / Resources
  - 4.1 References



## Contents

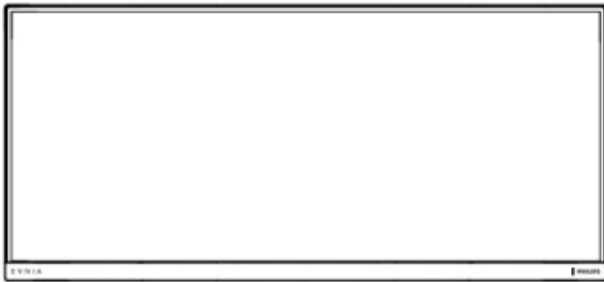

Power



HDMI



DP



USB A-B

The images shown are for illustrative purposes only.

Actual product and accessory may vary by country or regions. Actual product and accessory shall prevail in kind.

## Installation Instruction

1

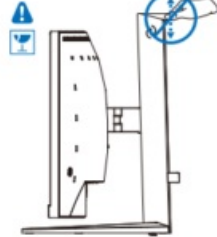
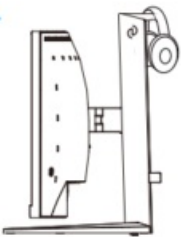
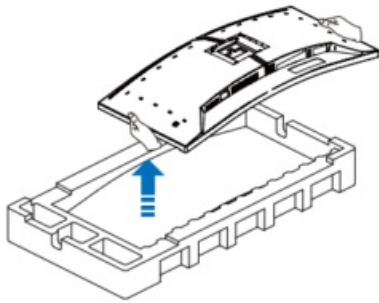
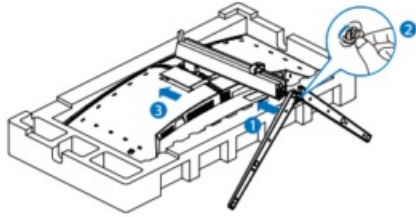

2

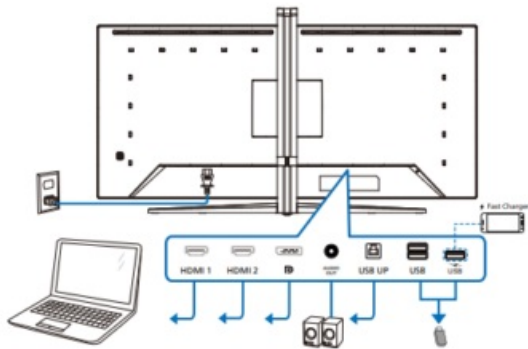

USB hub

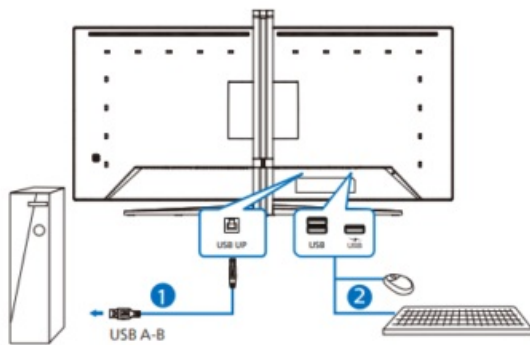

3

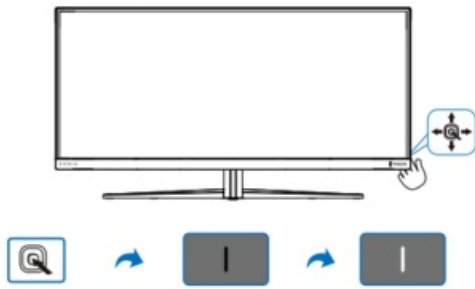



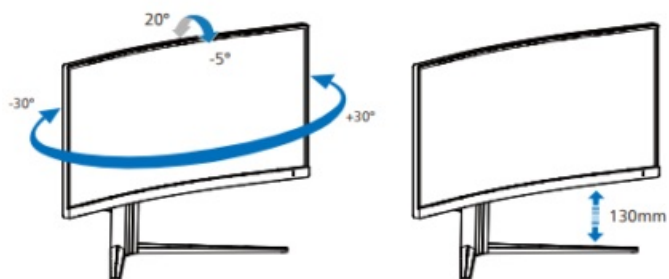

4

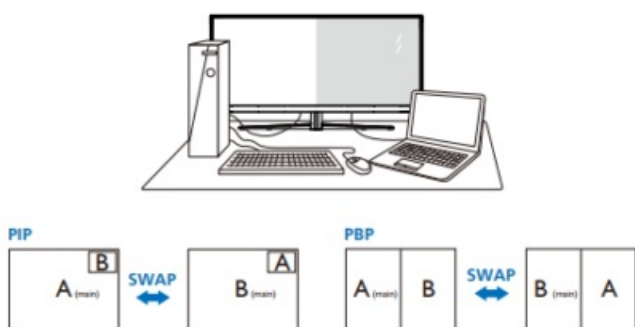

5



		SUB SOURCE POSSIBILITY(xl)		
Multi View	Inputs	HDMI 1	HDMI 2	DisplayPort
MAIN SOURCE (xl)	HDMI 1	•	•	•
	HDMI 2	•	•	•
	DisplayPort	•	•	•

## Customer Support

Register your product and get support at [www.philips.com/support](http://www.philips.com/support)



FAQ



Software Smart Control



User Manual

**Version:** 34M2C5501AQ1T

2024 © TOP Victory Investments Ltd. All rights reserved.

This product has been manufactured by and is sold under the responsibility of Top Victory Investments Ltd., and Top Victory Investments Ltd. is the warrantor in relation to this product. Philips and the Philips Shield Emblem are registered trademarks of Koninklijke Philips N.V. and are used under license.

Specifications are subject to change without notice.

# HDMI®

The terms HDMI, HDMI High-Definition Multimedia Interface, HDMI Trade Dress and the HDMI Logos are trademarks or registered trademarks of HDMI Licensing Administrator, Inc.



[www.evnia.philips](http://www.evnia.philips)

# PHILIPS

## Documents / Resources

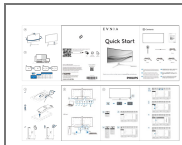

**[PHILIPS 34M2C5501A Computer Monitor](#)** [pdf] User Guide  
34M2C5501A Computer Monitor, 34M2C5501A, Computer Monitor, Monitor

## References

- [Philips Customer Service Support - Home | Philips](#)
- [Product registration | Philips](#)
- [User Manual](#)

[Manuals+](#), [Privacy Policy](#)

This website is an independent publication and is neither affiliated with nor endorsed by any of the trademark owners. The "Bluetooth®" word mark and logos are registered trademarks owned by Bluetooth SIG, Inc. The "Wi-Fi®" word mark and logos are registered trademarks owned by the Wi-Fi Alliance. Any use of these marks on this website does not imply any affiliation with or endorsement.