

**PHILIPS
27M2N5501
Computer Monitor**



PHILIPS 27M2N5501 Computer Monitor User Manual

[Home](#) » [Philips](#) » PHILIPS 27M2N5501 Computer Monitor User Manual 

Contents

- [1 PHILIPS 27M2N5501 Computer Monitor](#)
- [2 Contents](#)
- [3 Specifications](#)
- [4 Setting Up Your Monitor](#)
- [5 Using the Monitor Functions](#)
- [6 FAQs](#)
- [7 Documents / Resources](#)
 - [7.1 References](#)

PHILIPS

PHILIPS 27M2N5501 Computer Monitor



The images shown are for illustrative purposes only. Actual products and accessories may vary by country or region. Actual product and accessory shall prevail in kind.

CAUTION

Place the monitor face down on a smooth surface. Pay attention not to scratch or damage the screen.

Contents

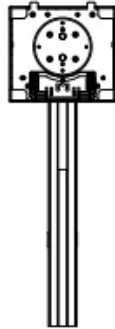
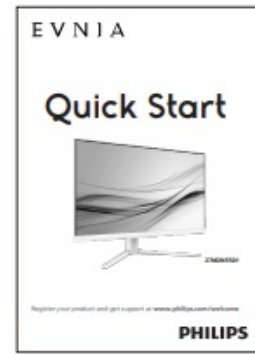

Power



HDMI



DP

Specifications

- Model: 27M2N5501
- Dimensions: 130mm x 4mm
- Power Input: HDMI, DP

Product Information

This product is a monitor manufactured by Top Victory Investments Ltd. and sold under the responsibility of the same company. It features HDMI and DP inputs, with a sleek design and high-quality display technology. The monitor is designed for various uses, including gaming, multimedia consumption, and general computing tasks.

Setting Up Your Monitor

1. Place the monitor face down on a smooth surface to avoid scratching or damaging the screen.

1

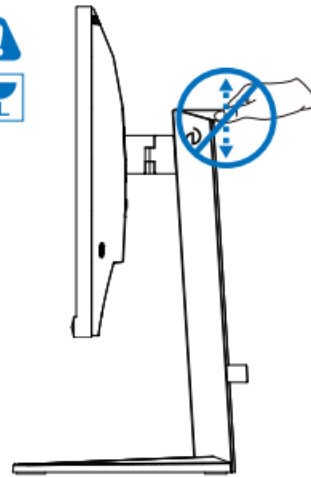
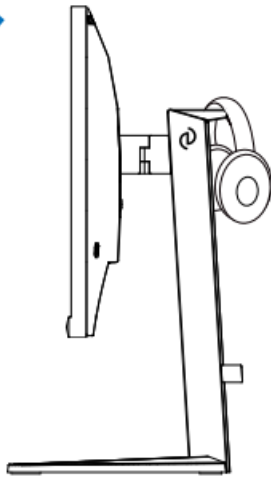
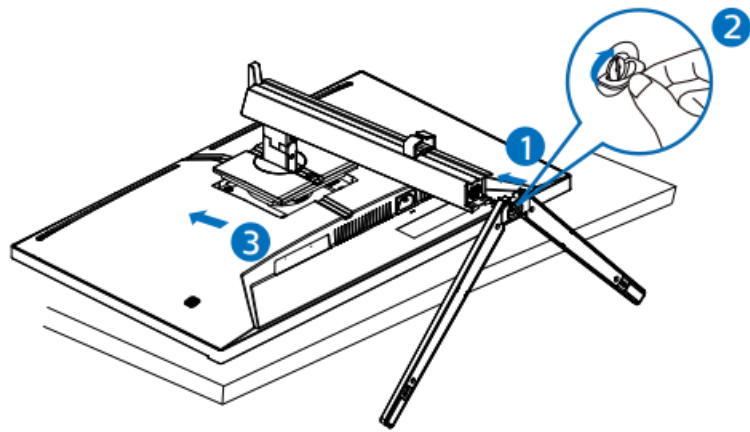

2. Connect the power input using the provided HDMI or DP cables.

2

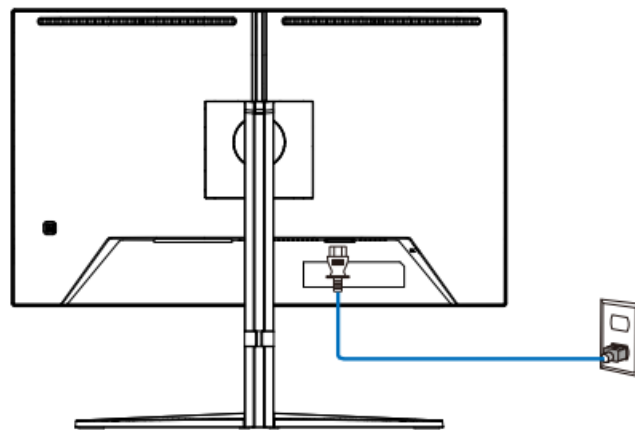

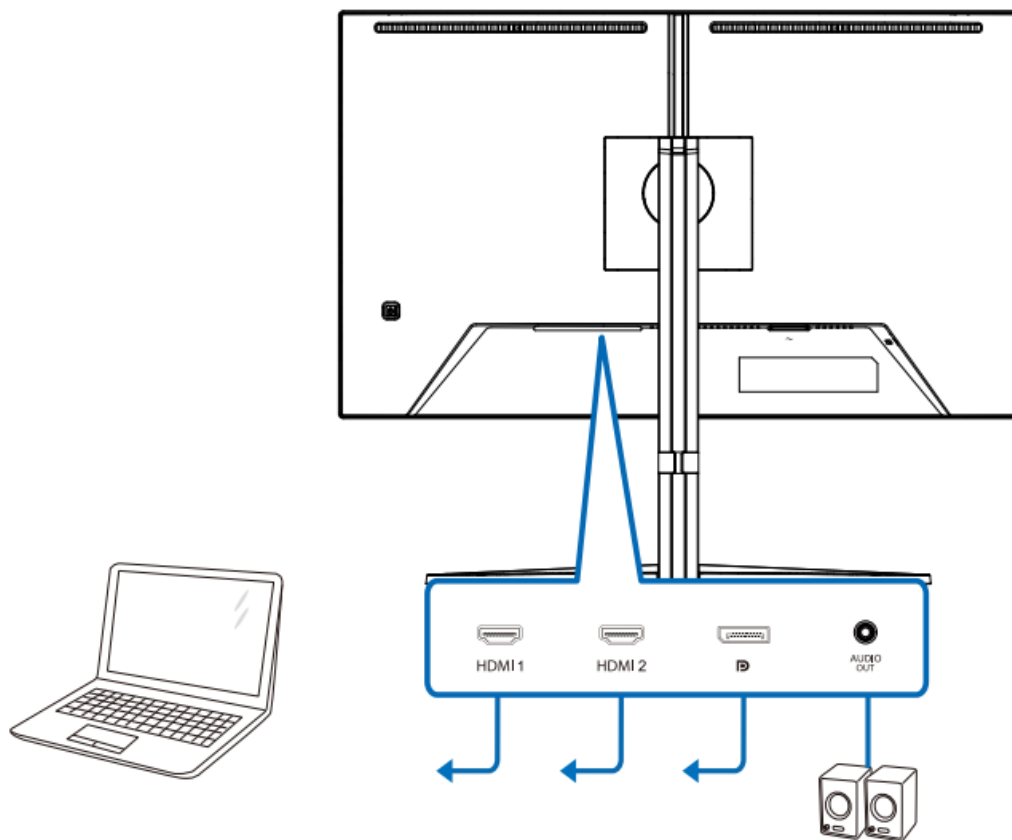

3

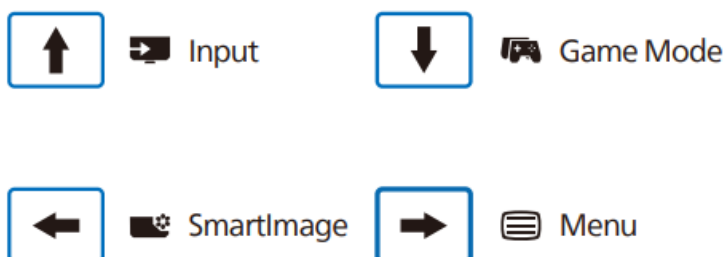
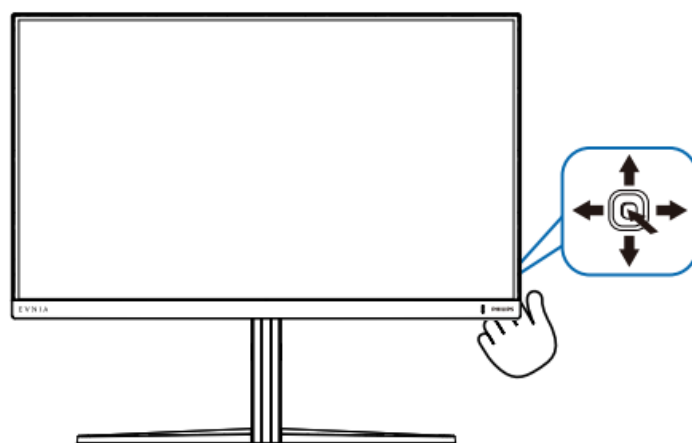

3. Adjust the monitor position for optimal viewing angle.

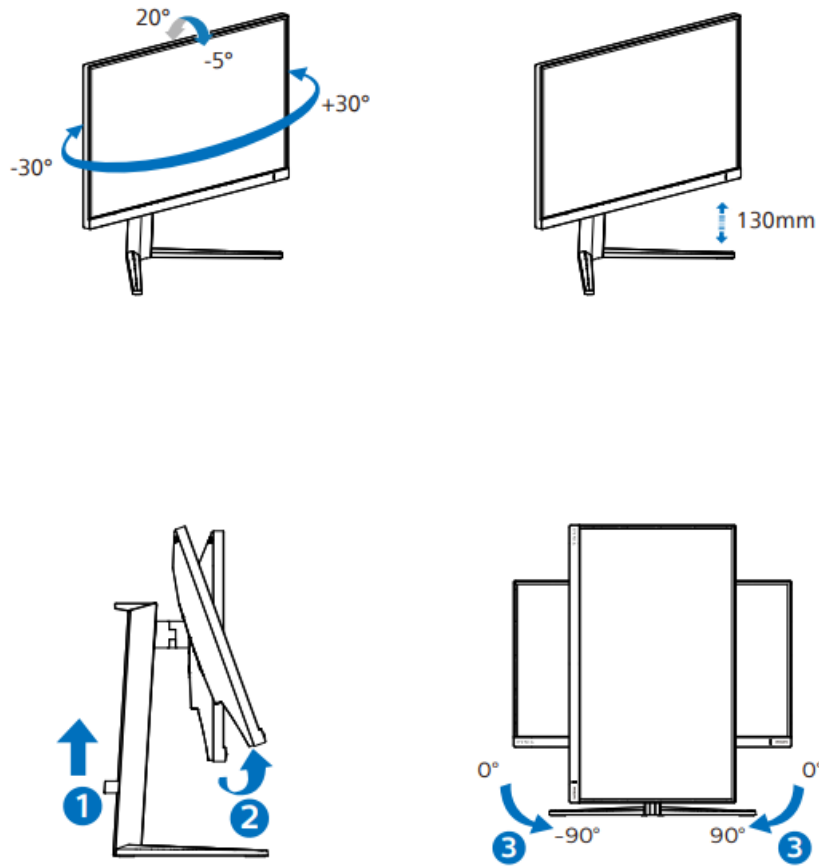

Using the Monitor Functions

- The monitor features various functions accessible through the on-screen menu.
- Use the SmartImage feature to adjust display settings based on your preferences.
- The Game Mode enhances visuals for gaming experiences.

FAQs

Q: How do I register my product for support?

A: You can register your product and get support by visiting www.philips.com/welcome and following the registration instructions.

Q: What should I do if the monitor screen is damaged?

A: If the monitor screen is damaged, contact customer support for assistance and avoid using the product further to prevent further damage.

Register your product and get support at www.philips.com/support



FAQ



Software



User
Manual

This product has been manufactured by and is sold under the responsibility of Top Victory Investments Ltd., and Top Victory Investments Ltd. is the warrantor for this product. Philips and the Philips Shield Emblem are registered trademarks of Koninklijke Philips N.V. and are used under license. Specifications are subject to change without notice. The terms HDMI, HDMI High-definition Multimedia Interface, HDMI Trade Dress, and HDMI Logos are trademarks or registered trademarks of HDMI Licensing Administrator, Inc.

Documents / Resources

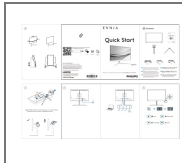

[PHILIPS 27M2N5501 Computer Monitor](#) [pdf] User Manual

27M2N5501-93, 27M2N5501Q1T, 27M2N5501 Computer Monitor, 27M2N5501, Computer Monitor, Monitor

References

- [Support Home | Philips](#)
- [Product registration | Philips](#)
- [User Manual](#)

Manuals+, [Privacy Policy](#)

This website is an independent publication and is neither affiliated with nor endorsed by any of the trademark owners. The "Bluetooth®" word mark and logos are registered trademarks owned by Bluetooth SIG, Inc. The "Wi-Fi®" word mark and logos are registered trademarks owned by the Wi-Fi Alliance. Any use of these marks on this website does not imply any affiliation with or endorsement.