



PHILIPS 275S9 S Line Smart LED Display User Guide

[Home](#) » [Philips](#) » PHILIPS 275S9 S Line Smart LED Display User Guide 

PHILIPS

Quick Start
S Line
275S9



Contents

- 1 275S9 S Line Smart LED Display
- 2 Documents / Resources
 - 2.1 References
- 3 Related Posts

275S9 S Line Smart LED Display

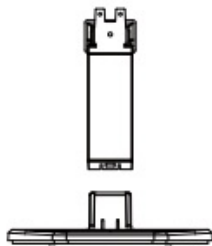
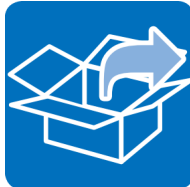

Screw and screwdriver
M4-10 x 3

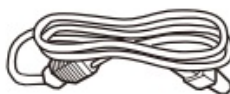

Power



*HDMI



*DP



*USB A-B



*VGA

***Different according to region**

Display design may differ from that illustrated

1

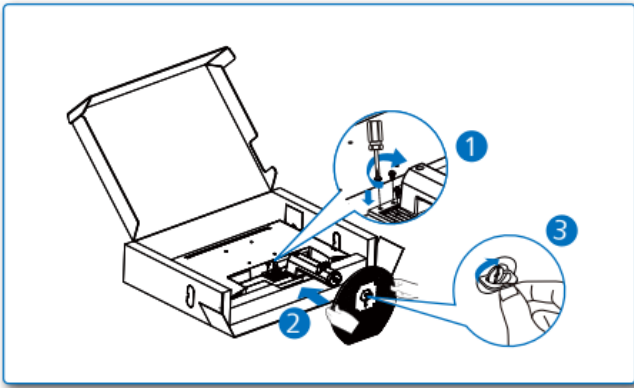

2

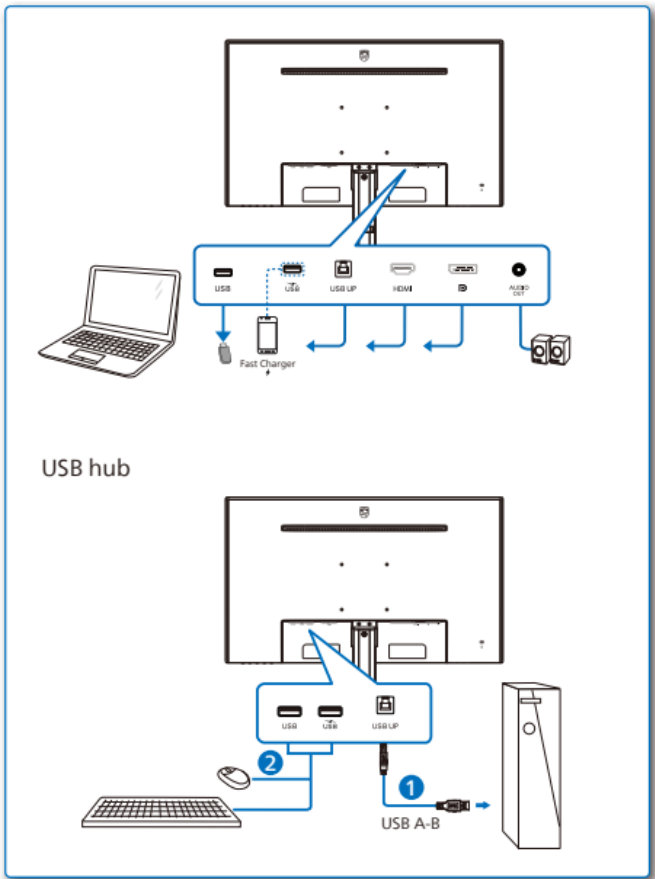
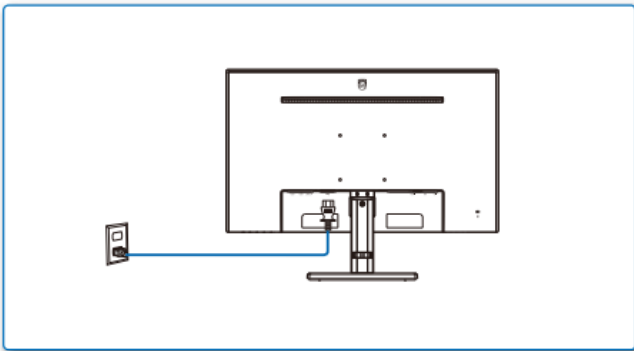

3

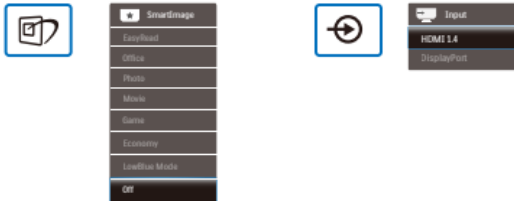
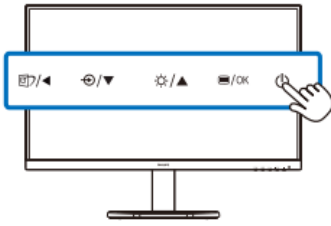

4

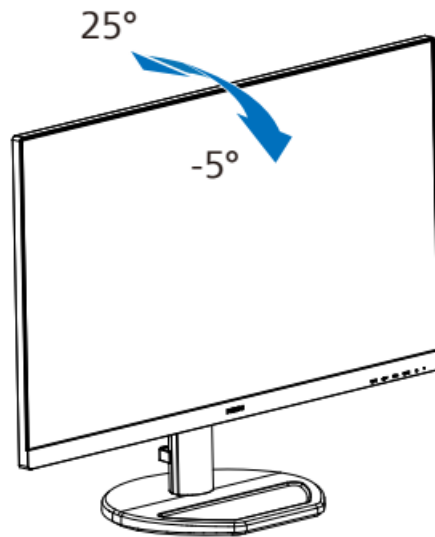

Register your product and get support at www.philips.com/support



<http://www.philips.com/support>

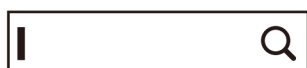

FAQ



Software
SmartControl



User
Manual

Version: M9275SJQ1T

2022 © TOP Victory Investments Ltd. All rights reserved.

This product has been manufactured by and is sold under the responsibility of Top Victory Investments Ltd., and Top Victory Investments Ltd. is the warrantor in relation to this product.

Philips and the Philips Shield Emblem have registered trademarks of Koninklijke Philips N.V. and are used under license.

Specifications are subject to change without notice.

HDMI®

The Adopted Trademarks HDMI, HDMI High Definition

Multimedia Interface and the HDMI Logo are trademarks or registered trademarks of HDMI Licensing Administrator, Inc. in the United States and other countries.

www.philips.com

Energy Labelling
275S9JAL



<https://eprel.ec.europa.eu/qr/1289778>



Printed in China





H41G78S381364A



[PHILIPS 275S9 S Line Smart LED Display](#) [pdf] User Guide

275S9 S Line Smart LED Display, 275S9, S Line Smart LED Display, Smart LED Display, Display

References

-  [Philips - United States | Philips](#)
-  [Philips Customer Service Support - Home | Philips](#)
-  [Product registration | Philips](#)

Manuals+.