



PHILIPS 272S1 S Line Smart LED Display User Guide

[Home](#) » [Philips](#) » PHILIPS 272S1 S Line Smart LED Display User Guide 

Contents

- [1 PHILIPS 272S1 S Line Smart LED Display](#)
- [2 WHATS IN THE BOX](#)
- [3 INSTALLATION INSTRUCTIONS](#)
- [4 Documents / Resources](#)
 - [4.1 References](#)
- [5 Related Posts](#)

PHILIPS

PHILIPS 272S1 S Line Smart LED Display



WHATS IN THE BOX

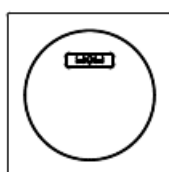
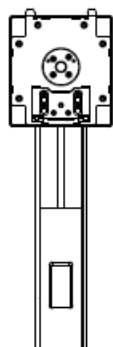
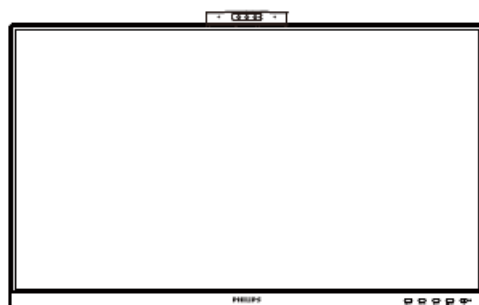

*USB A-B

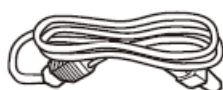

Power

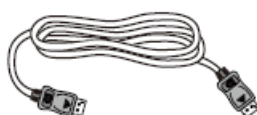

*DP

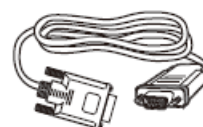

*VGA



* Audio



* DVI



*HDMI

INSTALLATION INSTRUCTIONS

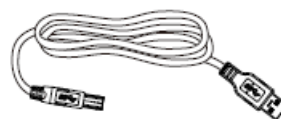
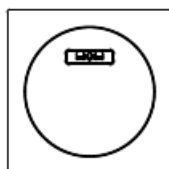
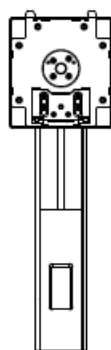
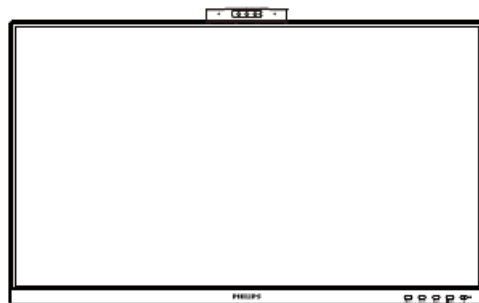

*USB A-B



Power



*DP

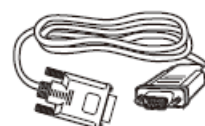

*VGA



*Audio



*DVI



*HDMI

1

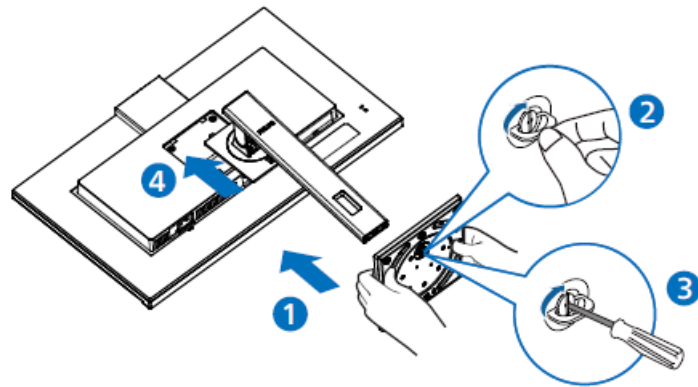

2

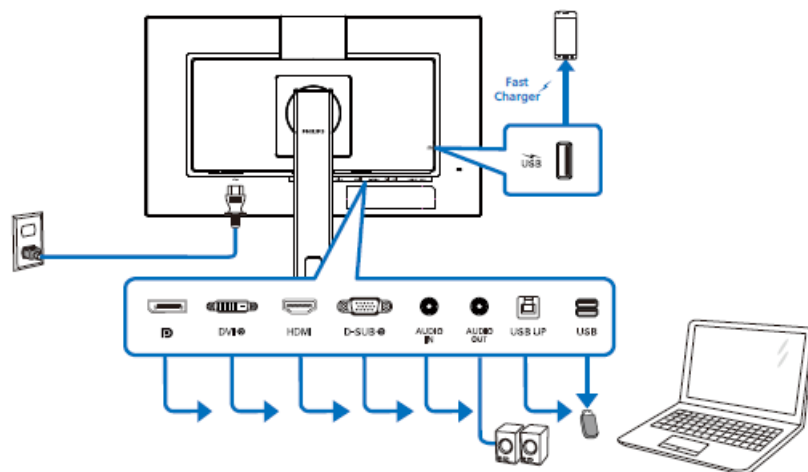

USB hub

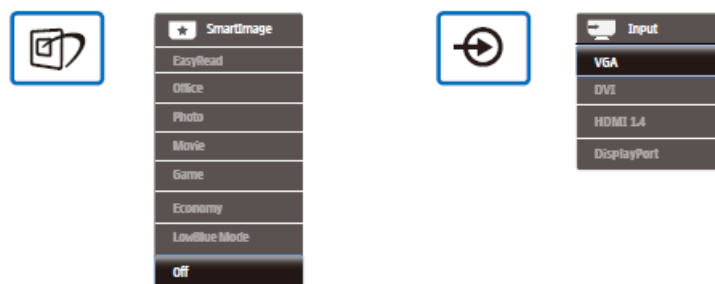
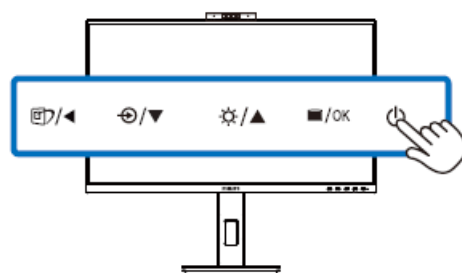
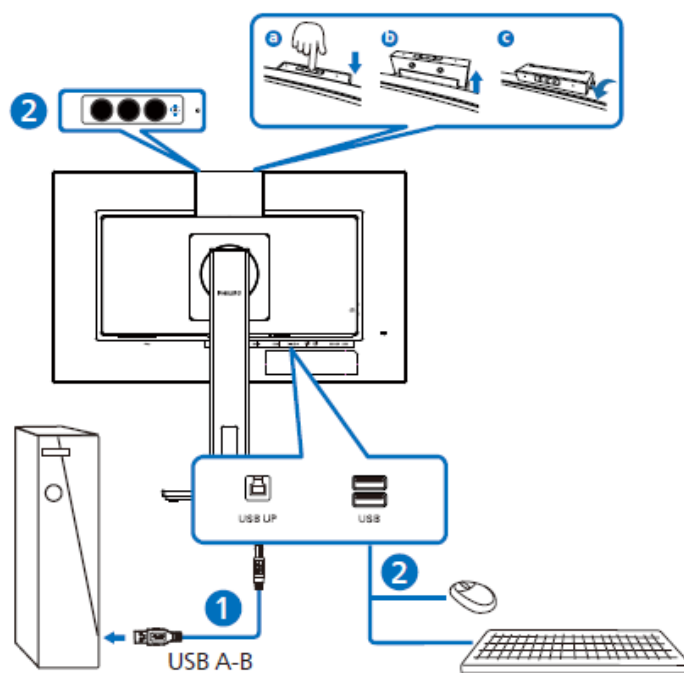



LowBlue Mode	On	
	Off	✓
Input		
Picture		
Audio		
Color		
Language		
▼		



LowBlue Mode	On	
	Off	✓
Input		
Picture		
Audio		
Color		
Language		
▼		



LowBlue Mode	On	
	Off	✓
Input		
Picture		
Audio		
Color		
Language		
▼		



LowBlue Mode	On	
	Off	✓
Input		
Picture		
Audio		
Color		
Language		
▼		

4

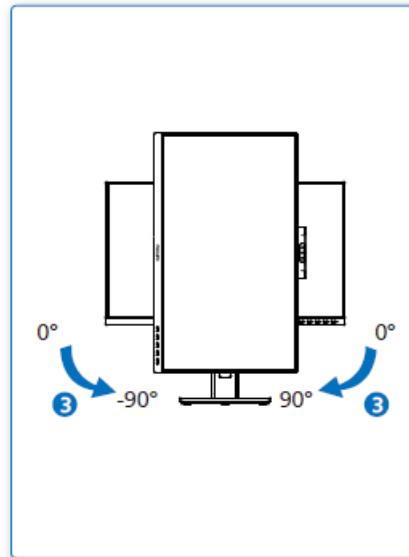
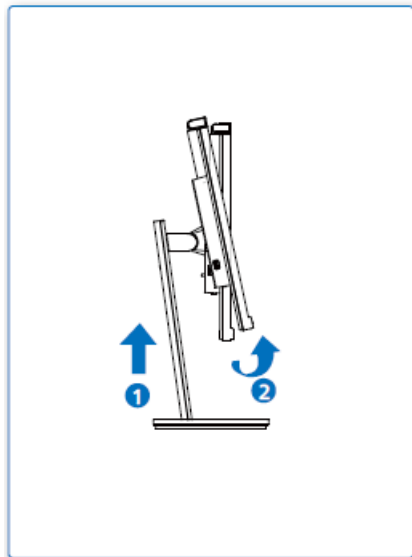
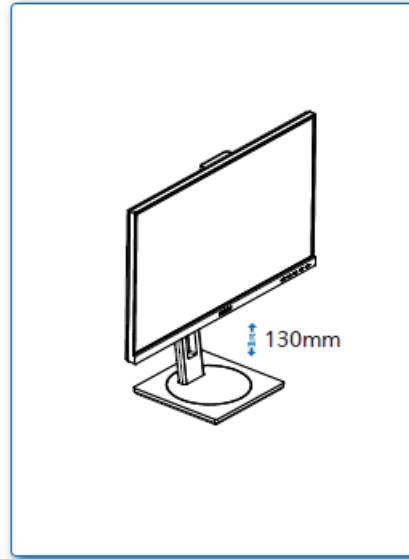
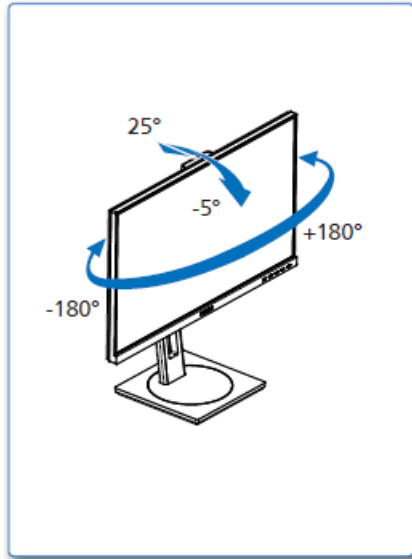

Register your product and get support at www.philips.com/support



Version: M10272SMHQ1T

2022 © TOP Victory Investments Ltd. All rights reserved. This product has been manufactured by and is sold

under the responsibility of Top Victory Investments Ltd., and Top Victory Investments Ltd. is the warrantor in relation to this product. Philips and the Philips Shield Emblem are registered trademarks of Koninklijke Philips N.V. and are used under license. Specifications are subject to change without notice.

Energy Labelling



H41G78S381345A

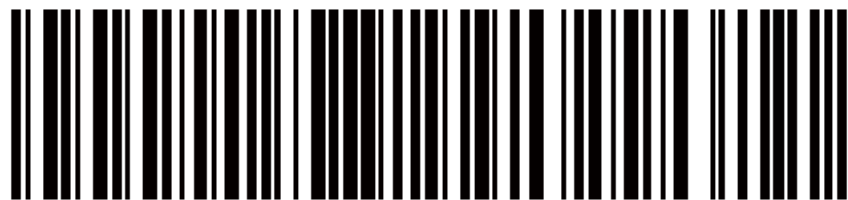

The terms HDMI, HDMI High-Definition Multimedia Interface, and the HDMI Logo are trademarks or registered trademarks of HDMI Licensing Administrator, Inc. www.philips.com

Documents / Resources

	<p>PHILIPS 272S1 S Line Smart LED Display [pdf] User Guide 272S1 S Line Smart LED Display, 272S1, S Line Smart LED Display, Smart LED Display, LED Display, Display</p>
---	---

References

- [Philips - United States | Philips](#)
- [Philips Customer Service Support - Home | Philips](#)
- [Product registration | Philips](#)