

PHILIPS

24E1N2100A
Computer
Monitor



PHILIPS 24E1N2100A Computer Monitor User Manual

[Home](#) » [Philips](#) » PHILIPS 24E1N2100A Computer Monitor User Manual 

Contents

- [1 PHILIPS 24E1N2100A Computer Monitor](#)
- [2 Product Information](#)
- [3 Contents](#)
- [4 Important Information](#)
- [5 Setup Instructions](#)
- [6 FAQ](#)
- [7 Documents / Resources](#)
 - [7.1 References](#)
- [8 Related Posts](#)

PHILIPS

PHILIPS 24E1N2100A Computer Monitor



Product Information

Specifications

- Model: Monitor 2000 Series
- Available Models: 24E1N2100A, 27E1N2100A, 24E1N2100AW, 27E1N2100AW
- Manufacturer: Top Victory Investments Ltd.
- Brand: Philips
- Version: 2XE1N2100AQ1L

Contents

- Monitor
- Quick Start Guide
- Power Cable
- HDMI Cable
- VGA Cable
- Audio Cable



Power

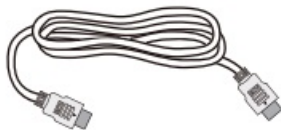

HDMI

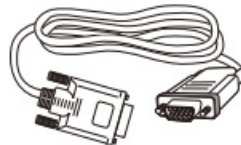

VGA

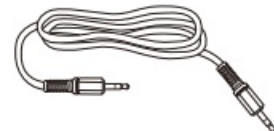

Audio

Important Information

The images shown are for illustrative purposes only. Actual product and accessory may vary by country or region. Actual product and accessory shall prevail in kind.

Setup Instructions

Step 1: Placement

1

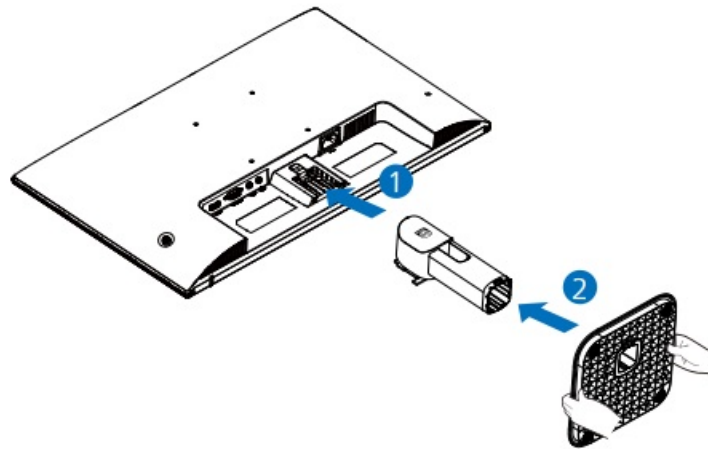

CAUTION: Place the monitor face down on a smooth surface. Pay attention not to scratch or damage the screen.

Step 2: Connecting Cables

Connect the power cable to the monitor and then to a power outlet. Connect the HDMI, VGA, or Audio cable as needed to your computer or other device.

2

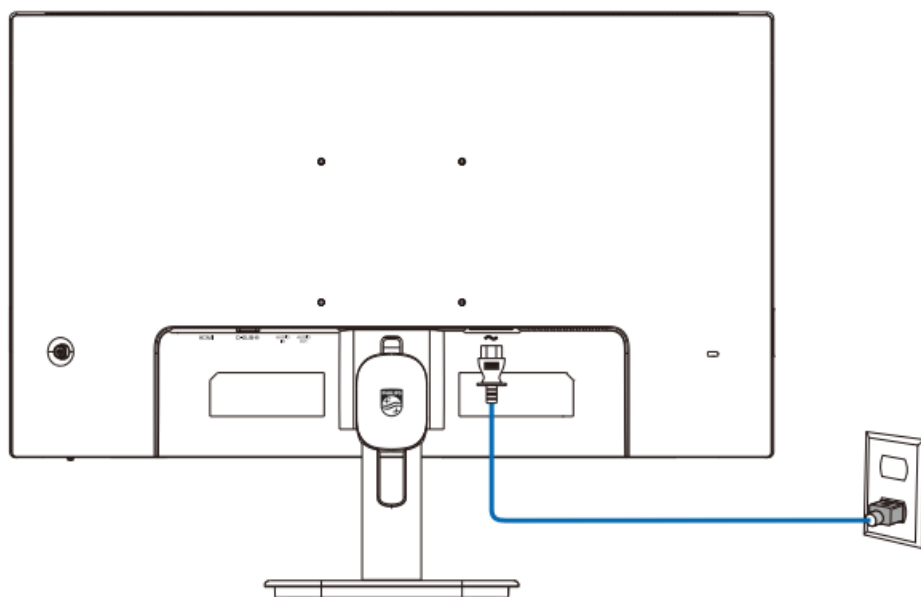

2

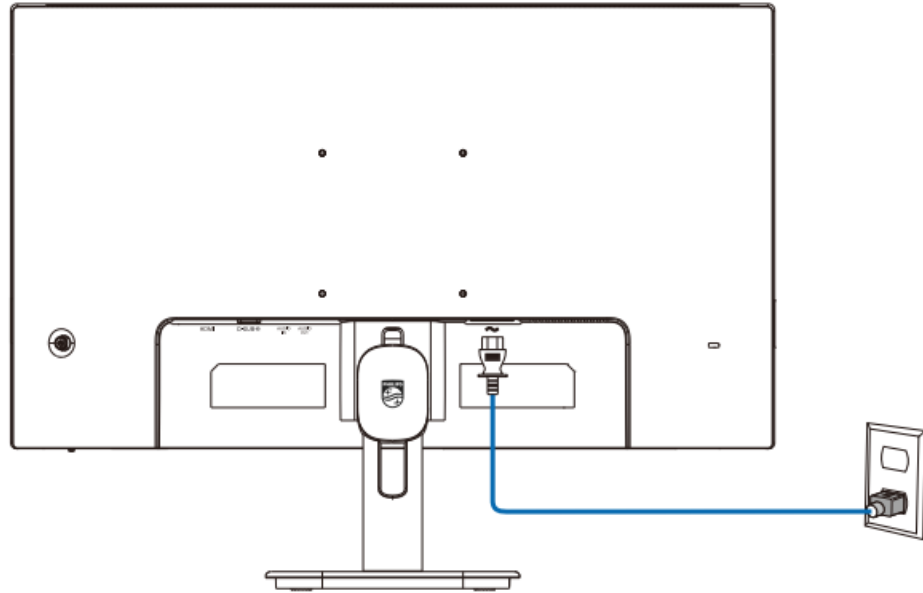

Step 3: Monitor Controls

- Input
- SmartImage
- Volume
- Menu

3

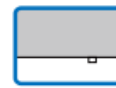
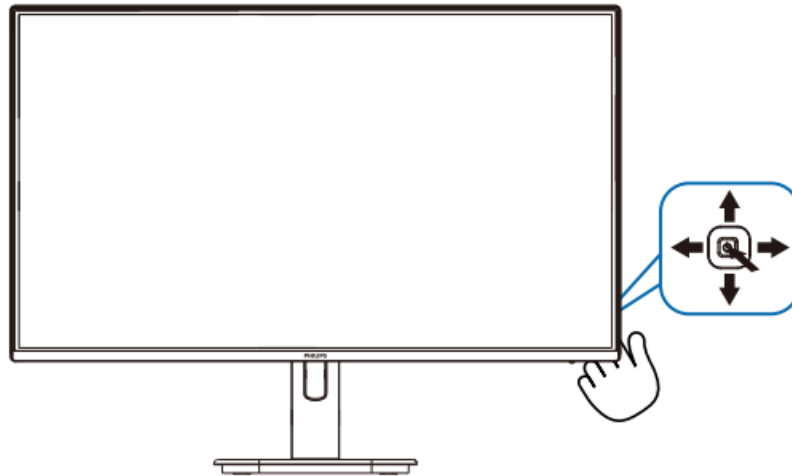

⇒ Input



🔊 Volume



⚙️ SmartImage



☰ Menu

Dimension

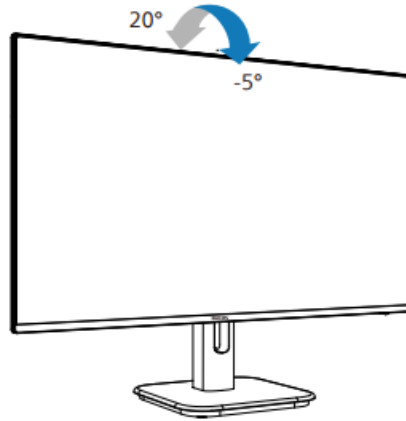

Register your product and get support at www.philips.com/support



FAQ



Software



User
Manual

Version: 2XE1N2100AQ1L

2025 © TOP Victory Investments Ltd. All rights reserved.

This product has been manufactured by and is sold under the responsibility of Top Victory Investments Ltd., and Top Victory

Investments Ltd. is the warrantor in relation to this product.

Philips and the Philips Shield Emblem are registered trademarks of Koninklijke Philips N.V. and are used under license.

Specifications are subject to change without notice.



The terms HDMI, HDMI High-Definition Multimedia Interface, HDMI Trade Dress and the HDMI Logos are trademarks or registered trademarks of HDMI Licensing Administrator, Inc.
www.philips.com

FAQ

FAQ Section

- **Q: How do I adjust the display settings?**

A: You can adjust the display settings using the menu button on the monitor. Navigate to the settings and make changes according to your preferences.

- **Q: Can I connect external speakers to this monitor?**

A: Yes, you can connect external speakers to the monitor using the audio input port. Adjust the volume accordingly using the monitor's controls.

Documents / Resources

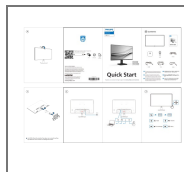

[PHILIPS 24E1N2100A Computer Monitor](#) [pdf] User Manual
27E1N2100A, 24E1N2100AW, 27E1N2100AW, 24E1N2100A Computer Monitor, 24E1N2100A, Computer Monitor, Monitor

References

-  [Philips - United States | Philips](#)
-  [Philips Customer Service Support - Home | Philips](#)
-  [Product registration | Philips](#)
- [User Manual](#)

[Manuals+](#), [Privacy Policy](#)

This website is an independent publication and is neither affiliated with nor endorsed by any of the trademark owners. The "Bluetooth®" word mark and logos are registered trademarks owned by Bluetooth SIG, Inc. The "Wi-Fi®" word mark and logos are registered trademarks owned by the Wi-Fi Alliance. Any use of these marks on this website does not imply any affiliation with or endorsement.