



Contents [[hide](#)]

- [1 PHILIPS 2000 Series LCD Monitor](#)
- [2 Specifications](#)
- [3 Contents](#)
- [4 Setting Up the Monitor](#)
- [5 Using the Monitor Controls](#)
- [6 FAQs](#)
- [7 Documents / Resources](#)
 - [7.1 References](#)

PHILIPS

PHILIPS 2000 Series LCD Monitor



Specifications

- Model: Monitor 2000 Series
- Models Available: 24E1N2300AE, 27E1N2300AE, 27E1N2600AE
- Connectivity: HDMI, USB C-A, USB C-C, USB C-C/A
- Manufacturer: Top Victory Investments Ltd.
- Trademark: Philips

Register your product and get support at www.philips.com/welcome.

Contents

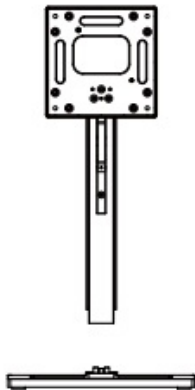
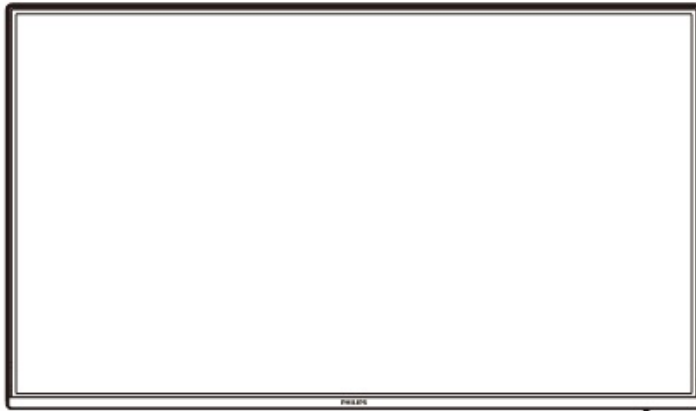

Screwdriver

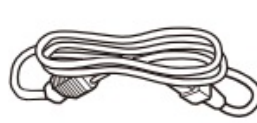

Power

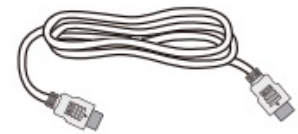

HDMI

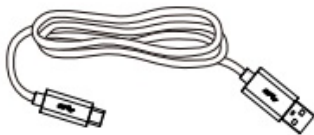

USB C-A



USB C-C



USB C-C/A

The images shown are for illustrative purposes only. The actual product and accessory may vary by country or region. Actual product and accessory shall prevail in kind.

⚠ CAUTION

Place the monitor face down on a smooth surface. Pay attention not to scratch or damage the screen.

Setting Up the Monitor

1. Place the monitor face down on a smooth surface to avoid scratching or damaging the screen.

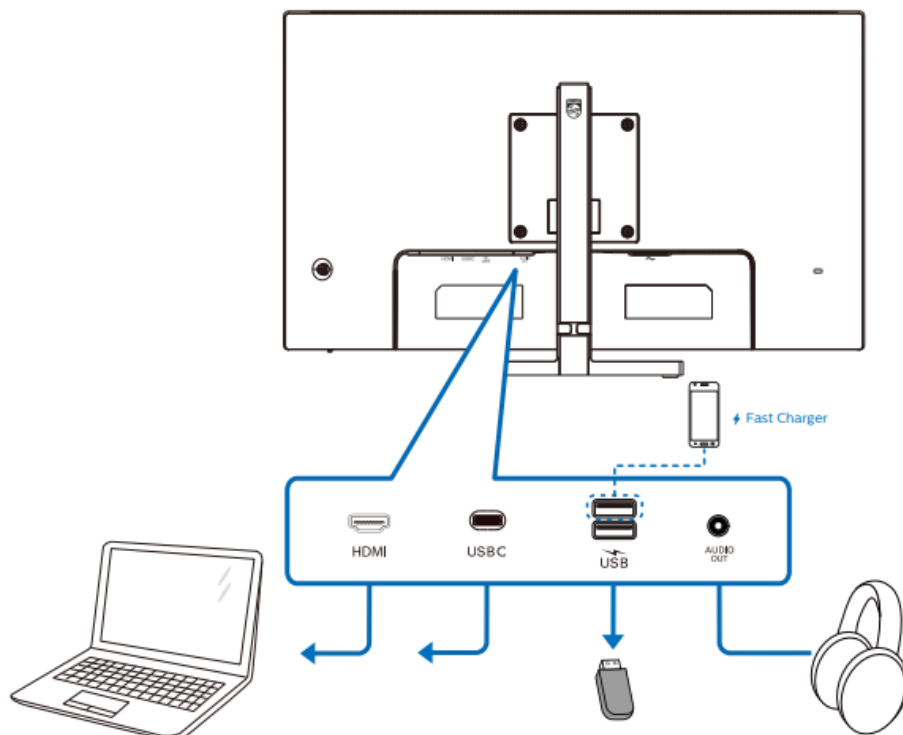
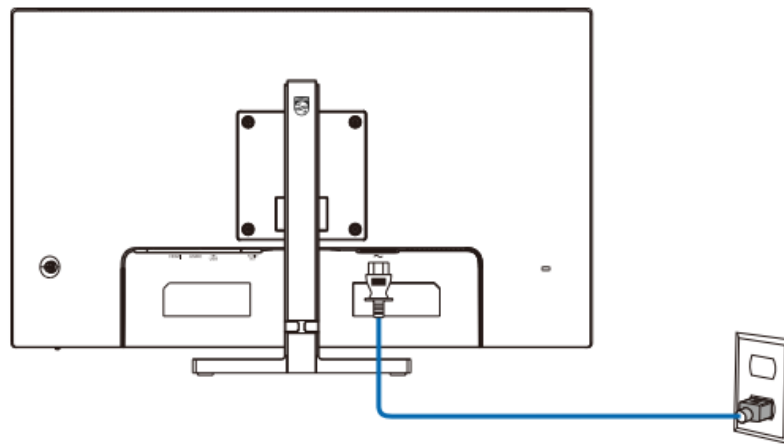
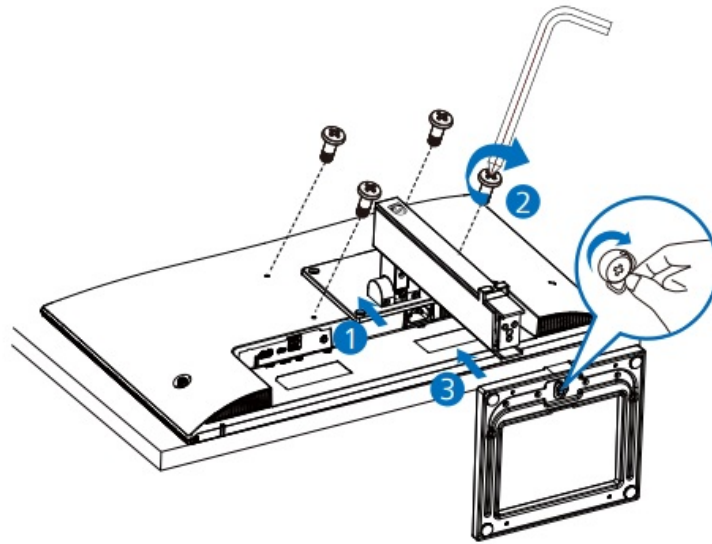

2. Connect the power cable and any necessary cables (HDMI, USB) to the corresponding ports on the monitor.

USB C-C

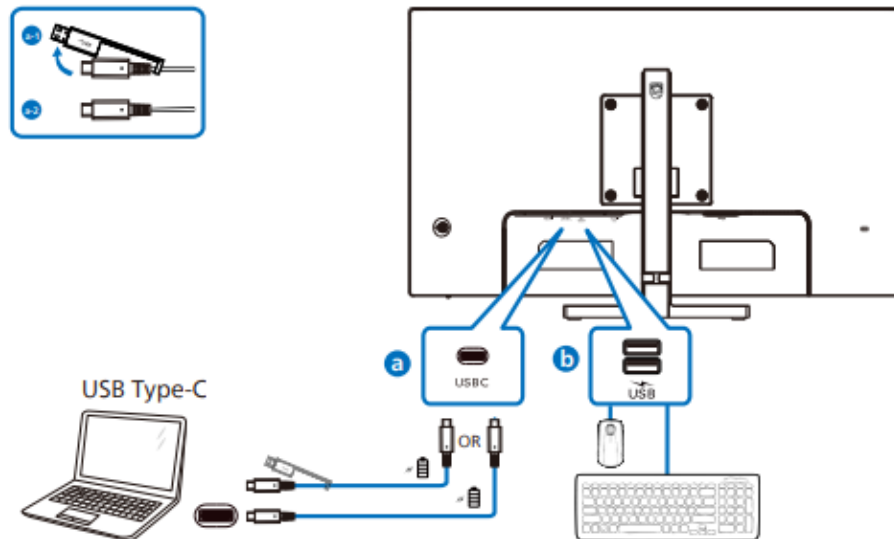

USB hub (USB A-C)

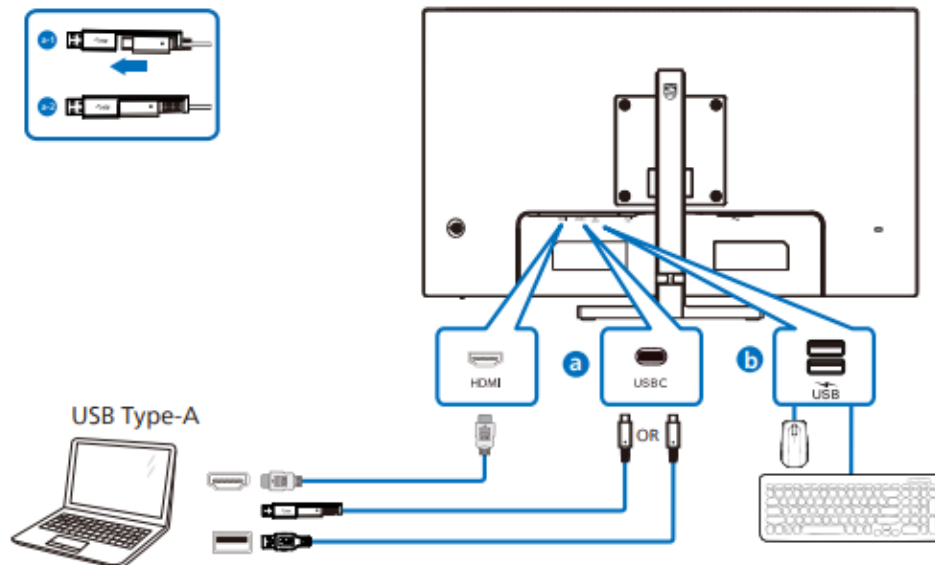

3. If using a USB hub, connect it to the monitor following the provided instructions.

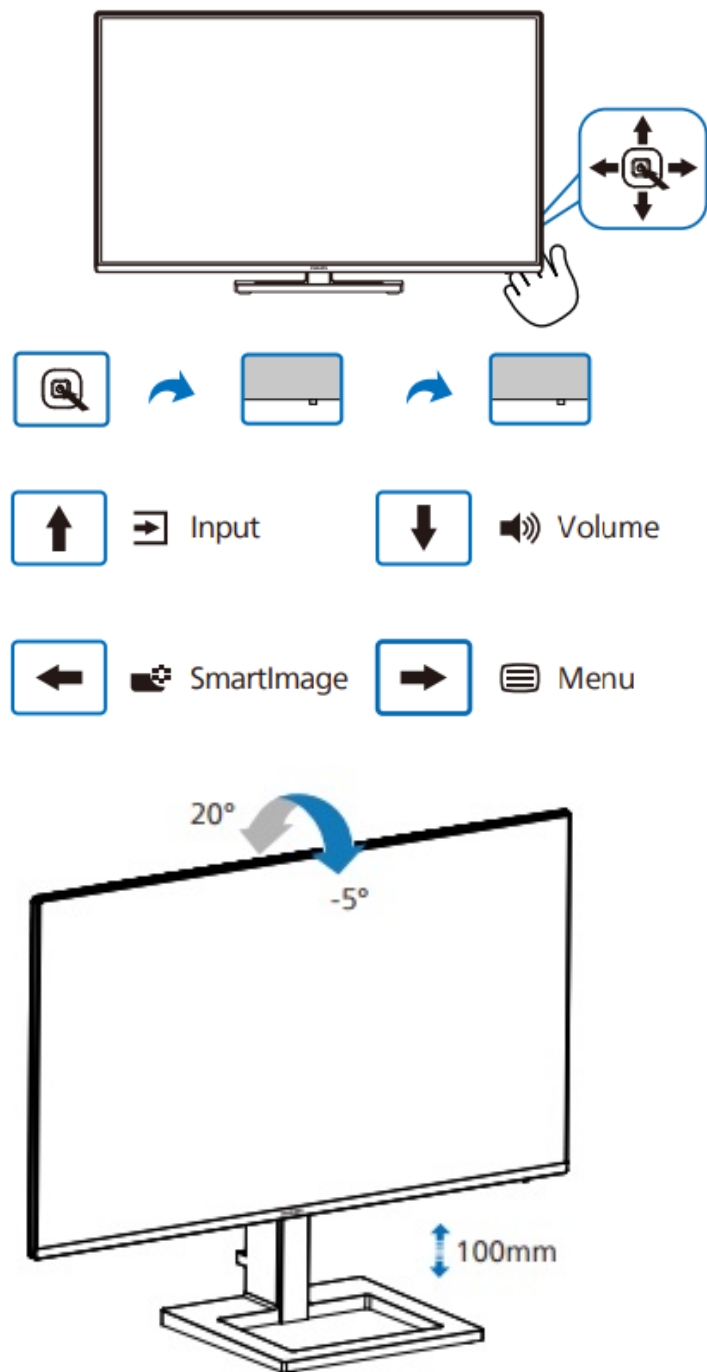

Using the Monitor Controls

The monitor features input selection, SmartImage adjustments, volume control, and menu navigation controls. Follow these steps:

1. Use the input button to select the desired input source.
2. Adjust SmartImage settings for optimal display performance.
3. Control the volume using the dedicated volume buttons.
4. Navigate through the menu options using the menu buttons.

Register your product and get support at www.philips.com/support



FAQ



Software



User
Manual

2025 © TOP Victory Investments Ltd. All rights reserved. This product has been manufactured by and is sold under the responsibility of Top Victory Investments Ltd., and Top Victory Investments Ltd. is the warrantor of this product.

Philips and the Philips Shield Emblem are registered trademarks of Koninklijke Philips N.V. and are used under license.

Specifications are subject to change without notice.

HDMI The terms HDMI, HDMI High-Definition Multimedia Interface, HDMI Trade Dress and the HDMI Logos are trademarks or registered trademarks of HDMI Licensing Administrator, Inc. www.philips.com



F41G24S1813XXA----

FAQs

Q: How do I register my product for support?

A: To register your product and receive support, visit www.philips.com/welcome or www.philips.com/support and follow the provided instructions.

Documents / Resources

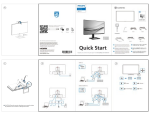
	PHILIPS 2000 Series LCD Monitor [pdf] User Guide 2000 Series, 2000 Series LCD Monitor, LCD Monitor, Monitor
---	--

References

- [Philips - United States | Philips](#)
- [Philips Customer Service Support - Home | Philips](#)
- [Product registration | Philips](#)
- [User Manual](#)

🔍 2000 Series, 2000 Series LCD Monitor, LCD Monitor, Monitor,

📁 Philips Philips

—Previous Post

PHILIPS 27B2U4601 Monitor User Guide

Next Post—

PHILIPS BVP166 LED Flood Light Installation Guide

Leave a comment

Your email address will not be published. Required fields are marked *

Comment *

Name

Email

Website

☐ Save my name, email, and website in this browser for the next time I comment.

Post Comment

Search:

e.g. whirlpool wrf535swhz

Search

[Manuals+](#) | [Upload](#) | [Deep Search](#) | [Privacy Policy](#) | [@manuals.plus](#) | [YouTube](#)

This website is an independent publication and is neither affiliated with nor endorsed by any of the trademark owners. The "Bluetooth®" word mark and logos are registered trademarks owned by Bluetooth SIG, Inc. The "Wi-Fi®" word mark and logos are registered trademarks owned by the Wi-Fi Alliance. Any use of these marks on this website does not imply any affiliation with or endorsement.