



PHEANOO D6 Sound Bar User Guide

[Home](#) » [PHEANOO](#) » PHEANOO D6 Sound Bar User Guide 

Contents

- 1 PHEANOO D6 Sound Bar
- 2 Product Information
- 3 Product Usage Instructions
- 4 CHECKING THE COMPONENTS
- 5 SOUNDBAR ASSEMBLE DETAILS
- 6 CONNECTING A TV
- 7 POWER YOUR SYSTEM
- 8 CHOOSE INPUT MODE
- 9 CHANGE AUDIO SETTINGS ON YOUR TV
- 10 CONTROL YOUR SOUNDBAR
 - 10.1 Top panel
 - 10.2 Remote control
- 11 Mounting your PHEANOO D6 Sound Bar
- 12 BLUETOOTH CONNECTION (OPTIONAL)
- 13 TROUBLESHOOTING
- 14 Documents / Resources
 - 14.1 References
- 15 Related Posts



PHEANOO D6 Sound Bar



Product Information

Specifications

- **Model:** D6
- **Components:**
 - Soundbar x 1
 - HDMI(ARC) cable x 1
 - 3.5mm to RCA audio cable x 1
 - Subwoofer x 1
 - Wall brackets x 2
 - Remote control x 1
 - Screws bag x 1
 - Adapter x 1
 - User manual x 1
 - Mounting template x 1
 - Quick Start Guide x 1

Product Usage Instructions

Checking the Components

Before starting, make sure you have all the required components:

- Soundbar x 1
- HDMI(ARC) cable x 1
- 3.5mm to RCA audio cable x 1
- Subwoofer x 1

- Wall brackets x 2
- Remote control x 1
- Screws bag x 1
- Adapter x 1
- User manual x 1
- Mounting template x 1
- Quick Start Guide x 1

Soundbar Assembly Details

Follow the steps below to assemble the soundbar:

1. **STEP 1:** Plug the audio connector into the audio input port on another main unit.
2. **STEP 2:** Align the arrows on the two stickers.
3. **STEP 3:** Twist clockwise about 20 degrees until it locks securely.

Connecting a TV

Choose one of the following options to connect your TV:

Option 1: HDMI ARC

If your TV has an ARC (Audio Return Channel) label on one of its HDMI ports:

- Connect the HDMI cable to your TV's HDMI ARC jack and the soundbar's TV(ARC) jack.

Option 2: Optical

If your TV has no ARC label on its HDMI ports:

- Connect the optical cable to your TV's OPTICAL OUT jack and the soundbar's OPTICAL jack.

Option 3: AUX

If your TV has no ARC label on its HDMI ports:

- Connect the 3.5mm to RCA audio cable to your TV's AUDIO OUT jack and the soundbar's AUX jack.

Power Your System

Note:

Batteries are not included for shipping safety. You will need two AAA batteries.

Choose Input Mode

Turning On:

- If you hear audio coming from your TV's internal speaker, make sure the TV speaker is off or set to the minimum volume.
- Select the soundbar input mode by pressing the TV ARC, AUX, OPT, and BT mode buttons on the remote control.

Change Audio Settings on Your TV

Follow these steps to enable Consumer Electronics Control (CEC) on your TV (Exclusive for Option 1: HDMI ARC connection):

1. **Enable CEC on your TV. Note:** Only Option 1: HDMI ARC connections need to enable CEC.
2. These are names different brands might use for HDMI-CEC:
 - Samsung(Anynet+++)
 - Vizio(CEC)
 - Sony(Bravvia Sync)
 - LG(SimpLink)
 - Sharp(Aquos Link)
 - Philips(EasyLink)
 - Roku(1-Touch Play)

Control Your Soundbar

Top Panel

Use the following buttons on the top panel:

- Long Press 3 Seconds: Power On/Off
- Short Press 1 Second: Switch Input Source
- Volume Down
- Volume Up

Remote Control

Use the following buttons on the remote control:

1. **POWER:** Turns on the Sound Bar or sets it to standby mode.
2. **MUTE:** Turn off the sound temporarily.
3. **TREB+:** Increase treble level.
4. **TREB-:** Decrease treble level.
5. **VOL+:** Increase volume.
6. **VOL-:** Decrease volume.
7. **RESET(PLAY/PAUSE):** Start, pause, or resume play in BT Mode. Press and hold for about 2 seconds to reset the volume level and switch to the Music EQ effect.
8. **BASS+:** Increase bass level.
9. **BASS-:** Decrease bass level.
10. **MUSIC:** Select MUSIC for the sound effect.
11. **MOVIE:** Select MOVIE for the sound effect.
12. **DIALOGUE:** Select DIALOGUE for the sound effect.

FAQ

- **Q: Do I need batteries for the remote control?**

A: Yes, you will need two AAA batteries for the remote control. Please note that batteries are not included for shipping safety.

- **Q: How do I change the input mode on the soundbar?**

A: You can change the input mode by pressing the corresponding buttons on the remote control. The available input modes are TV ARC, AUX, OPT, and BT.

- **Q: What should I do if I hear audio coming from my TV's internal speaker?**

A: Make sure to turn off or set the TV speaker to the minimum volume. This will ensure that the audio is played through the soundbar.

- **Q: How do I control the soundbar's volume?**

A: You can control the soundbar's volume using the Volume Up and Volume Down buttons on the top panel or the VOL+ and VOL- buttons on the remote control.

CHECKING THE COMPONENTS

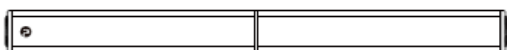

Soundbar x 1

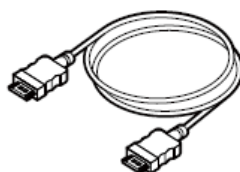

HDMI(ARC) cable x 1

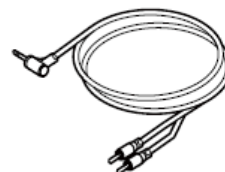

3.5mm to RCA audio cable x 1

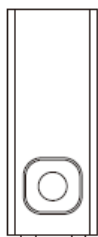

Subwoofer x 1

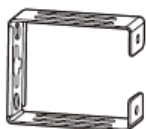

Wall brackets x 2

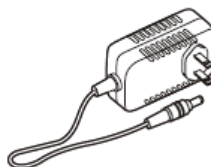

Adapter x 1

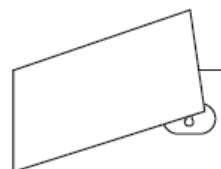

Mounting template x 1



Remote control x 1

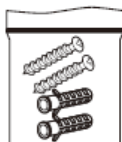

Screws bagx 1

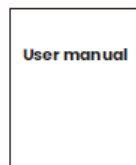

User manual x 1

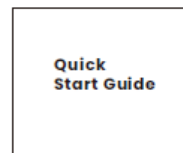

Quick Start Guide x 1

SOUNDBAR ASSEMBLE DETAILS

- **STEP 1:** Plug the audio connector into the audio input port on another main unit
- **STEP 2:** Align the arrows on the two stickers
- **STEP 3:** Twist clockwise about 20 degrees until locks securely



CONNECTING A TV

OPTION 1 (Preferred): HDMI ARC

If the TV has an ARC (Audio Return Channel) label on one of its HDMI ports, connect the HDMI cable to your TV's HDMI ARC jack and the soundbar's TV(ARC) jack.

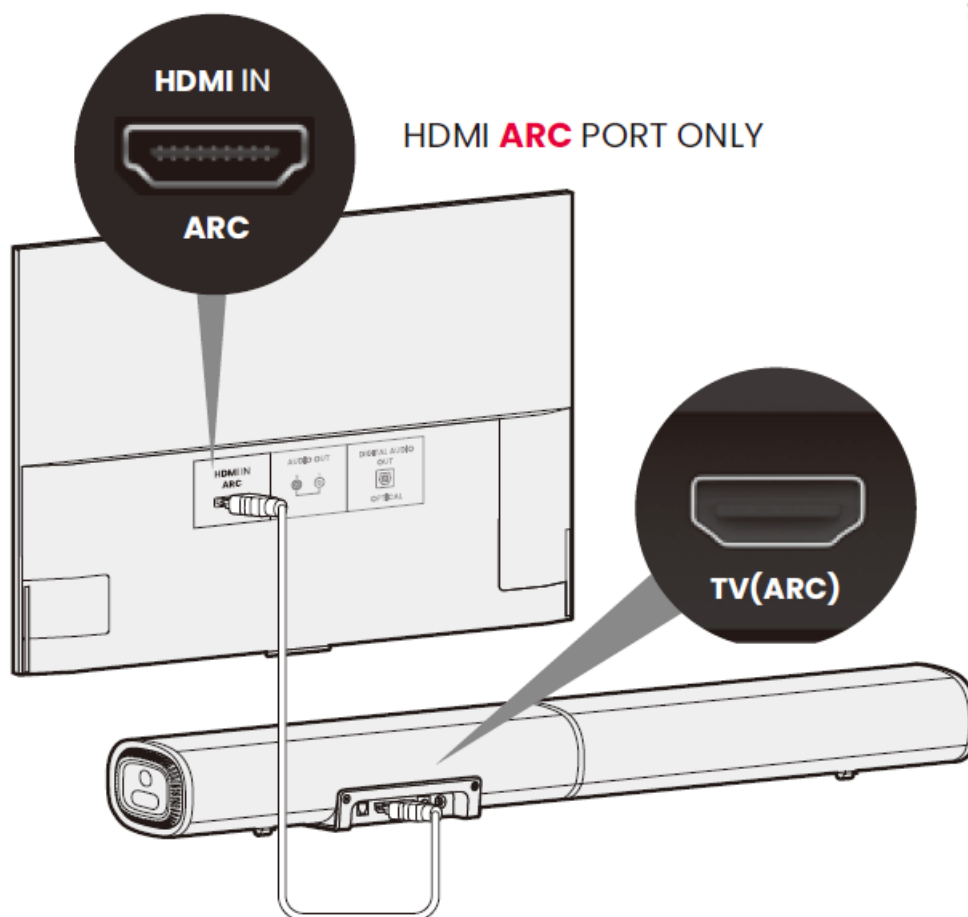

NOTE

- HDMI connection is unavailable if your TV does not have an HDMI port labeled “ARC” Connecting via HDMI(ARC) enables the following functions using the TV’s remote control:
 - **Turn the power on and off**
Both the TV and the sound bar turn on/off at the same time.
 - **Volume adjustment**
The soundbar’s volume can be adjusted when the TV’s audio output is set to the soundbar.

OPTION 2: OPTICAL

If the TV has no ARC label on its HDMI ports, connect the optical cable to your TV’s OPTICAL OUT jack and the soundbar’s OPTICAL jack.

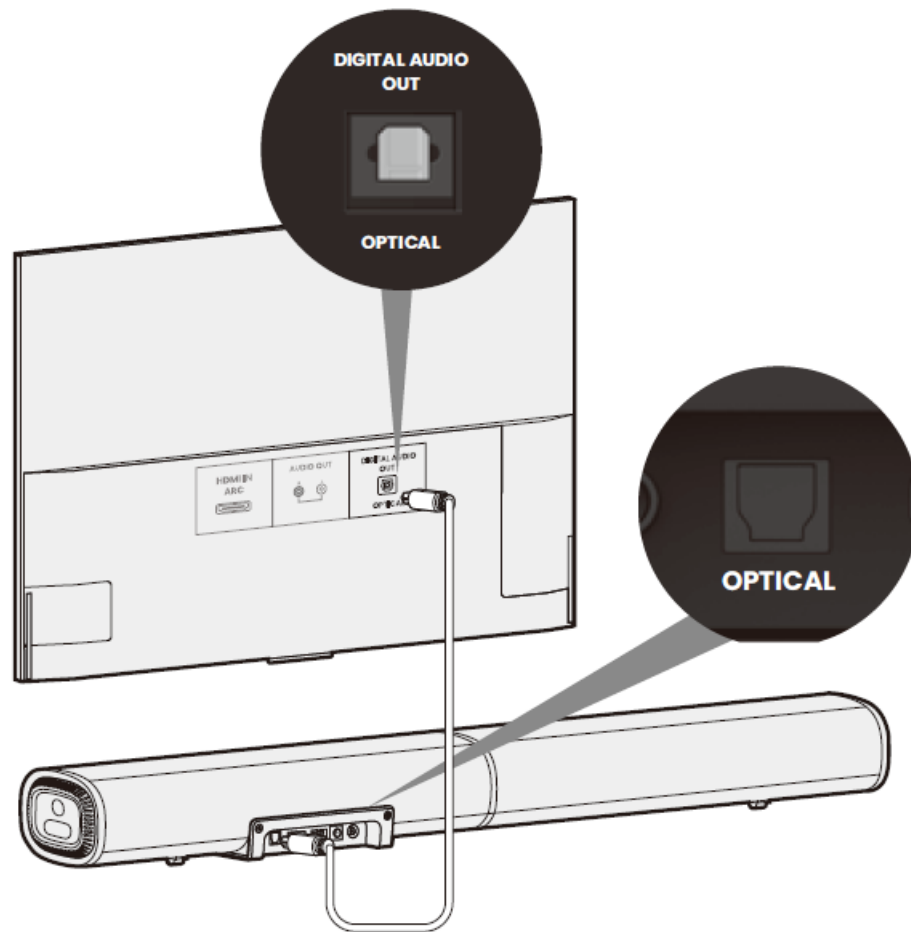
**NOTE**

If you hear audio coming from the TV's internal speaker, make sure the TV speaker is off or min volume.

OPTION 3: AUX

If the TV has no ARC label on its HDMI ports, connect the 3.5mm RCA audio cable to your TV's AUDIO OUT jack and the soundbar's AUX jack.

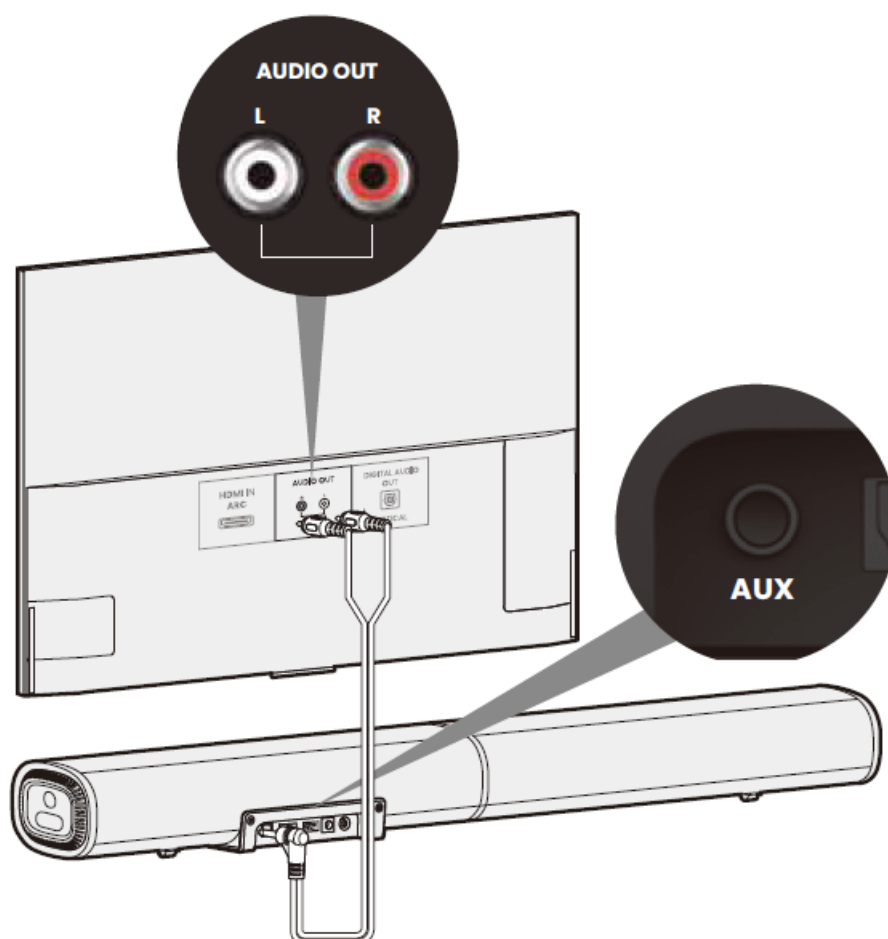

NOTE

- Make sure that the cable ends match the color of the ports.
- Some TV models have AUDIO IN jack only. it can't deliver an audio signal to the soundbar.

POWER YOUR SYSTEM

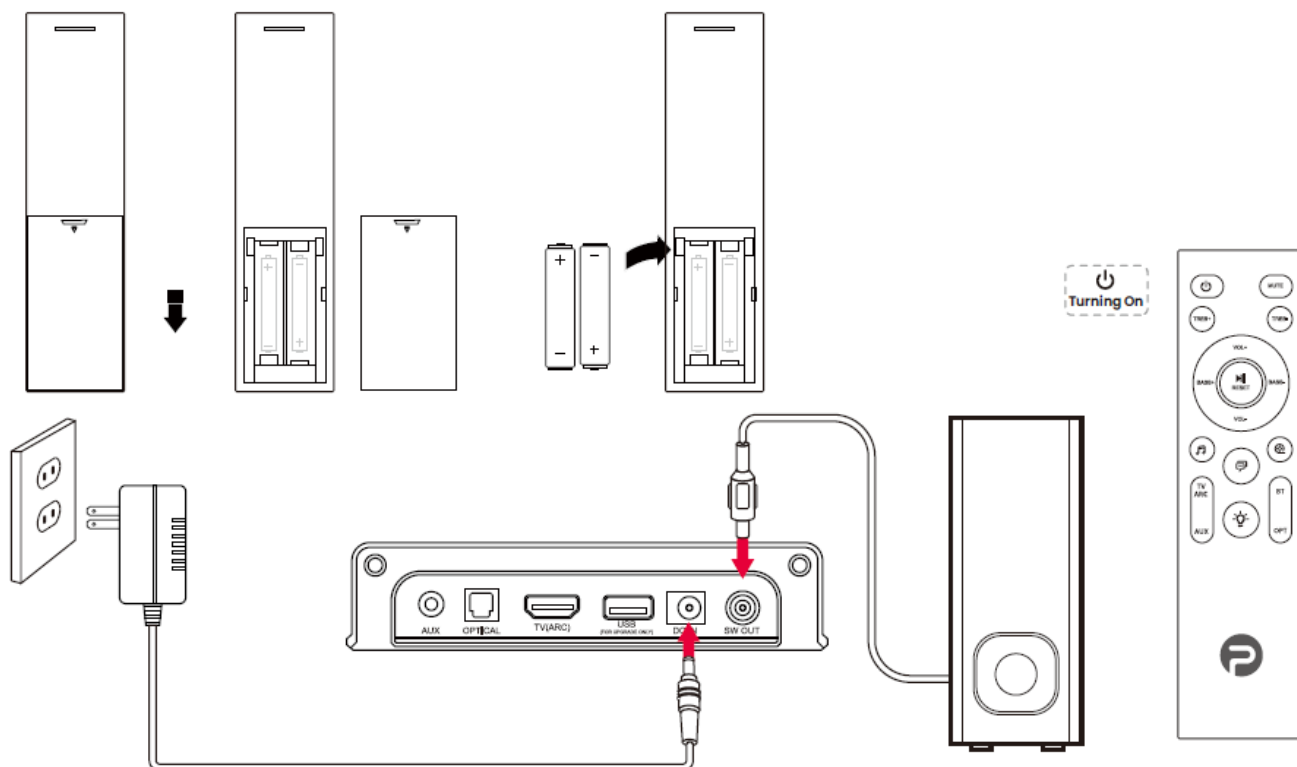

"Batteries not included for shipping safety. Two AAA batteries needed"

CHOOSE INPUT MODE

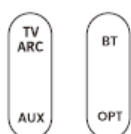
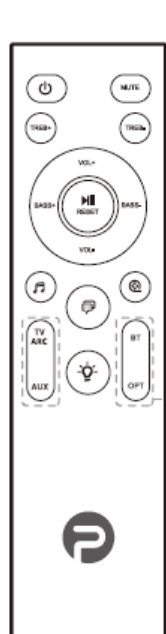

Select the soundbar input mode by pressing the **TV ARC**, **AUX**, **OPT**, and **BT** mode button on the remote control

INPUT MODE INDICATORS	TV CONNECTION
● TV ARC mode	Option 1 (Preferred) : HDMI ARC
● OPT mode	Option 2 : OPTICAL
● AUX mode	Option 3 : AUX
● BT mode	BLUETOOTH CONNECTION

LED Indicators are located here

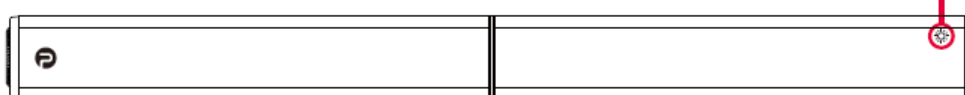

NOTE

- Input mode on the soundbar needs to match the connected external device (TV, Projector, Cable box, etc.) output mode.
- Make sure the LED light on the soundbar matches the TV connection method.

CHANGE AUDIO SETTINGS ON YOUR TV

Very Important!

Enable Consumer Electronics Control (CEC) on your TV(Exclusive for Option 1: HDMI ARC connection)



NOTE

1. **Only Option 1:** HDMI ARC connections need to enable CEC
2. **These are names different brands might use for HDMI-CEC:** Samsung(Anynet+++), Vizio(CEC), Sony(Bravia Sync), LG(SimpLink), Sharp(Aquos Link), Philips (EasyLink), Roku(1-Touch Play)

CONTROL YOUR SOUNDBAR

Top panel

Long Press 3 Seconds---Power On/Off
Short Press 1 Second---Switch Input Source

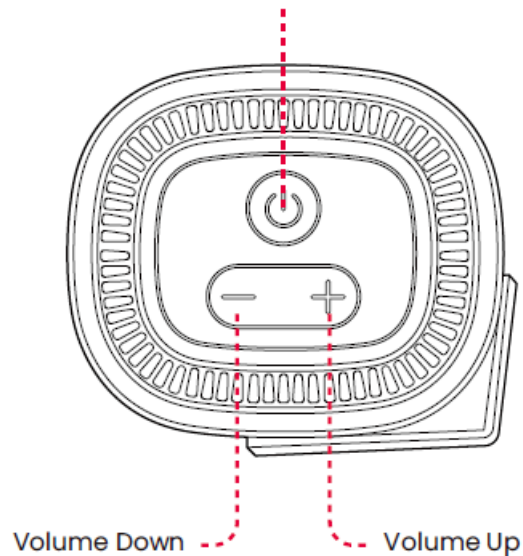

Remote control

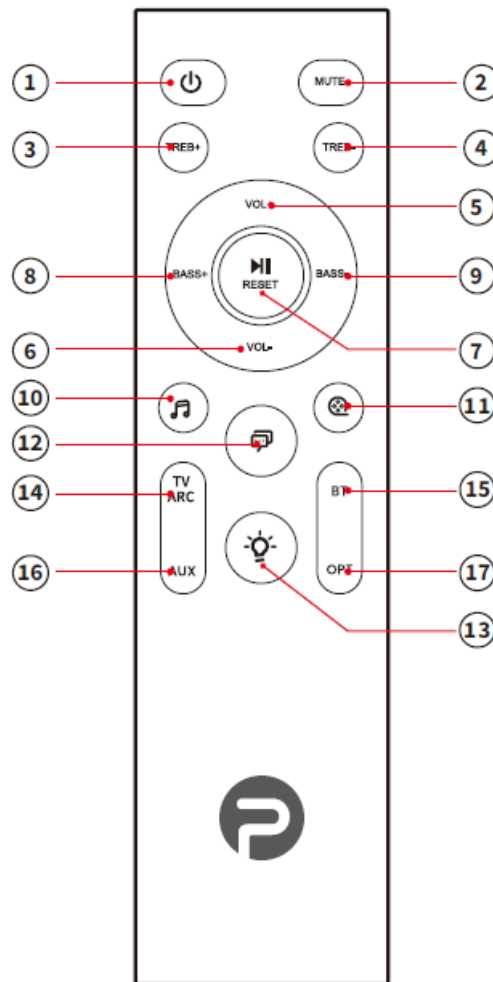

1. POWER

Turns on the Sound Bar or sets it to standby mode.

MUTE

2. MUTE

Turns off the sound temporarily

TREB+

3. TREB+

Increase treble level

TREB-

4. TREB-

Decrease treble level

VOL+

5. VOL+

Increase volume

VOL-

6. VOL-

Decrease volume



RESET

7. RESET(PLAY/PAUSE)

Start, pause or resume play in BT Mode Press and hold for about 2 seconds to reset the volume level and switch to the Music EQ effect.

BASS+

8. BASS+

Increase bass level

BASS-

9. BASS-

Decrease bass level



10. MUSIC

Selects MUSIC for the sound effect



11. MOVIE

Selects MOVIE for the sound effect



12. DIALOGUE

Selects DIALOGUE for the sound effect



13. INDICATOR

Press to turns on/off the indicators on the Bar Speaker.

TV
ARC

14. TV ARC

Set the input source for the Soundbar to HDMI ARC mode

BT

15. BT

Set the input source for the Soundbar to Bluetooth mode

AUX

16. AUX

Set the input source for the Soundbar to AUX mode

OPT

17. OPT

Set the input source for the Soundbar to Optical mode

Mounting your PHEANOO D6 Sound Bar

1. Remove the 2 screws from the main unit

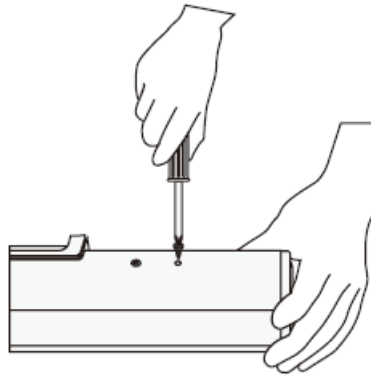

2. Paste the EVA foam A (with holes) on the wall bracket

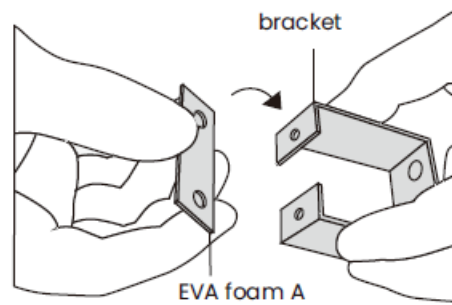

3. Install the wall bracket into the main unit

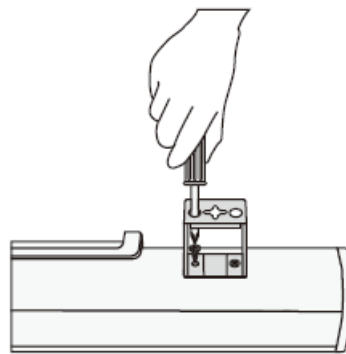

4. Mark the wall

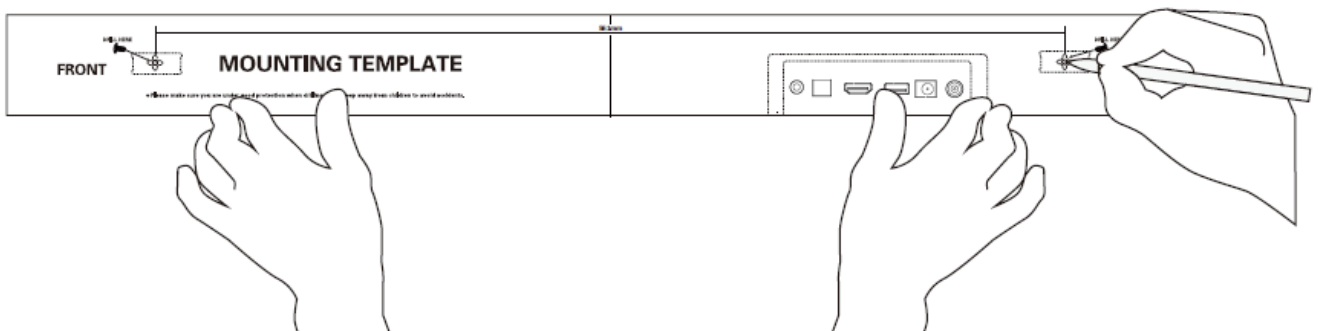

5. 1. Drill screw holes at markings
2. Insert the wall anchors
3. Insert the screws into the wall anchors

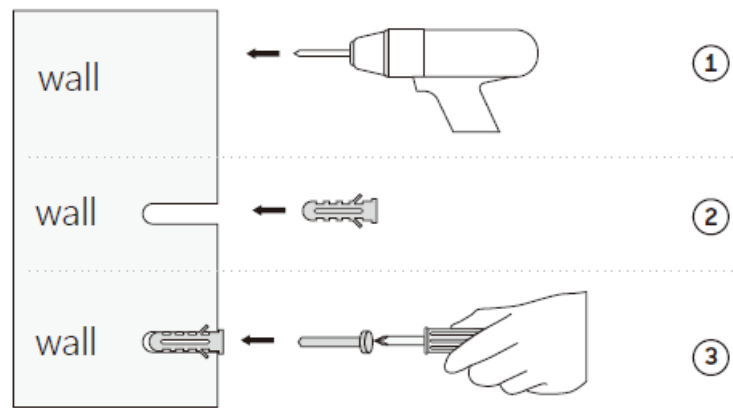

6. Paste the EVA foam B (without holes) on the wall bracket.

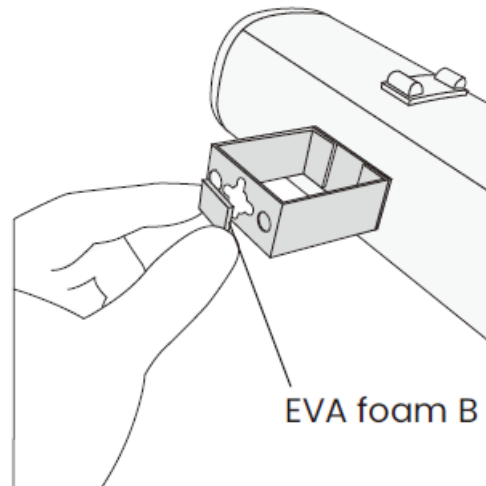

7. Hang the soundbar on the wall

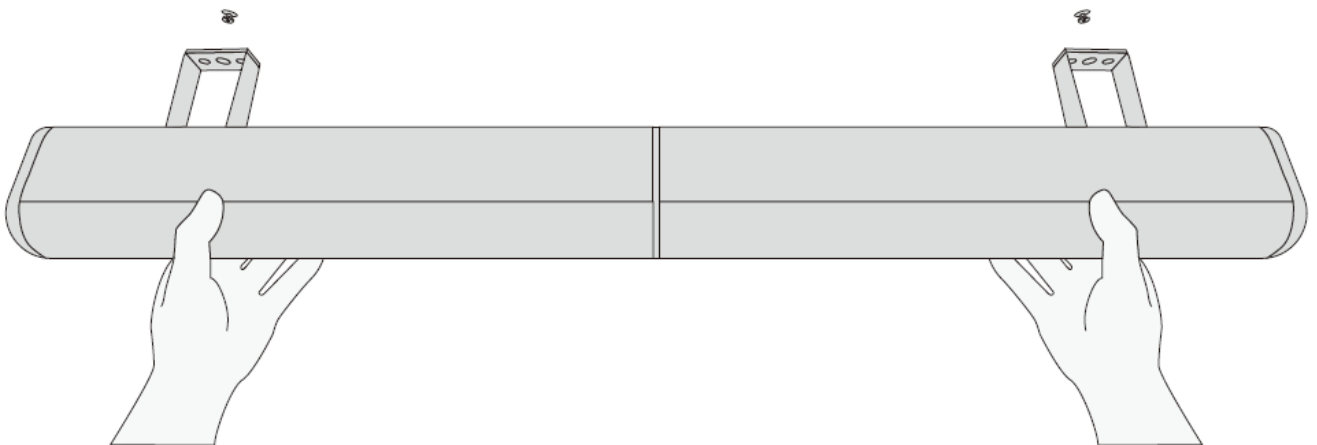

BLUETOOTH CONNECTION (OPTIONAL)

1. Press the (Bluetooth) button on the Soundbar (or remote control unit) until the Bluetooth LED blinks in blue.
2. Go to the Bluetooth settings on your device and make sure Bluetooth is turned ON.
3. **Select "D6".**

The Bluetooth LED turns solid blue to indicate that the Soundbar is being paired with your Bluetooth device

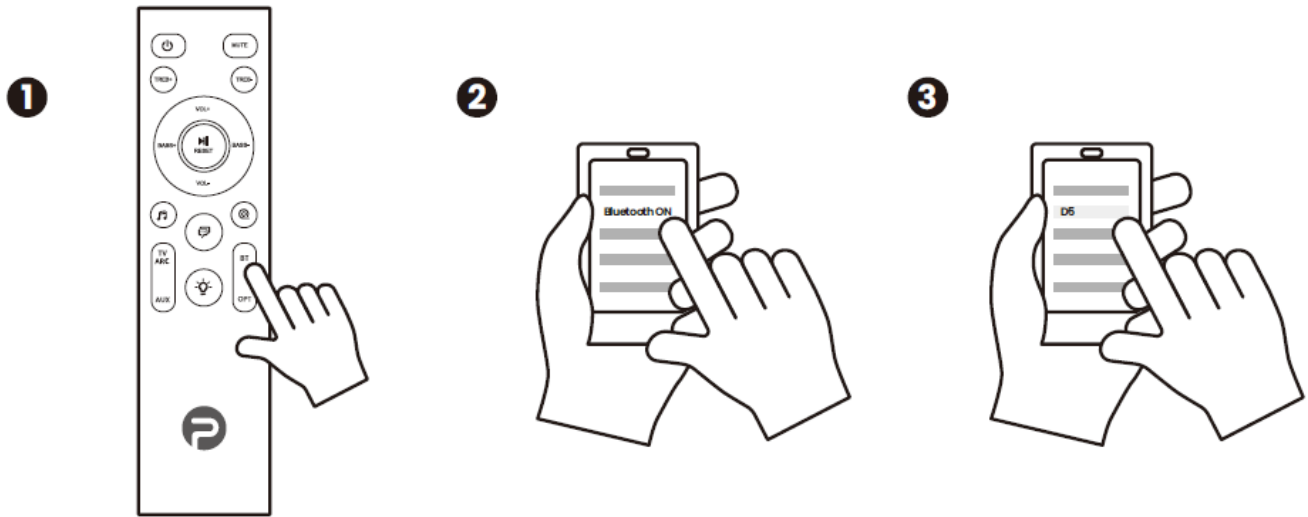

TROUBLESHOOTING

ISSUES	PROBLEMS	SOLUTIONS
Sound	No sound from SoundBar speakers	<ol style="list-style-type: none"> 1. Make sure that the soundbar is plugged into a power source 2. Make sure the soundbar's HDMI cable is inserted into an HDMI ARC or Audio Return Channel connector on your TV, not a standard HDMI connector. 3. If the soundbar is connected to your TV's HDMI ARC connector, make sure that Consumer Electronics Control (CEC) is enabled in your TV system menu. Your TV may refer to CEC by a different name. Refer to your TV owner's guide. 4. On the remote control, select the correct audio input. 5. Ensure the audio output format is set to PCM
	Distorted sound or echo	Distorted sound of you play audio from the TV through the SoundBar, make sure that the TV is muted.
Bluetooth	A device cannot connect with the SoundBar	You have not enabled the Bluetooth function of the device. See the user manual of the device on how to enable the function.
		The SoundBar is already connected with another Bluetooth device. Disconnect the connected device, then try again.

FIRMWARE UPDATE

Occasionally, PHEANOO provides important firmware updates for your soundbar. Updating the firmware on your soundbar gives you all the benefits of the latest improvements. If an update is available from PHEANOO, you can download it onto a USB device, and then upload it to your soundbar.

• Step 1. Preparing the USB Drive

1. Important Specs for USB Drive: USB2.0; Max Drive Size: 32GB
2. Plug a USB drive into your PC/Mac
3. Reformat the USB drive to "FAT16" or "FAT32" format.



Recommended USB 2.0 Drives

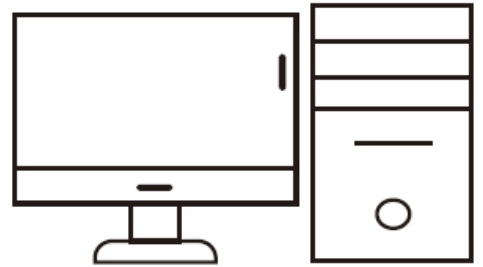

PC/MAC

- **Step 2.** Download the Firmware Version from www.pheanoo.com/firmware.html.



A. Download the "D5 FIRMWARE"

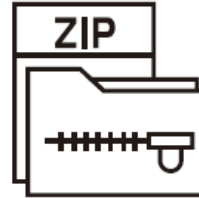

B. Unzip the download file



C. Open the folder to locate "fw5000.upd" firmware files



D. Copy and Paste the "fw5000.upd" files into your USB drive.

Do not change the name of the files

(Do not copy the folder or the update will not work)

- **Step 3.** Press the Power on button on your remote control.

Power on the soundbar

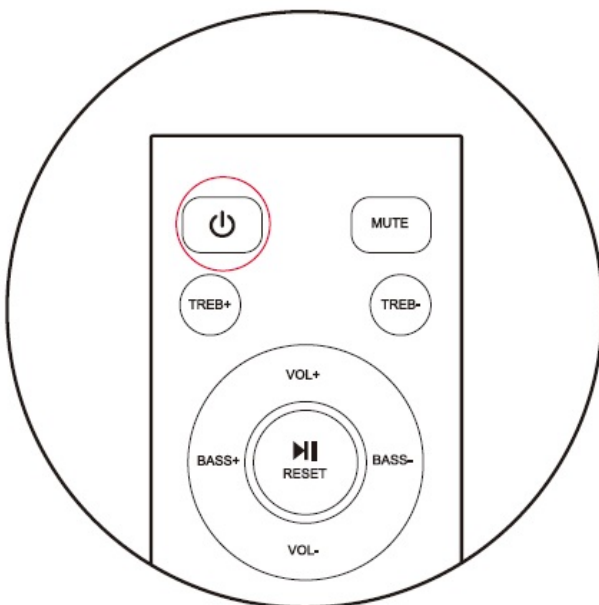

- **Step 4.** Plug USB Drive into USB Port

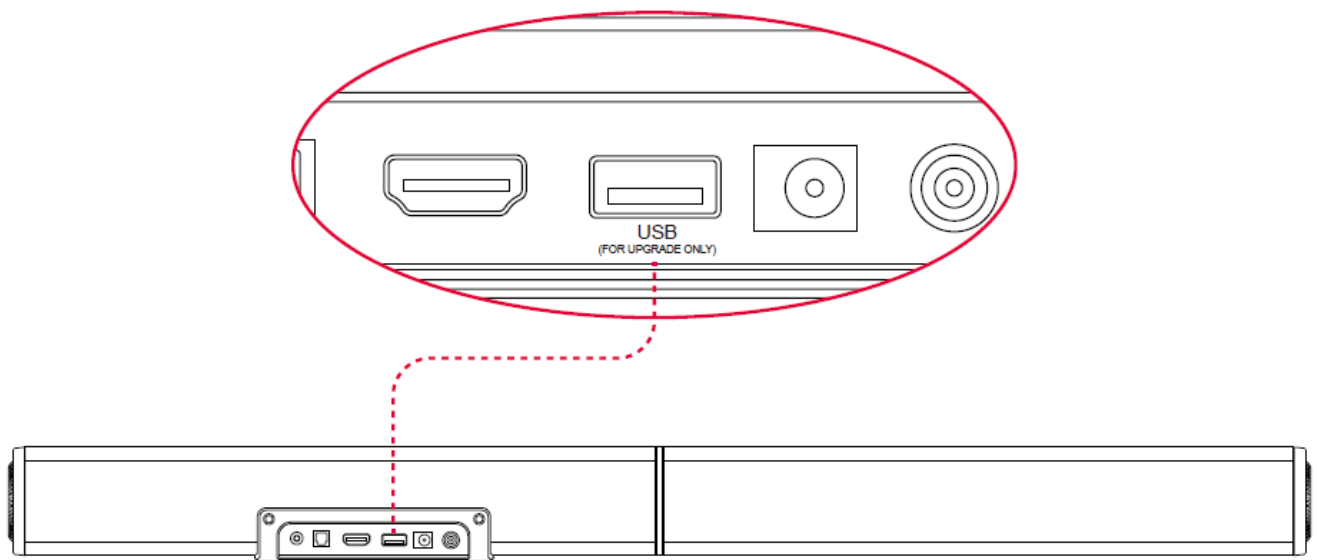

Back of PHEANOO soundbar

- **Step 5. Upgrading the Soundbar**

1. The soundbar will automatically start upgrading after the USB drive is inserted.

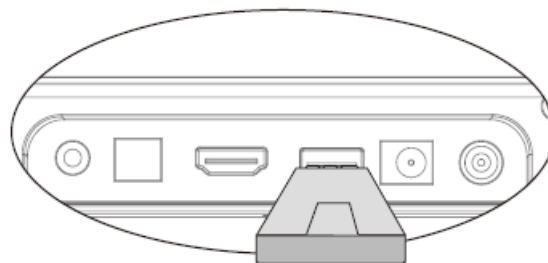

2. The front indicator on the soundbar will be Purple while upgrading.



3. After the upgrade is completed, The front indicator will change to RED.



4. Then unplug the soundbar from the wall outlet and remove the USB Drive.

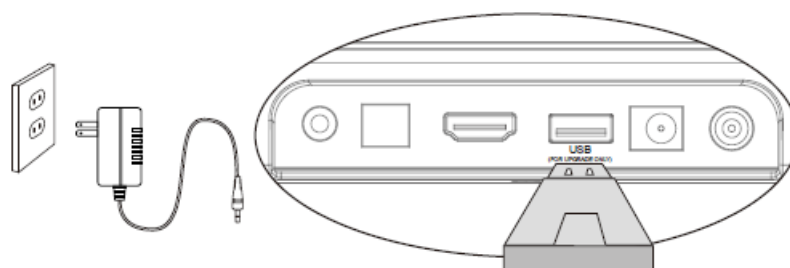

IMPORTANT

1. Only drives with these specs will work USB2.0; Max Drive Size: 32GB.
2. Do not remove the USB drive or turn off your Soundbar while upgrading.

If the soundbar system does not work after the firmware upgrade, please contact our support immediately at support@pheanoo.com.

Documents / Resources

	<p>PHEANOO D6 Sound Bar [pdf] User Guide D6 Sound Bar, D6, Sound Bar, Bar</p>
---	---

References

- [PHEANOO](#)
- [User Manual](#)