



Phasemation CS-900 Head Shell Owner's Manual

[Home](#) » [Phasemation](#) » Phasemation CS-900 Head Shell Owner's Manual 

Contents

- [1 Phasemation CS-900 Head Shell](#)
- [2 Product Information](#)
- [3 Product Usage Instructions](#)
- [4 Installation Notes](#)
- [5 Main Dimensions](#)
- [6 Specifications](#)
- [7 Attachments](#)
- [8 Documents / Resources](#)
 - [8.1 References](#)

Phasemation

Phasemation CS-900 Head Shell



Product Information

Thank you for purchasing the CS-900 Head Shell from Phasemation. This product is designed to enhance your audio experience. Please read the following instructions carefully to ensure proper use and enjoyment of the product.

Specifications:

1. Material: Machined Aluminum
2. Treatment: Anodization
3. Weight: 13.3g (including lead wire, hook, attaching screw M2.6×10, nut, washer)
4. Lead Wires: 4N copper wire

Appearance and specifications are subject to change without notice due to improvements.

Main Dimensions:

- Length: 44.6mm
- Width: 12.7mm
- Height: 19.5mm
- Mounting Screw Size: M2.6×6, M2.6×10, M2.6×16 (2pcs each)

Installing Example Polarity:

Seen from the cartridge side:

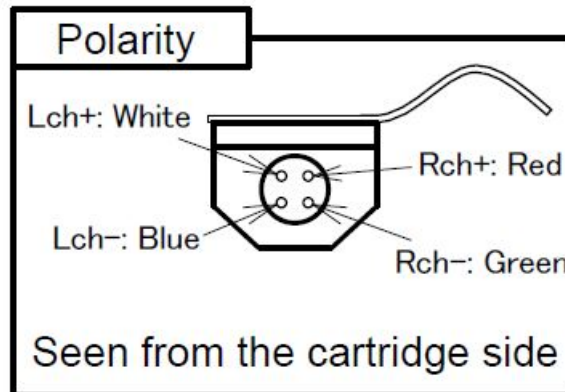
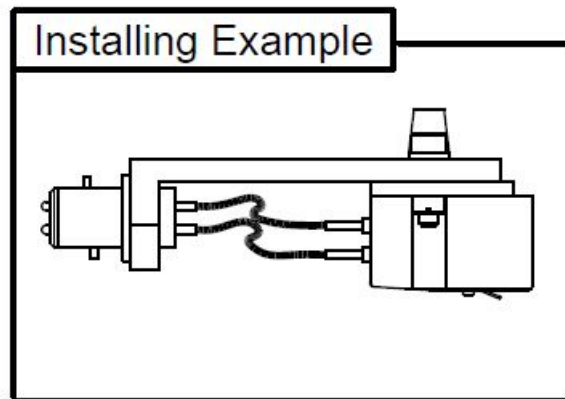

- Lch+: White
 - Lch-: Blue
 - Rch+: Red
 - Rch-: Green
-
- Lead wire – 4 pcs
 - Hook (brass) – 1 pc
 - Hexagonal wrench for screw tightening (steel) – 1 pc
 - Mounting nut (aluminum) – 2 pcs
 - Washer (polyslider) – 4 pcs
 - Mounting screw (steel) – M2.6×6, M2.6×10, M2.6×16 (2pcs each)

Kyodo Denshi Engineering Co., Ltd. is the original audio brand of Kyodo Denshi Engineering Co., Ltd.

Contact Information:

- Address: 8-40-17 Shinyoshidahigashi, Kohoku-ku, Yokohama, Kanagawa, 223-0058 Japan
- Phone: 81-45-710-0975
- Fax: 81-45-710-0976
- Website: <https://phasemation.com>

Product Usage Instructions

1. Before starting the installation, carefully read and understand the user manual.

2. Ensure that you have all the necessary attachments and tools mentioned in the manual.
3. Choose the appropriate mounting screw size (M2.6×6, M2.6×10, or M2.6×16) based on your setup requirements.
4. Identify the polarity of the cartridge by referring to the instructions and make note of the color coding.
5. Attach the lead wires to the head shell following the polarity instructions:
 - Lch+ (Left Channel Positive): Connect the white lead wire.
 - Lch- (Left Channel Negative): Connect the blue lead wire.
 - Rch+ (Right Channel Positive): Connect the red lead wire.
 - Rch- (Right Channel Negative): Connect the green lead wire.
6. Use the provided hexagonal wrench to tighten the mounting screws securely.
7. Verify that all connections are properly made and secure.
8. Proceed with the setup of your audio system as per the manufacturer's instructions.

For further assistance or troubleshooting, please refer to the user manual or contact Phasemation's customer support.

Thank you for purchasing this Phasemation product. Please read the following instructions carefully to follow the proper use of CS-900 before setting it up in order to enjoy this product for many years.

Installation Notes

(For installation, please follow the instruction manual of the cartridge and arm and pay attention to the following items.)

1. Connect the lead wires and the cartridge terminals with the left and right polarities matched.
2. Fix the cartridge to the shell matching the overhang position that is specified for the pickup arm. When tightening the screws, be careful not to upset the left-right balance of the cartridge mounting position.
3. Install the shell on the pickup arm with caution so that it does not tilt to the left or right. (Since the sound quality was prioritized when this was designed, the rubber ring of the terminal is not included.)
4. Do not touch the terminals or connectors where lead wires are inserted directly with bare hands. Doing so may cause corrosion or poor contacts.
5. Adjust the height and needle pressure of the pickup arm.
6. The included screws are made of steel for the sound quality and strength.

The included wrench is also made of steel and therefore please be careful not to let it adhere to or damage the magnetic circuit of the cartridge during installation. The included washers are made of resin to make it spin in order to prevent over-tightening.

Main Dimensions

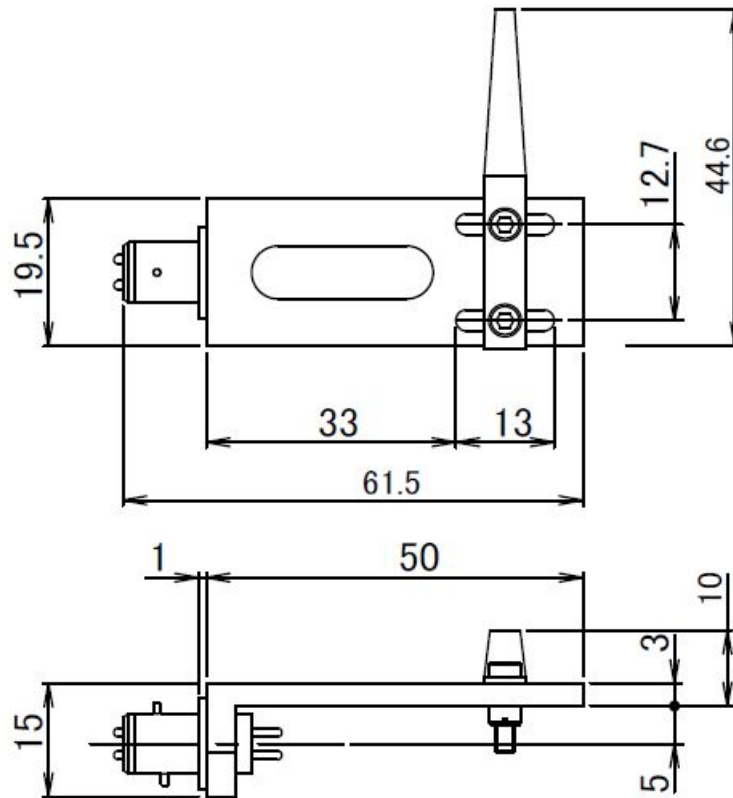

Specifications

1. **Material:** Machined Aluminum
2. **Treatment:** Anodization
3. **Weight:** 13.3g \pm 0.3 (including lead wire, hook, attaching screw M2.6 \times 10, nut, washer)
4. **Lead Wires:** 4N copper wire

Appearance and specifications are subject to change without notice due to improvements

Attachments

1. Lead wire 4 pcs
2. Hook (brass) 1pc
3. Hexagonal wrench for screw tightening (steel) 1pc
4. Mounting nut (aluminum) 2pcs
5. Washer (poly slider) 4pcs
6. Mounting screw (steel) 2pcs each

M2.6 \times 6 M2.6 \times 10 M2.6 \times 16

Kyodo Denshi Engineering Co., Ltd.

8-40-17 Shinyoshidahigashi, Kohoku-ku, Yokohama, Kanagawa, 223-0058 Japan

TEL 81-45-710-0975

FAX 81-45-710-0976

URL <https://phasemation.com>

is the original audio brand of Kyodo Denshi Engineering Co., Ltd.

Documents / Resources

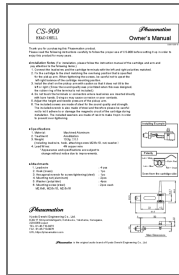

[Phasemation CS-900 Head Shell](#) [pdf] Owner's Manual
CS-900, CS-900 Head Shell, Head Shell, Shell

References

- Phasemation

Manuals+,