



Contents [[hide](#)]

- [1 PGST PG-B01 Sound and Light Door and Window Alarm](#)
- [2 Product Specifications](#)
- [3 Product Information](#)
- [4 Product Usage Instructions](#)
- [5 Product Introduction](#)
- [6 Functional Diagram](#)
- [7 Function Button Introduction](#)
- [8 Connect With the Mobile APP](#)
- [9 APP Operation](#)
- [10 Installation](#)
- [11 Installation Precautions](#)
- [12 Maintenance](#)
- [13 Technical parameters](#)
- [14 Environmental Protection](#)
- [15 FCC Statement](#)
- [16 Frequently Asked Questions \(FAQ\)](#)
- [17 Documents / Resources](#)
 - [17.1 References](#)



PGST PG-B01 Sound and Light Door and Window Alarm

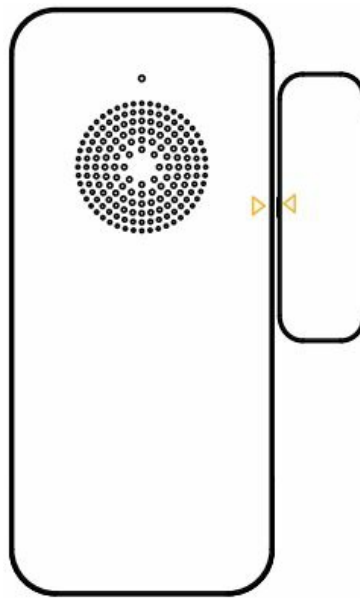

Product Specifications

- **Operating voltage:** DC3V

Product Information

This sound and light door and window alarm consists of two parts: a sensor and a magnet. It utilizes WiFi communication technology to detect the open or closed status of doors and windows, transmitting status changes to the mobile app. The sensor is versatile and suitable for various door and window types.

Product Usage Instructions

Function Button Introduction:

To initiate network configuration:

- Press and hold the Setup button for 5 seconds.
- The buzzer will beep, and the indicator light will flash.

Connect With the Mobile APP:

To connect the device with the mobile app:

- Press and hold the setup button for 5 seconds.
- The buzzer will sound, and the LED light will keep flashing.
- Swipe down to open the housing symbol.

APP Operation:

To operate the app:

- Click Settings to set arming/disarming/open door alarm/alarm time/alarm volume.
- Turn on arming: The device is in hibernation and needs to be triggered to take effect.
- Open Door Alarm: When armed, opening the door triggers a sound and light alarm.
- Close the door alarm: No sound and light alarm when armed, and the door magnet is opened.

Installation:

To install the battery:

- Align the fasteners and push up to close the rear cover.

Installation Precautions:

Ensure:

- WiFi distance between the router and the device is within 10m.
- The gap between the components does not exceed 0.7cm.

Maintenance:

For maintenance:

- Replace with new LR6 AAAM-3 (2X1.5) batteries when needed.
- Fix the housing securely after replacement.

Product Introduction

This sound and light door and window alarm consists of two parts: sensor and magnet, It adopts WiFi communication technology, can detect the open or closed status between doors and windows, and report the status change to APP. The sensor is suitable for different types of doors and windows.

Functional Diagram

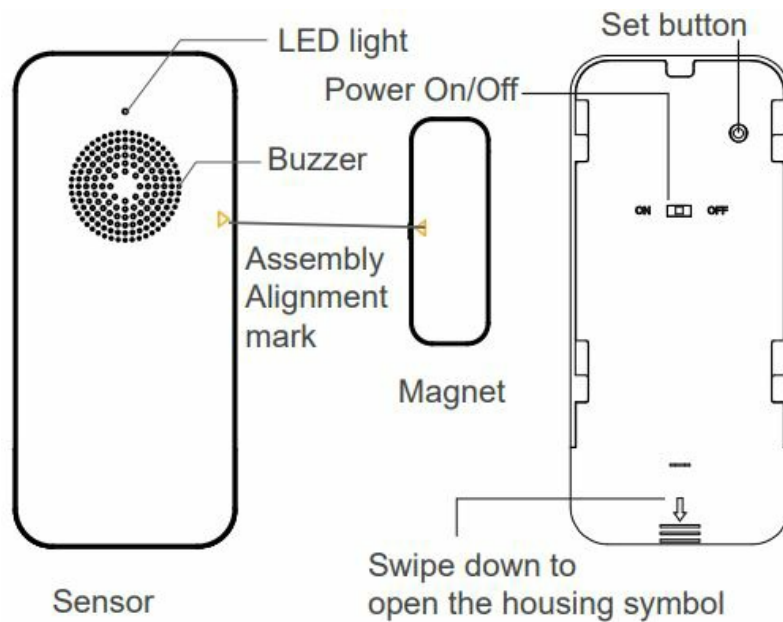

Function Button Introduction

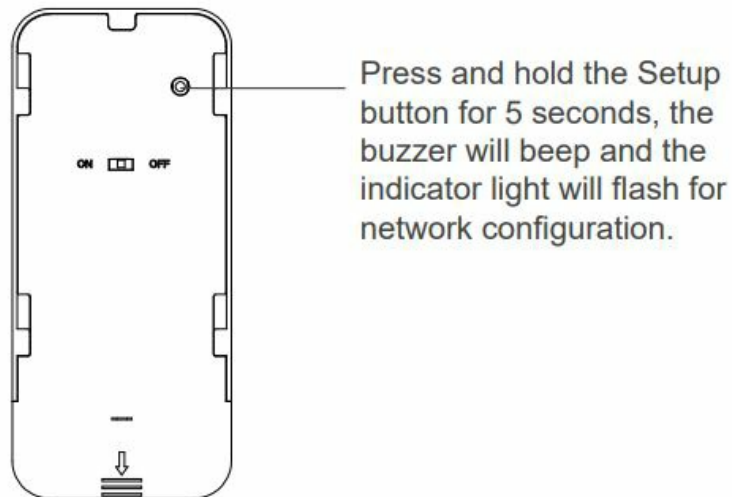

Connect With the Mobile APP

Download APP

- Scan the QR code to download the APP.
- Please go to the application market and search “Smart Life” to download the APP.

Network with a mobile phone

1. Connect to a mobile phone Wi-Fi (2.4 GHz frequency) and turn on Bluetooth.



2. The device enters the network configuration state.



3. Open the APP and click "Add Device". (picture 1)

4. Discover the device and click "device". (picture 2)

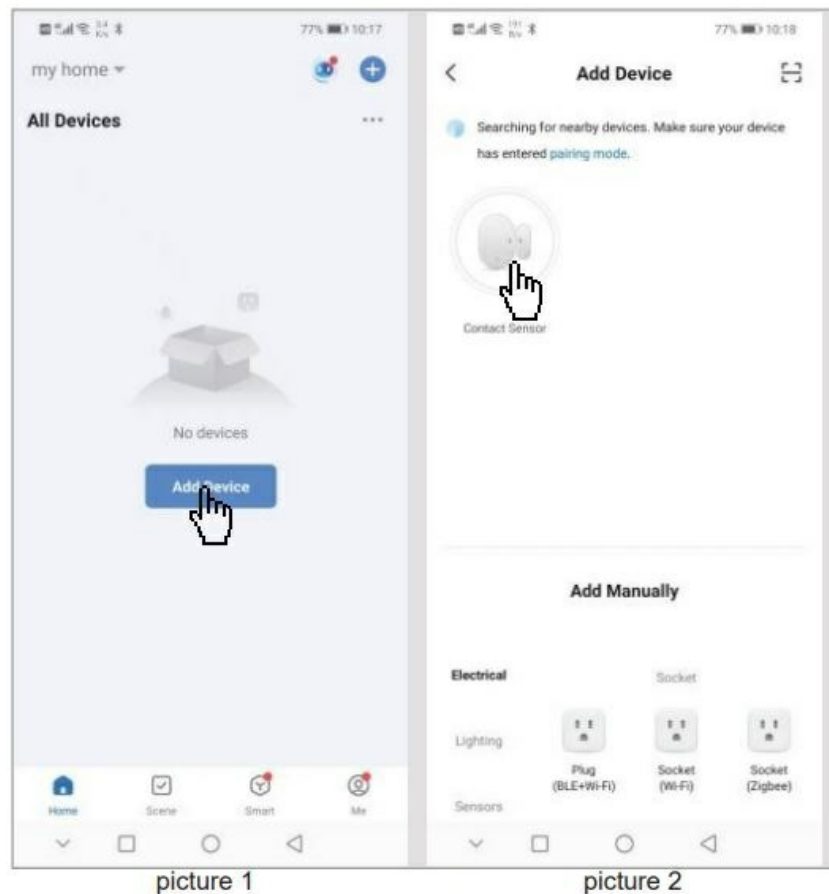

5. Enter the Wi-Fi "password" and click "Next".

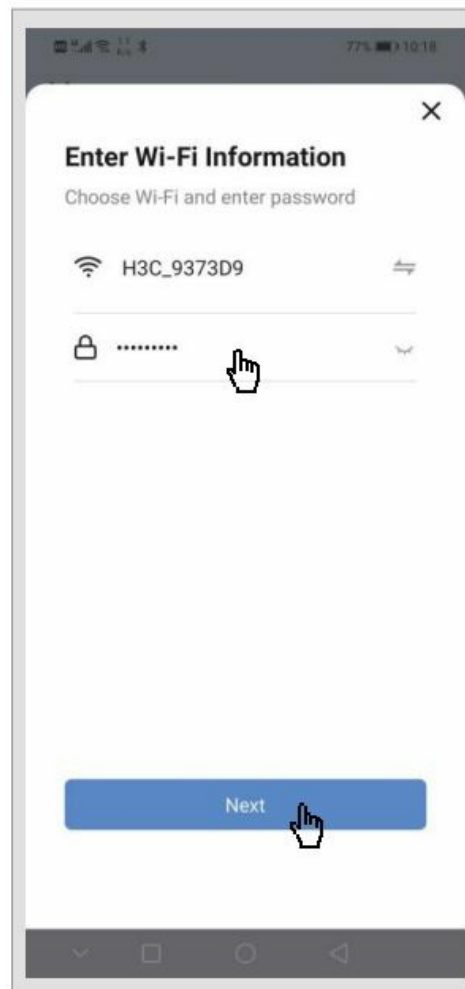

6. Show “adding”.

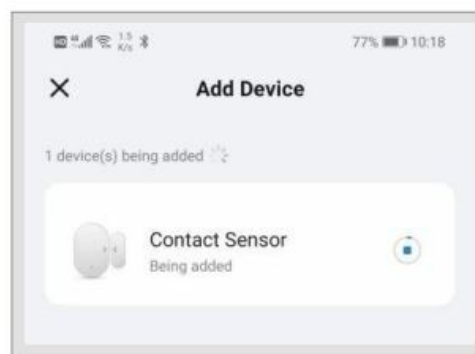

7. Click “Done” when you’ve added it successfully.

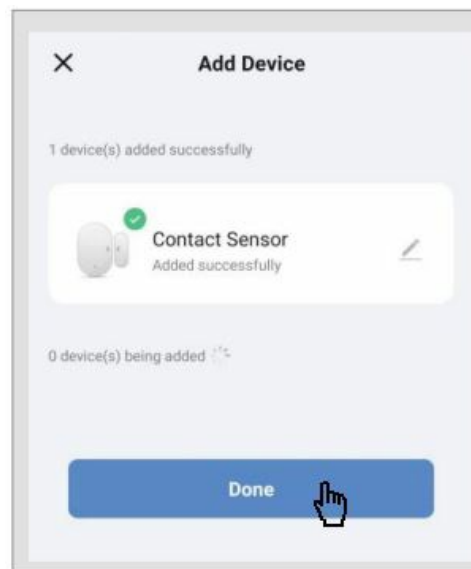

APP Operation

1. Click Settings to set arming/disarming/open door alarm/alarm time/alarm volume.

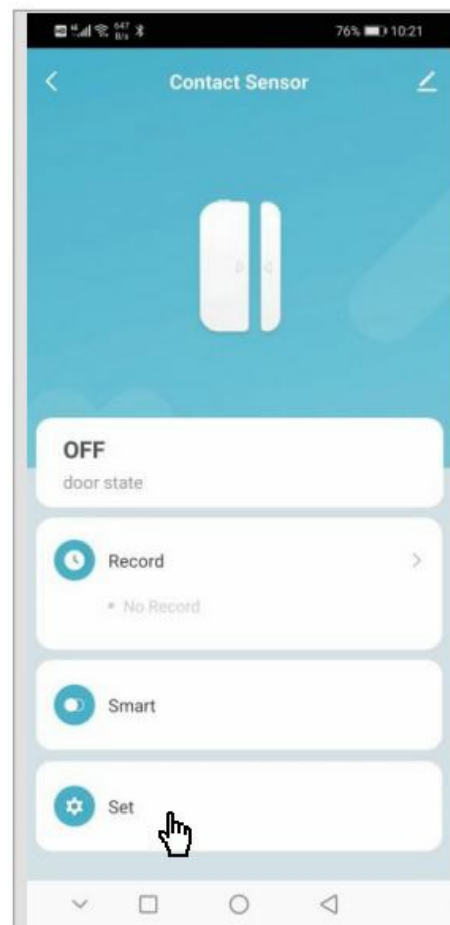

- **Turn on the arming**

The device is in hibernation, and the device needs to be triggered to take effect.

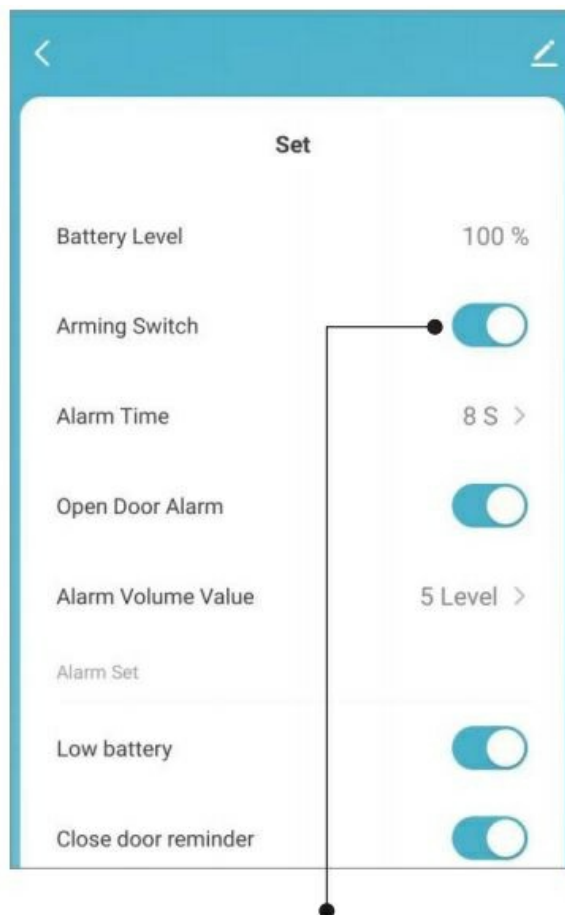

- **Disable arming**

The device is in hibernation, and the device needs to be triggered to take effect.

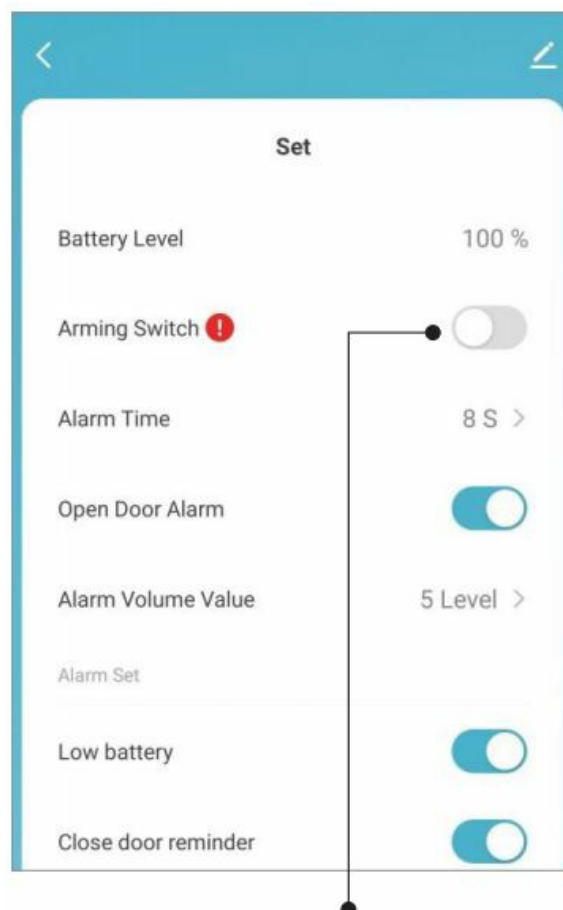

- Open Door Alarm: When the device is armed and the door magnet is opened, there is a sound and light alarm.
- Close the door alarm: when the device is armed and the door magnet is opened, there is no sound or light alarm.

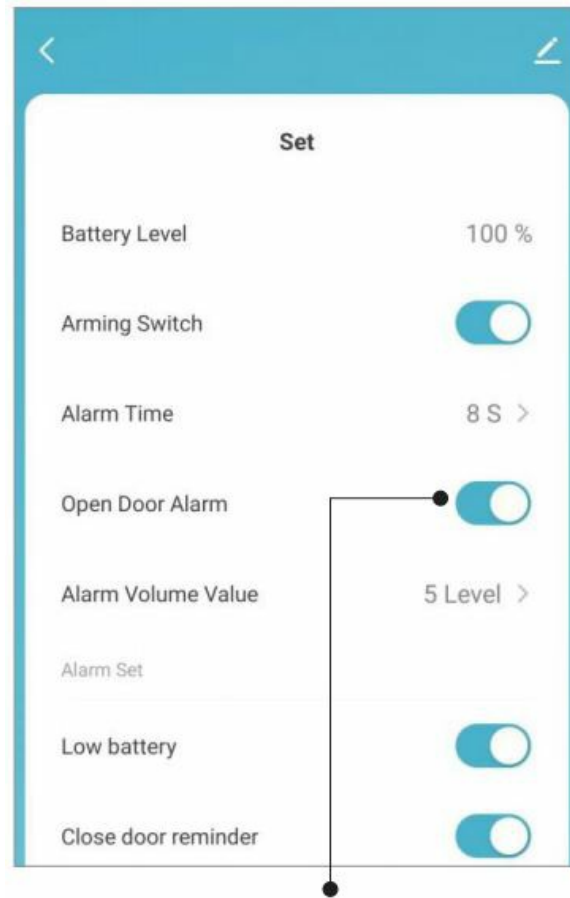

Note: When it is 0, the alarm is silent, and the APP receives the alarm.

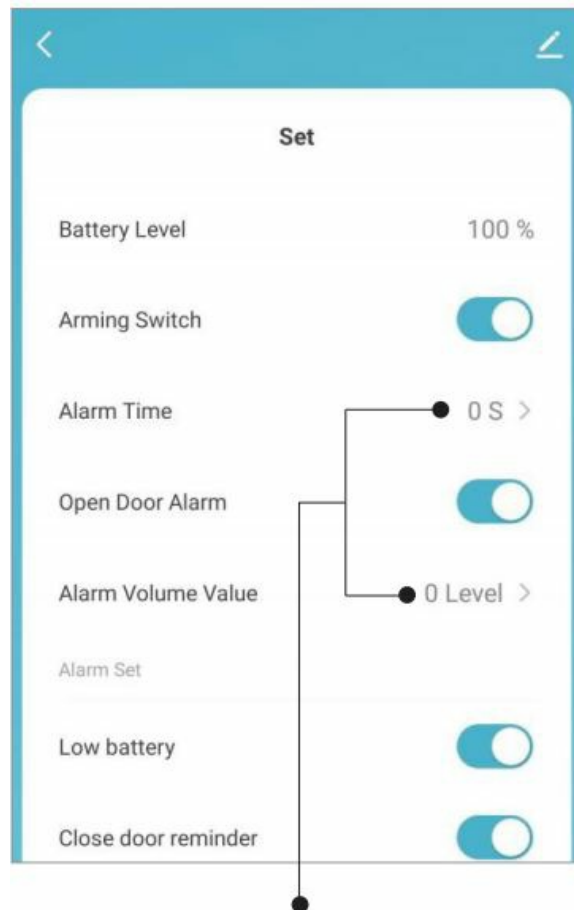

2. Modify Device Name/shared Device.

1. Click on the upper right corner. (picture 1)
2. Click "Contact Sensor", modify the device name. (picture 2)
3. Click "Share Device".and then dick "Add" to add a shapictureidurpictureplcure 3)

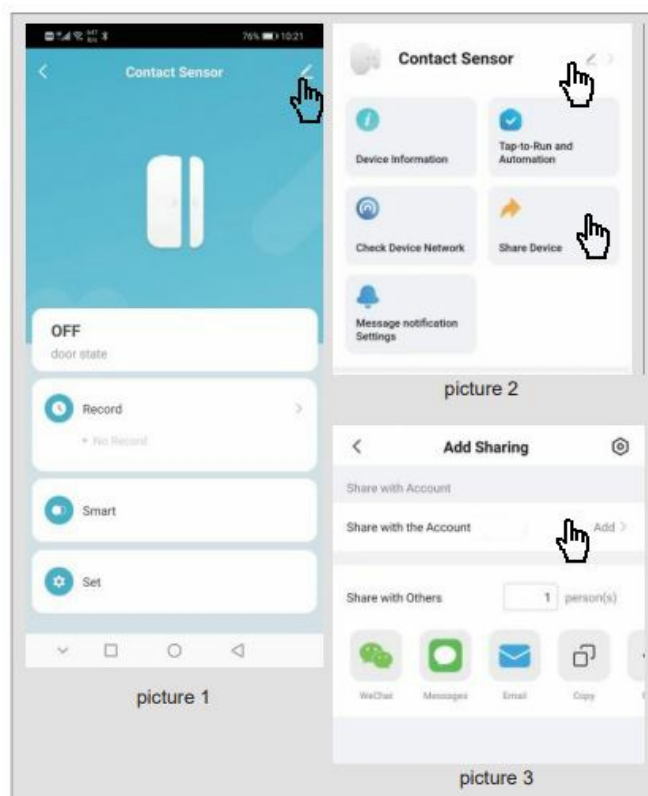

Installation

1. Way for battery installation

1. Open the rear cover of the sensor.

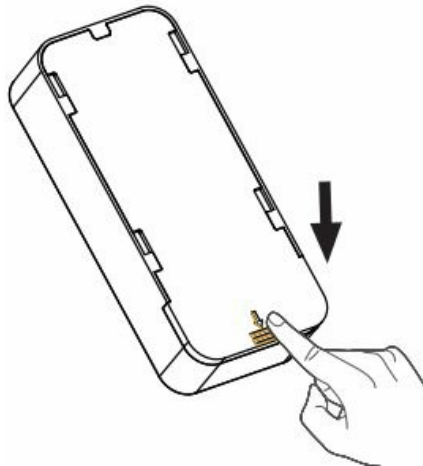

2. Insert the battery

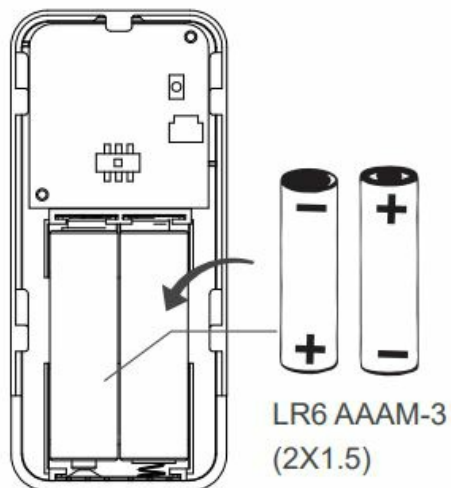

3. End of battery installation

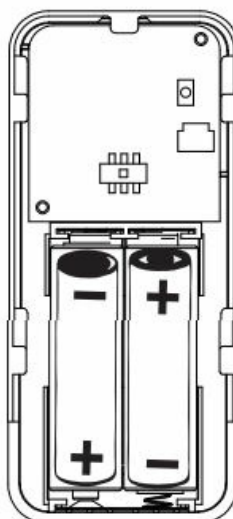

4. Close the rear cover.

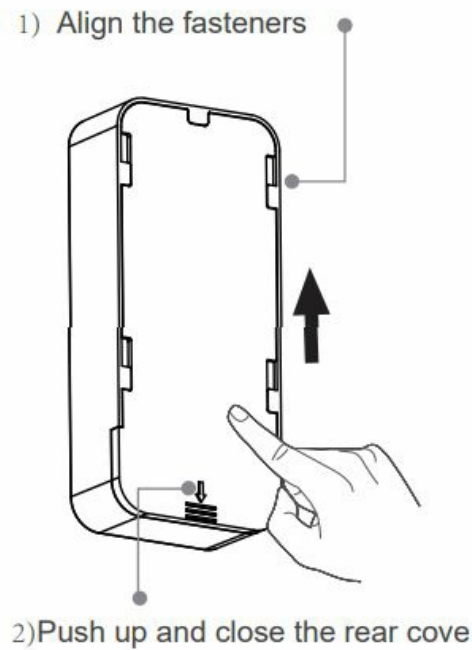

2. 3M glue fixed installation method.

1. Tear off the side of the release paper on the two foam glues, and attach the two foam glues respectively onto the fixing surfaces of the sensor and the magnetic stripe (as shown in Figure 1);
2. Tear off the side of the release paper on the back of the Sensor and magnetic stripe and attach it at the installation position of a door or a window (as shown in Figure 2).

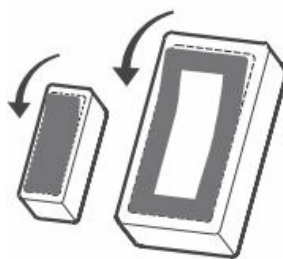

Figure 1

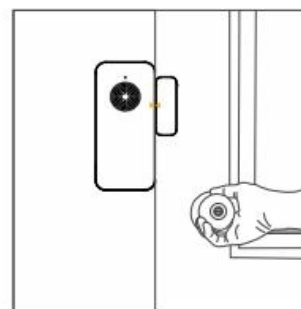
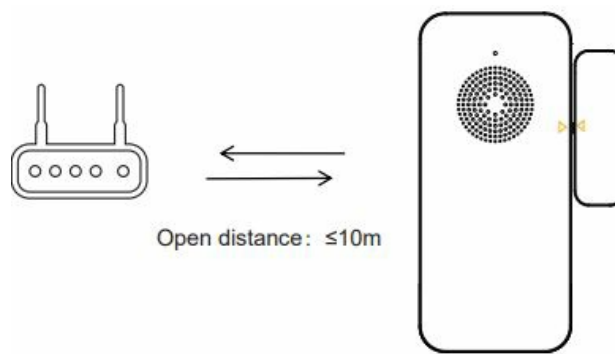

Figure 2

Installation Precautions

1. The WiFi distance between the router and the device.



2. Installation Precautions

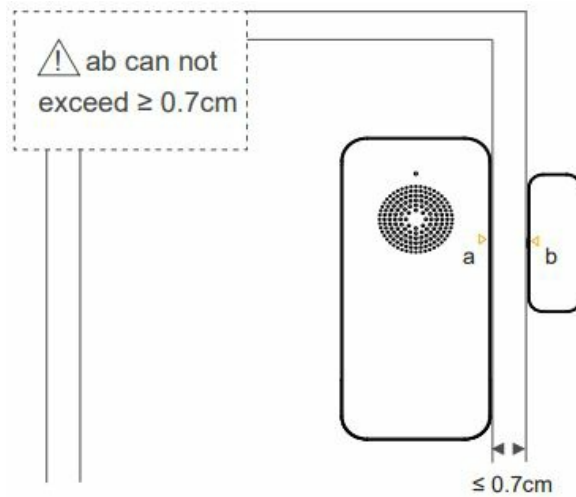

Maintenance

1. Replacement battery

1. Remove shell

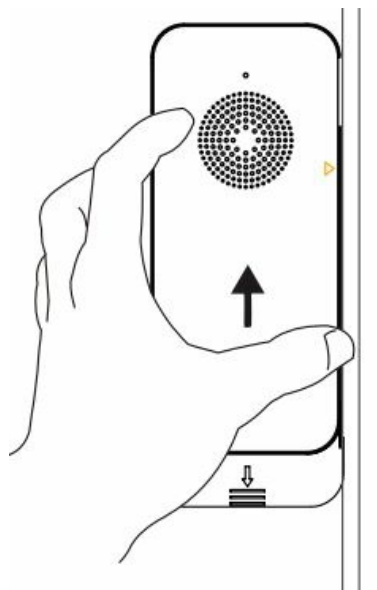

2. Remove batteries.

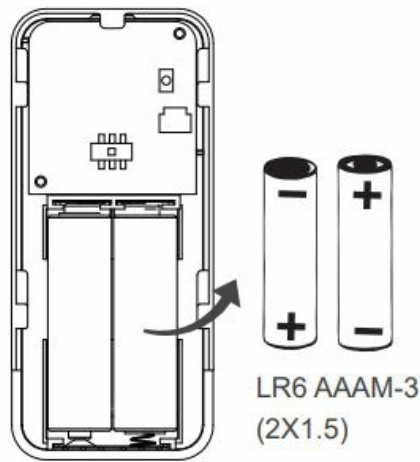

3. Replace with a new battery.
4. Fix the housing.

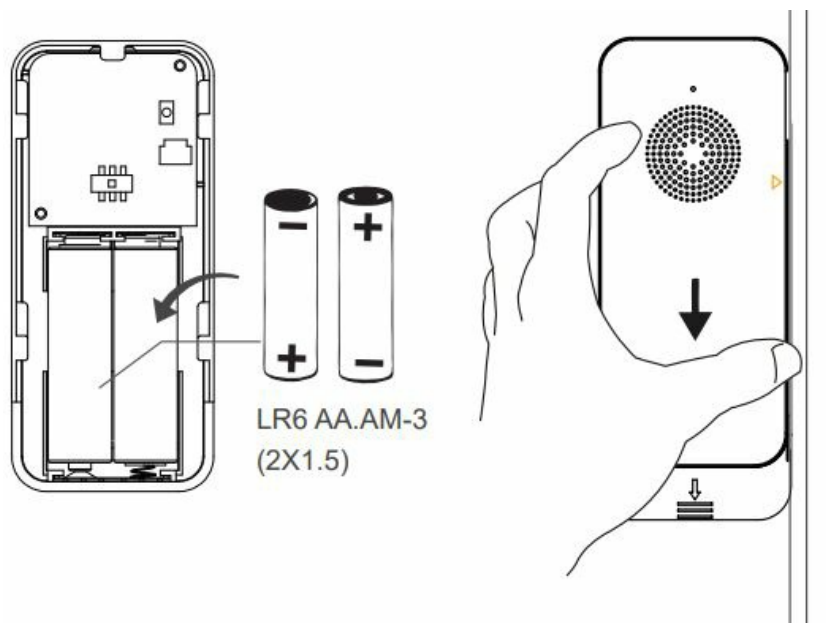

Technical parameters

- **Operating voltage:** DC3V
- **Standby current:** <30uA
- **Alarm current:** <250mA
- **Alarm sound:** < 100 dB (within 30cm)
- **Battery specification:** LR6 AA.AM-3 (2*15)
- **WiFi standard:** IEEE 802.11b/g/n 2.4G

Environmental Protection

Waste electrical products should not be disposed of with household waste. Please recycle where facilities exist. Check with the Local Authority or retailer for recycling

advice.

FCC Statement

This device complies with part 15 of the FCC rules. Operation is subject to the following two conditions:

1. This device may not cause harmful interference
2. This device must accept any interference received, including interference that may cause undesired operation.

Caution: Changes or modifications not expressly approved by the party responsible for Compliance could void the user's authority to operate the equipment.

NOTE: This equipment has been tested and found to comply with the limits for a Class B digital device, under part 15 of the FCC Rules. These limits are designed to provide reasonable protection against harmful interference in a residential installation. This equipment generates and can radiate radio frequency energy and, if not installed and used according to the instructions, may cause harmful interference to radio communications. However, there is no guarantee that interference will not occur in a particular installation. Suppose this equipment does cause harmful interference to radio or television reception, which can be determined by turning the equipment off and on. In that case, the user is encouraged to try to correct the interference by one or more of the following measures:

- Reorient or relocate the receiving antenna.
- Increase the separation between the equipment and receiver.
- Connect the equipment to an outlet on a circuit different from that to which the receiver is connected.
- Consult the dealer or an experienced radio/LV technician for help important announcement.

Radiation Exposure Statement

To comply with FCC RF exposure compliance requirements, this grant is applicable to only mobile configurations. The antennas used for this transmitter must be installed to provide a separation distance of at least 20 cm from all persons and must not be co-

located or operating in conjunction with any other antenna or transmitter.

Frequently Asked Questions (FAQ)

- **What should I do if the alarm is silent when triggered?**
Check the battery level and replace it if necessary. Ensure proper alignment of the sensor and magnet for accurate detection.
- **How can I adjust the alarm volume?**
In the mobile app settings, you can adjust the alarm volume along with other configurations like arming/disarming settings.

Documents / Resources

	PGST PG-B01 Sound and Light Door and Window Alarm [pdf] User Manual 2AIT9-PG-B01, 2AIT9PGB01, PG-B01 Sound and Light Door and Window Alarm, PG-B01, Sound and Light Door and Window Alarm, Light Door and Window Alarm, Door and Window Alarm, Alarm
--	---

References

- [User Manual](#)

PGST
2AIT9-PG-B01, 2AIT9PGB01, Alarm, Door and Window Alarm, Light Door and Window Alarm, PG-B01, PG-B01 Sound and Light Door and Window Alarm, PGST, Sound and Light Door and Window Alarm

—Previous Post

[PGST PG-S01 Smoke Alarm User Manual](#)

Next Post—

[PGST PG-P02W Wi-Fi Infrared Detector User Manual](#)

Leave a comment

Your email address will not be published. Required fields are marked *

Comment *

Name

Email

Website

☐ Save my name, email, and website in this browser for the next time I comment.

Post Comment

Search:

e.g. whirlpool wrf535swhz

Search

[Manuals+](#) | [Upload](#) | [Deep Search](#) | [Privacy Policy](#) | [@manuals.plus](#) | [YouTube](#)

This website is an independent publication and is neither affiliated with nor endorsed by any of the trademark owners. The "Bluetooth®" word mark and logos are registered trademarks owned by Bluetooth SIG, Inc. The "Wi-Fi®" word mark and logos are registered trademarks owned by the Wi-Fi Alliance. Any use of these marks on this website does not imply any affiliation with or endorsement.