

PETZL MGO 60 INT Auto Locking Carabiner



PETZL MGO 60 INT Auto Locking Carabiner Instruction Manual

[Home](#) » [PETZL](#) » PETZL MGO 60 INT Auto Locking Carabiner Instruction Manual 

Contents

- [1 PETZL MGO 60 INT Auto Locking Carabiner](#)
- [2 Product Usage Instructions](#)
- [3 Directional connector](#)
- [4 Warning symbols](#)
- [5 Documents / Resources](#)
 - [5.1 References](#)
- [6 Related Posts](#)



PETZL MGO 60 INT Auto Locking Carabiner



Specifications

- **Model:** MGO 60 INT
- **Standard:** EN 362:2004 class A
- **Material:** Aluminum
- **Maximum Load Capacity:** Check the product label for specific details

Product Usage Instructions

Field of Application

This product is personal protective equipment (PPE) designed for fall protection from height. It is an auto-locking carabiner intended for activities with a risk of falls from height. Ensure not to exceed its limits or use it for purposes other than intended.

Nomenclature

The carabiner consists of the following components: Frame, Gate, Rivets, Unlocking lever, and Attachment hole. The principal material used is aluminum.

Inspection and Verification

Before Each Use: Check for any deformations, cracks, wear, or corrosion on the frame, rivets, gate, and unlocking lever. Ensure the gate opens and closes automatically and completely.

During Use: Confirm that the carabiner is loaded on the major axis, moves freely in the anchor, and is not subjected to pressure that may damage it. Regularly inspect its condition and connections to other equipment.

Compatibility

Ensure this carabiner is compatible with other elements in your system. All equipment used with the connector must meet current standards in your country.

Carabiner Positioning

Load the carabiner on the major axis with the gate closed for maximum strength. Avoid cantilever loading as it can reduce strength. Always double-check that the gate is securely locked.

Additional Information

Equipment Retirement: Follow the provided icons for information on when to retire your equipment based on various factors like lifespan, temperatures, cleaning, maintenance, etc.

Warranty: This product comes with a 3-year guarantee against material or manufacturing defects, excluding normal wear and tear, misuse, negligence, etc.

FAQ

- **Q: Can this carabiner be used for rock climbing?**
 - **A:** The carabiner is designed for fall protection from height activities and should not be used for rock climbing purposes.
- **Q: How often should I inspect the carabiner?**
 - **A:** The carabiner should be inspected before each use and periodically during use to ensure safety.

3-year guarantee



Directional connector

WARNING

Activities involving the use of this equipment are inherently dangerous.
You are responsible for your own actions and decisions.

Before using this equipment, you must:

- Read and understand all Instructions for Use.
- Get specific training in its proper use.
- Become acquainted with its capabilities and limitations.
- Understand and accept the risks involved.



- FAILURE TO HEED ANY OF THESE WARNINGS MAY RESULT IN SEVERE INJURY OR DEATH.

Traceability and markings

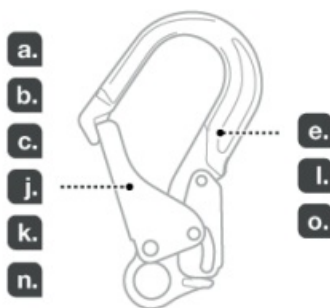



SATRA Technology Europe Limited
Bracetown Business Park
Clonee D15YN2P
Republic of Ireland
N°2777

b. 0082

Apave Exploitation France SAS
6 Rue du Général Audran
92412 Courbevoie cedex - France
N°0082

e. Individual number

YY M 0000000 000

f.

g.

h.

i.

m.



- [PETZL.COM](https://www.petzl.com)



Latest version



Other languages



Technical tips



PPE checking

Warning symbols



(1)



(2)



(3)



(4)

PETZL

- FR-38920 Crolles Cidex 105A
- **Tel:** +33 (0)4 76 92 09 00
- [PETZL.COM](https://www.petzl.com)

- ISO 9001



Sustaining our Community

- [FONDATION-PETZL.ORG](https://www.fondation-petzl.org)

© 2023 Petzl Distribution

CSA[®]
C **US** CARABINER IN ACCORDANCE WITH CAN/CSA-2259.12-2016 AND ANSI/ASSP
 Z359.12-2019

Field of application (text part)

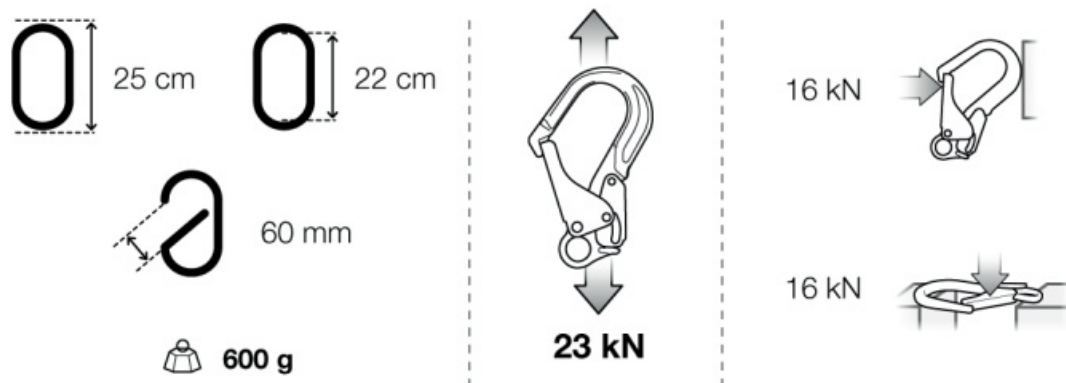

Opening/closing

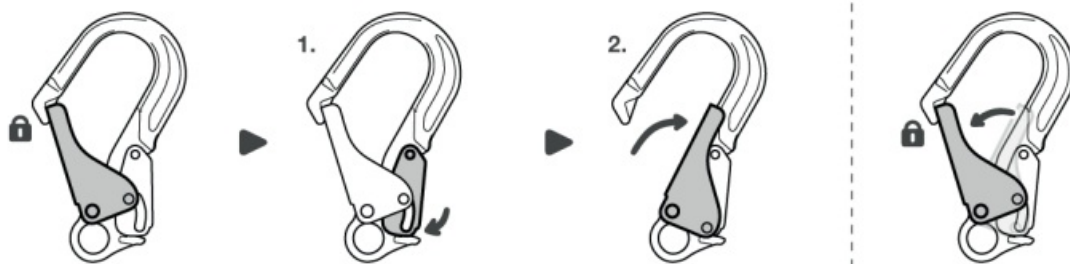

Nomenclature

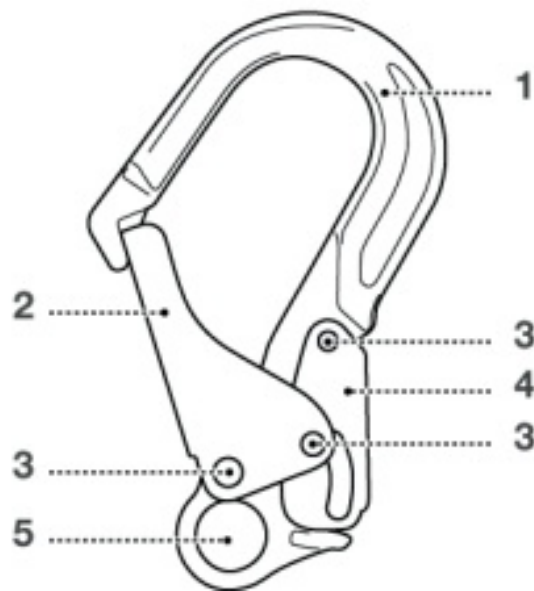

Inspection. points to verify



- [PETZL.COM](https://www.petzl.com)

Compatibility (text part)

Carabiner positioning



Additional information

A. Lifetime



B. Acceptable T°



C. Precautions for use



D. Cleaning



E. Drying

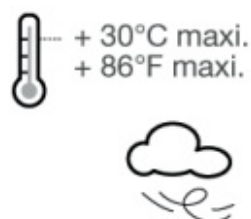

F. Storage - Transport



G. Maintenance



H. Modifications - Repairs

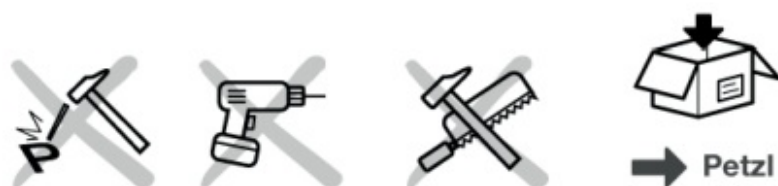

I. FAQ - Contact Questions - Contact



- These instructions explain how to correctly use your equipment. Only certain techniques and uses are described.
- The warning symbols inform you of some potential dangers related to the use of your equipment, but it is impossible to describe them all. Check Petzl.com for updates and additional information.

- You are responsible for heeding each warning and using your equipment correctly. Any misuse of this equipment will create additional dangers. Contact Petzl if you have any doubts or difficulty understanding these instructions.

Field of application

- Personal protective equipment (PPE) is used for fall protection from height.
- **EN 362:** 2004 class A (anchor) connector.
- Auto-locking carabiner designed for activities with a risk of falls from height.
- This product must not be pushed beyond its limits, nor be used for any purpose other than that for which it is designed.

Responsibility

WARNING

Activities involving the use of this equipment are inherently dangerous. You are responsible for your own actions, decisions and safety.

Before using this equipment, you must:

- Read and understand all Instructions for Use.
- Get specific training in its proper use.
- Become acquainted with its capabilities and limitations.
- Understand and accept the risks involved.
- Failure to heed any of these warnings may result in severe injury or death. This product must only be used by competent and responsible persons, or those placed under the direct and visual control of a competent and responsible person. You are responsible for your actions, your decisions and your safety and you assume the consequences of same. If you are not able, or not in a position to assume this responsibility, or if you do not fully understand the Instructions for Use, do not use this equipment.

Nomenclature

- **(1)** Frame\
- **(2)** Gate
- **(3)** Rivets
- **(4)** Unlocking lever
- **(5)** Attachment hole.

Principal materials: aluminum.

Inspection, points to verify

Your safety depends upon the integrity of your equipment.

Petzl recommends a detailed inspection by a competent person at least once every 12 months (depending on current regulations in your country, and your conditions of usage). **WARNING:** your intensity of use may cause you

to inspect your PPE more frequently. Follow the procedures described at [Petzl.com](https://www.petzl.com). Record the results on your PPE inspection form: type, model, manufacturer contact info, serial number or individual number, dates: manufacture, purchase, first use, next periodic inspection; problems, comments, inspector's name and signature.

Before each use

Verify the absence of any deformation, cracks, marks, wear, or corrosion (on the frame, rivets, gate, and unlocking lever). Verify that the gate opens and that it closes automatically and completely.

During use

Verify that the carabiner is always loaded on the major axis. Verify that the carabiner moves freely in the anchor to avoid any jamming.

Avoid any pressure or rubbing that could unlock the gate or damage the gate and the unlocking lever.

It is important to regularly monitor the condition of the product and its connections to the other equipment in the system. Make sure that all items of equipment are correctly positioned with respect to each other.

Compatibility

Verify that this product is compatible with the other elements of the system in your application (compatible = good functional interaction).

Equipment used with your connector must meet current standards in your country (e.g. EN 358 lanyard).

Carabiner positioning

A carabiner is not indestructible.

A carabiner is strongest when loaded on the major axis, with the gate closed. Loading a carabiner in any other way (e.g. cantilever loading) is dangerous and reduces its strength. Check each time you close it to make sure it is completely locked.

Additional Information

This product meets the requirements of Regulation (EU) 2016/425 on personal protective equipment. The EU Declaration of Conformity is available at [Petzl.com](https://www.petzl.com).

- In a fall-arrest system, the length of the connector affects the fall distance.
- You must have a rescue plan and the means to rapidly implement it in case of difficulties encountered while using this equipment.
- The anchor point for the system should preferably be located above the user's position and meet EN 795 requirements (12 kN minimum strength).
- In a fall-arrest system, it is essential to check the required clearance below the user before each use, in order to avoid hitting the ground or an obstacle in the event of a fall.
- Make sure that the anchor point is correctly positioned, in order to limit the risk and the length of a fall.
- A fall-arrest harness is the only device allowable for supporting the body in a fall-arrest system.
- When using multiple items of equipment, a dangerous situation can arise in which the safety function of an item of equipment can be affected by the safety function of another item of equipment.
- **WARNING – DANGER:** ensure that your products do not rub against abrasive or sharp surfaces.
- Users must be medically fit for activities at height.

- **WARNING:** inert suspension in a harness can result in serious injury or death.
- The Instructions for Use for each item of equipment used in conjunction with this product must be followed.
- The Instructions for Use must be provided to the user of this equipment, in the language of the country where the equipment is used.
- Keep the Instructions for Use in a permanent file for reference after removing them from the equipment.
- Make sure the markings on the product are legible.

When to retire your equipment:

WARNING: an exceptional event can lead you to retire a product after only one use, depending on the type and intensity of usage and the environment of usage (harsh environments, marine environments, sharp edges, extreme temperatures, chemicals...).

A product must be retired when:

- It has exceeded its lifespan.
- It has been subjected to a major fall or load.
- It fails to pass inspection. Do you have any doubt as to its reliability?
- You do not know its full usage history (e.g. an illegible product marking).
- When it becomes obsolete due to changes in legislation, standards, technique or incompatibility with other equipment...

Destroy these products to prevent further use.

Icons:

- **A.** Unlimited lifespan
- **B.** Acceptable temperatures
- **C.** Usage precautions
- **D.** Cleaning (use only the recommended methods)
- **E.** Drying
- **F.** Storage/transport
- **G.** Maintenance
- **H.** Modifications/repairs (prohibited outside of Petzl facilities, except replacement parts)
- **I.** Questions/contact

3-year guarantee

Against any material or manufacturing defect. Exclusions: normal wear and tear, oxidation, modifications or alterations, incorrect storage, poor maintenance, negligence, uses for which this product is not designed.

Warning symbols

1. Situation presenting an imminent risk of serious injury or death. 2. Exposure to a potential risk of accident or injury. 3. Important information on the functioning or performance of your product. 4. Equipment incompatibility.

Traceability and markings

- **a.** Meets PPE regulatory requirements. Notified body performing the EU-type examination –
- **b.** A number of the notified bodies responsible for the production control of this PPE

- **c.** Traceability: DataMatrix
 - **d.** Strength
 - **e.** Serial number
 - **f.** Year of manufacture
 - **g.** Month of manufacture
 - **h.** Batch number
 - **i.** Individual identifier
 - **j.** Standards
 - **k.** Read the Instructions for Use carefully
 - **l.** Model identification
 - **m.** ANSI/CSA certification body
 - **n.** Manufacturer address
 - **o.** Material batch number
-

Documents / Resources

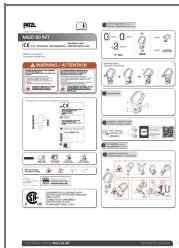

[PETZL MGO 60 INT Auto Locking Carabiner](#) [pdf] Instruction Manual
MGO 60 INT, MGO 60 INT Auto Locking Carabiner, Auto Locking Carabiner, Locking Carabiner, Carabiner

References

- [PETZL Petzl.com](#)
- [User Manual](#)

[Manuals+.](#) [Privacy Policy](#)

This website is an independent publication and is neither affiliated with nor endorsed by any of the trademark owners. The "Bluetooth®" word mark and logos are registered trademarks owned by Bluetooth SIG, Inc. The "Wi-Fi®" word mark and logos are registered trademarks owned by the Wi-Fi Alliance. Any use of these marks on this website does not imply any affiliation with or endorsement.