



PETZL E0810AB Swift RL Head Torch Instruction Manual

[Home](#) » [PETZL](#) » PETZL E0810AB Swift RL Head Torch Instruction Manual 

PETZL E0810AB Swift RL Head Torch



Contents

- 1 IMPORTANT INFORMATION
- 2 LED risk group 2 – IEC 624 71
- 3 Rechargeable battery
- 4 Removing the battery
- 5 Installing the battery
- 6 Additional information
- 7 Lamp operation
- 8 Accessories
- 9 Nomenclature
- 10 Lamp operation
- 11 Charging the rechargeable battery
- 12 General information on Petzl lamps and batteries
- 13 The Petzl guarantee
- 14 Responsibility
- 15 Documents / Resources
 - 15.1 References
- 16 Related Posts

IMPORTANT INFORMATION



Charge the battery completely before the first use.

WARNING

Before using this headlamp, you must:

- Read and understand all Instructions for Use.
- Become acquainted with its capabilities and usage restrictions.
- Understand and accept the risks involved.



FAILURE TO HEED ANY OF THESE WARNINGS MAY RESULT IN SEVERE INJURY OR DEATH.

LED risk group 2 – IEC 624 71



Do not stare at operating lamp. May be harmful to the eyes.

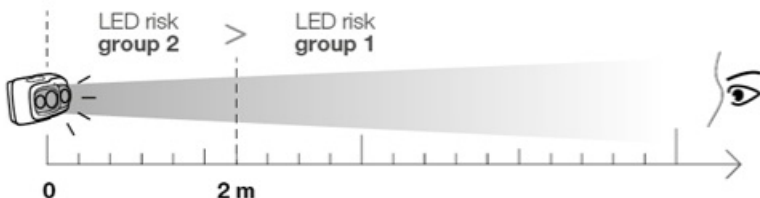

Rechargeable battery



Recharge time Temps de charge

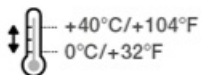

USB 5V CE/UL



Removing the battery

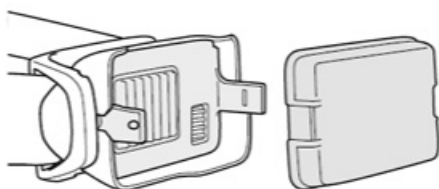
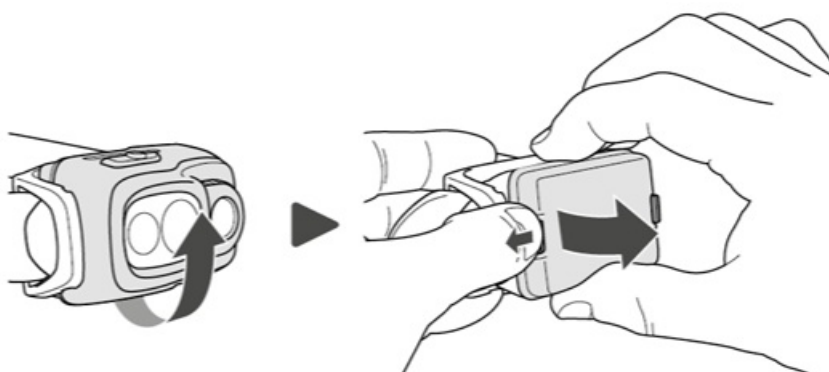

Installing the battery

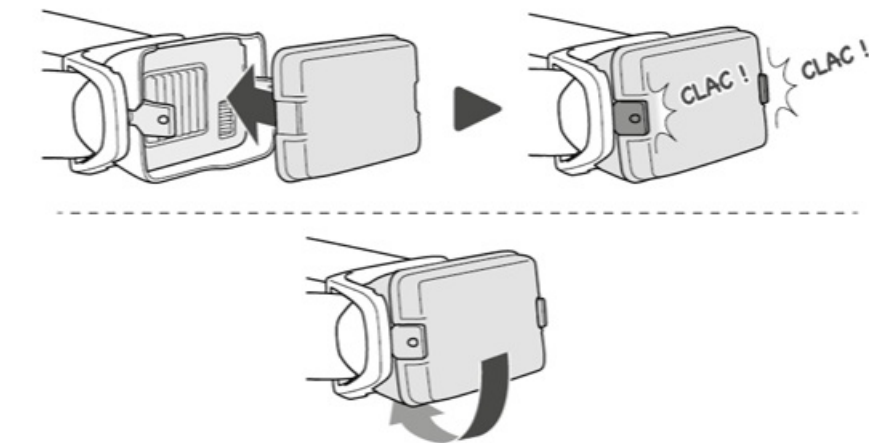

Additional information

A. Rechargeable battery precautions Precautions batterie rechargeable



B. Headlamp precautions



C. Cleaning – Drying



D. Storage – Transport



E. Protecting the environment



F. Modifications – Repairs



G. FAQ – Contact Questions – Contact



[PETZL.COM](https://www.petzl.com)

Latest version



Other languages



Technical tips



PPE checking



PETZL F-38920 Crolles Cidex 105A [PETZL.COM](https://www.petzl.com) ISO 9001 OPetzl



Sustaining our Community

[FONATION-PETZL.ORG](https://fondoation-petzl.org)

Lighting performance – burn time



[PETZL.COM](https://www.petzl.com)

Lamp operation

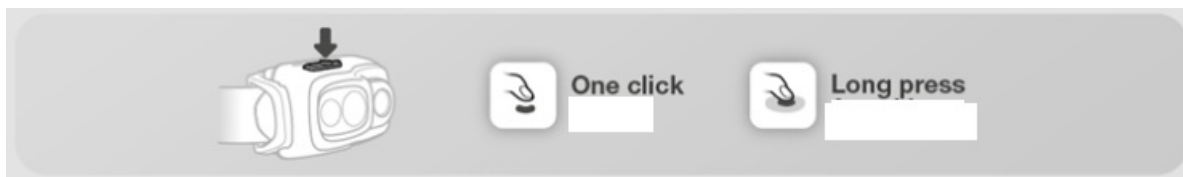

Switching on-off

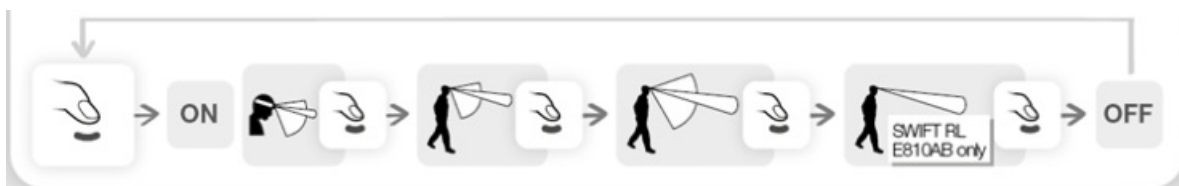

Lighting / Eclairage STANDARD → Lighting / Eclairage REACTIVE



Lock – Unlock



SWIFT RL E095BB :

Your lamp turns on at the lower power setting in REACTIVE LIGHTING mode.

SWIFT RL E81 DAB :

Your lamp turns on in the same mode as when you last switched it off, at the lowest power setting.

Red lighting



Energy gauge

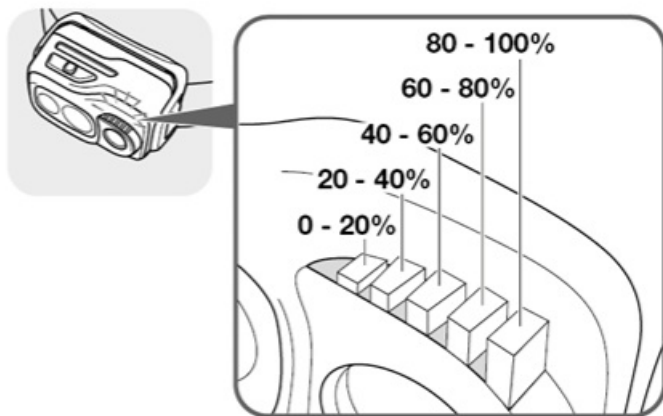

Reserve Lighting



Accessories

- ACCU SWIFT RL
E092DB00 (USB-C)



- SHELL LT
E075AA00



- HEADBAND/BANDEAU PRO28mm
E092FB00

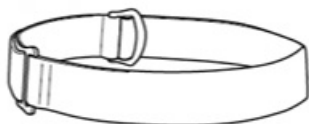

- HEADBAND/BANDEAU SWIFTRL
E092EB00

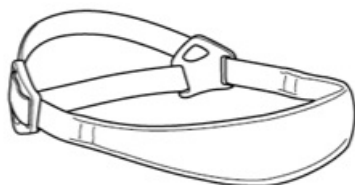

- BIKEADAPT2
E074AA00



**HELMET
ADAPT
E073AA00**

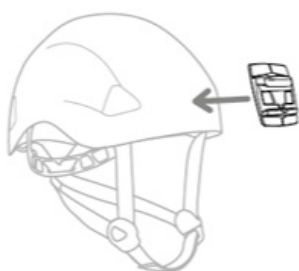

**SLOT
ADAPT
E073BA00**



SWIFT RL E0810AB



SWIFT RL E095BB



Before using this headlamp, you must:

- Read and understand all Instructions for Use.
- Understand and accept the risks involved.
- Become acquainted with its capabilities and usage restrictions.

Lamp not recommended for children under 3 years old. Children under 12 years old using this headlamp must do so under responsible adult supervision.

Failure to heed any of these warnings may result in severe injury or death.

Nomenclature

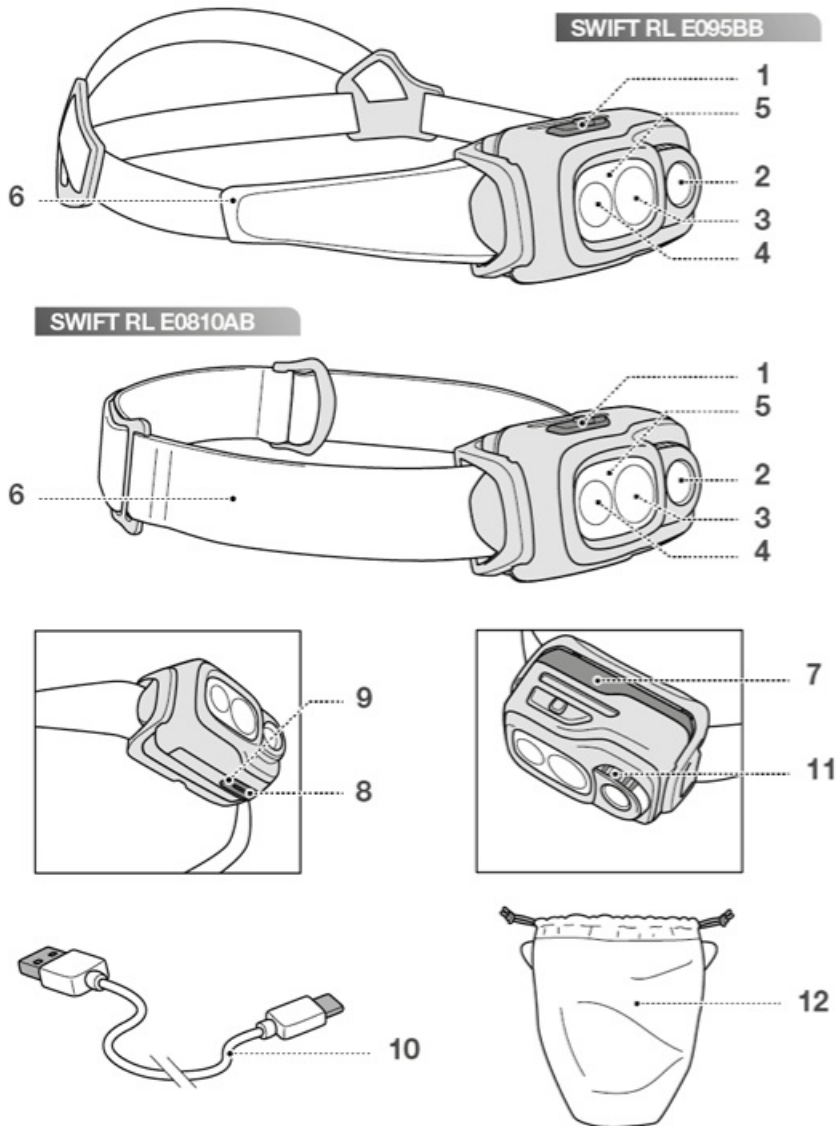

1. Button,
2. Light sensor,
3. White LED focused beam,
4. White LED wide beam,
5. Red LED,
6. Headband,
7. Rechargeable battery,

8. USB port for charging the rechargeable battery,
9. Battery charge indicator,
10. USB-C cable,
11. Energy gauge,
12. SHELL LT pouch (supplied with SWIFT RL E095BB only).

REACTIVE LIGHTING® technology

Using REACTIVE LIGHTING® technology, a sensor analyzes the ambient light and automatically adjusts brightness to user requirements.

Lamp operation

Turning on & off, selecting

The lamp has three modes: REACTIVE LIGHTING®, STANDARD LIGHTING and RED LIGHTING.

- **SWIFT RL E095BB:**

The lamp has three brightness levels per mode: MAX BURN TIME, STANDARD and MAX POWER. When you turn on the lamp, it always lights up with REACTIVE LIGHTING® technology.

- **SWIFT RL E0810AB:**

The lamp has four brightness levels for REACTIVE LIGHTING® and STANDARD LIGHTING modes: close-range work, proximity lighting, movement and long-range vision. The lamp turns on in the same mode as when you last switched it off, at the lowest brightness level.

- **0SWIFT RL E095BB and E0810AB:**

When switching between REACTIVE LIGHTING® and STANDARD LIGHTING modes, the brightness level remains the same.

- **With REACTIVE LIGHTING®** technology, when the sensor detects an area with sufficient light, the lamp will blink dimly for two minutes, then automatically turn off to conserve rechargeable battery life.
- The lamp's burn time in REACTIVE LIGHTING® mode varies depending on usage.
- **In REACTIVE LIGHTING®** mode, the lamp turns off after two minutes of remaining motionless in an area with constant ambient light. In this case, use the STANDARD LIGHTING mode instead.
- Lock the lamp when not in use to avoid accidentally turning it on.
- The energy gauge lights when the lamp is turned on or off.
- Reserve lighting: the lamp blinks when it switches to reserve lighting, and 5 minutes beforehand. When the lamp switches to reserve lighting, it provides enough light to walk by, but not enough for a dynamic activity.
- When the switch is pressed for more than six seconds, the lamp turns off.

Charging the rechargeable battery

The lamp comes with a Petzl Li-Ion rechargeable battery.

Capacity: 2350 mAh. Charge it completely before first use.

Use only a Petzl ACCU SWIFT RL rechargeable battery.

In general, Li-Ion rechargeable batteries lose 10 % of their capacity each year. After 300 charge/discharge cycles, they still have about 70 % of their initial capacity.

WARNING

Charge only with a USB cable. The charger's output voltage must not exceed 5 V.

Use only a Class II electrical, CE/UL approved charger (double insulation against hazardous voltages). Do not

leave the battery unattended while charging.

Charging time

Charging time is 5 hours with the USB charger or a computer. Note: if several USB devices are connected to a computer, the charging time can increase. While charging, the battery charge indicator lights steady red, then turns steady green when charging is complete.

Replacing the rechargeable battery

Use only a Petzl ACCU SWIFT RL rechargeable battery: ACCU SWIFT RL E092DB00 (USB-C) or E092DA00 (USB) or E810BA00 (USB). Using another type of rechargeable battery can damage the lamp. Do not use another type of rechargeable battery.

General information on Petzl lamps and batteries

The EU declaration of conformity is available at [Petzl.com](https://www.petzl.com).

A. Rechargeable battery precautions

WARNING – DANGER: there is a risk of explosion and burns.

WARNING: incorrect use can damage the rechargeable battery.

- Do not submerge the rechargeable battery in water.
- Do not dispose of a rechargeable battery in fire.
- Do not expose the battery to high temperatures. Follow the recommended usage and storage temperatures.
- Do not destroy the rechargeable battery; it can explode or release toxic materials.
- If the rechargeable battery is damaged, do not dismantle it or change its structure. Dispose of the rechargeable battery in accordance with current local regulations.
- If the battery leaks electrolyte, avoid any contact with this caustic and dangerous liquid; see a doctor if any contact occurs. Change out the battery and dispose of the defective battery in accordance with current local regulations.

B. Lamp precautions

WARNING: a headband can pose a strangulation risk. Certain small parts pose a choking risk (e.g. batteries).

Eye safety

The lamp is classified in risk group 2 (moderate risk) according to the IEC 62471 standard.

- Do not stare directly at the lamp when lit.
- The optical radiation emitted by the lamp can be dangerous. Avoid aiming the lamp's beam into another person's eyes. Beware of the risk of blinding others in your work environment, particularly in areas subject to traffic regulations.
- There is a risk of retinal damage from the emission of blue light, particularly in children.

Electromagnetic compatibility

Meets regulations on electromagnetic compatibility. **WARNING:** this does not guarantee that interference will not occur. If you notice electromagnetic interference between the lamp and electrical devices, turn off the lamp or keep it away from sensitive electronic devices (e.g. avalanche beacons, flight controls, communications equipment, medical devices...).

ErP Directive

Complies with energy-related product Directive (ErP) 2009/125/EC.

- Instantaneous full brightness
- Color temperature: 6000-7000 K
- Focused beam nominal angle: 15° / wide: 50°
- Number of switching cycles before failure: 13000 minimum.

C. Cleaning, drying

In the event of contact with seawater, rinse the lamp in fresh water and dry it.
Do not allow chemicals to come into contact with the lamp.

D. Storage, transport

For long-term storage, charge the rechargeable battery (repeat every six months) and remove the battery from the lamp. Avoid allowing the rechargeable battery to discharge completely. Be sure to store the rechargeable battery in a dry place. The ideal storage temperature is between 20 and 25° C.

After 12 months in these conditions without use, the rechargeable battery will be discharged.

For carrying the lamp when not in use, we recommend that the battery be disconnected from the lamp to prevent it accidentally turning on.

E. Protecting the environment

Dispose of the lamp only in accordance with current local regulations.

F. Modifications/repairs

Prohibited outside of Petzl facilities, except replacement parts.

G. Questions/contact

The Petzl guarantee

This lamp is guaranteed for 5 years against any defects in materials or manufacture (except the rechargeable battery, which is guaranteed for 2 years or 300 cycles). Exclusions from the guarantee: more than 300 charge/discharge cycles, normal wear and tear, oxidation, modifications or alterations, incorrect storage, poor maintenance, damage due to accidents, to negligence, or to improper or incorrect usage.

Responsibility

Petzl is not responsible for the consequences, direct, indirect or accidental, or any other type of damage befalling or resulting from the use of its products.



Documents / Resources

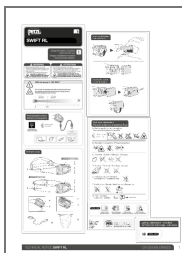

[PETZL E0810AB Swift RL Head Torch](#) [pdf] Instruction Manual
E095BB, E0810AB, E0810AB Swift RL Head Torch, E0810AB, Swift RL Head Torch, RL Head Torch, Head Torch, Torch

References

- [Petzl.com](#)
- [User Manual](#)

[Manuals+](#), [Privacy Policy](#)