



PETKIT W2S Smart Pet Circulating Water Machine User Manual

[Home](#) » [PETKIT](#) » PETKIT W2S Smart Pet Circulating Water Machine User Manual 

Contents

- 1 PETKIT W2S Smart Pet Circulating Water Machine
- 2 Introduction
- 3 Safety Instructions
- 4 Package Contents
- 5 Product Introduction
- 6 Operating Instructions
- 7 Explanation
- 8 Basic Parameters
- 9 Maintenance and Cleaning
- 10 Warranty Conditions
- 11 EU Declaration of Conformity
 - 11.1 Subject of the declaration
- 12 Documents / Resources
 - 12.1 References
- 13 Related Posts



PETKIT W2S Smart Pet Circulating Water Machine



Dear customer

Thank you for purchasing our product. Please read the following instructions carefully before first use and keep this user manual for future reference. Pay particular attention to the safety instructions. If you have any questions or comments about the device, please contact the customer line.

- ✉ www.alza.co.uk/kontakt
- ☎ +44 (0)203 514 4411

Importer: Alza.cz a.s., Jankovcova 1522/53, Holešovice, 170 00 Praha 7, www.alza.cz

Introduction

Thank you for purchasing PETKIT W2S smart pet drinking fountain. PETKIT is committed to creating a better life for you and your pets with technology. Please read the user manual carefully before using the product. Once the product is installed or used, it indicated that you have carefully read the user manual and accept the safety instructions below.

PETKIT will neither assume any responsibility nor undertake any legal liabilities for any accidents and damages caused due to violations. The company reserves the right of explanation and revision for the terms.

Safety Instructions

Failure to comply with the following clauses may lead to equipment malfunction or other safety concerns.

- Please install and use the device in strict accordance with the manual.
- The device is not recommended for pets within three months of age.
- Please use the device indoors.
- This device operates at low voltage, but the pet biting of wires will still cause electric leakage. Please guide the pet to use it properly.
- Please use the original USB power cord, otherwise it will damage the device or cause safety hazards.

- Keep the device placed horizontally and do not overturn it, otherwise it will work abnormally or spill water.
- If the product is not used for a long period of time or is being moved, please remove the batteries and unplug the power cord.
- If children use this device, be sure to use it under the guidance of adults.
- To avoid accidental injury, no one except for the maintenance personnel can repair this product.
- Be sure to check the remaining water in the drinking fountain before leaving for a long period of time (e.g., vacation).
- Please contact customer service in time if you have any problem when using this product.

Package Contents

Please confirm that your package contains all of the items below before installing and using the device.

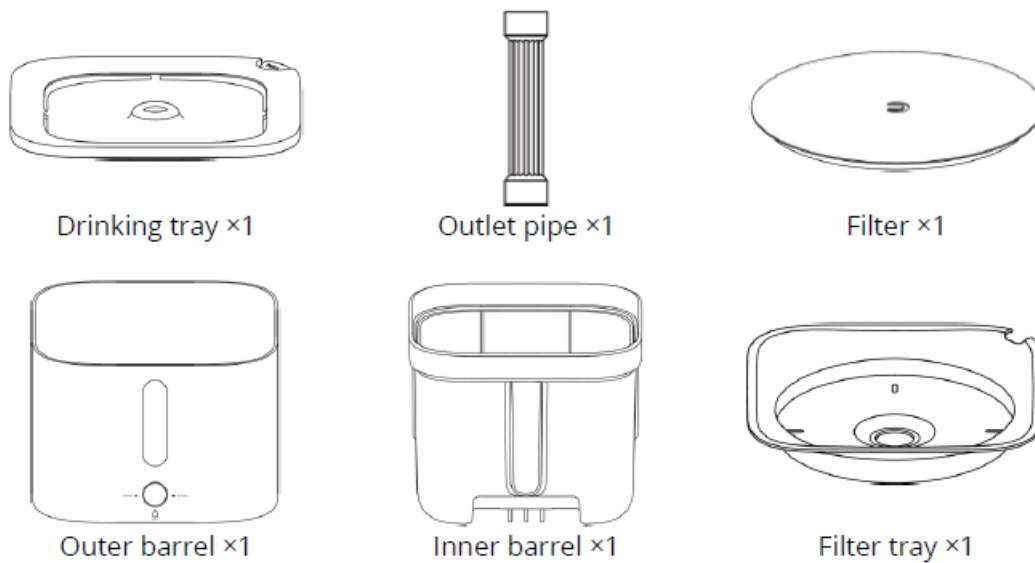

Product Introduction

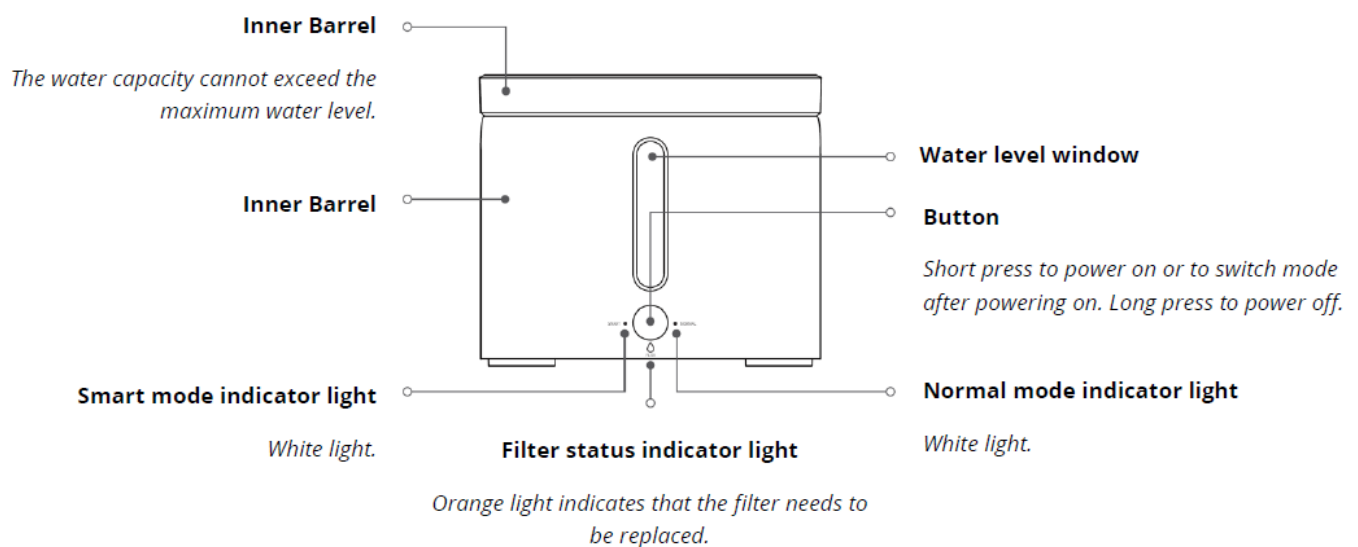

Interior of the inner barrel of the main device

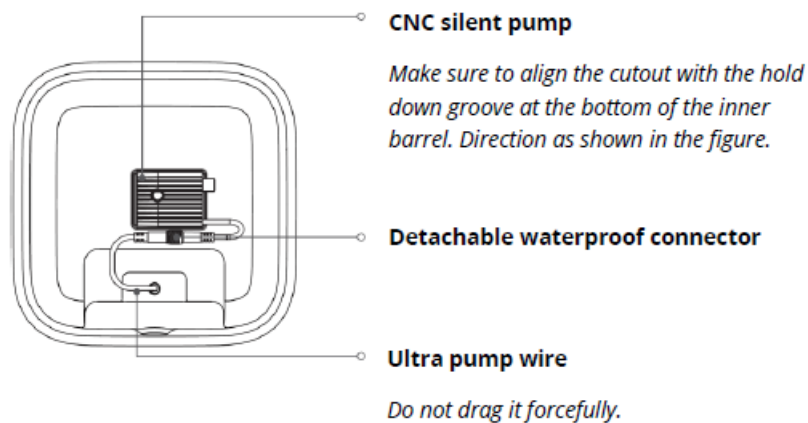

Interior of the outer barrel of the main device

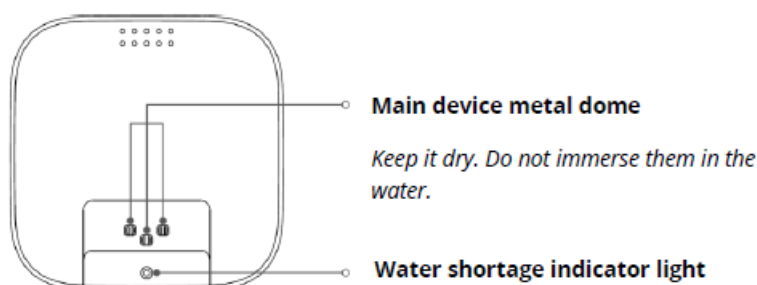

Outer barrel base of the main device

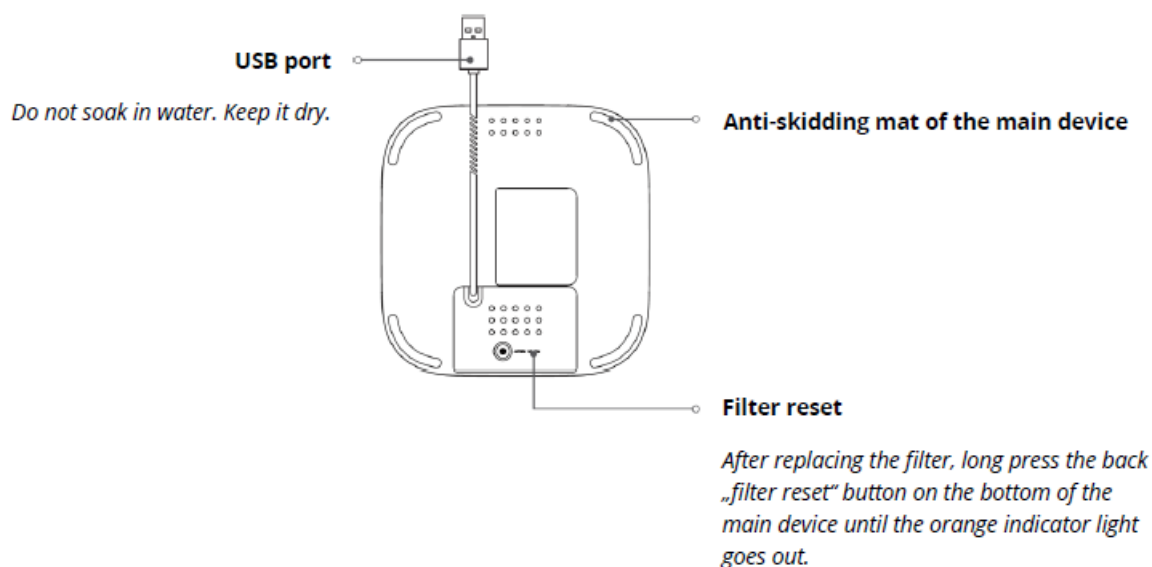

Operating Instructions

1. Take out the device

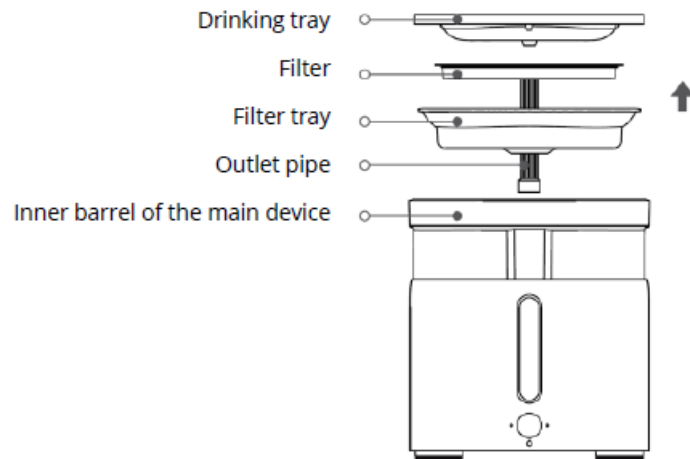

1. Unpack and take out the main device and all its parts. Read the package contents for details.
2. Soak the filter.

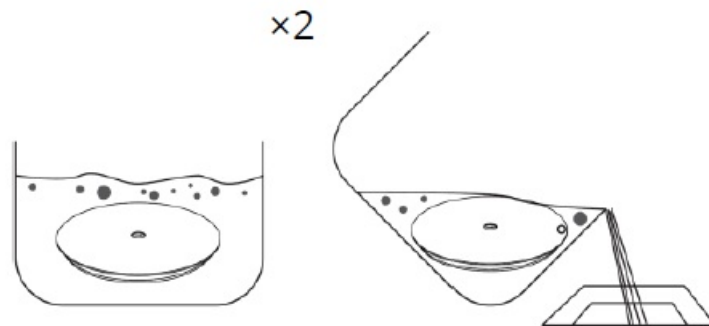

1. Put the filter into the water, soak it and clean it thoroughly before installing. It is recommended to soak the filter in water twice, five minutes each.
3. Flush the drinking tray, filter tray and the interior of the inner barrel of the main device.

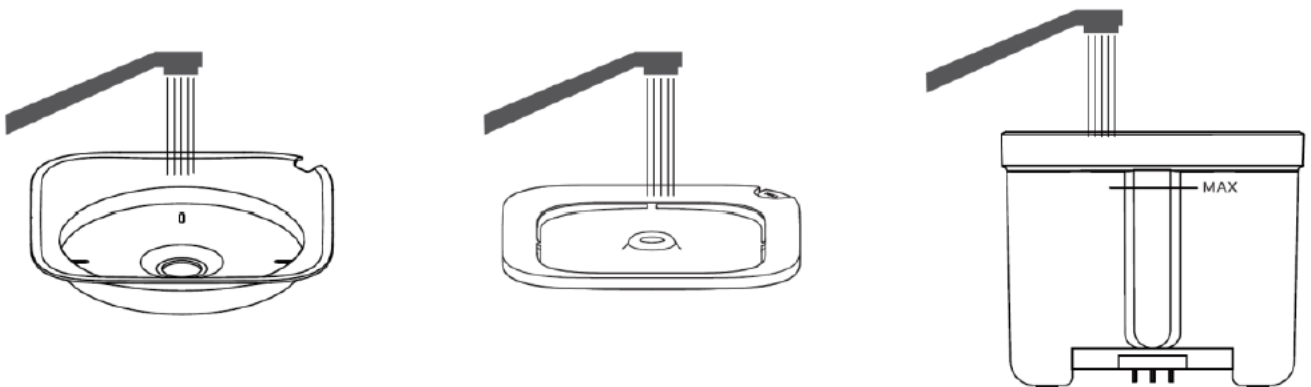

1. Clean the tray set (drinking tray and filter tray) and the water storage barrel and internal accessories with clean water before use. It is recommended to clean them twice. Only the interior of the inner barrel of the main device can be cleaned with water. The exterior can be wiped, but make sure to keep it dry.
4. Install the silent pump and the outlet pipe.

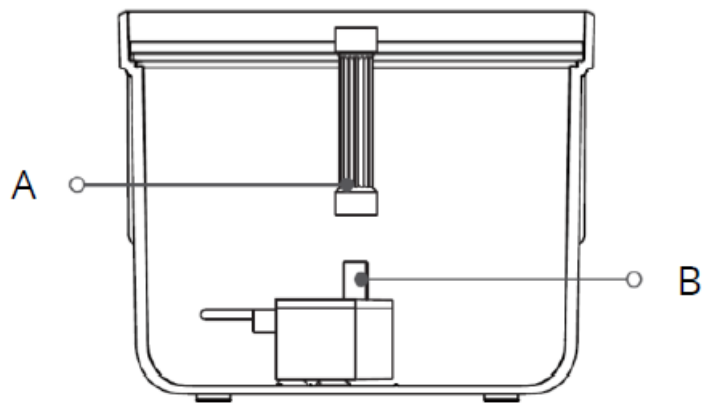

1. Please make sure that the pump is placed in the bottom groove correctly. Take out the outlet pipe (A) and align it with water pump outlet (B), press it tightly.
5. Refill water into the inner barrel of the main device.

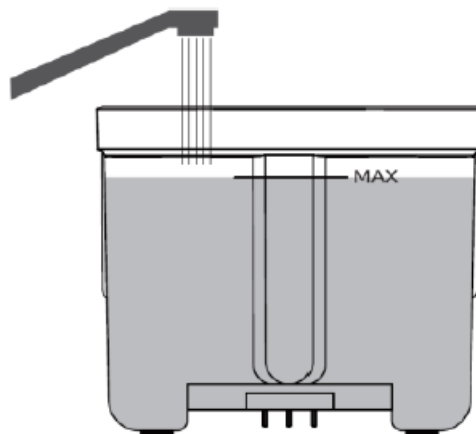

1. Refill water into the inner barrel of the main device.
6. Install the accessories in order after cleaning.

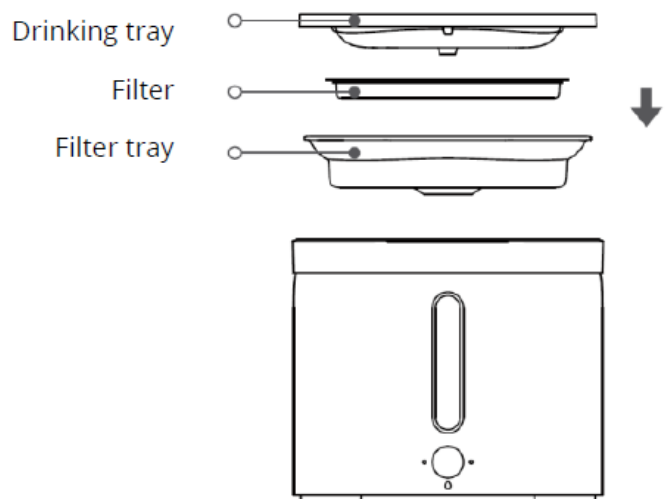
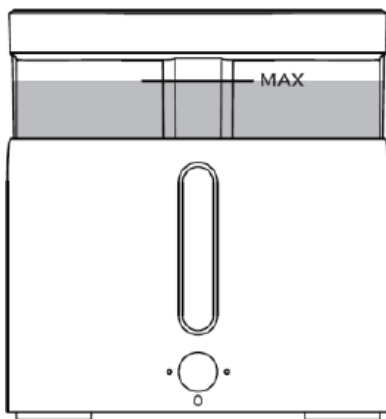

1. Put the inner barrel of the main device, filter tray, filter and drinking tray in this order. Please be sure to keep them in proper order and align the outlet pipe with the outlet holes reserved for each part.

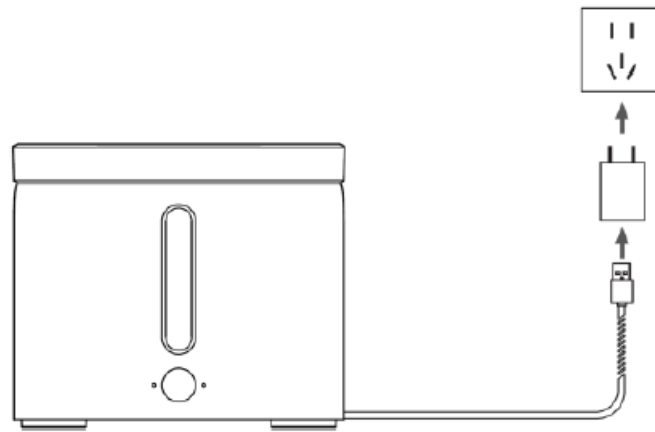

7. Connect the USB power port to the power plug, and then plug it into a power socket to start.

Tip: Use together with PETKIT +10 Smart Water Warmer.

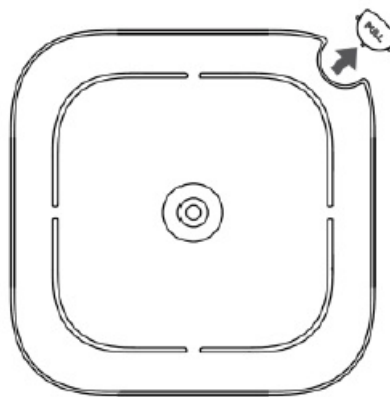

Take out the drinking tray, filter, and filter tray. Take out the drinking tray and break the fixed part by pushing it downwards. Fix the PETKIT +10 in the drinking fountain. Place the parts back to the drinking fountain in the correct order.

Explanation

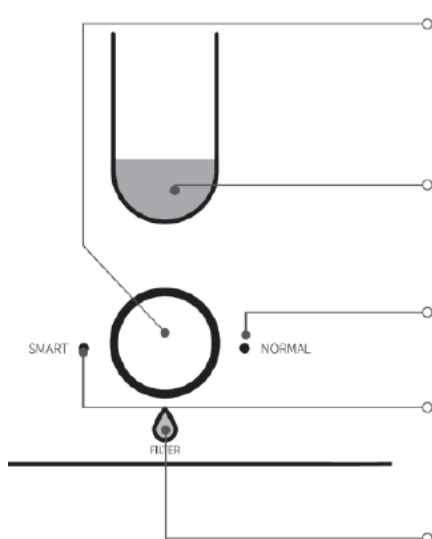

Button

Short press to power on, long press to power off. Short press when the device is on to switch between normal and smart modes.

Water shortage indicator

Blue light indicates water shortage and that the device is in standby. The drinking fountain can resume normal operation after refilling.

Normal mode

Uninterrupted welling up of water.

Smart mode

Works for three minutes, then stops for three minutes. Intermittent welling up of water.

Filter indicator light

When the orange light is on, the filter needs to be replaced. Long press the back „filter reset“ button on the bottom of the main device until the orange indicator light goes out when you change the filters.

Basic Parameters

Product name	PETKIT W2S
Product model	P4101
Size	180mm × 180mm × 155mm
Recommended for	Cats and medium- and small-sized dogs
Product weight	1.03 kg
Rated voltage	5V DC
Rated power	2W

Maintenance and Cleaning

Cleaning and maintenance of water storage barrel

- The water temperature of the complete device is between 0°C and 50°C.
- Do not expose to direct sunlight, so as not to accelerate the yellowing and brittleness of the device.
- Please clean the complete device after disconnecting the power supply and ensure that the bottom of the connector is dry.
- Please clean the inner barrel in a large-capacity container such as sink to prevent water from spilling.
- Do not use petrol, kerosene, polishing powder, bleach and other chemical reagents to clean the device.
- The drinking fountain and the water pump cannot be soaked in boiling water.
- For daily maintenance, wipe the surface of the device or power cord to remove stains with a soft cloth rinsed with warm water.
- It is recommended to completely replace the drinking water every 3-4 days. When replacing, please clean the washable parts.
- When not used for a long time, please clean the device, and put the parts into the packing box in the original packaging order after dry and store them properly in a dry place.

Replacement of the filter

- The filter shall be replaced every 60 days or so in smart mode, and every 30 days or so in normal mode. Specific replacement shall be subject to the filter indicator light.
- Soak the new filter thoroughly. It is recommended to soak the filter twice, five minutes each, and rinsed slightly before replacing.

- For health of pets, please replace the filter frequently according to the use of the filter.

Cleaning the CNC silent pump

- The CNC silent pump shall be cleaned every week to prevent dirt from clogging the waterway, resulting in abnormalities such as poor water quality and poor water discharge.

Filter

- A little black powder floating in the water: A little of non-toxic and harmless coconut shell activated carbon used for PETKIT filter will float out with the water flow, which is a normal phenomenon. Please feel free to use.
- A “click” sound of the pump in use: Due to circulation of water flow, the coconut shell activated carbon floating in the water may be absorbed by the pump. Please check and clean up in time.

Warranty Conditions

A new product purchased in the Alza.cz sales network is guaranteed for 2 years. If you need repair or other services during the warranty period, contact the product seller directly, you must provide the original proof of purchase with the date of purchase. The following are considered to be a conflict with the warranty conditions, for which the claimed claim may not be recognized:

- Using the product for any purpose other than that for which the product is intended or failing to follow the instructions for maintenance, operation, and service of the product.
- Damage to the product by a natural disaster, the intervention of an unauthorized person or mechanically through the fault of the buyer (e.g., during transport, cleaning by inappropriate means, etc.).
- Natural wear and aging of consumables or components during use (such as batteries, etc.).
- Exposure to adverse external influences, such as sunlight and other radiation or electromagnetic fields, fluid intrusion, object intrusion, mains overvoltage, electrostatic discharge voltage (including lightning), faulty supply or input voltage and inappropriate polarity of this voltage, chemical processes such as used power supplies, etc.
- If anyone has made modifications, modifications, alterations to the design or adaptations to change or extend the functions of the product compared to the purchased design or use of non-original components.

EU Declaration of Conformity

Identification data of the manufacturer's / importer's authorized representative

- **Importer:** Alza.cz a.s.
- **Registered office:** Jankovcova 1522/53, Holešovice, 170 00 Prague 7
- **CIN:** 27082440

Subject of the declaration

- **Title:** Drinking Fountain
- **Model / Type:** W2S

The above product has been tested in accordance with the standard(s) used to demonstrate compliance with the essential requirements laid down in the Directive(s)

- Directive No. 2014/53/EU
- Directive No. 2011/65/EU as amended 2015/863/EU



Prague, 10.4.2022

CE



WEEE

This product must not be disposed of as normal household waste in accordance with the EU Directive on Waste Electrical and Electronic Equipment (WEEE – 2012/19 / EU). Instead, it shall be returned to the place of purchase or handed over to a public collection point for the recyclable waste. By ensuring this product is disposed of correctly, you will help prevent potential negative consequences for the environment and human health, which could otherwise be caused by inappropriate waste handling of this product. Contact your local authority or the nearest collection point for further details. Improper disposal of this type of waste may result in fines in accordance with national regulations.

Documents / Resources

 	PETKIT W2S Smart Pet Circulating Water Machine [pdf] User Manual W2S Smart Pet Circulating Water Machine, W2S, Smart Pet Circulating Water Machine, Circulating Water Machine, Water Machine, Machine
--	--

References

-  alza.co.uk
-  alza.hu
-  alza.sk