

PERFORMANCE iN LIGHTING GUELL 4 LED Floodlight Instruction Manual

August 19,
2022

[Home](#) » [PERFORMANCE iN LIGHTING](#) » **PERFORMANCE iN LIGHTING GUELL 4 LED
Floodlight Instruction Manual** 

Contents [[hide](#)]

[1 PERFORMANCE iN LIGHTING GUELL 4 LED Floodlight](#)

[2 SYMBOL](#)

[3 OVERVIEW](#)

[4 INSTALLATION INSTRUCTIONS](#)

[5 Documents / Resources](#)

[5.1 References](#)

[6 Related Posts](#)

PERFORMANCE
 LIGHTING

PERFORMANCE iN LIGHTING GUELL 4 LED Floodlight



IMPORTANT: - In order to ensure optimum performance and safety, the luminaire must be correctly installed by qualified personnel, in compliance with the following instructions.

- Before performing any maintenance, always remove the voltage with a bipolar switch.
- The light source must be replaced only by qualified personnel or by the manufacturer of the luminaire.
- Any type of component maintenance can only be carried out by qualified personnel or by the manufacturer of the device.
- The following instructions must be kept in a safe place.
- Any misuse or any modification of the product not expressly authorised by PERFORMANCE IN LIGHTING S.p.A. is hazardous and makes the warranty nil and void..
- Any reproduction of the contents of this sheet without prior written consent of PERFORMANCE IN LIGHTING S.p.A. is prohibited.

SYMBOL

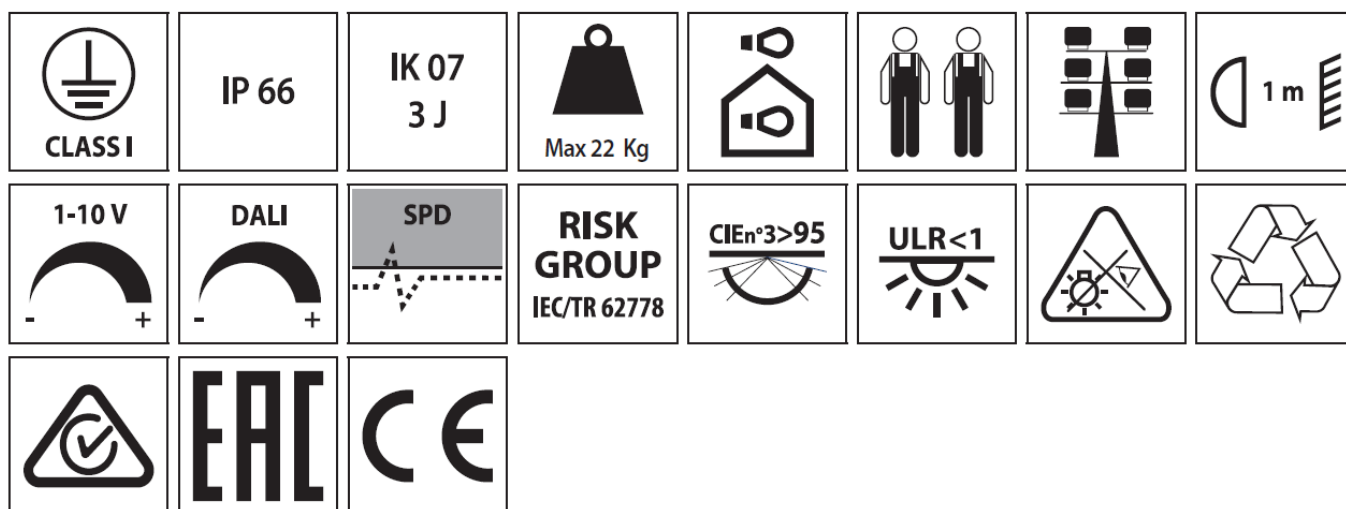

THIS PRODUCT CONTAINS A LIGHT SOURCES OF ENERGY EFFICIENCY CLASS:

	5700K	5000K	4000K	3000K	2700K
CRI 90	—	—	—	—	—
CRI 80	—	—	D	D	—
CRI 70	—	—	—	—	—

IMPORTANT NOTE:

Before performing any exchange please contact ecodesignsupport.it@pil.lighting for technical instructions.

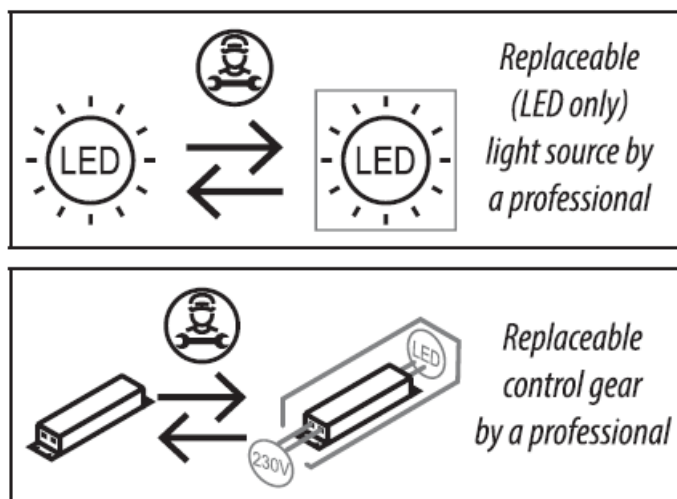

OVERVIEW

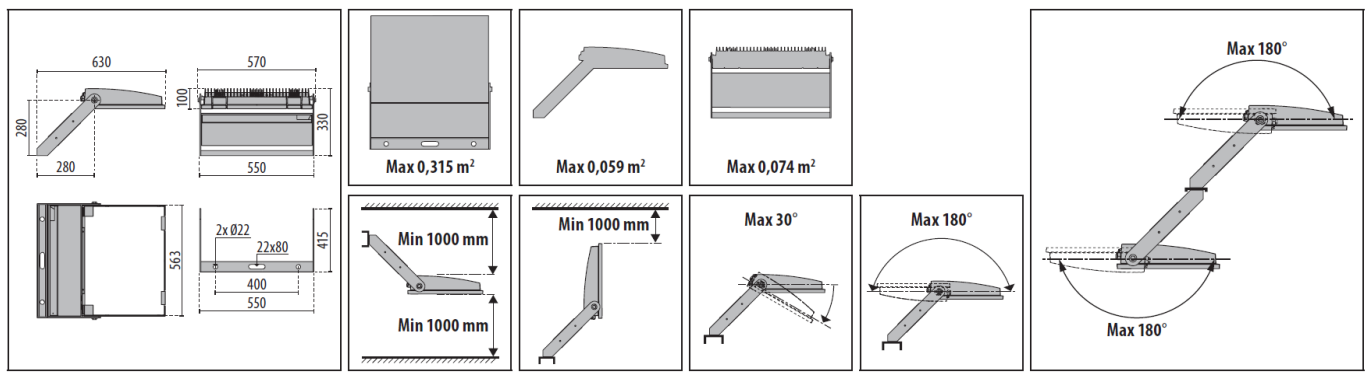

INSTALLATION INSTRUCTIONS

- The luminaire is suitable for outdoor and indoor installation.
- The luminaire is suitable for installation on usually flammable surfaces.
- Provide the supply line with devices able to avoid over voltages (surge protection).
- Always verify that the structure is suitable to fix the luminaire. **ELECTRICAL CONNECTION:**

- Check the local voltage is same as indicated on the product label.
- For the electrical connection please respect the mark on the luminaire.

STEPS

STEP 1

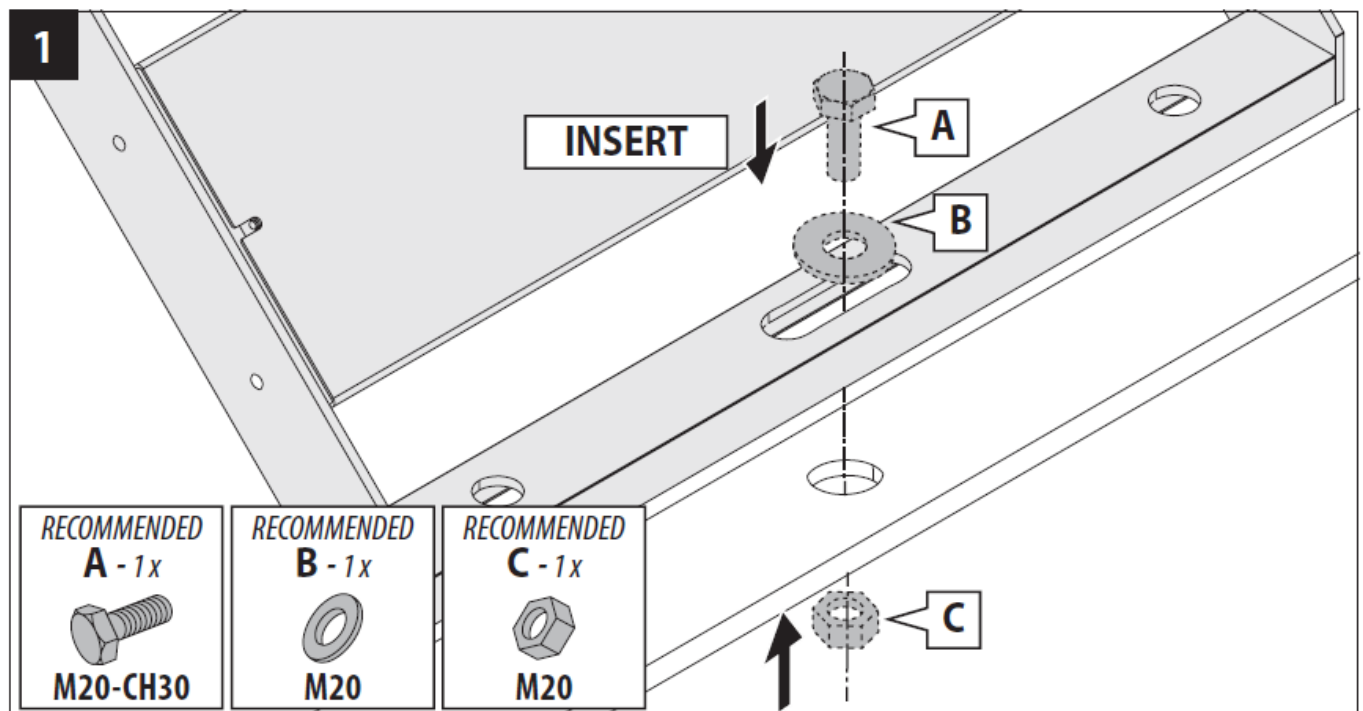

STEP 2

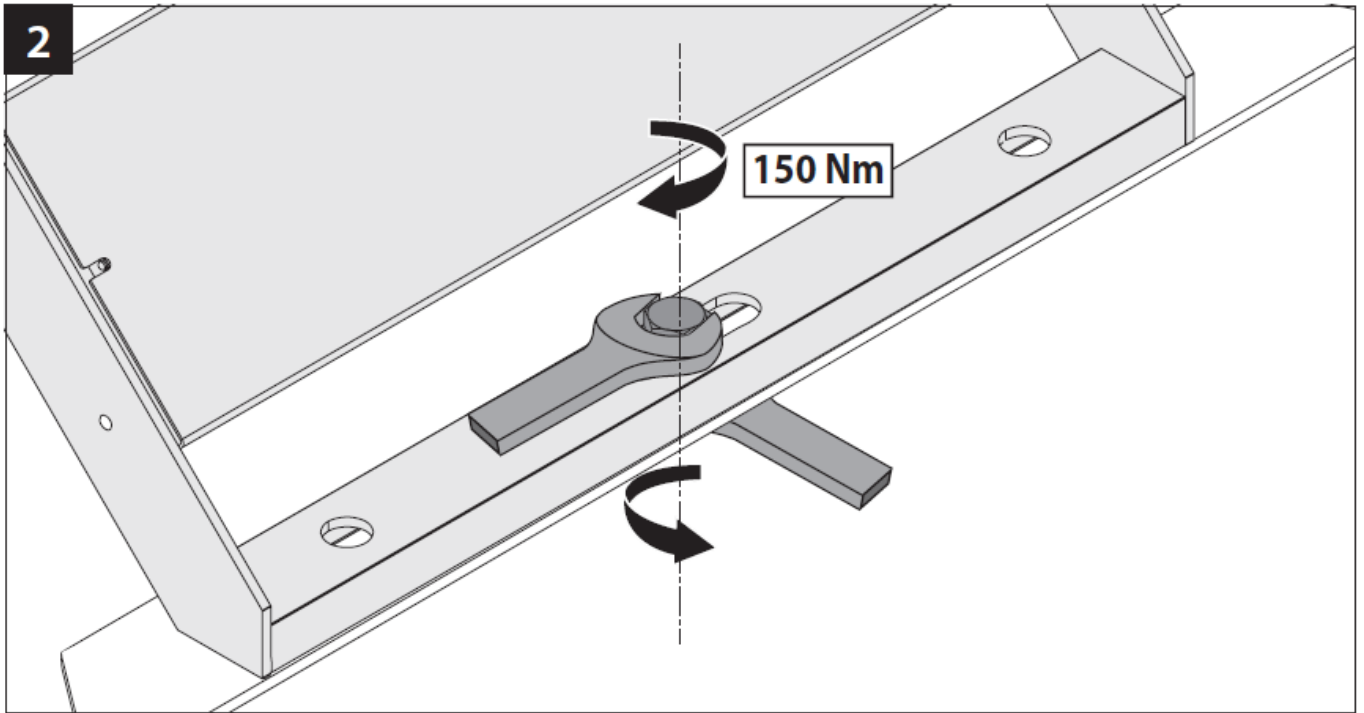

STEP 3

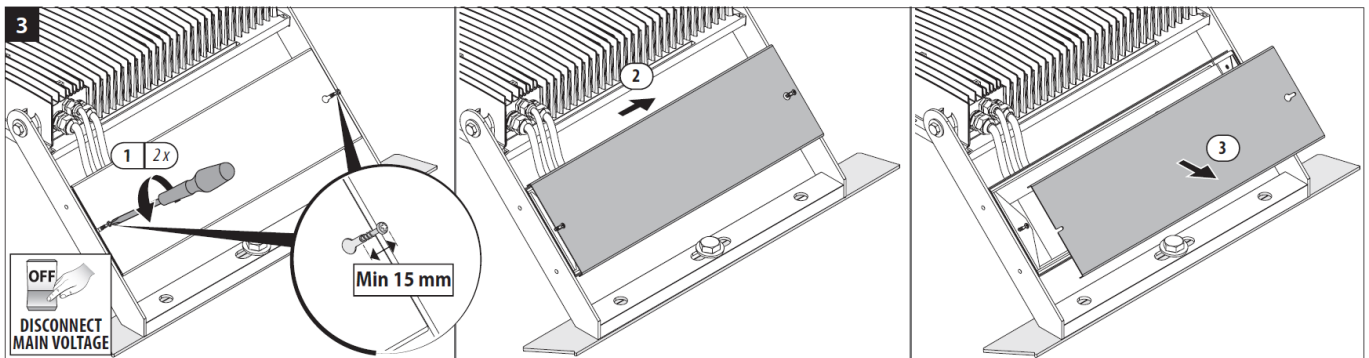

STEP 4

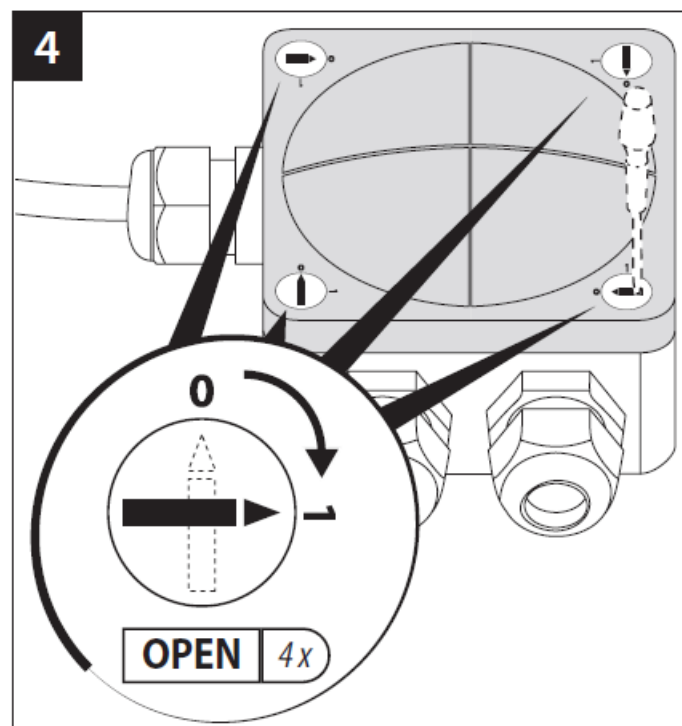

STEP 5

5A ON-OFF / SPD WIRING

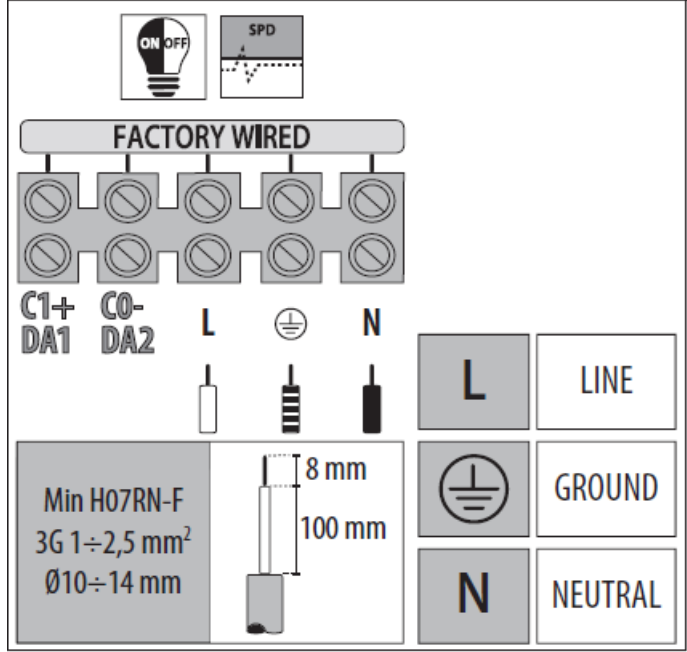

5B 1-10V / DALI WIRING

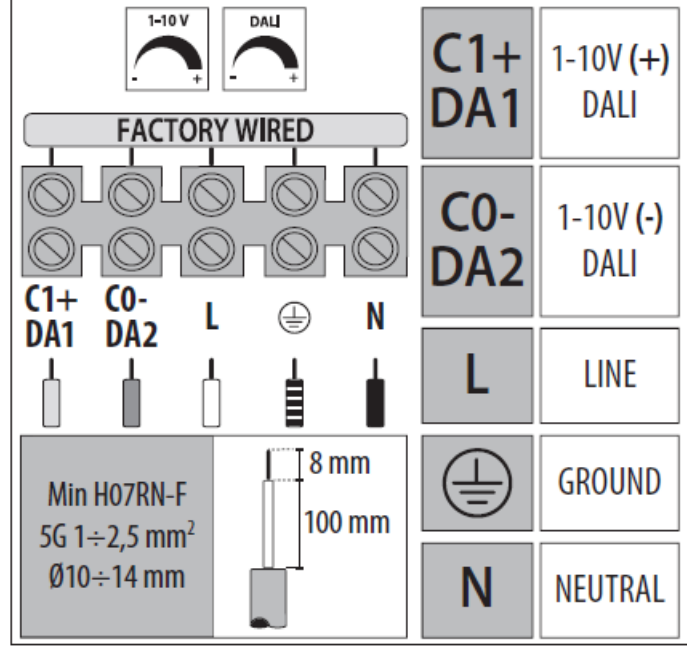

STEP 6

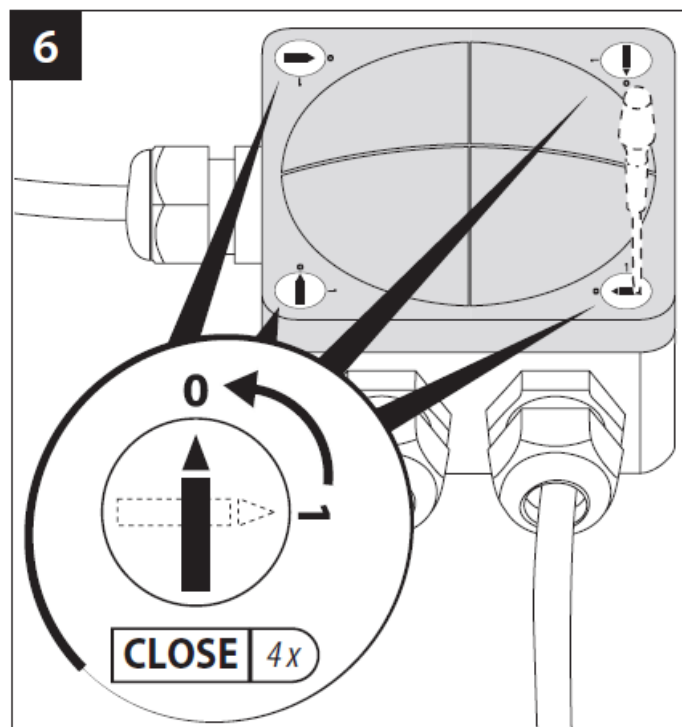

STEP 7

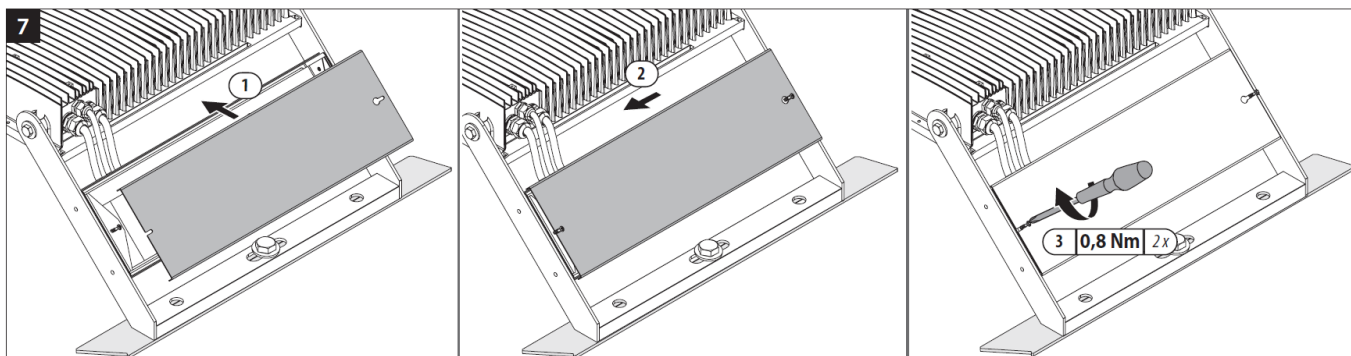

STEP 8

PERFORMANCE-iN-LIGHTING-GUELL-4-LED-Floodlight-fig12

STEP 9

PERFORMANCE-iN-LIGHTING-GUELL-4-LED-Floodlight-fig13

Minimum distance between floodlight and illuminated surface.

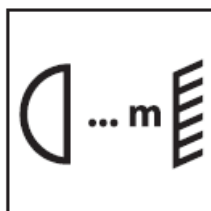

Complete with supplementary SPD device with connection in series. The device protects against sudden surges from the mains up to a peak of 10kV / 5kA (according to standard EN 61643-11). At the end of its lifecycle, the device opens the circuit, protecting by also turning the equipment off (indicator off) With indicator off, replace the device. – For correct operation of the 10kV protection device, provide a fuse (max 16A)

on the power supply line.

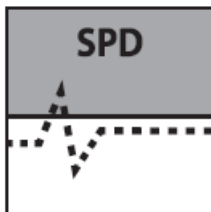

Complete with supplementary SPD device with connection in series. The device protects against sudden surges from the mains up to a peak of 10kV / 5kA (according to standard EN 61643-11). At the end of its lifecycle, the device opens the circuit, protecting by also turning the equipment off (indicator off) With indicator off, replace the device. – For correct operation of the 10kV protection device, provide a fuse (max 16A) on the power supply line.



Risk group RG1 at a distance of 6.44 m according to Standard IEC/TR **62778**.



WARNING: do not stare at the light source.

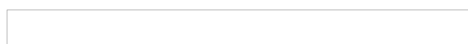

Replace any damaged glass/diffusers or other damaged parts. Request the manufacturer to provide a spare part.



Regularly clean the glass/diffuser diffuser of the spotlight with a soft cloth. – Do not use chemicals for cleaning the glass/diffuser diffuser of the luminaire.

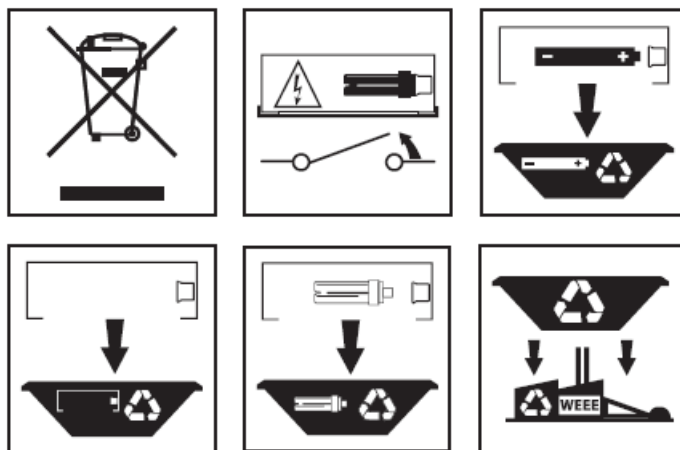

In respect and compliance to environmental standards at the end of life do not dispose of as standard waste, this must be taken to one of the authorised collection points.

PERFORMANCE IN LIGHTING S.p.A.

Viale del Lavoro 9/11 – 37030 Colognola ai Colli (VR) Italia Tel: +39.045.61.59.211 –

Fax: +39.045.61.59.292

www.performanceinlighting.com

Documents / Resources

	PERFORMANCE IN LIGHTING GUELL 4 LED Floodlight [pdf] Instruction Manual GUELL 4, LED, LED Floodlight, GUELL 4 LED Floodlight, Floodlight
---	---

References

- [_prohibited.DE](#)
- [This server is operated by UnoEuro Webhosting](#)
- [_Api Market - zakupy spożywcze przez Internet! - Apimarket.pl - zakupy spożywcze przez Internet!](#)

Related Posts



[PERFORMANCE IN LIGHTING GUELL 2.5 LED Floodlight Instructions](#)

PERFORMANCE IN LIGHTING GUELL 2.5 LED

Floodlight IMPORTANT: - In order to ensure optimum performance and safety, the...



[EYE LIGHTING Guell 2.5 Floodlight Instruction Manual](#)

EYE LIGHTING Guell 2.5 Floodlight IMPORTANT: In order to ensure optimum performance and safety, the luminaire must be...



[IKEA LEDBERG LED Lighting Strip Instruction Manual](#)

LEDBERG LED Lighting Strip Instruction Manual

IMPORTANT SAFETY INSTRUCTIONS For indoor use only. Regularly check the cord, the...

IKEA IRSTA LED Worktop Lighting Instruction Manual IMPORTANT SAFETY
INSTRUCTIONS For indoor use only. Regularly check the cord,...

■ PERFORMANCE iN
LIGHTING

◆ floodlight, GUELL 4, GUELL 4 LED Floodlight, LED, LED Floodlight, PERFORMANCE iN
LIGHTING

—Previous Post

PERFORMANCE iN LIGHTING [Guell Zero Outdoor and Indoor Compact
Spotlight Instructions](#)

Next Post—

PERFORMANCE iN LIGHTING [Spider+ 20 LED Flood Light for Indoor
and Outdoor Instructions](#)

Leave a comment

Your email address will not be published. Required fields are marked *

Comment *

Name

Email

Website

☐ Save my name, email, and website in this browser for the next time I comment.

Post Comment

Search

Search ...

Search

Manuals+,