

PERFASCIN
PERFASCIN JH-TX507 Clone
Remote Duplicator Control
Multi Frequency



PERFASCIN JH-TX507 Clone Remote Duplicator Control Multi Frequency User Manual

[Home](#) » [PERFASCIN](#) » PERFASCIN JH-TX507 Clone Remote Duplicator Control Multi Frequency User Manual 

Contents

- [1 PERFASCIN JH-TX507 Clone Remote Duplicator Control Multi Frequency](#)
- [2 Product Information](#)
- [3 Product Usage Instructions](#)
- [4 INSTRUCTIONS TO PROGRAM REMOTE](#)
- [5 Troubleshooting](#)
- [6 FCC](#)
- [7 Documents / Resources](#)
 - [7.1 References](#)
- [8 Related Posts](#)

PERFASCIN

PERFASCIN JH-TX507 Clone Remote Duplicator Control Multi Frequency



Product Information

Specifications:

- Compliance: Part 15 of FCC Rules
- RF Exposure Compliance: Yes

Product Usage Instructions

Caution:

Any changes or modifications to this device not explicitly approved by the manufacturer could void your authority to operate this equipment.

Compliance:

This device complies with part 15 of the FCC Rules.

Operation is subject to the following two conditions:

1. This device may not cause harmful interference.
2. This device must accept any interference received, including interference that may cause undesired operation.

RF Exposure:

The device has been evaluated to meet general RF exposure requirements.

Frequently Asked Questions (FAQ)

• Q: Can I make changes to the device on my own?

A: No, any changes or modifications not approved by the manufacturer may void your authority to operate the equipment.

• Q: What are the operating conditions for this device?

A: The device must not cause harmful interference and must accept any received interference, meeting general RF exposure requirements.

INSTRUCTIONS TO PROGRAM REMOTE

Method 1: Receiver-Based Programming

Step 1: Locate garage receiver and determine the unique 10 digit code. You can use the original 10 digit code or reset the new 10 digit code at this time. Take note of the unique code.

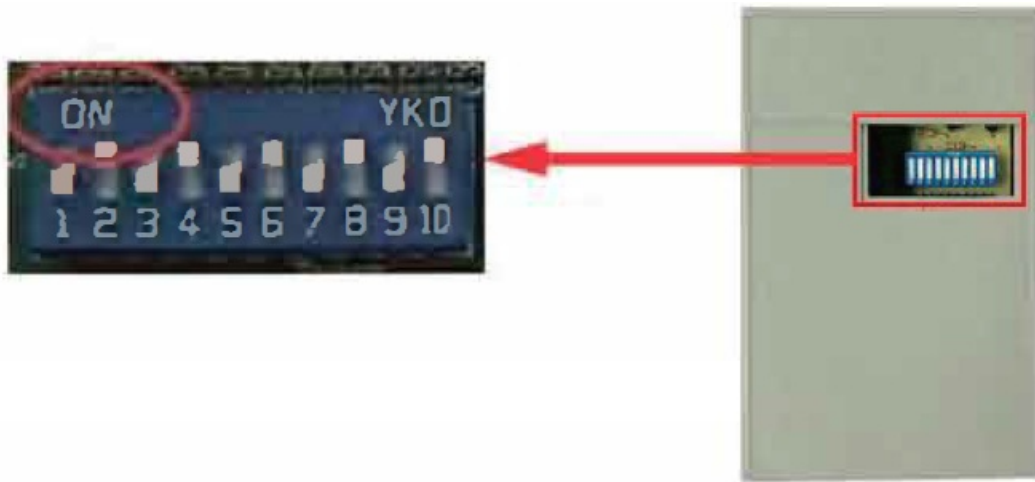

TIP: Use a random sequence of numbers to make the code as secure as possible!
Avoid easy to guess sequences.

Step 2: Remove the front panel from the transmitter which will expose the 10 digit code selector.

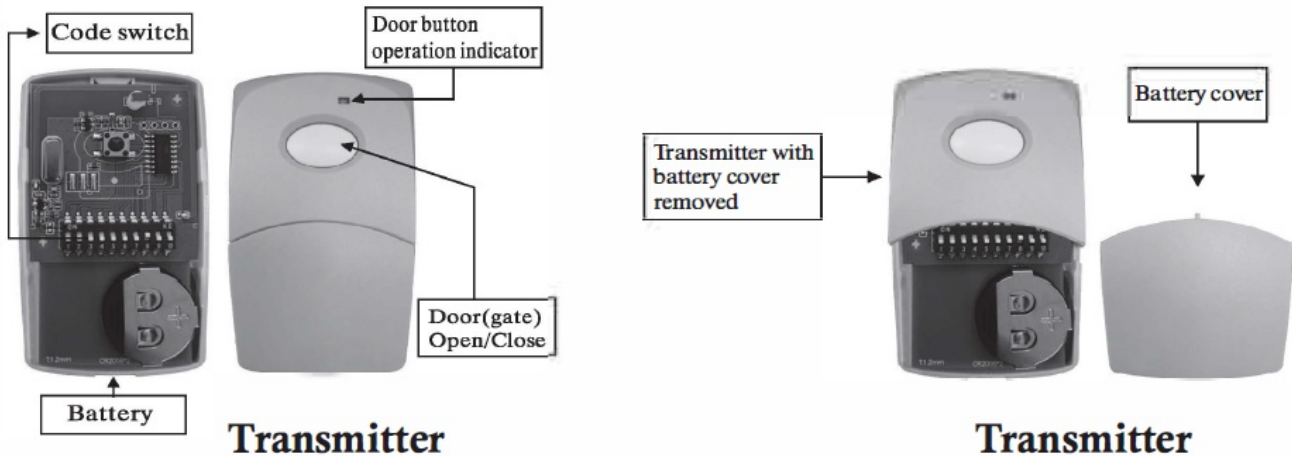

Step 3: Using a small screwdriver match the code to your receiver which was determined in step1. The switch has an on and off positions which is selected by pressing up or down. The 10 digit code on all remote controls must match what was selected in step 1.



If programming don't success, please see troubleshooting on the next page.

Method 2: Transmitter -To-Transmitter Programming

- Step 1 : Open the casing of your already-programmed transmitter.
- Step 2: You will see a row of small programmable numbered switches. They are in the ON or OFF position.
- Step 3: Open the casing of your new transmitter.
- Step 4: You will see a row of small programmable numbered switches.
- Step 5: Set them in the same way as those set in your already-programmed transmitter. Step 6: Your new transmitter control is programmed.



Instructions To Erase A Remote Control Transmitter

- Method 1 : You may erase a transmitter by selecting a new unique code on your receiver.
- Method 2: You can alter the 10 digit code on the transmitter so it DOES NOT match the receiver.

Troubleshooting

- Solution 1: Please make sure to dial the switch to the top or bottom. If not, press it again.
- Solution 2: Check whether the 10 digit code of the transmitter and receiver are identical.
- Solution 3: Try to dial the Dip Switches to the opposite position. Then test again.



- Solution 4: Change another set of 10 digit code for the transmitter and receiver. Then test again.

Battery Replacement

- Battery type: CR2016
- Quantity: 2

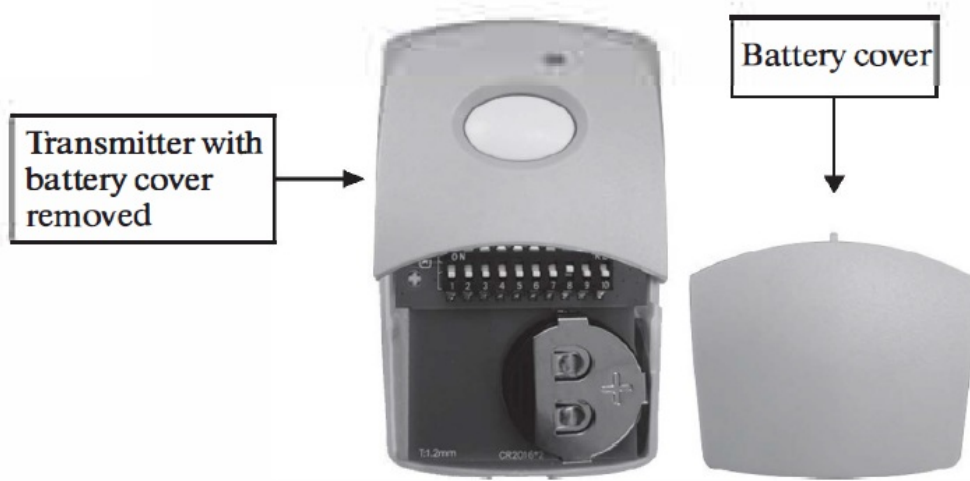

Transmitter

FCC

This equipment has been tested and found to comply with the limits for a Class B digital device, pursuant to part 15 of the FCC Rules. These limits are designed to provide reasonable protection against harmful interference in a residential installation. This equipment generates, uses and can radiate radio frequency energy and, if not installed and used in accordance with the instructions, may cause harmful interference to radio communications. However, there is no guarantee that interference will not occur in a particular installation. If this equipment does cause harmful interference to radio or television reception, which can be determined by turning the equipment off and on, the user is encouraged to try to correct the interference by one or more of the following measures:

- Reorient or relocate the receiving antenna.
- Increase the separation between the equipment and receiver.
- Connect the equipment into an outlet on a circuit different from that to which the receiver is connected.
- Consult the dealer or an experienced radio/TV technician for help.

Caution: Any changes or modifications to this device not explicitly approved by manufacturer could void your authority to operate this equipment.

This device complies with part 15 of the FCC Rules.

Operation is subject to the following two conditions:

1. This device may not cause harmful interference, and
2. this device must accept any interference received, including interference that may cause undesired operation.

The device has been evaluated to meet general RF exposure requirement.

Documents / Resources

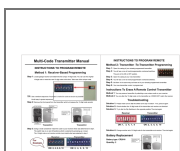

[PERFASCIN JH-TX507 Clone Remote Duplicator Control Multi Frequency \[pdf\] User Manual](#)

JH-TX507 Clone Remote Duplicator Control Multi Frequency, JH-TX507, Clone Remote Duplicator Control Multi Frequency, Duplicator Control Multi Frequency, Control Multi Frequency, Multi Frequency, Frequency

References

- [User Manual](#)

Manuals+, **Privacy Policy**

This website is an independent publication and is neither affiliated with nor endorsed by any of the trademark owners. The "Bluetooth®" word mark and logos are registered trademarks owned by Bluetooth SIG, Inc. The "Wi-Fi®" word mark and logos are registered trademarks owned by the Wi-Fi Alliance. Any use of these marks on this website does not imply any affiliation with or endorsement.