



## Perenio PEHPL10 Power Link WiFi Smart Plug User Guide

[Home](#) » [Perenio](#) » Perenio PEHPL10 Power Link WiFi Smart Plug User Guide 

### Contents

- [1 Perenio PEHPL10 Power Link WiFi Smart Plug](#)
- [2 GENERAL INFO](#)
- [3 INSTALLATION AND CONFIGURATION](#)
- [4 SAFETY OPERATION RULES](#)
- [5 TROUBLESHOOTING](#)
- [6 GENERAL DRAWING](#)
- [7 Documents / Resources](#)
  - [7.1 References](#)
- [8 Related Posts](#)



### Perenio PEHPL10 Power Link WiFi Smart Plug



## GENERAL INFO

Specification <sup>1</sup>	Wi-Fi (IEEE802.11 b/g/n20/n40), 100VAC to 240VAC, 16A (4,000W max), 1.0W max, 50/60Hz, 2.4GHz, IP20 Protection Class, plug type E/F, socket type C/F, LED Indicator, protective shutter, integration with Google Home, Yandex Smart Home, Amazon Alexa, Apple Siri, Marusia (Mail.ru)
Functions	Monitoring of voltage, current, power and consumed energy, power on/off schedule, countdown timer, custom scenarios
Scope of supply	PEHPL10 Power Link Wi-Fi (white), Quick Start Guide, Warranty Card, Sticker
Warranty	2 years (Service life: 2 years)

## INSTALLATION AND CONFIGURATION

1. Unpack the Power Link Wi-Fi device, plug it into the mains socket and power on (Push the Power Button and wait until the LED flashes).
2. Connect your smartphone to Wi-Fi (2.4GHz) and log in to your Perenio Smart or Perenio Lite3 app account (or download the mobile application from Google Play or Apple Store and register a new User Account). Then, click on the “+” icon and follow connection tips specified on the screen.
3. Activate the device in Google Home, Yandex Smart Home (Alice), Marusia (Mail.ru), Amazon Alexa or Apple Siri<sup>4</sup>, if any.

## SAFETY OPERATION RULES

The device may be connected to the power supply, if the main voltage matches the value in the device specification. The device must be connected directly to the mains socket. Do not connect it to other plugged in smart plugs. It is not allowed to drop, throw or disassemble the device, as well as attempt to repair it on one's own or use it in case of visible damage or defects

## TROUBLESHOOTING

1. The LED does not light up: Check that the device is plugged in and powered on, otherwise contact our Support.
  2. The device does not connect to the Wi-Fi Network: Check that the selected Network is of 2.4GHz frequency.
  3. The device changes status to “offline” unexpectedly: Power supply failure, or the smart plug is out of Wi-Fi Network coverage.
- This device is for indoor installation only.
  - All information contained herein is subject to amendments without prior notification of the User. For current information and details on the device description and specification, connection process, certificates, warranty and quality issues, as well as the Perenio Smart/Perenio Lite app functionality, see relevant Installation and Operation Manuals available for downloading at [perenio.com/documents](http://perenio.com/documents). All trademarks and names herein are the property of their respective owners. See operating conditions and date of manufacture on the individual packaging. Manufactured by Perenio IoT spol s r.o. (Na Dlouhem 79, Ricany – Jazlovice 251 01, Czech Republic). Made in China.
  - Perenio Smart app is a primary mobile application where all Perenio® devices may be activated, while Perenio Lite is a simplified version with limited functionality for certain devices.
  - For some third-party applications, the PowerLink Wi-Fi device must be first activated in the Perenio Smart or

Perenio Lite app.

## GENERAL DRAWING

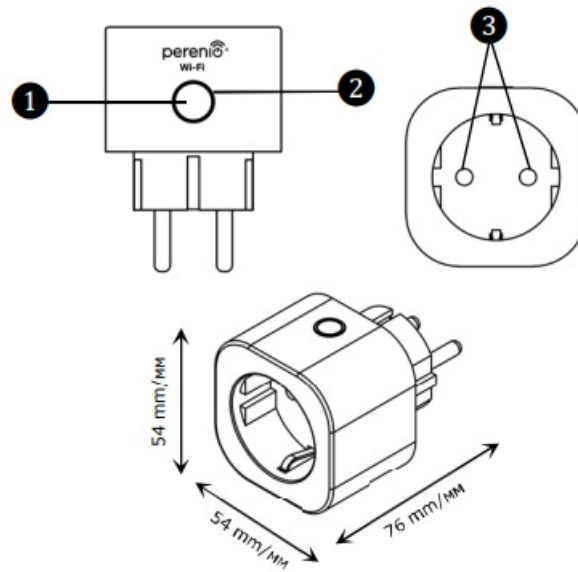

1. Power Button
2. LED Indicator
3. Protective



**Perenio Lite**  
Mobile Application



**Perenio Smart:**  
Building Management  
System





[perenio.com](https://perenio.com)

## Documents / Resources

 <p>perenio PEHPL10 Power Link WiFi Smart Plug Quick Start Guide</p>	<p><a href="#">Perenio PEHPL10 Power Link WiFi Smart Plug</a> [pdf] User Guide PEHPL10, Power Link WiFi Smart Plug, PEHPL10 Power Link WiFi Smart Plug</p>
---	--

## References

- [Mail.ru](#)

-  [Smart Home and Office | Perenio IoT](#)
-  [Files and documents](#)

Manuals+.