



PEREL Sport Marker – Timer User Manual

[Home](#) » [PEREL](#) » PEREL Sport Marker – Timer User Manual 

PEREL Sport Marker – Timer



Contents

- 1 Introduction
- 2 Safety Instructions
- 3 General Guidelines
- 4 Overview
- 5 Installation
- 6 Care and Maintenance
- 7 Technical Specifications
- 8 Documents / Resources
 - 8.1 References
- 9 Related Posts

Introduction



To all residents of the European Union

Important environmental information about this product

This symbol on the device or the package indicates that disposal of the device after its lifecycle could harm the environment. Do not dispose of the unit (or batteries) as unsorted municipal waste; it should be taken to a specialized company for recycling. This device should be returned to your distributor or to a local recycling service. Respect the local environmental rules.

If in doubt, contact your local waste disposal authorities.

Thank you for choosing Perel! Please read the manual thoroughly before bringing this device into service. If the device was damaged in transit, do not install or use it and contact your dealer.

Safety Instructions



Read and understand this manual and all safety signs before using this appliance.



Indoor use only.

- This device can be used by children aged from 8 years and above, and persons with reduced physical, sensory or mental capabilities or lack of experience and knowledge if they have been given supervision or instruction concerning the use of the device in a safe way and understand the hazards involved. Children shall not play with the device. Cleaning and user maintenance shall not be made by children without supervision.

General Guidelines

- Refer to the Velleman® Service and Quality Warranty on the last pages of this manual.
- All modifications of the device are forbidden for safety reasons. Damage caused by user modifications to the device is not covered by the warranty.
- Only use the device for its intended purpose. Using the device in an unauthorised way will void the warranty.
- Damage caused by disregard of certain guidelines in this manual is not covered by the warranty and the dealer will not accept responsibility for any ensuing defects or problems.
- Nor Velleman nv nor its dealers can be held responsible for any damage (extraordinary, incidental or indirect) –

of any nature (financial, physical...) arising from the possession, use or failure of this product.

- Keep this manual for future reference.

Overview

A	long bar	1 x
B	long bar with handle	1 x
C	short bar	2 x
D	base	1 x
E	base with wheel bolts	1 x
F	socket head bolt 8M, long	10 x
G	locknut 8M	12 x
H	flat washer 8M	22 x
I	locknut	2 x
J	wheel washer	2 x
K	wheel	2 x
L	knob bolt	2 x
M	plastic plug, round	1 x
N	plastic plug, square	2 x
O	plastic cap, square	2 x
P	socket head bolt 8M, short	2 x
R	spacer	2 x
S	scoreboard	not incl.

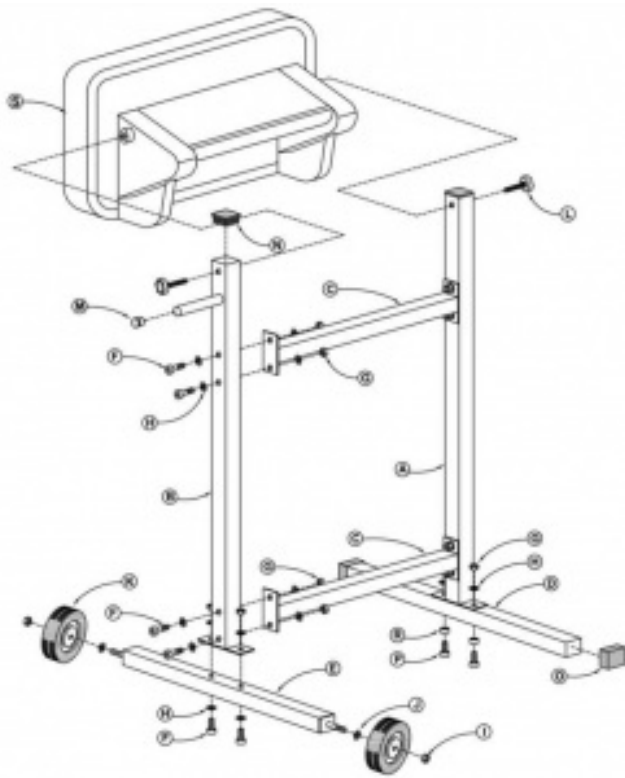

Installation



Disconnect the scoreboard power supply before installing.

1. Assemble the stand as indicated in the illustration.
2. Place the assembled stand upright and mount the scoreboard (not included) as indicated in the illustration.
3. Tighten all nuts and bolts once more to make sure that the assembly is solid and safe

Care and Maintenance

- All screws should be tightened and free of corrosion.
- The parts should not be deformed, modified or tampered with e.g. do not drill extra holes, do not change the location of the connections...
- Mechanically moving parts must not show any signs of wear and tear.
- Wipe the device regularly with a moist, lint-free cloth. Do not use alcohol or solvents.
- Do not immerse the device in any liquid.
- There are no user-serviceable parts. Contact your dealer for spare parts if necessary.

Technical Specifications

dimensions	108 x 18.5 x 12 cm
weight	10 kg

Use this device with original accessories only. Velleman nv cannot be held responsible in the event of damage or injury resulting from (incorrect) use of this device. For more info concerning this product and the latest version of this manual, please visit our website www.velleman.eu. The information in this

manual is subject to change without prior notice.

© COPYRIGHT NOTICE

The copyright to this manual is owned by Velleman nv. All worldwide rights reserved.

No part of this manual may be copied, reproduced, translated or reduced to any electronic medium or otherwise without the prior written consent of the copyright holder.



Documents / Resources

The thumbnail shows the cover of the user manual for the PEREL Sport Marker - Timer (WC202). It features the PEREL logo at the top, a diagram of the device, and some technical specifications in a small table.

[PEREL Sport Marker - Timer](#) [pdf] User Manual
Sport Marker - Timer, WC202

References

- [Details “ Own brands “ Velleman “ Wholesaler and developer of electronics](#)
- [Velleman “ Wholesaler and developer of electronics](#)