

[Skip to content](#)

Manuals+

User Manuals Simplified.

PENTAIR IntelliChem Controller LCD Instructions

[Home](#) » [Pentair](#) » PENTAIR IntelliChem Controller LCD Instructions

Contents [hide](#)

[1 PENTAIR IntelliChem Controller LCD](#)

[2 CONTROLLER LCD REPLACEMENT INSTRUCTIONS](#)

[3 Technical Support](#)

[4 Documents / Resources](#)

[4.1 References](#)

[5 Related Posts](#)



PENTAIR IntelliChem Controller LCD



CONTROLLER LCD REPLACEMENT INSTRUCTIONS

DANGER

Risk of Electrical Shock or Electrocution!

IntelliChem controller must be installed by a licensed or certified electrician or a qualified pool professional in accordance with the current National Electrical Code and all applicable local codes and ordinances. Improper installation will create an electrical hazard that could result in death or serious injury to pool users, installers or others due to electrical shock, and may also cause damage to property.

WARNING

Always disconnect the power to the IntelliChem controller enclosure at the circuit breaker before servicing the unit. Failure to do so could result in death or serious injury to servicemen, pool users, or others due to electrical shock.

To remove and replace the IntelliChem Controller LCD Display module:

1. Loosen the four screws securing the controller top cover. Open the top cover. See Figure 1.

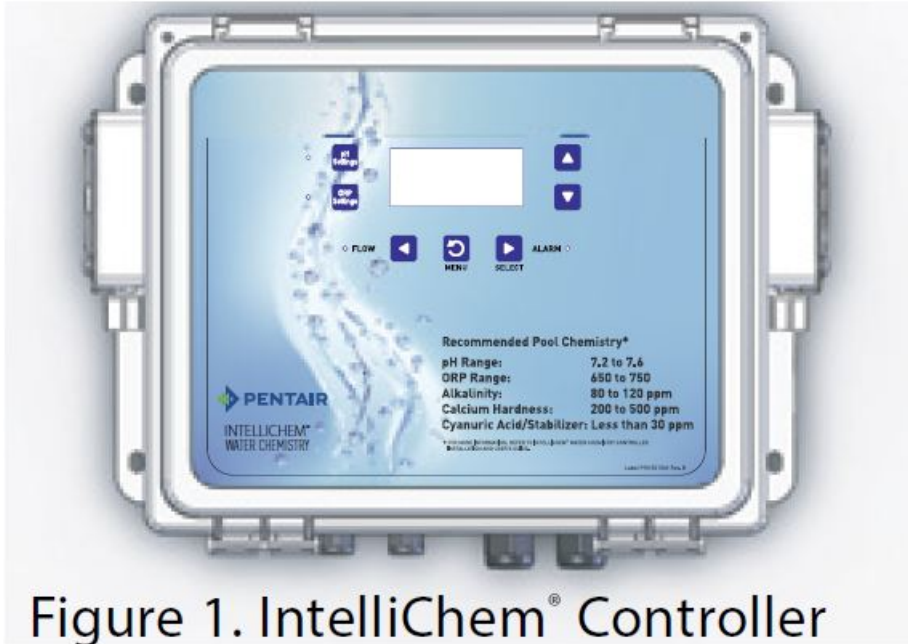

Figure 1. IntelliChem® Controller

2. Disconnect the DC power plug from the IntelliChem Controller circuit board. See Figure 2.
3. **REMOVAL:** Carefully lift the LCD Display module upward to disconnect the 16 pins (located under the LCD Display module) from the 16-pin connector on the Controller board. See Figure 2.
4. Release the LCD Display module from the four plastic standoffs located on each corner of the board.
5. **REPLACEMENT:** Align the replacement LCD Display module 16 pins with the 16-pin connector on the IntelliChem Controller board. See Figure 2.
6. Align with LCD Display module with the four Controller board plastic standoffs. See Figure 2.

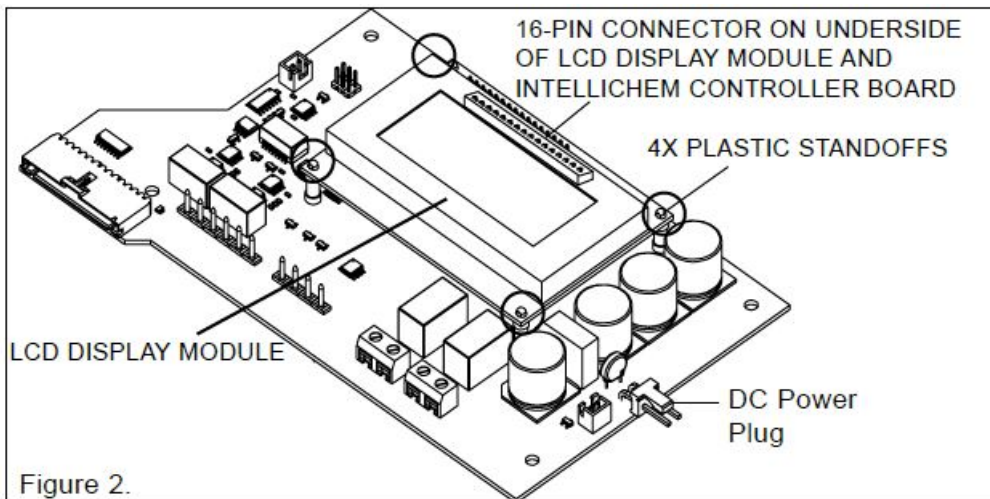

Figure 2.

7. Gently press down on the LCD module to connect both 16-pin connectors and the four snap-in-place plastic standoffs.
8. Connect the DC power plug to the IntelliChem Controller circuit board DC power pins. Close the top cover and secure the cover with the four screws.

Technical Support

- Phone 800.831.7133
- Website www.pentair.com.

Documents / Resources

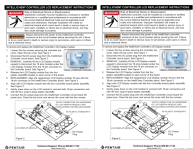

[PENTAIR IntelliChem Controller LCD](#) [pdf] Instructions
IntelliChem Controller LCD, Controller LCD, IntelliChem LCD, LCD

References

-  [Pentair](#)

[Manuals+](#),

- [home](#)
- [privacy](#)