



Pego ECP APE 03 Lock in Alarm Instruction Manual

[Home](#) » [PEGO](#) » Pego ECP APE 03 Lock in Alarm Instruction Manual 



ECP APE 03 Lock in Alarm USE AND MAINTENANCE MANUAL

Contents

- [1 CHAPTER 1:
INTRODUCTION](#)
- [2 CHAPTER 2: INSTALLATION](#)
- [3 APPENDICES](#)
- [4 Documents / Resources](#)
 - [4.1 References](#)

CHAPTER 1: INTRODUCTION

1.1 MAN IN COLD ROOM ALARM KIT COMPONENTS

THE MAN IN COLD ROOM ALARM KIT consists of:

- Visual/acoustic alarm control unit complete with buffer battery.
- N° 3 seals, to be inserted between fixing screw and box backing.
- Emergency cold room light switch.
- Use and maintenance manual.

1.2 PRODUCT IDENTIFICATION CODE

ECPAPE03

Complete KIT with luminous/acoustic man in cold room emergency alarm.

1.3 TECHNICAL CHARACTERISTICS

Mains power supply	230 Vac 50/60 Hz
Max consumption on mains power	20 mA
Buffer battery	12 V DC Ni-MH 1300 mAh Complete recharge time: 110 h
Operating autonomy	– With 230 Vac NOT ON (running on charged buffer battery): 14 h approx. – With 230 Vac power ON: unlimited I62
Out-of-room module	IP 43 protection rating Operating temperature: -5 – +45 °C
Acoustic characteristics	Type: piezoelectric Sound power: 90 dB at 1m
Visual warning	Flashing red LED, 12 V DC
In-room emergency pushbutton	Lighting: red LED, 12 V DC NC contact Keypad with IP65 protection rating Operating temperature: -25 – +70 °C
Auxiliary relay	8A AC1 exchange contact (Relay deenergized with alarm on)

1.4 DIMENSIONS OF ALARM CONTROL UNIT



1.5 DIMENSIONS OF EMERGENCY PUSHBUTTON UNIT



1.6 IDENTIFICATION DATA

The unit described in this manual has, on its side, an ID plate showing all the relevant identification data:

- Name of Manufacturer
- Code of the UNIT
- Serial number
- IP protection rating
- Power supply voltage

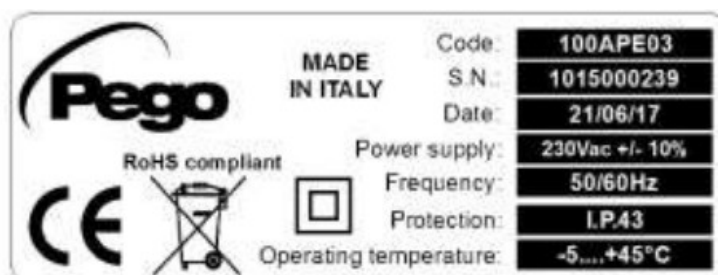

1.7 DESCRIPTION OF SYSTEM

The purpose of this safety system is to allow a person trapped inside the cold room to activate an acoustic/luminous alarm located outside the room and so request help. The system has been designed to function even in the event of a temporary mains power failure: in this event the system is powered by a buffer battery housed in the external unit. It conforms to the UNI EN 378-1: 2016, applicable to cold rooms at negative temperatures and with a volume greater than 10 m³.

The system consists of the following parts:

- **Emergency pushbutton to be fitted inside the cold room.**

Consists of a luminous mushroom-type button with N.C. contact. The pushbutton is permanently lit by LEDs so that it can be located in the dark.

- **Acoustic/visual alarm control unit to be fitted outside the cold room.**

Features a siren and flashing light and a buffer battery to provide power in the event of a black-out. There is also a clean contact (closed with alarm on) that can be used to activate other devices such as a remote warning dialler or additional sirens.

Connection between the two devices – consisting of a lead laid by the installer as per the wiring diagram – is ensured by the system safety logic. Should the lead be cut or disconnected the alarm will be activated immediately.

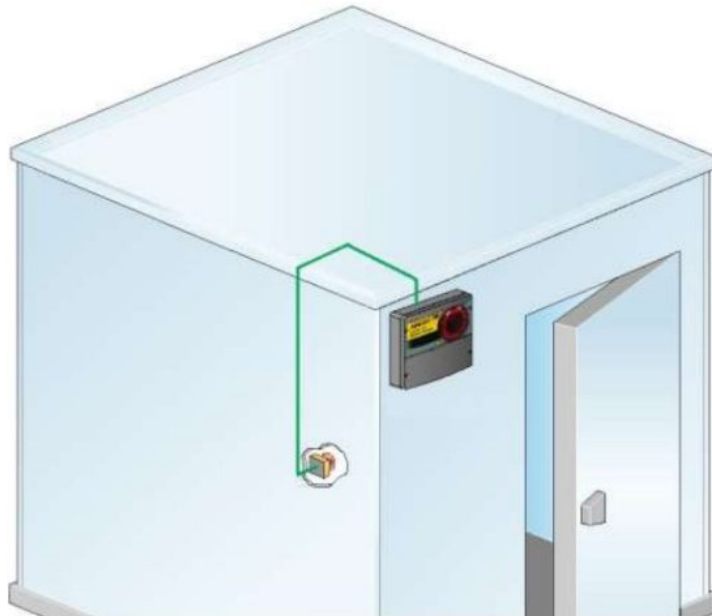

CHAPTER 2: INSTALLATION

2.1 INSTALLING THE OUT-OF-ROOM ALARM CONTROL UNIT

1. Unscrew the 4 locking screws on the front.



2. Use the three existing holes to fix the box back panel to the wall: use three screws of a length suitable for the thickness of the wall to which the panel will be attached. Fit a rubber washer (supplied) between each screw and the box backing.

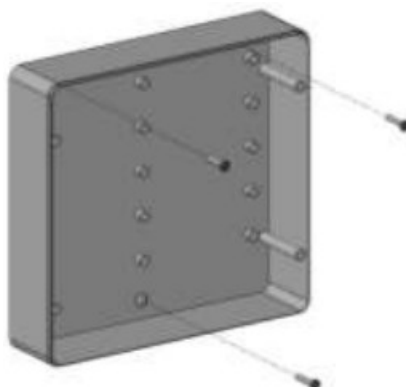

Make all the electrical connections as illustrated in the diagram on chapter 2.5. To effect correct electrical connection and maintain the protection rating, use appropriate wire/raceway grips to ensure a good seal. Route

the wiring inside the unit in as tidy a fashion as possible: be especially careful to keep power wires away from signal wires. Use clips to hold wires in place.

3. Close the front panel, making sure that all the wires are inside the box and that the box seal sits in its seat properly. Tighten the front panel using the 4 screws, making sure the O-rings on the head of each screw are used.



2.2 INSTALLING THE IN-ROOM EMERGENCY PUSHBUTTON

1. The in-room pushbutton must be positioned so that it is always visible and easily reachable.
2. Undo the four closure screws on the front of the pushbutton panel.
3. Using the four internal holes fix the box backing with four screws of a length suitable for the thickness of the wall to which it is to be attached.



2.3 OPERATION AND MAINTENANCE

- Carry out the connections as per the wiring diagram (Chap. 2.5).
- After initial connection it will take 110 hours to fully charge the battery.
- Press the luminous pushbutton installed inside the cold room to activate the acoustic and luminous warning devices on the external alarm control unit. The auxiliary relay contact closes.
- In the event of a 230 V AC power failure the buffer battery will intervene and power the system for the duration indicated on the technical characteristics chart.
- Reset the emergency switch inside the cold room to cancel the alarm.

- Periodically check that the buffer battery is working properly.
- If the battery is replaced make sure it is disposed of properly at an authorised waste collection facility.
- If the alarm is tripped without the pushbutton being pressed check the connection lead and the connections between the pushbutton and external control unit.

SPARE PARTS AND ACCESSORIES:

Buffer battery: 100APEBATT

Emergency pushbutton: 100APEPUL2

2.4 EXPLODED DIAGRAM

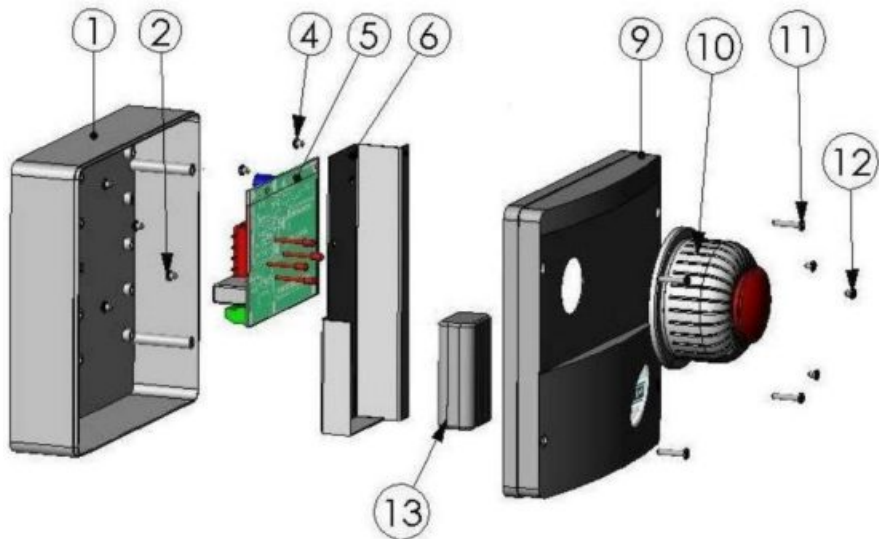

KEY

REF	DESCRIPTION
1	BOX BACKING IN ABS
2	BOARD ATTACHMENT SCREWS
4	BUFFER BATTERY SUPPORT FIXING SCREWS
5	BOARD
6	BUFFER BATTERY SUPPORT METAL SHEETING
9	FRONTAL SECTION IN ABS
10	ACOUSTIC/VISUAL ALARM
11	BOX CLOSURE SCREWS
12	ACOUSTIC/VISUAL ALARM ATTACHMENT SCREWS
13	BUFFER BATTERY

2.5 ELECTRICAL CONNECTIONS

Warning: The positive pole of the battery (Fastom with red wire) is initially disconnected to maintain the charge during product storage.

Once the in-room keypad connections have been made it is, therefore, necessary to connect this fastom to the connector marked (1) on the upper left side of the board as also indicated on the wiring diagram.

It is advisable to first connect the control unit to the relative emergency pushbutton and only then connect up the battery and the mains power. This will prevent activation of the alarm.

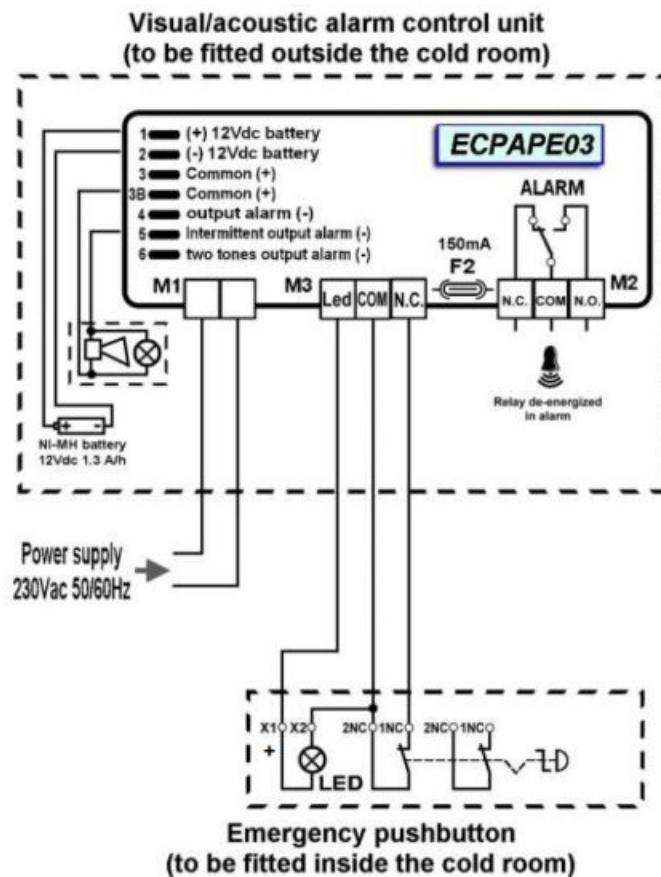

NOTE: The supplied in-room emergency pushbutton unit can alternatively have the lighting LED in two different positions (A or B). See the figure. In both cases the connection diagram remains unchanged.

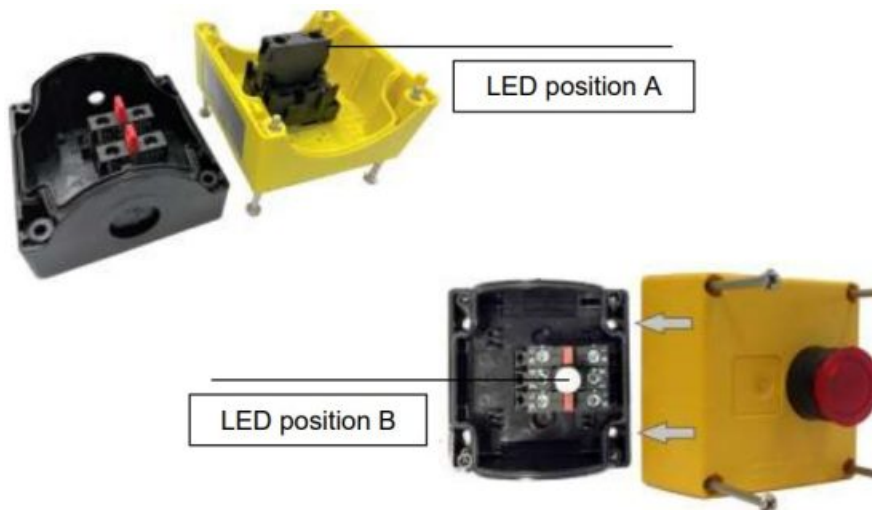

2.6 WARRANTY TERMS

The man in cold room alarm kit is covered by a 24-month warranty against all manufacturing defects as from the date indicated on the product ID code. If the system malfunctions as a result of tampering, impact or improper installation the warranty will automatically be rendered null and void. It is strongly recommended that you observe all instructions/information regarding the technical characteristics of the device.



Any modifications made to wiring and/or internal components or any work carried out in a way that fails to comply with the information/instructions in this manual shall render the warranty null and void immediately.

Modifications/improper work can also cause malfunctions, irreparable damage, serious injury or put persons/objects in danger.



PEGO S.r.l. cannot be held liable for possible errors or inaccuracies written in this manual as a result of printing or transcription errors.

PEGO S.r.l. reserves the right to modify its products as it deems necessary without altering its main characteristics. Each new release of a PEGO user manual replaces previous ones.

APPENDICES

A.1 EU DECLARATION OF CONFORMITY

LA PRESENTE DICHIARAZIONE DI CONFORMITA' E' RILASCIATA SOTTO LA RESPONSABILITA' ESCLUSIVA DEL FABBRICANTE:

THIS DECLARATION OF CONFORMITY IS ISSUED UNDER THE EXCLUSIVE RESPONSIBILITY OF THE MANUFACTURER:

PEGO S.r.l. a socio unico – Via Piacentina 6/b, 45030 Occhiobello (RO) – Italy – Company subject to the management and coordination of Castel S.r.l.

DENOMINATION OF THE PRODUCT IN OBJECT

CODE	ECPAPE03
DESCRIPTION	Man in cold room Alarm

THE PRODUCT IS IN CONFORMITY WITH THE RELEVANT EUROPEAN HARMONIZATION LEGISLATION:

Direttiva Bassa Tensione (LVD):	2014/35/UE
Low voltage directive (LVD):	2014/35/EU
Direttiva EMC:	2014/30/UE
Electromagnetic compatibility (EMC):	2014/30/EU

THE CONFORMITY REQUIRED BY THE DIRECTIVE IS GUARANTEED BY THE FULFILLMENT TO THE FOLLOWING STANDARDS:

European standards: EN 60335-1:2012, EN 378-1:2016, EN 61000-6-1:2007, EN 61000-6-3:2007

THE PRODUCT HAS BEEN MANUFACTURED TO BE INCLUDED IN A MACHINE OR TO BE ASSEMBLED TOGETHER WITH OTHER MACHINERY TO COMPLETE A MACHINE ACCORDING TO DIRECTIVE: EC/2006/42 "Machinery Directive".

Signed for and on behalf of:

Pego S.r.l.
Martino Villa
Presidente



Place and Date of Release: Occhiobello (RO), 01/01/2020

PEGO s.r.l.

Via Piacentina, 6/b 45030 Occhiobello ROVIGO – ITALY

Tel. +39 0425 762906

e-mail: info@pego.it – www.pego.it

AFTER-SALES ASSISTANCE

Tel. +39 0425 762906 e-mail: tecnico@pego.it

Distributor:

PEGO s.r.l. reserves the right to make amendments to this user manual at any moment.

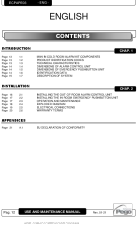

Documents / Resources

	<p>Pego ECP APE 03 Lock in Alarm [pdf] Instruction Manual ECPAPE03, ECP APE 03 Lock in Alarm, ECP APE 03, Lock in Alarm, Alarm</p>
---	--

References

- [User Manual](#)

Manuals+, [Privacy Policy](#)

This website is an independent publication and is neither affiliated with nor endorsed by any of the trademark owners. The "Bluetooth®" word mark and logos are registered trademarks owned by Bluetooth SIG, Inc. The "Wi-Fi®" word mark and logos are registered trademarks owned by the Wi-Fi Alliance. Any use of these marks on this website does not imply any affiliation with or endorsement.