

PEGIANT
HL5K-P1EU
Off Grid Single
Phase Hybrid
Inverter



PEGIANT HL5K-P1EU Off Grid Single Phase Hybrid Inverter Installation Guide

[Home](#) » [PEGIANT](#) » PEGIAN HL5K-P1EU Off Grid Single Phase Hybrid Inverter Installation Guide 

Contents

- [1 PEGIAN HL5K-P1EU Off Grid Single Phase Hybrid Inverter](#)
- [2 Product Information](#)
- [3 Product Usage Instructions](#)
- [4 FAQ](#)
- [5 Select the installation location](#)
- [6 Carry the inverter](#)
- [7 Dimension](#)
- [8 Mounting holes](#)
- [9 Electrical connection operation steps](#)
- [10 Documents / Resources](#)
 - [10.1 References](#)
- [11 Related Posts](#)



PEGIANT HL5K-P1EU Off Grid Single Phase Hybrid Inverter



Product Information

Specifications

- Model: SSA-HL5K-P1EU
- Installation Guide Included
- Mounting Holes for Easy Installation
- Designed for Electrical Connection Operations

Product Usage Instructions

- Locate the mounting holes on the product and align them with the desired installation face. Secure the power strip using suitable screws or mounting hardware.
- To remove the power strip, carefully loosen and remove the screws or mounting hardware holding it in place. Ensure to disconnect any electrical connections before removal.
- Use a suitable tool to tighten the expansion screws securely. This step is crucial to ensure the stability and safety of the installed product.
- Use wire strippers to remove the insulation layer of the cables to a suitable length.
- Utilize crimping pliers to press the cable firmly.
- Connect the cables to the inverter terminals and tighten them using a screwdriver for a secure connection.
- Ensure easy access to cables for maintenance or adjustments as needed. Proper cable management is

essential for efficient operation.

FAQ

- **Q:** How do I ensure a proper cable connection?
- **A:** Follow the provided steps to strip, crimp, and connect the cables securely. Use appropriate tools and ensure tight connections for optimal performance.
- **Q:** What should I do if I encounter difficulties during installation?
- **A:** Refer to the installation guide for troubleshooting tips. Double-check all connections and consult a professional if needed.

Select the installation location

- Choose the appropriate location to install the inverter to ensure that the inverter can work normally and efficiently. The following factors must be taken into account in the selection of the installation location:
- The protection level of the inverter is IP20, and it cannot be used outdoors without protection.
- The ambient temperature should be kept below 45°C to ensure optimal operation and prolong its service life.
- In the living area, do not install the inverter on the gypsum board wall or similar wall with poor sound insulation, so as not to disturb the residents in the living area due to the noise emitted when it is working.
- The inverter should be installed in a well-ventilated environment to ensure good heat dissipation.
- Do not expose the inverter to direct sunlight, rain, and snow.
- The cable connection area must face downward.
- It is recommended to choose an appropriate height for installation to facilitate the observation and operation of the monitoring panel.
- The installation method and location must be suitable for the weight and size of the inverter, please refer to the technical data.
- Please ensure that the wall is firm and meets the load-bearing requirements of the inverter.
- The distance between the inverter and the surrounding objects should meet the following conditions: the distance between the left and right $\geq 200\text{mm}$, the upper distance $\geq 500\text{mm}$, and the lower distance $\geq 500\text{mm}$ to ensure that there is enough space for installation and heat dissipation.

Carry the inverter

- Please remove the inverter from the outer packaging and carry it horizontally to the designated installation position.
- The inverter is heavier, please pay attention to keeping the balance when handling, it so as not to fall and hurt the operator.
- The power cord interface and signal cable interface at the bottom of the inverter cannot bear weight, and the terminal blocks should not be directly touched to the ground. Please place the inverter horizontally.
- When the inverter is placed on the ground, it is necessary to pad foam or paper under it to avoid damage to the shell.

Steps to install the inverter

1. Determine the punching position, level the hole position with a level, and mark it with a marker, size unit: mm.

Dimension

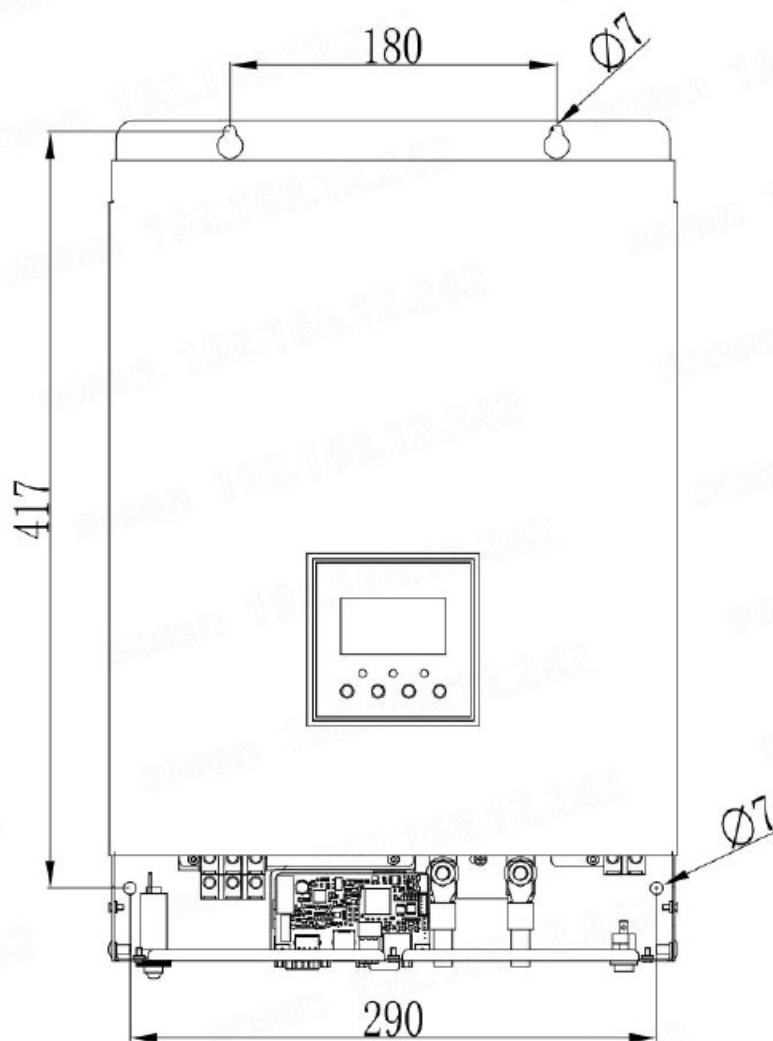

Mounting holes

- Select the drill bit of $\Phi 8$ model, use a percussion drill to punch holes in the vertical wall at the marked hole position, slightly tighten the expansion bolt and hang it into the hole, and beat it with a rubber hammer until the expansion pipe all enters the installation hole.
- Remove the wiring cover plate under the inverter, align the inverter chassis with the hole, and put the expansion bolt through the backplate into the hole, tighten the expansion bolt with a sleeve, and the tightening torque reaches 5N•m.



Remove the power strip



Tighten the expansion screws

Electrical connection operation steps

- Install battery cable BAT+, BATAs shown in the figure below, connect the two cables to the corresponding position of the inverter and lock the flange nut with a tightening torque of $10\text{N}\cdot\text{m}$

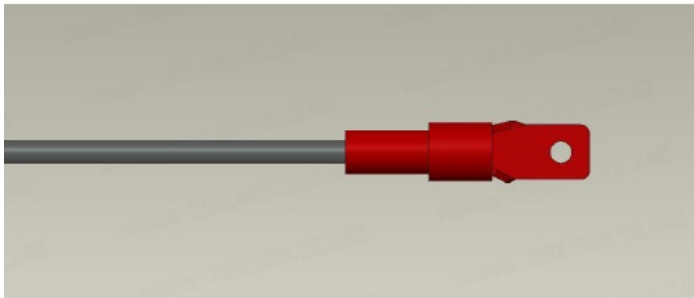

Crimp terminals



Access to BAT+, BAT-

Install PV, mains, and load cables

a. Use wire strippers to strip the insulation layer of the cable to a suitable length.

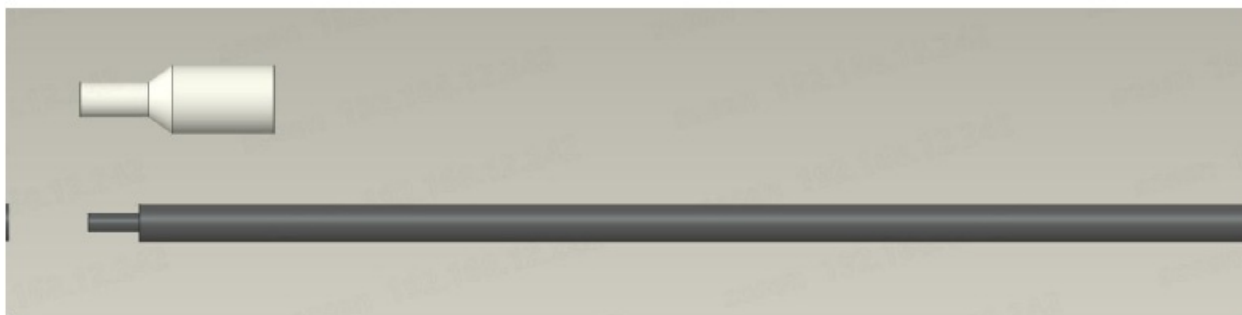

b. Use crimping pliers to press the cable.



c. Connect the cable to the inverter and tighten it with a screwdriver.

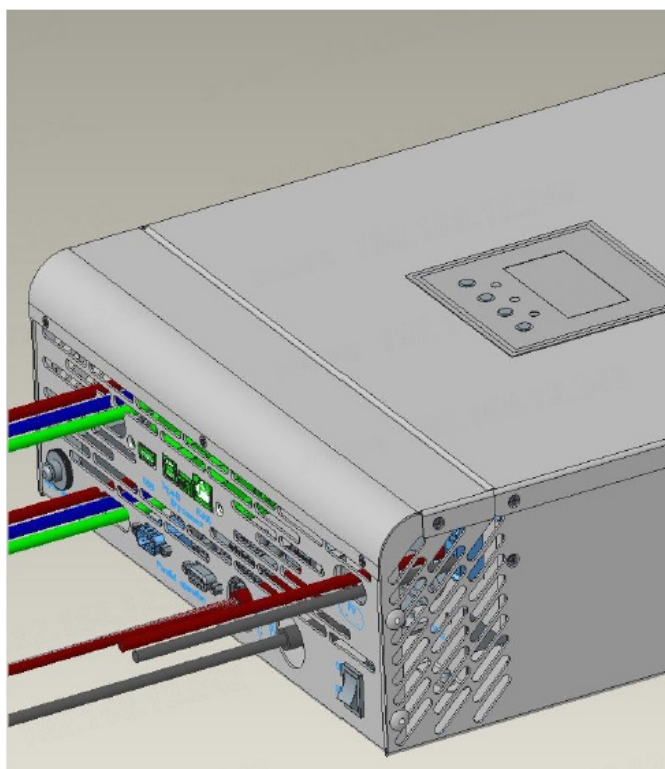
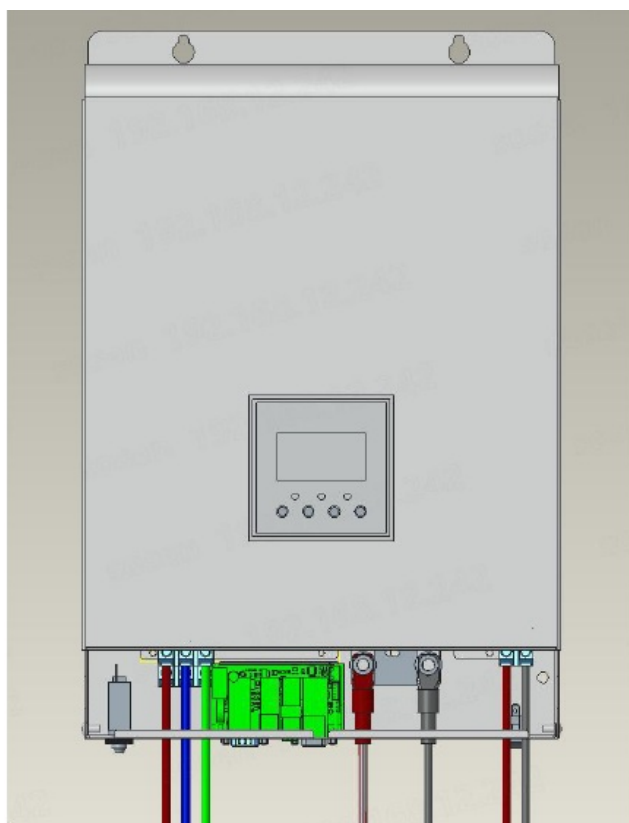

Access cable

Documents / Resources

