

**Peg Perego
IGOR0039 Ground
Force Tractor**



Peg Perego IGOR0039 Ground Force Tractor User Manual

[Home](#) » [Peg Perego](#) » Peg Perego IGOR0039 Ground Force Tractor User Manual 

Contents

- [1 Peg Perego IGOR0039 Ground Force Tractor](#)
- [2 Introduction](#)
- [3 Specifications](#)
- [4 Features](#)
- [5 INITIAL BATTERY CHARGE](#)
- [6 ASSEMBLY INSTRUCTIONS](#)
- [7 WIRING DIAGRAM](#)
- [8 REPLACEMENT PARTS](#)
- [9 IMPORTANT INFORMATION](#)
- [10 PACKAGE Contents](#)
- [11 BATTERY MAINTENANCE AND SAFETY](#)
- [12 VEHICLE MAINTENANCE AND SAFETY](#)
- [13 Troubleshooting](#)
- [14 FCC STATEMENT](#)
- [15 FAQs](#)
- [16 Video-Peg Perego IGOR0039 Ground Force Tractor](#)
- [17 References](#)
- [18 Related Posts](#)



Peg Perego IGOR0039 Ground Force Tractor



Launch Date: January 2013

Price: \$279.99

Introduction

The Peg Perego IGOR0039 Ground Force Tractor is a top battery-operated ride-on toy designed to give kids a thrilling outdoor experience. The sturdy design and utilitarian qualities of this farm tractor make it an intriguing choice for young adventurers. This tractor, powered by a 12-volt rechargeable battery, has two forward and one backward speed for novice and experienced young drivers. It has a huge, detachable trailer for toys and other treasures, a built-in FM radio, and an adjustable seat with armrests for comfort. The foot accelerator controls speed smoothly, and automated brakes are safe. Its all-terrain wheels easily handle grass, dirt, gravel, and concrete. This ride-on tractor can hold up to 85 lbs and provide hours of outdoor fun and imaginative play for kids aged 3 to 7.

Specifications

- **Item Weight:** 50 pounds
- **Weight Capacity:** Up to 85 lbs
- **Speed:**
 - 2 forward speeds (2.5 and 4.5 mph)
 - 1 reverse speed
- **Batteries:** 1 12V battery required (included)
- **Item Model Number:** IGOR0039
- **Item Weight:** 50 pounds

Features

- **Realistic Design:** The Peg Perego IGOR0039 Ground Force Tractor boasts an authentic tractor appearance, meticulously crafted to mimic a real farm tractor. This realistic design enhances the imaginative play experience for children, making them feel like they are driving a real tractor.
- **Adjustable Seat:** The seat of the Peg Perego IGOR0039 Ground Force Tractor is adjustable, allowing it to accommodate children as they grow. It also features flip-up armrests for added comfort and support during rides.
- **FM Radio:** For added entertainment, the Peg Perego IGOR0039 Ground Force Tractor includes a built-in FM radio. This feature allows children to enjoy music or listen to their favorite radio stations while driving, making their playtime more enjoyable.
- **Detachable Trailer:** The tractor comes with a large, detachable trailer that can be used to haul toys, tools, or other items. This feature not only adds to the fun but also provides practical utility, allowing children to transport their belongings easily.
- **Speed Options:** The Peg Perego IGOR0039 Ground Force Tractor offers two forward speeds (2.25 mph and 4.5 mph) and one reverse speed. The higher speed (4.5 mph) can be locked out for beginners, ensuring safety for younger or less experienced drivers.
- **Pedal Accelerator:** The tractor is equipped with a foot pedal accelerator, which provides easy speed control. Children can press the pedal to move forward or backward and release it to stop.

INITIAL BATTERY CHARGE

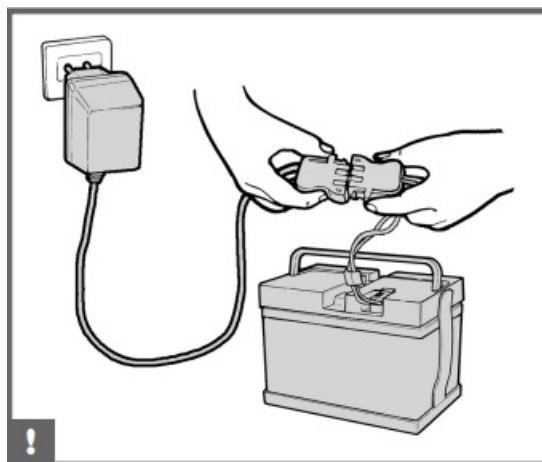

Connect the battery charger to a 120vac wall receptacle. Connect the battery charger to the battery

ASSEMBLY INSTRUCTIONS

ADULT ASSEMBLY REQUIRED. USE CARE WHEN UNPACKING AS COMPONENTS TO BE ASSEMBLED MAY POSE A SMALL PARTS/SHARP EDGE HAZARD.
IF THE PRODUCT IS DAMAGED WHEN YOU OPEN THE PACKAGING, CONTACT THE SERVICE CENTER AND DO NOT USE THE PRODUCT.
BATTERY IS INCLUDED AND MUST BE CONNECTED.

- 1-2 • Turn the tractor upside down, and remove the trailer chassis from the underside of the tractor chassis by removing the screw.
- 3 • Insert washer washer-shaped retainer into the retainer installation tool with the finished side facing up.

ATTENTION: the tabs on the self-locking washer must be turned towards the interior of the tool (see detail A).

- 4 •Place one end of the trailer axle into the retainer installation tool and pound the axle into the tool (and retainer) until fully seated.
- 5 •Insert white bushing into the inside of each trailer wheel as shown.
- 6 •Install the following components onto the axle;

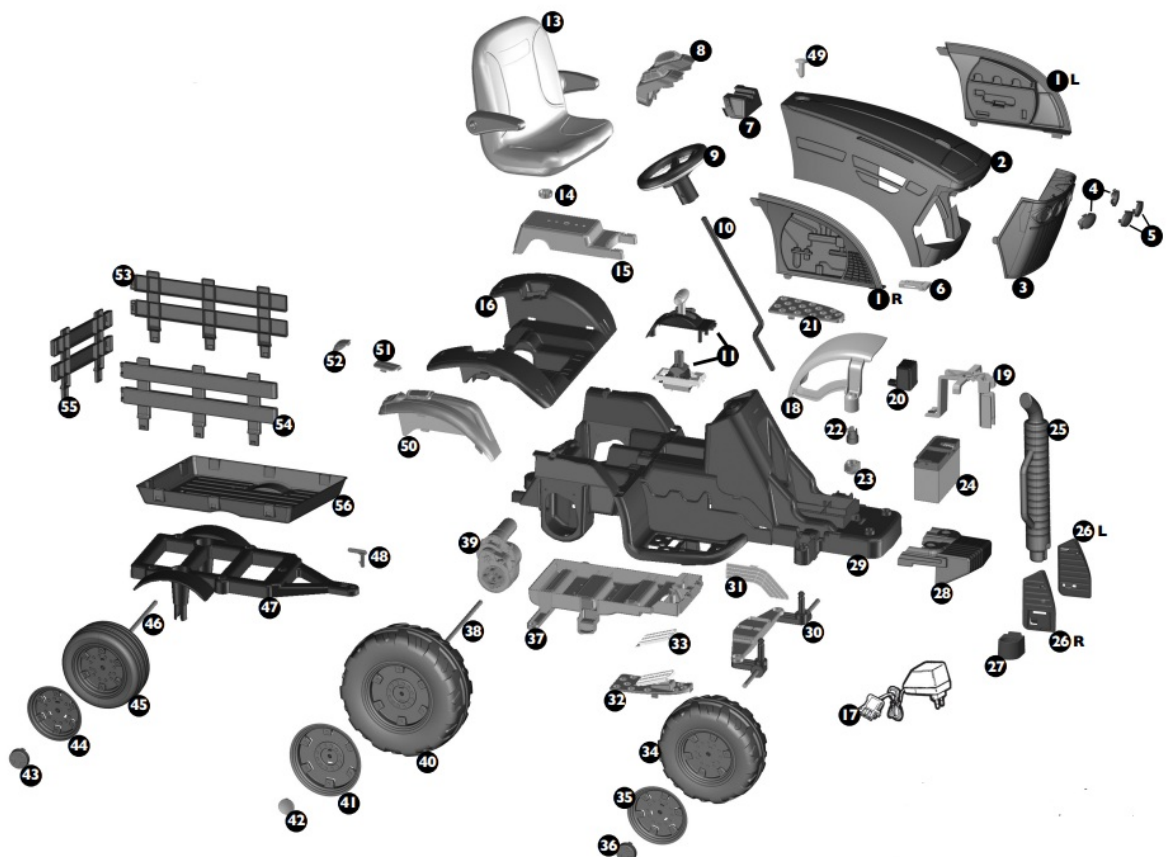
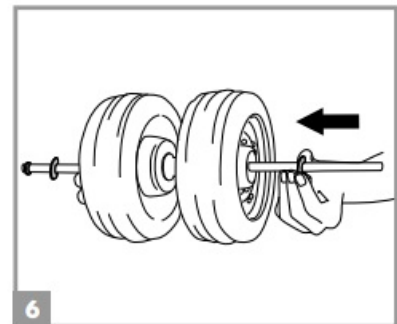
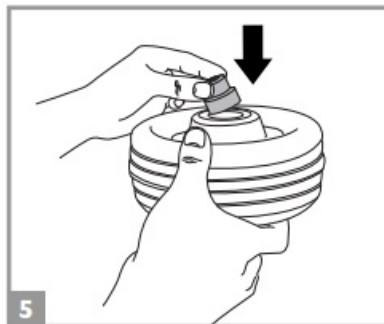
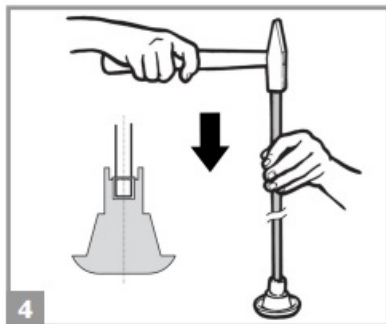
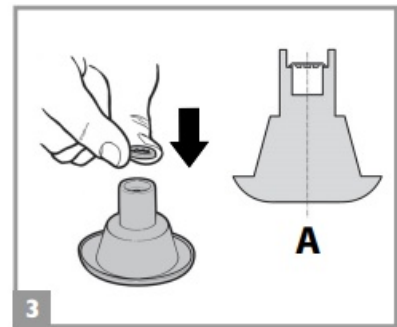
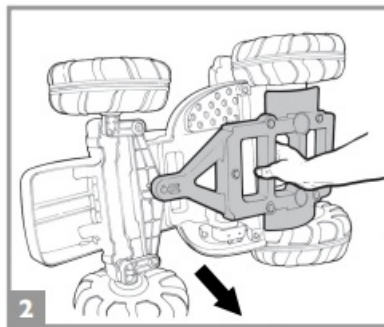
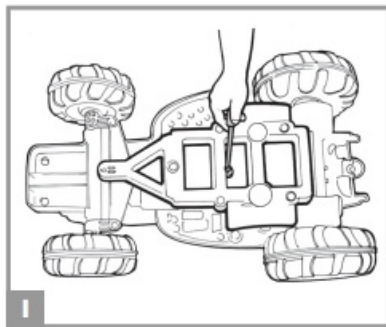

- washer
- wheel (hubcap facing down)
- 3) 2nd wheel (hubcap facing up) 4) washer.

ATTENTION: Check to make sure that the wheels have been inserted correctly on the axle. The hubcaps must

be facing away from the toy.

- 7 •Place retainer into installation tool, place tool onto the upper end of axle, and pound until seated. Remove tool.
- 8 •Place wheel & axle assembly onto trailer chassis with washers outside of posts and press down until axle is firmly seated into chassis.
- 9 •Insert the red pin into trailer chassis tongue.
- 10 •Remove the 5 protective caps from the bottom of the trailer.
- 11 •Assemble yellow trailer sides with finished sides facing out.
- 12 •Place trailer sides firmly into stake pockets in the trailer bed

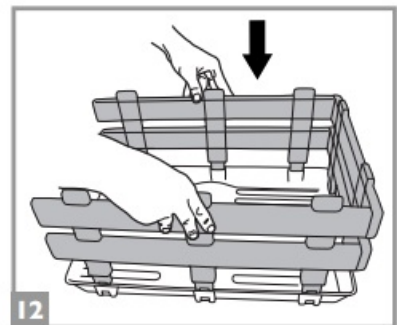
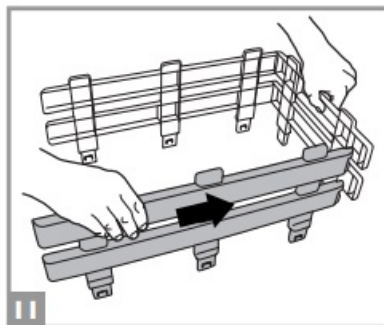
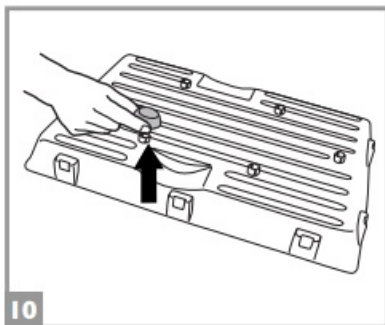
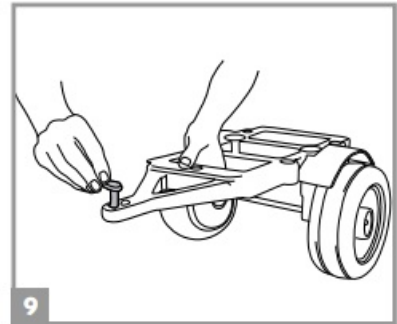
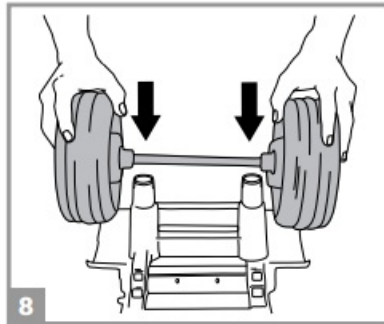
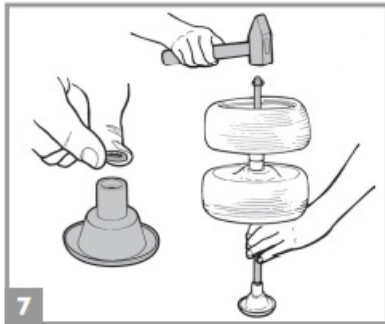

- 13 •Turn the trailer bed upside down, place the trailer chassis onto the bed, align the 5 pegs in the green bed with the 5 holes in the black chassis and very firmly press or pound pegs into the holes with a hammer until firmly seated.
- 14 •Place the green counterweight on the black chassis; chassis pegs will pass through holes in the counterweight. Press the lower sides of the counterweight into the chassis to latch.
- 15 •Secure with 2 screws.
- 16 •Remove the installed screw. Position the hood by inserting the hinge into the hinge receiver slots of the chassis (1). Then secure the hinge with a screw (2). Close the hood and use a coin to lock the safety catch (3).
- 17 •Press the 2 identical central headlights into place paying attention to the 3 respective slots.
- 18 •Proceed to mount the remaining 2 side headlights. Caution! The 2 headlights are not identical: check the direction of insertion into the slots.

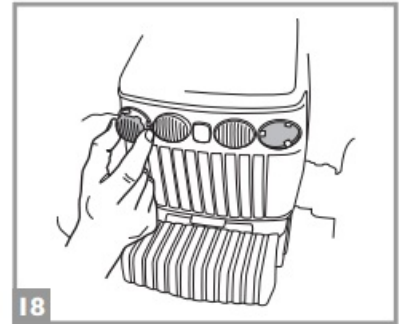
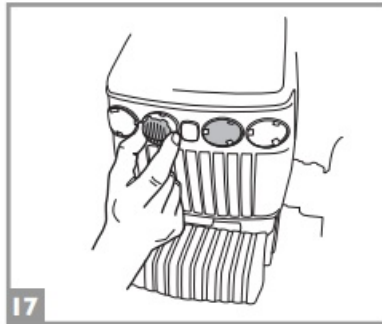
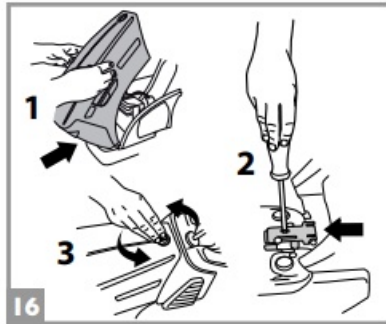
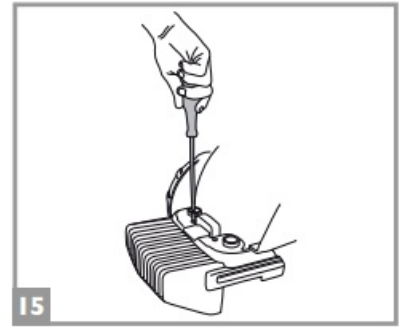
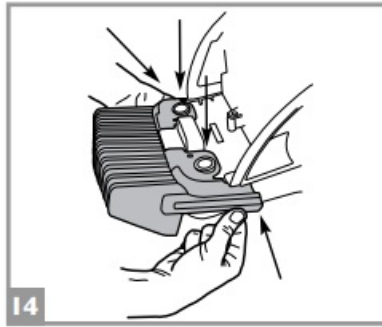
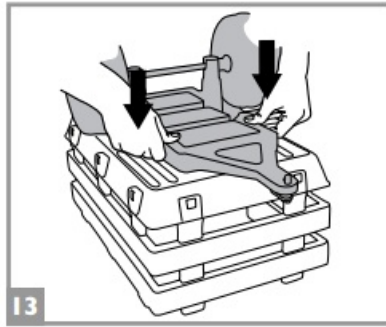

- 19 •Press the side inserts into place on the body.
- 20 •Unscrew the knobs on the bottom of the seat.
- 21 •Place seat bolts into green seat support holes.
- 22 •The seat can be adjusted to 2 positions to suit the height of the child (see figure).
- 23 •After adjusting the seat, tighten the 2 knobs that hold it in place.
- 24 •Insert front green seat support fingers into the chassis.

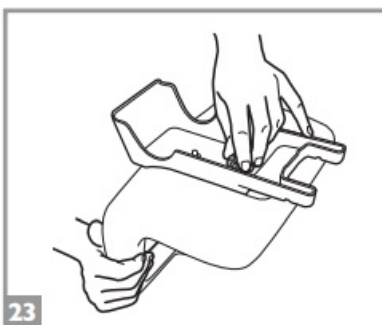
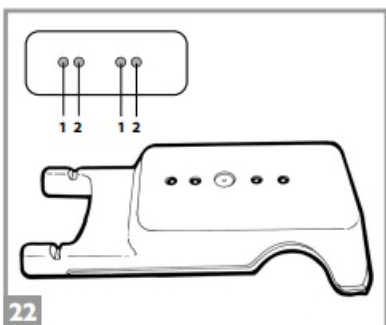
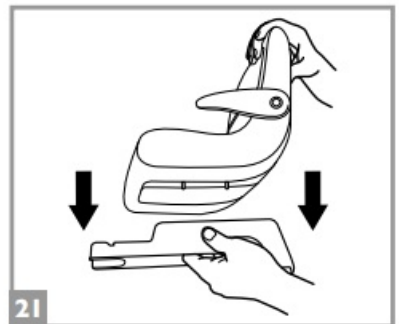
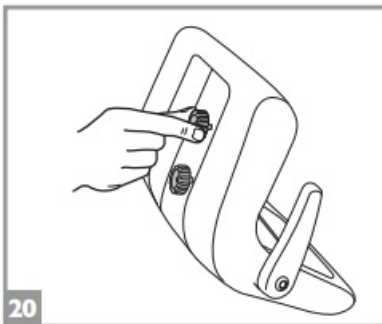
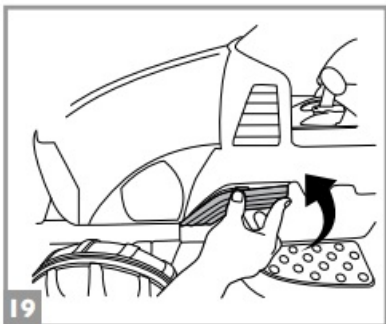

- 25 •Rotate support (and seat) down onto the chassis at the rear. Turn tractor chassis upside down and secure support to chassis with 2 screws.
- 26 •Apply the chrome decals to the taillight positions as shown in the figure.
- 27 •Attach the taillight lenses by pressing from the bottom upwards.

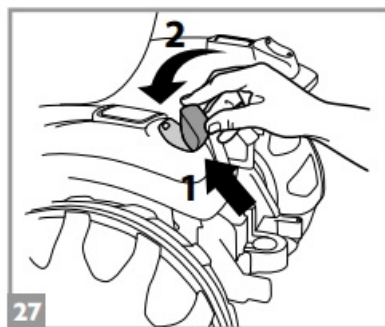
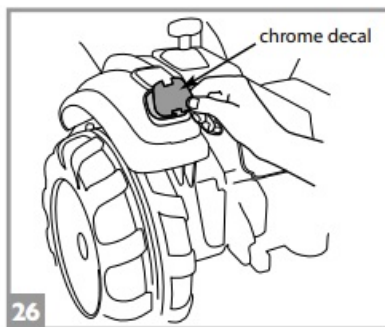
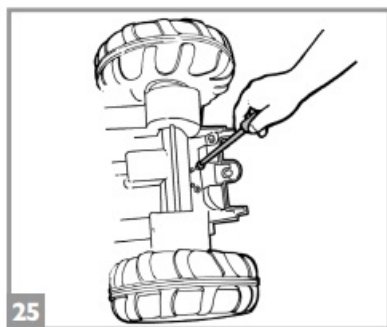

- 28 •Install left & right black plastic covers into “C” slots on each rear fender.
- 29 •Install 2 AA batteries in FM radio (through door on back side)
- 30 •Attach radio to tractor; insert 2 fingers on radio into the slots in the chassis beneath the steering column. Secure with a screw.
- 31 •Press the trim piece into place under the steering wheel.
- 32 •Install steering wheel; reach under tractor
- to find metal steering column tube. Push it upward as far as possible and hold it.
- 33 •Place steering wheel onto tube, align bolt holes.

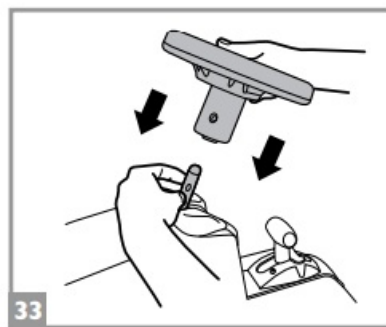
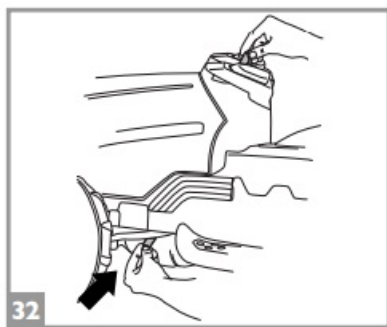
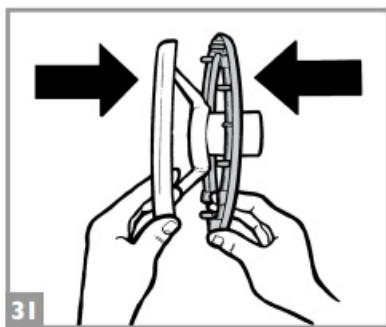
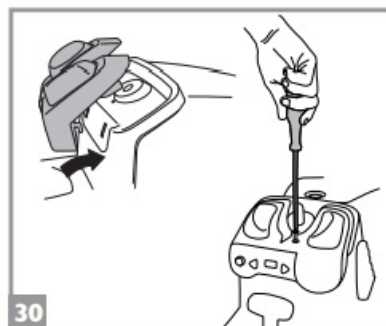
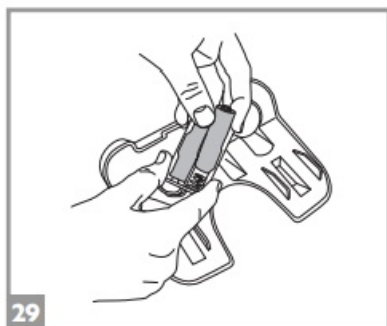

- 34 •Install bolt and nut. Tighten.
- 35/6 •Place exhaust stack into bracket and secure with long screw.
- 37 •Attach the trailer to the tractor as follows: insert the trailer coupling into the opening on the back of the tractor, and rotate it (see fig. 38).

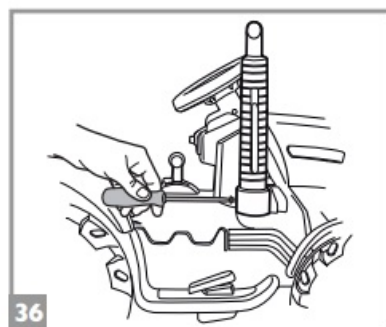
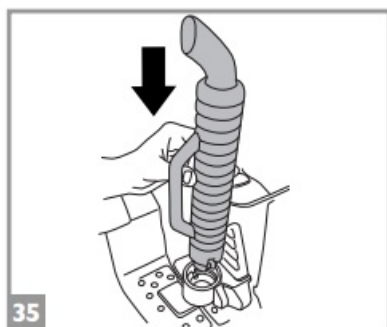

- 38 •Position 1: the trailer can be removed. Position 2: the trailer is locked into place.

WARNING: The trailer will hold a load weighing up to 10 kg/22 lbs.

VEHICLE FEATURES AND INSTRUCTIONS FOR USE

- 39 •GEAR SHIFT LEVER. This vehicle has 2 speeds + reverse, with PARENTAL CONTROL: When produced, IT IS RESTRICTED TO SLOW SPEED and REVERSE ONLY (For safety, shifter must be held in reverse to back up).
- 40 •TO ACCESS HIGH SPEED (see red bar beneath shift lever) remove the screw, rotate the red bar 90 degrees counterclockwise and replace screw.
- 41 •3 position accelerator; 1) up = off/brake 2) ½ down = coast. 3) run

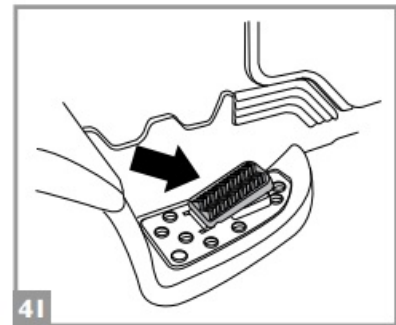
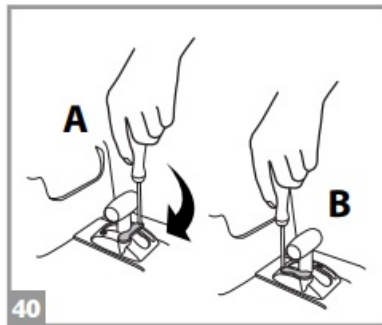
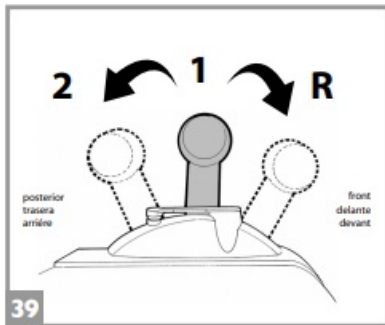
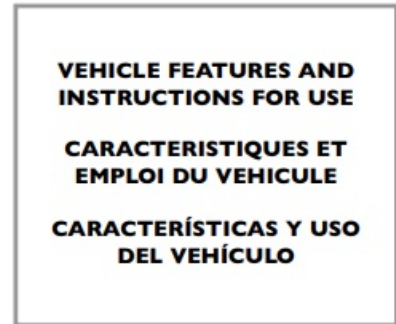
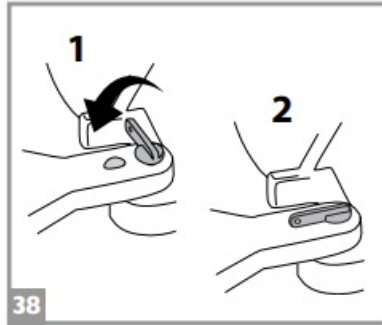
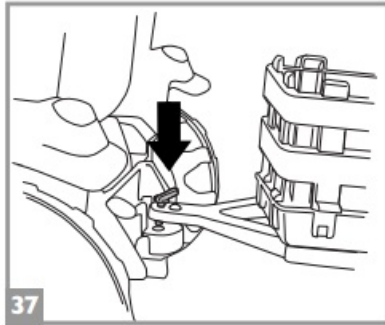

- 42 •FM RADIO. To switch on, switch off and adjust volume, turn the A button. To select the frequency, press the 2 triangle buttons.

BATTERY RECHARGE

WARNING: BATTERY CHARGING AND ANY OTHER OPERATION ON THE ELECTRICAL SYSTEM MUST BE CARRIED OUT BY ADULTS ONLY. THE BATTERY CAN ALSO BE CHARGED WITHOUT REMOVING IT FROM THE VEHICLE.

- 43 •Install Battery: Open the hood by turning black latch with 90 degrees with a coin. Rotate hood forward to open.
- 44 •Insert the battery charger plug into an electrical outlet. Connect point B to point C on the battery charger. When the battery has been completely recharged, disconnect the battery charger from the electrical outlet, and disconnect point C from point B.
- 45 •Insert point B into point A, pressing until it clicks into place. Replace the battery brace. Always remember to close and fasten the hood on the battery compartment when you have finished working on the battery.

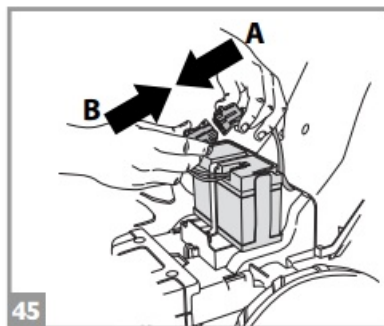
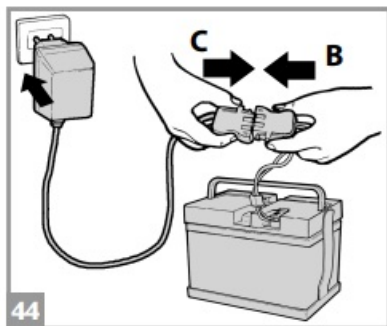
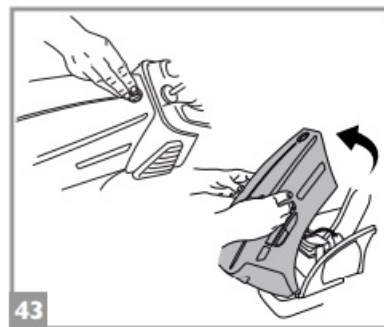
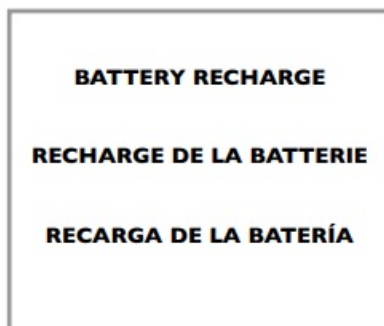
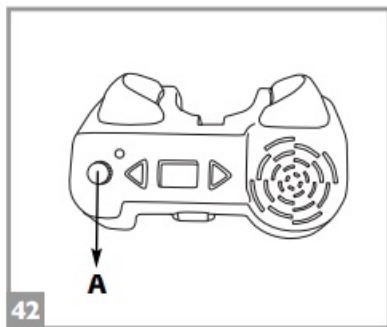

BATTERY REPLACEMENT

- 46 •Open the hood, as described above. Disconnect the battery from the electrical system by squeezing the sides of the plugs.
- 47 •Loosen the 2 screws on the battery brace, as shown in the figure.
- 48 •Remove the battery.
- 49 •Remove the battery clamp from the dead battery.

INSTALLING BATTERY

- 50 •If you have bought or own a Peg Perego 12V/12Ah battery, you will have to remove the plastic filler (A) by slipping it off the battery clamp.

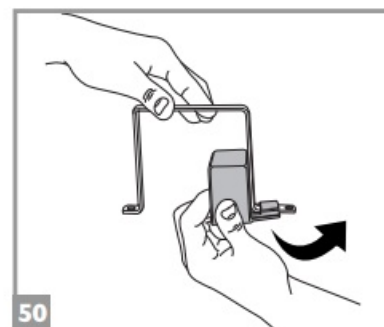
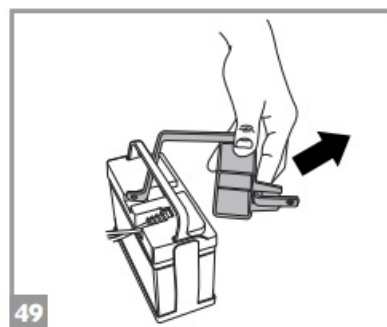
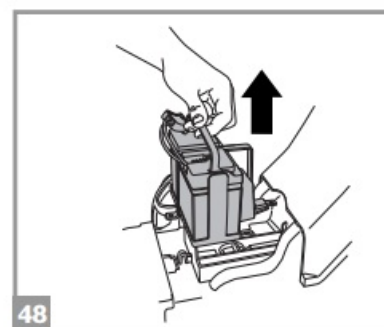
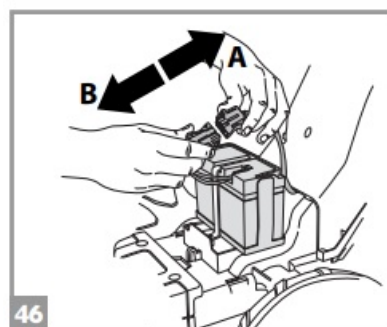

- 51 •Reposition the new battery with the battery clamp in its housing. Fasten the clamp with the two screws.
- 52 •Connect the battery plug to the electrical system.
- 53 •Close again the cab by repositioning the hook, as done above.

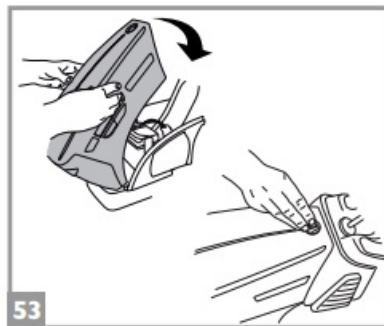
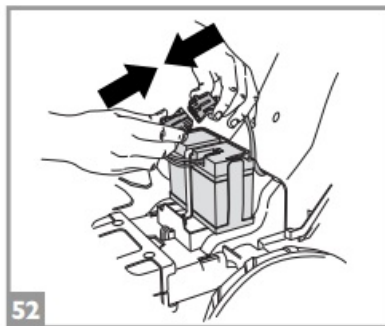
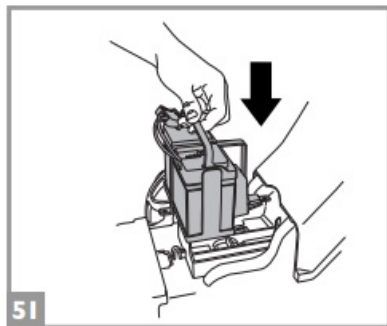

WIRING DIAGRAM

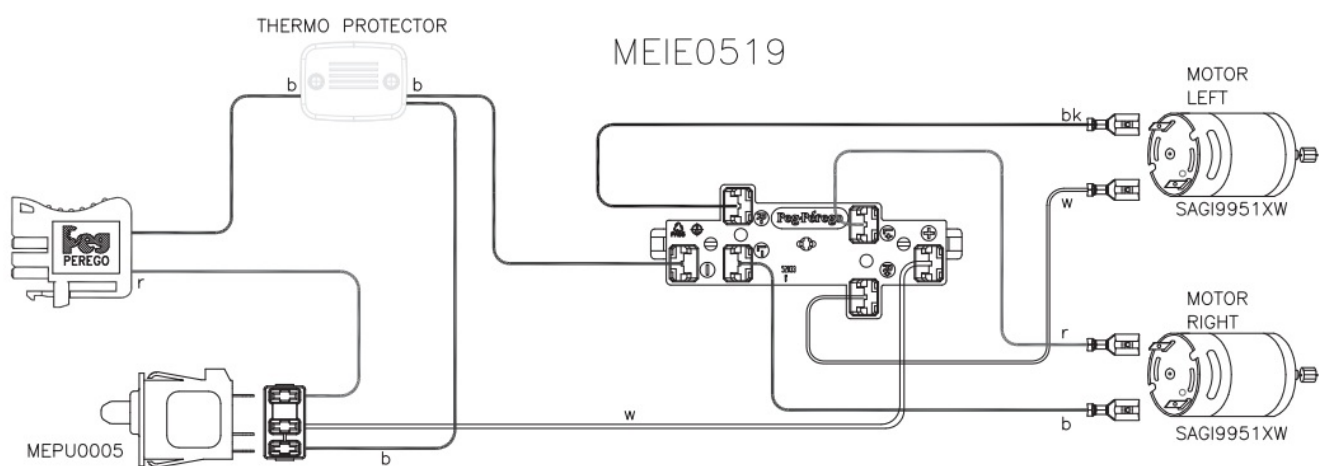

REPLACEMENT PARTS

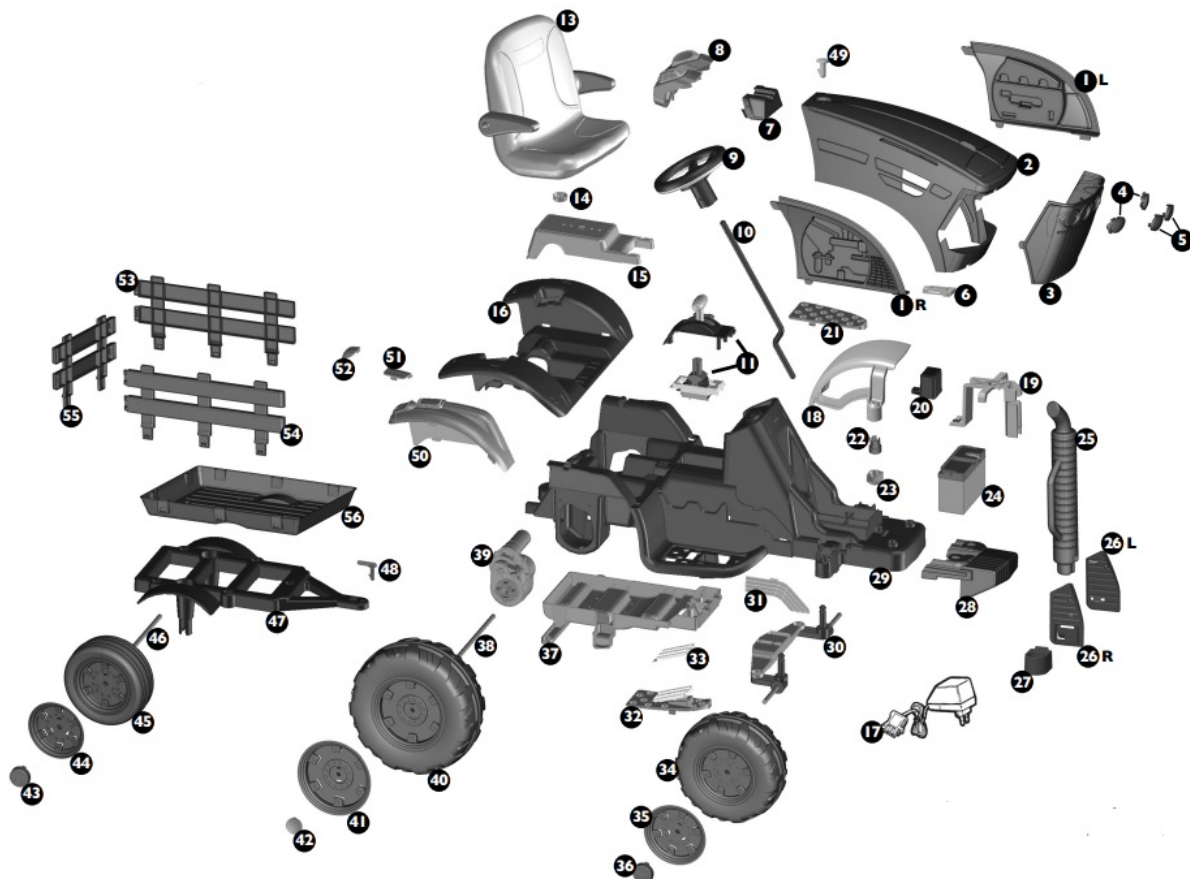

PEG PEREGO® thanks you for choosing this product. For more than 60 years, PEG PEREGO have been taking children for an outing: first with its famous baby carriages and strollers, later with its pedal and battery-operated toy vehicles.

Discover our complete range of products, news and other information about the Peg Perego world on our website www.pegperego.com

IMPORTANT INFORMATION

- Read this instruction manual carefully to learn the use of the vehicle and to teach your child safe and enjoyable driving. Please keep this manual (with your original sales receipt) for use as a reference in the future.
- DO NOT RETURN YOUR VEHICLE TO THE STORE. This product cannot be returned for a refund after it has been used. If you have any questions, need replacement parts or need assistance, call us toll-free; U.S.A. , call 1-800-728-2108 / CANADA, call 1-800-661- 5050
- This product meets and/or exceeds all ASTM (American Society for Testing and Materials) TOY SAFETY STANDARDS, including F 963, Consumer Toy Safety Specifications as well as C.R.C, c.931, the Canadian Hazardous Products (Toys) Regulations.
- If you give away the product to third parties, make sure that it is accompanied by the instruction manual.
- Tools needed for assembly: Phillips screwdriver medium, pliers and a hammer (not included)
- Your new vehicle is partially pre-assembled. It will require adult assembly. Please set aside at 45 minutes for assembly.
- Before the vehicle is used for the first time, charge the battery for 18 hours to initiate it. Failure to do this can result in permanent battery damage.
- Use only the included Peg Perego 12 Volt lead-acid, rechargeable battery and a Peg Perego 12 Volt Charger

(both included).

- **Year 3+**
- **Weight capacity 85 lbs**
- Do not exceed the maximum total weight capacity of 85 lbs (38,6 kg).

PACKAGE Contents

- 1 John Deere Ground Force riding vehicle — partially assembled
- 1 Rechargeable 12V 8Ah sealed lead-acid battery
- 1 Charger 12V
- two 165 W motors — pre installed
- assembly hardware
- parts to be assembled decals

Speed

- Speed in 1st gear 21/4 MPH
- Speed in 2nd gear 41/2 MPH
- Speed in reverse gear 21/4 MPH

To prevent damaging the motor and gears, teach your child to stop the vehicle before switching directions. Use this vehicle **ONLY** outdoors. Most interior flooring can be damaged by riding this vehicle indoors. Peg Perego will not be responsible for damage to the floor if the vehicle is used indoors. Peg Perego reserves the right to modify or change its products. Price, literature, manufacturing processes or locations or any combination of the above mentioned entities may change at any time for any reason without notice with impunity.

CAUTION:

ELECTRIC VEHICLES ARE NOT RECOMMENDED FOR CHILDREN UNDER 3 YEARS OF AGE. AS WITH ALL ELECTRIC PRODUCTS, PRECAUTIONS SHOULD BE OBSERVED DURING HANDLING AND USE TO PREVENT ELECTRIC SHOCK. RECHARGER INCLUDED. 120Vac 60Hz 16W INPUT – 12Vdc 12W OUTPUT

BATTERY MAINTENANCE AND SAFETY

CAUTION:

- Only adults should recharge batteries never children.
- Never allow children to handle batteries.
- Only use the batteries specified by the manufacturer. Only use the charger specified by the manufacturer. Do not mix old and new batteries.
- Do not mix alkaline, standard (carbon-zinc), or rechargeable (nickel-cadmium) batteries.

CHARGING THE BATTERY

- Charge the batteries no longer than 24 hours, following the instructions enclosed with the battery charger.
- Charge the battery, as the vehicle shows low power, in this way you will avoid damage to the battery.
- If you don't use your vehicle for a long period of time unplug the battery from the main wire harness of the

vehicle. Remember to charge the battery at least every three months.

- Never charge the battery upside down.
- Do not forget batteries during charging! Check them periodically.
- Never use a replacement recharger or batteries unless they are approved by PEG PEREGO.
- Batteries are sealed and maintenance free.
- Battery polarity must be observed when connecting battery to wiring.

WARNING:

- BATTERIES CONTAIN TOXIC AND CORROSIVE SUBSTANCES. DO NOT TAMPER WITH THEM.
- Batteries contain an acid-based electrolyte.
- Do not make direct contact between battery terminals, as this can cause an explosion or fire.
- Charging produces explosive gases. Charge batteries in a well ventilated area away from sources of heat and flammable materials.
- Exhausted batteries are to be removed from the vehicle.
- Do not place the batteries near clothing to avoid damage.

IF A LEAK DEVELOPS

- Shield your eyes. Avoid direct contact with the electrolyte, protect your hands.
- Place battery in a plastic bag and follow directions listed below.

IF ELECTROLYTE COMES IN CONTACT WITH SKIN OR CLOTHING

- Flush with cool water for at least 15 minutes.
- See a physician at once.

IF ELECTROLYTE IS INJECTED

- Give tap water, milk of magnesia or egg whites at once.
- Do not induce vomiting.
- See a physician at once.

DISPOSAL OF BATTERIES;

CONTAINS SEALED LEAD ACID BATTERY. BATTERY MUST BE RECYCLED.

- Help protect the environment!
- Do not throw used batteries in your regular, household trash.
- Dispose old batteries at an approved battery dumping station; contact your local Environmental Protection Agency office or call Peg Perego Customer Service for additional information.

CAUTION AA BATTERIES

The insertion of batteries must only be carried out or supervised by adults. Do not let children play with the batteries.

- The batteries should be replaced by an adult.
- Use only the type of battery specified by the manufacturer.
- Respect the polarity +/-
- Do not allow the batteries to be in contact with metal parts (risk of fire or explosion).
- Always remove the batteries if the toy is not in use for a long period.
- Never attempt to charge batteries that are not rechargeable.
- Remove dead batteries from the toy.
- Dispose of dead batteries into appropriate containers provided for their recycling.

RULES FOR SAFETY DRIVING

DON'T STOP THE FUN: purchase a spare battery to have a freshly charged back-up available. For your child's safety: please read and follow all instructions below before operating.

- **ATTENTION:**

Check the fastening retainers to be sure they are tight.

- **1st SPEED slow speed (beginner drivers):**

With both hands on the steering wheel press down on the accelerator pedal; the vehicle goes forward at 21/4 mph.

- **2nd SPEED: fast speed (experienced drivers):**

With both hands on the steering wheel press down on the accelerator pedal; the vehicle goes forward at 41/2 mph.

- **REVERSE:**

Place the left hand on steering wheel. With the right hand holding the gearshift in reverse, press your foot down on the accelerator; the vehicle reverses at 21/4 mph. (Reverse is spring-loaded for safety).

- **BRAKE:**

The electric braking system stops the vehicle automatically when your child lifts his foot off the pedal.

Teach your child the proper use of this vehicle for a safe and fun playtime.

- Before starting be sure that the way is free from people and objects.
- Drive with both hands on the steering wheel and keep your eyes on the road at all times.
- Stop in time to avoid accidents and immediately release pedal when stuck.
- Use the 2nd speed only after your child has the maturity and the reflexes to operate the vehicle safely.

CAUTION:

If the vehicle is overloaded, as can happen on soft sand, mud, or very uneven ground, the overload switch will immediately disconnect the power. The power supply will be restored after a few seconds.

VEHICLE MAINTENANCE AND SAFETY

This product meets and/or exceeds all ASTM (American Society for Testing and Materials) TOY SAFETY STANDARDS, including F 963, Consumer Toy Safety Specification.

This vehicle is not intended for use on streets, around traffic or parked cars.

MAINTENANCE AND CARE

- Do not try to repair the vehicle by yourself.
- Regularly check the conditions of the vehicle, particularly the electrical system, the plug connections, the covering caps and the charger. In case of fault, do not try to use the vehicle and the charger. For repair use only original PEG PEREGO's spare parts.
- PEG PEREGO assumes no liability if the electrical system is tampered with.
- Take care with the battery charger cable. For example, do not pull it to remove the plug, do not pull the vehicle along on its wheels using the cable, do not cover the cable because it may overheat, do not leave it on hot surfaces and be careful about where and how you roll it up.
- Do not leave vehicle or batteries near sources of heat such as radiators, stoves, fireplaces, etc.
- Protect vehicle from water, rain, snow, etc.
- When operating in overload conditions, such as soft deep sand, mud or rough uneven terrain, the overload circuit breaker will automatically disconnect the power. After 30 or more seconds, the circuit breaker will automatically reset, however you must eliminate overload conditions to resume normal driving.
- Periodically lubricate (with a light weight oil) moving parts, such as wheel bearings, steering linkages, where they rotate or touch one another.
- The vehicle's surfaces can be cleaned with a damp cloth. Do not use abrasive cleaners. The cleaning must be carried out by adults only.
- Never disassemble the vehicle mechanisms or motor unless authorized by PEG PEREGO.

SAFETY

- To reduce the risk of injury, adult supervision is required. Never use in roadways, near motor vehicles, on or near steep inclines or steps, swimming pools or other bodies of water; always wear shoes, and never allow more than one rider.
- Surfaces that are appropriate for use: grass, dirt or hard surfaces with slopes not to exceed 10%.
- A child must be 3 years of age or older for the necessary coordination and maturation to operate this motorized vehicle safely.
- Never use the vehicle on steep slopes or near steps or stairs. This vehicle is not suitable for use on public highways.
- Children should always wear shoes when riding in or driving a riding vehicle.
- Do not allow children to place their hands, feet or any part of their body, clothing or other articles near the moving parts while vehicle is in operation.
- Do not allow the electrical components, motors, wiring, or switches of your motorized vehicle to become wet and never wash it with a hose.
- The vehicle is designed just for one child: never allow more than one rider.
- NEVER STORE GASOLINE OR ANY FLAMMABLE SUBSTANCE WHERE A CHILD CAN ACCESS IT. CHILDREN MAY WANT TO SIMULATE ADULTS BY POURING GASOLINE ON VEHICLE. NEVER ALLOW GASOLINE OR ANY FLAMMABLE SUBSTANCE TO BE NEAR A BATTERY-POWERED CHILDREN'S VEHICLE WHEN IT IS BEING RIDDEN.

PROBLEMS?

- When operating in overload conditions, such as running the vehicle against a fixed object, through soft deep sand or mud, or over rough or uneven terrain, the overload circuit breaker will automatically disconnect the power. After 10 or more seconds, the circuit breaker will automatically reset, however-you must eliminate overload conditions to resume normal driving.
- Check that all plugs are properly connected.
- Check electrical switches. Replace if necessary.
- Check that the battery is connected to the electrical system.

IF THERE IS NO POWER?

Fully recharge the battery. If the problem persist, check with an Authorised PEG PEREGO Service Center.

Troubleshooting

Issue	Possible Cause	Solution
Tractor Not Moving	Battery not fully charged	Ensure the battery is fully charged and properly connected.
	Gear shift in the incorrect position	Verify the gear shift is in the correct position for movement.
	Pedal accelerator obstructed	Check that the pedal accelerator is free from obstructions.
	Loose or disconnected wires	Inspect wiring connections and secure any loose wires.
Battery Not Charging	Charger not plugged in properly	Ensure the charger is plugged into a working outlet.
	Poor connection between battery and charger	Check and secure the connections between the battery and the charger.
	Damaged battery or charger	Inspect the battery and charger for damage; replace if necessary.
FM Radio Not Working	Radio not turned on or volume too low	Make sure the radio is turned on and the volume is turned up.
	Poor antenna positioning	Extend and properly position the antenna.
	Dead batteries in the radio	Replace the batteries in the radio.
Trailer Detachment	The trailer not properly attached	Ensure the trailer is correctly and securely attached before use.
	Damaged attachment mechanism	Inspect the attachment mechanism for damage; repair or replace as needed.
Slow Movement	Low battery charge	Recharge the battery fully.
	Excessive weight load	Ensure the load does not exceed the tractor's weight capacity.
Poor Performance	Dirt or debris in moving parts	Clean the tractor's moving parts to remove any dirt or debris.
	Worn tires or mechanical parts	Inspect tires and mechanical parts; replace any worn components.

CUSTOMER SERVICE

For your convenience, PEG PEREGO offers after-sales service, directly or through a network of authorized service centers for repairs or replacement parts.

If you have any questions about your Peg Perego vehicle, please call our toll-free service lines at;

- U.S.A , call 1-[800-728-2108](tel:800-728-2108)
- CANADA, call 1-[800-661-5050](tel:800-661-5050)

Trained customer service representatives are available to take your call in English or Spanish.

FCC STATEMENT

(United States Only)

In reference to the radio:

This equipment has been tested and found to comply with the limits for a Class B digital device, pursuant to Part 15 of the FCC Rules. These limits are designed to provide reasonable protection against harmful interference in a residential installation. This equipment generates, uses and can radiate radio frequency energy and, if not installed and used in accordance with the instructions, may cause harmful interference to radio communications. However, there is no guarantee that interference will not occur in a particular installation. If this equipment does cause harmful interference to radio or television reception, which can be determined by turning the equipment off and on, the user is encouraged to try to correct the interference by one or more of the following measures:

- Reorient or relocate the receiving antenna.
- Increase the separation between the equipment and receiver.
- Consult the dealer or an experienced radio/TV technician for help.

Note: Changes or modifications not expressly approved by the manufacturer responsible for compliance could void the user's authority to operate the equipment.

STOP!

Do not return your vehicle to the store!

We're a toll-free phone call away and we can help.

If you are missing parts or need assistance, please see the contact information below.

- Model Number IGOR0039
- PEG PEREGO U.S.A Inc. 3625 INDEPENDENCE Dr. FORT WAYNE IN 46808
- fax 260-484-2940
- call us toll free 1-800-728-2108
- llame USA gratis 1-800-225-1558
- PEG PEREGO CANADA Inc.
- 585 GRANITE COURT PICKERING ONT. CANADA L1W3K1
- fax 905-839-9542
- call us toll free 1-800-661-5050
- PEG PEREGO S.p.A.
- via A. De Gasperi, 50 20862 ARCORE (MB) ITALIA

www.pegperego.com

FAQS

What is the weight capacity of the Peg Perego IGOR0039 Ground Force Tractor?

The Peg Perego IGOR0039 Ground Force Tractor has a weight capacity of up to 85 lbs.

What type of battery does the Peg Perego IGOR0039 Ground Force Tractor use?

The Peg Perego IGOR0039 Ground Force Tractor uses a 12-volt rechargeable battery.

How many speeds does the Peg Perego IGOR0039 Ground Force Tractor offer?

The Peg Perego IGOR0039 Ground Force Tractor offers two forward speeds (2.5 and 4.5 mph) and one reverse speed.

What is the recommended age range for children to use the Peg Perego IGOR0039 Ground Force Tractor?

The recommended age range for the Peg Perego IGOR0039 Ground Force Tractor is 3 to 7 years.

What are the dimensions of the Peg Perego IGOR0039 Ground Force Tractor?

The dimensions of the Peg Perego IGOR0039 Ground Force Tractor are 24.5 x 26.5 x 67.5 inches.

What type of materials are used in the construction of the Peg Perego IGOR0039 Ground Force Tractor?

The Peg Perego IGOR0039 Ground Force Tractor is made of high-quality plastic and metal components.

How long has the Peg Perego IGOR0039 Ground Force Tractor been available on the market?

The Peg Perego IGOR0039 Ground Force Tractor has been available since January 1, 2013.

What is the best sellers rank of the Peg Perego IGOR0039 Ground Force Tractor in Toys & Games?

The Peg Perego IGOR0039 Ground Force Tractor ranks #5,661 in Toys & Games.

What is the item weight of the Peg Perego IGOR0039 Ground Force Tractor?

The item weight of the Peg Perego IGOR0039 Ground Force Tractor is 50 pounds.

What is the customer rating for the Peg Perego IGOR0039 Ground Force Tractor?

The Peg Perego IGOR0039 Ground Force Tractor has a customer rating of 4.7 out of 5 stars.

How is the Peg Perego IGOR0039 Ground Force Tractor powered?

The Peg Perego IGOR0039 Ground Force Tractor is powered by a 12-volt rechargeable battery that is included in the package.

Video-Peg Perego IGOR0039 Ground Force Tractor

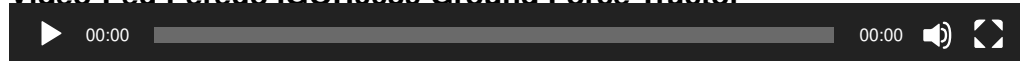

[Download this Manual: https://www.pegperego.com/wp-content/uploads/2024/07/Peg-Perego-IGOR0039-Ground-Force-Tractor-.mp4](https://www.pegperego.com/wp-content/uploads/2024/07/Peg-Perego-IGOR0039-Ground-Force-Tractor-.mp4)

[Peg Perego IGOR0039 Ground Force Tractor User Manual](#)

References

- [User Manual](#)

[Manuals+](#), [Privacy Policy](#)

This website is an independent publication and is neither affiliated with nor endorsed by any of the trademark owners. The "Bluetooth®" word mark and logos are registered trademarks owned by Bluetooth SIG, Inc. The "Wi-Fi®" word mark and logos are registered trademarks owned by the Wi-Fi Alliance. Any use of these marks on this website does not imply any affiliation with or endorsement.