



# PEERLESS Renna Surface Mount Patterns Static Instruction Manual

[Home](#) » [Peerless](#) » PEERLESS Renna Surface Mount Patterns Static Instruction Manual 

## Contents

- [1 PEERLESS Renna Surface Mount Patterns Static](#)
- [2 Product Information](#)
- [3 Usage Instructions](#)
- [4 IMPORTANT SAFEGUARDS](#)
- [5 INSTALLATION INSTRUCTIONS](#)
- [6 Identification of Renna Luminaire](#)
- [7 Mounting Kit – Surface Mount \(RNNAS\)](#)
- [8 Overview of RNNASP Installation](#)
- [9 Transitions used in Surface Mount Patterns](#)
- [10 Documents / Resources](#)
  - [10.1 References](#)
- [11 Related Posts](#)

# Peerless®

**PEERLESS Renna Surface Mount Patterns Static**

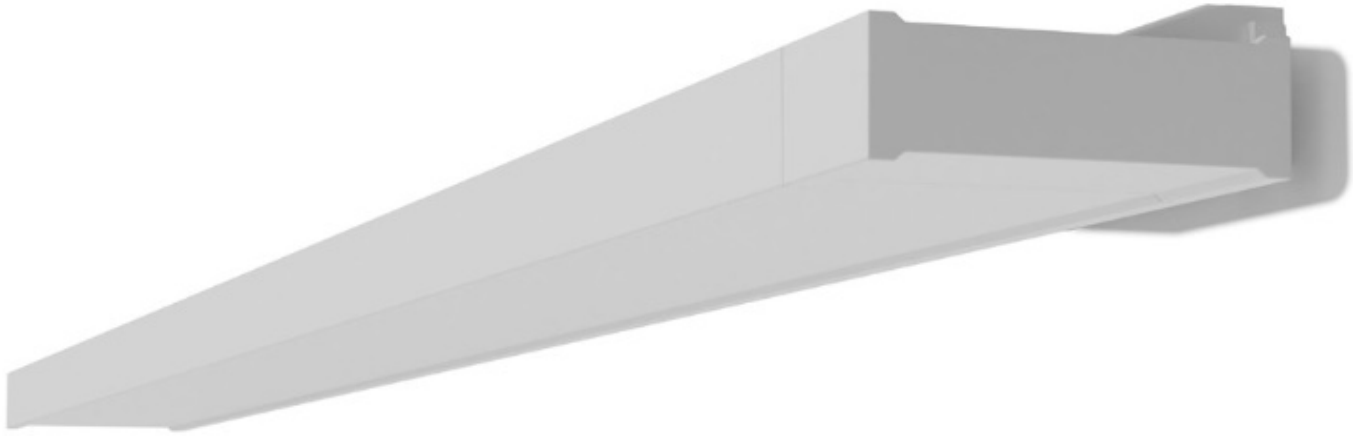

## Product Information

The product is the Modulus luminaire, specifically the Peerless Renna model. It is a lighting fixture that is designed to be powered by low voltage DC power provided from an adequately rated Modulus head unit. It is important to note that line voltage should not be connected to Modulus luminaires as this can cause product damage or void product warranties. The product comes with a limited warranty, and complete warranty terms can be found on the Acuity Brands website.

## Usage Instructions

Before using the Modulus luminaire, it is important to read and follow all safety instructions provided in the user manual. When installing or servicing the product, it is essential to disconnect or turn off power and allow the lamp/fixture to cool before handling. Do not touch hot lens, lamp, guard, or enclosure. Make sure to verify that the supply voltage is correct by comparing it with the equipment label information. Also, do not exceed the maximum wattage marked on the luminaire label. All electrical and grounded connections should be made in accordance with the National Electrical Code (NEC) and any applicable local code requirements. When removing equipment from the carton, installing, servicing, or performing maintenance, it is crucial to wear gloves and safety glasses at all times. Avoid direct eye exposure to the light source while it is on. Keep combustible and other materials that can burn away from lamp/lens and do not operate in close proximity to persons, combustible materials, or substances affected by heat or drying. It is important to follow all lamp manufacturer's warnings, recommendations, and restrictions on lamp operation including but not limited to: ballast type, burning position, replacement, and recycling. All wiring connections should be capped with UL approved recognized wire connectors. For specific installation instructions and additional warnings or any applicable FCC or other regulatory statements, please refer to the product manual. Failure to follow any of these instructions could void product warranties.

## IMPORTANT SAFEGUARDS

When using electrical equipment, basic safety precautions should always be followed including the following:

### READ AND FOLLOW ALL SAFETY INSTRUCTIONS

- To reduce the risk of death, personal injury or property damage from fire, electric shock, falling parts, cuts/abrasions, and other hazards please read all warnings and instructions included with and on the fixture box and all fixture labels.
- Before installing, servicing, or performing routine maintenance upon this equipment, follow these general precautions.
- Installation and service of luminaires should be performed by a qualified licensed electrician.
- Maintenance of the luminaires should be performed by person(s) familiar with the luminaires' construction and

operation and any hazards involved. Regular fixture maintenance programs are recommended.

- Do not use outdoors.
- Do not mount near gas or electric heaters.
- Equipment should be mounted in locations and at heights where it will not be subjected to tampering by unauthorized personnel.
- The use of accessory equipment not recommended by the manufacturer may cause an unsafe condition.
- Do not use this equipment for other than its intended use.
- It will occasionally be necessary to clean the outside of the refractor/lens. Frequency of cleaning will depend on ambient dirt level and minimum light output which is acceptable to user. Refractor/lens should be washed in a solution of warm water and any mild, non abrasive household detergent, rinsed with clean water and wiped dry. Should optical assembly become dirty on the inside, wipe refractor/lens and clean in above manner, replacing damaged gaskets as necessary.
- **DO NOT INSTALL DAMAGED PRODUCT!** This luminaire has been properly packed so that no parts should have been damaged during transit. Inspect to confirm. Any part damaged or broken during or after assembly should be replaced.
- Recycle: For information on how to recycle LED electronic products, please visit [www.epa.gov](http://www.epa.gov).
- These instructions do not purport to cover all details or variations in equipment nor to provide every possible contingency to meet in connection with installation, operation, or maintenance. Should further information be desired, or should particular problems arise which are not covered sufficiently for the purchaser's or owner's purposes, this matter should be referred to Acuity Brands Lighting, Inc.

#### **WARNING RISK OF ELECTRIC SHOCK**

- Disconnect or turn off power before installation or servicing.
- Verify that supply voltage is correct by comparing it with the equipment label information.
- Make all electrical and grounded connections in accordance with the National Electrical Code (NEC) and any applicable local code requirements.
- All wiring connections should be capped with UL approved recognized wire connectors.

#### **CAUTION RISK OF INJURY**

- Wear gloves and safety glasses at all times when removing equipment from carton, installing, servicing or performing maintenance.
- Avoid direct eye exposure to the light source while it is on.

#### **WARNING RISK OF BURN**

- Allow lamp/fixture to cool before handling. Do not touch hot lens, lamp, guard, or enclosure.
- Do not exceed maximum wattage marked on luminaire label.
- Follow all lamp manufacturer's warnings, recommendations and restrictions on lamp operation including but not limited to: ballast type, burning position, replacement, and recycling.

#### **CAUTION RISK OF FIRE**

- Keep combustible and other materials that can burn away from lamp/lens.
- Do not operate in close proximity to persons, combustible materials or substances affected by heat or drying.

## CAUTION RISK OF PRODUCT DAMAGE

- Modulus luminaires should only receive low voltage DC power provided from an adequately rated Modulus head unit. DO NOT CONNECT LINE VOLTAGE TO MODULUS LUMINAIRES.
- Never connect components under load.
- Do not mount or support these fixtures in a manner that can cut the outer jacket or damage wire insulation.
- Unless individual product specifications deem otherwise: Never connect an LED product directly to a dimmer packs, occupancy sensors, timing devices, or other related control devices. LED fixtures must be powered directly off a switched circuit.
- Unless individual product specifications deem otherwise: Do not restrict fixture ventilation. Allow for some volume of airspace around fixture. Avoid covering LED fixtures with insulation, foam, or other material that will prevent convection or conduction cooling.
- Unless individual product specifications deem otherwise: Do not exceed fixtures maximum ambient temperature.
- Only use fixture in its intended location.
- LED products are Polarity Sensitive. Ensure proper Polarity before installation.
- Electrostatic Discharge (ESD): ESD can damage LED fixtures. Personal grounding equipment must be worn during all installation or servicing of the unit.
- Do not touch individual electrical components as this can cause ESD, shorten lamp life, or alter performance.
- Some components inside the fixture may not be serviceable. In the unlikely event your unit may require service, stop using the unit immediately and contact an ABL representative for assistance.
- Always read the fixtures complete installation instructions prior to installation for any additional fixture specific warnings.

Please see product specific installation instructions for additional warnings or any applicable FCC or other regulatory statements. Failure to follow any of these instructions could void product warranties. For a complete listing of product Terms and Conditions, please visit [www.acuitybrands.com](http://www.acuitybrands.com) Acuity Brands Lighting, Inc. assumes no responsibility for claims arising out of improper or careless installation or handling of its products. ABL LED General Warnings, Form No. 503.203 © 2010 Acuity Brands Lighting, Inc. All rights reserved. 12/01/10

## SAVE THESE INSTRUCTIONS AND DELIVER TO OWNER AFTER INSTALLATION

## INSTALLATION INSTRUCTIONS

**PIN007904 REV. E 09/26 ECO#074 293246**

These installation instructions are used for installing the following luminaires and kits:

Luminaire	Mounting Kit	Endcap Kit	Head Unit
RNNASP	—	—	—

**WARNING:** Please read the “important safety instructions” prior to installation of this product. The mounting

instructions can be found inside the mounting kits  
or downloaded from <https://peerlesslighting.acuitybrands.com/Renna>

**IMPORTANT:** Wear cotton gloves AND lift and handle the luminaire from the ends to avoid damaging or soiling the lens surface. Should the lens surface become smudged or otherwise blemished, clean using only a soft, microfiber cotton cloth.

## Identification of Renna Luminaire

Typical Luminaire layout

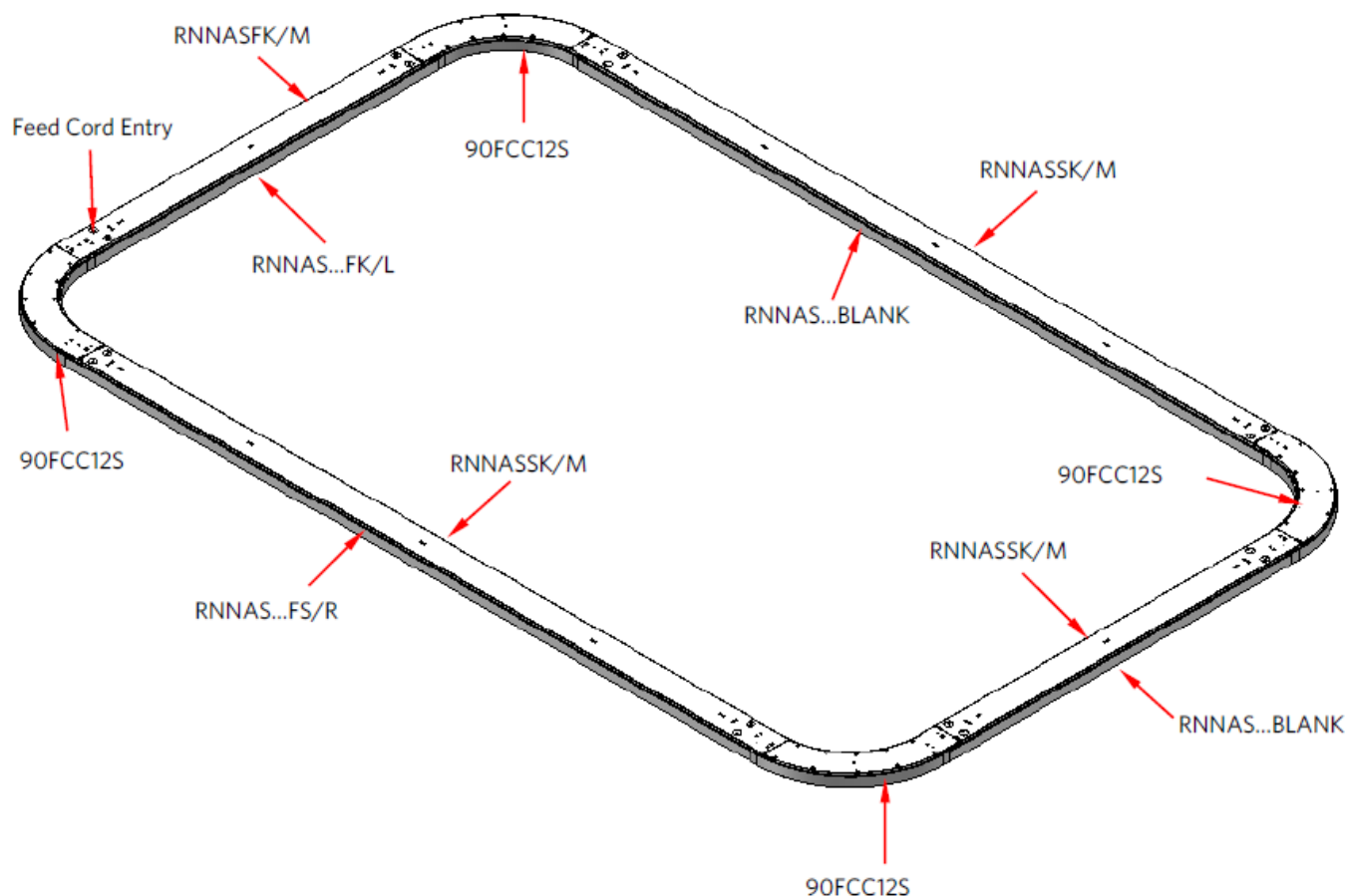

FK/L	Feed Kit / Left
EP	Endcap
FS/R	Feed Stop / Right
SK/L	Support Kit / Left
SK/M	Support Kit / Middle
SK/R	Support Kit / Right

**IMPORTANT:** Each luminaire section must be paired with its corresponding driver enclosure. Look for matching numbers on the luminaire and head unit packaging boxes.

## Mounting Kit – Surface Mount (RNNAS)

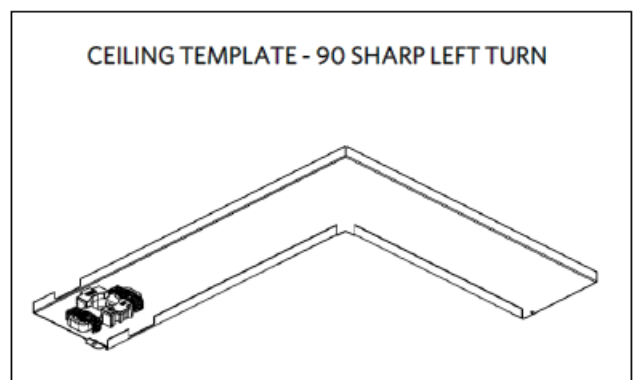
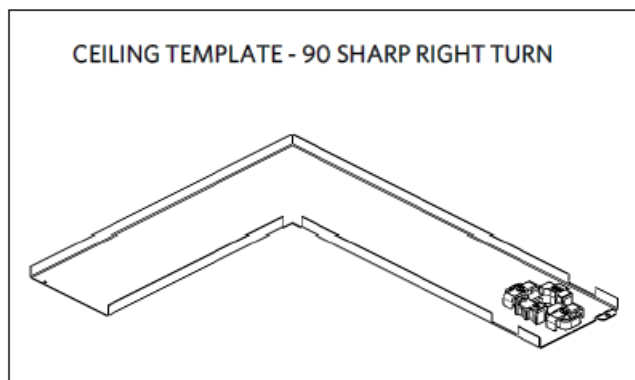
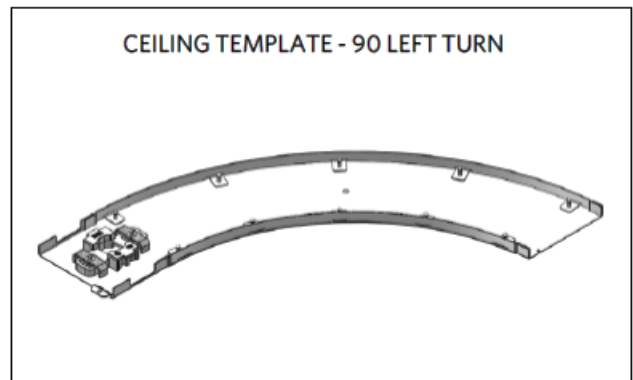
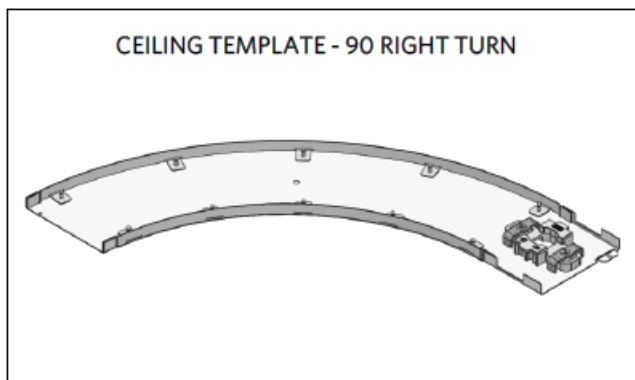
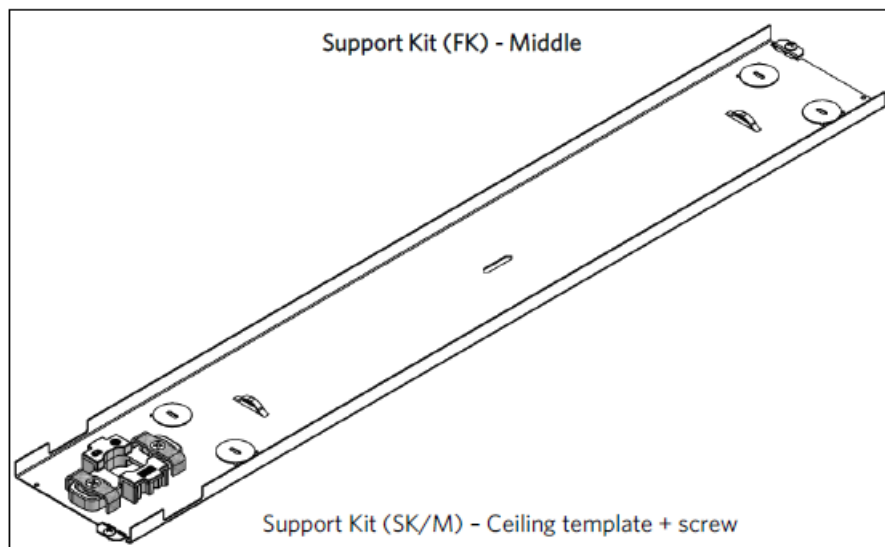

## Overview of RNNASP Installation

### Overview of Installation for Hard Surface Ceiling (F2)

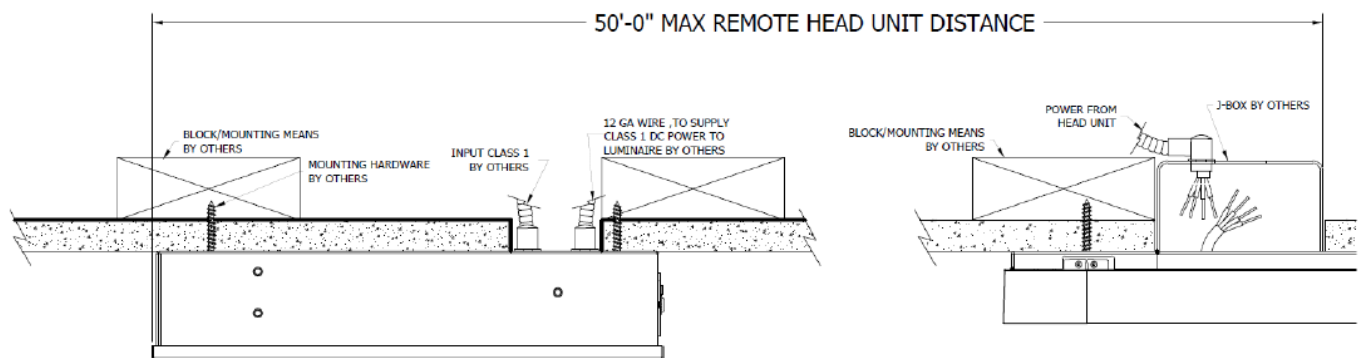

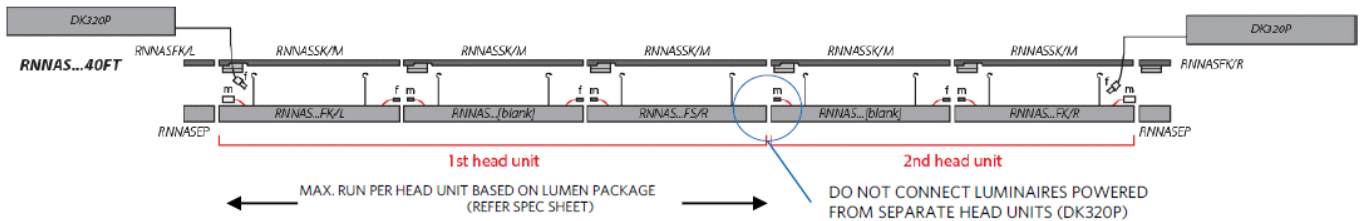

## ELEVATION VIEW TYPICAL LUMINAIRE LAYOUT (\*MOUNTING POINTS CAN VARY BASED ON CONFIGURATIONS)

1. For On-Grid Installations follow steps C1-C3 then skip to Step C7: In an accompanying hardware box, locate a Universal Mounting Bracket (UMB). Insert bolt into bottom hole of Bracket A, then hook Bracket A onto grid
2. Hook Bracket B onto Bracket A. Letters are clearly marked on the UMB.
3. Adjust brackets to proper location along the ceiling grid then screw sides A to B together. Secure the brackets to the building structure per local building codes.

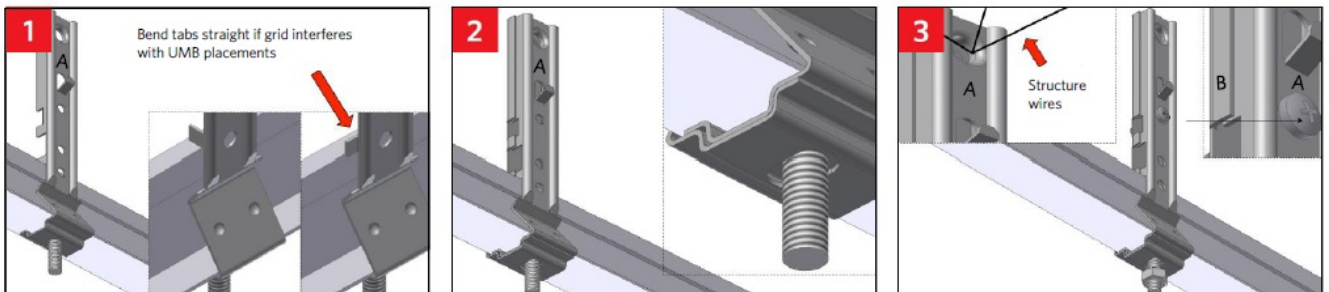

4. For Off-Grid Installations, skip steps C1-C3 begin here at Step C4: In an accompanying hardware box, locate a Universal Mounting Bracket (UMB). Insert bolt into Bracket A. Hook Bracket B onto Bracket A. Secure with nut (DO NOT TIGHTEN).
5. Slide hanger (by others) onto Caddy Bar and fit Caddy Bar into upper slots in the bracket.
6. Adjust brackets to proper location along the ceiling grid then screw sides A to B together. Secure the brackets to the building structure per local building codes.

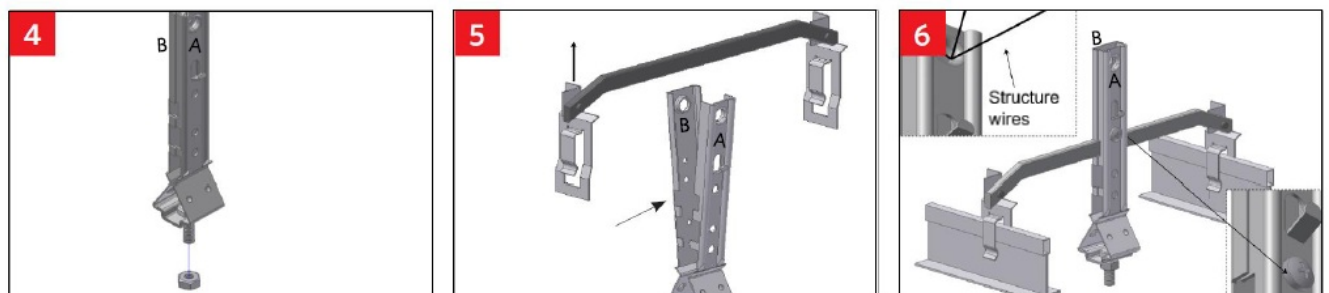

7. Locate the matching driver enclosure box for the luminaire section currently being installed. Remove cover from provided Jbox by unscrewing 2X #8 screws. Attach black bushing to J-Box.
8. Hang J-box assembly onto Bracket A tab and screw J-box to bracket.

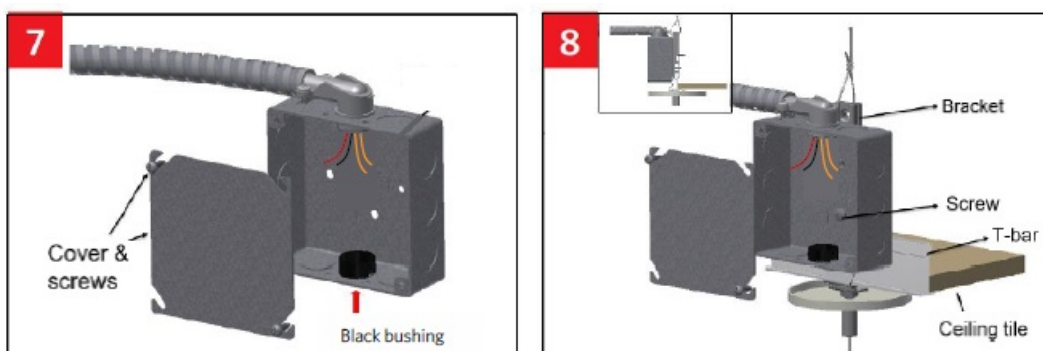



## Luminaire Installation for Hard Surface Ceilings (F2)

1. Near power feed location: Mark the origin "O", on the ceiling. Measure 14 T 7 8 " and T 5 8 " and mark the intersection with A. Trace and cut 2"X4" J-box opening around A center. Alternate J-box location is marked A' as shown above. Install the J-box into the hard surface ceiling (by others). Ensure that the bottom edge of J-box is flushed with the ceiling level.
2. Take the middle template (FK/M) and remove the knock-out that is above the luminaire wireway channel aligned with the J-box center. Insert the Heyco® bushing into the opening and insert the feed cord through it (1). Position the template, on the ceiling at the correct location from origin 'O' and mark the mounting hole positions 'B' (noted with arrows). Predrill a hole, if needed. Mount the middle template to the hard surface ceiling using #8 drywall screws (provided by others).
3. Slide the 90° turn ceiling template towards the middle template and align them using the tabs and their corresponding holes provided (1). Flush the template with the ceiling and mark the hole positions 'B' (noted with arrows) and pre-drill a hole, if needed. Assemble both templates at tabs using 2X #6-32 screws (2) and mount the 90° turn template to the hard surface ceiling using #8 drywall screws (provided by others). TORQUE 8.2-9.2 in-lbs

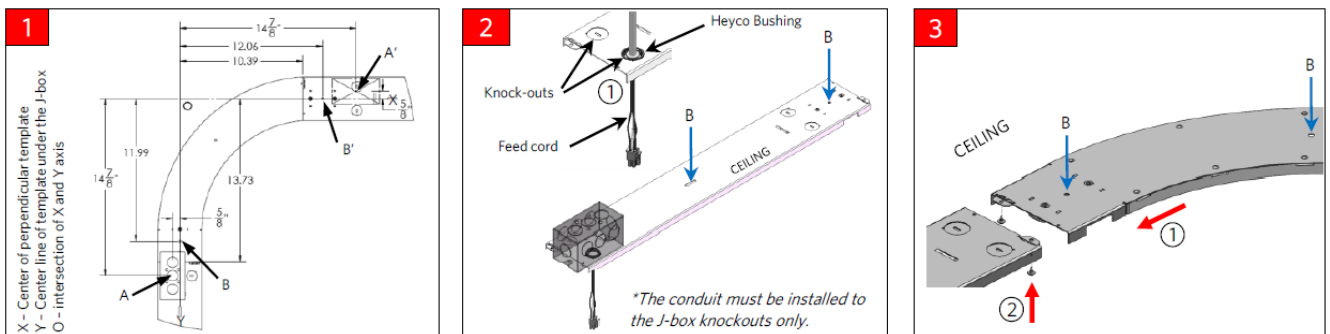

4. Keep adding the ceiling templates till the required transition layout is obtained. Align the templates using the tabs and their holes provided. Mark respective hole positions and pre-drill a hole, if needed. Assemble both templates at tabs using #6-32 screws and mount the templates to the hard surface ceiling using #8 drywall screws (provided by others). TORQUE 8.2-9.2 in-lbs
5. Align the luminaire (FK/L) with the middle ceiling template (FK/M). Connect the safety tether from the luminaire to the lances provided on the ceiling template (the luminaire will hang on the ceiling template through the safety tether). Complete the wire harness by connecting the feed cord to its mating connector on the bus board.
6. Place excess wires into the bus board compartment to avoid pinch points. Lift the luminaire and tighten the 2X set screws slightly on both sides (to ensure luminaire does not hang by the feed cord). The image is an illustration to show one end of luminaire is connected with surface mount bracket and other end on the tether.

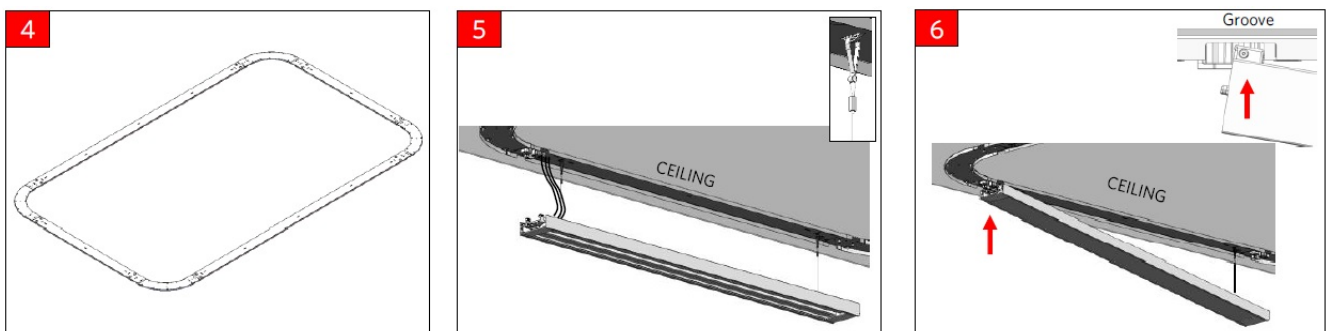

7. Lift and slide the luminaire (1,2) or bracket (3) to align the set screws into groove-1 of the surface mount brackets and tighten it using 4X #8-32 set screws on both ends and both sides of the luminaires using allen key tool provided. Ensure that the wires does not get pinched between surfaces while lifting. TORQUE 4.2-5.8 in-lbs



8. Lift the 90FCC12S transition kit towards the 90° turn template and align it with the luminaire. Complete the wire harness between them using the connectors provided in the transition. Raise the transition towards the ceiling template tighten the 2X set screws slightly on both sides. Ensure that the wires does not get pinched between surfaces while lifting.
9. Lift and slide the transition kit upwards in the groove-2 of the surface mount bracket. Tighten the 4X #8-32 set screws on either sides and both ends of the transition, using the allen key tool provided in the kit. Ensure that the knuckle set screws should be slightly tightened, so that fastening can happen in a quarter turn to half-turn of the set screws. TORQUE 4.2-5.8 in-lbs

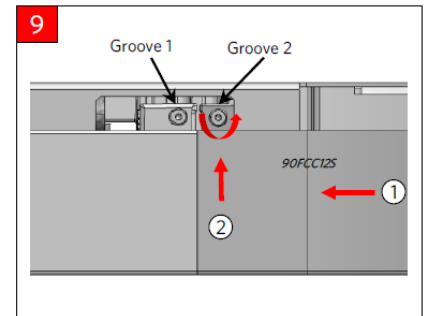
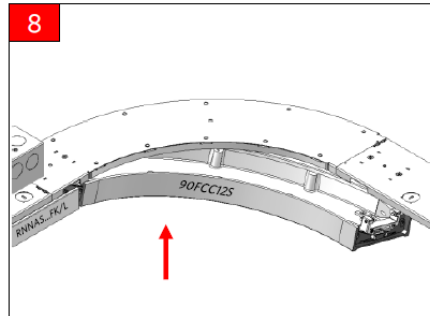
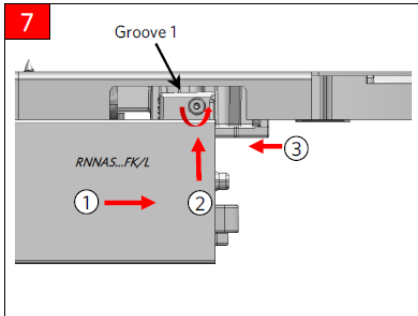

10. Repeat the steps from D5 to D9 till the last transition kit is assembled with the first luminaire in the surface mount pattern. Complete the wire harness between them using the connectors provided in the transitions and luminaires. Ensure that the wires does not get pinched between surfaces while lifting. Fasten the knuckle set screws to the surface mount brackets and make sure that the knuckle set screws should be slightly tightened, so that final fastening can happen in a quarter-turn to half-turn of the set screws. TORQUE 4.2-5.8 in-lbs

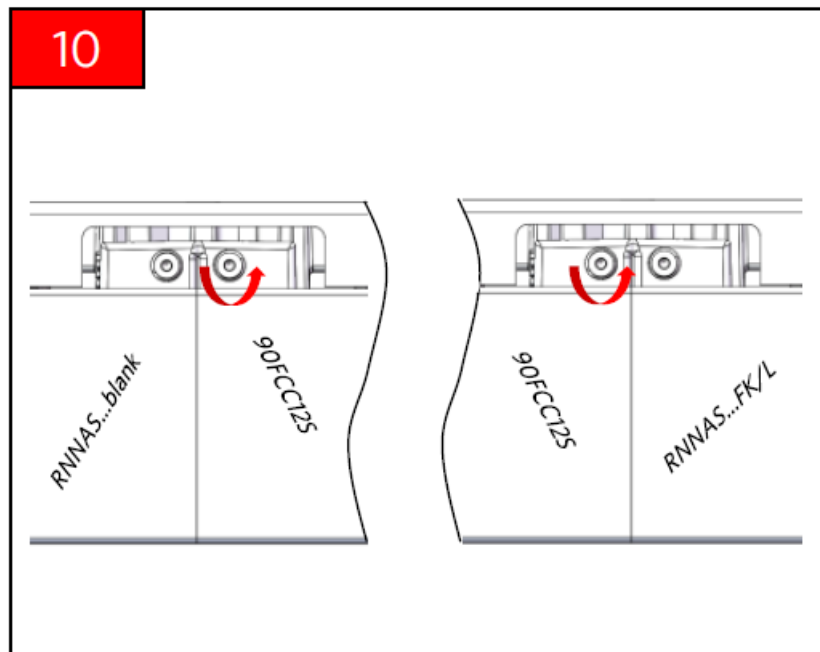

## Transitions used in Surface Mount Patterns

- 90VC3S (90 degree Vertical Corner 3 in Surface Mount)

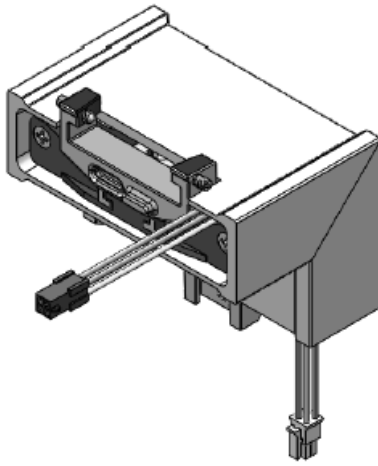

- 90VCC3S (90 degree Vertical Curved Corner 3 in Surface Mount)

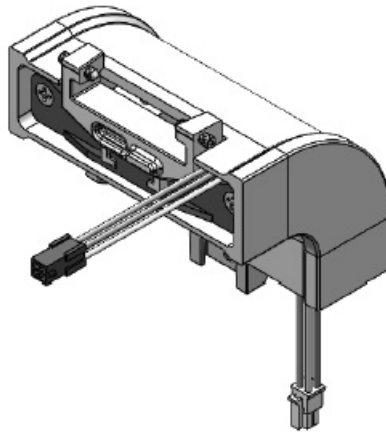

- 90FC4S (90 degree Flat Corner 4 in Surface Mount)

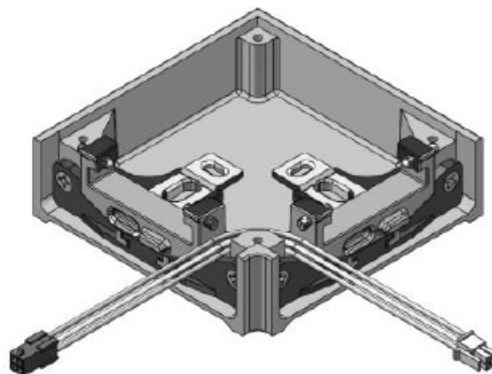

- 90FCC12S (90 degree Flat Curved Corner 12 in Surface Mount)

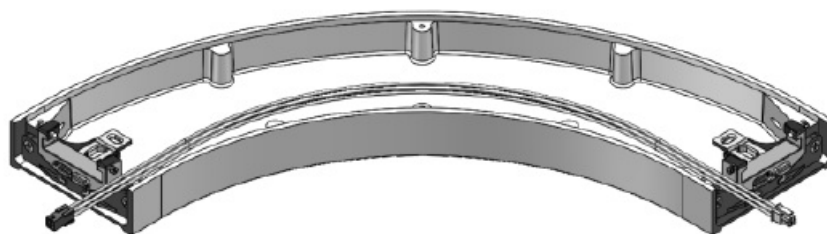

- 90FC12S (90 degree Flat Corner 12 in Surface Mount)

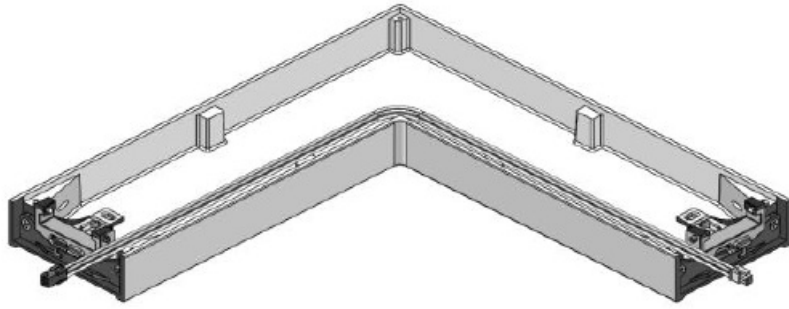

© 2014 Acuity Brands Lighting, Inc. All Rights Reserved.. Products in this document may be covered by one or more U.S. Patents and Patents Pending. Specifications subject to change without notice. Limited warranty applies. Complete warranty terms located at [www.AcuityBrands.com/CustomerResources/Terms\\_and\\_Conditions.aspx](http://www.AcuityBrands.com/CustomerResources/Terms_and_Conditions.aspx)

## Documents / Resources

	<p><b><a href="#">PEERLESS Renna Surface Mount Patterns Static</a></b> [pdf] Instruction Manual  Renna Surface Mount Patterns Static, Surface Mount Patterns Static, Mount Patterns Static, P  atterns Static, Static</p>
--	---

## References

- [Acuity Brands | Lighting, Controls, and Building Management Solutions](#)
- [Acuity Brands | Lighting, Controls, and Building Management Solutions](#)
- [Terms and Conditions and Warranties | Acuity Brands](#)
- [U.S. Environmental Protection Agency | US EPA](#)