

PEAK PNx13 Control 9 Smart Terminal 2024 Controlmicro



PEAK PNx13 Control 9 Smart Terminal 2024 Controlmicro Instruction Manual

[Home](#) » [PEAK](#) » PEAK PNx13 Control 9 Smart Terminal 2024 Controlmicro Instruction Manual 

Contents

- [1 PEAK PNx13 Control 9 Smart Terminal 2024 Controlmicro](#)
- [2 Adapter for Gira Control 9](#)
- [3 Documents / Resources](#)
 - [3.1 References](#)



PEAK PNx13 Control 9 Smart Terminal 2024 Control micro



Adapter for Gira Control 9

1. Switch off the power supply and remove your Gira Control 9 from the flush-mounted box. Switch the power supply and remove your Gira Control 9 from the flush-mounted box.

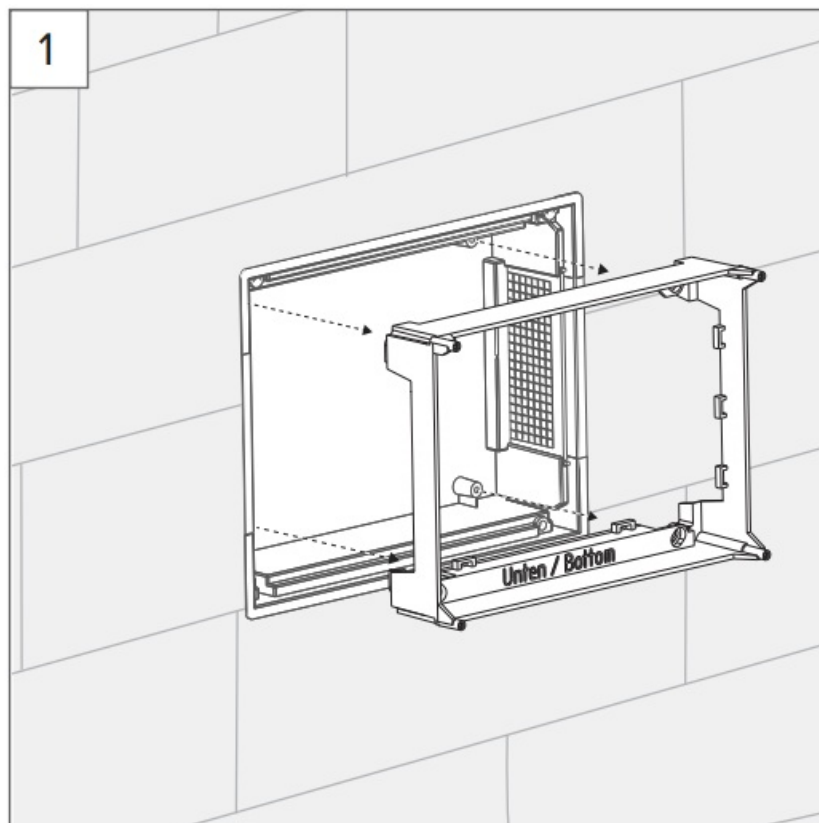

2. Attach the adapters directly to the Gira Control 9 Flush-mounted box. Use the Gira mounting screws for fastening. Plug the adapters directly into the Gira Control 9 flush-mounted box. Use the Gira screws for

fastening.

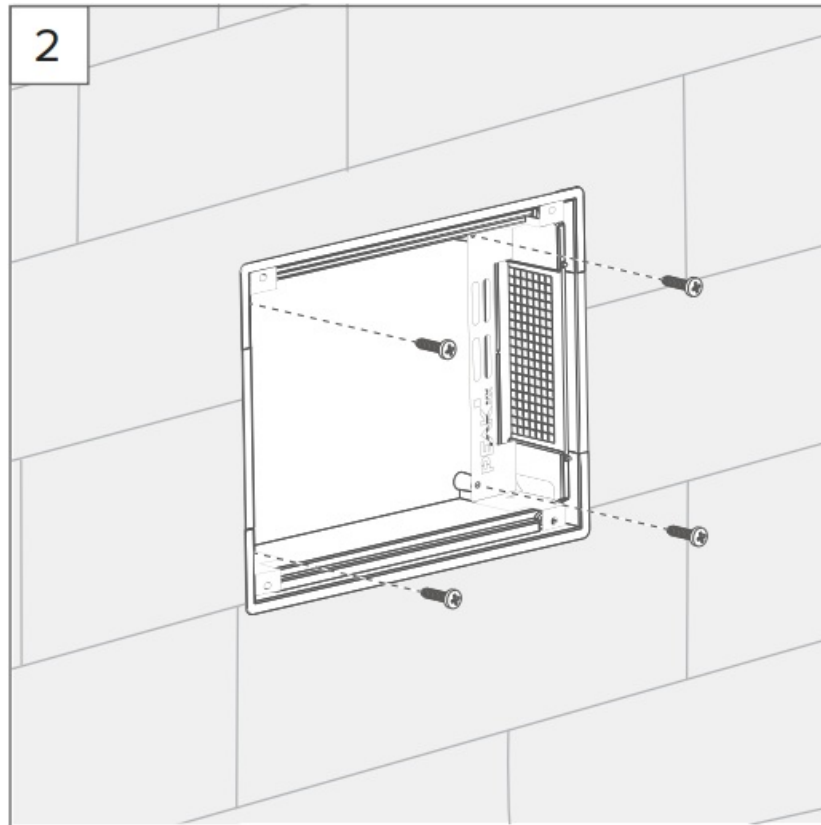

3. Attach the GiraControl 9 adapter plate to the flush-mounted box with the included mounting screws. Fastening the Gira Control 9 adapter plate to the flush-mounted box using the supplied mounting screws.

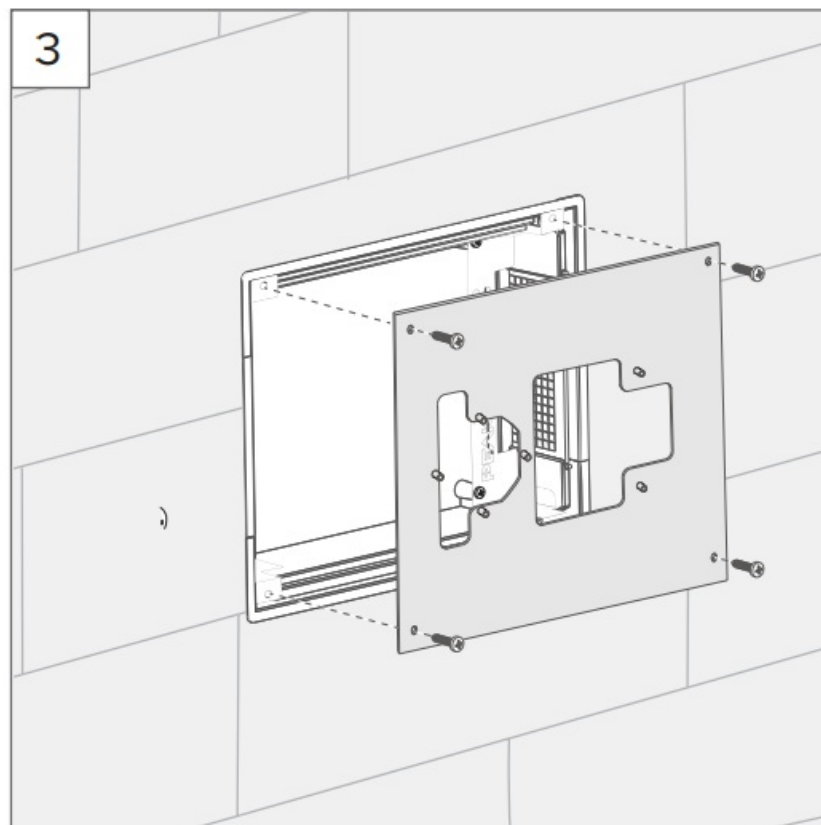

4. Attach the Power supply coming 24 V cable cores to the Screw terminals (GND, 24V) the Control micro mounting plate or plug it in the PoE cable. Connect the KNX and the network cable. Attach the Mounting plate of the Control micro with the ones supplied Screws on the adapter. Plug the 24V cable wires coming from the power supply unit into the screw terminals (GND, 24 V) of the Control micro mounting plate or connect the PoE cable. Connect the KNX and the network cable. Attach the Control micro mounting plate to the adapter using the screws provided.

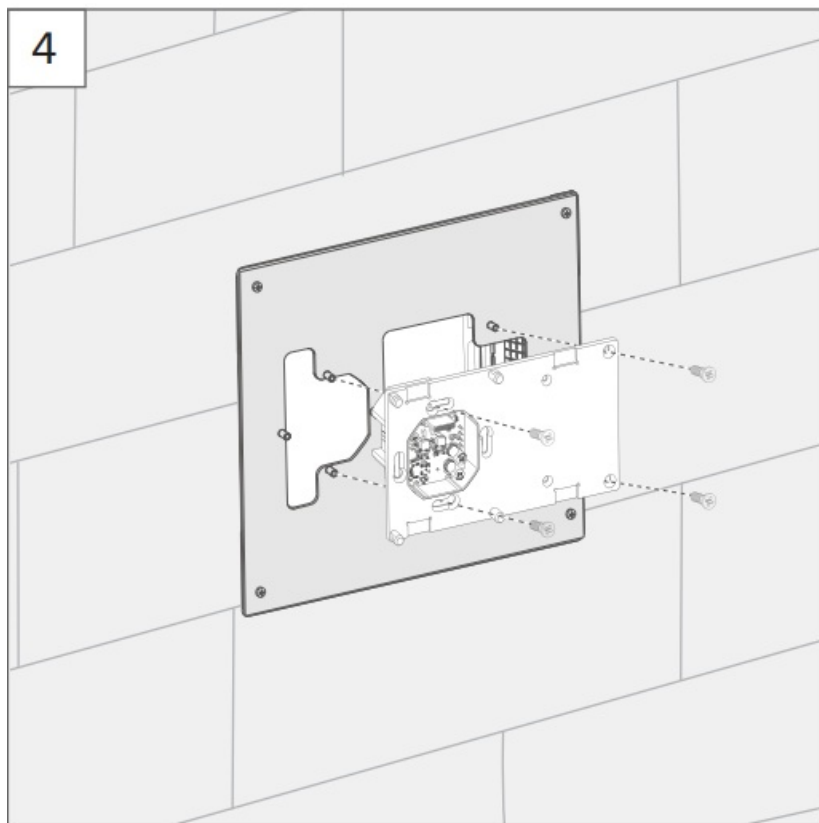

5. Attach the panel to the mounting plate and if necessary, fasten the grub screws to protect against theft. Insert the panel into the mounting plate and fasten the grub screws to prevent theft.

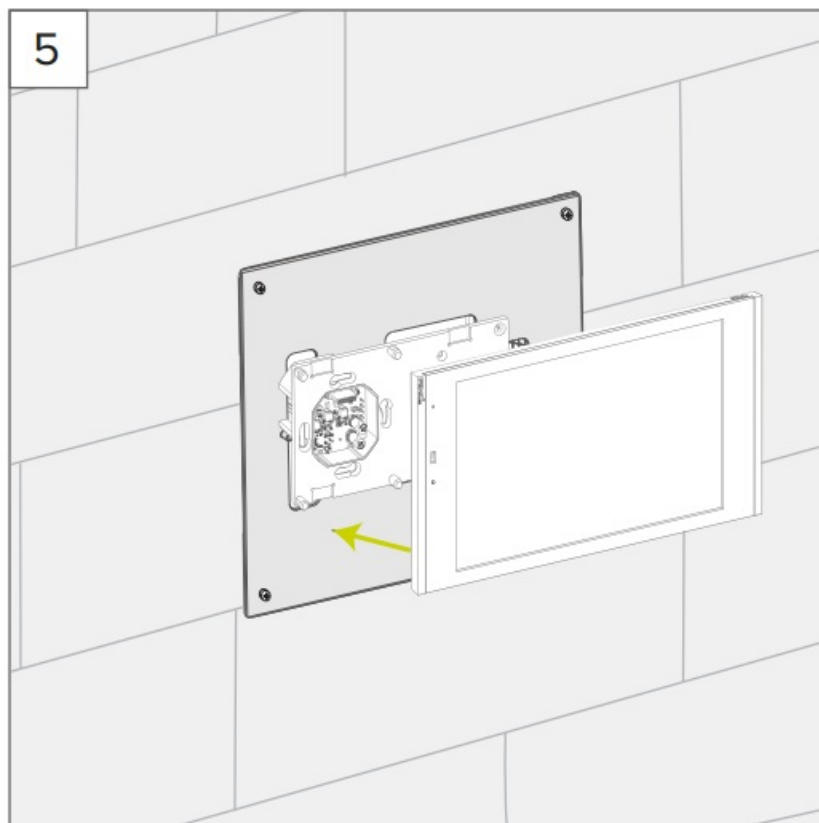

Documents / Resources

	<p>PEAK PN13 Control 9 Smart Terminal 2024 Controlmicro [pdf] Instruction Manual PNX13 Control 9 Smart Terminal 2024 Controlmicro, PNX13, Control 9 Smart Terminal 2024 Controlmicro, Smart Terminal 2024 Controlmicro, Terminal 2024 Controlmicro, Controlmicro</p>
---	--

References

- [User Manual](#)

Manuals+, Privacy Policy

This website is an independent publication and is neither affiliated with nor endorsed by any of the trademark owners. The "Bluetooth®" word mark and logos are registered trademarks owned by Bluetooth SIG, Inc. The "Wi-Fi®" word mark and logos are registered trademarks owned by the Wi-Fi Alliance. Any use of these marks on this website does not imply any affiliation with or endorsement.